



**OWNERS MANUAL  
PAGER ALARM LOCK (P.A.L.)**

## **CONGRATULATIONS**

You have purchased the only motorcycle lock that has both an alarm, and a transmitter-pager unit. Today's motorcycles are wonders of electronic complexity. Many have totally electronic ignitions: and fuel injection managed by computers. All of which can be negatively affected by tampering with their connections and wiring. At Bully Locks we know that you want the peace of mind of an alarm, but also of a high quality physical lock, and also a pager. Until now, your only choices were very expensive integrated alarm systems that require you to cut wires and patch in components to your bike's electrical system. Some have audible alarms that you probably wouldn't be able to hear inside a building.

The Bully Locks Pager Alarm Lock (P.A.L.) is a tough, fully-tempered steel lock with a pick-resistant, 9-cylinder tumbler and a fully integrated pager alarm. The P.A.L. requires no wire cutting/splicing or battery-draining, after-market electronics. It will not leave you defenseless. The P.A.L. is complete, integrated, portable and effective when used as explained in this manual. On top of that, you have saved hundreds of dollars over the "cut and splice" systems... Smart choice! Now you can have a meal or run into the store, and know that you have your P.A.L. "looking out" for you!

Please take a few minutes to read through this manual as it points out the operation, features and benefits of your new P.A.L.. You will see that it is simple to use and care for.

## **INDEX**

Index .....	1
Disclaimer .....	2
Package contents .....	3
Alarm features .....	4
Lock features .....	4
Locking mechanism features .....	4
Alarm activation .....	5
Alarm deactivation .....	5
Installation of the lock battery .....	6
Pager features and functions .....	7
Pager activation and deactivation .....	8
Setting up the pager .....	9
Pager Battery installation .....	9
Trouble-shooting .....	10
Main specifications .....	11

## **DISCLAIMER**

### **FIRST AND FOREMOST, YOUR SAFETY!**

Our pager alarm is designed to alert you to movement of your motorcycle. This could be someone trying to take parts, someone hitting your parked motorcycle with their vehicle, kids sitting on it or even someone trying to steal it. In response to an alert from your P.A.L., you could return to your bike and find someone tampering with or even attempting to steal it.

We at Bully Locks value our customers' safety and well-being above all else. We NEVER condone confrontation of a person or persons tampering with your motorcycle. Even if you are accompanied, confrontation is very dangerous and could lead to bodily injury or death. If you discover a thief near your motorcycle, immediately call the nearest security and/or the police. Bully Locks cannot and will not be responsible for any losses or personal injury incurred due to the lock user confronting another individual or individuals.

You should know that any lock or security system is only a deterrent and can in no way guarantee or insure that your motorcycle (or parts of it) will not be stolen or tampered with. The best that you can hope for is that the thief sees the lock or hears the alarm and decides to move on to another easier-to-steal motorcycle. Of course, common sense must always be used when parking your motorcycle and careful consideration must be given to the location in which you leave your motorcycle unattended: visible, populated, well lit areas, within range of the pager are best. No amount of security can totally protect your property from determined criminals. Bully Locks is not responsible for stolen or damaged motorcycles, the destruction of the Bully Lock, damage to the motorcycle caused by the user forgetting to remove the lock (or any other consequential or collateral damages caused by the same) the motorcycle being towed, the lock system being removed from the wheel and/or batteries running flat by not being replaced at regular intervals or being incorrectly fitted. Nor is Bully Locks responsible for any of the actions of any person or persons that do manage to defeat the lock and steal the motorcycle. Again, this lock is a deterrent only.

Users of Bully Locks must read, fully understand and follow the operating instructions in this manual. Bully Locks is not responsible for damages or losses resulting from applications not compliant with this manual. This Bully Lock has been designed as a deterrent to motorcycle theft only. There is no guarantee against any parts, accessories or equipment being stolen. You must NOT use this Bully Lock for purposes for which it was not designed, nor expressly mentioned in this manual. This lock is designed for short term use, for longer periods it is necessary to use other devices (available from Bully Locks) and take additional measures for a comprehensive "security system".

### **GET INTO THESE HABITS, TO PROTECT YOURSELF, OTHERS AND YOUR BIKE:**

- Be sure to unlock and remove the lock BEFORE you start your motorcycle. Even before you put the key in the motorcycle ignition! Damage to persons and or property will result if this first step isn't followed
- Lock securely with the shackle around the wheel and tire (and fork if possible). Make certain it is securely fastened, and won't fall off
- Do not use this Bully Lock as a weapon against any person or object or as a tool
- After removal of your Bully Lock, make sure it is stored in a secure place and cannot fall off the bike when you are in motion
- You must not dismantle this Bully Lock or adapt it for other purposes
- This Bully Lock is Water-resistant, NOT waterproof, do not soak or immerse it in water. Store it in a dry place
- Use only a dry cloth when cleaning this Bully Lock; don't use water, alcohol, sprays or detergents
- Lubricate the key hole and the moving parts monthly
- Dispose of any battery in a responsible manner, drop off at a recycler

## PACKAGE CONTENTS

### PLEASE CHECK THAT CONTENTS MATCH THIS LIST:

- Motorcycle alarm lock
- L.C.D. pager
- Two keys with key code plate
- Owners manual
- Spare screw
- Allen wrench

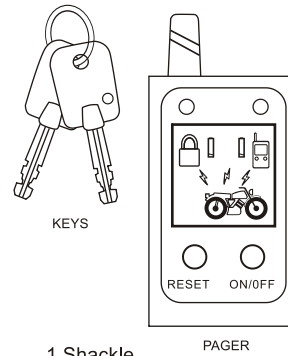
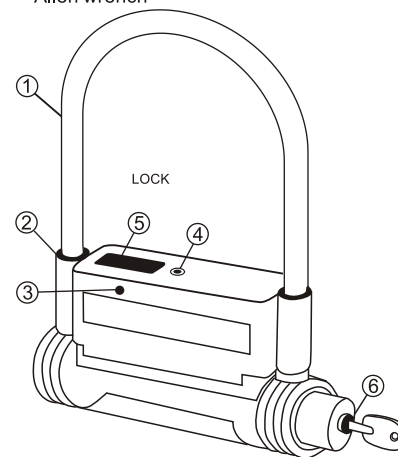

- 1.Shackle
- 2.Alarm
- 3.L.E.D. indicator
- 4.Lock body cover screw
- 5.Siren port
- 6.Keyhole

## FEATURES AND FUNCTIONS

General Features and Advantages over conventional hard-wired alarms:

- Simple and easy to install and use.
- No cutting of motorcycle wiring harness (no mass of confusing wiring!)
- No risk of damage to your motorcycle electrical system.
- No risk of draining your motorcycle battery.
- Also can secure your motorcycle to a post or other object.
- Can be easily transferred from bike to bike.

**ALARM FEATURES:**

- High temperature durability, operation temperature is -22°F to +175°F.
- High electrical resistance (can withstand 200,000 volts). The lock immediately sends a message if it senses an unusual electric surge.
- Warning sound is about 100 dB.
- Uses one, 9-volt alkaline battery

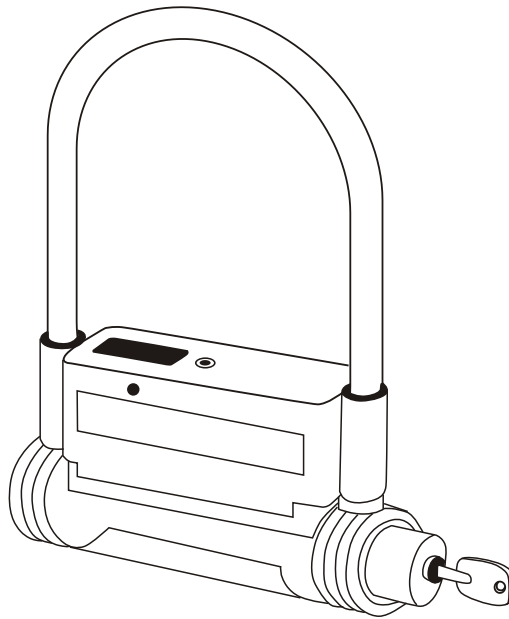
**LOCK BODY FEATURES:**

- Lock body and U-shackle are hard-to-cut, high-tempered steel.
- The transmitter has over 1,000,000 different codes to prevent unauthorized access.

**LOCKING MECHANISM FEATURES:**

- Patented 9 Disc cylinder lock which is pick resistant.
- The discs and the tumbler body are also high-tempered steel to resist damage from drills.
- Up to 20,000,000 key code combinations make it hard to duplicate.
- A replacement key is available directly from the manufacturer.
- Made from high-quality, durable alloy making it almost unbreakable and rust-resistant.

## ALARM ACTIVATION AND DEACTIVATION

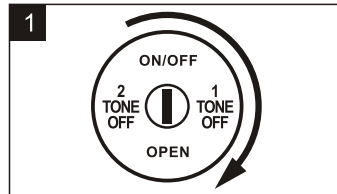

- Insert the key into the keyhole
- Turn the key clockwise to the "OPEN" position

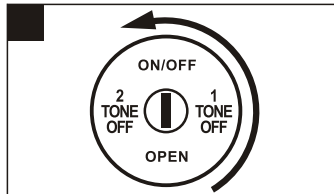

- Turn the key counter clockwise to the "ON/OFF" position

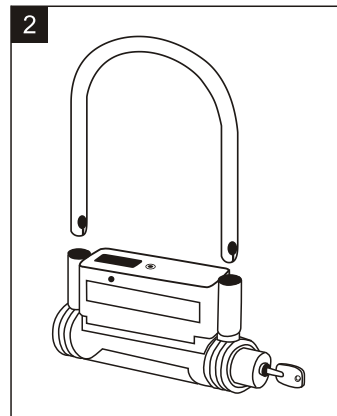

- Pull out the shackle
- Place the shackle around the wheel and tire (not just the spokes)
- Install the lock body on the shackle

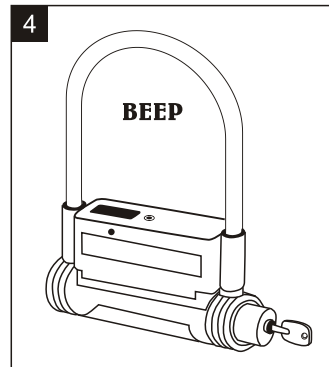

- The lock will sound one short "beep"
- Remove the key and the alarm is activated
- Place the warning lanyard on the throttle (to remind you that the lock is installed)

### IMPORTANT:

- Each key has nine barrels on the lock cylinder. You must insert the key all the way in or you will be unable to lock the unit. Using force will damage the key.
- If you have difficulty inserting the key, gently wiggle it as you insert it.
- The pager beeps once to signify that it has been switched on.
- The pager beeps twice to signify that it has been switched off.
- If the alarm sounds during the unlocking process, insert the key and turn to the "Open" position and remove the shackle.

## ALARM DEACTIVATION

- Follow the above steps in reverse order to deactivate alarm.
- When alarm is successfully deactivated the lock will sound two short "beeps"

## INSTALLATION OF THE LOCK BATTERY

1. Insert the key into the keyhole
2. Turn the key clockwise to the "OPEN" position and remove the shackle.
3. Using the supplied "L" shaped hex wrench, remove the retaining screw in the top center of the alarm body and pull the protective cover up and off.
4. Using the supplied hex wrench, unscrew and remove the two screws securing the battery compartment cover. Care must be taken when removing and installing the battery compartment cover as it contains a thin rubber seal for water resistance.
5. Insert a new 9-volt alkaline battery being careful to match the polarity of the battery with the markings inside the unit
6. Replace the battery compartment cover, making sure it is seated correctly, and install the two screws
7. Slide the protective cover over the lock body and install the retaining screw.
8. Reinsert the shackle.

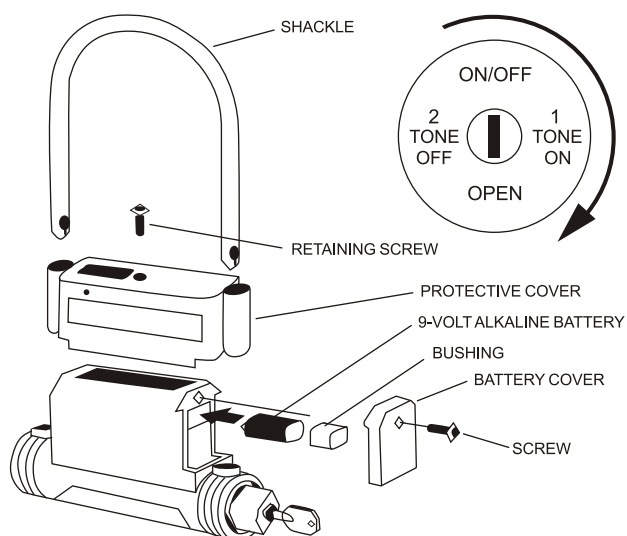

**IMPORTANT:** The enclosed batteries may discharge during testing. Please change the battery if the sound is too weak or if the alarm beeps three times or the pager sounds a warning and shows the low battery icon.



### **PAGER FEATURES:**

- Small convenient size
- Robust construction
- Can receive more than 1,000,000 different codes
- Use one, 1.5-volt AAA alkaline battery

### **L.C.D. PAGER FUNCTIONS**

- |                        |  |
|------------------------|--|
| 1. L.E.D. Indicator    | Flashes when activated, also when in arming mode and when the alarm sounds   |
| 2. L.C.D. Screen       | Flashes according to the warning status.   |
| 3. Reset               | Stops the warning sound or vibration when receiving a signal from the lock. Also to toggle between warning sound and vibration |
| 4. Power ON/OFF Button | When the lock is activated or deactivated, the pager is activated or deactivated simultaneously.                               |

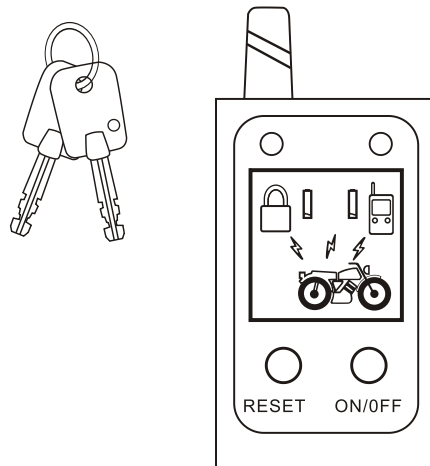

A sufficient impact to or movement of the lock will immediately trigger the alarm. The audible warning is approximately 100 dB. At the same time, a signal is transmitted to the pager up to a half mile away depending on conditions, which will cause the pager to produce an audible warning, and/or vibrate. This is accompanied by the alert status being displayed on the L.C.D. screen.

## PAGER ACTIVATION AND DEACTIVATION

Before using the pager check that the power level of the battery is sufficient. If the pager beeps every 5 seconds when in standby mode the battery is low.

### ACTIVATION:

After installing and activating the lock, press the "ON/OFF" button once to activate the pager

The pager will emit one long beep and the pager symbol will flash approximately once every second. The two green L.E.D.s will also flash approximately every 4 seconds

When alarm lock is triggered, it will immediately notify the pager which will emit a warning sound

To stop the warning sound, simply press "RESET" after 10 seconds

Always take the pager with you!

### DEACTIVATION:

Before deactivating the lock, press "ON/OFF" to switch the pager off. It will confirm with two short beeps.

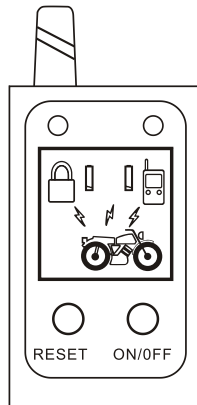

## SETTING UP THE PAGER

### ACTIVATE PAGER VIBRATION MODE

1. Whenever the pager is switched on it is in audio mode.
2. To activate the vibration mode, press "RESET" until the pager starts to vibrate; release the button immediately to remain in vibration mode.

### DEACTIVATE PAGER VIBRATION MODE

1. When in vibration mode press "RESET" until the pager beeps; release the button immediately to return to audio mode

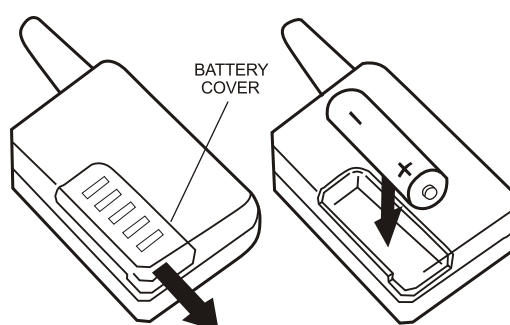
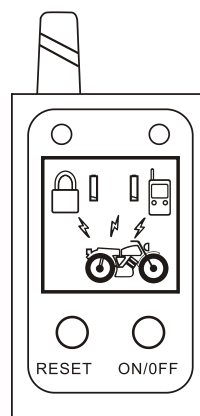

## PAGER BATTERY INSTALLATION

1. The pager emitting a warning sound every 5 seconds, when in standby mode, indicates the battery is low
2. When the L.C.D. screen shows the Low Battery icon, please install a new AAA alkaline battery
3. Slide the battery compartment cover in the direction of the arrow
4. Place the battery in the compartment paying careful attention to the polarity of the battery and the markings inside the compartment
5. Slide the battery compartment cover back into its original position

## **TROUBLE-SHOOTING**

Lock	Alarm does not work	<ol style="list-style-type: none"><li>1. Battery is depleted, replace with 9-volt alkaline battery.</li><li>2. Battery installation is incorrect. Check the battery and make sure the positive and negative poles are in position.</li></ol>
Pager	No power	Battery depleted, replace with a AAA battery
Pager	No warning sound	<ol style="list-style-type: none"><li>1. The pager is out of range. Make sure you park the motorcycle within range.</li><li>2. Pager is in vibrating mode. This silences the audible warning. Set to audible mode in order to receive the audible alarm.</li></ol>
Pager	Beeps every 5 seconds	The pager battery is low

## **MAIN SPECIFICATIONS**

### **LOCK**

Volume of alarm:	About 100dB (near the buzzer)
Operational temperature range	-22°F to +175°F
Tensile strength:	Approximately 4,500kg/9,900lbs. (lock and lock bolt)
Shear strength:	Approximately 5,000kg/11,000lbs. (shackle)
Electric shock durability:	Approximately 200,000 Volts
Hardness:	Above 60 HRC (metal)
Size:	24mm tall x 21mm wide x 4 mm deep
Weight:	Approximately 2lbs., 12oz. (without battery)
Power:	One, 9-volt alkaline battery only

### **PAGER AND KEY**

Power:	One, AAA 1.5-volt alkaline battery only
Effective distance:	Approximately 700 m (open area)
Size:	75mm tall x 35mm wide x 18mm deep
Weight:	Approximately 1.2 oz. (without battery)
Key code:	20,000,000 combinations

### **SUPPORT AND BACKUP**

12-month warranty:	Under normal operation within warranty period. If any failure is caused by manufacturer error, send it back to the distributor for repair.
Spare key:	Contact the distributor with the key code when you need to purchase a spare key.

Please note: specifications may be altered without prior notice.

### **Federal Communications Commission (FCC) Statement**

15.21

You are cautioned that changes or modifications not expressly approved by the part responsible for compliance could void the user's authority to operate the equipment.

15.105(b)

This equipment has been tested and found to comply with the limits for a Class B digital device, pursuant to part 15 of the FCC rules. These limits are designed to provide reasonable protection against harmful interference in a residential installation. This equipment generates, uses and can radiate radio frequency energy and, if not installed and used in accordance with the instructions, may cause harmful interference to radio communications. However, there is no guarantee that interference will not occur in a particular installation. If this equipment does cause harmful interference to radio or television reception, which can be determined by turning the equipment off and on, the user is encouraged to try to correct the interference by one or more of the following measures:

- Reorient or relocate the receiving antenna.
- Increase the separation between the equipment and receiver.
- Connect the equipment into an outlet on a circuit different from that to which the receiver is connected.
- Consult the dealer or an experienced radio/TV technician for help.

### **Operation is subject to the following two conditions:**

- 1) this device may not cause interference and
- 2) this device must accept any interference, including interference that may cause undesired operation of the device.

### **FCC RF Radiation Exposure Statement:**

This equipment complies with FCC radiation exposure limits set forth for an uncontrolled environment. End users must follow the specific operating instructions for satisfying RF exposure compliance. This transmitter must not be co-located or operating in conjunction with any other antenna or transmitter.



[www.bullylocks.com](http://www.bullylocks.com)

Distributed by:  
Tucker Rocky Distributing  
4900 Alliance Gateway Freeway  
Fort Worth, TX 76177  
USA