

# Flash Trigger & Release



## mini-sync

### User Guide



**SMDV**

[www.smdv.co.kr](http://www.smdv.co.kr)

# Table of contents

■ 3p	-----	Specification
■ 4p	-----	Part reference (TX)
■ 5p	-----	Part reference (RX)
■ 6p	-----	Battery (TX)
■ 7p	-----	Battery (RX)
■ 8p	-----	Using with Mono lights
■ 9p	-----	Using with Speed lights
■ 10p	-----	Channel setting
■ 11p	-----	Using as a wireless shutter release
■ 12p	-----	Correct set up example for wireless shutter release
■ 13p	-----	Correct set up example for wireless shutter release
■ 14p	-----	Incorrect set up example for wireless shutter release
■ 15p	-----	Incorrect set up example for wireless shutter release
■ 16p	-----	Cables for camera release function (Sold separately)
■ 17p	-----	Cables for camera release function (Sold separately)
■ 18p	-----	Troubleshooting
■ 19p	-----	Warranty

# Specifications

## Model : mini-sync TX (Transmitter)

Channels : 16

Operating frequency : 2.427GHz~2.457GHz

Max. working range : 100m

Above-average range : 50m

Max. flash sync speed : 1/200sec

Battery : CR2450 3V X 1 Lithium

Sync output voltage : 3V DC

Battery life : Approximately One year or more in standby

(Slightly different depending on the number of uses and method)

Dimensions : 30 x 30 x 36 (mm)

## Model : mini-sync RX (Receiver)

Channels : 16

Operating frequency : 2.427GHz~2.457GHz

Max. working range : 100m

Above-average range : 50m

Max. flash sync speed : 1/200sec

Battery : AA 1.5V X 2 Alkaline

Sync output voltage : 3V DC

Battery life : Approximately 150 hours or more in standby

(Slightly different depending on the number of uses and method)

Dimensions : 54 x 31 x 80 (mm)



Transmitter(TX)



Receiver(RX)

## Part reference (Transmitter)

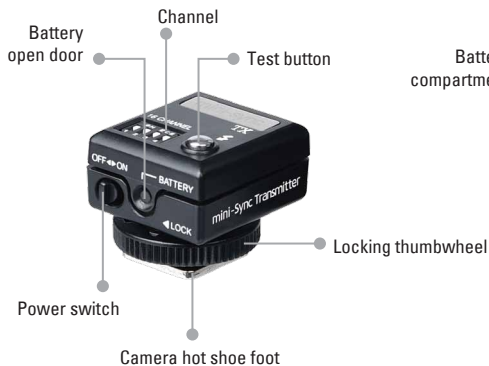

## Part reference (Receiver)



## Battery (Transmitter)



1. Open the battery cover using supplied channel pin or pen.
2. Insert CR2450 3V battery then close it.
3. Power on the transmitter then press the test button to check it correctly works.  
Slide the transmitter onto your camera's hot shoe.  
Then push the camera shutter button to trigger the flashes.



## Battery (Receiver)



1. Open the battery cover then insert two AA batteries.

2. Power on the receiver then the LED status light will on. Now it is ready to operate.

## Using with Mono lights

Mount the transmitter onto the camera's hot shoe.  
Connect the receiver to mono light using supplied 3.5mm flash sync cable.

Attach the receiver to your flash with an adhesive-backed holder.

Power on the flash, transmitter, receiver and your camera.

Synchronize the channel setting both on the transmitter and receiver.

Push the camera's shutter button to trigger the light.



**Receiver(RX)**



**Transmitter(TX)**



**Receiver holder**



# Using with Speed lights

Slide the transmitter onto the camera's hot shoe.  
Mount the flash onto the receiver's hot shoe.  
Power on the flash, transmitter, receiver and your camera.  
Synchronize the channel setting both on the transmitter and receiver.  
Push the camera's shutter button to trigger the flash.



**Transmitter(TX)**



**Receiver(RX)**

# Channel setting

<div>ON ECE</div> <div><input type="checkbox"/> <input type="checkbox"/> <input type="checkbox"/> <input type="checkbox"/></div> <div>1 2 3 4</div>	<div>ON ECE</div> <div><input type="checkbox"/> <input type="checkbox"/> <input type="checkbox"/> <input type="checkbox"/></div> <div>1 2 3 4</div>	<div>ON ECE</div> <div><input type="checkbox"/> <input type="checkbox"/> <input type="checkbox"/> <input type="checkbox"/></div> <div>1 2 3 4</div>	<div>ON ECE</div> <div><input type="checkbox"/> <input type="checkbox"/> <input type="checkbox"/> <input type="checkbox"/></div> <div>1 2 3 4</div>	<div>ON ECE</div> <div><input type="checkbox"/> <input type="checkbox"/> <input type="checkbox"/> <input type="checkbox"/></div> <div>1 2 3 4</div>	<div>ON ECE</div> <div><input type="checkbox"/> <input type="checkbox"/> <input type="checkbox"/> <input type="checkbox"/></div> <div>1 2 3 4</div>	<div>ON ECE</div> <div><input type="checkbox"/> <input type="checkbox"/> <input type="checkbox"/> <input type="checkbox"/></div> <div>1 2 3 4</div>	<div>ON ECE</div> <div><input type="checkbox"/> <input type="checkbox"/> <input type="checkbox"/> <input type="checkbox"/></div> <div>1 2 3 4</div>
Channel 1	Channel 2	Channel 3	Channel 4	Channel 5	Channel 6	Channel 7	Channel 8
<div>ON ECE</div> <div><input type="checkbox"/> <input type="checkbox"/> <input type="checkbox"/> <input type="checkbox"/></div> <div>1 2 3 4</div>	<div>ON ECE</div> <div><input type="checkbox"/> <input type="checkbox"/> <input type="checkbox"/> <input type="checkbox"/></div> <div>1 2 3 4</div>	<div>ON ECE</div> <div><input type="checkbox"/> <input type="checkbox"/> <input type="checkbox"/> <input type="checkbox"/></div> <div>1 2 3 4</div>	<div>ON ECE</div> <div><input type="checkbox"/> <input type="checkbox"/> <input type="checkbox"/> <input type="checkbox"/></div> <div>1 2 3 4</div>	<div>ON ECE</div> <div><input type="checkbox"/> <input type="checkbox"/> <input type="checkbox"/> <input type="checkbox"/></div> <div>1 2 3 4</div>	<div>ON ECE</div> <div><input type="checkbox"/> <input type="checkbox"/> <input type="checkbox"/> <input type="checkbox"/></div> <div>1 2 3 4</div>	<div>ON ECE</div> <div><input type="checkbox"/> <input type="checkbox"/> <input type="checkbox"/> <input type="checkbox"/></div> <div>1 2 3 4</div>	<div>ON ECE</div> <div><input type="checkbox"/> <input type="checkbox"/> <input type="checkbox"/> <input type="checkbox"/></div> <div>1 2 3 4</div>
Channel 9	Channel 10	Channel 11	Channel 12	Channel 13	Channel 14	Channel 15	Channel 16



The mini-sync provides 16 channels to prevent any radio or flash interference.

Ensure the channel on both devices is identical. See above chart.

**\*\*The mini-sync is backward compatible with FlashWave-III, FlashWave-4 and FW-2 Radio Slave System.**

# Using as a wireless shutter release

The Mini-Sync can be used as a wireless shutter release.

1. Connect the receiver to the camera using an appropriate camera release cable.  
(Camera release cable list : see page 16-17)
2. Synchronize the channel selection on the transmitter and receiver.
3. Press the test button on the transmitter halfway to autofocus and push it strongly to shoot.



## Using wireless Bulb mode

Set your camera to Bulb mode. Connect the receiver to your camera using a camera shutter release cable. Press and hold the test button on the transmitter for 3 seconds to open the camera's shutter. The LED light on the transmitter turns off. Now the receiver is in bulb mode. Release the button when the desired exposure time has elapsed.



# Correct set up example for wireless shutter release

- To trigger a camera and flash at the same time, set ① and ② to channel no.1. Then set the ③ and ④ to channel no.2.

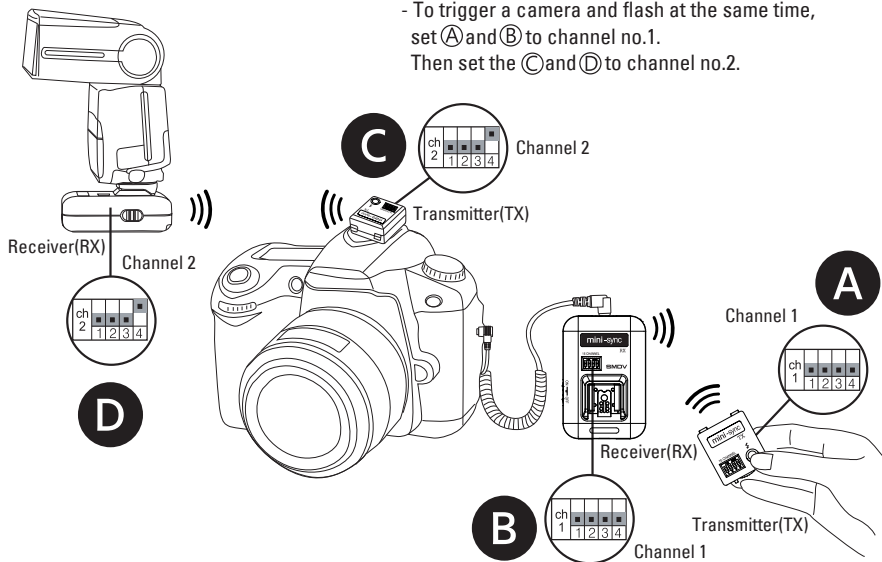

## Correct set up example for wireless shutter release



- A single transmitter can trigger many remote cameras at the same time. Make sure that the transmitter and the receivers are set to the same channel.

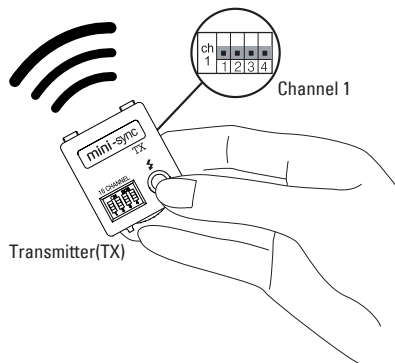

## Incorrect set up example for wireless shutter release

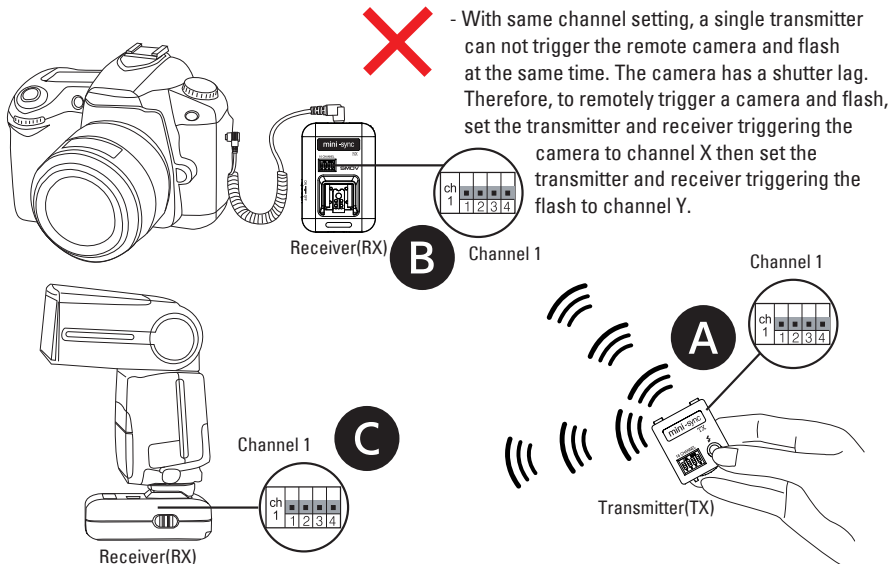

## Incorrect set up example for wireless shutter release

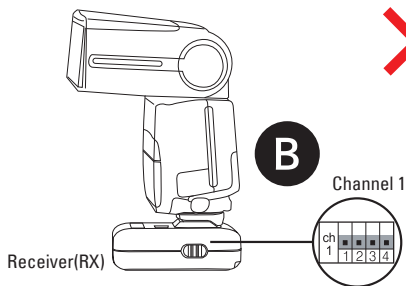

- With same channel setting, a single transmitter can not trigger the remote camera and flash at the same time. The camera has a shutter lag. Therefore, to remotely trigger a camera and flash, set the transmitter and receiver triggering the flash to channel X then set the transmitter and receiver triggering the camera to channel Y.

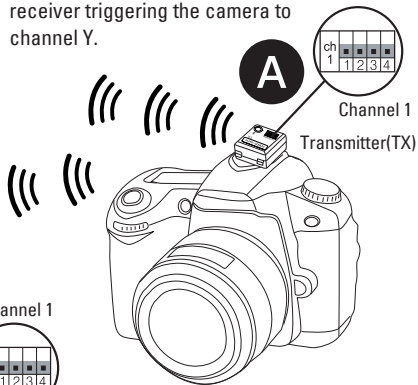
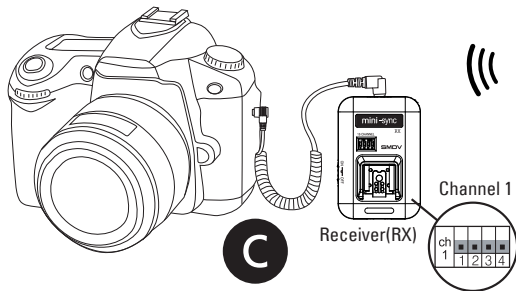

## Cables for camera release function **(Sold separately)**

To use your mini-sync system as a shutter release, you'll need an additional camera release cable compatible with your camera. Following release cables are available as separate accessories.

<b>RC-611</b>	<b>Canon</b> 1D, 1DMark II, 1DMark III, 1DMark IV, 1Ds, 1DsMark II, 1DsMark III, 1Dx, 1DxMark II, 5D, 5DMark II, 5DMark III, 5DMark IV, 5Ds, 5DsR, 6D, 6D Mark II, 7D, 7DMark II, 50D, 40D, 30D, 20D, 10D, D60, D30 Film Camera Canon EOS3, EOS1 VHS, EOS1 V
<b>RC-605</b>	<b>Canon</b> 1300D, 1100D, 1000D, 800D, 760D, 750D, 700D, 650D, 600D, 550D, 500D, 450D, 400D, 350D, 300D, 200D, 100D, 80D, 77D, 70D, 60D, EOS 30, 50, 500N, Kiss, 300, 88, 66, 55, M3, M5, M6 Power shot G1X, G3X, G5X, G10, G11, G12, G15, SX50HS, EOS Hi <b>Pentax</b> *ist D, S, DL, DL2, K10D, K20D, K100D, K110D, K200D, K3, K5, K7, 645D <b>Samsung</b> GX-1S, GX-1L, GX-10, GX-20, NX10, NX11, NX100 <b>Sigma</b> SD15, SD14, SD10, SD9 <b>Contax</b> N, N1, NX, N645, N Digital <b>Fuji</b> X-E1, X-E2
<b>RC-603</b>	<b>Nikon</b> D850, D810, D800, D700, D500, D300, D300s, D200, D100(battery grip is required), D5, D4, D4S, D3, D3S, D3X, D2, D2X, D2Xs, D2Hs, D2H, D1H, D1, F6, F5, F100, F90X, F90 <b>Fuji</b> GX645, S5Pro, S3Pro <b>Kodak</b> DCS Pro, SLR/N, DCS-14N
<b>RC-608</b>	<b>Nikon</b> D90, D750, D600, D610, D3100, D3200, D3300, D3400, D5000, D5100, D5200, D5300, D5500, D5600, D7000, D7100, D7200, D7500, COOLPIX A, COOLPIX P7700, Df
<b>RC-604</b>	<b>Nikon</b> D70s, D80



## Cables for camera release function (Sold separately)

<b>RC-602</b>	<b>Olympus</b> OM-D E-M1, E-M5, E-M10, E-PM1, PEN E-P1, E-P2, E-PL2, E-P3, E-PL3, E-P5, E-PL5, E-PL6, E620, E520, E510, E-450, E420, E30, E410, E400, SP-820UZ, SP-810UZ, SP-720UZ, SP-620UZ, SP-590UZ, SP-570UZ, SP-565UZ, SP-560UZ, SP-550UZ, SP-510UZ, PEN-F
<b>RC-607</b>	<b>Sony</b> a900, a850, a700, a580, a560, a550, a500, a450, a350, a300, a200, a100, a99, a99 II, a77, a65, a57, a55, a35, a33, a5 <b>Minolta</b> Maxxum 7D, 5D, 9, 7, 4, 3, 807si, 800si, 700si, 600si, 505si, 500si, 9000, 7000, 5000, sweets/Dynax 7D, 5D, 9, 7, 4, 3, sweet s, sweet/DiIMAGE 7Hi, 7, 5, 7i, A1, A2
<b>RC-613</b>	<b>Sony</b> a7s, a7r, a7, a7 II, a58, a6300, a6000, a5100, a5000, a3000, NEX-3NL, RX100Mark IV, RX100Mark III, RX100Mark II, RX10, RX10Mark II, RX10Mark III, HX60V, HX300, HX400V
<b>RC-609</b>	<b>Samsung</b> NX MINI, NX30, Galaxy NX, NX1000, NX20, NX210, EX2F, NX300, NX2000, NX1

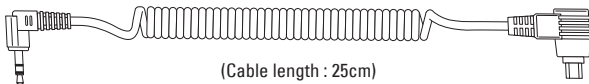

(Cable length : 25cm)

Note : The right camera jack is different for each camera cable.

# Troubleshooting

## **Receiver is on but ON/Off LED does not blink.**

- Insert fresh batteries in a right battery polarity.

## **Status LED on the receiver does not respond when transmitter test button is pressed.**

- Make sure that both the transmitter and receiver are on the same channel.

## **Flash does not work, even though receiver is responding to signals from the transmitter.**

- Check the flash unit is functional when removed from the receiver.
- Check all connections.
- Try interchanging between hot shoe and sync cable.

## **Status LED on the receiver blinks continuously even though test button is not pressed.**

- Disconnect the unit from camera or flash and reconnect them.
- Check that the transmitter and receiver are on the same channel.

## **Receiver does not perform the bulb shooting even though the receiver is powered on.**

- Insert fresh batteries on the receiver in a right battery polarity.

## **Working extended range**

- Sync speed and working distance are affected by radio interference and obstructions.  
Avoid having a large hill, concrete, metal or water obstructions between the transmitter and receiver.  
Move the transmitter and receiver at least one meter away from the ground.  
Often moving the transmitter and receiver a few meters will improve the situation.

# FCC Compliance

FCC RF Radiation Exposure Statement: This equipment complies with FCC RF Radiation exposure limits set forth for an uncontrolled environment.

This device and its antenna must not be co-located or operating in conjunction with any other antenna or transmitter.

This device complies with part 15 of the FCC Rules. Operation is subject to the following two conditions:

1. This device may not cause harmful interference.
2. This device must accept any interference received, including interference that may cause undesired operation.

Any changes or modifications(including the antennas) made to this device that are not expressly approved by the manufacturer may void the user's authority to operate the equipment.

**FC** ID WU2SMRSMINISYNC

## Warranty

SMDV provides limited warranty to the original purchaser on this product from an authorized dealer. SMDV will, at its option, repair or replace any eligible product that become defective within the warranty period.

Damage or failure which results from misuses, neglect, accident, alteration, abuse, improper installation or maintenance are excluded. Defective units should be returned to us with a detailed note describing the defects.

## CE Statements

**CE 0678** This device has been tested and found to comply with the requirements set up in the council directive on the approximation of the law of member states relating to R&TTE Directive 1999/5/EC.

#1532, Nakdongdae-ro, Sasang-gu, Busan, Korea  
Tel. +82 (0)51 324 0788 / Fax. +82 (0)51 301 0788  
Website. [www.smdv.co.kr](http://www.smdv.co.kr) / E-mail. [smdv\\_info@naver.com](mailto:smdv_info@naver.com)

**SMDV**