

7. Open the heater roller.

- Press the heater roller open/close lever to the [OPEN].
- Then the hook is unlocked and you can open the heater roller.



CAUTION

Be careful not to touch the surface of heater roller because it is very hot.

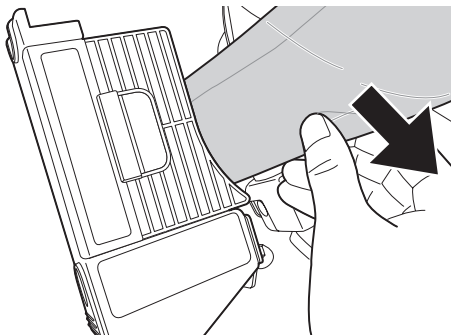

- Remove the remaining packing paper in the heater roller.

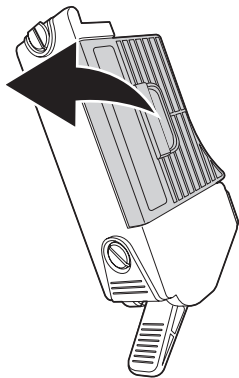

8. Open the heater roller cover

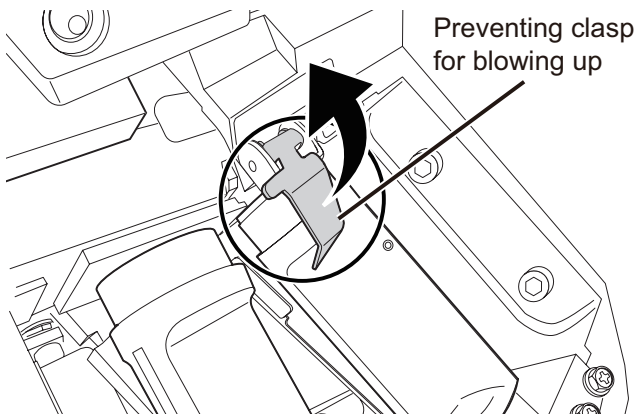

9. Pull up the preventing clasp for blowing up.



WARNING

Do not touch the heater roller and its surrounding part during heating or right after turning off the power because they are high temperature. Otherwise, it may cause a burn injury.

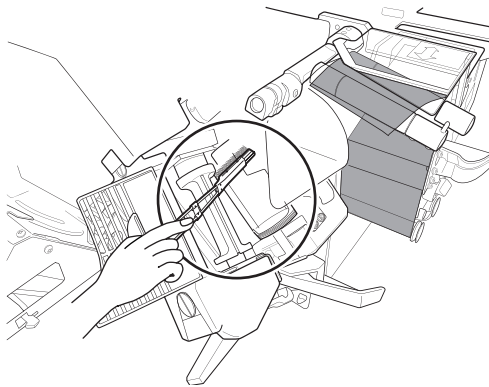

10. Clean the heater roller.

- Remove dirt from the heater roller using the heater roller cleaning brush (provided).

CAUTION

Be careful not to touch the surface of heater roller because it is very hot.

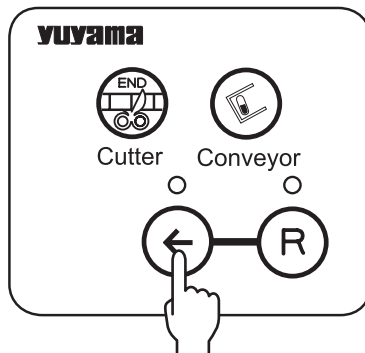

- Clean it while rotating it by pressing the [Heater Roller RW] switch.

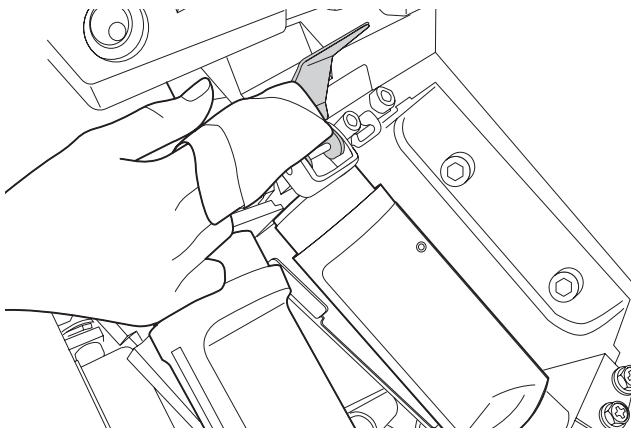

11. Clean the preventing clasp for blowing up.

- Clean the preventing clasp for blowing up with an alcohol-moistened and soft cloth.

WARNING

Do not touch the heater roller and its surrounding part during heating or right after turning off the power because they are high temperature. Otherwise, it may cause a burn injury.

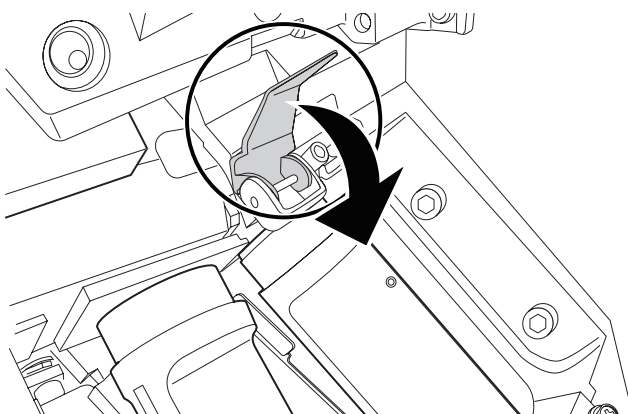

12. Return the preventing clasp for blowing up the original position.

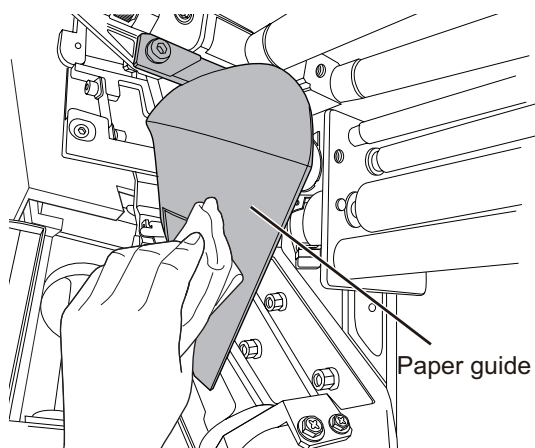

13. Clean the paper guide.

- Wipe the paper guide with a soft water-moistened cloth.
- After cleaning, wipe the paper guide again with a dry soft cloth.

WARNING

Do not touch the heater roller and its surrounding part during heating or right after turning off the power because they are high temperature. Otherwise, it may cause a burn injury.

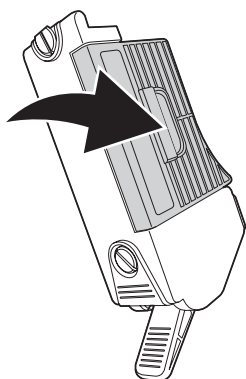

14. Close the heater roller cover.

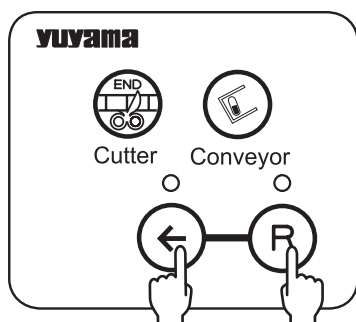

- After cleaning, press the [Heater roller RW] switch and [Heater roller FW] switch together.
- Then move the heater roller to the paper feed position.

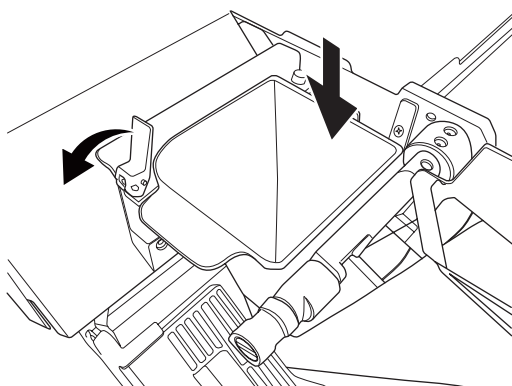

15. Attach the last hopper.

- After attaching the last hopper, tilt the fixing lever.

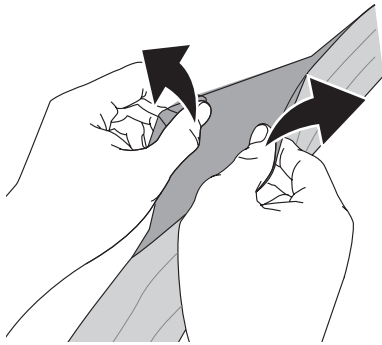

16. Pass the packing paper through the heater roller.

- Open the packing machine.

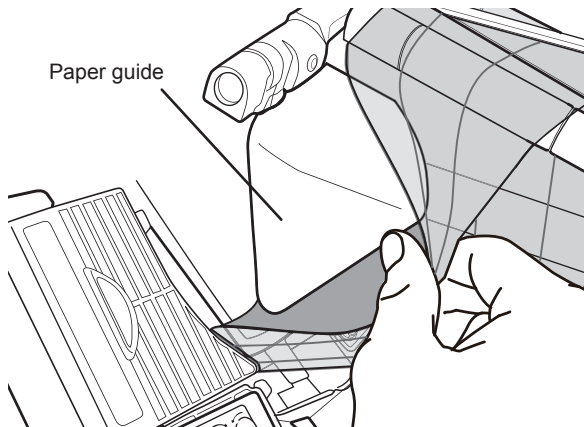

- Open the packing paper to wrap the paper guide, then pass the packing paper.

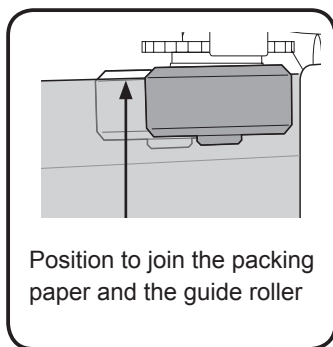

- Pass the packing paper through the heater roller.

CAUTION

Be careful not to touch the surface of heater roller because it is very hot.

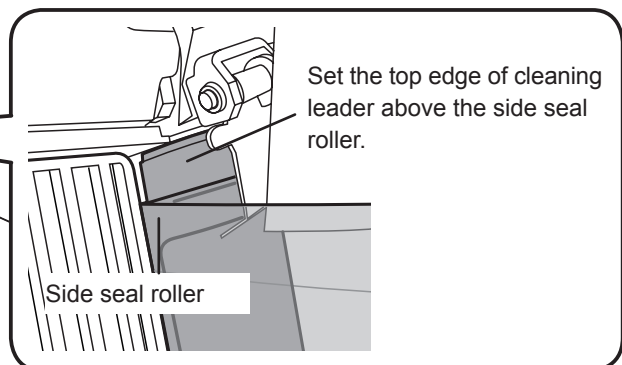
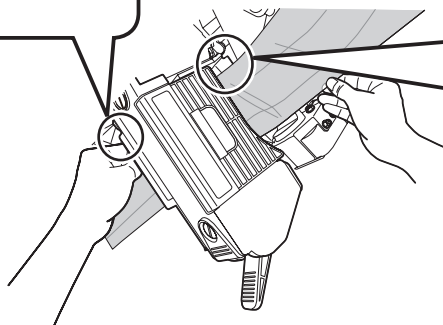

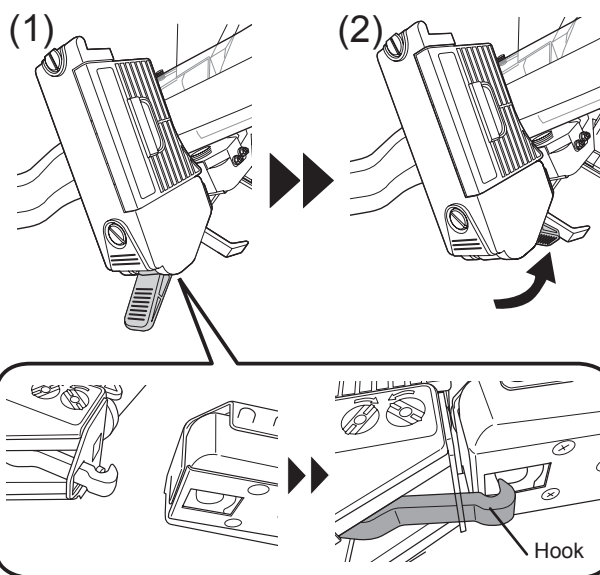

9. Close the heater roller.

- (1) Hold the lever and set the hook.
- (2) Close the lever.

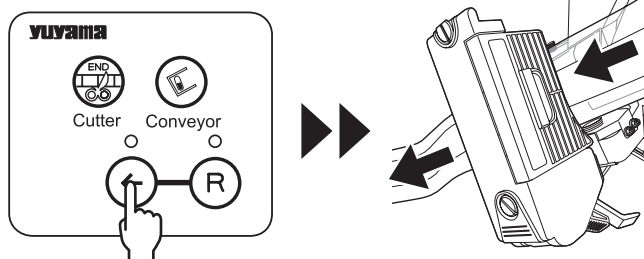

18. Feed the packing paper.

- Press the [Heater roller RW] switch to feed the packing paper.

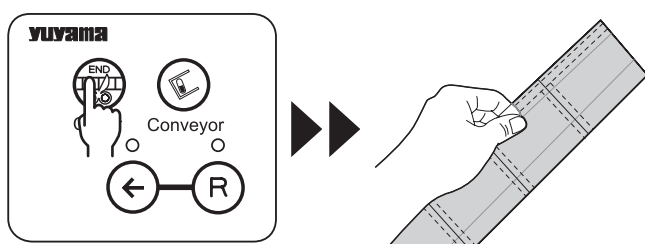

19. Cut the packing paper.

- Check that the packing paper is sealed correctly, and press the [Cutter] switch to cut the packing paper.
- Then, remove the cut packing paper.

CAUTION

Be careful not to feed the cut packing paper to the conveyor because the conveyor will work when you press the [Cutter] switch.

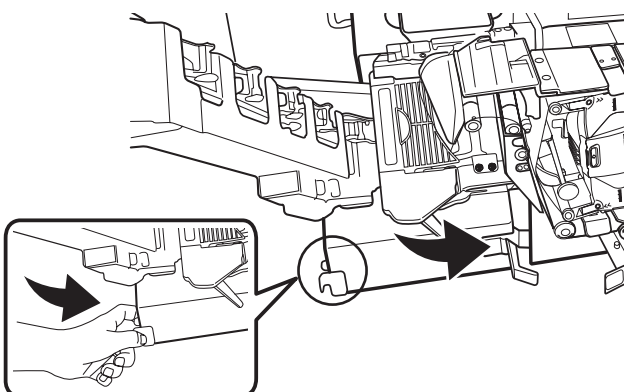

20. Close the conveyor.

- Hold the conveyor's handle like the left image, and push the conveyor.
- Push the conveyor until you hear a clicking noise.

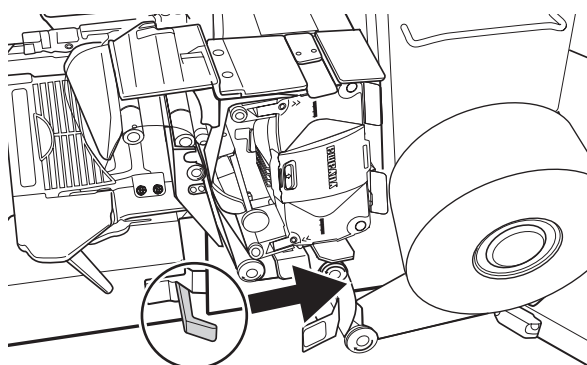

21. Return the packing unit to the original position.

- Push the packing unit while holding its open/close lever.
- Push the packing unit until you hear a clicking noise.

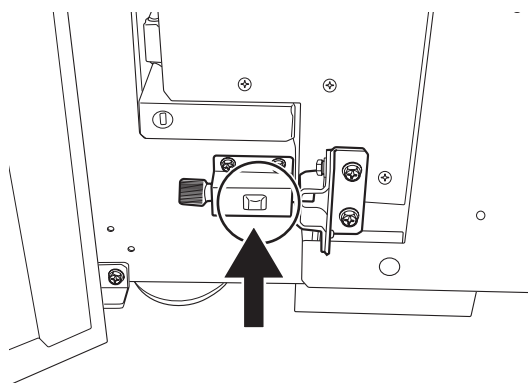

22. Return the packing base to the original position.

- Unlock the packing base.

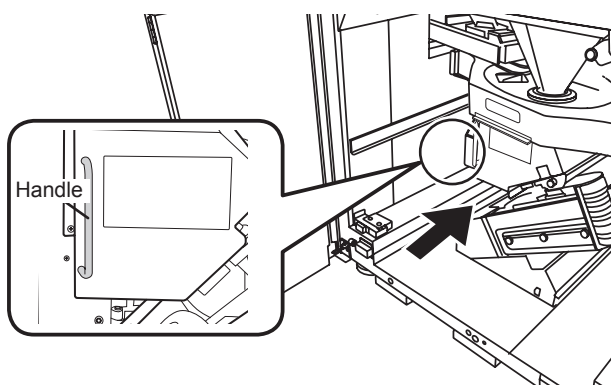

- Push the packing base while holding its handle.
- Push the packing base until you hear a clicking noise.
- You will hear a blip to return the packing base to the original position when the packing machine is on.

Troubleshooting

Symptom	Cause	Measure to be taken
The machine does not operate.	The power cord is disconnected.	Insert the power cord plug all the way. (P15)
	The breaker is [OFF].	Turn [ON] the breaker. (P16)
	The heater roller is not heated yet.	Wait until the rapid heating is completed. (P16)
The edge of the paper is displaced.	A laminate is attached to the heater roller.	Remove the laminate. (P101)
	The packing paper is not attached properly.	Reattach the paper. (P55)
The error cannot be released even after packing paper has been refilled.	The packing paper is not passed through the paper out sensors.	Pass the packing paper through the paper out sensors. (P59)
The print is so light even after the ink ribbon has been replaced with a new one.	The printer head is dirty.	Clean the printer head. (P97)

Warning errors

If you misuse the machine or any failure occurs in the packing machine, warning (error) numbers and messages are displayed on the touch panel. After stopping the sound alarm, take measures for the warnings and errors. If you cannot release errors even after you have taken measures, contact with your nearest Yuyama's sales office.

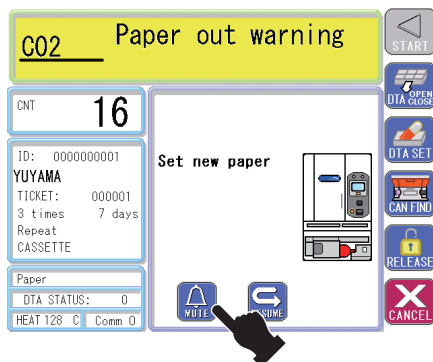

1. Touch [MUTE].

- The sound alarm stops.
- Take measures for the warning (or the error). Read the next page for how to take measures for each warning (error).

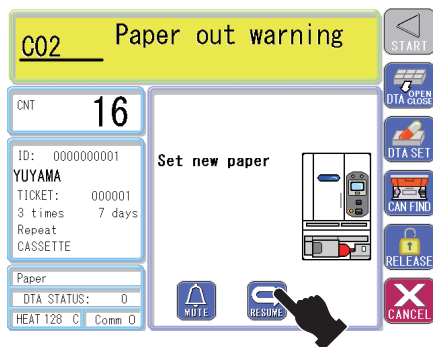

2. Touch [RESUME].

- The packing machine restarts.
- If the packing machine does not restart, check the measures to be taken again.

■ List of Warnings

Display number	Description	Cause	Measure to be taken
C00	Paper jam warning	The paper is jammed in the heater roller.	Remove the jammed paper and then touch [RESUME].
C02	Paper out warning	The paper is out.	Replace the paper with new one and then touch [RESUME]. (P55)
C03	Remaining paper warning	The remaining paper is insufficient.	Replace the paper with new one.
C04	LPU out position warning	The packing unit is open.	Insert the paper all the way and then touch [RESUME]. (P59)
C05	DTA UT position warning	The DTA unit is open.	Insert the DTA unit all the way and touch [RESUME]. (P83)
C06	Ink ribbon empty warning	The ink ribbon is out.	Replace the ink ribbon with a new one. (P66)
C08	Cassette empty warning	There is no tablet in the cassette.	Refill tablets in the cassette. (P26)
C09	Cassette position warning	The cassette has not been inserted properly.	Reinsert the cassette and then touch [RESUME]. (P23)
C10	Cassette ID warning	The numbers of the attached cassettes are duplicated.	Insert the cassette into the correct position (with a flashing lamp) and then touch [RESUME].
C11	Cassette set warning	The cassette has been attached to a wrong position.	
C15	Printer ready warning	The paper and the ink ribbon are not set properly.	Set the paper or the ink ribbon at the correct position and then touch [RESUME]. (P55, 66)
C16	No DTA tray warning	The DTA tray is not set at the correct position.	Close the DTA tray and then touch [RESUME]. (P33)
C17	Revolver UT out of pos warning	The revolver is not set at the correct position.	Insert the revolver unit all the way and then touch [RESUME]. (P89)
C19	Tablet missing warning	The machine does not detect a tablet in 12 seconds after the motor base starts rotating when the machine packs half tablets.	1. Set the removing powder unit at the correct position and then touch [RESUME]. 2. Clean the tablet route and then touch [RESUME]. 3. Refill the missing tablet and then touch [RESUME].

■ List of Warnings (continued)

Display number	Description	Cause	Measure to be taken
C20	Dirty tablet route warning	The machine detects the tablet except when you remove and insert the cassette and the machine dispenses the tablets.	Clean the tablet route of the motor base.
C21	Cassette jam warning	Tablets are jammed in the cassette.	Remove jammed tablets in the cassette and then touch [RESUME].
C22	Lower door open warning	The lower door is open.	Close the lower door and then touch [RESUME]. (P64)
C23	Conveyor jam warning	There is a jam in the conveyor.	Remove the jam and then touch [RESUME].
C24	PC version warning	The communication version of the packing machine does not match that of the personal computer.	Contact with your dealer.
C25	Internal version warning	The communication version of the packing machine is not correct.	
C26	Printer head low temp warning	Printing is disabled because the printer head temperature is too low.	Wait until the printer head reaches the suitable temperature.
C28	Slide UT out of position warning	The slide unit is not set at the correct position.	Set the slide unit at the correct position and then touch [RESUME].
C29	Outer carousel limit warning	The outer cylinder is not set at the correct position.	Turn the outer cylinder until the error message is released. (P54)
C30	Inner carousel limit warning	The inner cylinder is not set at the correct position.	Turn the inner cylinder until the error message is released. (P54)
C32	Large hopper out of position warning	The large hopper is not attached to the correct position.	Reattach the large hopper to the correct position and then touch [RESUME]. (P87)
C33	Slide hopper out of position warning	The slide hopper is not set at the correct position.	Set the slide hopper at the correct position and then touch [RESUME].
C34	Duplicate cassette warning	The cassette number is not set properly.	Set the cassette number correctly and then touch [RESUME].
C47	Removing powder UT out of position warning	The removing powder unit is not set at the correct position.	Set the removing powder unit at the correct position and then touch [RESUME].

■ List of Warnings (continued)

Display number	Description	Cause	Measure to be taken
C48	Dirty tablet route warning	The machine detects the tablet except when you remove and insert the cassette and the machine dispenses the tablets.	Clean the tablet route of the motor base.
C50	Tray connection warning	The DTA tray is not set at the correct position.	Set the DTA tray at the correct position and then touch [RESUME].
C51	Ribbon insertion warning	The ink ribbon is not set at the correct position.	Set the ink ribbon at the correct position and then touch [RESUME]. (P75)
C52 C65	Ribbon out of position warning	The correct ribbon is not set on the machine.	
C53	Ribbon type warning		
C54	Paper type warning	The correct paper is not set on the machine.	Set the correct paper and then touch [RESUME]. (P55)
C14 C55 C56	Paper core set warning	The paper is not set to the paper core properly.	Insert the paper all the way and then touch [RESUME]. (P68)
C07 C54-64	Ribbon winding warning	The ink ribbon is not winded properly.	Set the ink ribbon at the correct position and then touch [RESUME]. (P58)

■ List of Errors

Display number	Description	Part where the error occurred	Measure to be taken
E00	Roller home error	Heater roller	Remove the jammed paper and drug from the heater roller and then touch [RESUME].
E04	Heater temp error	Heater roller	Turn off the breaker of the packing machine. After a while, turn off the breaker. *
E05	Printer head high temp error	Printer head	
E06	Cutter home error	Cutter	Remove the jammed paper and drug from the heater roller and then touch [RESUME].
E11	Roller alarm error	Heater roller	Touch [RESUME]. (If the error cannot be released, turn off and on the breaker.) *
E15	Printer board error	Inside the packing machine	
E16	Printer head open position error	Printer head	
E17	Printer head close position error	Printer head	
E20	Revolver close position error	Revolver unit	
E21	Revolve middle position error		
E30	Slide upper pusher error	Slide unit (YS-TR-406FDSII)	
E31	Slide lower pusher error		
E32	Slide valve error		
E50	Encoder error	Heater roller	

■ List of Errors (Continued)

Display number	Description	Part where the error occurred	Measure to be taken
E61	Outer carousel feed error	Cylinder	Touch [RESUME]. (If the error cannot be released, turn off and on the breaker.) *
E62	Outer carousel time out error		
E63	Inner carousel feed error		
E64	Inner carousel time out error		
E69	LED lighting error	DTA tray	Touch [RESUME] and release the error. After the error is released, the LED will light up. Please contact with your nearest Yuyama's sales office.
E70	V-holder error	V-holder	Touch [RESUME]. (If the error cannot be released, turn off and on the breaker.) *
E71	V-holder error		
E72	DTA open position error	DTA unit	
E73	DTA close position error		
E74	DTA tray retry error		
E75	DTA cells feed error	DTA cells	Reattach the DTA cells table to the correct position and then touch [RESUME].
E76	DTA R limit error		Touch [RESUME]. (If the error cannot be released, turn off and on the breaker.) *
E77	Slide plate open position error	DTA slide plate (Under the DTA cells)	Reattach the DTA cells table to the correct position and then touch [RESUME].
E78	Slide plate close position error		

■ List of Errors (Continued)

Display number	Description	Part where the error occurred	Measure to be taken
E80	DTA signal error	Inside the packing machine	Touch [RESUME]. (If the error cannot be released, turn off and on the breaker.) *
E81	V-holder signal error		
E82	Slide signal error		
E83	Cassette signal error		
E91	EEPROM writing error		
E92	Cassette UT comm. error		
E93	Internal parity error		
E95	Fill duplicate error	Inside the packing machine or personal computer	Turn off the breaker of the packing machine. After a while, turn off the breaker. *
E96	Internal comm. error	Inside the packing machine	
E98	Fil ID error		
E99	EEPROM error		
F01-99	Internal error		

* If you cannot release errors, contact with your nearest Yuyama's sales office.

Specification

Name	Full automatic tablet packing machine “PROUD”	
Model	YS-TR-260FDSII YS-TR-330FDSII YS-TR-406FDSII YS-TR-520FDSII YS-TR-590FDSII	
Dispensing size	Width: 60, 70, 76, 80 or 90 x Height: 70mm (double-folded paper)	
Packing paper (type)	Cello-polly	
Packing speed	Up to 60 pouches/minute	
Tablet detection method	Photo sensor system	
Tablet supply method	Free fall	
Ink ribbon	Normal type (black or color), half type (black)	
Pouch print	New thermal printer: black/4 colors (cassette type)	
Journal printer	Thermal: Single color (black, reverse)	
Loss bag	Advance loss: 5 bags (0 bag regardless of the cut setting in the continuous prescription mode) Subsequent loss: 0 to 4 bags (The setting can be changed in the personal computer.)	
Input device	Personal computer	
Cassette size and total number	YS-TR-260FDSII	L: 36 LM: 224
	YS-TR-330FDSII	L: 36 M: 64 S: 90 SS: 140
	YS-TR-406FDSII	L: 42 LM: 70 M: 64 S: 90 SS: 140
	YS-TR-520FDSII	L: 72 LM: 448
	YS-TR-590FDSII	L: 72 LM: 224 M: 64 S: 90 SS: 140
Cassette identification	RFID system	
Detachable tablet adapter (DTA)	63 pouches/time, max. 16 times (max. 999 pouches per a prescription, including drug pouches, inspection drugs and loss bags)	
Contamination level	2	
Use environment	Indoors	
Altitude	2000 m	
Body dimension	YS-TR-260FDSII YS-TR-330FDSII	Width: approx. 890 mm x Depth: approx. 930 mm x Height: approx. 1998 mm
	YS-TR-406FDSII	Width: approx. 1291 mm x Depth: approx. 930 mm x Height: approx. 1998 mm
	YS-TR-520FDSII YS-TR-590FDSII	Width: approx. 1780 mm x Depth: approx. 930 mm x Height: approx. 1998 mm



Body weight	YS-TR-260FDSII YS-TR-330FDSII	Approx. 580 kg
	YS-TR-406FDSII	Approx. 730 kg
	YS-TR-520FDSII YS-TR-590FDSII	Approx. 1140 kg
Power	YS-TR-260FDSII YS-TR-330FDSII YS-TR-406FDSII	AC100 V \pm 10 V 50/60 Hz
	YS-TR-520FDSII YS-TR-590FDSII	AC120 V \pm 10 V 50/60 Hz
Consumption power	YS-TR-260FDSII YS-TR-330FDSII	800 VA (MAX)
	YS-TR-406FDSII	1000 VA (MAX)
	YS-TR-520FDSII YS-TR-590FDSII	1400 VA (MAX)

* The packing paper and the ink ribbon vary depending on the factory specification. If you change them after you have purchased them, you need to adjust them before use. Contact with your dealer.



Yuyama U.S.A. Inc
IL Office
1513 Carmen Drive
Elk Grove Village, IL 60007

Yuyama U.S.A. Inc
CA Office
17835 Sky Park Circle, Bldg 14 Ste. A
Irvine, CA 92614

Yuyama U.S.A. Inc
FL Office
6308 Benjamin Road, Suite 704
Tampa, FL 33637

Yuyama U.S.A. Inc
TX Office
210 Belt Line Road, Suite 114
Farmers Branch, TX 75234

As of September 27, 2013
13IPROUDA