

6. Return the packing base to the original position.

- Unlock the packing base.

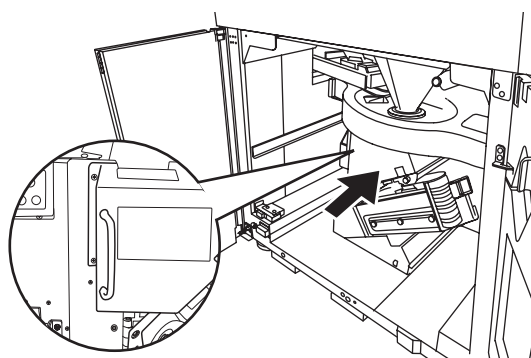

- Return the packing base to the original position while holding its handle.
- Keep inserting it until you hear a beep sound.

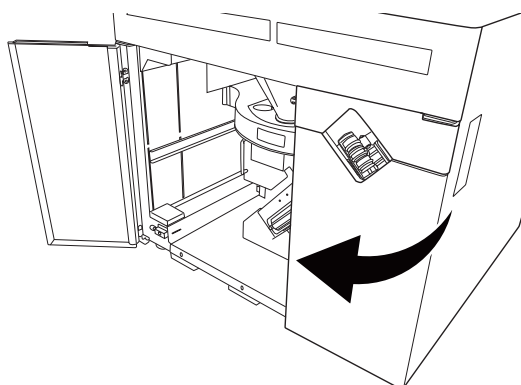

7. Close the lower door.

- Close the door on the conveyor side.

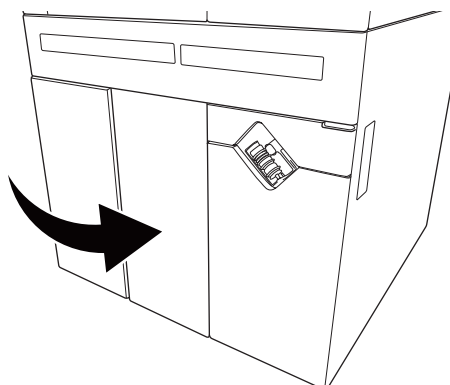

- Close the acrylic door.
- After closing it, push [PUSH] on the acrylic door.

Large hopper

After dispensing plain tablets, a small amount of powder may remain inside the packing machine. Maintain the packing machine periodically to ensure that such powder is not mixed with other drugs.

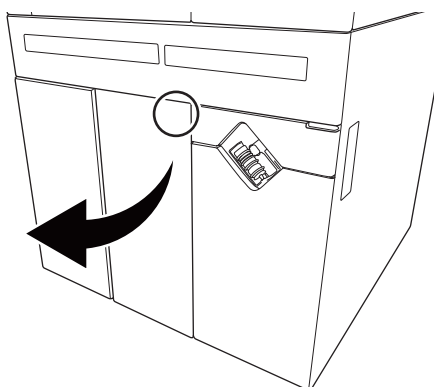

1. Open the lower door.

- Push [PUSH] on the acrylic door and then open it while folding it.

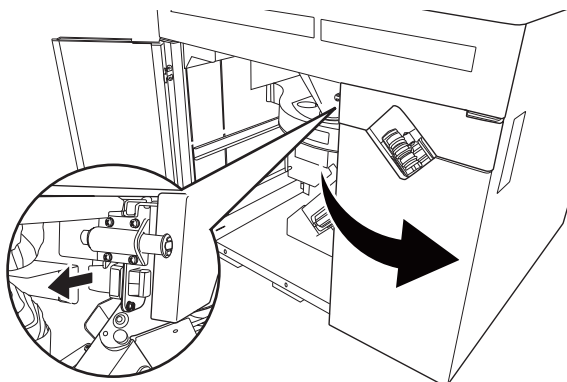

- Unhook to open the door on the conveyor door.

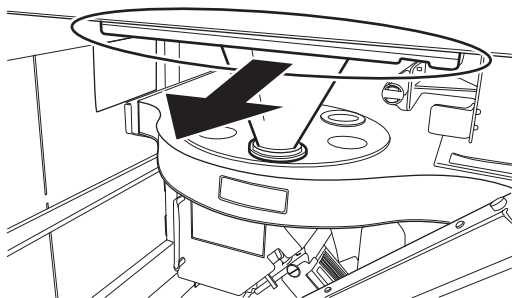

2. Pull the large hopper.

- Pull the large hopper while holding its frame.

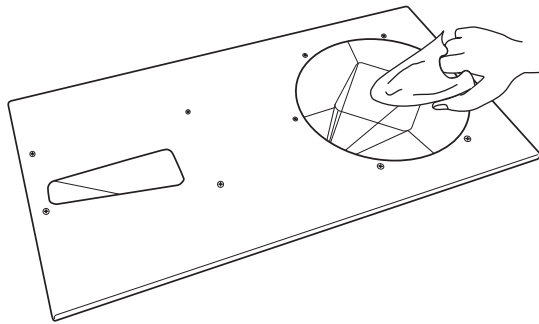

3. Clean the large hopper.

- Remove dirt from the surface by wiping it with a soft water-moistened cloth.
- After removing dirt, remove moisture from the surface by wiping it with a dry soft cloth.
- When you cannot remove dirt, wash it with water using a soft sponge. After washing it with water, let it dry naturally to remove moisture completely.

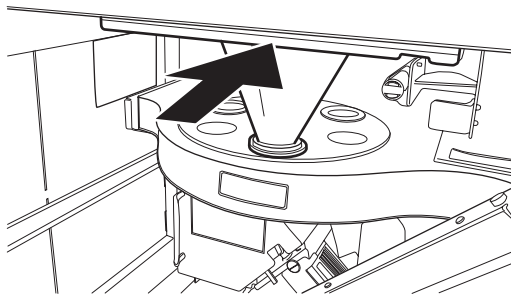

4. Attach the large hopper.

- Insert the large hopper all the way.

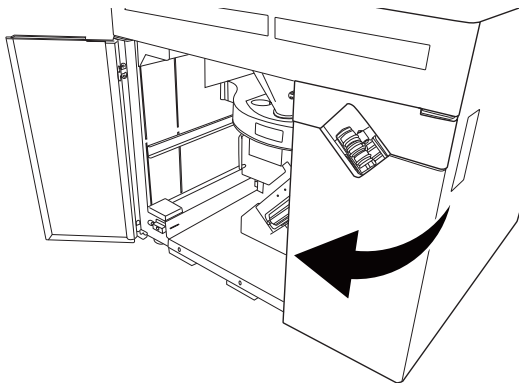

5. Close the lower door.

- Close the door on the conveyor side.

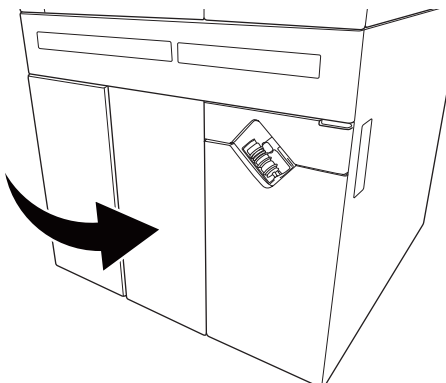

- Close the acrylic door.
- After closing it, push [PUSH] on the acrylic door.

Revolver unit

After dispensing plain tablets, a small amount of powder may remain inside the packing machine. Maintain the packing machine periodically to ensure that such powder is not mixed with other drugs.

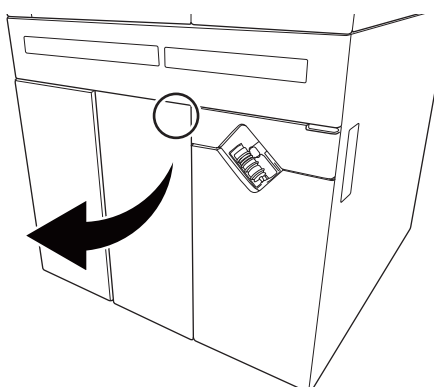

1. Open the lower door.

- Push [PUSH] on the acrylic door and then open it while folding it.

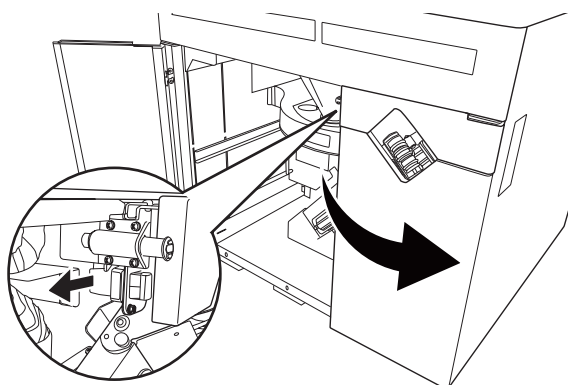

- Unhook to open the door on the conveyor door.

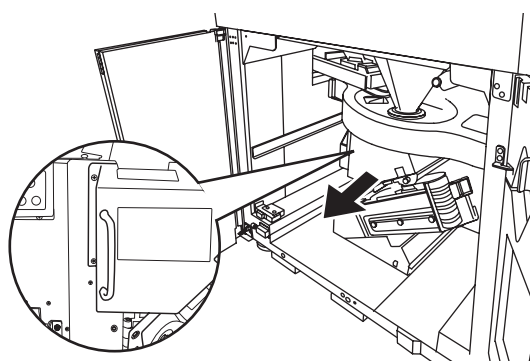

2. Pull the packing base.

- Pull the packing base while holding its handle.

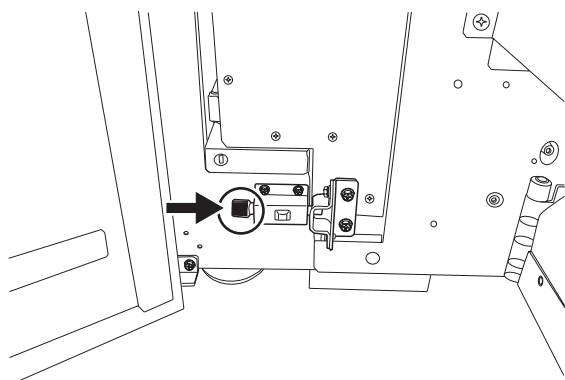

- Lock the packing base.

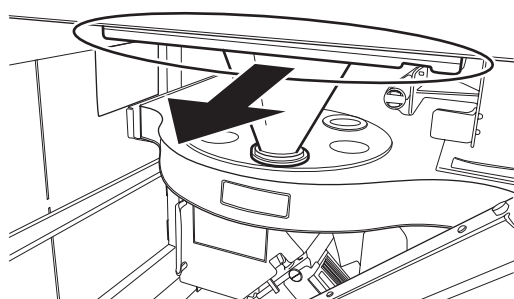

3. Pull the large hopper.

- Pull the large hopper while holding its frame.

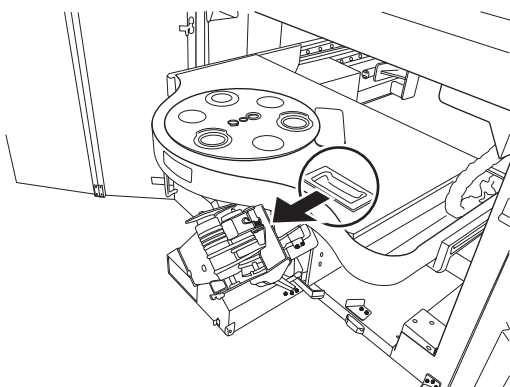

4. Pull the revolver unit.

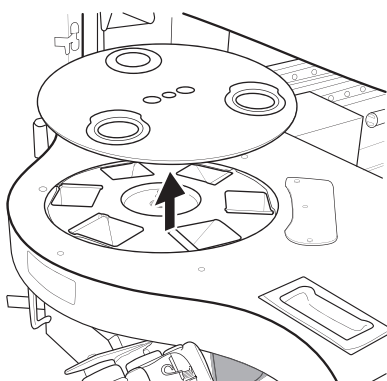

- Then remove the revolver case.

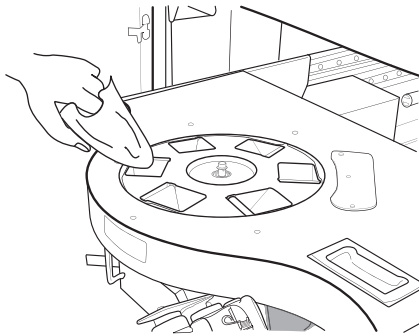

5. Clean the revolver unit and case.

- Remove dirt from the surface by wiping it with a soft water-moistened cloth. (6 points)
- After removing dirt, remove moisture from the surface by wiping it with a dry soft cloth.

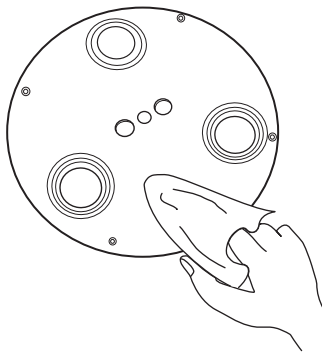

- Remove dirt from the surface by wiping it with a soft water-moistened cloth.
- After removing dirt, remove moisture from the surface by wiping it with a dry soft cloth.
- When you cannot remove dirt, wash it with water using a soft sponge. After washing it with water, let it dry naturally to remove moisture completely.

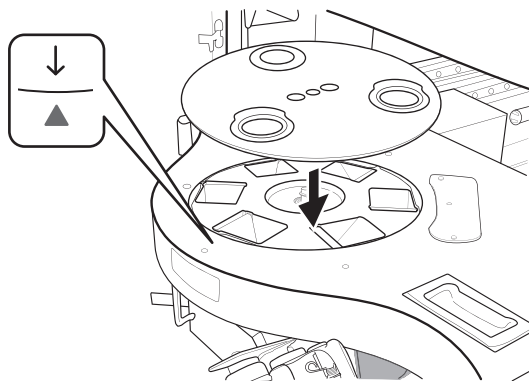

6. Attach the revolver unit.

- First, attach the revolver case.
- Attach the revolver unit so that the arrow of the revolver case matches with the mark of the revolver unit.

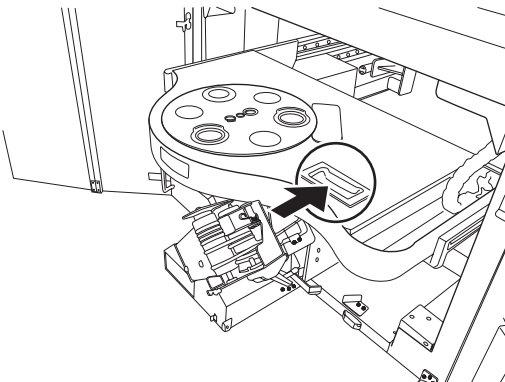

- After attaching the revolver case, keep pushing the revolver unit until you hear a click sound.

7. Attach the large hopper.

- Insert the large hopper all the way.

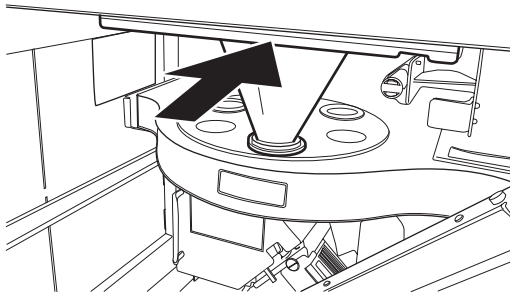

8. Return the packing base to the original position.

- Unlock the packing base.

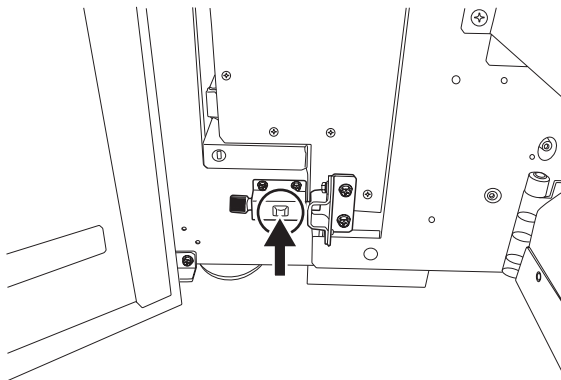

- Return the packing base to the original position while holding its handle.
- Keep inserting it until you hear a beep sound.

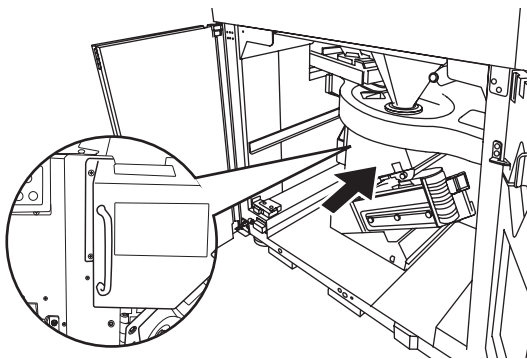

9. Close the lower door.

- Close the door on the conveyor side.

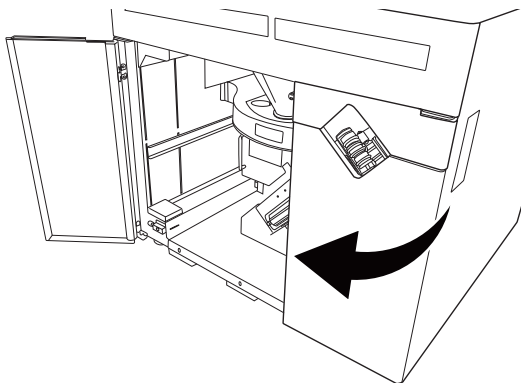

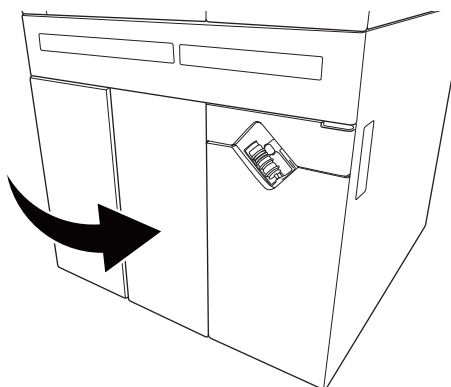

- Close the acrylic door.
- After closing it, push [PUSH] on the acrylic door.

Sash unit

After dispensing plain tablets, a small amount of powder may remain inside the packing machine. Maintain the packing machine periodically to ensure that such powder is not mixed with other drugs.

- When a password has been set, cancel the password.

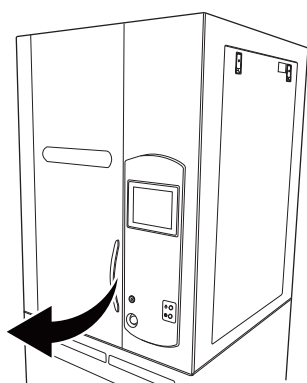

1. Open the upper door.

- Open the upper door while holding its handle.

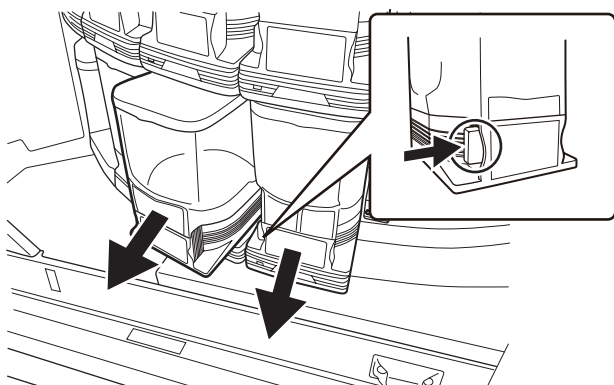

2. Remove the cassette.

- Remove the cassette while pressing the lock of the cassette until you hear a click sound.
- Remove two cassettes from the top and the bottom respectively.

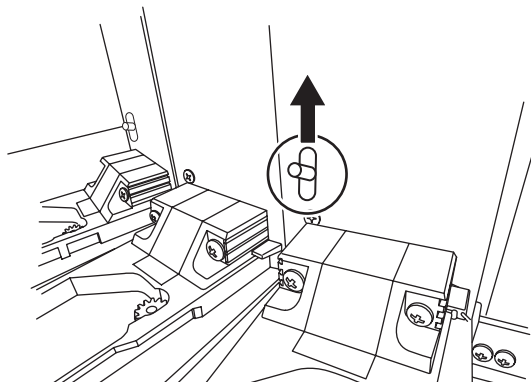

3. Lift the sash-fixing lever.

- Lift and hold the fixing lever.

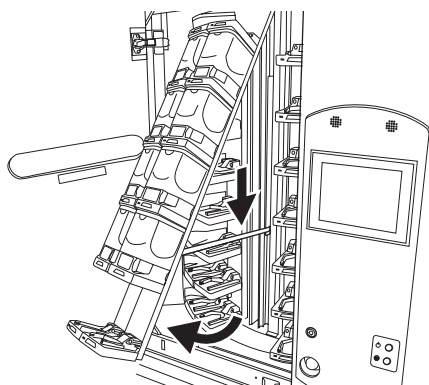

4. Open the sash.

- Lower the sash-fixing bar to fix the sash.

CAUTION

Do not open the sash swiftly. Failing to obey this instruction will lower the fixing bar suddenly, resulting in injury.

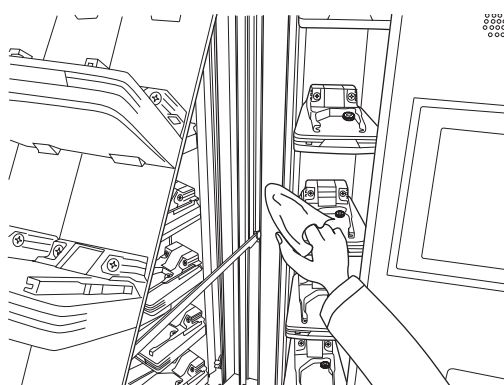

5. Clean the inside of the sash.

- Remove dirt from the surface by wiping it with a soft water-moistened cloth.
- After removing dirt, remove moisture from the surface by wiping it with a dry soft cloth.

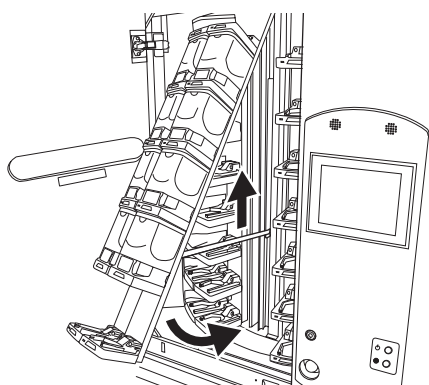

6. Lift the sash-fixing bar.

- After lifting the fixing bar, close the sash.

CAUTION

Be careful not to pinch your fingers.

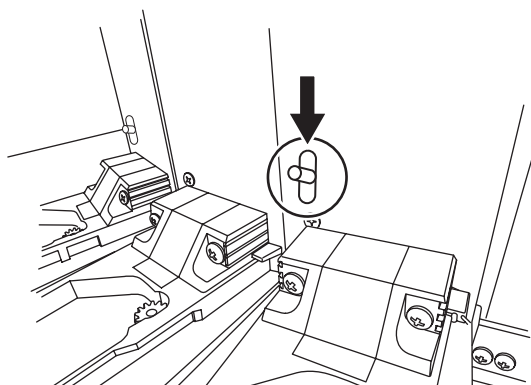

- Closing the sash will automatically lower the fixing lever. (Make sure that the sash is securely locked.)

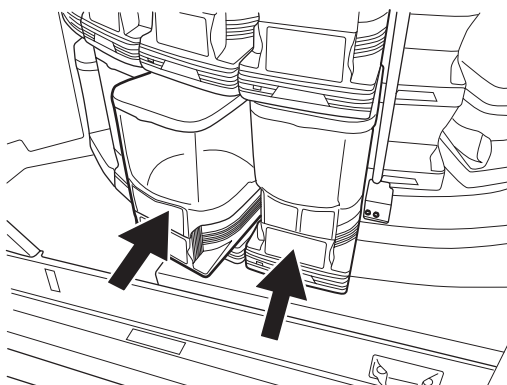

7. Attach the cassettes.

- Attach two cassettes to the top and the bottom respectively.
- Insert them all the way.

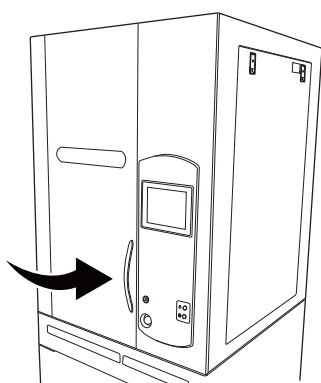

8. Close the upper door.

- Close the upper door while holding its handle.

Printer head

If the print is so light even after ink ribbon replacement, clean the printer head.

*Turn [OFF] the breaker of the packing machine in advance.

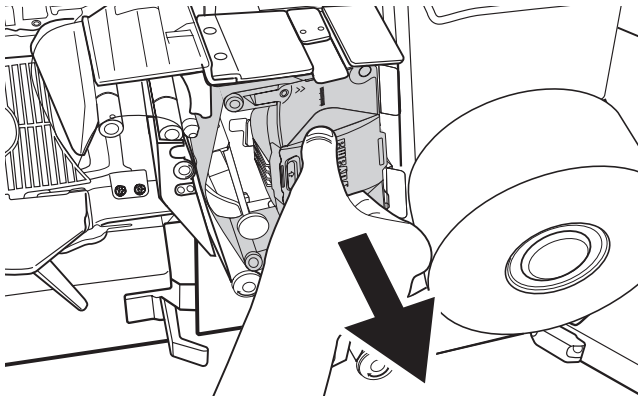

1. Remove the ink ribbon.

- Refer to page 64 for the removal of the ink ribbon.

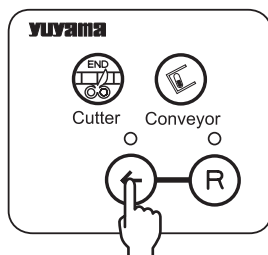

Tips

You cannot open the printer head to pull out the packing unit while the packing machine stops working temporarily. When you open the printer head, press the [Heater roller RW] switch and check whether the printer head is opened.

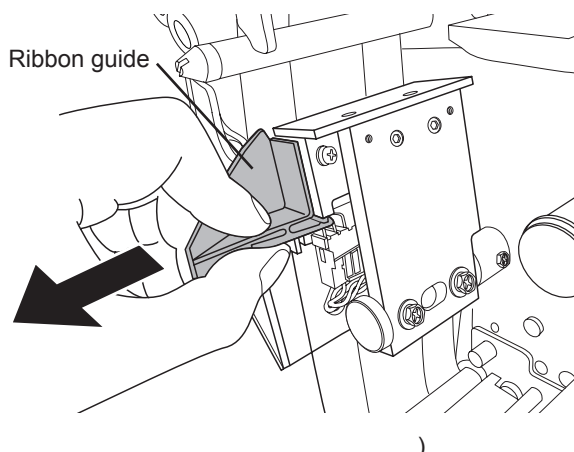
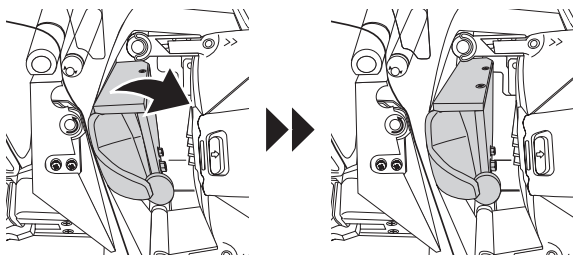

2. Remove the ribbon guide.

- Push the knob on the ribbon guide, and remove the tab.

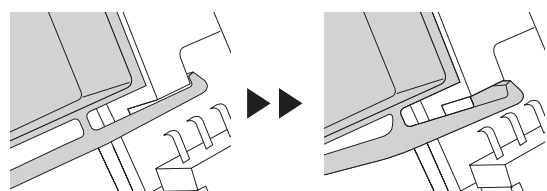

The tab is unattached.

3. Shutdown the system.

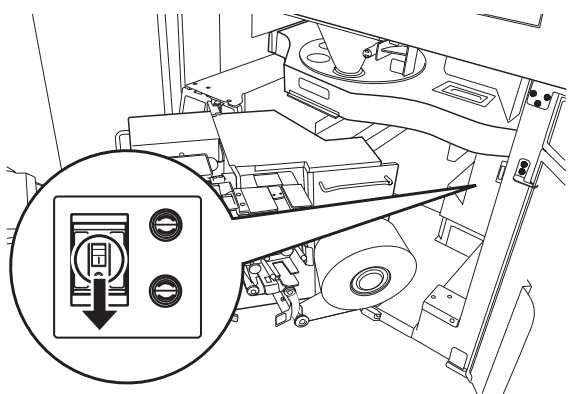

4. Turn [OFF] the breaker.

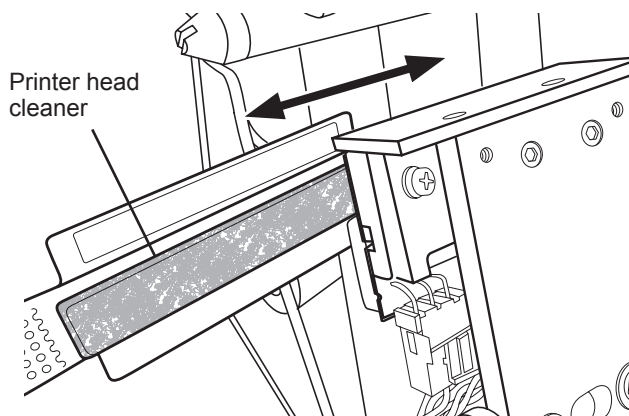

5. Clean the printer head.

- Wipe the surface of the printer head with an alcohol-moistened printer head cleaner (provided).

CAUTION

Make sure to turn off the packing machine's breaker when you use an alcohol.

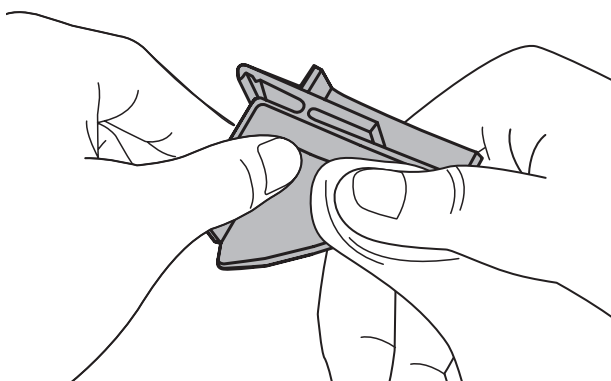

6. Clean the ribbon guide.

- Wipe the ribbon guide with a soft water-moistened cloth.

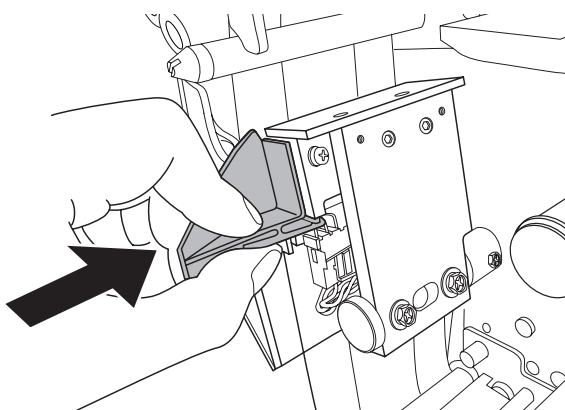

7. Attach the ribbon guide.

- Push the knob on the ribbon guide, and attach it straight to fit the insertion slot.

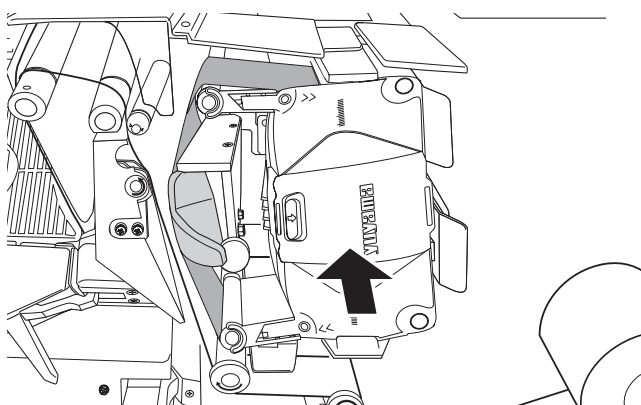

8. Attach the ink ribbon.

- Please refer to page 75 for installation of the ink ribbon.

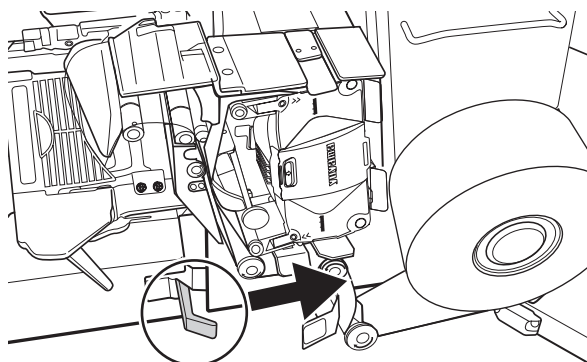

9. Return the packing unit to the original position.

- Push the packing unit while holding its open/close lever.
- Push the packing unit until you hear a clicking noise.

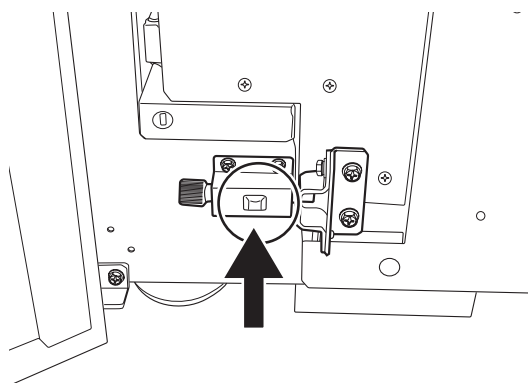

10. Return the packing base to the original position.

- Unlock the packing base.

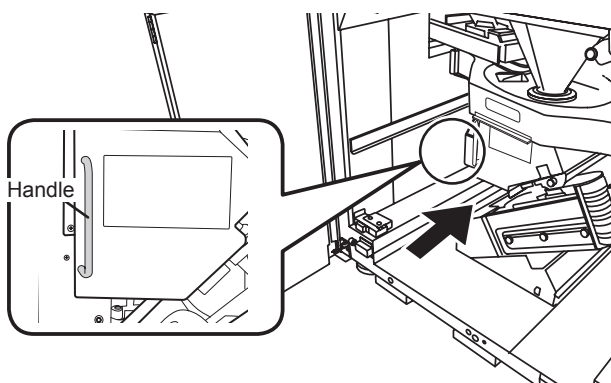

- Push the packing base while holding its handle.
- Push the packing base until you hear a clicking noise.

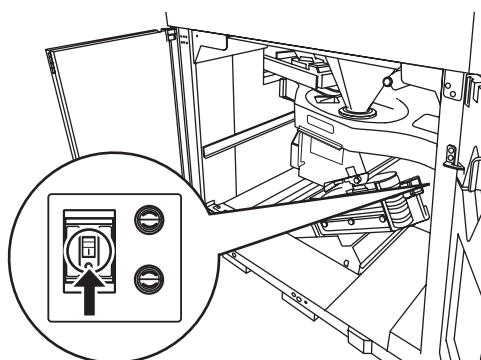

11. Turn [ON] the breaker.

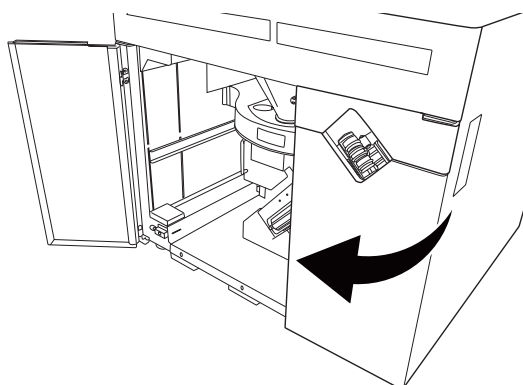

12. Close the lower door.

- Close the door on the conveyor side.

13. Start the system.

Heater roller

If the paper twists around the heater roller, its laminate may stick to the heater roller. If this happens, clean the heater roller to remove the attached laminate.

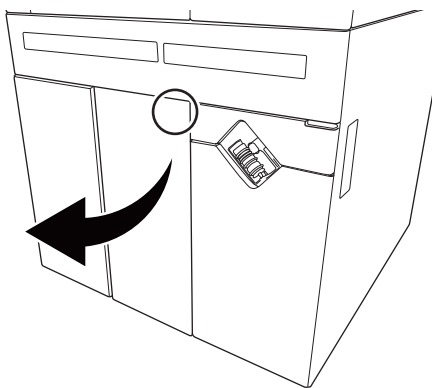

1. Open the lower door.

- Push [PUSH] on the acrylic door and then open it while folding it.

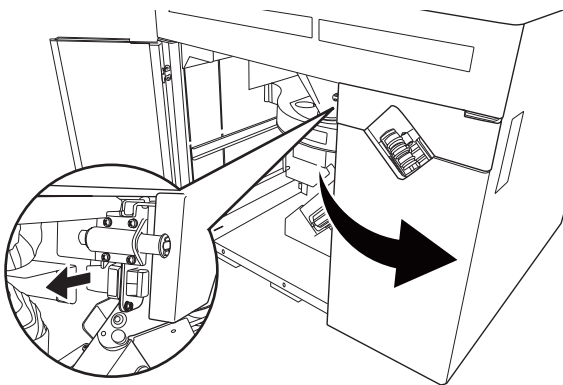

- Unhook to open the door on the conveyor door.

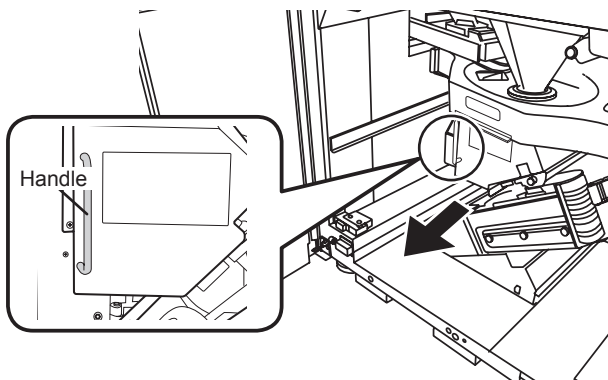

2. Pull the packing base.

- Pull the packing base while holding its handle.

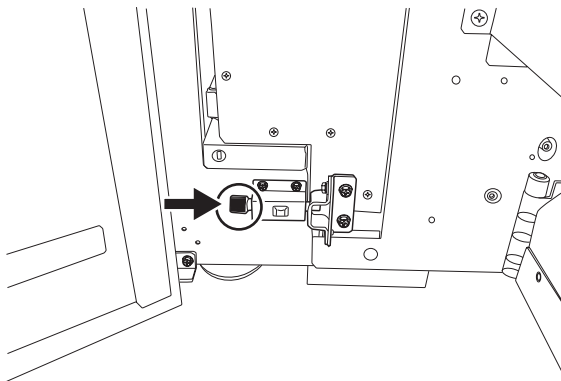

3. Lock the packing base.

CAUTION

Make sure to lock the packing base.
Otherwise the packing base moves and it may cause an injury.

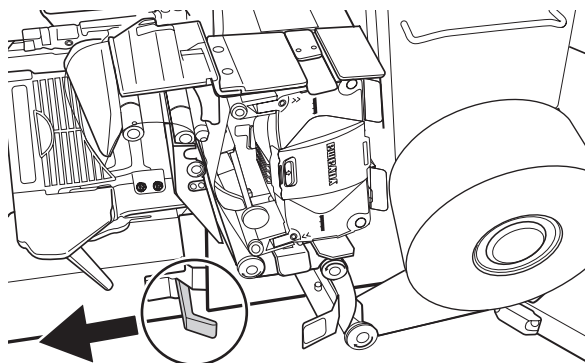

4. Open the packing unit.

- Open the packing unit while pulling its open/close lever.

CAUTION

Be careful not to hit other items when opening the packing unit.

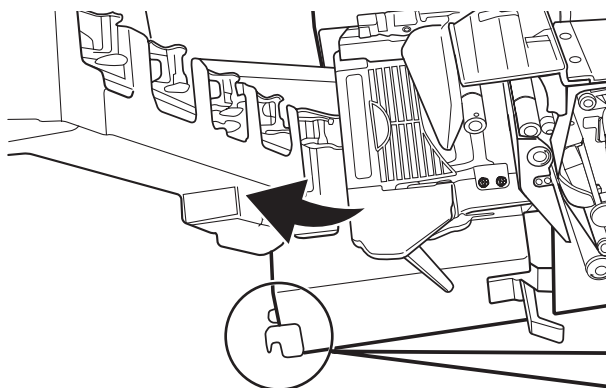

5. Open the conveyor.

- Hold the unlock hook on the conveyor unit, and open the conveyor to the left side.

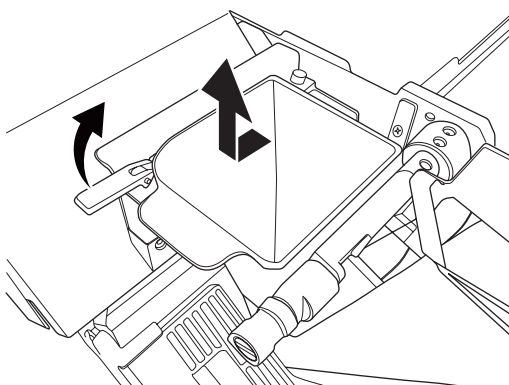
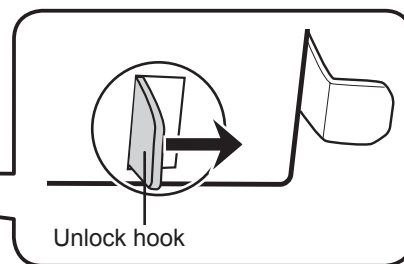

6. Remove the last hopper.

- After lifting the fixing lever, slide the last hopper toward you to remove it.