

5. Collect the ink ribbon

- Remove the used ink ribbon and ribbon shaft.

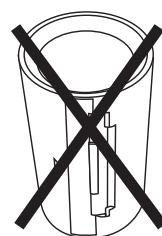

CAUTION FOR DISPOSAL

Do not dispose of the used ink ribbon and ribbon shaft for reuse.

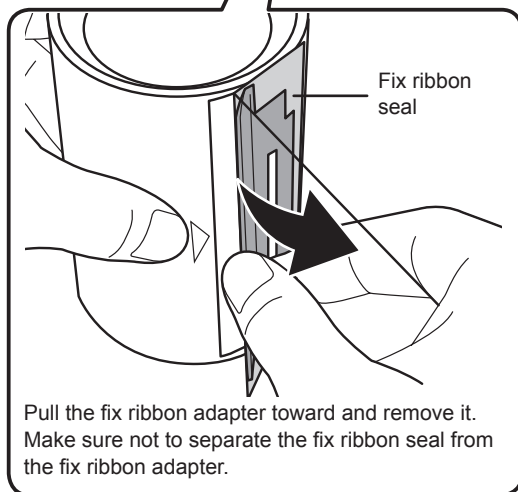
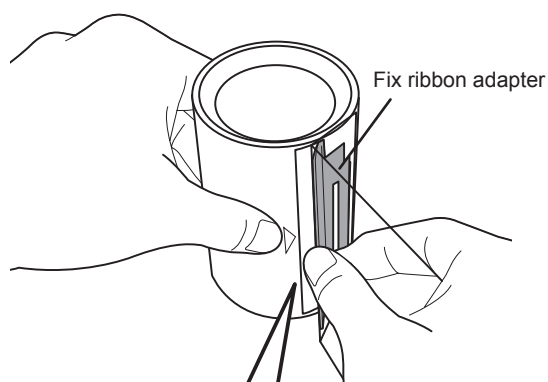

- Remove the fix ribbon adapter from the ribbon shaft for reuse.



Tips

When only the fix ribbon seal is removed, make sure to remove the fix ribbon adapter as well.

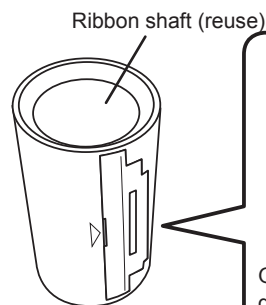

Fix ribbon adapter (dispose)

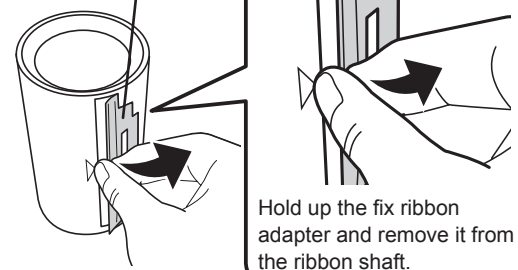

* Dispose of the used fix ribbon adapter.



Tips

When you find shavings on where the ink ribbon passes, such as metal parts of the case or the roller, remove shavings to wipe with an alcohol-soaked cloth. After cleaning, dry the cassette case completely and install the ink ribbon.

⚠ WARNING

- When you use the machine to left shavings into the cassette case, it may cause a faint print or foreign matter contamination.
 - Make sure to verify that there is no problem such as a breakage of cassette case
- When you find any problem, exchange the cassette case to new one.**

** When you want to purchase the cassette case, please contact your sales agent. (for value)

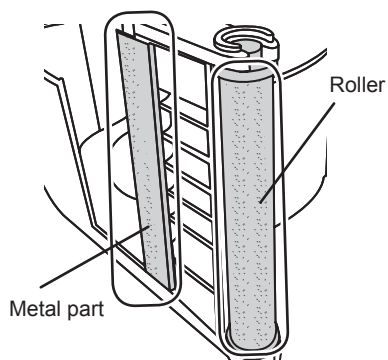
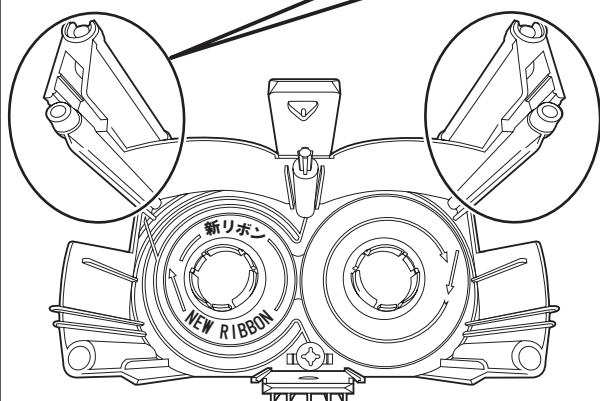

There are shavings on the roller and metal parts.

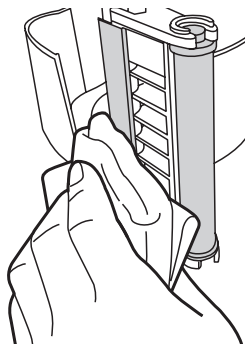

Wipe with an alcohol-moistened cloth.

Fix ribbon adapter

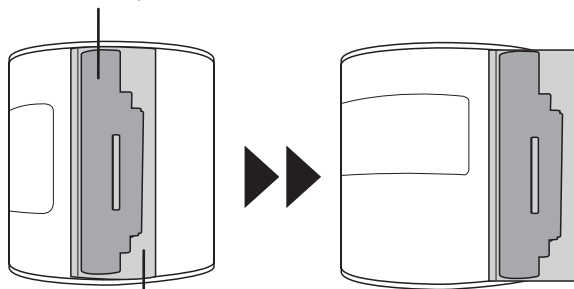

Fix ribbon seal

6. Install the fix ribbon adapter on the ribbon shaft.

- Remove the fix ribbon seal on the new ink ribbon.

CAUTION

Make sure not to remove the fix ribbon seal completely. Otherwise the fix ribbon adapter would be unattached from the ink ribbon.

Ribbon shaft

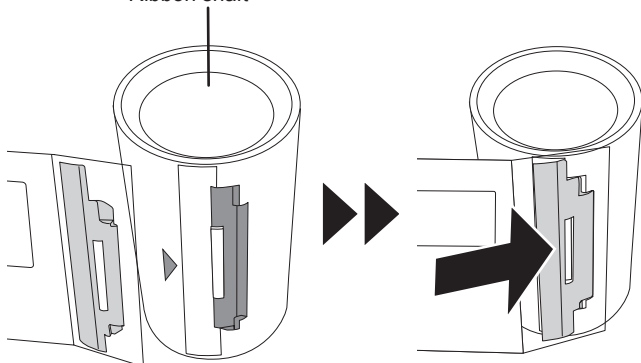

- Adjust the direction of the fix ribbon adapter on the new ink ribbon to make it the same way with the arrow mark on the ribbon shaft for rolling up.
- Then, insert the fix ribbon adapter to the insertion slot on the ribbon shaft.

* Reuse the corrected ribbon shaft.

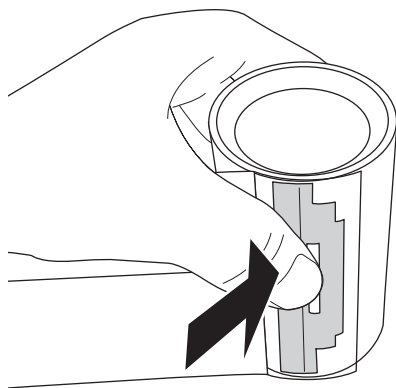

- Insert the fix ribbon adapter to the ribbon shaft until you hear a clicking noise.

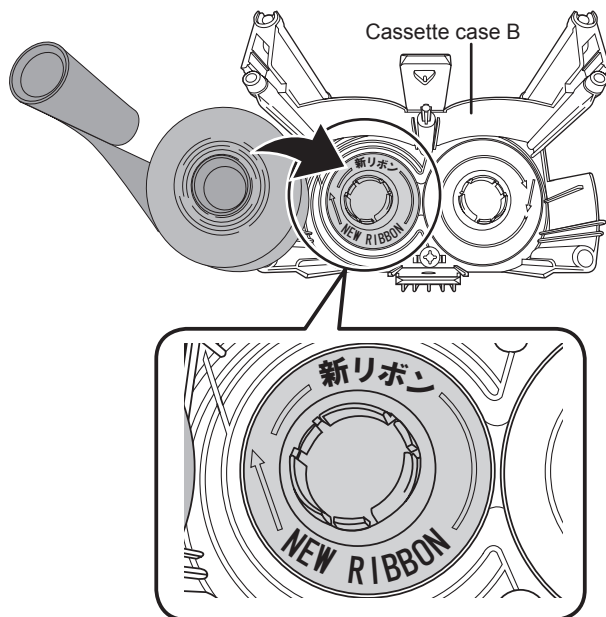

7. Install the ink ribbon

- Install the ink ribbon to the cassette case B.
- Put the new ink ribbon into the [NEW RIBBON] side.



Tips

* When to install the 4 color ink ribbon

Be careful about the ink ribbon's direction. The top color is BLACK, and the bottom color is BLUE.

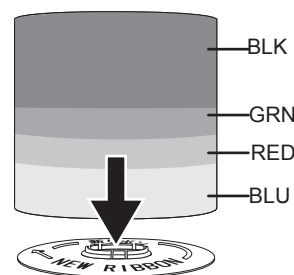

* When to install the half ink ribbon

Make the short side bottom to install the ink ribbon.

If you make the long side bottom, you cannot install the cassette case A.

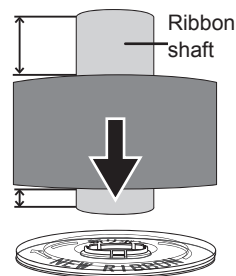

Make the short side bottom to install the ink ribbon.



CAUTION

Pass the ink ribbon through the cassette with correct direction as the following image. Otherwise it causes the malfunction.

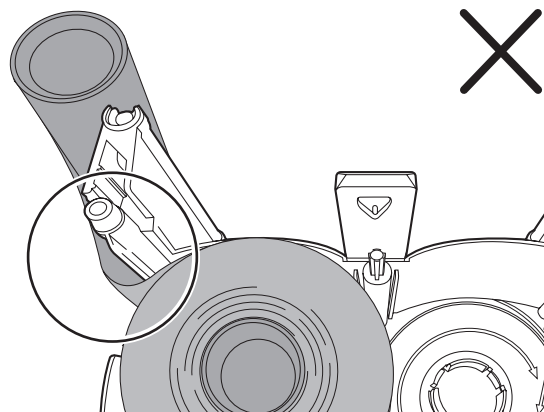
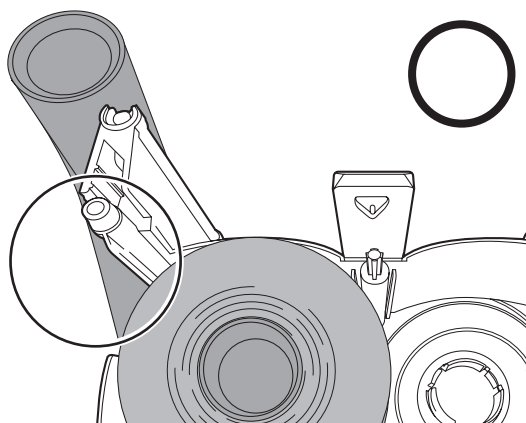

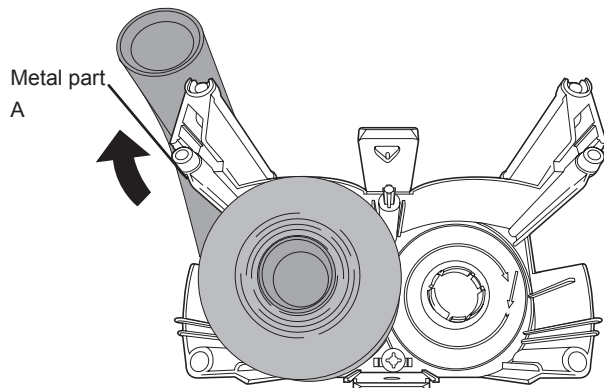

How to Pass Ink Ribbon through Cassette

- Pass the ribbon through the left side of the metal part A.

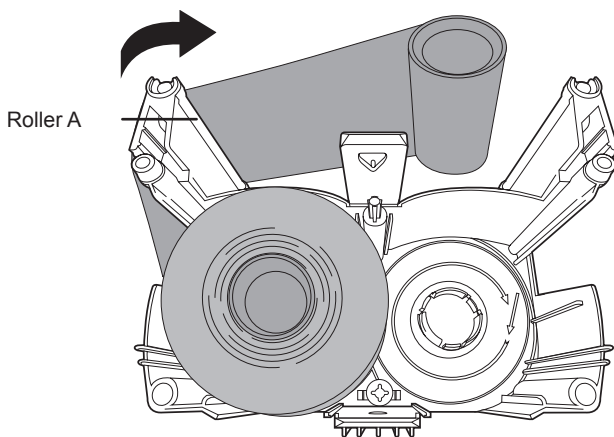

- Pass the ribbon through the upper side of the roller A.

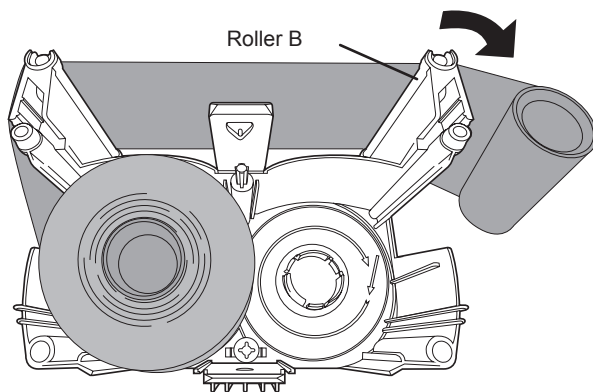

- Pass the ribbon through the upper side of the roller B.

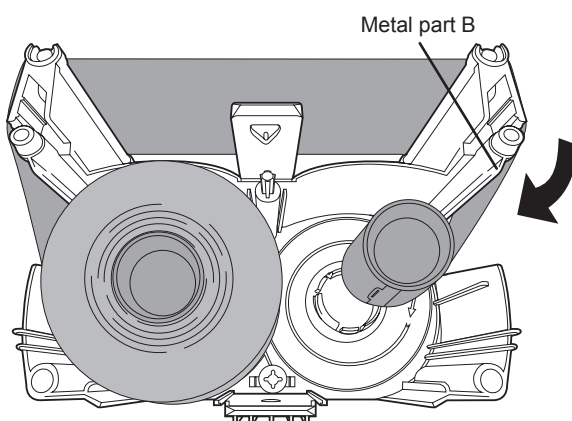

- Pass the ribbon through the right side of the metal part B.

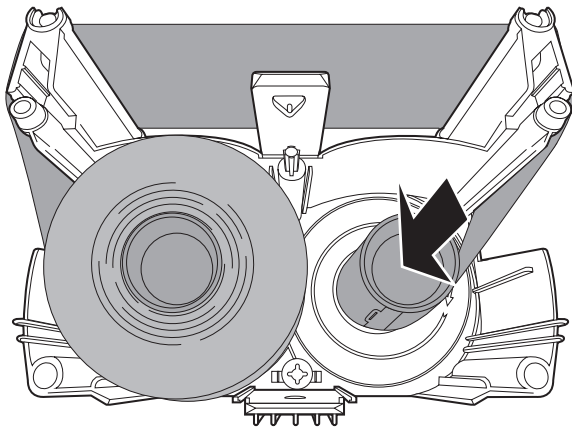

- Insert the ribbon shaft to the case.

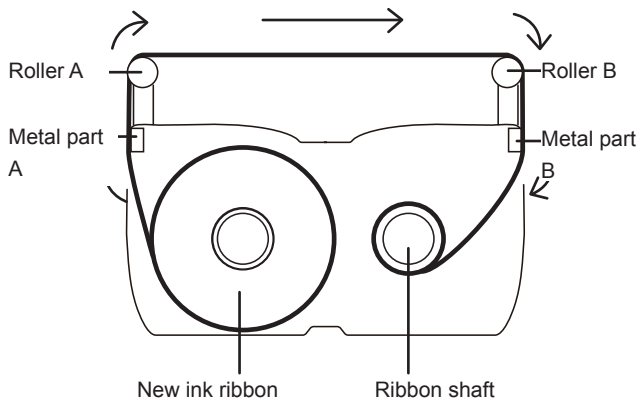

- Make sure to verify that the ink ribbon is installed correctly.

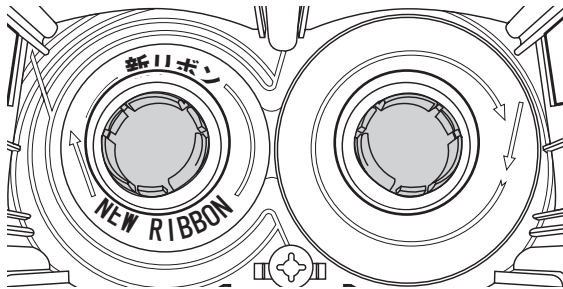

- Make sure to verify that the new ink ribbon and the ribbon shaft are fixed on the cassette case B.

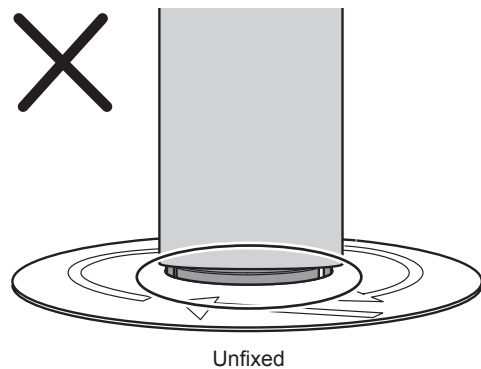
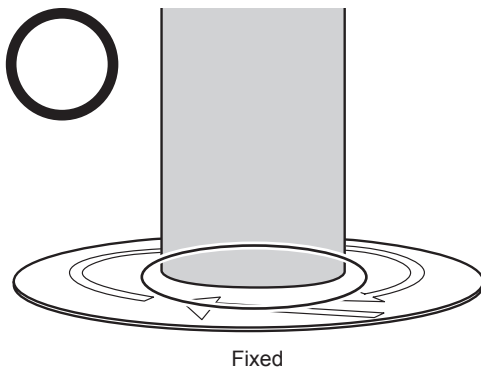

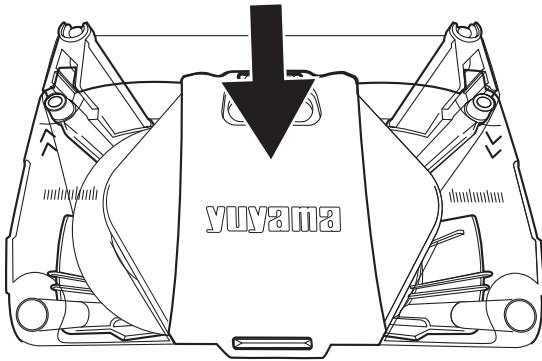

8. Attach the cassette case.

- Attach the cassette case A to holes of the cassette case B.

* Push the cassette case A into the cassette case B until you hear a clicking noise.



CAUTION

Make sure to verify that the ink ribbon does not get caught between cassette case A and B.

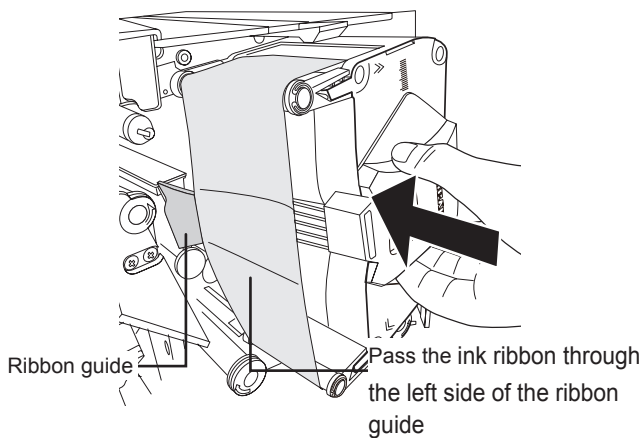

9. Replace the ink ribbon cassette to the original position.

- Pass the ink ribbon through the left side of the ribbon guide, and attach the ink ribbon cassette.
- Make sure to verify that the ink ribbon cassette is fixed.

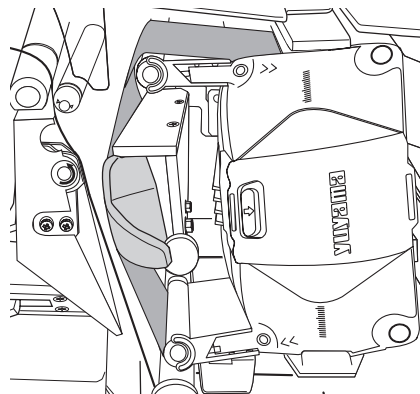
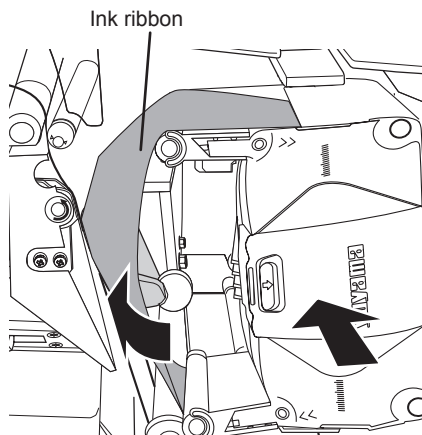

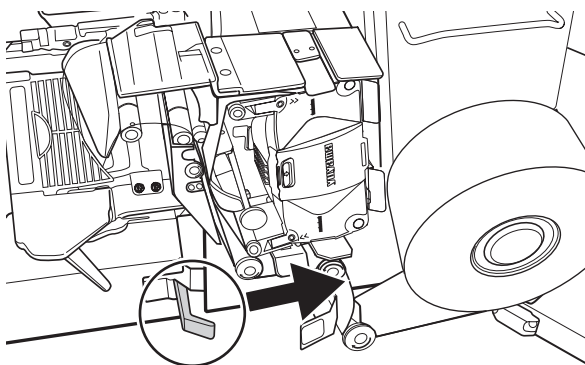

10. Replace the packing unit to the original position.

- Push the packing unit while holding its open/close lever.
- Push the packing unit until you hear a clicking noise.

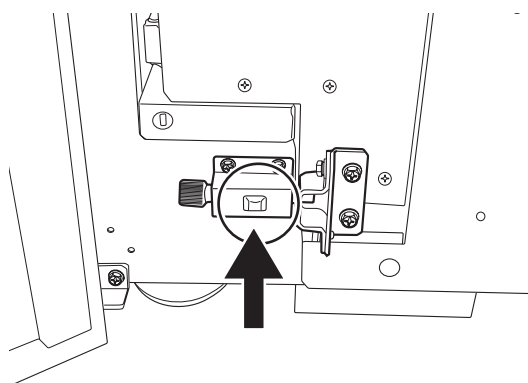

11. Return the packing base to the original position.

- Unlock the packing base.

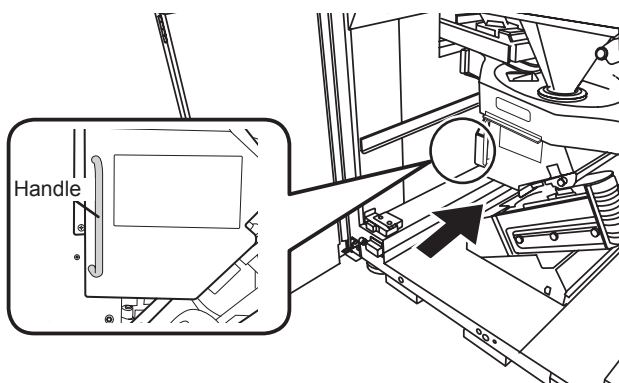

- Push the packing base while holding its handle.
- Push the packing base until you hear a clicking noise.
- When the packing machine turns on and you return the packing base, you will hear the blip.

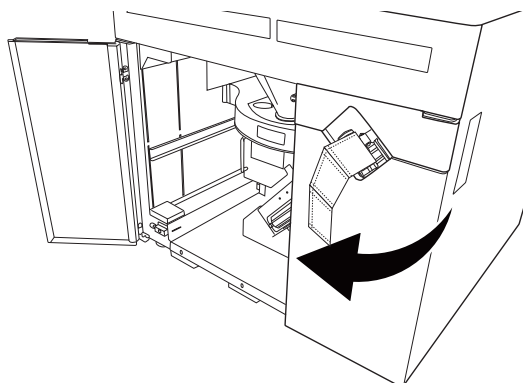

12. Close the lower door.

- Close the door on the conveyor side.

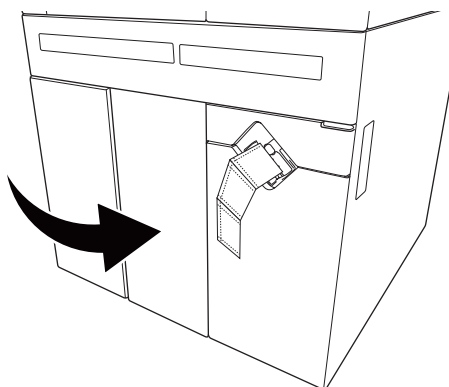

- Close the acrylic door.
- Push [PUSH] on the acrylic door after closed.



- Touch [RESUME], and dispensing resumes.

DTA unit

After dispensing items such as plain tablets, a small amount of powder may remain inside the packing machine. Maintain the packing machine periodically to ensure that such powder is not mixed with other drugs.

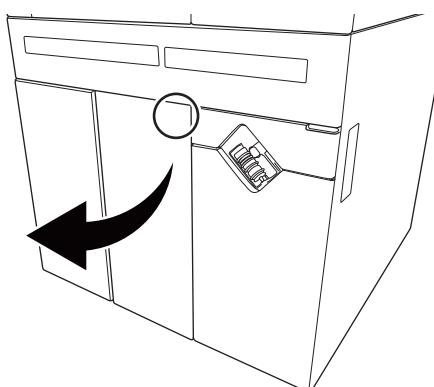

1. Open the lower door.

- Push [PUSH] of the acrylic door and then open it while folding it.

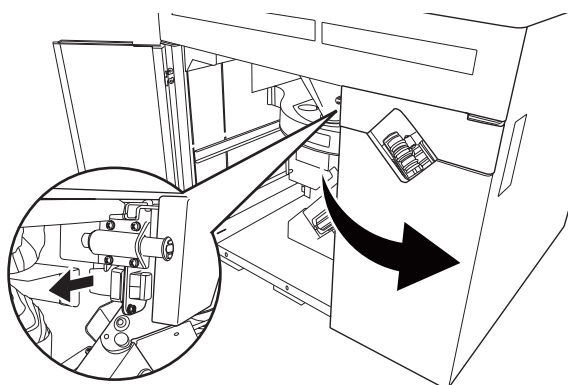

- Unhook to open the door on the conveyor side.

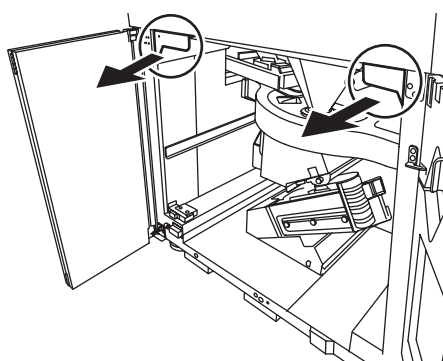

2. Pull the DTA unit.

- Pull the DTA unit while holding its handle.

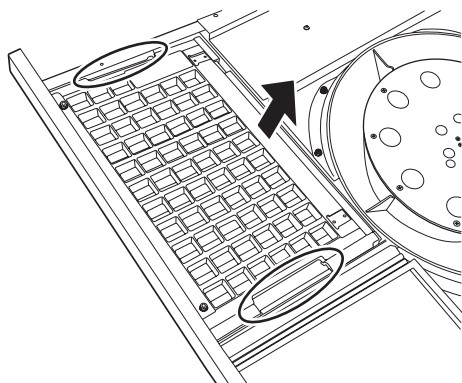

3. Remove the DTA set plate.

- Hold the both ends of the DTA set plate.
- Lift it slightly and then remove it from the deep end.

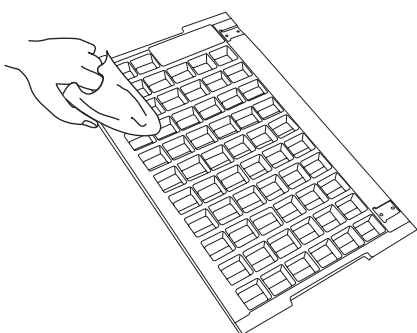

- Remove dirt from the surface by wiping it with a soft water-moistened cloth.
- After removing dirt, remove moisture from the surface by wiping it with a dry soft cloth.
- When you cannot remove dirt, wash it with water using a soft sponge. After washing it with water, let it dry naturally to remove moisture completely.

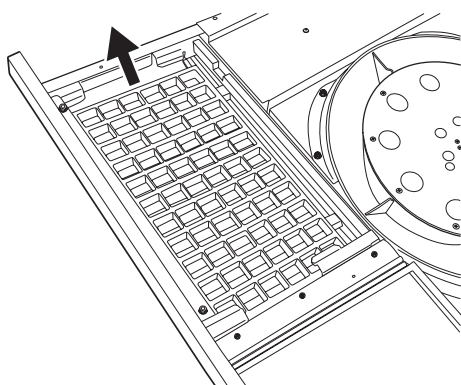

4. Remove the DTA cells.

- Lift the DTA cells slightly and remove it from the left side.

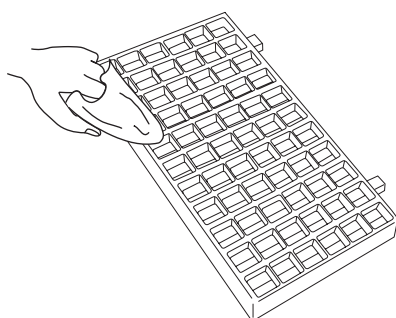

- Remove dirt from the surface by wiping it with a soft water-moistened cloth.
- After removing dirt, remove moisture from the surface by wiping it with a dry soft cloth.



5. Touch [Maintenance].

- The screen is switched to the [Maintenance] screen.

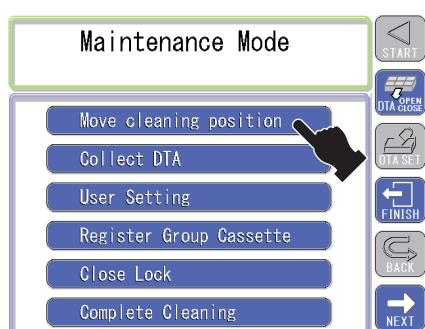

6. Touch [Move cleaning position].

- The slide plate opens.

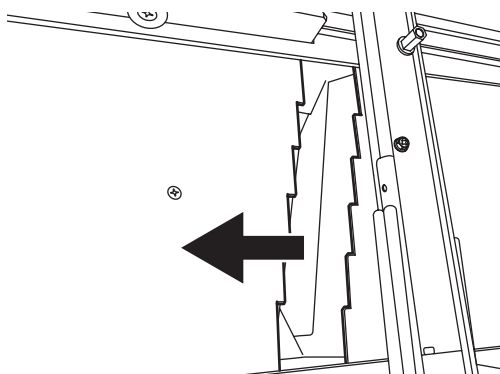

- The V-holder opens.

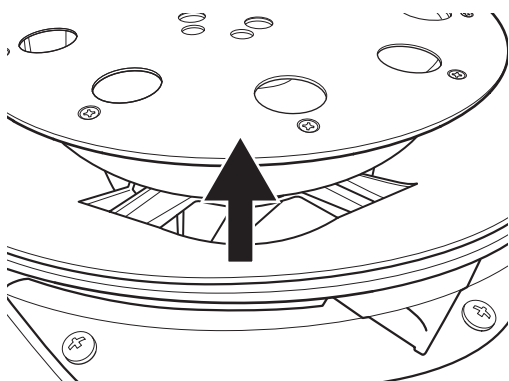

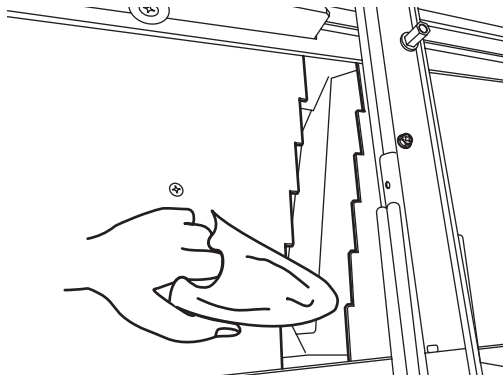

- Remove dirt from the surface by wiping it with a soft water-moistened cloth.
- After removing dirt, remove moisture from the surface by wiping it with a dry soft cloth.

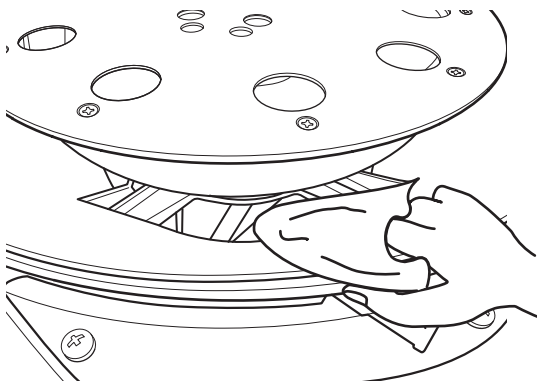

- Remove dirt from the surface by wiping it with a soft water-moistened cloth.
- After removing dirt, remove moisture from the surface by wiping it with a dry soft cloth.

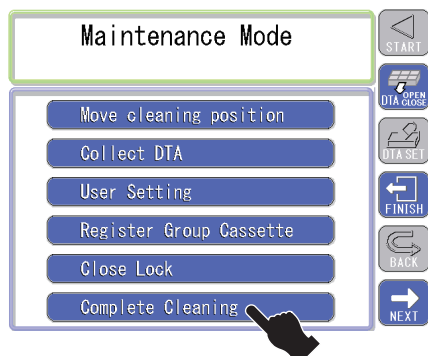

7. Touch [Complete Cleaning].

- The confirmation message is displayed. Touch [Yes].

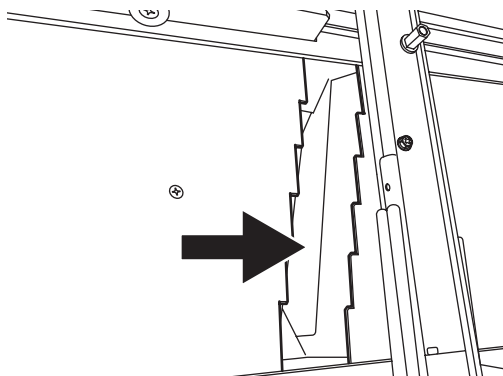

- The slide plate closes.



CAUTION

Be careful not to pinch your fingers.

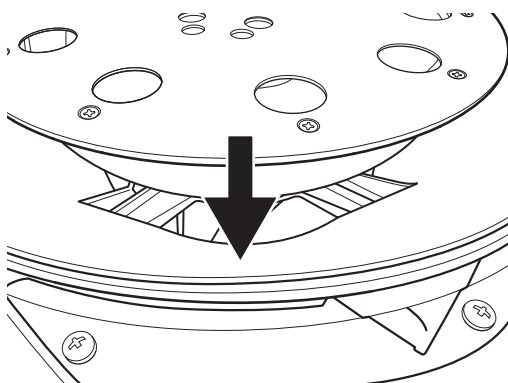

- The V-holder closes.



CAUTION

Be careful not to pinch your fingers.

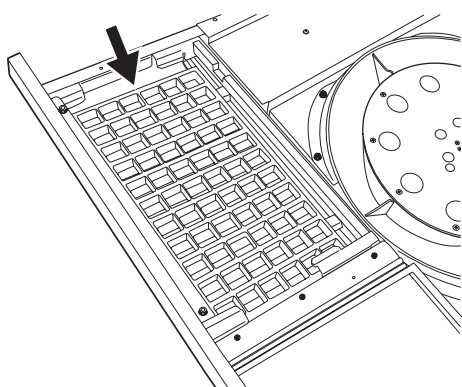

8. Attach the DTA cells and the DTA set plate.

- Slide the DTA cells from the left side to the right side to set.



CAUTION

Before attaching the DTA cells, make sure that the slide plate is closed.

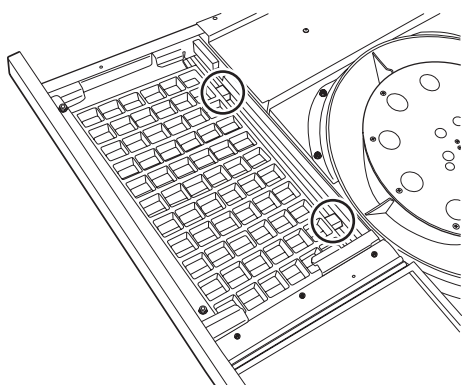

- Make sure that the DTA cells are fit into the grooves.

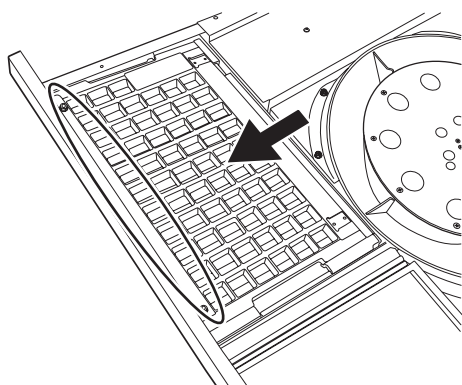

- Before attaching the DTA set plate, make sure that the front side is aligned.

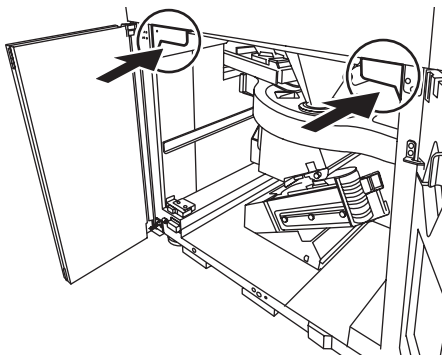

9. Return the DTA unit to the original position.

- Insert the DTA unit all the way while holding its handle.

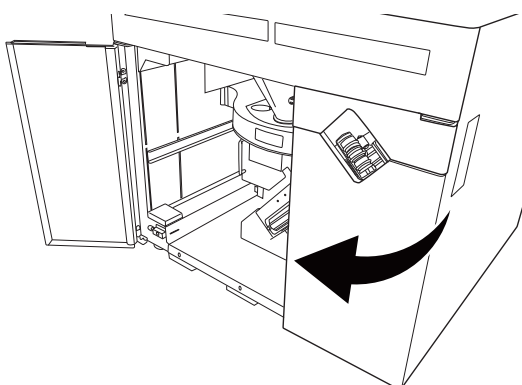

10. Close the lower door.

- Close the door on the conveyor side.

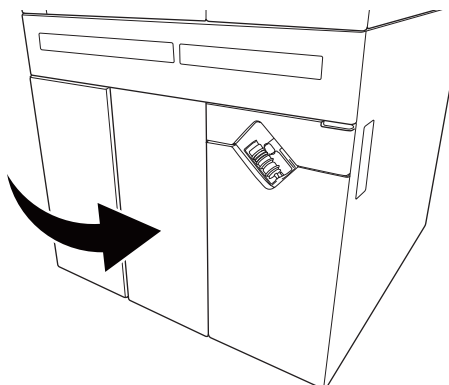

- Close the acrylic door.
- After closing the acrylic door, push [PUSH] on the acrylic door.

Last hopper

After dispensing plain tablets, a small amount of powder may remain inside the packing machine. Maintain the packing machine periodically to ensure that such powder is not mixed with other drugs.

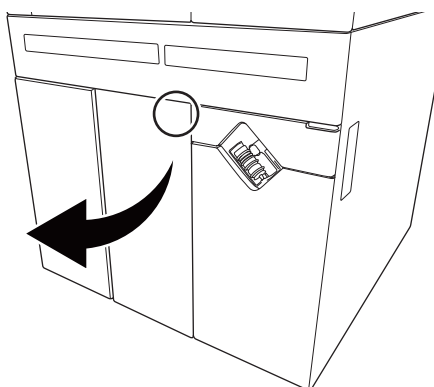

1. Open the lower door.

- Push [PUSH] on the acrylic door and then open it while folding it.

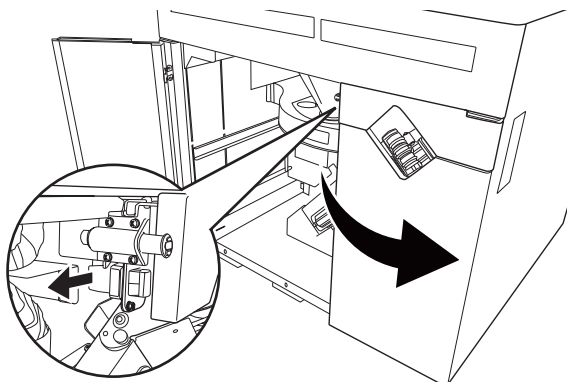

- Unhook to open the door on the conveyor side.

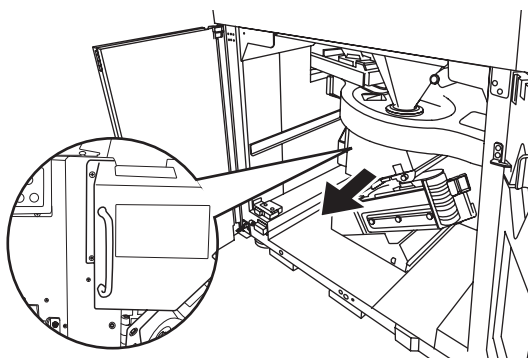

2. Pull the packing unit.

- Pull the packing unit while holding its handle.

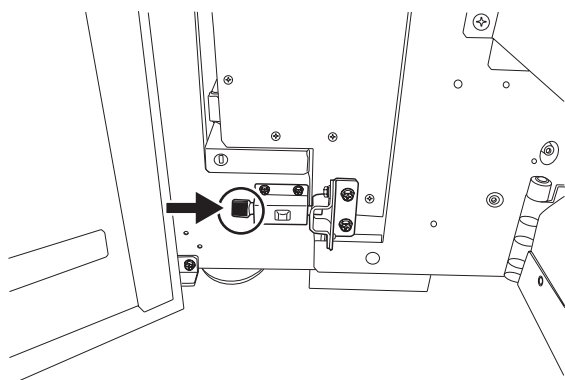

- Lock the packing unit.

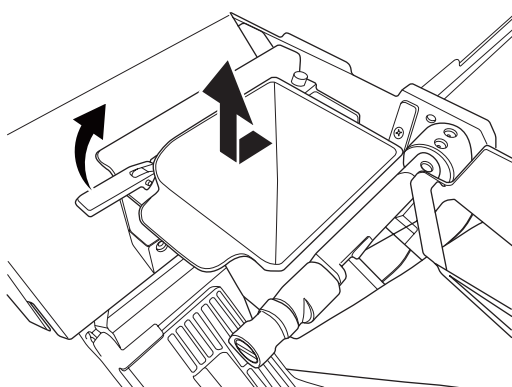

3. Remove the last hopper.

- After lifting the fixing lever, slide the last hopper toward you to remove it.

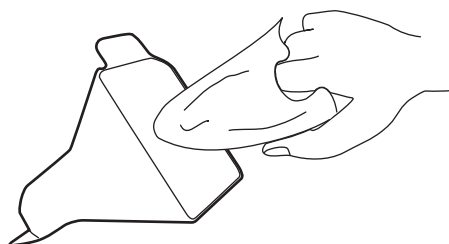

4. Clean the last hopper.

- Remove dirt from the surface by wiping it with a soft water-moistened cloth.
- After removing dirt, remove moisture from the surface by wiping it with a dry soft cloth.
- When you cannot remove dirt, wash it with water using a soft sponge. After washing it with water, let it dry naturally to remove moisture completely.

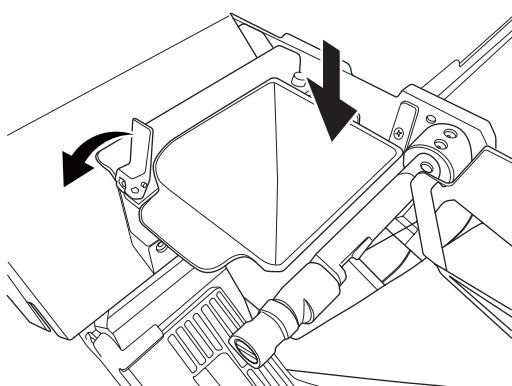

5. Attach the last hopper.

- After attaching the last hopper, tilt the fixing lever.