

10. Feed the cleaning leader.

- Press the [Heater roller RW] switch to feed the cleaning leader.
- * Keep on pressing the [Heater roller RW] switch until the cleaning leader feed has done.

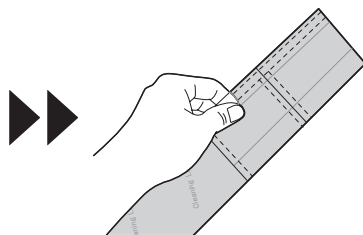
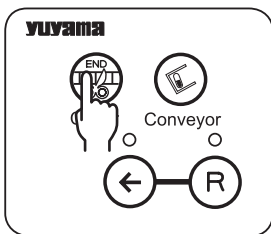

11. Cut the packing paper.

- After the part of packing paper passes the heater roller, press the [Cutter] switch to cut the packing paper.
- Remove the cut packing paper.
- Make sure to check whether the packing paper passes correctly. (P65)

CAUTION

Be careful not to feed the cut packing paper to the conveyor because the conveyor will work when you press the [Cutter] switch.

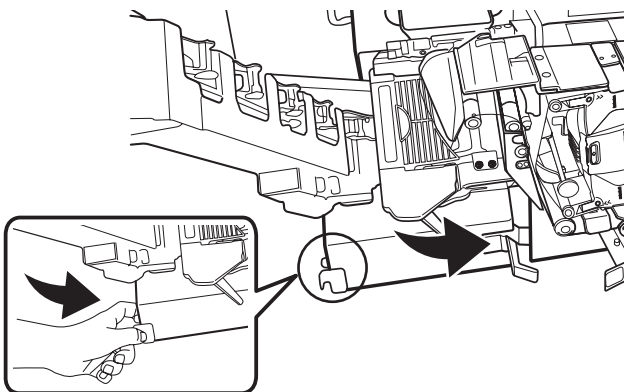

12. Close the conveyor.

- Hold the conveyor's handle like the left image, and push the conveyor.
- Push the conveyor until you hear a clicking noise.

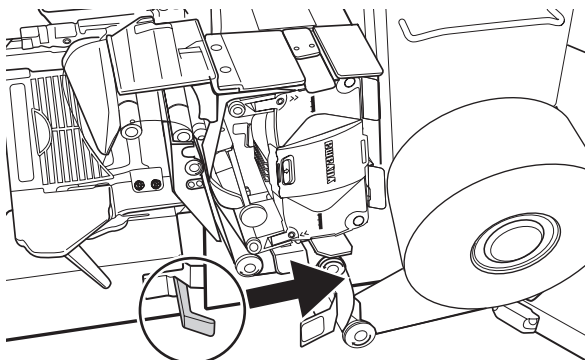

13. Return the packing unit to the original position.

- Push the packing unit while holding its open/close lever.
- Push the packing unit until you hear a clicking noise.

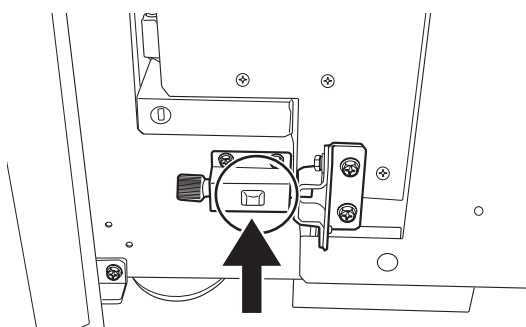

14. Return the packing base to the original position.

- Unlock the packing base.

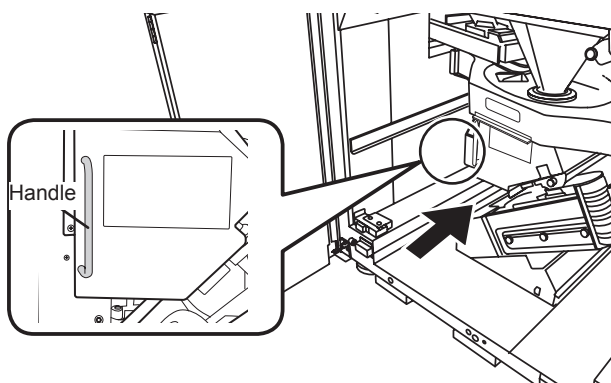

- Push the packing base while holding its handle.
- Push the packing base until you hear a clicking noise.
- You will hear a blip to return the packing base to the original position when the packing machine is on.

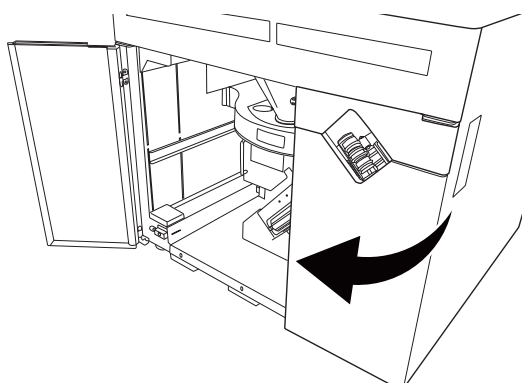

15. Close the lower door.

- Close the door on the conveyor side.

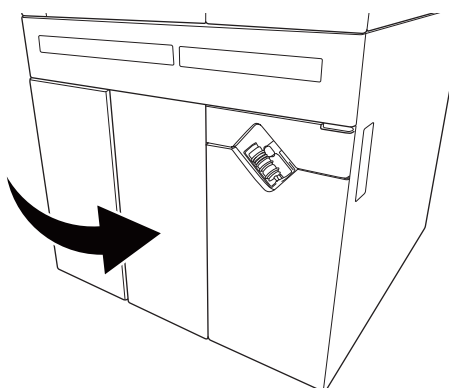

- Close the acrylic door.
- After closing it, push [PUSH] on the acrylic door.

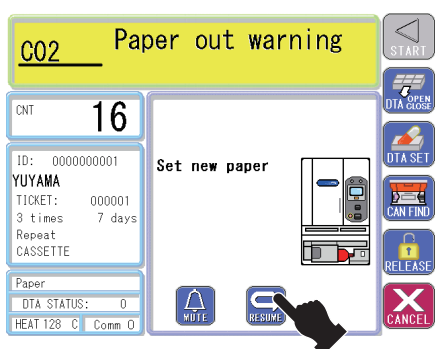

16. Touch [RESUME].
- Dispensing resumes.

The route of packing paper

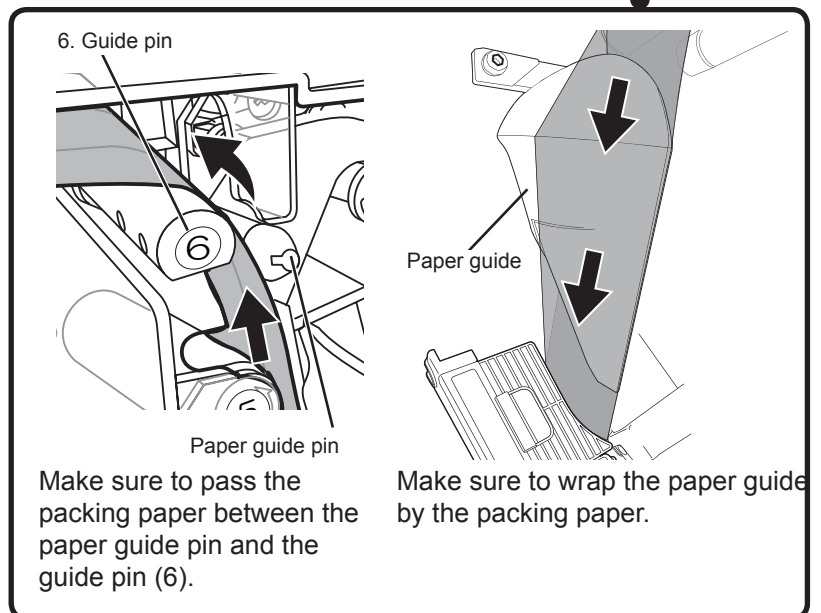
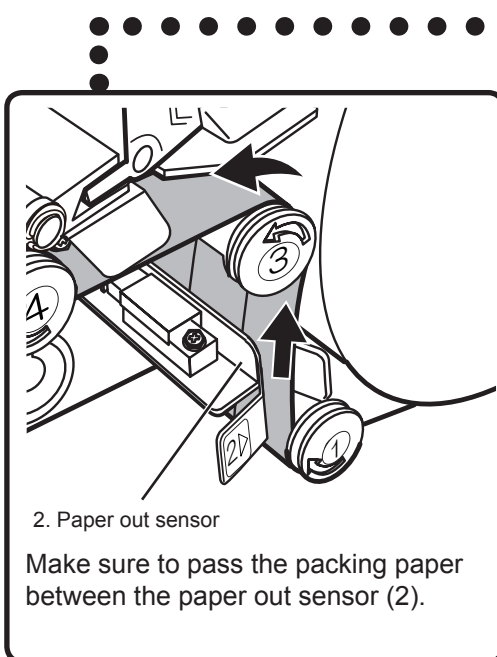
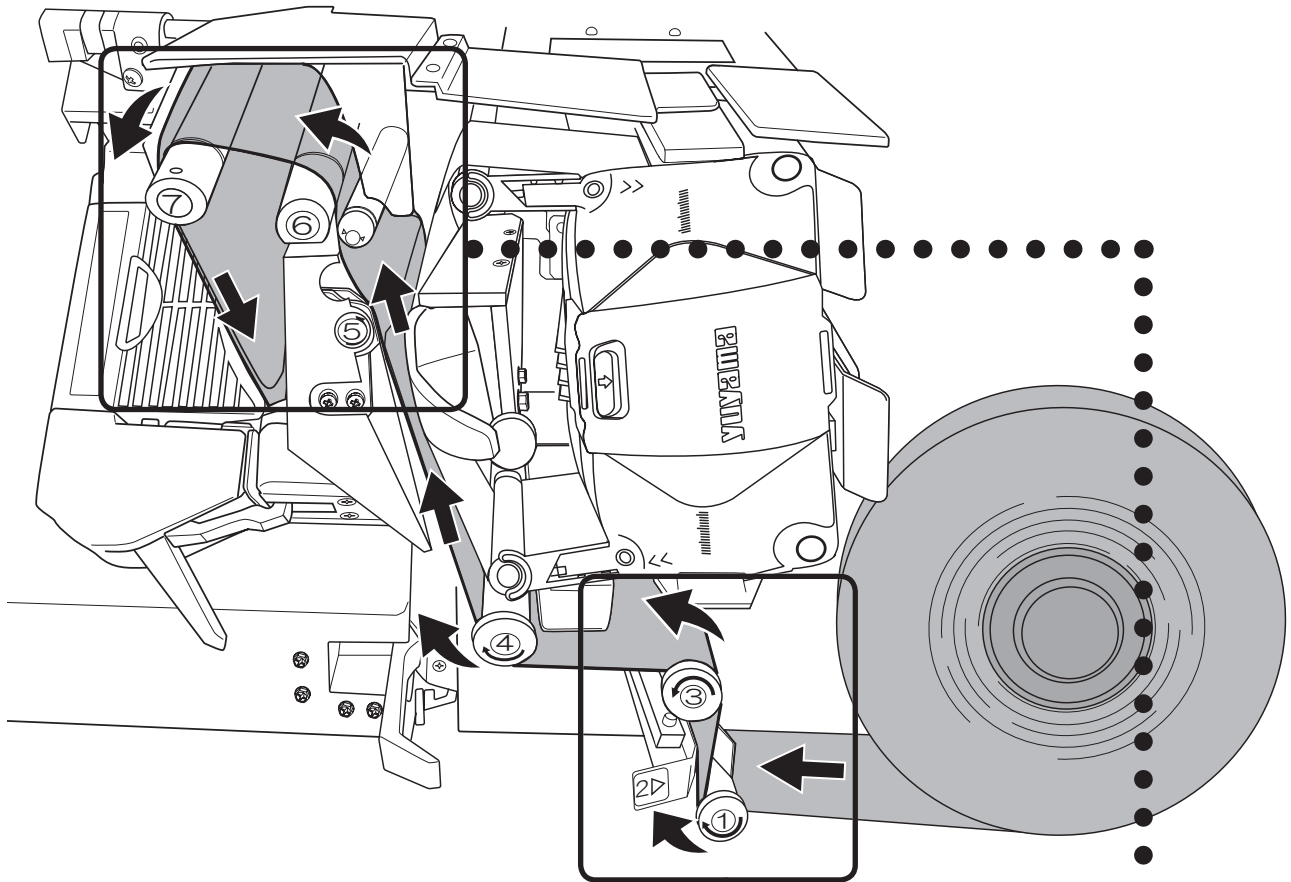

* Make sure to follow this order.

Ink ribbon

Dispensing stops when the ink ribbon is out during dispensing. Replace it with a new ink ribbon.

When you need to purchase a new ink ribbon, contact with your dealer or your nearest Yuyama's sales office (provided in the separate sheet).

- If the print is so light even after ink ribbon replacement, clean the printer head. (P97)



- [Ink ribbon empty warning] is displayed on the touch panel and an alarm is issued.

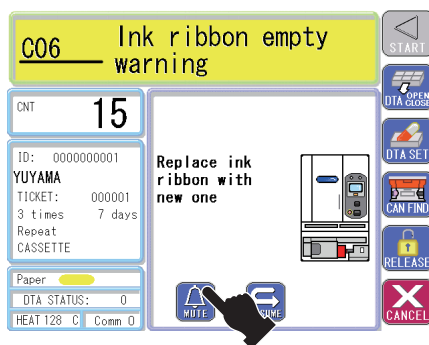

- Touch [Mute] to stop the alarm.

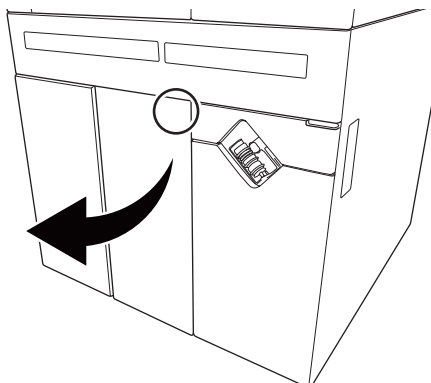

1. Open the lower door.
 - Push [PUSH] on the acrylic door and open it while folding it.

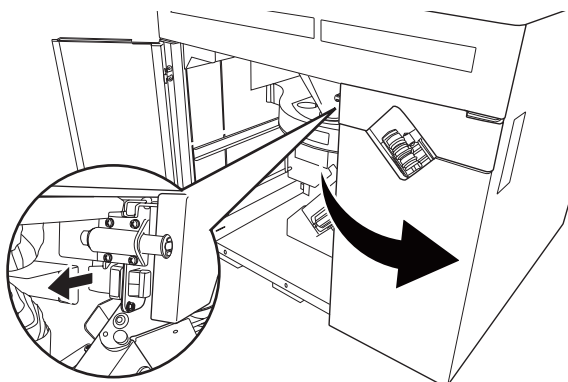

- Unhook to open the door on the conveyor side.

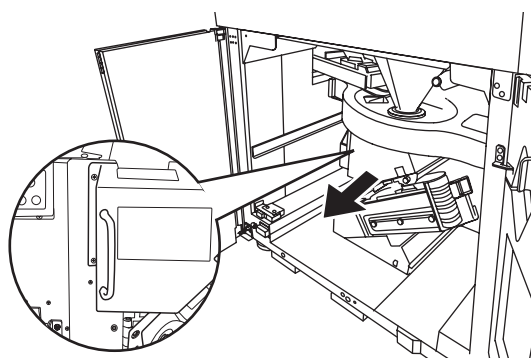

2. Pull the packing base.

- Pull the packing base while holding its handle.

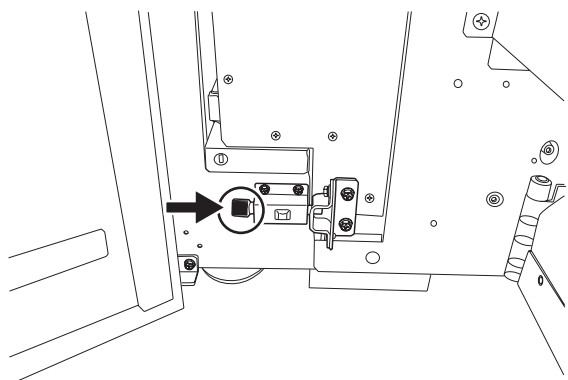

- Lock the packing base.

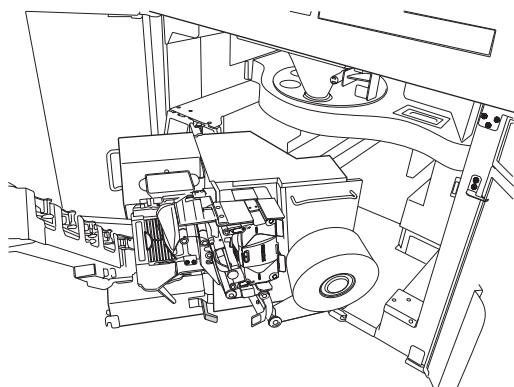

- Open the packing unit while pulling its open/close lever.

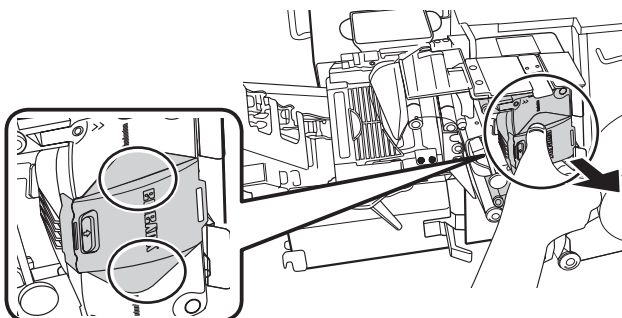

3. Remove the ink ribbon cassette

- Grab two grooves of the cassette case and remove the ink ribbon cassette.

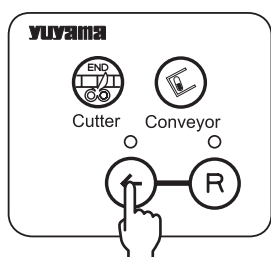

Tips

When you pull out the packing unit, the printer head is not opened. Make sure to press [Heater roller normal rotation] switch and open the printer head when you want to open it.

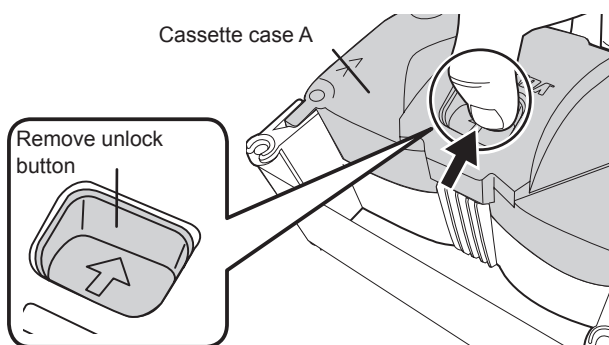
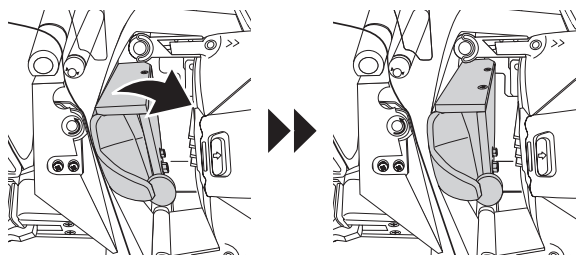

4. Remove the cassette case



CAUTION

When you exchange the ink ribbon, make sure to exchange it on the horizontal place, such as a desk and a stand.

- Press into the [Remove unlock button] which is on the cassette case A.
- Hold up the cassette case A and remove it.

