

Maintenance Mode

Group No

Name

Reg. #	1	2	3	4	5	6	7
Brnc. #	1						

Register Clear

START
DTA OPEN
DTA CLOSE
DTA SET
FINISH
BACK
NEXT

- The drug name of the set cassette is displayed.
- The drug is registered as [No.1] of [Brnc. #].

Maintenance Mode

Group No

Name

Reg. #	1	2	3	4	5	6	7
Brnc. #	1	2	3	4			

Register Clear

START
DTA OPEN
DTA CLOSE
DTA SET
FINISH
BACK
NEXT

- When you continue to register other drugs, place their cassettes in the same way.
- [No. 2], [No. 3] and [No. 4] are registered at [Brnc. #] in this order.

Maintenance Mode

Group No

Name

Reg. #	1	2	3	4	5	6	7
Brnc. #	1	2	3	4			

Register Clear

START
DTA OPEN
DTA CLOSE
DTA SET
FINISH
BACK
NEXT

4. Touch [Register].

- The cassettes placed on the refilling table are registered as a group.

Maintenance Mode

Group No

Name

Reg. #	1	2	3	4	5	6	7
Brnc. #	1	2	3	4			

Register Clear

START
DTA OPEN
DTA CLOSE
DTA SET
FINISH
BACK
NEXT

- To cancel a registered group, touch [Clear].
- You can cancel the registered group by touching [Register] after [Name] and [Brnc. #] have been canceled.

■ [Close Lock]

You can lock the upper door.

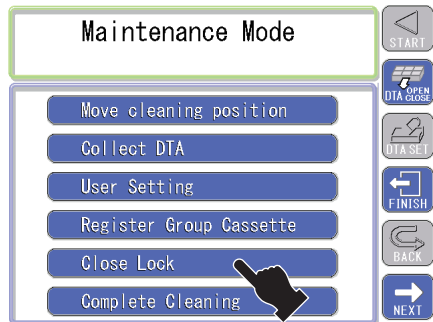

1. Touch [Close Lock].

- The upper door is locked.

Turning the cylinder manually

You can turn the cylinder where the cassette is attached to manually.
You can do this when cleaning the sash. (P94)

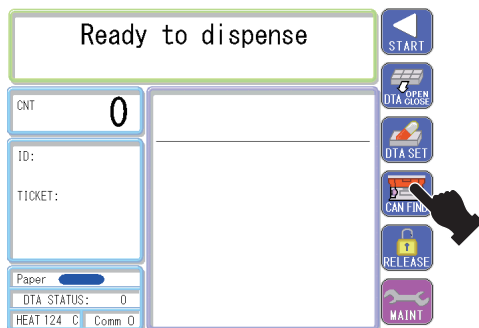

1. Touch [CAN FIND].

- The screen is switched to the [Call Cassette] screen.

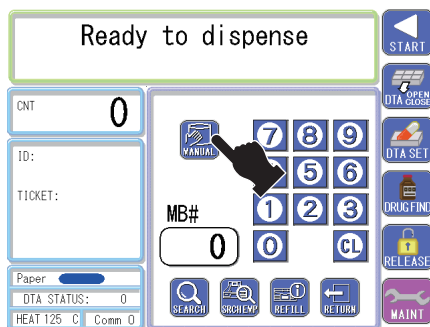

2. Touch [MANUAL].

- The cylinder is unlocked.

- Now, you can turn the cylinder manually.

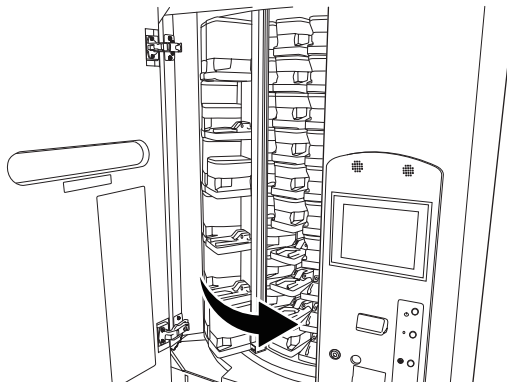

CAUTION

Hold the cassette base when turning the cylinder.
Turning the cylinder while holding the cassette may
result in the cassette base damage.

Packing paper

Dispensing stops if all packing paper is used during dispensing. In this case, refill new packing paper.

When you need to purchase new paper, contact with your dealer or your nearest Yuyama's sales office (provided in the separate sheet).

- * Be sure to use genuine YUYAMA packing paper. Store packing paper in a place that is not exposed to direct sunlight or with high humidity.

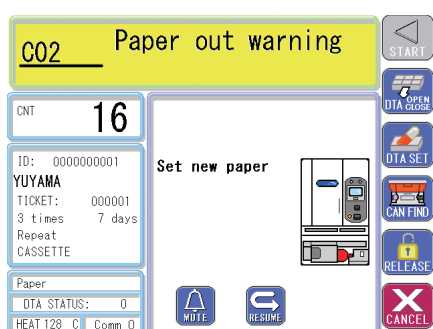

- [Paper Out Warning] is displayed on the touch panel and an alarm is issued.

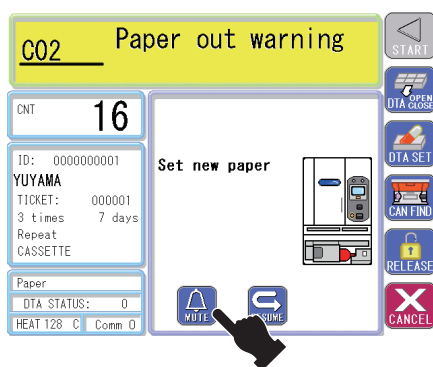

- Touch [MUTE] to stop the alarm.

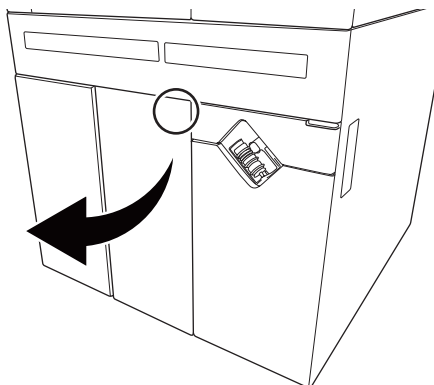

1. Open the lower door.
 - Push [PUSH] on the acrylic door and open the door while folding it.

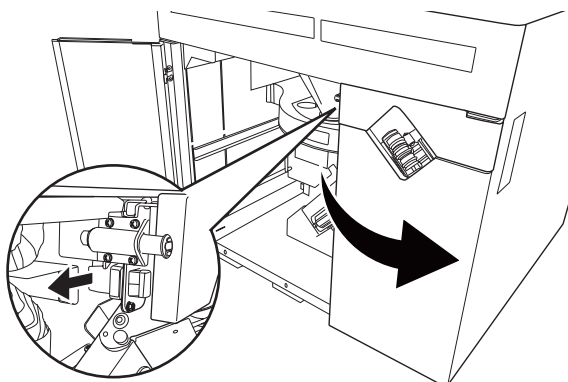

- Unhook to open the door on the conveyor side.

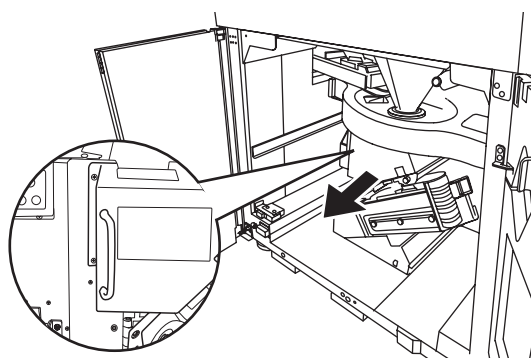

2. Pull the packing base.

- Pull the packing base while holding its handle.

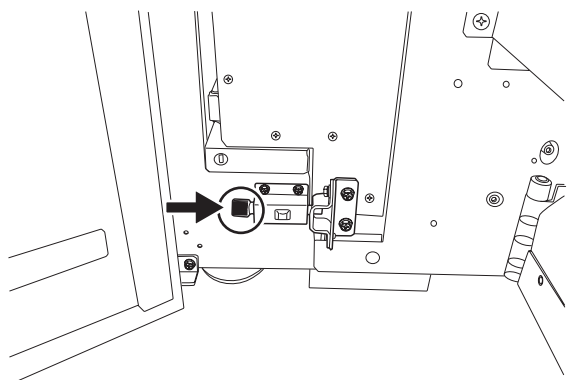

- Lock the packing base.

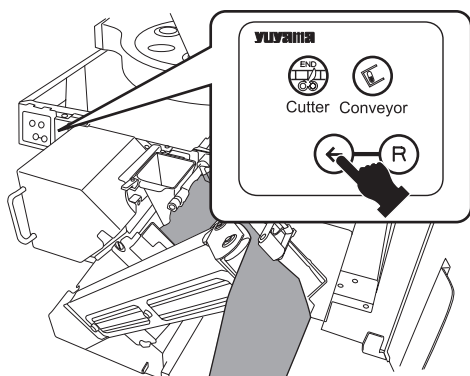

- Press the [Heater Roller FW] switch to remove the remaining packing paper.

CAUTION

When packing paper has been removed by pressing the [Cutter] switch, paper for a pouch remains. Remove it.

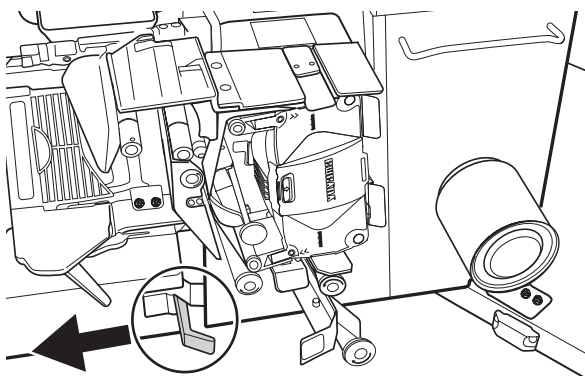

3. Open the packing unit.

- Open the packing unit while pulling its open/close lever.

CAUTION

Be careful not to hit other items when opening the packing unit.

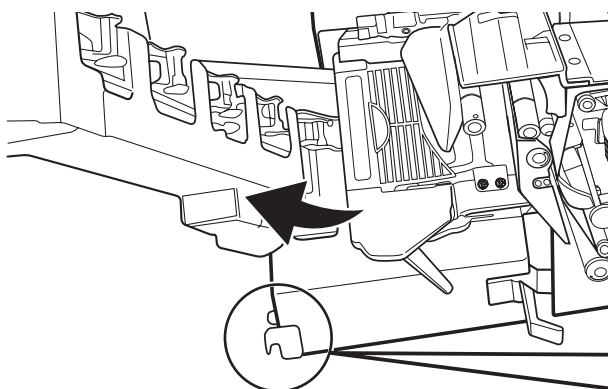

4. Open the conveyor.

- Hold the unlocking hook on the conveyor unit, and open the conveyor to the left side.

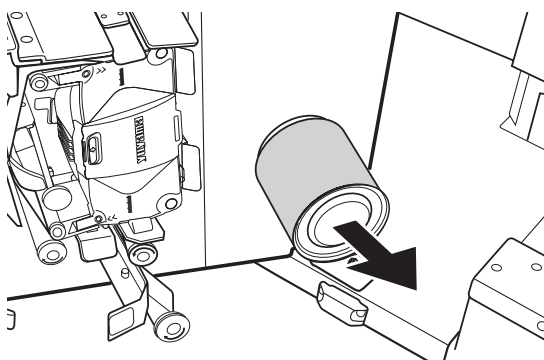
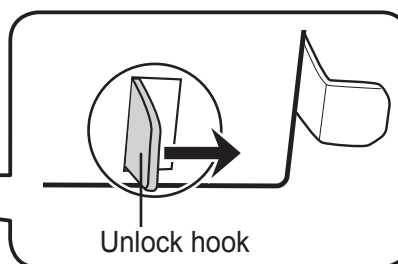

5. Remove the empty paper core (plastic).

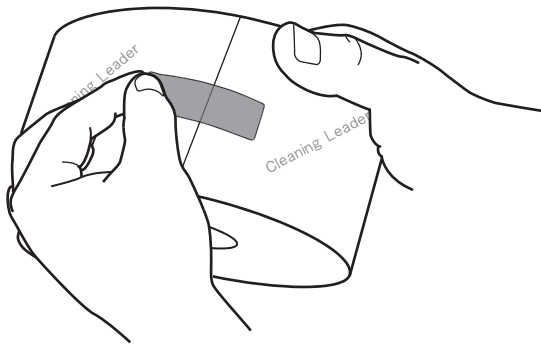

Set the new packing paper.

- Remove the fix ribbon seal on the new ink ribbon.
- Insert the packing paper so that the metal part of its ring comes to the back of the paper core.

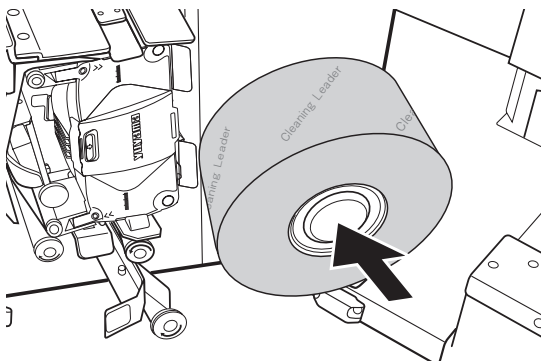
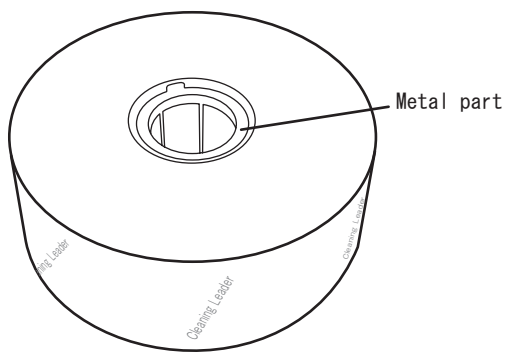

- Insert the new packing paper until you hear a clicking noise.

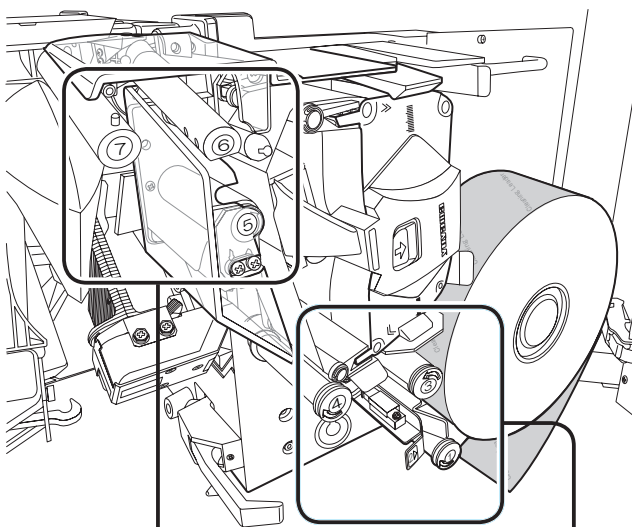

6. Pass the packing paper.

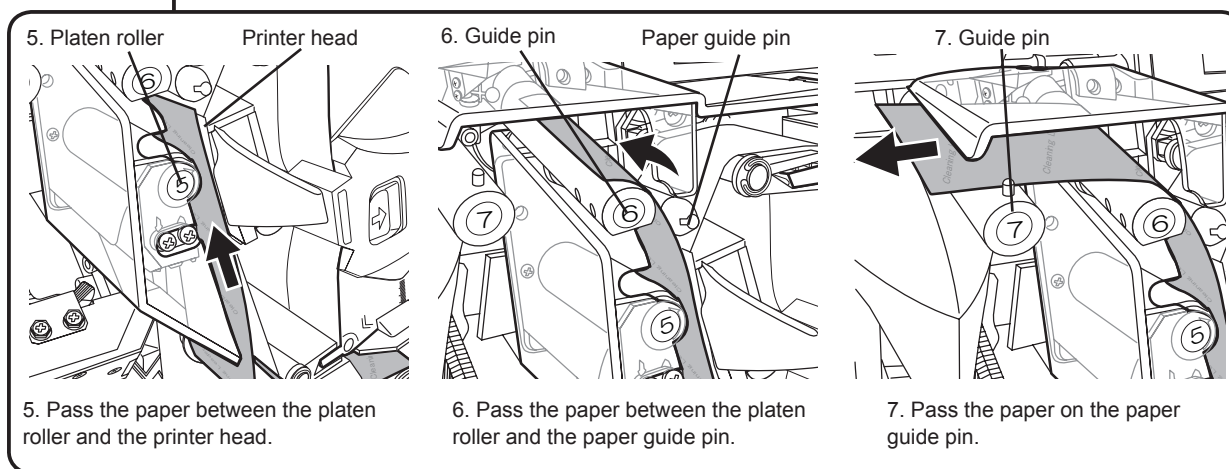
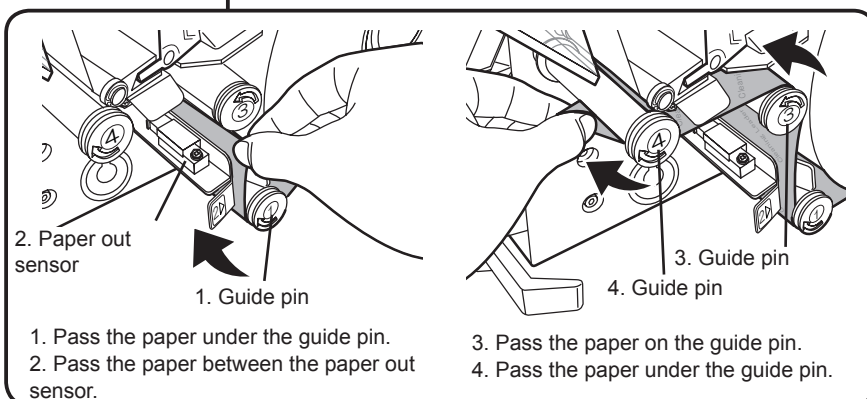
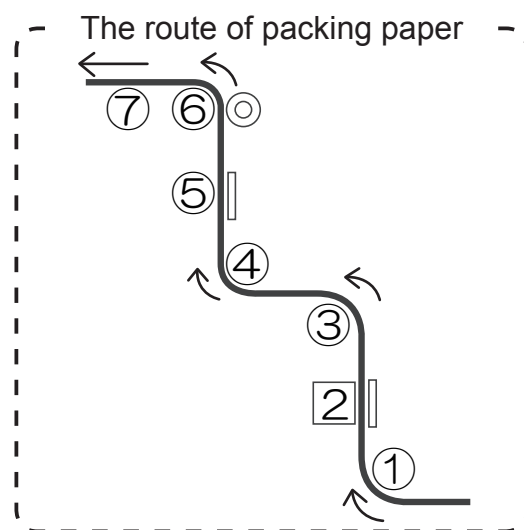

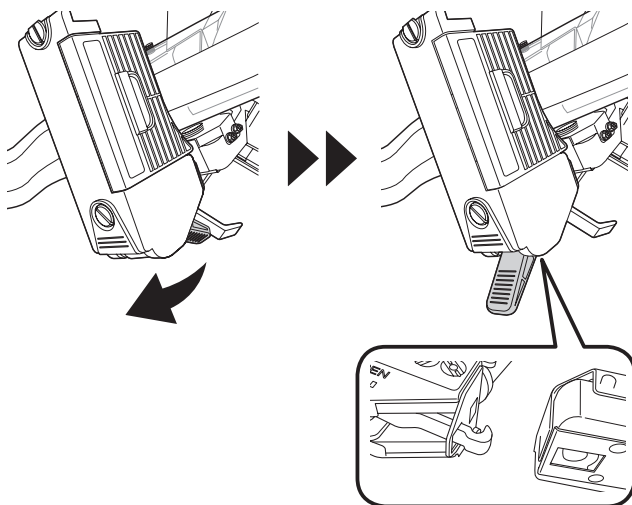

7. Open the heater roller.

- Press the heater roller open/close lever to the [OPEN].
- Then the hook is unlocked and you can open the heater roller.

CAUTION

Be careful not to touch the surface of heater roller because it is very hot.

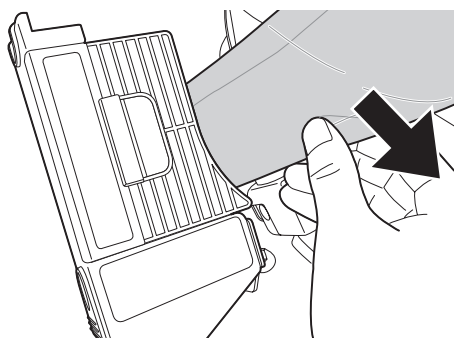

- Remove the remaining packing paper in the heater roller.

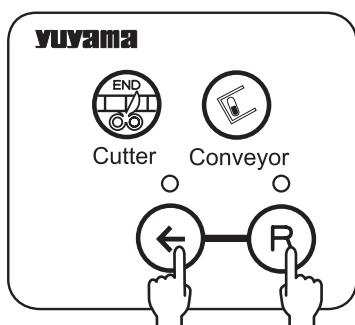

8. Pass the cleaning leader through the heater roller.

- Press the [Heater roller RW] switch and [Heater roller FW] switch together to pass the cleaning leader through the heater roller.

- Open the cleaning leader.

CAUTION

You cannot open the head of cleaning paper approximately 30 cm because it is sealed.

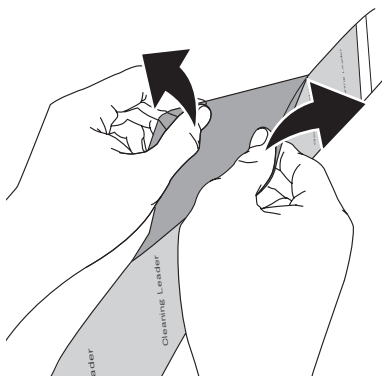

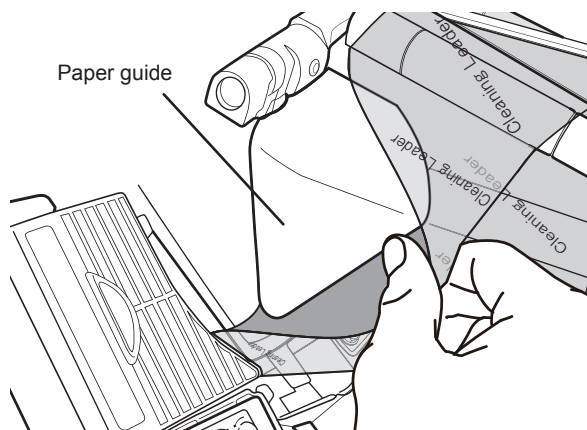

- Open the cleaning leader to wrap the paper guide, then pass the cleaning leader.



What is cleaning leader?

The cleaning leader prevents the paper jam because of the packing paper's paste on the heater roller. It removes the paste when you exchange the packing paper.

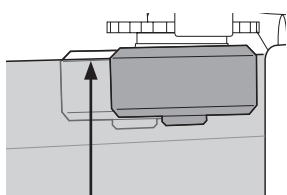

Position to join the cleaning leader and the guide roller

- Pass the cleaning leader through the heater roller.



CAUTION

Be careful not to touch the surface of heater roller because it is very hot.

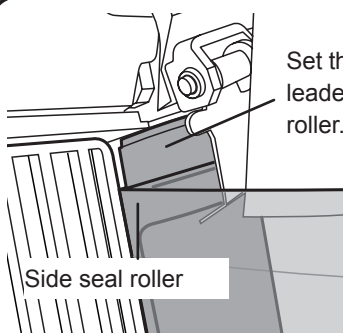

Set the top edge of cleaning leader above the side seal roller.

9. Close the heater roller.

(1) Hold the lever and set the hook.

(2) Close the lever.

