



SL-PM101

Quick Start Guide

Please read this Quick Start Guide carefully and keep it for future use.

Product Overview

Earphone x 2 (left & right)
Charging Case
USB-C Charging Cable
Quick Start Guide and Warranty Letter

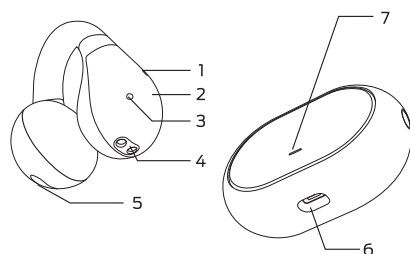

1. LED indicator
2. Multi-function Touch Button (MFB)
3. MIC hole
4. Charging contact
5. Vocal position
6. USB-C charging port
7. Charging indicator light

Wearing

Put the **SL-PM101** onto your ears and rotate to fit comfortably to get the best wearing and sound quality experience.

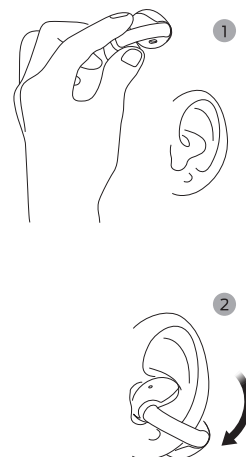

Case Charging

Use the USB-C charging cable provided with the product to charge, and the charging case indicator shows the charging status. When the charging case is fully charged, the charging case indicator lights up.

Power On/Off

Rotate the charging case, take out the earphones, and the earphones will turn on automatically. Put the earphone into the charging case, and the earphone will automatically shut down and charge.

Pairing

Rotate the charging case, take out the earphones, and the earphones turn on automatically. For new device connection, please turn on Bluetooth and search for "**SL-PM101**" to pair, after successful connection, you will hear the system voice prompt.

Volume Control

Turn down the volume: While the music is playing, press the touch multi-function button in your left earphone.
Turn up the volume: While the music is playing, press the touch multi-function button in the right earphone.

Call

Answer/end a call: Double-click MFB (left or right).
Reject an incoming call: When an incoming call comes, press and hold for 2 seconds (left or right).
Cancel a call: If the caller does not answer the call after dialing, double-click to cancel the call.

Music

Play/pause music: Double-click to touch the multi-function button (left or right).
Previous: Connected mobile phone status, left earphone touch 3 times.
Next: Connected phone status, right earphone touch 3 times.

Voice control

When the earphones is connected to the phone, press and hold for 2 seconds to wake up the voice assistant (both the left and right earphones can be operated).

Reset

When the earphone is on, touch both earphones for 5 times at the same time, and then the left and right earphone white lights flash quickly. After clearing the pairing record between the earphone and the phone (without clearing the left and right earphones), enter the device search and pairing mode, and automatically shut down if no new device is connected within 3 minutes

Indicator/Voice Guide

Mode	Description	Voice Prompt
Power On	White light on for 1 second	System tone
Power Off	The red light is on for 2 seconds	System tone
Pairing	White light flashes quickly	-
Connected	White indicator is on for 1 second and off	System tone
Charging Case	Charging Case When charging, the instructions on the charging case The red light blinks slowly, and then blinks long after it is full	-

Note

- * After removing the earphones from the charging case, the left and right earphone will automatically connect without pressing any button. Then they enter pairing mode.
- * Please place the earphones in the correct position for charging.
- * It is not recommended to replace the battery personally without permission.
- * The battery [battery pack or battery combination] shall not be exposed to lighting, baking or similar overheating or undercooling in the environment.

Key Operation

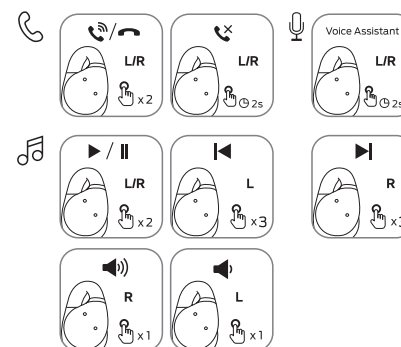

This device complies with part 15 of the FCC Rules. Operation is subject to the following two conditions: (1) this device may not cause harmful interference, and (2) this device must accept any interference received, including interference that may cause undesired operation. Any changes or modifications not expressly approved by the party responsible for compliance could void the user's authority to operate the equipment.

NOTE:
This equipment has been tested and found to comply with the limits for a Class B digital device, pursuant to Part 15 of the FCC Rules. These limits are designed to provide reasonable protection against harmful interference in a residential installation. This equipment generates, uses and can radiate radio frequency energy and, if not installed and used in accordance with the instructions, may cause harmful interference to radio communications. However, there is no guarantee that interference will not occur in a particular installation. If this equipment does cause harmful interference to radio or television reception, which can be determined by turning the equipment off and on, the user is encouraged to try to correct the interference by one or more of the following measures:
-- Reorient or relocate the receiving antenna.
-- Increase the separation between the equipment and receiver.
-- Connect the equipment into an outlet on a circuit different from that to which the receiver is connected.
-- Consult the dealer or an experienced radio/TV technician for help.
The device has been evaluated to meet general RF exposure requirement. The device can be used in portable exposure condition without restriction

