

Your local contact:



© 2011 Phonic Ear A/S



Produced by:

 **Phonic Ear**

Kongebakken 9 • 2765 Smørum • Denmark  
Tel: +45 3917 7101 • Fax: +45 3927 7900  
mail@phonicear.com  
www.phonicear.com

921-36-910-00 Rev. A 0511



User Guide

 **Phonic Ear**  
Connected to life

# Table of contents

## TV adapter

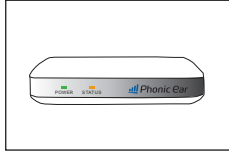

TV adapter  
(TV 75-02)



Power adapter



TV connector set

## Receiver

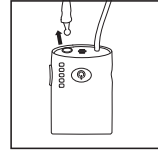

Receiver  
(HIME/HIM)



Power adapter

Congratulations and thank you for purchasing the HearIt Media HIME/HIM package.

HearIt Media is a hands-free, neck-loop solution for amplifying sound from your Bluetooth mobile phone and TV. HearIt Media has been specially designed for people with impaired hearing who want to use a mobile phone hands-free – and without any compromise in sound quality.

Before your HearIt Media can receive sound from the TV, the TV adapter must be connected to the TV and a power outlet. All needed parts for installation are included in the package.

Table of contents	3
<b>Function</b>	4-5
Power and status indicators	5
<b>Mobile and TV general setup and operation</b>	6
Installing the neck loop for mobile and TV	6
Adjusting the volume for mobile and TV	6
<b>Mobile receiver setup and operation</b>	7-8
Mobile wireless setup	7
Accepting an incoming call	7-8
<b>Mobile receiver setup and operation</b>	8-9
Making an outgoing call	8
Rejecting an incoming call	8
<b>TV connection</b>	8-9
TV connection with connector cord	8
TV connection (option 1, option 2)	9
<b>TV setup</b>	10
Establishing connection to your TV, pairing	10
<b>Daily use</b>	11
Sound ON/OFF, Power, TV sound range, etc.	11
Charging	12
<b>Test and approval</b>	13
<b>Warranty</b>	14
<b>Warnings</b>	15
<b>Declaration of conformity</b>	16-17

Function

HearIt Media receiver

- R1: On/off switch, answering button, and Bluetooth indicator
- R2: Volume button +/- (up/down)
- R3: Bluetooth and volume level 1 indicator
- R4: Volume level 2 indicator
- R5: Battery and volume level 3 indicator
- R6: Volume level 4 indicator
- R7: Volume level 5 indicator
- R8: Headphone jack
- R9: Neck loop jack
- R10: Neck loop
- R11: Charging port

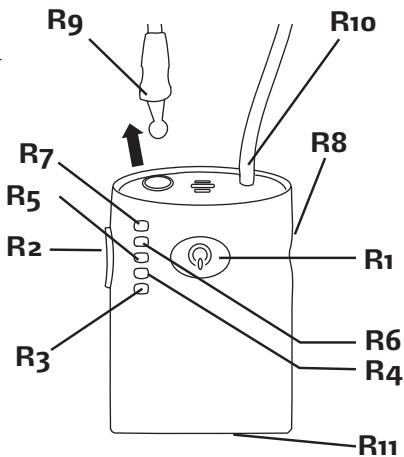

Button/diode/connectors	Functions
R1	<ul style="list-style-type: none"><li>Power on (hold for up to 5 seconds)</li><li>Power off (hold for up to 5 seconds)</li><li>Answering and ending mobile telephone calls</li><li>Mute TV sound temporarily</li><li>Blue light: Bluetooth active</li><li>Blue blink: Incoming call</li><li>White: TV adapter sound is active</li></ul>
R2+ (up)	<ul style="list-style-type: none"><li>Volume up</li></ul>
R2- (down)	<ul style="list-style-type: none"><li>Volume down (when mobile phone is ringing): Reject mobile telephone call (hold for 2 seconds)</li><li>Volume down: Deletes previous pairings (hold for 10 seconds)</li></ul>
R3	<ul style="list-style-type: none"><li>Blue blink: Bluetooth not connected</li><li>Green light: Volume level 1</li></ul>
R4	<ul style="list-style-type: none"><li>Green light: Volume level 2</li></ul>
R5	<p><b>When in use</b></p> <p>Red blink: Low battery</p> <p>Green light: Volume level 3</p> <p><b>When charging</b></p> <p>Red light: Charging</p> <p>Green light: Fully charged</p>
R6	<ul style="list-style-type: none"><li>Green light: Volume level 4</li></ul>
R7	<ul style="list-style-type: none"><li>Green light: Volume level 5</li></ul>
R8	<ul style="list-style-type: none"><li>Headphone jack</li></ul>
R9	<ul style="list-style-type: none"><li>Neck loop jack</li></ul>
R10	<ul style="list-style-type: none"><li>Neck loop</li></ul>
R11	<ul style="list-style-type: none"><li>Charging port</li></ul>

Function

HearIt Media TV adapter

- A1: Power indicator
- A2: Status indicator
- A: Power connection
- B: TV connection
- C: Microhone connection (optional accessory required)

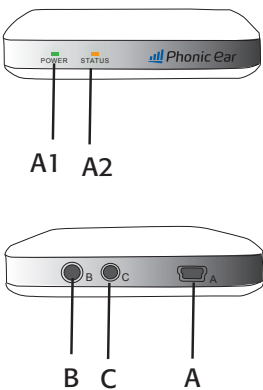

Power and status indicators

Overview of the light indicators on the HearIt Media TV adapter

- POWER indicator A1
  - Solid green: Power on
  - Off (no light): Power off
- STATUS indicator A2
  - Solid orange: Connected to TV - streaming TV sound
  - Off (no light): Stand-by
  - Flashing: Pairing

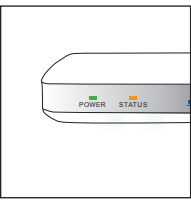

Overview of the light indicators on the HearIt Media receiver

- Flashing blue (R1): Incoming call
- Blue (R1): Wireless Bluetooth call activated
- Flashing blue (R3): No Bluetooth connection
- Green (R3-R7): Volume level
- Flashing red (R5): Battery low
- White (R1): TV adapter sound is active

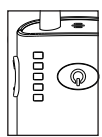

## Mobile and TV general setup and operation

### Installing the neck loop for mobile and TV



In order to use HearIt Media with hearing aids in T-position (telecoil), the hearing aid must be equipped with a telecoil fitted by the hearing care professional.

1. Detach the neck loop **R10** on the HearIt Media receiver from receiver jack **R9** by pulling the loop wire.
2. Place the HearIt Media receiver on the chest and place the loop wire around the neck.
3. Reattach the neck loop **R10** to the receiver jack **R9**.
4. Switch the hearing aid to the T (telecoil only) or MT (microphone and telecoil simultaneously) position.

#### Please note:

Connecting headphones to the headphone jack **R8** disconnects the signal to the neck loop.

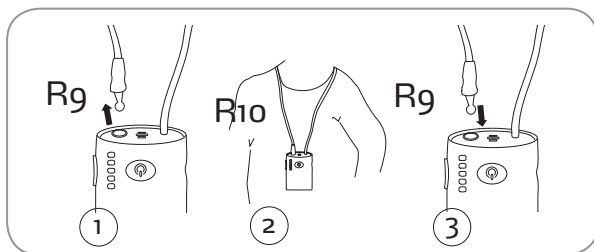

### Adjusting the volume for mobile and TV



1. Press the receiver button **R2+** (volume up) or **R2-** (volume down) to a set comfortable listening level.
2. The receiver indicators **R3** to **R7** illuminate depending on the volume level.

#### Please note:

The maximum volume level has been reached if all five indicators **R3** to **R7** are illuminated. If the signal is still too weak, adjust the volume on your mobile phone or TV. If the sound still is too weak, contact your hearing care professional for adjustment of the telecoil sensitivity in the hearing aid.

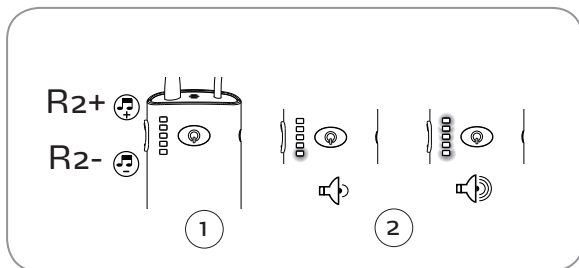

When you have turned off the HearIt Media receiver it will automatically remember the last volume setting for respectively television and mobile phone when you turn it back on again.

## Mobile receiver setup and operation

### Mobile setup



#### Mobile wireless setup

1. Press the **R1** button on the HearIt Media receiver for 5 seconds until the lights come on.
2. Enter the menu on your mobile phone to search for available Bluetooth devices.
3. Select the Bluetooth entry "**S HearIt Media**".
4. Enter the pass code into the mobile telephone (0000). Select connect. A short beep will be heard in the hearing aid or in the headphones.
5. Once the wireless connection is established, the HearIt Media receiver indicator **R3** stops blinking blue.

Once a wireless connection between HearIt Media and a Bluetooth unit has been established, the units will automatically connect when they are within range of each other.

#### Please note:

You can't connect your mobile phone to HearIt Media while watching TV with HearIt Media. Press the **R1** button on the HearIt Media receiver to turn off the TV sound. Now connect your mobile phone to HearIt Media. You can now turn on the TV sound again by pressing the **R1** button.

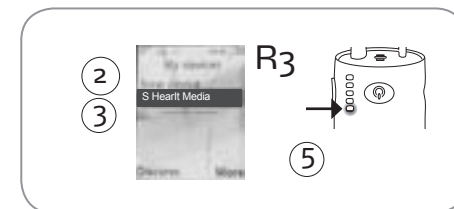

When you press the **R1** button and turn on the HearIt Media receiver, it goes into connection mode for the next 5 minutes. If you haven't setup the wireless connection within 5 minutes, you have to turn off and turn on the receiver again.

### Mobile operation



#### Accepting an incoming call

1. When a call comes in, a ringing tone will be heard in the hearing aid or headphones and the HearIt Media receiver indicator **R1** starts blinking blue.
2. Press the HearIt Media receiver button **R1** to accept the call.
3. Press the HearIt Media receiver button **R1** to end the call.

#### Please note:

Only make a single short push to accept or end a call. It may take a couple of seconds before a call is completely

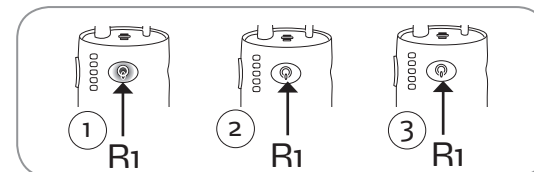

## Mobile receiver setup and operation

connected or disconnected. If the HearIt Media receiver is turned off when a mobile phone call comes in, that specific call cannot be answered or ended using HearIt Media.

### Making an outgoing call

1. Press the **R1** button on the HearIt Media receiver for 5 seconds until the lights come on.
2. Enter the dial number on the mobile phone and pick up the handset.
3. The call is automatically transferred to the HearIt Media receiver.
4. To end the call, press the button **R1** on the HearIt Media receiver or end the call on the mobile phone.

During telephone conversations, the HearIt Media receiver indicator will illuminate blue.

### Rejecting an incoming call

1. When a call comes in, a ringing tone will be heard in the hearing aid or headphones, and the receiver indicator **R1** starts blinking blue.
2. Press the receiver button **R2-** (volume down) for 2 seconds to reject the call.

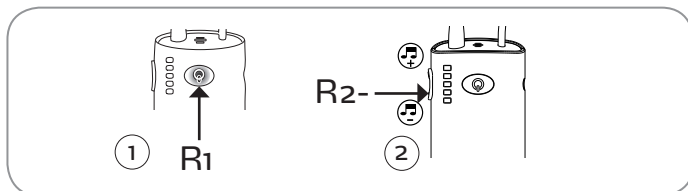

## TV connection



### With connector cord

Connect the black plug on the TV cord to the TV adapter.

Connect the red and white connectors to the "AUDIO OUT" terminals on the TV (typically marked "L - R" "AUDIO OUT" and found on the back of the TV or bottom panel).

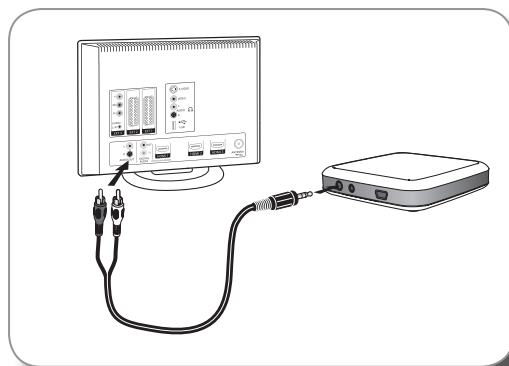

## TV setup and operation

### Please note:

If the TV has no "L - R" RCA Phono "OUTPUT", an adapter should be used for connecting the TV cord. Then proceed to "optional adapters".

### With optional adapters

#### Option 1 - SCART

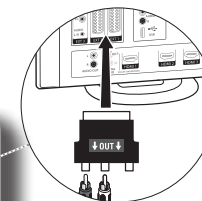
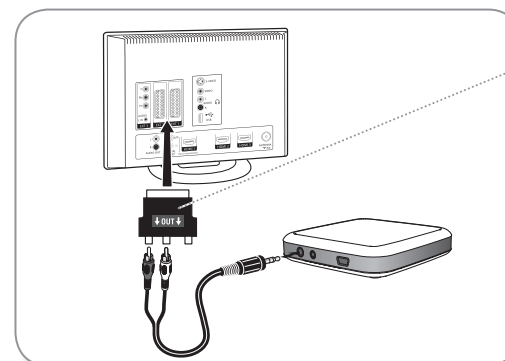

Connect the audio cord to the red and white terminals on the SCART adapter and plug it into the TV's SCART connection. If you already have used the SCART connection for a DVD or a satellite box, you should use option 2 instead.

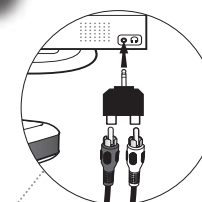

#### Option 2 - Headphone connection

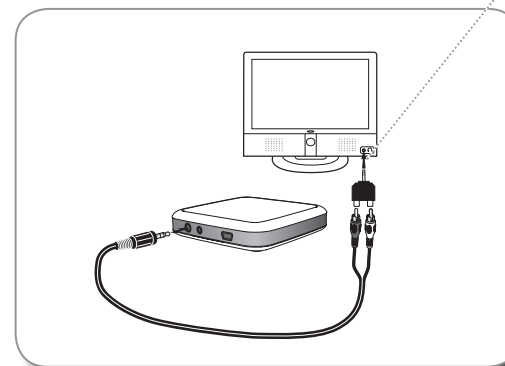

Connect the TV cord to the jack adapter and plug it into the TV's headphone output. The headphone output may be found on the side or front of the TV.

### Please note:

The sound from the TV speaker may turn off while the jack adapter is plugged in. To prevent the sound to be turned off, a SCART switch box can be connected (not included in the package, order nr. 890-60-033-00).

## TV setup

### Establishing a connection to your TV, pairing

The very first time your HearIt Media receiver is used with the HearIt media TV adapter, the two devices must be paired together.



#### Pairing

1. Press the **R1** button on the HearIt Media receiver for 5 seconds until the lights come on.
2. Place the HearIt Media receiver right next to the HearIt Media TV adapter (less than 30 cm / 1 ft. between the devices).
3. Connect the HearIt Media TV adapter to a mains wall outlet and turn the power on.
4. The two devices are now establishing a connection with each other. Wait one minute.
5. After one minute, the HearIt Media TV adapter connects to the HearIt Media receiver and the pairing is complete. The STATUS indicator on the HearIt Media TV adapter will show a solid orange light.

Pairing should be completed only once and will normally not have to be repeated. By pressing the receiver button **R1** once, you can turn the sound on and off.

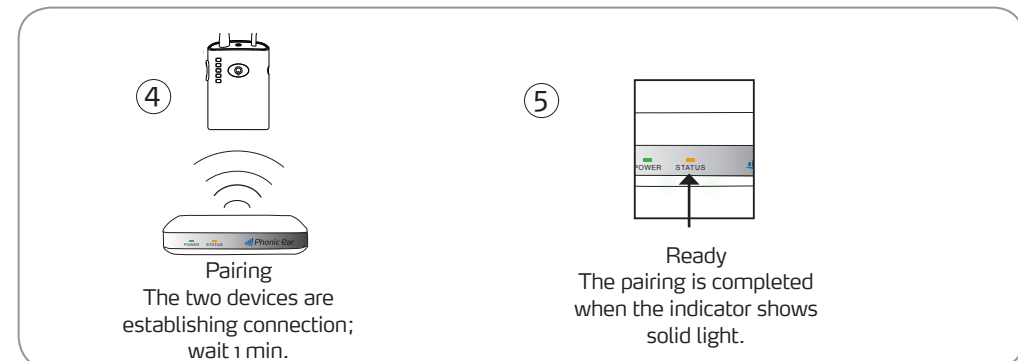
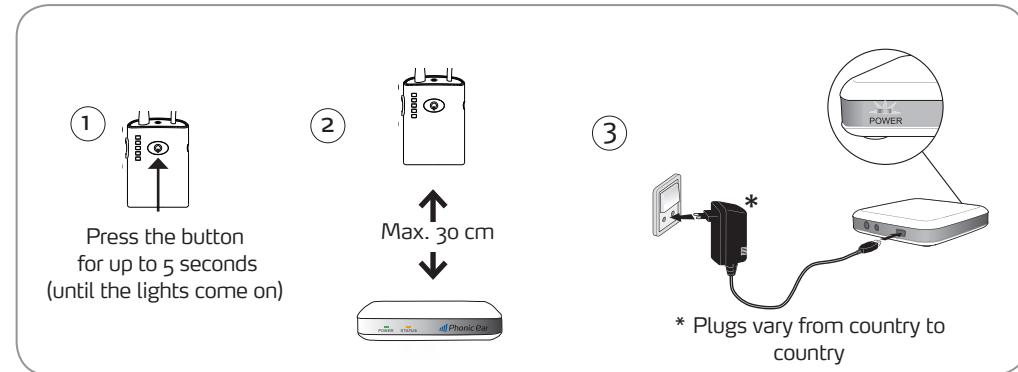

## Daily use

### Sound ON/OFF

Press the **R1** button on the HearIt Media receiver once, to turn the sound on and off.

### Power

The TV adapter uses very little power so it is not necessary to turn it off.

### TV sound range

The TV adapter has a range of about 10 meters / 30 feet, depending on room furniture and placement.

If you lose the wireless connection to your mobile phone while watching television, you need to turn off the wireless connection to your TV to reestablish the wireless connection to your mobile.

### Connection with SCART adapter

If you connect the TV adapter with the SCART adapter you will only hear audio from the TV tuner with the TV adapter. Audio from other sources such as DVD or VCR will not be played. This is a limitation of the SCART connector. It is possible to connect other sources by using a SCART switch box (not included in the package, order nr. 890-60-033-00).

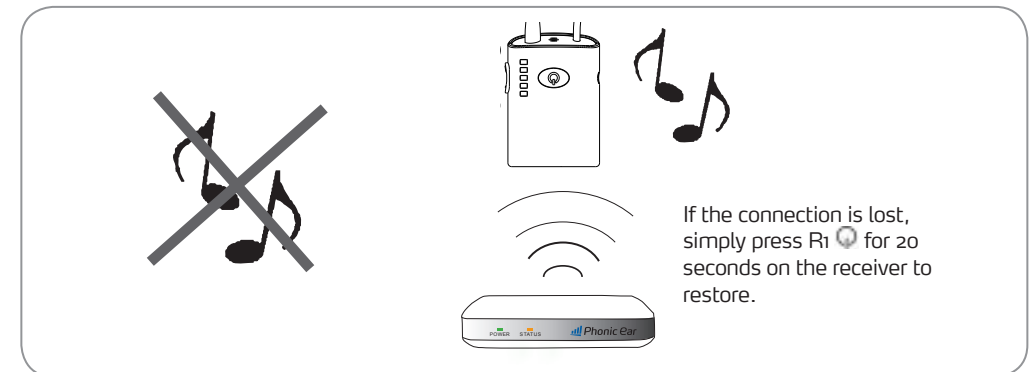



# Charging

## Charging

If the receiver light indicator **R5** flashes red during operation, or if the unit cannot be turned on, the receiver requires recharging.

1. Connect the power supply wire to Hearlt Media's jack **R11**.
2. Connect the power supply to a power outlet and turn on the mains power.
3. The light indicator **R5** lights continuously red during recharging.
4. When the Hearlt Media receiver is fully recharged, the light indicator **R5** lights green continuously.

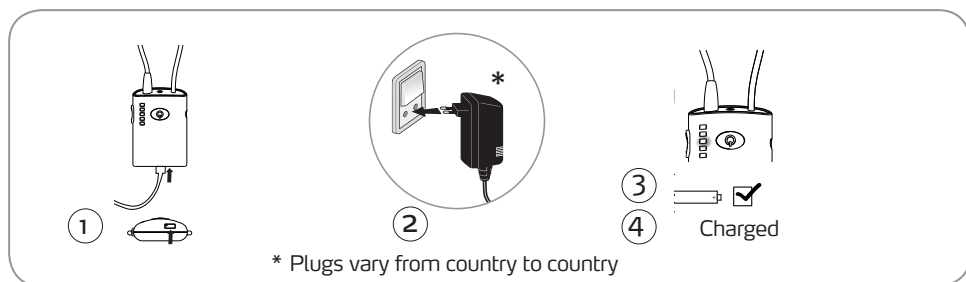

### Please note:

We recommend fully charging batteries before use; however, partly charging the units does not inflict damage to it.

Battery life (in use) until the Hearlt Media receiver has to be recharged is up to 40 hours. Standby time is approx. 12 days.

Recharging time is approx. 5 hours.

The Hearlt Media receiver can be used while charging. Just turn it on after connecting the power supply wire to the receiver jack R11 and it's ready for use.

# Test and approval

Phonic Ear A/S, Kongebakken 9, 2765 Smørum, Denmark

Hearlt Media HIME/HIM

TV adapter TV 75-02



CE 2150

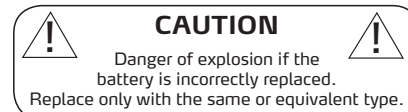

Electrical and electronic equipment (EEE) contains materials, components and substances that could be dangerous or detrimental to human health and the environment if waste electrical and electronic equipment (WEEE) is not disposed of correctly.

Products marked with the crossed-out dustbin shown above are electrical and electronic equipment. The crossed-out rubbish bin indicates that waste electrical and electronic equipment may not be disposed of with unsorted household waste and that it must be collected separately.

In developing and manufacturing your Phonic Ear product, we used high-quality materials and components that can be reused. Thus, when disposing of your waste electrical and electronic equipment, you must use a collection system designated for this purpose, regardless of whether you dispose of your waste at your local civic amenity site or whether your waste is collected from your household. Please contact your local authority for further information.

Batteries contain substances that can be harmful to human health and the environment if not handled correctly.

Batteries are marked with the crossed-out rubbish bin symbol illustrated. This symbolises that exhausted batteries must not be disposed of together with unsorted household rubbish, but are to be collected separately.

Some batteries are also marked with the chemical symbol Hg (mercury), Cd (cadmium) or Pb (lead). These substances are particularly harmful, so it is important that they are collected and disposed of via an established recycling scheme. This ensures that your batteries are reused in compliance with regulations and do not damage the environment. Therefore, when disposing of exhausted batteries, make sure that you utilise an established recycling scheme. This might involve delivering them to a designated collection point or recycling centre, or they may be collected directly from your address. For further details, please contact your local authorities.

### How to remove batteries from the receiver (the portable unit)

1. Unscrew two screws in the top corners on the rear of unit
2. Open top cover by lifting cover up in the top
3. Remove top cover completely
4. Cut battery away from the printed circuit board
5. Cut wires one at a time

The socket outlet must be installed near to the equipment and must be easily accessible. Only use power supplies listed in the user guide.

Use the following switch mode power supply with your Hearlt Media.

Fuhua, Model No.: UE08WCP-060100SPA, Input: 100-240V AC 400mA 50/60Hz, Output: 6V DC 1.0A.

Use the following switch mode power supply with your TV adapter:

Fuhua, Model No.: UE10W-050020SPC, Input: 100-240V AC 150mA 50-60Hz, Output: 5V DC 200mA/  
Model No. UE08WCP-050100SPA, Input: 100-240V AC 400mA 50-60Hz, Output: 5V DC 1.0A.

# Warranty

A two-year limited warranty is issued to the original consumer of this product by Phonic Ear A/S.

### Time period of warranty

This warranty will come into effect upon the date of the original purchase of this equipment, and will remain in effect for two calendar years from that date as long as the instrument remains the property of the original consumer.

### What is covered by this warranty

Any electronic component which, because of workmanship, manufacturing, or design defects, fails to function properly under normal use during the lifetime of this warranty will be replaced or repaired at no charge for parts or labour when returned to the factory service centre. Transportation costs are to be met by the customer. If it is determined that repair is not feasible, the entire unit may be replaced with an equivalent unit upon mutual agreement of the manufacturer and customer.

### What is not covered by this warranty:

1. Malfunctions resulting from abuse, neglect or accident.
2. Peripheral accessories as itemised within the product brochure, when such items are returned after 90 days from the original purchase.
3. Batteries.
4. Instruments connected, installed, used or adjusted in a manner contrary to instructions provided by the manufacturer.
5. Consequential damages and damages resulting from delay or loss of this instrument. The exclusive remedy under this warranty is strictly limited to repair or replacement as herein provided.
6. Products damaged in transit unless investigated by the shipper and returned to the warrantor with the investigation report.

Phonic Ear A/S reserves the right to make changes to the design or construction of any of its instruments at any time without incurring any obligation to make any changes whatsoever on units previously purchased. This warranty is in lieu of all other expressed warranties. All expressed and implied warranties will terminate upon the expiration of this written warranty. No representative or person is authorised to represent or assume for us any liability in connection with the sale or use of our products other than as set forth above. The above warranty does not affect any legal rights that you might have under applicable national legislation governing the sale of consumer goods. Your distributor may have issued a warranty that goes beyond the clauses of this limited warranty. Please consult your distributor for further information.

### What to do if you need service

If you require service under the terms of this warranty, carefully package the instrument to prevent damage and return it to your distributor (see information on back cover). Please provide your receipt, a detailed description of the problem, your full name, billing address and telephone number.

# Warnings

The TV adapter and the HearIt Media are not a toy and therefore should be kept out of the reach of children and anyone else who might swallow parts or otherwise cause injury to themselves. Special attention should be paid to the smaller components in order to prevent children from swallowing them and choking. If a part is swallowed, see a doctor immediately. The safety of the use of the units with an auxiliary input cable is determined by an external signal source. When the input cable is connected to mains operated equipment, this equipment must comply with IEC-60065, IEC-60601 or equivalent safety standards. The units are designed to comply with the most stringent Standards of International Electromagnetic Compatibility. However, the units might cause interference with other medical devices. Please contact relevant personnel to obtain a permission before using the units in hospitals or similar venues.

The TV adapter and the HearIt Media may never be washed or immersed in water or other liquids.

### FCC & IC RF Exposure info

This equipment complies with FCC radiation exposure limits set forth for an uncontrolled environment. End user must follow the specific operating instructions for satisfying RF exposure compliance. This transmitter must not be co-located or operating in conjunction with any other antenna or transmitter.

Cet appareil est conforme aux limites d'exposition au rayonnement RF stipulées par la FCC et l'IC pour une utilisation dans un environnement non contrôlé. L'utilisateur final doit suivre les instructions de fonctionnement spécifiques pour le respect d'exposition aux RF. Les émetteurs ne doivent pas être placés près d'autres antennes ou émetteurs ou fonctionner avec ceux-ci.

**Caution:** Changes or modifications not expressly approved by Phonic Ear could void the user's authority to operate the equipment.

This device complies with Industry Canada licence-exempt RSS standard(s) and Part 15 of the FCC Rules. Operation is subject to the following two conditions:

- (1) This device may not cause harmful interference, and
- (2) This device must accept any interference received, including interference that may cause undesired operation.

Le présent appareil est conforme aux CNR d'Industrie Canada applicables aux appareils radio exempts de licence et la partie 15 des Règles FCC. L'exploitation est autorisée aux deux conditions suivantes :

- (1) l'appareil ne doit pas produire de brouillage, et
- (2) l'utilisateur de l'appareil doit accepter tout brouillage radioélectrique subi, même si le brouillage est susceptible d'en compromettre le fonctionnement.

### Note:

This equipment has been tested and found to comply with the limits for a Class B digital device, pursuant to part 15 of the FCC Rules. These limits are designed to provide reasonable protection against harmful interference in a residential installation. This equipment generates, uses and can



radiate radio frequency energy and, if not installed and used in accordance with **the instructions**, may cause harmful interference to radio communications. However, there is no guarantee that interference will not occur in a particular installation. If this equipment does cause harmful interference to radio or television reception, which can be determined by turning the equipment off and on, the user is encouraged to try to correct the interference by one or more of the following measures:

- Reorient or relocate the receiving antenna.
- Increase the separation between the equipment and receiver.
- Connect the equipment into an outlet on a circuit different from that to which the receiver is connected.
- Consult the dealer or an experienced radio/TV technician for help.

This Class B digital apparatus complies with Canadian ICES-003.

Cet appareil numérique de la classe B est conforme à la norme NMB-003 du Canada.

## Declaration of conformity

We

**Phonic Ear A/S**  
**Kongebakken 9**  
**DK-2765 Smørum**  
**Denmark**

declare under our own responsibility that the product

**TV adapter, TV 75-02**

to which this declaration refers conforms with the relevant standards or other standardising documents

**EN 300 328 v. 1.7.1:2006-10**

Electromagnetic compatibility and Radio spectrum Matters (ERM); Wideband transmission systems; Data transmission equipment operating in the 2.4 GHz ISM band and using wide band modulation techniques; Harmonized EN covering essential requirements under article 3.2 of the R&TTE Directive

**EN 301 489-1 v. 1.8.1:2008**

Electromagnetic compatibility and Radio spectrum Matters (ERM); ElectroMagnetic Compatibility (EMC) standard for radio equipment and services; Part 1: Common technical requirements

**EN 301 489-17 v. 2.1.1:2009-05**

Electromagnetic compatibility and Radio spectrum Matters (ERM); ElectroMagnetic Compatibility (EMC) standard for radio equipment; Part 17: Specific conditions for 2.4 GHz wideband transmission systems

**EN 60950-1:2006 (ed2) + A11**

Information technology equipment - Safety - Part 1: General requirements

**EN 50371:2002**

Generic standard to demonstrate the compliance of low power electronic and electrical apparatus with the basic restrictions related to human exposure to electromagnetic fields (10 MHz - 300 GHz). General public

According the regulations in

**Radio Equipment and Telecommunications Terminal Equipment (R&TTE) Directive**  
**1999/5/EC**

Smørum the 23<sup>rd</sup> of May 2011

  
**Karen Wibling Solgård, General Manager**

**Phonic Ear A/S**

Kongebakken 9, 2765 Smørum, Denmark  
 tel: +45 3817 7101  
 fax: +45 3827 7900

tel: +45 3817 7101  
 fax: +45 3827 7900

e-mail: [info@phonicear.dk](mailto:info@phonicear.dk)  
 web: [www.phonicear.dk](http://www.phonicear.dk)

## Declaration of conformity

We

**Phonic Ear A/S**  
Kongebakken 9  
DK-2765 Smørum  
Denmark

declare under our own responsibility that the product

**HearIt Media**

to which this declaration refers conforms with the relevant standards or other standardising documents

**EN 300 328 v. 1.7.1:2006-10**

Electromagnetic compatibility and Radio spectrum Matters (ERM); Wideband transmission systems; Data transmission equipment operating in the 2.4 GHz ISM band and using wide band modulation techniques; Harmonized EN covering essential requirements under article 3.2 of the R&TTE Directive

**EN 301 489-1 v. 1.8.1:2008**

Electromagnetic compatibility and Radio spectrum Matters (ERM); ElectroMagnetic Compatibility (EMC) standard for radio equipment and services; Part 1: Common technical requirements

**EN 301 489-17 v. 2.1.1 (2009-05)**

Electromagnetic compatibility and Radio spectrum Matters (ERM); ElectroMagnetic Compatibility (EMC) standard for radio equipment; Part 17: Specific conditions for 2.4 GHz wideband transmission systems

**EN 60950-1:2006 (ed2) + A11**

Information technology equipment - Safety - Part 1: General requirements

**EN 50371:2002**

Generic standard to demonstrate the compliance of low power electronic and electrical apparatus with the basic restrictions related to human exposure to electromagnetic fields (10 MHz - 300 GHz). General public

According to the regulations in

**Radio Equipment and Telecommunications Terminal Equipment (R&TTE) Directive  
1999/5/EC**

Smørum the 19<sup>th</sup> of May 2011

  
Karen Wibling Solgård, General Manager