

Pick Buster User Manual

© 2008 All Right Reserved

Packing description

This product contains:

- * Key ring master x 1
- * Card slave x 1
- * Battery LR44 x 3 (inside of master)
- * Battery CR2016 x 2 (inside of card slave)
- * Protection insert for card slave x 2
- * User Manual x 1

The battery installment and the key description

(1) Master battery installment, as shown in the illustration.

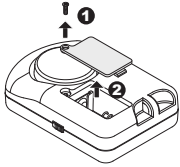

1. Remove the screw in back of master battery cover, and take out battery cover.

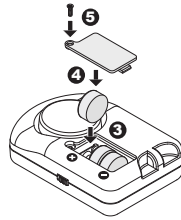

2. Make sure the battery's positive (+) and negative (-) ends are facing correctly when load it into the unit as shown in direction (total three batteries), and put battery cover back, then screw tighten it.

(2) Slave battery installment, as shown in the illustration. (Two protection inserts attached for your future replacement)

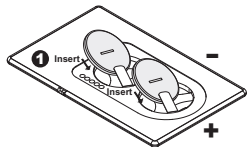

1. Make sure the battery's positive (+) and negative (-) ends are facing correctly when load it into the unit as shown in direction (total three batteries).

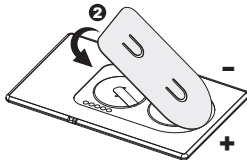

2. Stick the protection insert.

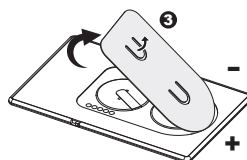

3. When replace new battery, please pull U-type tab and remove protection insert and the old battery, then follow the step 1 and 2 for replacement.

(3) Key description for master and slave, as shown in the illustration.

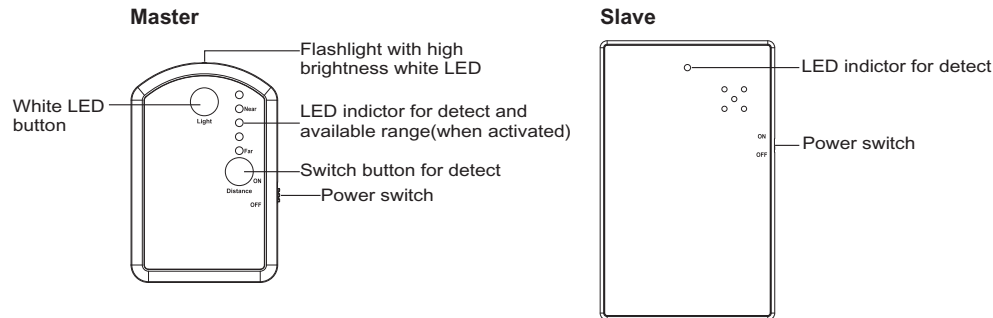

Specifications

Master specification: Key ring type

Size : 63 x 42 x 17.3 (mm)
Frequency : 2.4GHz ISM
Battery : 303/AG13/LR44 x 3pcs
Button (1) : Power switch
Button (2) : Range detect switch
Button (3) : LED flashlight switch
LED : 5 LEDs status indicator (when activated)
LED Light : 1 white LED flashlight

Slave specification: Slim card type

Size : 80 x 50 x 2.4 (mm)
Frequency : 2.4GHz ISM
Battery : CR2016 x 2pcs
Button : Power switch
LED : 1 LED status indicator (when activated)

Operating instructions

- (1) In the first time use, Please take out the plastic piece for electronic isolation on the battery slot of master and slave. (one piece on master, two pieces on slave)
- (2) Turn to power "ON" position for master and slave devices at the same time (in around 3 seconds), after master makes "Beep" sound, and slave device will start to flash LED light synchronal, then the device will be into the stand-by mode and ready to use.
- (3) Please put the slave and the master separately, and not separate both of them too far. For example, the slave can be put in the wallet or handbag, the master can be put in your pocket, or hang in the handbag strap, or attach to the leather belt. Because static electricity will be occurred by human body, if any happen and cause master device beep sounds randomly, please try to relocate the master position. (Please refer to Handling Precautions 2, and 3)
- (4) If the wallet with card slave attached was stolen and left around 3 to 8m, the master will beep high-frequency warning sounds (95dB/30cm approximately, battery is in full charged condition), and into the warning mode. As shown in the illustration. (Please refer to Handling Precautions 2)
- (5) To long press on "Distance" key of master device, if master flashes the range detect LED (with 5 lights), under 15 to 20m, 5 LEDs light may show how far the distance between master and slave. (Please refer to light signal and beep sound description) (Please refer to Handling Precautions 3)
- (6) In distance detect mode, if master flashes the range detect LED under 15~20m, the user may use master to survey 360° direction. If ranges detect LED increase lights in somewhere, then slave device possibly are located the position. As shown in the illustration.

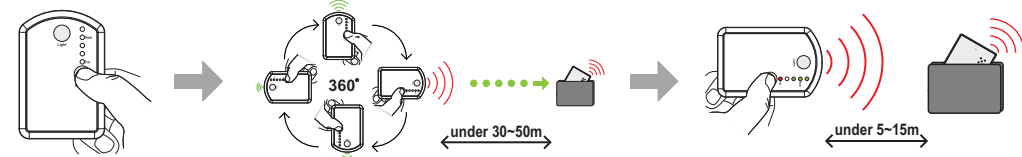

- (7) In warning mode or distance detect mode, be ware that when slave device is over 30 to 50m from master device, the detect action will be failed when over the limitation of detect distance. If slave device is back 30 to 50m, detect function will be able to search and return to alarm mode or distance detect mode. (Please refer to Handling Precautions 3)
- (8) To long press on "Light" key of master device, may enter the flashlight mode.
- (9) If static electricity is occurred by human body or irregular work by any artificial influence, please turn off and turn on again (reset) for both master and slave devices.

The light signal and beep sound description

●:The circle symbol indicates light shine ○:The semicircle symbol indicates light flash

	Master light signal and beep sound	Slave light signal and beep sound
Stand-by mode(1)	Turn on both master and slave devices, they will start to flash LED light synchronal Near Far	
Stand-by mode(2)	Turn on both master and slave devices, they will start to flash LED light synchronal	
Alarm mode	Slave is over 3 to 8m between master, start to beep sounds by alarm mode	
No signal mode	In warning mode or distance detect mode, slave device is over 30 to 50m from master device and detect fail	
Distance detect mode	To long press on "Distance" key of master device, and show how far the distance between master and slave by LED indicator and beep sounds Under 30 to 50m with signal appear, but searchable range is over 15 to 20m Under 30 to 50m with signal appear, and searchable range is under 15 to 20m, but range is long Under 30 to 50m with signal appear, and searchable range is under 15 to 20m, and range is long Under 30 to 50m with signal appear, and searchable range is under 15 to 20m, and range is close Under 30 to 50m with signal appear, and searchable range is under 5 to 15m, and range is close with side Under 30 to 50m with signal appear, and searchable range is under 3 to 10m, can hear the beep sounds of slave, carefully	
Low battery power mode (Master)	Battery power is lower than standard working power (Master)	
Low battery power mode (Slave)	Battery power is lower than standard working power (Slave)	
No battery power mode (Master)	No battery power for operation (Master)	
No battery power mode (Slave)	No battery power for operation (Slave)	
Others	Any irregular work by artificial influence, devices folded or distortion, please turn off and turn on (reset) for both master and slave devices	

Suggested Using Method

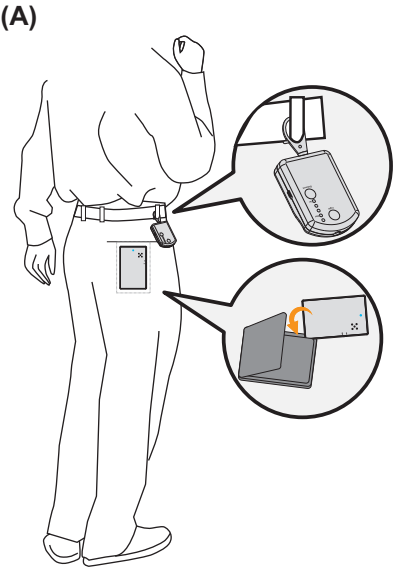

Figure A
Master device can be attached to the leather belt, and slave device can be put in the wallet, then put in your pocket.

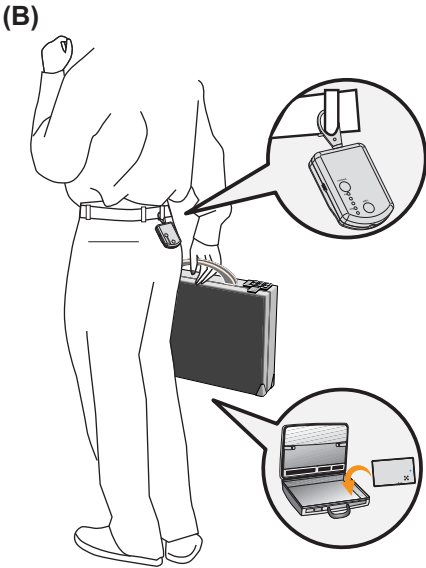

Figure B
Master device can be attached to the leather belt, and slave device can be put in the handbag or suitcase.

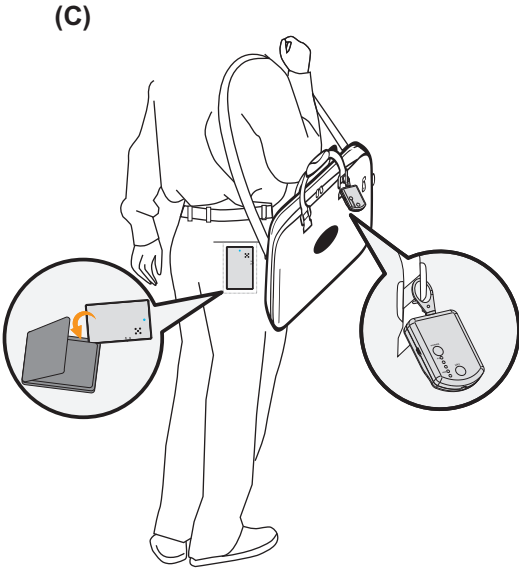

Figure C
Master device can be handed in the handbag strap, and slave device can be put in the wallet, then put in your pocket.

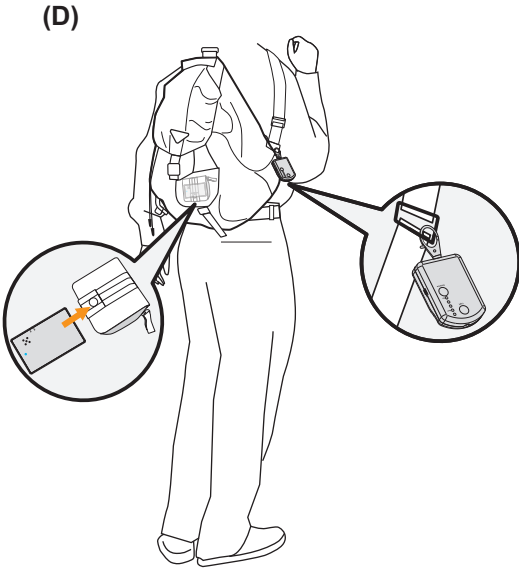

Figure D
Master device can be handed in backpack strap, and slave device can be put in the wallet, then put in your backpack.

Handling Precautions

- (1) Except for battery replacement for slave device, please do not paste protection insert in other place. It may cause protection insert to lose stickiness, and bad connection with devices.
- (2) Because static electricity will be occurred by human body, if any happen and cause master device beep sounds randomly, please try to relocate the master position. Both of master and slave devices can be put very closely as master in your right pocket, and slave in your right side wallet or handbag.
- (3) The product has to put both of master and slave devices separately. Please do not put both of them in the same handbag to avoid devices unable to send out warning beep sounds when stolen.
- (4) The warning ranges, the searchable detect distance and the farthest receiving distance, may cause unstable radio wave efficiency according to the terrain environment.
- (5) if the beep sounds are not loud enough, it means the battery power is declined. New battery can provide the louder alarm sound.
- (6) The product of card type slave is sophisticated equipment, please keep away from high temperature, heat sources, and do not fold, damage, and modify. If any damage by user's operation, please contact with your dealer for buying a new one.
- (7) The product only assists to provide the warning alarm to remind the user, does not guarantee to prevent steal and rob by person's behavior. The product does not connect with police department, please contact with police department to protect personal safety and property if any urgent need. The product will not guarantee any damage of personal safety, property, material or the information loss, or other related loss by using the product.
- (8) By flight safety law, please turn off the power of master and slave devices when take flight.
- (9) We reserve the right to change the change the specifications of the hardware and software described in these manuals at any time and without prior notice. Information in this document is subject to change without notice.

Recycle: The Battery provided in this product should be recycled to protect the local environment. Please contact with local recycle department for detail.

Warning: Do not put the battery into the fire or heat source, it will be dangerous and maybe an explosion.

FCC Certifications

Federal Communication Commission Interference Statement

This equipment has been tested and found to comply with the limits for a Class B digital device, pursuant to Part 15 of the FCC Rules. These limits are designed to provide reasonable protection against harmful interference in a residential installation. This equipment generates, uses and can radiate radio frequency energy and, if not installed and used in accordance with the instructions, may cause harmful interference to radio communications. However, there is no guarantee that interference will not occur in a particular installation. If this equipment does cause harmful interference to radio or television reception, which can be determined by turning the equipment off and on, the user is encouraged to try to correct the interference by one of the following measures:

- Reorient or relocate the receiving antenna.
- Increase the separation between the equipment and receiver.
- Connect the equipment into an outlet on a circuit different from that to which the receiver is connected.
- Consult the dealer or an experienced radio/TV technician for help.

This device complies with Part 15 of the FCC Rules. Operation is subject to the following two conditions: (1) This device may not cause harmful interference, and (2) this device must accept an interference received, including interference that may cause undesired operation.

FCC Caution: Any changes or modifications not expressly approved by the party responsible for compliance could void the user's authority to operate this equipment.

EU Declaration Conformity

This product is carrying the CE-Mark in accordance with the related European Directives.

