

LimeBook

User Manual



LimeBook

LimeBook

User Manual

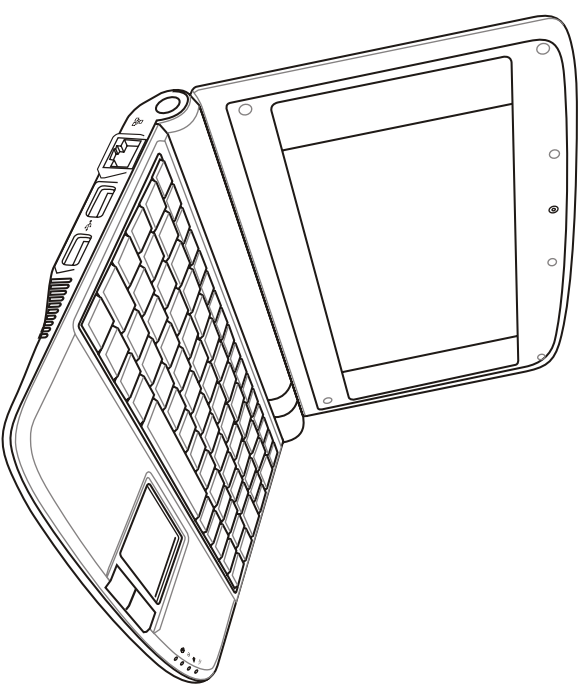

Table of Contents

Chapter 1: Introducing the LimeBook

About This User's Manual	05
Notes for This Manual	06
Safety Precautions	07
Transportation Precautions	08
Charging Your Batteries	08
Airplane Precautions	08
Preparing your LimeBook	09

Chapter 2: Knowing the Parts

Top Side	12
Bottom Side	14
Right Side	16
Left Side	17
Rear Side	18

Chapter 3: Getting Started

Power System	20
Using AC Power	20
Using Battery Power	21
Touchpad Usage	23
Starting use LimeBook	25



About This User's Manual

Notes for This Manual

Safety Precautions

Preparing Your LimeBook

About This User's Manual

You are reading the LimeBook User's Manual. This User's Manual provides information regarding the various components in the LimeBook and how to use them. The following are major sections of this User's Manual:

1. Introducing the LimeBook
Introduces the LimeBook and this User's Manual.
2. Knowing the Parts Provides information on the LimeBook's components.
3. Getting Started
Provides information on getting started with the LimeBook.
4. Using the LimeBook
Provides information on using the LimeBook's utilities.
5. Appendix
Provides you QVL and gives safety statements.

Introducing the LimeBook

Notes for This Manual

A few notes and warnings are used throughout this guide, allowing you to complete certain tasks safely and effectively. These notes have different degrees of importance as follows:



WARNING! Important information that must be followed for safe operation.



IMPORTANT! Vital information that must be followed to prevent damage to data, components, or persons.



TIP: Tips for completing tasks.



NOTE: Information for special situations.

Safety Precautions

The following safety precautions will increase the life of the LimeBook. Follow all precautions and instructions. Except as described in this manual, refer all servicing to qualified personnel. Do not use damaged power cords, accessories, or other peripherals. Do not use strong solvents such as thinners, benzene, or other chemicals on or near the surface.



Disconnect the AC power and remove the battery pack(s) before cleaning. Wipe the LimeBook using a clean cellulose sponge or chamois cloth dampened with a solution of nonabrasive detergent and a few drops of warm water and remove any extra moisture with a dry cloth.



DO NOT place on uneven or unstable work surfaces. Seek servicing if the casing has been damaged.



DO NOT expose to dirty or dusty environments. DO NOT operate during a gas leak.



DO NOT press or touch the display panel. Do not place together with small items that may scratch or enter the LimeBook.



DO NOT leave the LimeBook on your lap or any part of the body to prevent discomfort or injury from heat exposure.



SAFE TEMP: This LimeBook should only be used in environments with ambient temperatures between 5° C (41° F) and 35° C (95° F)



DO NOT throw the LimeBook in municipal waste. Check local regulations for disposal of electronic products.



DO NOT place or drop objects on top and do not shove any foreign objects into the LimeBook.



DO NOT expose to strong magnetic or electrical fields.



DO NOT expose to or use near liquids, rain, or moisture. DO NOT use the modem during electrical storms.



Battery safety warning: DO NOT throw the battery in fire. DO NOT short circuit the contacts. DO NOT disassemble the battery.



INPUT RATING: Refer to the rating label on the bottom of the LimeBook and be sure that your power adapter complies with the rating.



DO NOT carry or cover a LimeBook that is powered ON with any materials that will reduce air circulation such as a carrying bag.

Transportation Precautions

To prepare the LimeBook for transport, you should turn it OFF and disconnect all external peripherals to prevent damage to the connectors. Close the display panel and check that it is latched securely in the closed position to protect the keyboard and display panel.



The LimeBook's surface is easily dulled if not properly cared for. Be careful not to rub or scrape surfaces when transporting your LimeBook. You can purchase an optional carrying case for protection from dirt, water, shock, and scratches.

Charging Your Batteries

If you intend to use battery power, be sure to fully charge your battery pack and any optional battery packs before going on long trips. Remember that the power adapter charges the battery pack as long as it is plugged into the computer and an AC power source. Be aware that it takes much longer to charge the battery pack when the LimeBook is in use.

Airplane Precautions

Contact your airline if you want to use the LimeBook on the airplane. Most airlines have restrictions for using electronic devices. Most airlines allow electronic use only between and not during takeoffs and landings.



There are three main types of airport security devices: X-ray machines (used on items placed on conveyor belts), magnetic detectors (used on people walking through security checks), and magnetic wands (hand-held devices used on people or individual items). You can send your LimeBook and diskettes through airport X-ray machines. However, it is recommended that you do not send your LimeBook or diskettes through airport magnetic detectors or expose them to magnetic wands.

Preparing your LimeBook

These are only quick instructions for using your LimeBook. Read the following chapters for detailed information.

1. Install the battery pack

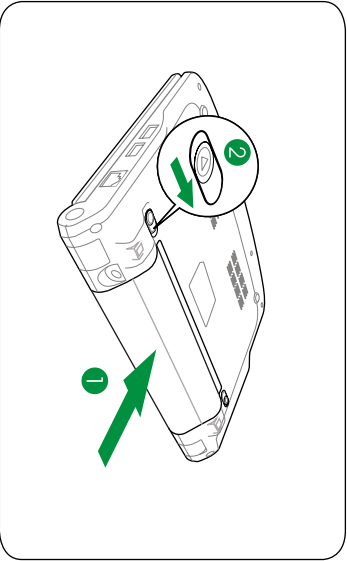

2. Connect the AC power adapter

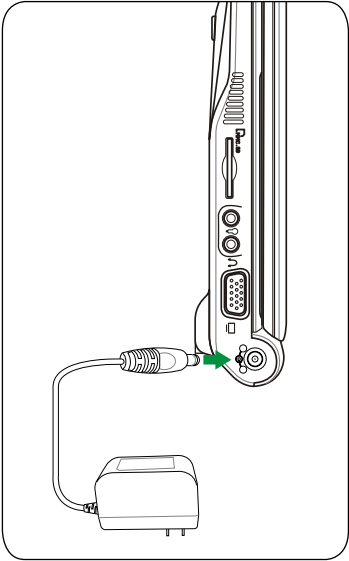

The wall outlet differs in type by country. Your LimeBook ships with an adapter compliant with your national standard. The illustration above is for reference only and may not exactly show your specific configuration. Refer to page 3-2 for more details.

3. Open the display panel

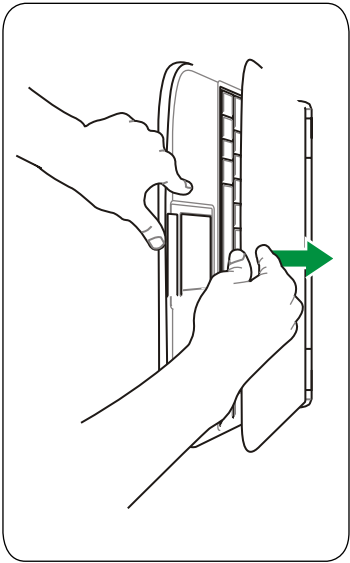

Top Side
Bottom Side
Right Side
Left Side
Rear Side

4. Turn ON the LimeBook

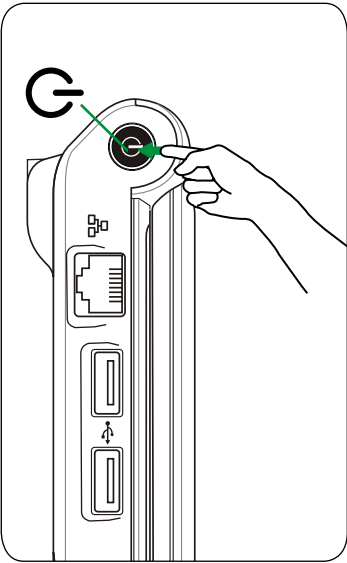

When you open the display panel, do not force it down to the table or else the hinges may break! Never lift the LimeBook by the display panel!

Knowing the Parts

Top Side

Refer to the diagram below to identify the components on this side of the LimeBook.

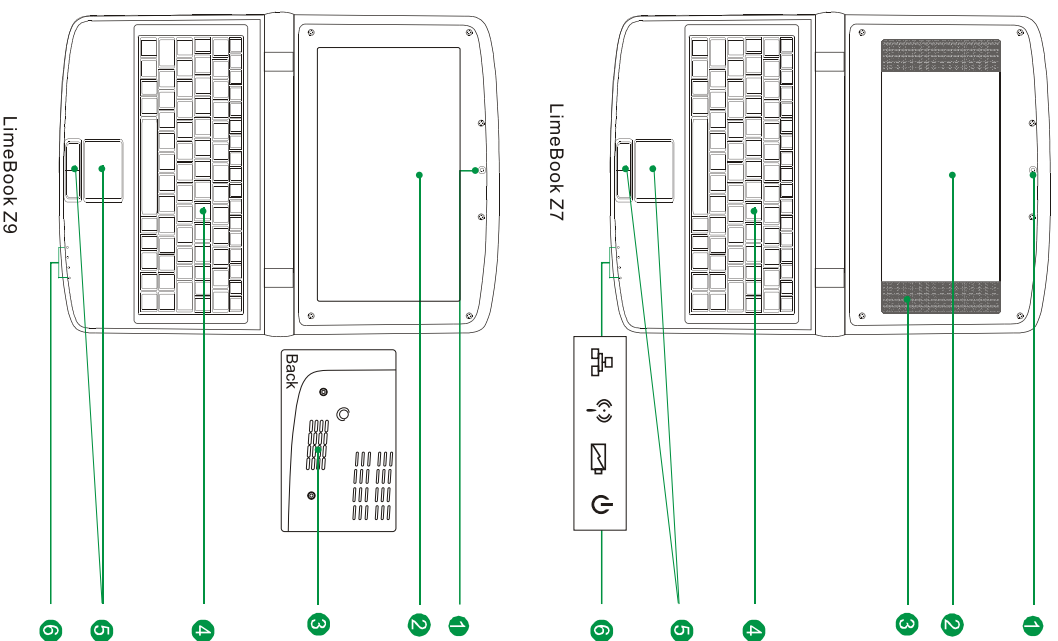

The keyboard will differ for each territory.

1 Built-in Camera (optional)

The built-in camera allows picture taking or video recording.

2 Display Panel

The display panel functions the same as a desktop monitor. The LimeBook uses an active matrix TFT LCD, which provides excellent viewing like that of desktop monitors. Unlike desktop monitors, the LCD panel does not produce any radiation or flickering, so it is easier on the eyes. Use a soft cloth without chemical liquids (use plain water if necessary) to clean the display panel.

3 Build-in speaker

4 Keyboard

The keyboard provides keys with comfortable travel and palm rest for both hands.

5 Touchpad and Buttons

The touchpad and its buttons comprises a pointing device that provides the same functions as a desktop mouse. Scrolling is available to allow easy web and document navigation.

6 Status Indicators (front)

Ethernet Indicator

This is only applicable on models with built-in ethernet .When the ethernet LAN is enabled, this indicator lights.

Wireless Indicator (No wireless network card in this product.)

This is only applicable on models with built-in wireless LAN. When the built-in wireless LAN is enabled, this indicator lights.

Battery Charge Indicator

The battery charge indicator (LED) shows the status of the battery' s power as follows:

ON: The LimeBook' s battery is charging when AC power is connected.

OFF: The LimeBook' s battery is charged or completely drained.

Blinking: Battery power is less than 10% and AC power is not connected.

Power Indicator

The power indicator lights when the LimeBook is turned ON and blinks slowly when the LimeBook is in the Save-to-RAM (Suspend) mode. This indicator is OFF when the LimeBook is turned OFF.

Bottom Side

Refer to the diagram below to identify the components on this side of the LimeBook.

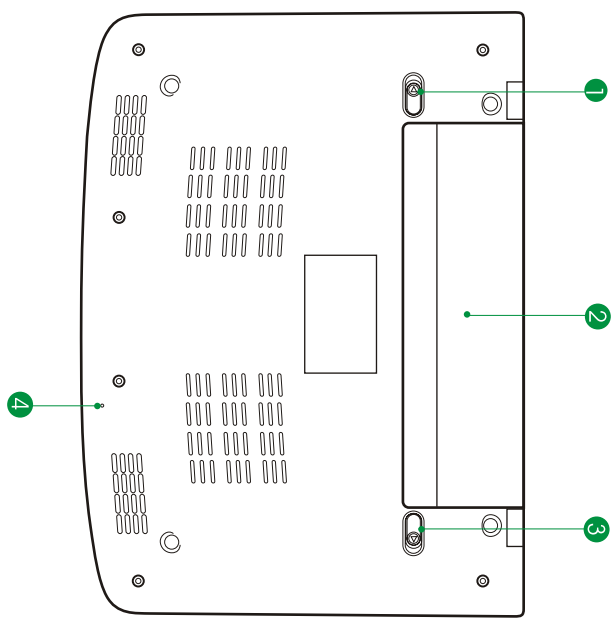

The bottom side may vary in appearance depending on model.



The bottom of the LimeBook can get very hot. Be careful when handling the LimeBook while it is in operation or recently been in operation. High temperatures are normal during charging or operation. Do not use on soft surfaces such as beds or sofas ,which may block the vents. Do not put the LimeBook on your lap or other parts of the body to avoid injury from the heat.

1 Battery Lock - Spring

The spring battery lock keeps the battery pack secure. When the battery pack is inserted, it will automatically lock. When removing the battery pack, this spring lock must be retained in the unlocked position.

2 Battery cell

a. The battery cell is automatically charged when connected to an AC power source and maintains power to the LimeBook when AC power is not connected. This allows use when moving temporarily between locations. Battery time varies by usage and by the specifications for this LimeBook. The battery pack cannot be disassembled and must be purchased as a single unit.

b. You can also choose empty shell without battery, then you can put the 6 AA battery cell into the shell, it will work!

3 Battery Lock - Manual

The manual battery lock is used to keep the battery pack secured. Move the manual lock to the unlocked position to insert or remove the battery pack. Move the manual lock to the locked position after inserting the battery pack.

4 Microphone (Built-in)

The built-in mono microphone can be used for skype, voice narrations, or simple audio recordings.

Right Side

Refer to the diagram below to identify the components on this side of the LimeBook

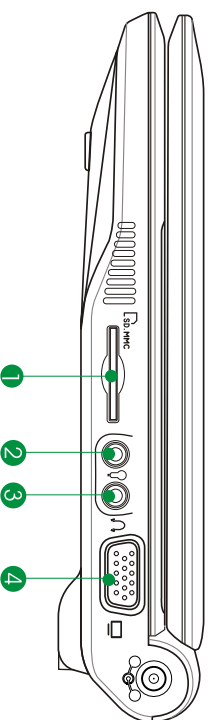

1 Memory Card Slot

The built-in memory card reader can read SD/MMC cards from devices such as digital cameras, MP3 players, mobile phones, and PDAs.

2 Microphone Jack

The microphone jack is designed to connect the microphone used for Skype, voice narrations, or simple audio recordings.

3 Headphone Output Jack

The 1/8" stereo headphone jack (3.55mm) connects the LimeBook's audio out signal to amplified speakers or headphones. Using this jack automatically disables the built-in speakers.

4 Display (Monitor) Output

The 15-pin D-sub monitor port supports a standard VGA-compatible device such as a monitor or projector to allow viewing on a larger external display.

Left Side

Refer to the diagram below to identify the components on this side of the LimeBook

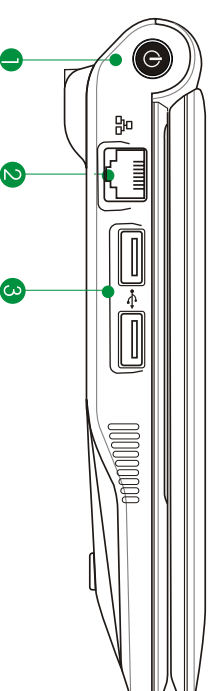

1 Power Switch

The power switch allows powering ON and OFF the LimeBook and recovering from STR. Press the switch once to turn ON and hold it to turn OFF the LimeBook. The power switch only works when the display panel is opened.

2 LAN Port

The eight-pin RJ-45 LAN port (10/100M bit) supports a standard Ethernet cable for connection to a local network. The built-in connector allows convenient use without additional adapters.

3 USB Port (2.0/1.1)

The USB (Universal Serial Bus) port is compatible with USB 2.0 or USB 1.1 devices such as keyboards, pointing devices, cameras, and storage devices, connected in a series up to 12Mbps/sec (USB 1.1) and 480Mbps/sec (USB 2.0). USB allows many devices to run simultaneously on a single computer, with some peripherals acting as additional plug-n sites or hubs. Also, it supports hot-swapping function.

Rear Side

Refer to the diagram below to identify the components on this side of the LimeBook.

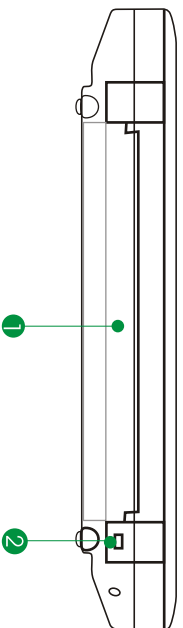

1 Battery Pack

The battery pack is automatically charged when connected to an AC power source and maintains power to the LimeBook when AC power is not connected. This allows use when moving temporarily between locations. Battery time varies by usage and by the specifications for this LimeBook. The battery pack cannot be disassembled and must be purchased as a single unit.

2 Kensington(R) Lock Port

The Kensington(R) lock port allows the LimeBook to be secured using Kensington(R) compatible security products. These security products usually include a metal cable and lock that prevent the LimeBook to be removed from a fixed object.

Power System Touchpad Usage Starting use LimeBook

3 Getting Started



Power System

Using AC Power

The LimeBook power comprises two parts, the power adapter and the battery power system. The power adapter converts AC power from a wall outlet to the DC power required by the LimeBook. Your LimeBook comes with a universal AC-DC adapter for connection to any 100V-120V as well as 220V-240V outlets without setting switches or using power converters. Different countries may require an adapter to connect the provided US-standard AC power cord to a different standard. Most hotels will provide universal outlets to support different power cords as well as voltages. It is always best to ask an experienced traveler about AC outlet voltages before travelling.

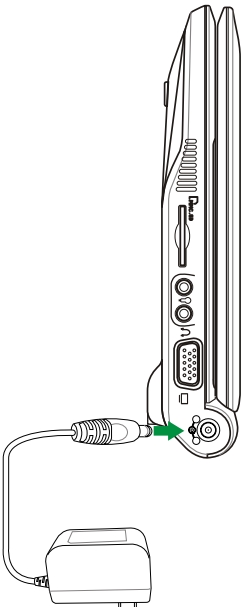

The power adapter may become warm to hot when in use. Be sure not to cover the adapter and keep it away from your body.



Damage may occur if you use a different adapter to power the LimeBook or use the LimeBook's adapter to power other electrical devices. If there is smoke, burning scent, or extreme heat coming from the AC-DC adapter, seek servicing. Seek servicing if you suspect a faulty AC-DC adapter. You may damage both your battery pack(s) and the LimeBook with a faulty AC-DC adapter.

Using Battery Power

The LimeBook is designed to work with a removable battery pack. The battery pack consists of a set of battery cells housed together. A fully charged pack will provide several hours of battery life. Additional battery packs are optional and can be purchased separately through an LimeBook retailer. Remember to fully charge the battery before first use and whenever it is depleted to prolong battery life.

Installing and Removing the Battery Pack

Your LimeBook may not have its battery pack installed. If not, use the following procedures to install the battery pack.



Never attempt to remove the battery pack while the LimeBook is turned ON, as this may result in the loss of working data.

To install the battery pack:

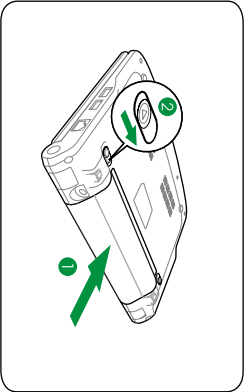

To remove the battery pack:

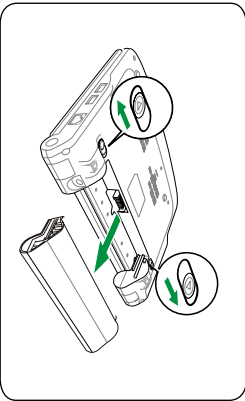

- 1 You can use the lithium battery we prepared for you
- 2 You also can use the traditional AA battery

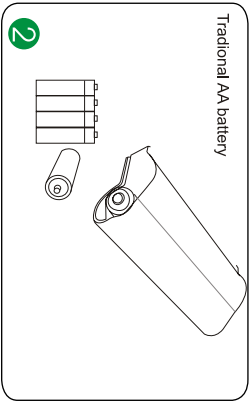
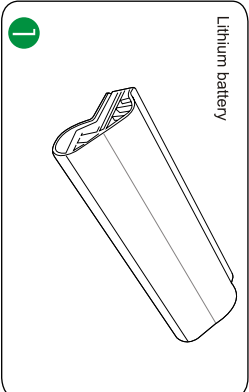



Only use battery packs and power adapters supplied with this LimeBook or specifically approved by the manufacturer or retailer for use with this model or else damage may occur to the LimeBook. And take the battery out of your LimeBook without using it for a long time



For safety reasons, Do not throw the battery in fire, Do not short circuit the contacts, and Do not disassemble the battery. If there is any abnormal operation or damage to the battery pack caused by impact, turn OFF the LimeBook and contact an authorized service center.



Emergency Shutdown

In case your operating system cannot properly turn OFF or restart, there are additional ways to shutdown and reset your LimeBook:

Shutdown: Hold the power button  until the system shuts down.

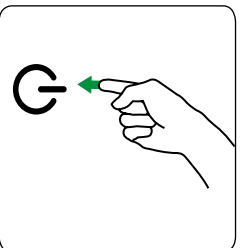

Use a pin or a straightened paper clip to press the power switch.

Do not use emergency shutdown/reset while data is being written or read; doing so can result in loss or destruction of your data.



Touchpad Usage

Clicking/Tapping - With the cursor over an item, press the left button or use your fingertip to touch the touchpad lightly, keeping your finger on the touchpad until the item is selected. The selected item will change color. The following 2 illustrations produce the same results.

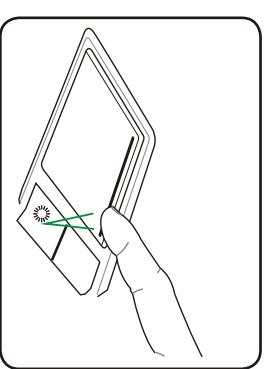
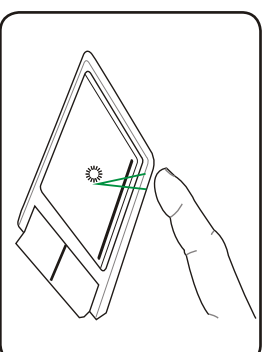

Double-clicking/Double-tapping - This is a common skill for launching a program directly from the corresponding icon you select. Move the cursor over the icon you wish to execute, press the left button or tap the pad twice in rapid succession, and the system launches the corresponding program. If the interval between the clicks or taps is too long, the operation will not be executed. The following 2 illustrations produce the same results.

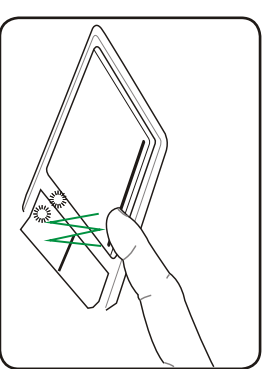
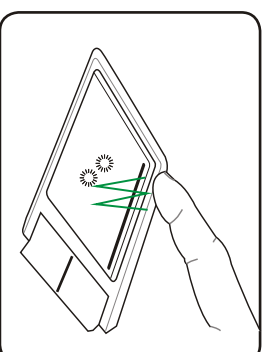

Dragging - Dragging means to pick up an item and place it anywhere on the screen you wish. You can move the cursor over the item you select, and while keeping the left button depressed, moving the cursor to the desired location, then release the button. Or, you can simply double-tap on the item and hold while dragging the item with your fingertip. The following illustrations produce the same results.

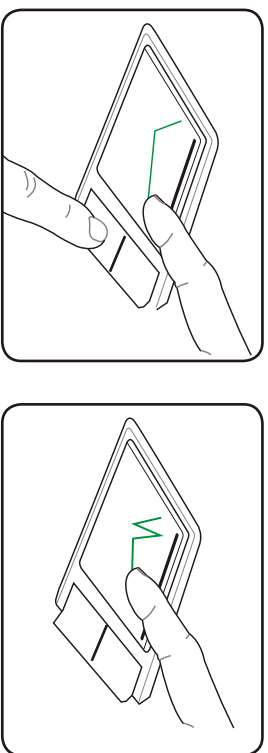

Scrolling - Slide you inger up or down on the right side of the touchpad to scroll a window up or down. If your display window includes several sub-windows, move the cursor on that pane before scrolling.

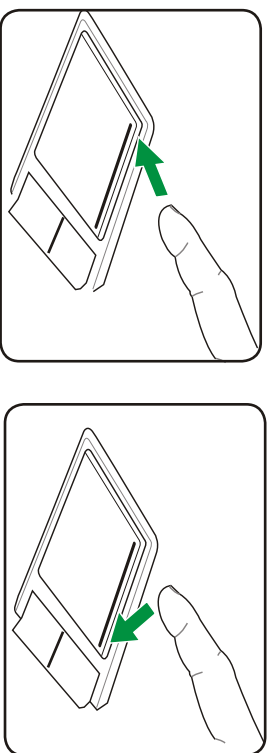

Starting use LimeBook

When you power on the LimeBook for the first time, the system will auto-launch and lead you through setting up your preferences and some basic information.

Follow the instructions to finish the initiation:

The first interface appeared



1. Click the Session button to select the system you wanted to run on your LimeBook, you can choose Xfce or LimeOS



2. Click the Language button to select the language you wanted to run on your LimeBook



3. Enter your User Name.
Click OK to continue.



4. Enter your Password . Click
OK to continue.



More information about LimeOS, please look over the user manual of LimeOS.

FCC NOTE:

THE MANUFACTURER IS NOT RESPONSIBLE FOR ANY RADIO OR TV INTERFERENCE CAUSED BY UNAUTHORIZED MODIFICATIONS TO THIS EQUIPMENT. SUCH MODIFICATIONS COULD VOID THE USER'S AUTHORITY TO OPERATE THE EQUIPMENT.

NOTE: This equipment has been tested and found to comply with the limits for a Class B digital device, pursuant to part 15 of the FCC Rules. These limits are designed to provide reasonable protection against harmful interference in a residential installation.

This equipment generates, uses and can radiate radio frequency energy and, if not installed and used in accordance with the instructions, may cause harmful interference to radio communications. However, there is no guarantee that interference will not occur in a particular installation. If this equipment does cause harmful interference to radio or television reception, which can be determined by turning the equipment off and on, the user is encouraged to try to correct the interference by one or more of the following measures:

- Reorient or relocate the receiving antenna.
- Increase the separation between the equipment and receiver.
- Connect the equipment into an outlet on a circuit different from that to which the receiver is connected.
- Consult the dealer or an experienced radio/TV technician for help.