

Certification Exhibit

**FCC ID: WIX08270924
IC: 7984A-08270924**

**FCC Rule Part: 15.231
IC Radio Standards Specification: RSS-210**

ACS Report Number 08-0382-15C

**Applicant: Polartec, LLC
Model(s): PLTH-4000**

User Manual

1

Introduction

Thank you for purchasing a Polartec Heat Garment, the state of the art in wearable comfort on demand.

The Polartec Heat garment represents the introduction of Polartec, LLC's E-Textile technology. Unlike bulky wired systems available for outdoor enthusiasts, the Polartec Heat garment was designed with your overall comfort in mind. From the ultra-thin and flexible Heat Panel to the ergonomic shaped battery and the use of our heat-management fabrics for the garment – the system represents the ultimate in wearable, active heating.

The discreet nature of the heating technology allows you to wear the Polartec Heat garment throughout your day and anywhere you might need a little warmth.

The wireless remote controls are designed to allow easy operation of the Heat Panel. The state of the art lithium batteries provide up to 2 hours of warmth on a continuous high setting and as long as 6 hours of warmth when continuously set to low.

This is the future of warmth. We know you will enjoy it.

2

Getting Started

Step 1 >>>

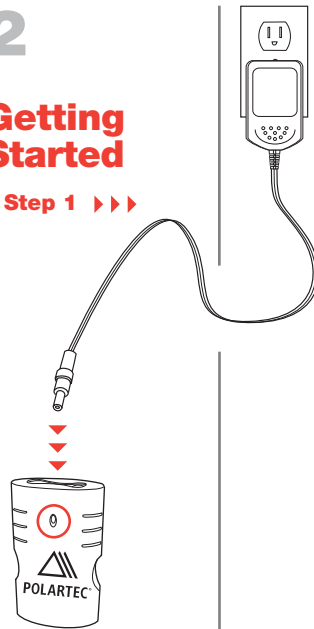

Lithium ion batteries show no degradation of performance in cold temperatures and exhibit no memory in charge and discharge cycles. A slight drain in capacity happens over time due to the nature of the battery. It is recommended to recharge the battery before each use to maximize duration.

The Heat Panel Battery Pack comes from the factory with a partial charge and must be fully charged before use.

To Charge the Heat Panel Battery Pack

Insert the wall plug of the battery charger into an accepting wall outlet. The supplied charger operates from standard 100V to 240V AC and requires a plug adapter for travel outside North America.

Insert the charging connector of the battery charger into the Heat Panel Battery Pack.

The green LED on the Heat Panel Battery Pack will flash as the unit is charging.

The battery will be fully charged in approximately 3-4 hours. When charging is complete, the green LED will stay illuminated.

* Connect the equipment into an outlet on a circuit different from that to which the receiver is connected; subject to the following two conditions: (1) This device may not cause harmful interference, and (2) this device must accept any interference received, including interference that may cause undesired operation.

This equipment has been tested and found to comply with the limits for a Class B digital device, pursuant to part 15 of the FCC Rules. These limits are designed to provide reasonable protection against harmful interference in a residential installation. This equipment generates, uses and can radiate radio frequency energy and, if not installed and used in accordance with the instructions, may cause harmful interference to radio communications. However, there is no guarantee that interference will not occur in a particular installation. If this equipment does cause harmful interference to radio or television reception, which can be determined by turning the equipment off and on, the user is encouraged to try to correct the interference by one or more of the following measures:

- * Reorient or relocate the receiving antenna.
- * Increase the separation between the equipment and receiver.
- * Consult the dealer or an experienced radio/TV technician for help.

Warning: Changes or modifications to this device not expressly approved by Polartec, LLC could void the user's authority to operate the equipment.

This equipment complies with FCC radiation exposure limits set forth for an uncontrolled environment. This equipment is in direct contact with the body of the user under normal operating conditions. This transmitter must not be co-located or operating in conjunction with any other antenna or transmitter. The term "IC," before the radio certification number only signifies that Industry Canada technical specifications were met.

3

Garment Parts and Components

Visit www.polartec-heat.com for battery replacement and purchase

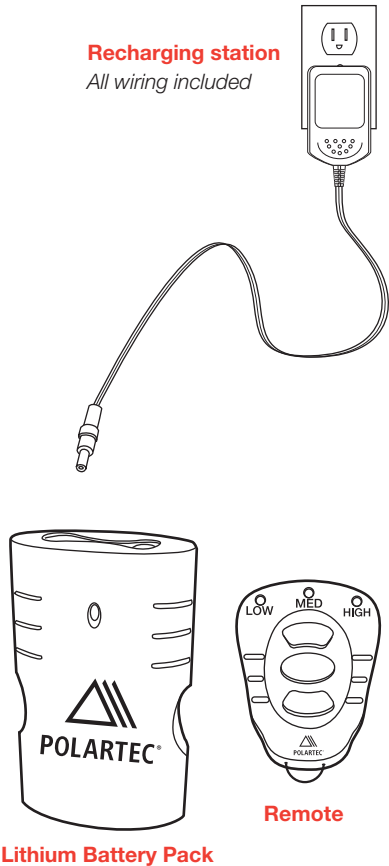

Men's Garment

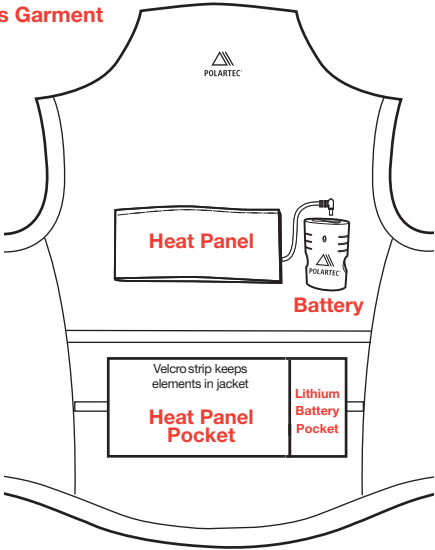

Women's Garment

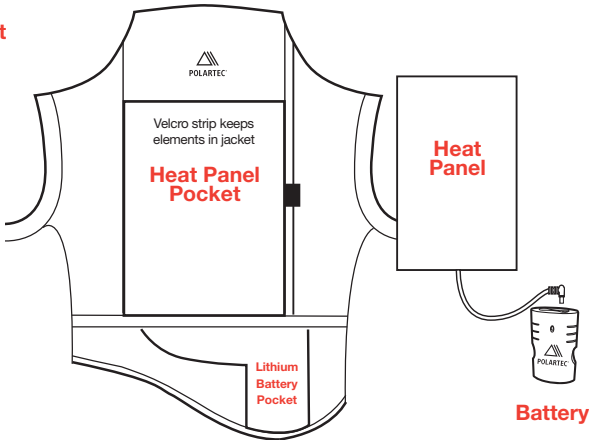



POLARTEC®

Polartec® Heat® Jacket/Vest

Instruction Manual
Model PLTH-4000

The Polartec® Heat® Garment provides warmth when you need it, addressing your changing needs in intermittent activities. Simple wireless remote control operation activates the Polartec® Heat® Panel to warm and keep you comfortable regardless of the activity.

If you have any questions about the operation of your Polartec® Heat® Garment, call Customer Service at **1-800-371-3986**

Contents

- 1. Introduction
- 2. Getting Started
- 3. Garment Parts and Components
- 4. Installing the System in the Garment
- 5. Using the Wireless Remote Control
- 6. Care and Cleaning
- 7. Troubleshooting
- 8. Replacing the Remote Battery
- 9. Synchronize the Remote to the Polartec Heat® Panel Battery

Warnings and Safeguards

As with all electrical products, misuse of this product or failure to properly follow the instructions may cause overheating, fire or personal injury. Please read all the product labels and all of the instructions before using your garment.

1. Do not use the garment with an infant, a child, or anyone who cannot clearly understand the instructions and/or operate the controls.
2. Do not use with damaged cords.
3. Do not dry clean or machine wash the heat panel, battery or remote control as it will cause damage to the system and will stop functioning.
4. Do not pinch, flex, or expose the heating panel to rubbing.
5. Turn off the garment when not wearing.
6. Do not use pins as they may damage the heating element.
7. The supplied Polartec® batteries are intended for outdoor use and are classified as water-resistant. If submerged, allow to completely dry.
8. Do not attempt to open battery case.
9. Do not expose batteries to an open flame or high heat.
10. Store system in a cool dry space away from open flame or any other heat source.
11. Disconnect batteries when not in use.
12. Do not use with pacemakers.
13. Do not operate while submerged in water.

4

Installing the System in the Garment

Step 1

Insert the Heat Panel into the garment pocket and align the Velcro strip on the panel with the lower half of the Velcro on the pocket. Push the power connector of the panel through the channel into the battery pocket. Align Velcro® and press to engage.

Step 2

Insert the fully charged Heat Panel Battery Pack into the battery pocket and connect the power connector of the panel to the Heat Panel Battery Pack. To get the best remote control communication, place the battery pack in the garment with the Polartec logo facing toward the body. Align Velcro and press to engage.

Note: When not in use, disconnect the heat panel from the battery pack to retain the battery charge.

Men's Garment

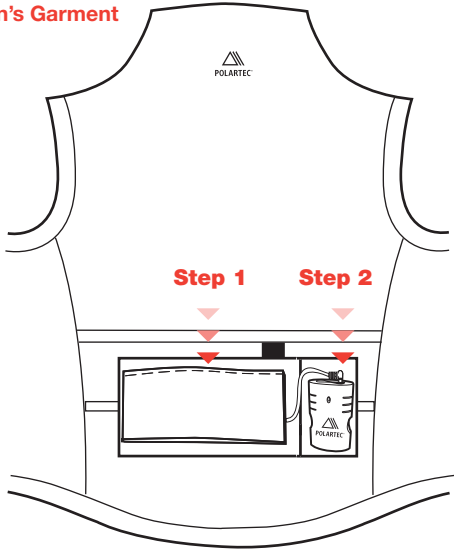

Women's Garment

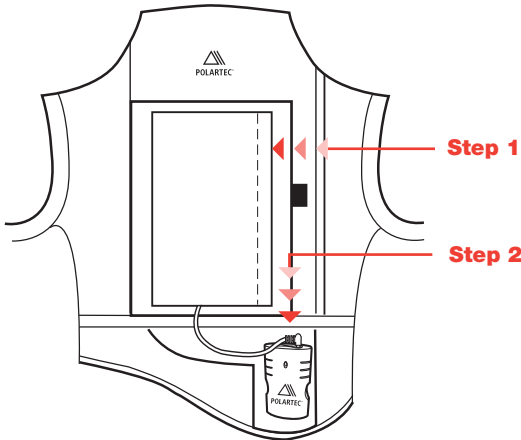

5

Using the Wireless Remote Control

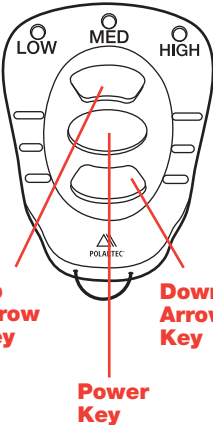

Turn on

Press power key for at least 1 second
All LEDs will light green briefly to signal system is on. "Low" will then light as starting heat setting.

Increase Heat

Press up arrow key for at least 1 second
LED will light up the increased setting in green.

Decrease Heat

Press down arrow key for at least 1 second
LED will light up the reduced setting in green.

Turn Off

Press power button for at least 1 second
The MED LED will briefly light red to signal system is off.

Check Heat Level

Press any button quickly (less than a second)
LED for current heat setting will light green.

6

Care and Cleaning

CAUTION: Always remove the remote control, rechargeable battery and Heat Panel before washing your garment. Do not wash the remote control, rechargeable battery, or Heat Panel.

Machine Washing of Vest

Remove the batteries, remote control, and Heat Panel before washing. Machine wash garment in delicate cold, dark colors separately, or hand wash.

Hang to dry.

Do not bleach, iron or dry clean.

Cleaning the Heat Panel system

1. Unplug the Heat Panel's power cord from the battery or the charger.
2. Wipe the Heat Panel with a damp cloth.

7

Trouble-shooting

There are no lights on the remote control

1. Replace remote control batteries. (See section 8)

The remote control lights up but the panel does not heat

1. Make sure panel is plugged into rechargeable battery.
2. Make sure Heat Panel Battery Pack is charged.

My garment isn't heating quickly

The garment takes about 2 minutes to heat up to maximum temperature. For maximum warmth, it is designed to be worn tight to the body. Vests are designed to be worn with a jacket overtop to aid in the trapping of warmth by the body.

The battery charger has a North American plug, can I use it in other countries?

The charger can be used with a standard North American to European adapter without the use of a transformer.

Can I still use the garment if caught in a rain storm?

If the garment becomes wet, discontinue use and unplug the battery. Moderate precipitation and perspiration will not affect the garment's performance.

If you have additional questions or concerns, please contact Polartec Heat Hotline at 1-800-371-3986.

8

Replacing the Remote Battery

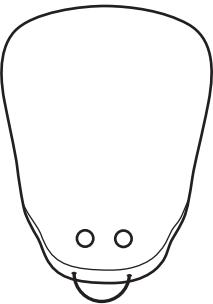

The remote control battery is designed to last one season of regular use.

Inserting and removing the battery

1. Remove the two screws from the back of the remote.
2. Remove circuit board. Slide batteries out of holders.
3. Place the new batteries in the holder with the + sign facing up. The remote is powered with a CRt2032 Lithium coin cell battery.
4. Reinsert circuit board.
5. Replace back of remote and screws.

9

Synchronize the Remote to the Polartec Heat® Panel Battery

Replacement or spare battery packs require synchronization with the remote.

1. Using a fully charged Heat Panel Battery Pack, plug the Heat Panel into the battery.
2. Press all 3 buttons on the remote simultaneously for at least 1 second. The red LED on the battery pack will flash on and off quickly for 3 seconds to indicate the remote and the Battery Pack are now synchronized.