



# 5G CPE CPX80I

Quick Start Guide ▶

## Welcome to the SRP Series

SRP series ruggedized outdoor router provides 5G NR service in a ruggedized form factor. With an operating temperature range of -40°C ~ 70°C endurance, they offer industrial-grade environmental qualifications while providing higher speed data services for video and other bandwidth-intensive applications. SRP series industrial router has very strong anti-vibration ability and it is qualified for extreme industrial environments and ideally suited for rail, transportation, mining, oil and gas, manufacturing, and other outdoor applications.

With the diverse self-developed 5G NR embedded modules integrated, SRP series industrial router can support multi-band for Private 5G NR, even support uncommon frequencies. SRP series industrial router can provide accurate real-time location information.

This document will serve as a quick start guide for SRP series ruggedized outdoor router. In this document, the SRP series ruggedized outdoor router will be replaced by the router.

## Device Architecture

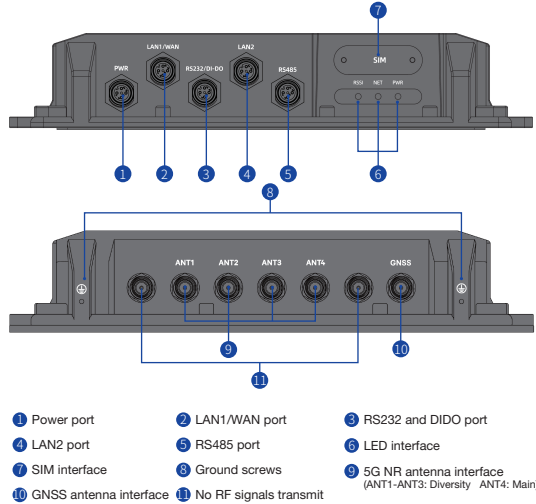

**Note1** The reset button is beside SIM interface, if press 1s, router will restart; If press on for 10s, the router will reset to factory defaults.

**Note2** There are two white ground screws also at behind of device.

## RS232/485 Cable Definition

RS232/485 cable definition				
Number	Colors	RS485	RS232+DIDO	
1	Orange&white	NC	DO2	
2	Orange	NC	DI2	
3	Green&white	RS_GND	DO1	
4	Blue	RS_GND	DI1	
5	Blue&white	RS_GND	RS_GND	
6	Green	RS_GND	RS_GND	
7	Brown&white	RS485_B	RS232_TX	
8	Brown	RS485_A	RS232_RX	

## LAN/WAN Cable Definition

LAN/WAN cable definition			
Number	Colors	LAN/WAN	
1	Orange&white	MDI0-/RJ45-1	
2	Orange	MDI0-/RJ45-2	
3	Green&white	MDI1-/RJ45-3	
4	Blue	MDI2-/RJ45-4	
5	Blue&white	MDI2-/RJ45-5	
6	Green	MDI1-/RJ45-6	
7	Brown&white	MDI3-/RJ45-7	
8	Brown	MDI3-/RJ45-8	

## Power Cable Definition

Power cable definition			
Number	Colors	PWR	
1	Red	PWR_Positive	
2	Black	PWR_GND	
3	NC	NC	
4	NC	NC	

## Working Environment

Operating Temperature	-40°C ~ 70°C
Storage Temperature	-40°C ~ 85°C
Humidity	5% ~ 95%
Power Supply	9 ~ 36VDC
Power Consumption	<20W
Water and Dustproof	IP67

## Packing List

Items	Accessories	Qty
1	A-Code cable to RJ45 jack ADC2 (Ethernet cable)	1
2	A-Code 8-Pin cable ADB1 (Data cable)	1
3	A-Code 4-Pin cable M12A (Power cable)	1
4	Mounting bolt	4
5	Grounding cable	1
6	Protective cap (TNC)	6
7	Protective cap (M12)	5

## Hardware Configuration

### Install SIM Cards

**Step1** Use a cross screwdriver to remove the SIM card cover.

**Step2** Slide the SIM cards into the SIM slots until they click into place. By default, the SIM card in slot 1 (the upper slot) is the Primary SIM card. When the SRP router is powered on or rebooted, it automatically connects to the network associated with the Primary SIM card.

**Step3** Re-attach the cover.

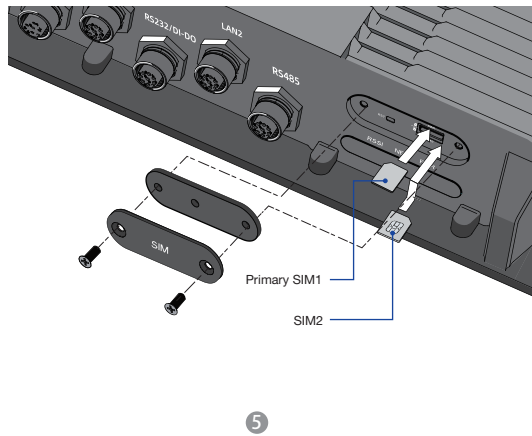

## Connect and Turn on the Router

⚠ Please connect the protecting ground cable as first step, connect 9-36 VDC power cable as the last step.

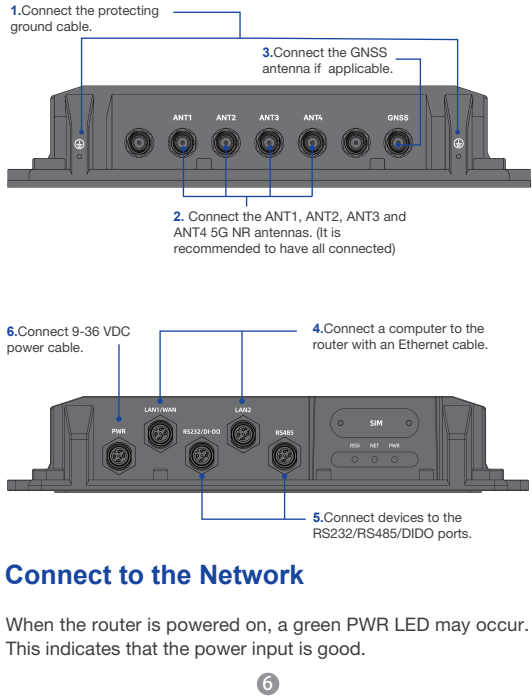

## Connect to the Network

When the router is powered on, a green PWR LED may occur. This indicates that the power input is good.

Once the router's radio module is configured for the SIM card, it begins the activation/provisioning process and attempts to connect to the mobile network. This process typically takes several minutes. A successful connection is indicated by a solid green NET LED. And the strength of the RF signal can be indicated by the Signal LEDs in different quantity.

Indicator	Status	Description
PWR	Green	Power on
	Off	No power supply
NET	Green	Registered to network
	Off	Not register to network
RSSI	Blinking	Searching network
	Green	Signal strong
	Yellow	Signal good
	Red	Signal weak
	Off	No signal
	Red Blinking	No SIM or SIM error

## Software Configuration

### Login to the Web Management Page

**Step1** Launch the web browser, enter http://192.168.1.1 in the address bar, and press Enter.

192.168.1.1/pub/login.htm

**Step2** Enter the username and password, and click **Login**.

**Step3** After the password is verified, you can login to the web management page.

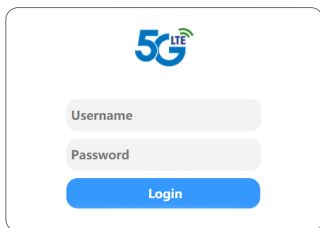

The default username and password are both **admin**. If you want to view or configure the router, you should use the super account to login to the web management page. The default super username is **superadmin**, and the password is **admin**.

## Radio Settings

**Step1** Choose **Network > Radio Settings**.

**Step2** On **Radio Settings** page, you can set the configuration of 5G NR network.

**Step3** In the **5G Status** list, you can view the 5G NR status, such as Frequency, RSSI, RSRP, RSRQ, CINR, SINR, Cell ID and etc.

Device Information	CINR0	-45
Network	CINR1	-45
WAN Settings	TX Power	-45dB
DNS Settings	PCI	360
APN Management	Cell ID	16
Radio Settings	MCC	460
Scan Mode	MNC	00
PNM Management	5G Status	
Dual SIM	DL Frequency	2124.950391Hz
SIM Lock	UL Frequency	2124.950391Hz
LAN Settings	Band	41
Basic Route	Bandwidth	20MHz
Radio On/Off	RSRP0	-45dBm
Security Settings	RSRP1	-45dBm
VPN	RSRQ	-45dBm
IPv6	RSRQ	-45dBm
System	RSRQ	-45dBm
	SINR	16dB
	PCI	3
	Cell ID	...
	MCC	460
	MNC	00

## FAQs

### The POWER indicator does not turn on.

- Make sure that the power cable is connected properly and the router is powered on.
- Make sure that the power supply is compatible with the router.

### Fails to Login the web management page.

- Make sure that the router is powered on.
- Verify that the router is correctly connected to the computer through a network cable.
- If the problem persists, please contact the authorized local service suppliers.

### The router fails to search for the wireless network.

- Check if the power supply is connected properly.
- Check if the router is placed in an open area that is far away from obstructions, such as concrete or wooden walls.
- If the problem persists, please contact the authorized local service suppliers.

### The parameters are restored to default values.

- If the router is powered off unexpectedly while being configured, the parameters may be restored to the default settings.
- After configure the parameters, download the configuration file and restore the desired settings quickly.

**The router does not support SIM card hot-plug, please confirm that the device is powered off when the SIM card is inserted or removed.**

This device complies with Part 15 of the FCC Rules. Operation is subject to the following two conditions:  
(1) this device may not cause harmful interference, and  
(2) this device must accept any interference received, including interference that may cause undesired operation.

This equipment complies with FCC radiation exposure limits set forth for an uncontrolled environment. This equipment should be installed and operated with minimum distance 20cm between the radiator and your body. This transmitter must not be co-located or operating in conjunction with any other antenna or transmitter.

### Caution!

Any changes or modifications not expressly approved by the party responsible for compliance could void the user's authority to operate the equipment.