

IMPORTANT NOTICE:

- Do not mix old and new batteries.
- Do not mix alkaline, standard (Carbon Zinc) or rechargeable (Nickel-Cadmium) batteries.
- Batteries should be replaced by adults because of small parts.
- Batteries are to be inserted with correct polarity.
- Non-rechargeable batteries are not to be charged.
- Only batteries of the same or equivalent type as recommended are to be used.
- Expired batteries are to be removed from the toy and disposed of safely.
- Do not operate your car in dangerous places.
- Do not put your car and transmitter near any source of heat.
- Do not run through water, including pools and puddles.
- Avoid all possible collisions. Check the road ahead and watch for obstacles.
- Avoid your car and transmitter antennas touching each other.
- Do not operate your car in the vicinity of another radio-controlled car with the same frequency.
- Do not leave your car and transmitter outside overnight. Night dampness will cause harm.
- Do not forget to remove batteries from your car and transmitter if you are not going to operate the car again soon.
- If malfunction occurs, replace batteries.
- The supply terminals must not be short-circuited.
- Rechargeable batteries are to be removed from the toy before being charged.
- Rechargeable batteries are only to be charged under adult supervision.
- Do not dispose of batteries in fire. Batteries may either leak or explode.
- Make sure that people know that you are playing with Rascal Rods.
- Keep away from face and eyes.
- Batteries are to be inserted with the correct polarity.
- Manufacturer makes no guarantee as to the demonstration of the battery life.
- Consumer is responsible for replacement of batteries.
- Follow diagrams for battery installation/replacement.
- Remove exhausted batteries from the toy.

Warning: Changes or modifications to this unit not expressly approved by the party responsible for compliance could void the user's authority to operate the equipment.

This equipment has been tested and found to comply with the limits for a Class B digital device, pursuant to Part 15 of the FCC Rules. These limits are designed to provide reasonable protection against harmful interference in a residential installation. This equipment generates, uses and can radiate radio frequency energy and, if not installed and used in accordance with the instructions, may cause harmful interference to radio communications. However, there is no guarantee that interference will not occur in a particular installation. If this equipment does cause harmful interference to radio or television reception, which can be determined by turning the equipment off and on, the user is encouraged to try to correct the interference by one or more of the following measures:

- Reprint or relocate receiving antenna.
- Increase the separation between the equipment and receiver.
- Connect the equipment into an outlet on a circuit different from that to which the receiver is connected.
- Consult the dealer or an experienced radio/TV technician for help.

Changes or modifications not expressly approved by the party responsible for compliance could void the user's authority to operate the equipment.

Please read carefully
before operating.

INSTRUCTION MANUAL

Adult supervision is
recommended.

RADIO CONTROL

Rascal Rods

FULLY FUNCTIONAL
WORKING HEADLIGHTS
AND TAILLIGHTS

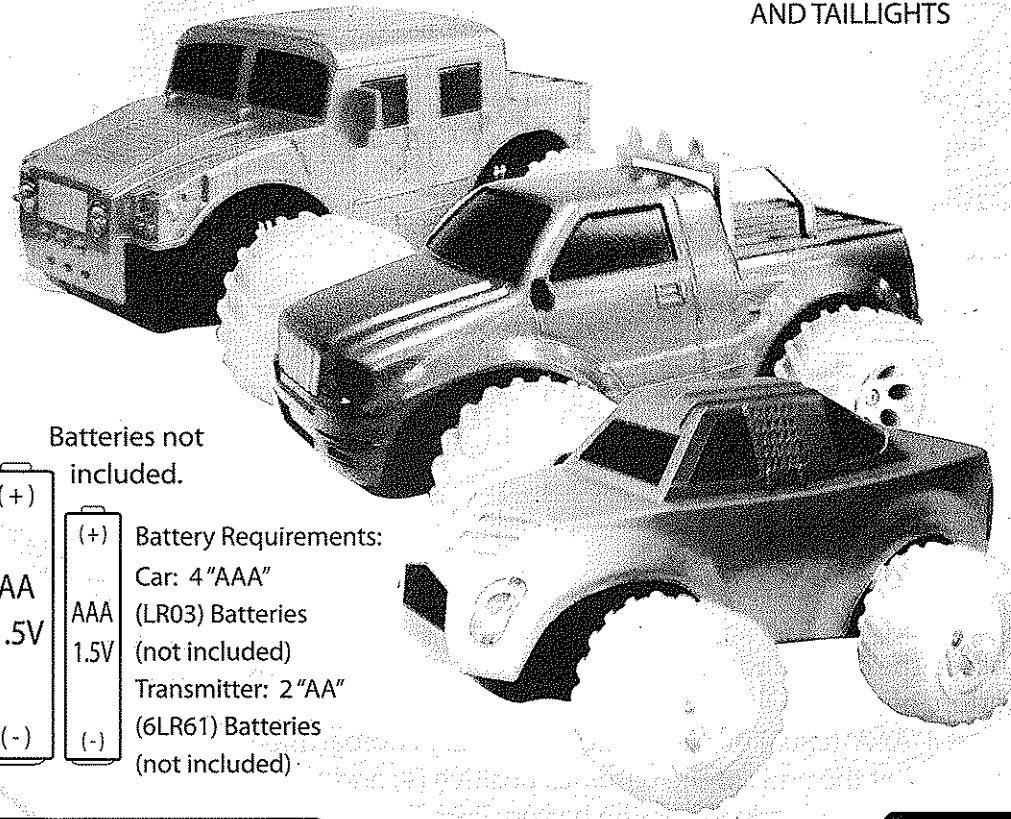

Batteries not
included.

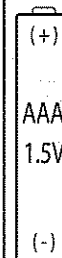
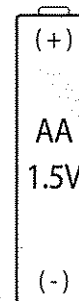

Battery Requirements:
Car: 4 "AAA"
(LR03) Batteries
(not included)
Transmitter: 2 "AA"
(6LR61) Batteries
(not included)



WARNING:

CHOKING HAZARD: Small Parts
Not suitable for children under 3 years.

Packaging contains important
information. Do not discard.



BATTERY & ON/OFF SWITCH DIAGRAM AND BATTERY INSTALLATION

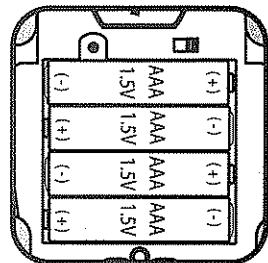
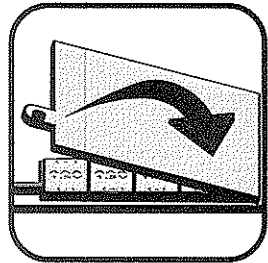
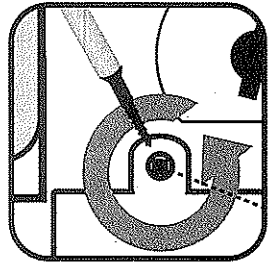

VEHICLE:

- Loosen the screw and open the battery compartment at the bottom of the car.
- Insert 4 "AAA" (LR03) batteries into the battery compartment. Be sure that the ends of the batteries positive (+) and negative (-) signs match the markings on the battery compartment.
- Close battery cover. Replace screw and tighten.

*IMPORTANT!

Switch to "OFF" position after use to avoid battery drainage.



ON/OFF

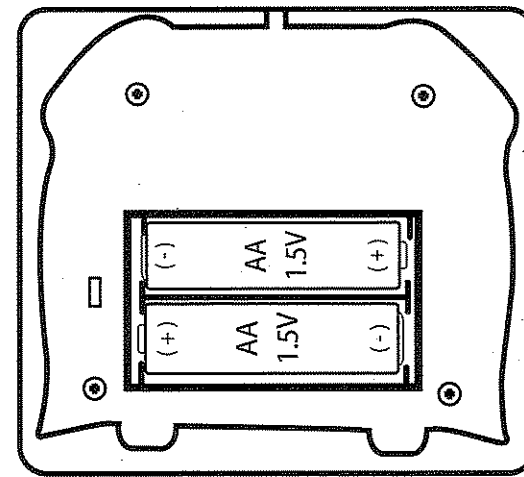

TRANSMITTER

- Open the battery compartment at the back of the transmitter with a "Phillips" screwdriver and install 2 "AA" (6LR61) batteries.
- Close and tighten the battery cover with a "Phillips" screwdriver.

ANTENNA

Screw the antenna in the cavity of the transmitter, and ensure it is fully extended when in use.

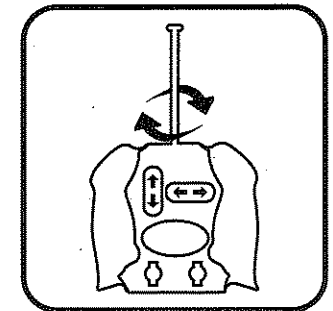

HOW TO OPERATE:

FIRST, turn ON/OFF switch at bottom of vehicle to "ON" position.

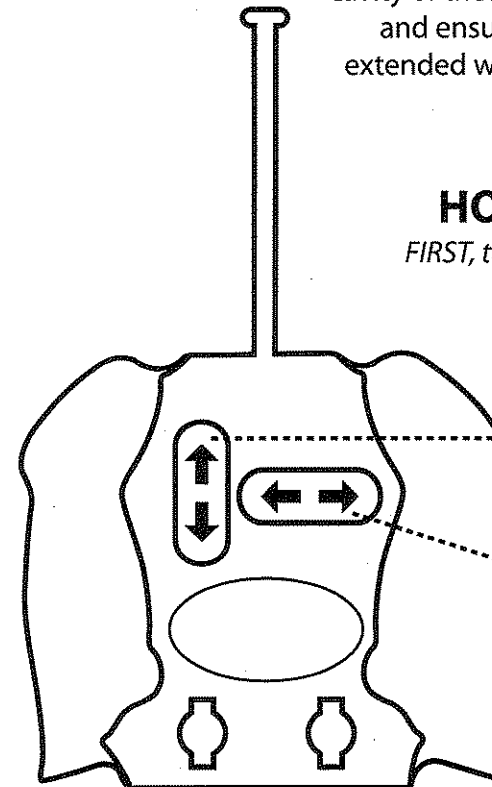

FORWARD
&
BACKWARD

Transmitter has no ON/OFF switch and is in standby mode when not in use. If not used, batteries in transmitter can last more than 6 months.

LEFT
&
RIGHT

Transmitters are not interchangeable between the Rascal Rods. Each car will ONLY operate with the corresponding transmitter.