

WIRELESS VIDEO DOORBELL

Operation manual



E40-0009DP

Feature:

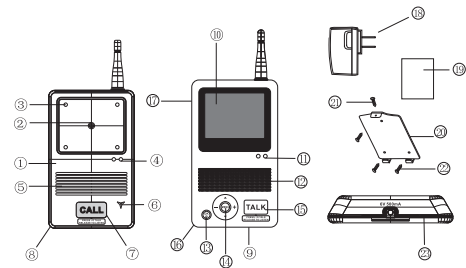

- | | |
|-------------------------------------|-----------------------------|
| 1. Camera unit | 12. Speaker |
| 2. CMOS camera sensor | 13. Power button |
| 3. Infrared LED | 14. Menu button |
| 4. Indicator LED | 15. Talk button |
| 5. Speaker | 16. Pairing button |
| 6. Microphone | 17. Battery door |
| 7. Call button | 18. AC adaptor |
| 8. Built in lithium polymer battery | 19. Double side sponge tape |
| 9. Receiver unit | 20. Metal wall bracket |
| 10. 2.4" TFT LCD display | 21. Screw |
| 11. Indicator light | 22. Screw |

Operation direction

1) Pairing

a) ~Camera Unit

Press the pairing button for 5 second and the indication LED would be flashing

b) ~Receiver unit

Press the Menu button for 5 second and pairing action would be complete while hearing "di" sound.

2) Installation.

Installing the metal bracket to wall or door and then attach the Camera Unit to the metal bracket. Please see installing direction as illustration

Mounting method A (for cement or brick wall)

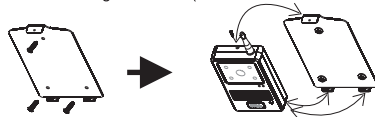

Mounting method B (for wood door or metal door)

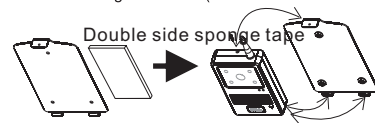

Noted:

Please check the installing position can let the antenna vertical to the ground. It is not recommend the unit install on a metal wall, it would affect the distance of the reception.

3) When someone press the camera unit, the receiver unit would receive a door ringing tone and video at the same time.

4) User press the talk button to voice back to the outdoor user. indoor release the talk button can let the outdoor user continue to speak.

Picture Record:

- We can check with visitors record on the receiver unit when offline.
- Press the Menu Button once and then press the Up/Down key to review who is visited us already.

Picture Control:

When in Call mode, we can press the up or down to adjust for the picture quality.

Volume Control:

Press the +/- Button to adjust the Sound Level.

5)Charge battery of receiver unit

User can put receiver unit into charging dock and then make AC adaptor plug into correctly slot on dock. Or user also directly plug into slot on receiver unit.

Finally ,user make another terminal of AC adaptor plug into AC socket. Please see as illustration.

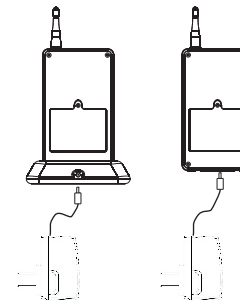

6)Water proof for camera unit

7) Installing batteries on camera unit

- rotate knob on battery door as counter clockwise direction to open battery door.
- insert correctly 4 x AA batteries into compartment according to polarity marking.
- Rotate knob on battery door as clockwise direction to close battery door.

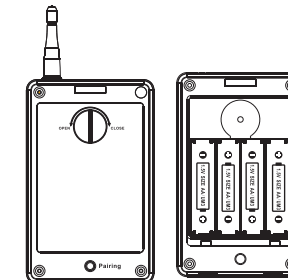

FCC Statement

This device complies with Part 15 of the FCC Rules.

Operation is subject to the following two conditions:

- (1) This device may not cause harmful interference, and
- (2) This device must accept any interference received, including interference that may cause undesired operation.

Note: The manufacturer is not responsible for ANY interference, for example RADIO or TV interference, caused by unauthorized modifications to this equipment. Such modifications could void the user ' authority to operate the equipment.