

RF exposure statement

This equipment complies with the FCC radiation exposure limits set forth for an uncontrolled environment. This transmitter must not be co-located or operating in conjunction with any other antenna or transmitter.

FCC Warning

This device complies with Part 15 of the FCC Rules. Operation is subject to the following two conditions:
(1) This device may not cause harmful interference, and (2) this device must accept any interference received, including interference that may cause undesired operation.

Note: This equipment has been tested and found to comply with the limits for a Class B digital device, pursuant to part 15 of the FCC Rules. These limits are designed to provide reasonable protection against harmful interference in a residential installation. This equipment generates, uses and can radiate radio frequency energy and, if not installed and used in accordance with the instructions, may cause harmful interference to radio communications. However, there is no guarantee that interference will not occur in a particular installation. If this equipment does cause harmful interference to radio or television reception, which can be determined by turning the equipment off and on, the user is encouraged to try to correct the interference by one or more of the following measures:
—Reorient or relocate the receiving antenna.
—Increase the separation between the equipment and receiver.
—Connect the equipment into an outlet on a circuit different from that to which the receiver is connected.
—Consult the dealer or an experienced radio/TV technician for help.

NOTE 2: Any changes or modifications to this unit not expressly approved by the party responsible for compliance could void the user's authority to operate the equipment.

DD118B

Wind-sun Sensor Instruction

Version: A/03

Product Features

Note: 1,Pls make sure that the wind-sun sensor have been paired to the receiver.
2,pls make sure when press UP button, the awning will be retracted.

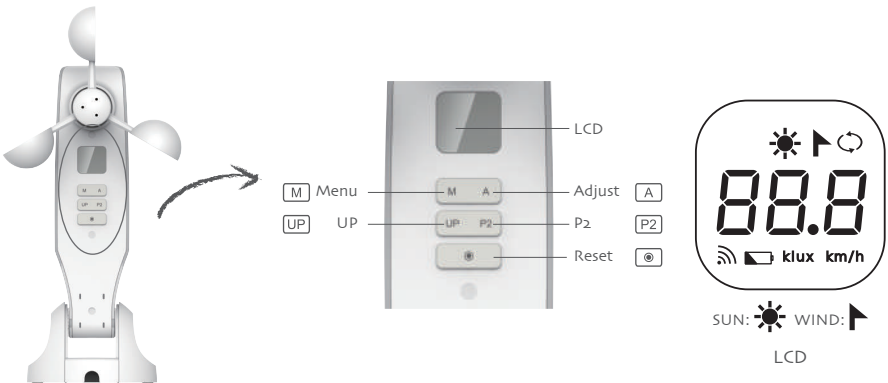

Technical specification

Working voltage: DC 3.7V	Working temperature: -10℃~+60℃	Working current: <20mA
Radio frequency: 433.92MHz	Radio range: outdoor >100 meters, indoor >40 meters	
Safety code (50 million times without repeat, high security)		

Warning

- 1, Stable performance, wireless remote control, solar powered, Type-C charging.
- 2, Check the voltage once a day. When the voltage is lower than 2.7V, a small battery icon is displayed to indicate low voltage.
- 3, The sensor can be fixed to the wall with two screws.
- 4, Adjustable wind intensity range: 0~180Km/h; sunlight intensity range: 0~100Klux.
- 5, Once the wind intensity exceeds the setting level, the sensor will send signals to the motor automatically to close the awning within 3s.
- 6, When the sunlight intensity exceeds the setting level continuously more than 2 minutes, the sensor will send signals to open the awning and will not detect the sunlight intensity within 15 minutes; when the sunlight intensity hasn't less than the setting level continuously more than 15 minutes, the sensor will send signals to close the awning.
- 7, The LCD display screen will be ON for 30s. The LCD screen will turn off after 30s without any press while the programming keeps running at the background; Press any button(except reset button) to turn on the LCD screen for 30s.

Matchable Motors And Emitters

Uni-directional mode

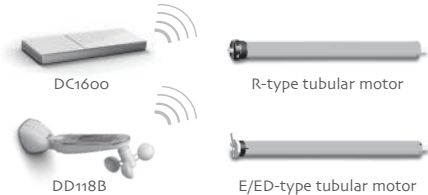

Bi-directional mode



Matchable Receivers

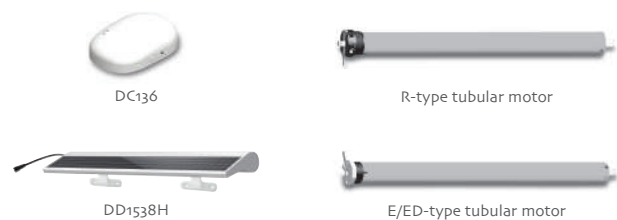

Wind-sun Sensor Working Principle

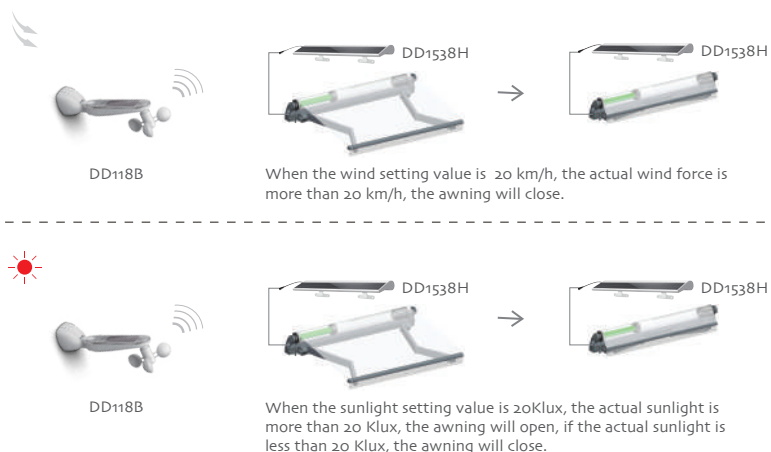

Correct Installation Method

Note: Installation must keep the sun blades at the horizontal level (as below picture).

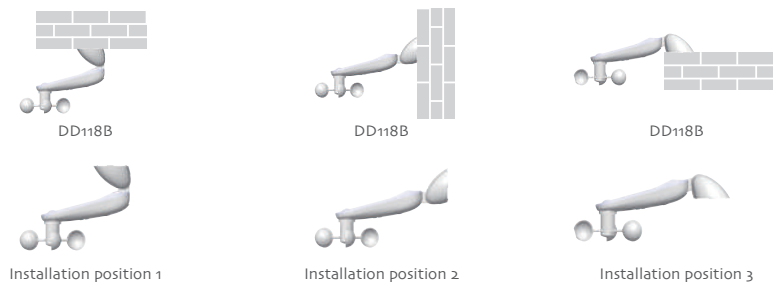

View The Data Of Wind-sun Sensor

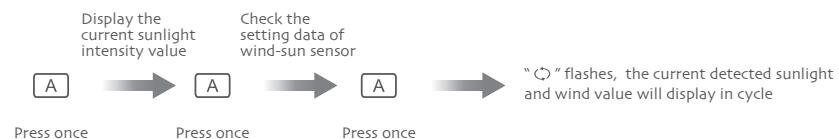

Checking The Setting Level Of Wind-sun Sensor

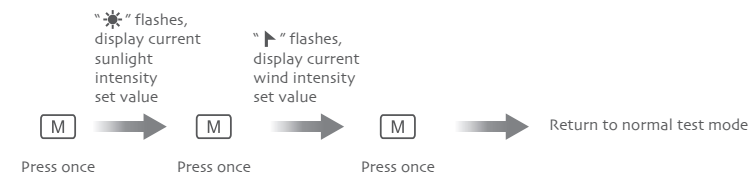

Setting The Wind And Sun Intensity Level

Note: 1, Long press [A] the decimal value will decrease faster, long press [UP] will increase faster.
2, Under the setting status, the corresponding setting value will flash, press [A] to change the setting value.
3, Under the setting status, if there is no any operation within 10s, the display will return to normal.

