

CONNECTIONS WITH SPEAKERS AND EQUIPMENT

1. Connection with sound resource equipment

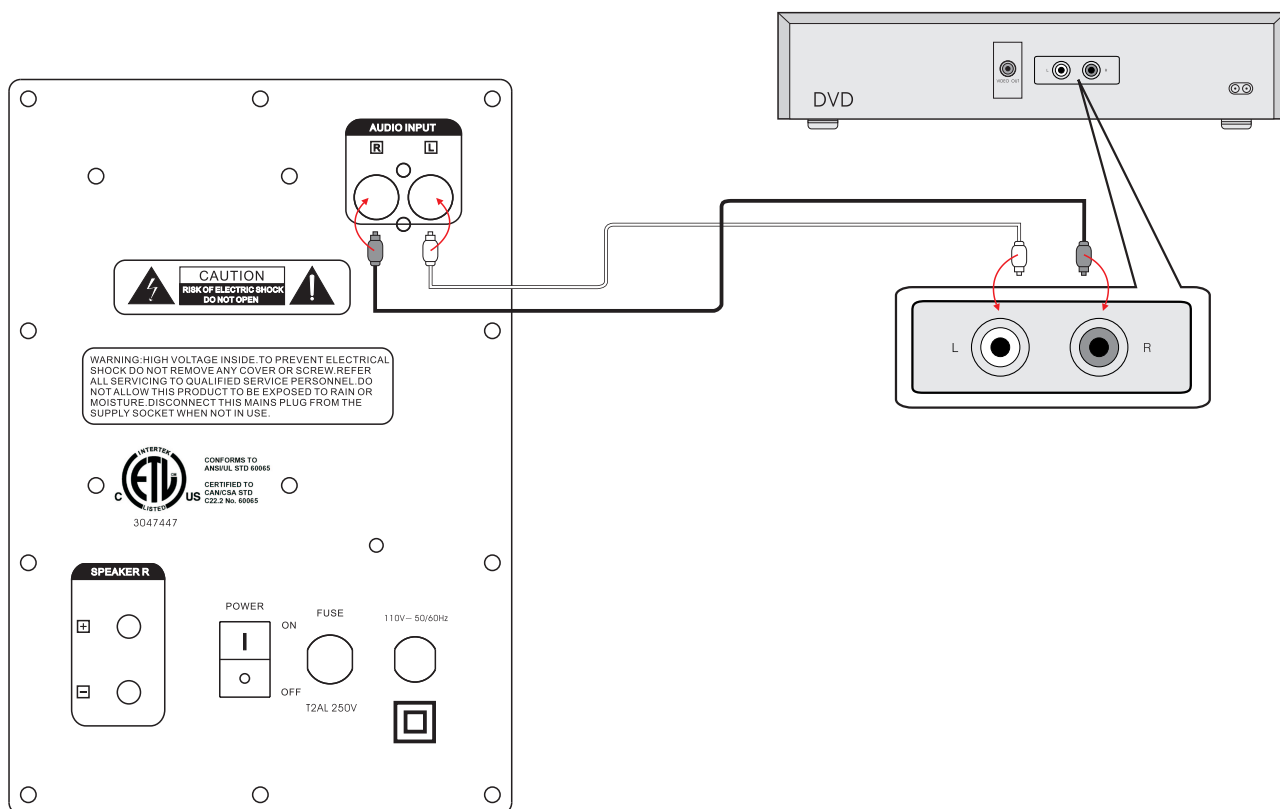

2. Connection with speakers

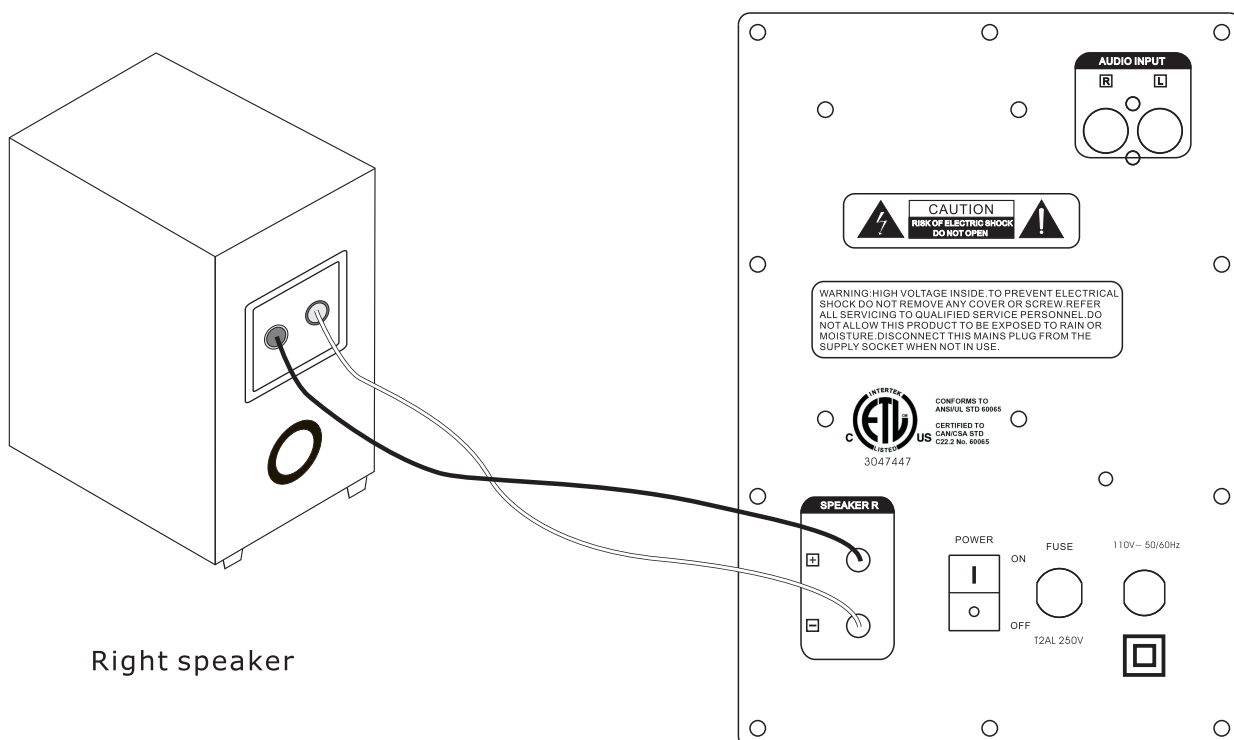

OPERATION INSTRUCTIONS

Connect the audio input source with the RCA cable to the system.

A. Power On/Off

- Connect the power cord of BT900 to the wall power socket. Press the Power Switch to "ON", and the LED on the front panel will flash 4 times, the system will go into operation status. Switch to "OFF" to turn off the system.
- If the system is not in use for prolong period, unplug the power cord.

B. Input Selection

- When only AUX input is connected, BT900 will automatically output AUX sound source.
- When both AUX and Bluetooth input are connected, the system will set Bluetooth signal in priority as default.

C. Bluetooth Application (applicable for devices (e.g. cell phone, laptop etc) with Bluetooth Stereo Audio

- Press and hold the "Pairing" button on the front panel for 3 seconds, BT900 will start pairing process with your Bluetooth device. Pairing time will last for 1 minute.
- Under pairing condition, the LED will flash in a faster mode.
- When your Bluetooth equipment successfully searched the system, please enter password "0000" for connection.
- To disconnect, either disconnect from your Bluetooth device, or press and hold the "Pairing" button again for 3 seconds.
- If Bluetooth signal does not disconnect while BT900 is power off, then it will automatically pair with the previous Bluetooth device when switching Power On again.

D. Volume Control

- Press the Vol+ or Vol- button on the front panel to adjust the volume of the system.

Note: Please unplug the power supply in case of long-time idle status.

TROUBLE SHOOTING

In case of malfunction, please power off the system immediately and check the unit according to following table. If the problem still exists, please contact the dealer or the manufacturer.

Problem	Cause	Solution
No sound	<ul style="list-style-type: none">◇ Improper connection of speaker terminal.◇ Improper connection of sound frequency terminal.◇ Improper connection of AC plug and the socket.◇ Volume is too low.◇ The speaker terminal is short-circuited.	<ul style="list-style-type: none">◇ Ensure that the equipment is connected properly.◇ Ensure that the sound frequency is connected properly.◇ Insert the AC plug securely into the AC outlet.◇ Increase the volume with volume controlling button.◇ Cut off power, reconnect the speaker, then start the power again.

TROUBLE SHOOTING

Problem	Cause	Solution
Sound distortion	<ul style="list-style-type: none"> ◇ Improper connection of amplifier input terminal. ◇ The volume is too high. 	<ul style="list-style-type: none"> ◇ Ensure that the input terminal is connected properly. ◇ Lower the volume with volume controlling button.
Sound only from one channel	<ul style="list-style-type: none"> ◇ Improper connection of amplifier input terminal. ◇ Input level is too high. 	<ul style="list-style-type: none"> ◇ Ensure that the input terminal is connected properly. ◇ Adjust the each channel volume properly.

MAIN SPECIFICATIONS

1、System specifications

Rated output power (THD≤2%) :18W/6Ω × 2

Max. Power:35W/6Ω × 2

Frequency resonance range:40Hz~20KHz

Power requirement:110V~ 50/60Hz

2、Speaker size (H×W×D) :340×180×275 mm

3、Package size (H×W×D) :420×461×346 mm

4、Power consumption:≤85W

5、Gross weight:14.2kg

Notes:

- 1.The specifications listed above are for reference only.
- 2.The technical specifications of this device are subject to changes without prior notice.



[Http://www.koda.com.cn](http://www.koda.com.cn)

Standard complied with: SJ/T 11217-2000

GUANGZHOU HUADU KODA ELECTRONIC CO.,LTD

Tel:(020)36860380 36860655