

AWSBT10



AR[®] portable wireless speaker **quick start guide**

Welcome

Congratulations on your purchase of this Acoustic Research Premier Series speaker, the ultimate in stereo-capable wireless sound.

This speaker offers two setup options:



Single-Speaker setup for one Premier speaker



Stereo setup for two Premier speakers

This guide takes you through the steps for either setup option.

Instructions en français	9
Instrucciones en español.....	17

Unpack

Make sure the following items came in this package.

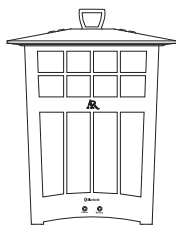

Wireless speaker

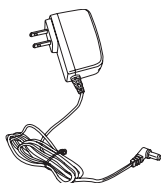

AC power adapter

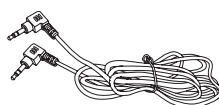

3.5mm AUX in cable

Getting to know Bluetooth

Bluetooth wireless is a quick and easy way to connect a smartphone to a speaker or a headset. There are basically two steps to making Bluetooth work.

PAIRING:

The two devices get to know each other.

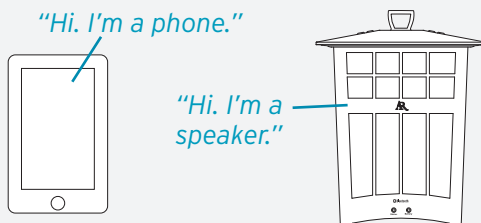

CONNECTING:

The two devices do something together (like play music).

This guide takes you through the steps to get started.

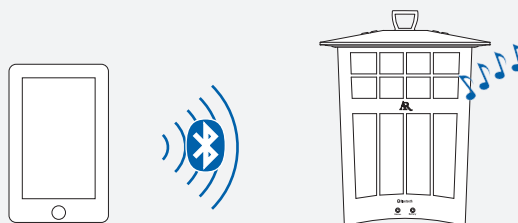



Single-Speaker Setup

- 1 Set the **Left-Mono-Right** switch to **Mono**.

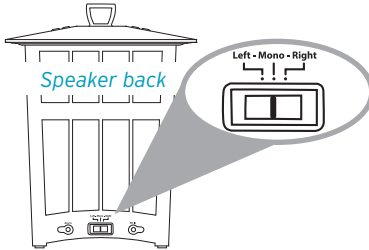

Note: Even though this speaker comes from the factory charged, it's a good idea to recharge it fully before using it for an extended period of time. See page 7 for info on recharging the speaker.

- 2 Press the  button on top of the speaker to turn it on.

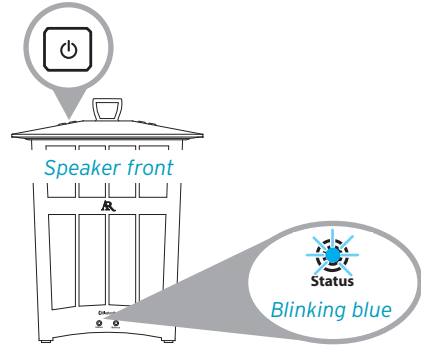

The **Status** light on the front of the speaker blinks blue.

- 3 Enable Bluetooth on your device (if it isn't already on).



Notes:

Make sure the **Status** light on the front of the speaker is blinking blue. (If it isn't, press and hold the **Pair** button on top of the speaker until the speaker gives an audio signal.)

If you've previously paired a different Bluetooth device with this speaker, the speaker will automatically attempt to reconnect to that device when you switch the speaker on. If you want to pair to a new device, press and hold the **Pair** button on the speaker until the speaker gives an audio signal.

- 4 Select **AR Speaker** from the list of Bluetooth devices available.

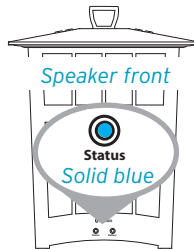
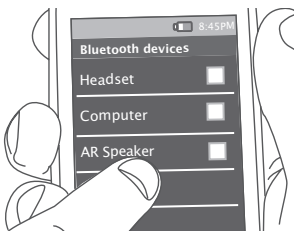

Notes: If you don't see **AR Speaker** in the list of Bluetooth devices on your phone, choose "Scan" from your phone's Bluetooth menu.

The process of enabling Bluetooth and connecting varies from device to device. See your device's owners manual for more information and specific instructions.

The speaker gives an audio signal when it's finished connecting to your smartphone. The **Status** light on the front of the speaker turns solid blue.



Single-Speaker Setup

5

Start playing music on your Bluetooth device.

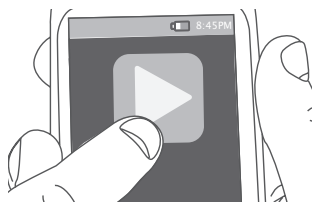

The speaker starts streaming your music wirelessly.

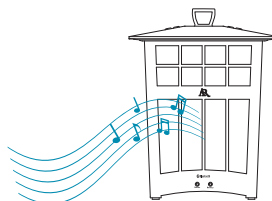

Note: Make sure your device's volume is set to at least 75%.

To control the volume, press the **+** and **-** buttons on top of the speaker, or use the volume controls on your Bluetooth device.

Bluetooth Wireless Connection Tips

- Make sure the Bluetooth capability of your device is turned on.
- Make sure there's nothing plugged into the speaker's **Aux In** jack when you're trying to use Bluetooth.
- The Bluetooth wireless connection works up to a range of roughly 33 feet (10 meters). This range may vary, however, based on other factors, such as room layout, wall material, obstacles, your device's Bluetooth performance, etc. If you're having problems connecting to the speaker, move closer to it.
- If your device asks you for a password to connect, use "0000".



Stereo Setup

If you have two speakers...

1

Set the **Left-Mono-Right** switch on one speaker to **Left**.

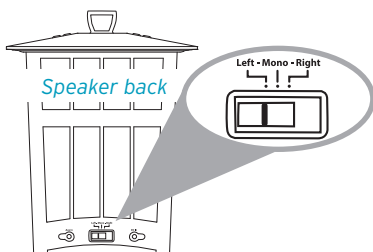

Set the **Left-Mono-Right** switch on the other speaker to **Right**.

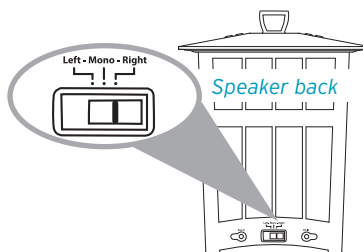

2

Press the  button on top of the left speaker to turn it on.

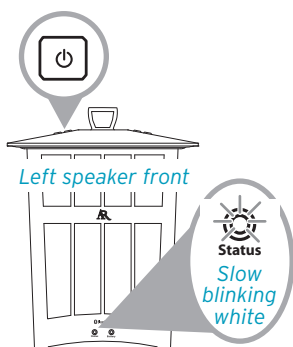

The **Status** light on the front of the left speaker blinks white slowly.

Press the  button on top of the right speaker to turn it on.

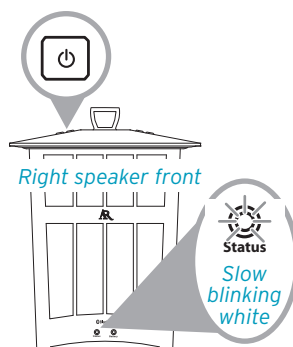

The **Status** light on the front of the right speaker blinks white slowly.

3

Wait for the **Status** light on the right speaker to turn solid white.

Left speaker



Right speaker



The **Status** light on the left speaker will start blinking white faster.

This means the two speakers are linked for stereo and ready to pair with your Bluetooth device.

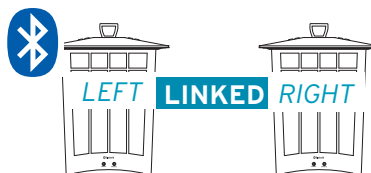

Continues on the next page...



Stereo Setup

If you have two speakers...

- 4 Enable Bluetooth on your device (if it isn't already on).

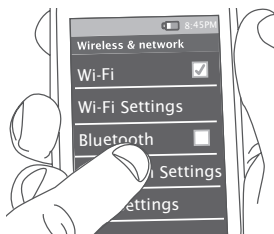

Make sure the **Status** light on the front of the left speaker is fast-blinking white. (If it isn't, press and hold the **Pair** button on top of the left speaker until the speaker gives an audio signal.)

Note: If you've previously paired a different Bluetooth device with this speaker, the speaker will automatically attempt to reconnect to that device when you switch the speaker on. If you want to pair to a new device, press and hold the Pair button on the speaker until the speaker gives an audio signal.

- 5 Select **AR Stereo** from the list of Bluetooth devices available.

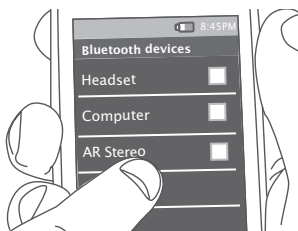

The left speaker gives an audio signal when it's finished connecting to your smartphone. The **Status** light on the front of the speaker turns solid white.

Left speaker



Status

Solid white

If you don't see **AR Stereo** in the list of Bluetooth devices on your phone, choose "Scan" from your phone's Bluetooth menu.

Note: The process of enabling Bluetooth and connecting varies from device to device. See your device's owners manual for more information and specific instructions.

- 6 Start playing music on your Bluetooth device.

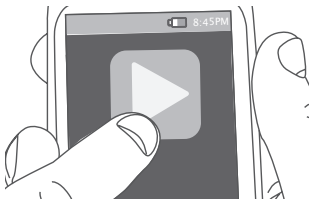

The speakers start streaming your music wirelessly, in True Stereo.

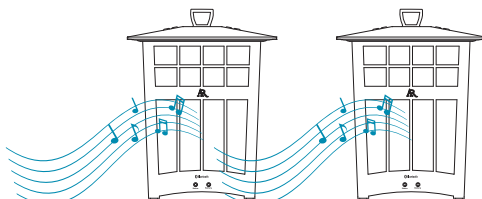

Note: Make sure your device's volume is set to at least 75%.

To control the volume, press the + and - buttons on top of the left speaker, or use the volume controls on your Bluetooth device.

Using the AUX input

Use the audio cable included with this speaker to connect the audio output from your device to the **Aux In** audio input on the speaker's back panel (you might need to open the rubber flap protecting the jack). The speaker automatically switches to the **Aux In** audio. The **Status** light on the front of the speaker turns white if you're using a single speaker. It turns blue if you're using two in stereo mode.

To listen to Bluetooth audio again, unplug the cable from the speaker's **Aux In** jack.

Speaker back

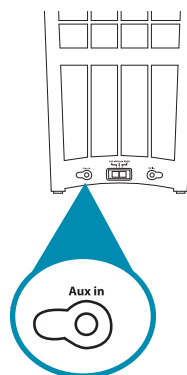

Recharging the speaker

The speaker's built-in rechargeable battery comes from the factory with a charge, so you can start using the speaker as soon as you get it out of the box. After you've used it for a while, you'll need to recharge the speaker's battery.

To recharge the speaker: Plug the included AC cable into the **DC In** jack on the back of the speaker.

Plug the other end of the adapter into a power outlet.

The **Battery** indicator on the front of the speaker is red while the speaker is charging. It turns green when the speaker is fully charged.

Note: You can use the speaker while it's charging.

Speaker back

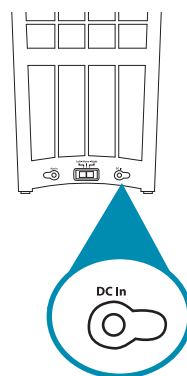

Tour of the Premier Series wireless speaker

Front

Status indicator shows the connection status of the speaker.

	<i>Status Indicator</i>	<i>Speaker status</i>
SINGLE-SPEAKER MODE	Solid blue	Connected via Bluetooth
	Fast blinking blue	Ready to pair via Bluetooth
	Slow blinking blue	Reconnecting via Bluetooth
	Solid white	Connected via the Aux in jack

	<i>Status Indicator, Speaker</i>	<i>Speaker status</i>
STEREO MODE	Solid white, right speaker	Linked with the left speaker for stereo
	Solid white, left speaker	Both speakers are connected via Bluetooth
	Slow blinking white, right speaker	Linking with the left speaker
	Slow blinking white, left speaker	Reconnecting via Bluetooth
	Fast blinking white, left speaker	Ready to pair with your device via Bluetooth
	Solid blue, left speaker	Connected via the Aux in jack

Battery is solid red when charging and turns green when fully charged.

Top

⏻ (Power) button turns the speaker on and off.

Pair button initiates pairing with a Bluetooth device.

- and **+** buttons increase or decrease the volume of the speaker's audio.

Back

Aux In jack lets you connect directly to the speaker to listen to an audio source.

Left-Mono-Right switch lets you set up two speakers as a stereo pair (Left and Right). Otherwise, this switch should be set to Mono.

DC In jack connects to the AC adapter provided to charge or power the speaker.