

<i>LABEL, FCC</i>				54-031637-A	
REV	ECO	DESCRIPTION		DATE	IN
A0		RELEASED		06/25/07	RI

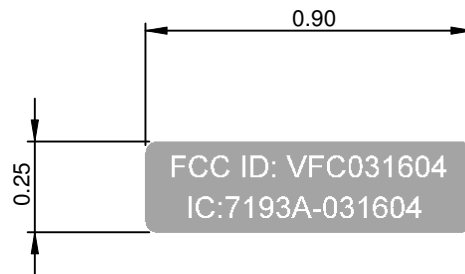

MATERIAL:

PRESSURE SENSITIVE WHITE POLYESTER LABEL STOCK,
PERMANENT ADHESIVE WITH SPLIT BACKING OR ROLL FORM.
(TYCO# WP-229064-10-9)

COLOUR:

WHITE MARKINGS ON BLACK BACKGROUND

RIBBON:

WEBER ULTRA PLATE II #620256

NOTES:

1. REVISIONS TO THE SPECIFICATIONS STATED HEREIN MUST BE APPROVED BY ETRATECH ENGINEERING.

PROPRIETARY RIGHTS ARE INCLUDED IN THE INFORMATION DISCLOSED HEREIN. THIS INFORMATION IS SUBMITTED IN CONFIDENCE AND NEITHER THIS DOCUMENT NOR THE INFORMATION DISCLOSED HEREIN SHALL BE REPRODUCED OR TRANSFERRED TO OTHER DOCUMENTS OR USED OR DISCLOSED TO OTHERS FOR MANUFACTURING OR OTHER PURPOSE EXCEPT AS SPECIFICALLY AUTHORIZED IN WRITING BY ETRATECH INC.

DIMENSIONS ARE IN INCHES		DO NOT SCALE PRINTS TOLERANCES: 3 PLACES = $\pm 0.005"$ 2 PLACES = $\pm 0.010"$ ANGULAR = $\pm 1^\circ$					
DRAWN BY ROB INFANTI		DATE 06/25/07		SCALE 2:1		SHEET 1 OF 1	
				CHECKED		APPROVED	
DESCRIPTION <i>LABEL, FCC</i>						DWG NO A 54-031637-A	

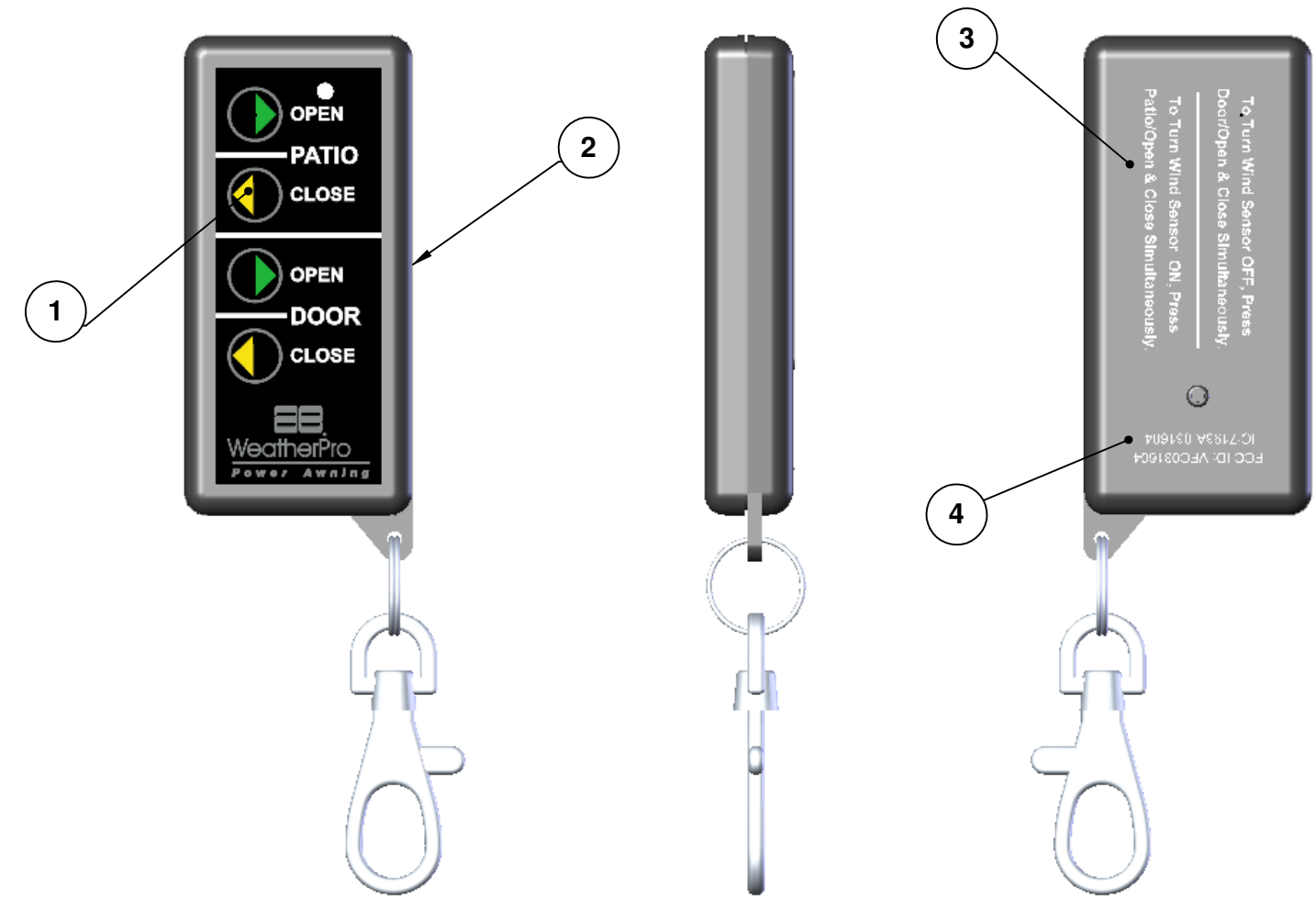

KEY FOB CONTROL ASSEMBLY.

02-031618-A

REV	ECO	DESCRIPTION	DATE	IN
A0	949	RELEASED	06-05-19	AP
A1		ADDED FCC LABEL	06-06-07	RI

NOTES

1. REVISIONS TO SPECIFICATIONS STATED HEREIN MUST BE APPROVED BY ETRATECH ENGINEERING.

4	54-031637-A	LABEL, FCC	1
3	54-031603-A	LABEL, KEY FOB.	1
2	03-011704-A	KEY FOB, RF TRANSMITTER MODULE.	1
1	52-011702-B	INLAY, WEATHER PRO KEY FOB.	1
ITEM	PART NO.	DESCRIPTION	QTY
DIMENSIONS ARE IN INCHES		<div><div></div><div></div></div> <div><div></div><div>AND MANUFACTURING</div></div>	
DO NOT SCALE PRINTS			SolidWorks
DRAWN BY ANDREW PRZYBYSZ		DATE 06-05-24	CHECKED APPROVED
SCALE 1:1		TOLERANCES: 3 PLACES = ± 0.005" 2 PLACES = ± 0.010" ANGULAR = ± 1°	
SHEET 1 OF 1		CUSTOMER PART # 3307906.044	
DESCRIPTION KEY FOB CONTROL ASSEMBLY.			B DWG NO 02-031618-A