

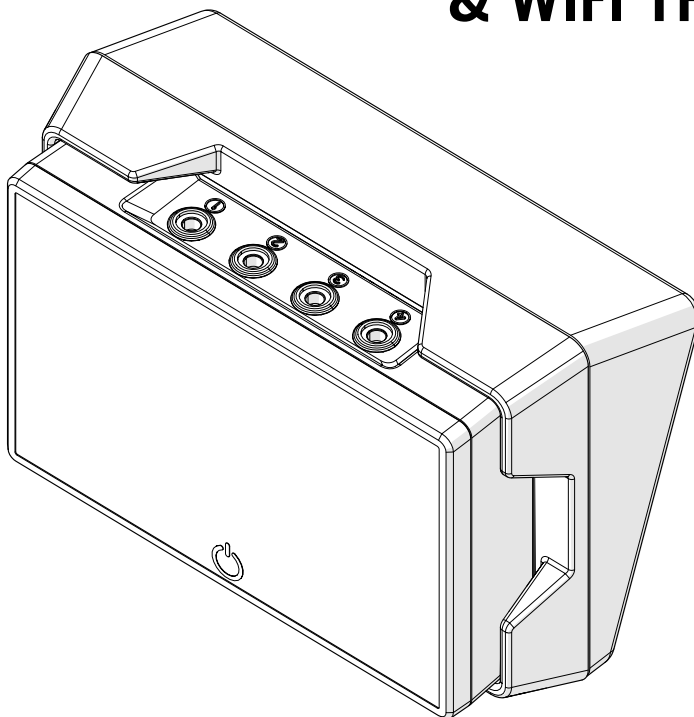

INSTALLATION AND OPERATION MANUAL

SIDEKICK BLUETOOTH & WIFI THERMOMETER



SAFETY INFORMATION

WARNING

- Do not place the Sidekick Thermometer on hot or magnetic surfaces or inside any appliances.
- The display unit and probe cords should never be immersed in water.
- Use a heat-resistant glove to touch the cords or stainless steel probes during cooking.
- Do not try to clean the probes without reading the "cleaning and maintenance" instructions in this manual.
- Do not operate the probe and cables to temperatures outside the range of -4° F (-20° C) to 572° F (300° C).

safety handling

WARNING

- Failure to follow these safety notices could result in fire, electric shock, other injuries, or damage to the thermometer and other property. Read all the safety notices below before using the thermometer.

- Avoid high humidity or extreme temperatures.
- Avoid long exposure to direct sunlight or strong ultraviolet light.
- Do not drop or expose the unit to intense vibration.
- Do not disassemble or try to repair the unit on your own.
- Do not expose the unit or its accessories to flammable liquids, gases, or other explosives.

Product Name	Model Number	FCC ID	IC ID
Sidekick Bluetooth and WiFi Thermometer	70079	VA870079	7114A-70079

This device complies with Part 15 of the FCC Rules. Operation is subject to the following two conditions: 1) The device may not cause harmful interference; and 2) the device must accept any interference received, including interference that may cause undesired operation. Changes or modifications not expressly approved by the party responsible for compliance could void the user's authority to operate the equipment.

FCC Compliance: This equipment has been tested and found to comply with the limits for a Class B digital device, pursuant to Part 15 of the FCC Rules. These limits are designed to provide reasonable protection against harmful interference in a residential installation. This equipment generates, uses, and can radiate radio frequency energy and, if not installed and used in accordance with the instructions, may cause harmful interference to radio communications. However, there is no guarantee that interference will not occur in a particular installation.

If this equipment does cause harmful interference to radio or television reception, which can be determined by turning the equipment off and on, the user is encouraged to try to correct the interference by one or more of the following measures:

- Reorient or relocate the receiving antenna.
- Increase the separation between the equipment and receiver
- Connect the equipment into an outlet on a circuit different from that to which the receiver is connected.
- Consult the dealer or an experienced radio/TV technician for help.

This equipment complies with FCC radiation exposure limits set forth for an uncontrolled environment. This equipment should be installed and operated with a minimum distance of 20cm between the radiator & your body. This transmitter must not be co-located or operating in conjunction with any other antenna or transmitter.

ISED Canada Statement

This device contains license-exempt transmitter(s)/receiver(s) that comply with Innovation, Science and Economic Development.

Canada's license-exempt RSS(s). Operation is subject to the following two conditions:

- 1) This device may not cause interference; and
- 2) This device must accept any interference, including interference that may cause undesired operation of the device.

Radiation Exposure: This equipment complies with Canada radiation exposure limits set forth for an uncontrolled environment.

RF Exposure Statement:

To maintain compliance with IC's RF Exposure guidelines, This equipment should be installed and operated with minimum distance of 20cm the radiator your body. This device and its antenna(s) must not be co-located or operation in conjunction with any other antenna or transmitter.

Déclaration de l'ISED Canada

Cet appareil contient des émetteurs/récepteurs exempts de licences conformer à l'innovation, la science et le développement économique.

Les RSS du Canada exemptes de licence. Leur fonctionnement suivant deux conditions:

- 1) cet appareil ne peut pas causer d'interférences; et
- 2) ce dispositif doit accepter toute interférence, y compris peut provoquer le fonctionnement indésirable de l'appareil.

Exposition aux rayonnements: Cet équipement est conforme aux radiations du Canada limites d'exposition pour un environnement incontrôlé.

Déclaration d'Exposition RF

Pour maintenir le respect des guides d'exposition RF d'IC, équipement doit être installé et actionné avec une distance minimale de 20cm le radiateur de votre corps. Cet appareil et ses antennes ne doivent pas être co-localisé ou en opération en conjonction avec toute autre antenne ou émetteur.

table of contents

1.0	welcome	5
1.1	in the box	5
1.2	features	6
1.3	where the Sidekick Thermometer may be used	6
1.4	compatible devices	6
1.5	screen overview	6
2.0	quick start instructions	7
3.0	Napoleon Home App	9
4.0	app overview	11
4.1	first download use	11
4.2	set probe (guided cook)	11
4.3	set probe (manual)	12
4.4	set probe (previous grill)	12
4.5	temperature alert	13
4.6	add temperature alert	13
4.7	add timer	14
4.8	save grill	14
4.9	settings	15
4.10	end grill	15
5.0	cleaning and maintenance	16
5.1	safeguards	16
5.2	check clearance prior to cooking	16
6.0	important information	17
6.1	intended use	17
6.2	battery disposal	17
6.3	battery safety information	17
6.3.1	storage & transportation	17
6.3.2	voltage, capacity, capacity in watts	17
7.0	troubleshooting	18
8.0	warranty	19



WARNING: This product can expose you to chemicals including chromium, which are known to the State of California to cause cancer, and chemicals including toluene, which are known to the State of California to cause birth defects or other reproductive harm. For more information, go to www.P65Warnings.ca.gov.

NOTE: The information throughout this manual is believed to be correct at the time of printing. Wolf Steel Ltd. reserves the right to change or modify any information within this manual at any time without notice. Changes, other than editorial, are denoted by a vertical line in the margin.

! WARNING

- **HOT SURFACE WARNING!** Avoid placing the Sidekick Thermometer on hot surfaces such as the lid or hood of your grill. Device is rated to 150° F (66° C).

The Napoleon Sidekick Thermometer allows you to program your type of meat, target temperature, and cooking time using your smart device with the Napoleon Home App. When your food is cooked to perfection, the thermometer will alert you on your smart device.

A digital thermometer will also help reduce the chance of dried, overcooked meat caused by cutting for a visual examination, and help make cooked food look more presentable. You do not need to wait by the grill to monitor the cooking status. This saves you time and leaves you free to attend to your guests. Download the Napoleon Home App and enjoy smart cooking (see "Napoleon Home App" section for more details)!

The Sidekick has both a Wifi and a Bluetooth function. When your default WiFi is not available, the Bluetooth function allows you to connect to the Sidekick with ease. See "quick start instructions" and "Napoleon Home App" sections for more information on connecting to Bluetooth.

Any use of such marks and logos as indicated are owned by the respective owners and any such use by Wolf Steel Ltd. is under license: Bluetooth® by Bluetooth SIG, Inc. Other trademarks and trade names are those of the respective owners: Android™ and Google Play™ are trademarks of Google Inc.; Apple, iPhone®, and the Apple App Store is a trademark of Apple Inc.; iOS is a trademark or registered trademark of Cisco Inc.

1.1 in the box

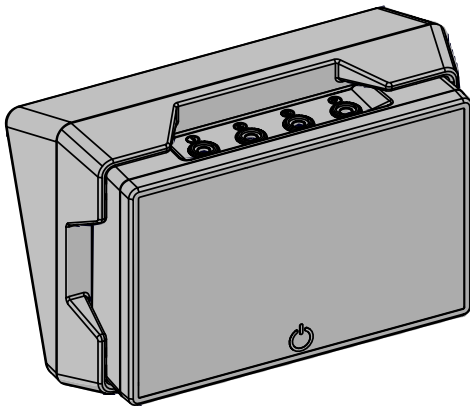

Sidekick Thermometer
with Outer Housing

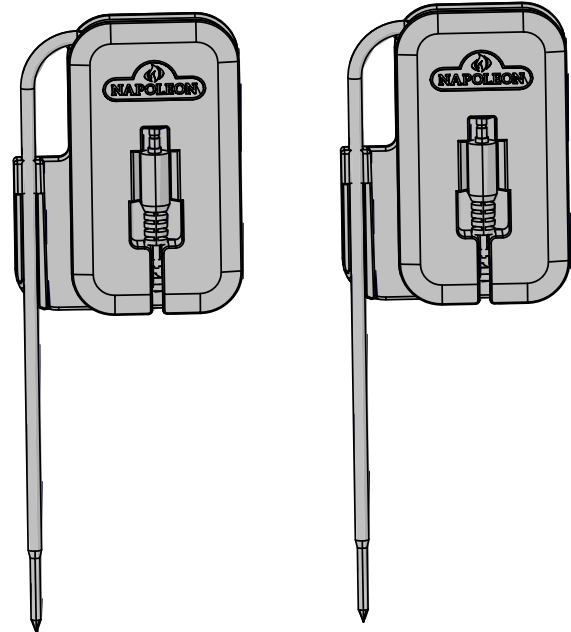

Temperature Probes
(x2)

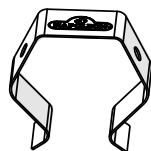

Grate Clip



Spacer

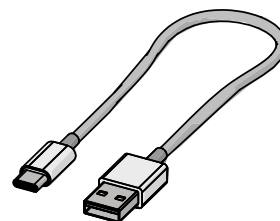

USB Cord

1.2 features

- 49.5" (125.73 cm) long water-resistant probes
- Cord wraps for tangle-free storage
- Measures food temperature from -4° F (-20° C) to 572° F (300° C).
- Magnetic mounting
- Temperature indication
- LCD display
- Custom temperature settings
- Manual shut-off
- Temperature readouts with or without Bluetooth connectivity
- WiFi functionality
- Bluetooth and Wifi switching (i.e., connectivity switching)

1.3 where the Sidekick Thermometer may be used

- Gas and electric stove tops
- Ovens, convection ovens
- Gas and electric grills
- Charcoal barbeques
- Smokers

1.4 compatible devices

The Napoleon Home App is designed to work with a wide range of Android and iOS devices, such as iPhone, iPad mini, and iPod. These include:

- Example
- Example
- Example
- Example
- Example

Device compatibility may not be guaranteed due to numerous different models and manufacturing standards.

1.5 screen overview



1



Down the Napoleon Home App (see "Napoleon Home App" section for more details) and make sure WiFi and Bluetooth are enabled in your smart device's settings.

NOTE: The Sidekick Thermometer can be used without the Napoleon Home App but only for the purposes of monitoring.

2

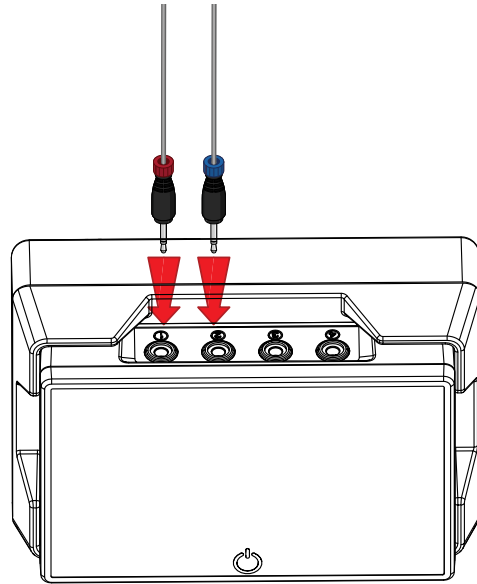

Remove the protective plastic and cling and plug one or more probes into your Sidekick Thermometer to power the unit on.

3

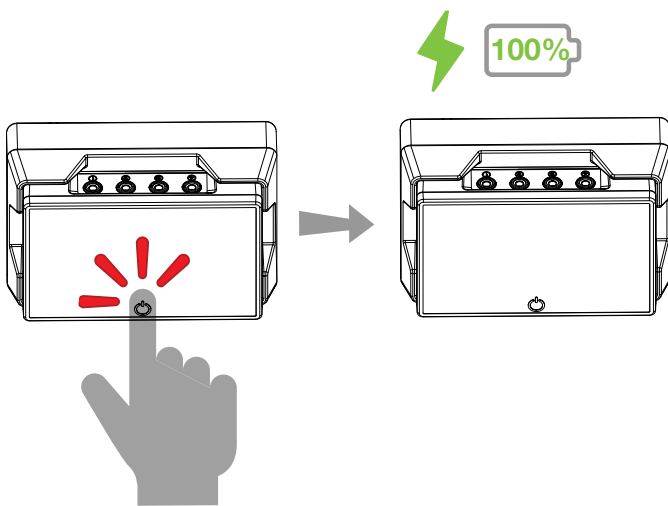

To check the battery status of your Sidekick Thermometer, press down on device when no probes are connected.

4

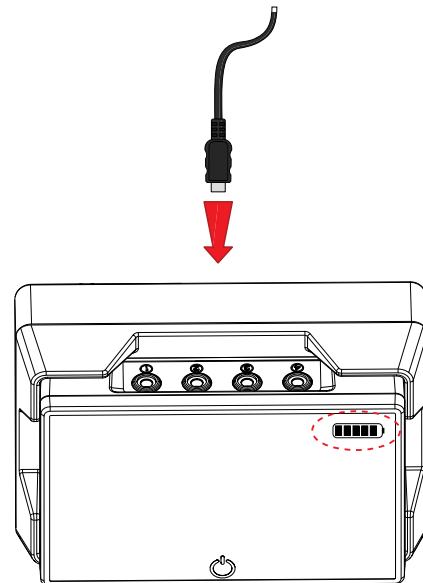

When needed, charge your Sidekick Thermometer until the charge icon is full.

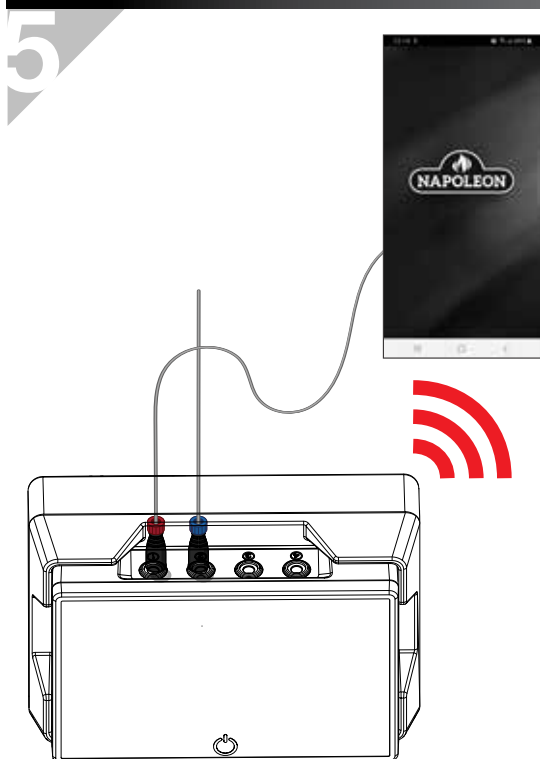

Open the Napoleon Home App on your smart device and make sure the Sidekick Thermometer is in range.

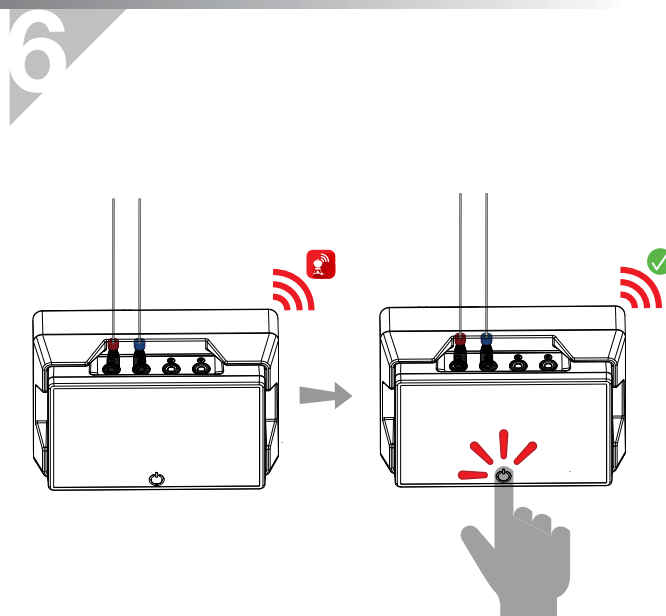

To finalize initial pairing with your smart device, press down on your Sidekick Thermometer for 5 seconds until it restarts.

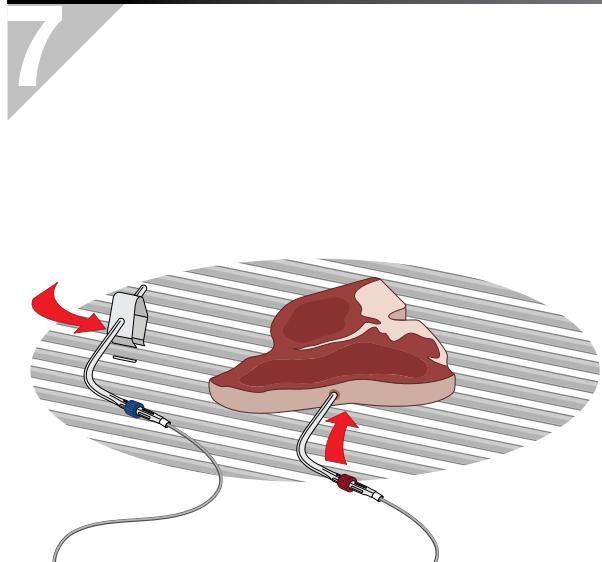

When using meat probes, ensure that the tip of the probe is inserted into the thickest section of the food, avoiding bones or fat.

When using ambient probes, ensure that the provided grate clip is properly secured to the cooking surface.

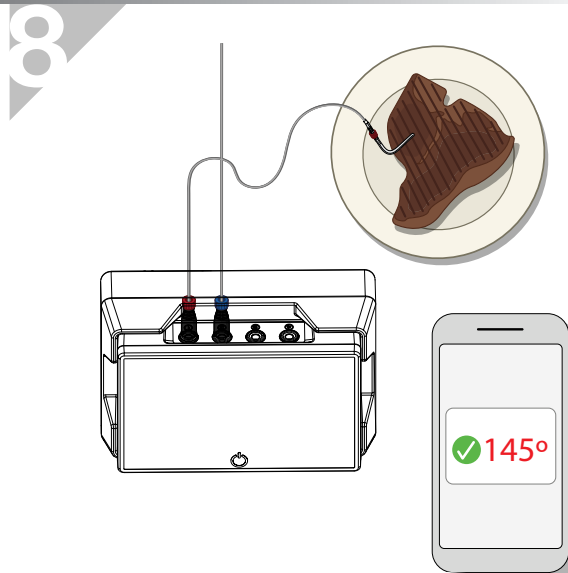

Follow the step-by-step grilling instructions in the Napoleon Home App. Enjoy your meal!

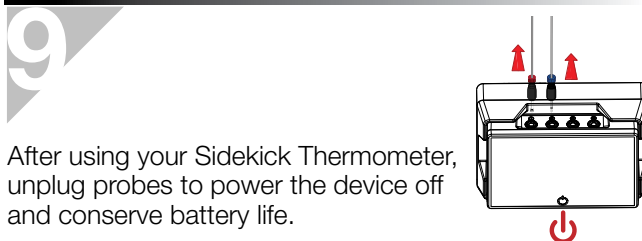

After using your Sidekick Thermometer, unplug probes to power the device off and conserve battery life.

HOW DOES IT WORK?

Access your appliance remotely by downloading the **Napoleon Home App** from your app store.

In order to access the app, you will be required to create an account by following the instructions listed within the app (see below for details).

By pairing your appliance to the **Napoleon Home App** via Wifi or Bluetooth, you can control to all modes and functions of the appliance.

All notifications and alarms are sent through the app to keep you connected with ease.



Scan this QR code for direct access to the **Napoleon Home App** website.

LET'S GET STARTED

1 DOWNLOAD



Download the **Napoleon Home App** from your app store (Google Play or Apple App Store).

Note: This requires Android 7.0 or iOS 11.0.

2 REGISTER



Register an account with the **Napoleon Home App** OR sign-in using your Facebook, Google, or Apple account information.

3 CREATE



Enter user information and create a password for the account. Select the country in which the appliance is located.

4 ALMOST THERE

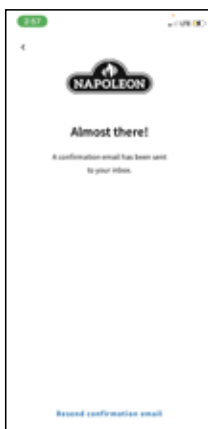

The information entered in Step 3 will be registered to the **Napoleon Home App** and a confirmation will be sent to the email provided.

5 CONFIRM

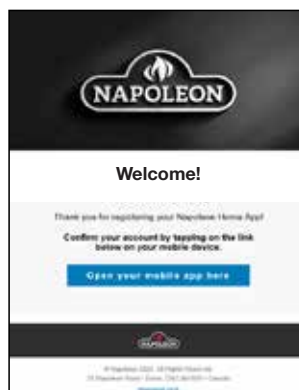

Open email inbox and select the confirmation link.

Note: The confirmation link must be opened on the device that the **Napoleon Home App** is installed on.

6 RE-CONFIRM

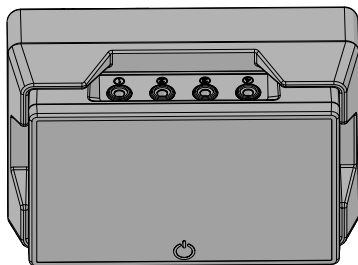

If no email is found, click "Re-Send Confirmation Link" and check junk folder.

ADDING A DEVICE**7 PLUG IN**

Ensure your appliance is plugged in and turned on.

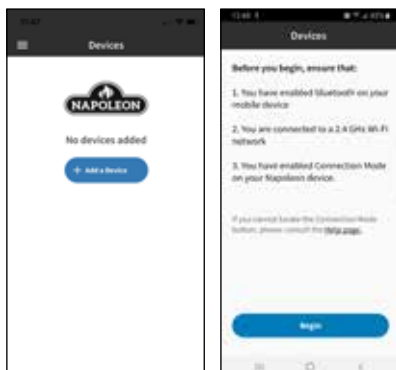
8 ADD DEVICE

Select "Add Device" and accept the permissions.

Ensure to turn on your WiFi and Bluetooth.

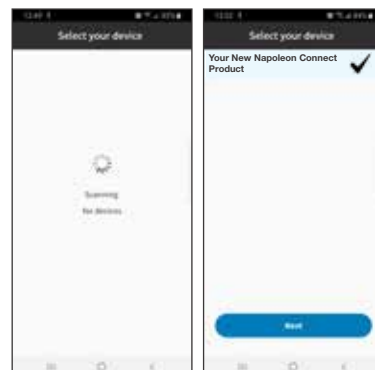
9 SEARCH

Search for devices and select the device from the list.

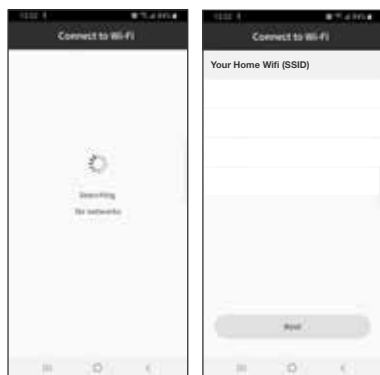
10 WIFI PASSWORD

Select your desired WiFi and connect by entering the WiFi password of your home.

11 ADD NICKNAME

Once the appliance has been connected to the access point, it can be given a nickname for recognizability.

12 SUCCESS

You are now connected!

4.1 first download use

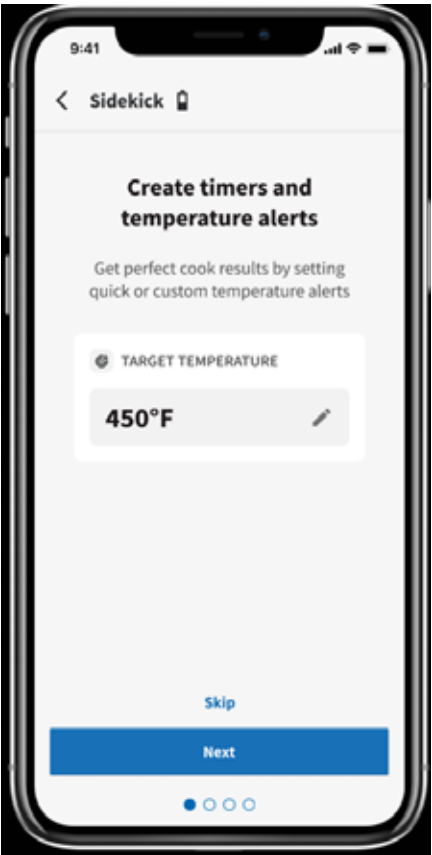

4.2 set probe (guided cook)



4.3 set probe (manual)

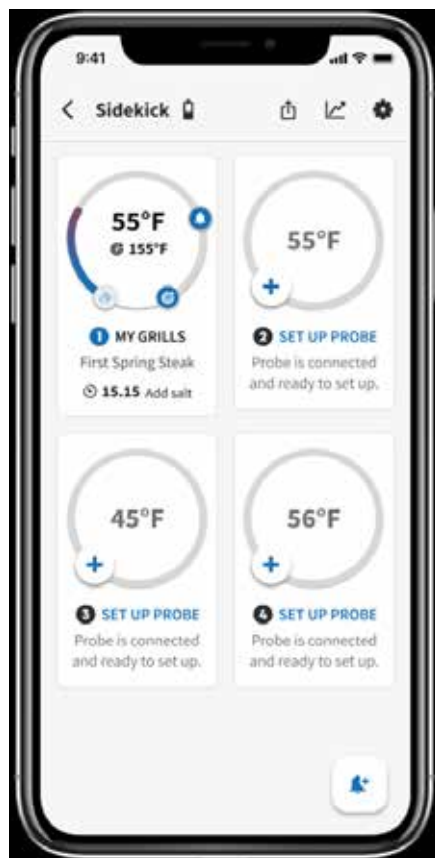

4.4 set probe (previous grill)

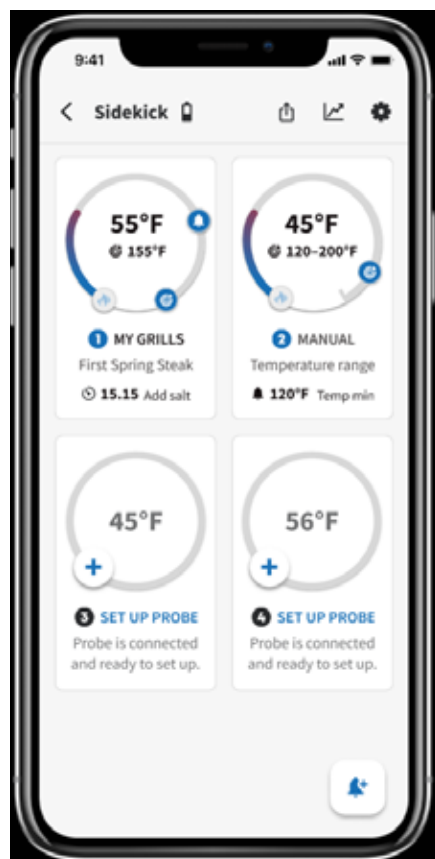

4.5 temperature alert

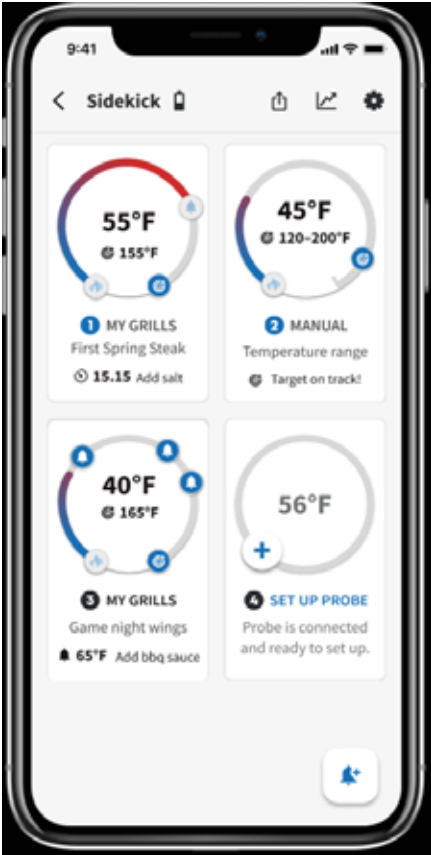

4.6 add temperature alert

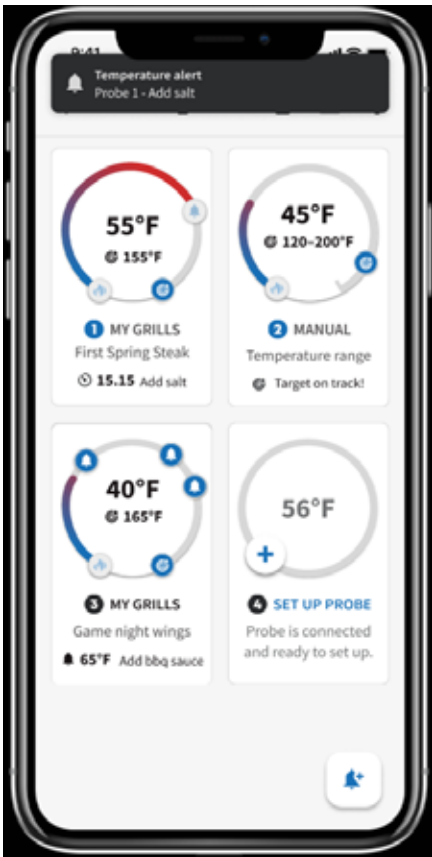

4.7 add timer

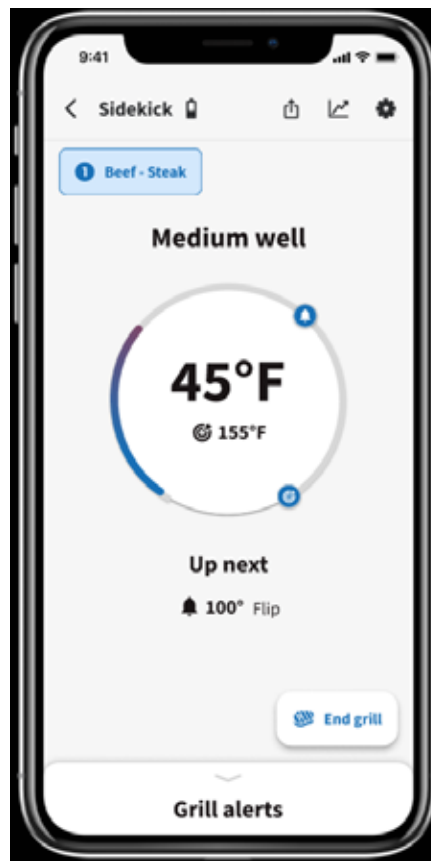
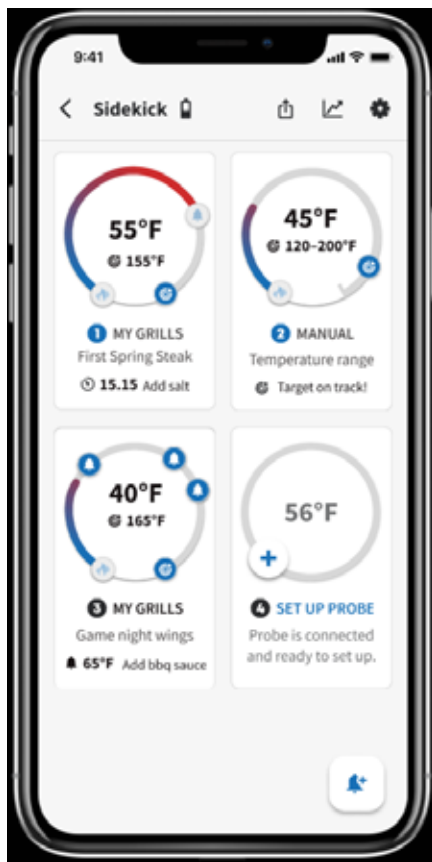

4.8 save grill

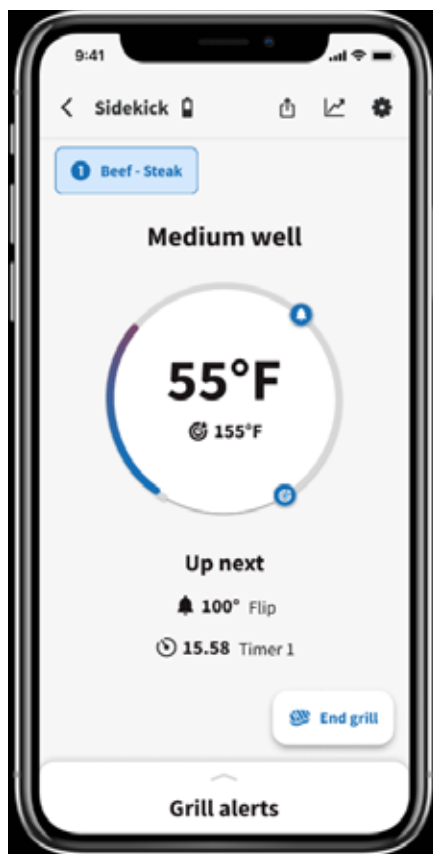

4.9 settings

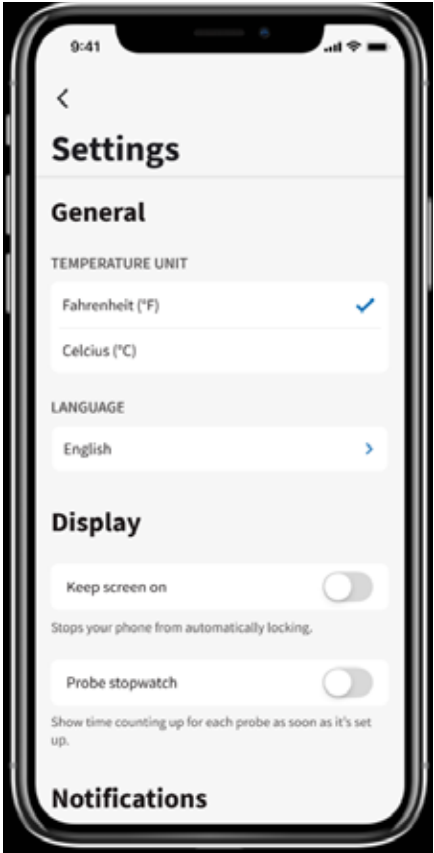

4.10 end grill

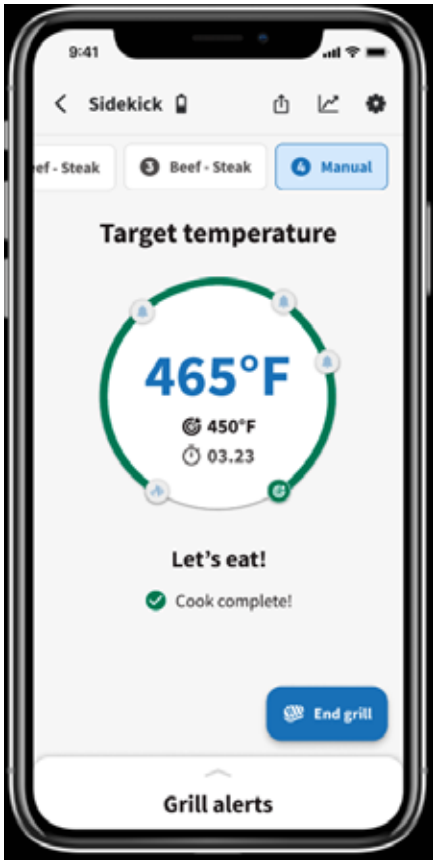

5.0 cleaning and maintenance

CAUTION



- Keep the stainless steel probe sensors and cords away from children. Use care when handling the probes. Always wear a heat resistant glove to touch the stainless steel probe sensors or cords during and right after cooking. Do not use probe cables or rings to move probes.
- Do not use the probes in microwave ovens or on a rotisserie.

- Clean the probes before using for the first time.
- Hand wash the metal portion of probes and dry thoroughly after each use. **Do not wash in a dishwasher.**

NOTE: The probe jacks, probe cables, and display unit are water resistant but should not be left in the rain. The appliance should never be immersed in water.

- Probes are rust-proof and corrosion resistant. Do not use any chemicals or cleaning solutions to clean the probes except mild soap.
- Use the cord wraps for tangle-free cord storage and to prevent kinks and folds.
- Store Sidekick Thermometer at ambient temperatures ranging from 32° F (0° C) to 95° F (35° C).

5.1 safeguards

- Probes can operate from -4° F (-20° C) to 572° F (300° C).
- Probe cords can operate within -4° F (-20° C) to 716° F (380° C).
- **IMPORTANT:** Do not allow the probes to be directly exposed to flames or temperatures exceeding 572° F (300° C).
- For accurate readings, insert the probes into the center of meat, ideally before it is placed on the grill.
- **IMPORTANT:** Point the tips of the probes downward but do not allow the tips to touch the grill grates. Also try to ensure that probes do not touch the grill.
- Place meat on the side of the grill closest to the thermometer.
- Position the cord at a high exit point so the cord stays sufficiently above the grill when the lid is closed.
- Alternatively, probe handles may be positioned under the lid seal. Ensure the sides of the grill do not exceed the highest operating temperature.
- When using more than one probe, colored probe rings can help identify the number of each probe. Place each ring around the probe tip and push until it reaches the base holder.

5.2 check clearance prior to cooking

Check that the cooking area does not exceed the maximum temperature and cords are not kinked or frayed by closed doors or lids.

First check the cord clearance at ambient temperature with the cooking unit closed; examine the cord for any severe kinking or bending.

Then turn the temperature unit on and use the probe to examine hot spots where the cord may make any surface contact.

6.1 intended use

Use this device only for measuring and monitoring the temperature of grilled items. Any use, other than that described, can cause damage. The manufacturer or retailer are not liable for damages arising from improper use. When using a Sidekick Thermometer, never leave your grill unattended and follow all instructions in your grill owner's guide.

NOTE: Do not modify/alter the Sidekick Thermometer.

NOTE: Do not throw or impact the Sidekick Thermometer.

NOTE: Do not submerge the Sidekick Thermometer.

NOTE: Do not put the Sidekick Thermometer in a microwave.

6.2 battery disposal

WARNING



Battery disposal! Never dispose of batteries in an open fire. Always dispose of batteries in accordance with local laws.

NOTE: The Sidekick Thermometer and its batteries are not designed to withstand high heat. If the surface is too hot to touch, it's too hot for the Sidekick Thermometer and its batteries.

NOTE: The device is not to be used by children or persons with reduced physical, sensory, or mental capabilities.

Frequency Range: 2402.0 - 2480.0 MHz.

Output Power: 0.0012 W.

6.3 battery safety information

IMPORTANT SAFETY INSTRUCTIONS AND WARNINGS FOR LITHIUM ION (LI-ION) BATTERIES:

- You must read these safety instructions and warnings before using or charging your Sidekick Thermometer.
- Li-Ion batteries are volatile. Failure to read and follow the below instructions may result in fire, personal injury, and damage to property if charged or used improperly.
- Li-Ion battery packs may explode and cause fire if misused or defective.
- Use only the charger supplied with your Sidekick Thermometer. Do not use a NiMH or NiCd charger. Failure to do so may cause a fire, which may result in personal injury and property damage.
- Do not charge when room temperature is below 32° F (0° C) or above 113° F (45° C).
- If at any time you witness your Sidekick Thermometer starting to smoke while charging, discontinue the charging process immediately and observe it in a safe place for approximately 15 minutes. Observation should occur in a safe area outside of any building or vehicle and away from any combustible material.
- Never drop the unit.
- Do not charge the battery in presence of flammable liquids or gases.
- Do not expose the charger to rain or snow.
- Children should be supervised to ensure they do not play with the battery charger.
- Use caution to avoid puncture of the cell. Puncture of cells may cause a fire.

6.3.1 storage & transportation

- Store unit at room temperature for best results.
- Do not expose battery pack to direct sunlight / heat for extended periods of time. Any exposure to heat can cause significant damage or fatal injury.
- Storing battery at temperatures greater than 140° F (60° C) for extended periods of time (more than 2 hours) may cause damage to battery and possible fire.

6.3.2 voltage, capacity, capacity in watts

- Voltage: 3.7 V
- Capacity: 3.2 Ah
- Capacity in Watts: 11.7 Wh

7.0 troubleshooting

This is a list of common troubleshooting steps to help correct typical situations that might occur when pairing the app with the thermometer unit.

On the thermometer unit, always ensure that the Bluetooth and WiFi logo icon is flashing, indicating it is ready to pair with a Smart device.

App Problem	Possible Causes / Solutions
The app is not installed or is not properly installed.	<ul style="list-style-type: none"> • Check internet connection. • Connect to Internet via WiFi and download the app from the App Store or Google Play. • Follow prompts to automatically install and open the app. • Check the app icon on home screen. • Uninstall and reinstall app if needed (see "Napoleon Home App" for more details). • Allow the app full access to files and your location.
The app is installed but shows a screen with a "probe is not connected" text.	<ul style="list-style-type: none"> • Ensure probes are properly inserted into the slots on your Sidekick Thermometer device. • Maximize Sidekick Thermometer receptivity by facing the LCD display on the thermometer with the Smart device in close range. • Completely close the app and restart it (be familiar with your device's basic operations and settings). • Close out any unnecessary programs on the Smart device that may be consuming memory.
The app worked before, but the device name is not listed in the app device list.	<ul style="list-style-type: none"> • App is not searching or not able to find the device. • Click "Try Again" on the "no devices found" page or hit the back button on the "devices found" page to restart scan. • Turn the thermometer off and on by holding the power button for 3 seconds. Ensure Bluetooth is activated in the mobile Smart device settings. • Bring the Smart device close to the thermometer unit. • Refresh the memory cache by closing and reopening the app. • Ensure your device's location setting is turned on. • Wait between 30 and 60 seconds between steps.
The thermometer lost the Bluetooth connection while in operation and shows a "connection lost" page.	<ul style="list-style-type: none"> • Try to locate cause of frequency interference or physical obstruction. • Bring Smart device back within range of the thermometer (50 m/ 160') or line of sight. • Toggle the thermometer unit off and on. • Reopen the app as a last resort.
The alarms are not working.	<ul style="list-style-type: none"> • Check the Bluetooth connection. • Check appropriate sounds or notifications are turned on in your Smart device settings. • Check that alarm (or vibrate) notification is selected in the Napoleon Home App.

Napoleon President's 1 Year Limited Warranty

Napoleon warrants that components in your new Napoleon product will be free from defects in material and workmanship from the date of purchase, for a period of 1 year from date of purchase.



If this product fails to meet your expectations for any reason, please email our customer solutions department or visit our website for more information.

NORTH AMERICA:

Website: www.napoleon.com

Email: grills@napoleon.com

Phone: 1-705-726-4278

Customer Solutions: 1-866-820-8686

EUROPE:

Website: www.napoleon.com

Email: eu.info@napoleon.com

Conditions and Limitations

Napoleon warrants its products against manufacturing defects to the original purchaser only, provided that the purchase was made through an authorized Napoleon dealer and is subject to the following conditions and limitations:

This factory warranty is non-transferable and may not be extended what-so-ever by any of our representatives.

This limited warranty does not cover damages caused by misuse, lack of maintenance, grease fires, extreme environments, accident, alterations, abuse or neglect. Discoloration to plastic parts from chemical cleaners or UV exposure is not covered by this warranty.

This limited warranty further does not cover any damage determined to be caused by heat or water.

Napoleon will not be responsible for: environmental conditions such as interference caused by other operating devices.

The bill of sale or copy will be required together with a serial number and a model number when making any warranty claims from Napoleon.

Napoleon reserves the right to have its representative inspect any product or part prior to honoring any warranty claim.

Napoleon shall not be liable for any transportation charges, labor costs, or export duties.

NAPOLEON CELEBRATING OVER 40 YEARS OF HOME COMFORT PRODUCTS



7200, Route Transcanadienne, Montréal, Québec H4T 1A3
24 Napoleon Road, Barrie, Ontario, Canada L4M 0G8
214 Bayview Drive, Barrie, Ontario, Canada L4N 4Y8
103 Miller Drive, Crittenden, Kentucky, USA 41030
De Riemsdijk 22, 4004 LC Tiel, The Netherlands

Phone: 1-866-820-8686
napoleon.com