

Owner's Manual  
Mode d'emploi et manuel  
Manual de instrucciones

# MW4

---

**MARINE BLACK BOX SOURCE UNIT WITH J1939**

## CLARION PRODUCT REGISTRATION INFORMATION

For USA and Canada only  
www.clarion.com

Dear Customer:

Congratulations on your purchase of a Clarion Marine Electronic Product. We are confident that you will enjoy your Clarion experience.

There are many benefits to registering your product. We invite you to visit our website at [www.clarion.com](http://www.clarion.com) to register your Clarion product.

We have made product registration simple with our easy to use website. The registration form is short and easy to complete. Once you are registered, We can keep you informed of important product information.

Register at [www.clarion.com](http://www.clarion.com) - It is easy to keep your Clarion product up to date.

## Contents

1. FEATURES.....	3
2. PRECAUTIONS.....	3
3. CAUTIONS ON HANDLING.....	3
4. DISPLAY CONTROLLER BUTTONS.....	4
About the Registered Marks, etc. ....	4
Name of Buttons and their Functions .....	5
5. OPERATIONS .....	7
Radio (AM/FM/Weather Band) Operation .....	8
SiriusXM Satellite Radio Operation .....	9
iPod Audio Operation.....	15
iPod Video Operation.....	24
USB 1 and USB 2 Operation .....	31
Pandora Operation .....	35
Settings.....	38
MW4 Information.....	38
System Reset.....	39
Clock .....	39
Date .....	40
Bluetooth .....	41
2-Zone Operation .....	47
AUX 1 and AUX 2 Operation.....	49
Camera Operation.....	50
Bluetooth Audio Operation .....	51
Phone Operation .....	56
Audio Settings (Button).....	66
Display Settings (Button) .....	70
Favorites (Button).....	73
Understanding the Graphical User Interface (GUI) .....	74
6. TROUBLESHOOTING .....	77
7. SPECIFICATIONS.....	80
8. INSTALLATION AND WIRE CONNECTIONS DIAGRAM.....	81

## 1. FEATURES

- SiriusXM-Ready™ (SiriusXM Connect Tuner and Subscription sold separately)
- Bluetooth (HFP, A2DP, Aptx, AVRCP 1.4, PBAP, SSP, SPP)
- Made for iPod® Made for iPhone®
- USB iPod/iPhone Audio and Video Compatible (CCA750 Required for iPod Video)
- 2-Zone (Independent Zone Source Control)
- SVC (Source Volume Control), Independent Volume Control for each source
- Two Audio/Video RCA Inputs
- Video Output
- Dedicated Rear Camera RCA Input
- Global AM/FM Tuner with RDS
- Weather Band Radio
- Water Resistant Chassis and Display Controller
- Dual 2.1A USB Ports
- OEM Steering Wheel Interface Ready
- Clarion Wired Remote Ready (MW1/MW2/MW4)
- 50W x 4 Built-In MOSFET Amplifier

## 2. PRECAUTIONS

## WARNING

\* For your safety, while boating, keep the volume to a level at which external sounds can be heard.

1. This unit has precision parts inside. Even in the event that trouble arises, never open the case, disassemble the unit, or lubricate the parts.
2. This equipment has been tested and found to comply with the limits for a Class B digital device, pursuant to Part 15 of the FCC Rules. These limits are designed to provide reasonable protection against harmful interference in a residential installation. This equipment generates, uses, and can radiate radio frequency energy and, if not installed and used in accordance with the instructions, may cause harmful interference to radio communications. However, there is no guarantee that interference will not occur in a particular installation. If this equipment does cause harmful interference to radio or television reception, which can be determined by turning the equipment off and on, the user is encouraged to consult the dealer or a experienced radio/TV technician for help.

**INFORMATION FOR USERS:**  
CHANGES OR MODIFICATIONS TO THIS PRODUCT NOT APPROVED BY THE MANUFACTURER WILL VOID THE WARRANTY AND MAY VIOLATE FCC REGULATIONS.

MANUFACTURED	CE MODEL	MW4	clarion
MANUFACTURER	12V (+GROUND)	USA: 530-110MHz, FM87.5-107.0MHz EUROPE: AM531-1620MHz, FM87.5-108.0MHz AUSTRALIA: AM531-1620MHz, FM87.5-108.0MHz	
EYES	SERIAL NO.	This device complies with Part 15 of the FCC Rules. Operation is subject to the following two conditions: (1) This device may not cause harmful interference, and (2) This device must accept any interference received, including interference that may cause undesired operation.	
ISO 8846 • SAE J1171		CLARION CORPORATION OF AMERICA 8200 GATEWAY DRIVE, CYPRESS, CA 90630, USA	
MARINE IGNITION PROTECTED		MADE IN CHINA	

## 3. CAUTIONS ON HANDLING

- Protect product from water. Do not submerge or expose the product directly to water, as this can cause electrical shorts, fire or other damages.
- Protect from high temperature. Exposure to direct sunlight for an extended period of time can produce very high temperature in your vessel. Cool down the interior before use.

## 4. DISPLAY CONTROLLER BUTTONS

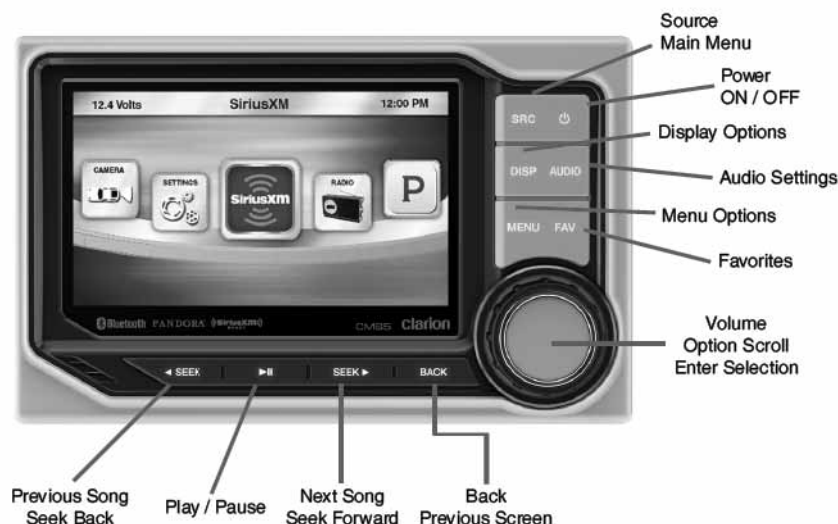

### Volume Knob

#### Functions:

- Rotate Volume Knob = Adjust Volume Level (Play Screens).
- Press in on Volume Knob = Mute (Play Screens).
- Rotate Volume Knob = Scroll Through Options (Menus).
- Press in on Volume Knob = Select/Enter (Menu Options).

### Options Arrow

This double sided arrow will only appear when additional options are available.



### About the registered marks, etc.

"Made for iPod" means that an electronic accessory has been designed to connect specifically to iPod and has been certified by the developer to meet Apple performance standards.  
Apple is not responsible for the operation of this device or its compliance with safety and regulatory standards.  
iPod is a trademark of Apple Inc., registered in the U.S. and other countries.  
Sirius, XM and all related marks and logos are registered trademarks of Sirius XM Radio Inc. All Rights reserved.

## Name of Buttons and their Functions

### Note:

Be sure to read this chapter while referring to the diagram in chapter "4. DISPLAY CONTROLLER BUTTONS"

### [Power] Power Button

- Press and release button to turn ON.
- Press and Hold for Three Seconds to turn OFF.

### Volume Knob

- Rotate Volume Knob Clockwise to increase Volume.
- Rotate Volume Knob Counter Clockwise to Decrease volume.

### Mute

- Press In and Release Volume Knob to Mute and Rotate the Volume Knob to Un-Mute the Audio.

### [SRC] Source Button

- Press SRC button to display the Main Menu.
- Use Volume Knob to Scroll through Source Options, then Press In and Release Volume Knob to Select Source.

### [MENU] Menu Button

- Press to access additional options.
- Radio (AM/FM/WB/LO/DX).
- SiriusXM (Search Functions, Direct, etc.).
- iPod (Audio, Video Menu options, Search, Playlists, Artists, Songs, Genre, etc.).
- USB (Folder, Song, Repeat, etc.).
- Bluetooth (HFP-ON/OFF, Pairing, etc.).

### [AUDIO] Audio Button

- Press to access Audio adjustment settings.
- Use Volume Knob to adjust by rotating Clockwise or Counter-Clockwise, then Press in and release Volume Knob to save Adjusted setting.

- Treble/Mid/Bass (12kHz/1k/50Hz).  
Adjust Levels from "-10" to "+10".

- EQ  
Adjust Frequency for each of the 5-Bands.

- Balance/Fader  
Adjust sound balance for Left and Right.  
Adjust sound fader for Front and Rear.

- Subwoofer  
Subwoofer Volume from "-10" to "+10".  
Subwoofer Frequency (50/75/100/THROUGH).  
Subwoofer Phase (Normal and Reverse).

### [AUDIO] Audio Button

- 2-Zone  
Adjust volume level for Zone 1, Zone 2 and Both Zones.
- SVC (Source Volume Control)  
Adjust volume level for each source independently
- Radio
- iPod
- Phone
- SiriusXM
- Bluetooth Audio
- USB
- AUX

### [DISP] Display Button

- Press to access Display adjustment settings
- Clock
  - ON = Large Clock will appear After 25 seconds of no action
  - Change Clock Font Color (White, Yellow, Red and Reverse)
  - OFF = Large Clock will Not appear after 25 Seconds of no action
  - Default = ON
- Status Bar
  - Change Status Bar to appear at Top or Bottom of Screen
  - Default = Top
- Mode
  - Change Display preset color settings from:
    - Day Mode = Brighter Colors
    - Night Mode = Darker Colors
    - Default = Day Mode
- Brightness
  - Adjust display brightness from "-10" to "+10"

### [FAV] Favorites Button

- Press to access saved stations/channels
- Save up to 50 favorites
  - SiriusXM
  - Radio (AM/FM/Weather Band)
  - Pandora
  - Phone Contact
    - Paired and Connected Phone
    - Contacts have been synced
    - You can now save contact as a favorite  
Example: Home, Work, etc.

## Name of Buttons and their Functions

### Note:

Be sure to read this chapter while referring to the diagram in chapter 4 "DISPLAY CONTROLLER BUTTONS"



### [◀ SEEK] Seek Back Button

- Press and release button to go back to previous song.
- Press and Hold for Three Seconds to scan back through song, release and song will continue playing.

### [SEEK ▶] Seek Forward Button

- Press and release button to advance to next song.
- Press and Hold for Three Seconds to scan through song, release and song will continue playing.

### [▶||] Play / Pause Button

- Press to PAUSE current song.
- When track is PAUSED, press again to continue playing current song (iPod, Bluetooth Audio, USB, and Pandora).

### [BACK] Back Button

- Press to go back to previous Menu or Settings Screen.
- Press to backwards in multiple Menu Screens.
- Press to return to current source play screen from Menu or Settings Screen.

## 5. OPERATIONS

### Basic Operations

#### CAUTION

When the unit is turned ON, and the volume has been increased to the maximum level May cause damage to your hearing.

Please be aware and cautious of the volume level at all times.

### Turning ON and OFF the System

#### Note:

- Start the engine before using this unit.
- Be careful about using this unit without the engine running. If used for long periods of time without the engine running to charge the batteries, you may not be able to start the engine and this can reduce the life and performance of the batteries. A Warning will appear when voltage is 10V or below.

#### ON

1. Start the engine.
2. Press and Release the Power Button. [⏻]
3. The Blue LED trim around the Volume Knob will light up and the MW4 Display Controller. - Clarion Splash Screen (10 Seconds). - Viewing Video Disclaimer (5 Seconds).



#### OFF

1. Press and Hold the Power Button for 3 sec. [⏻]
2. The Blue LED trim ring around the Volume Knob will turn OFF.
  - System in Powering Down Screen (5 Seconds).
  - Clarion Splash Screen (10 Seconds).



### Selecting a Source

1. Press the [SRC] button to display the Main Menu Screen.
  - \* External add-on accessories will be required in order to use that source.
  - SiriusXM requires a SiriusXM Connect Tuner and Subscription (sold separately).
  - Pandora requires a iPod or iPhone to be connected to the MW4.
  - CCA750 is required for iPod Video Playback.
  - OEM Steering Wheel Interface Module is required for the steering wheel buttons to operate the MW4 audio features.
2. Use the Volume Knob to scroll through the source carousel.
3. Press in on the Volume Knob to select the source displayed in the middle of the source Carousel.

### Adjusting the volume

1. Rotate the Volume Knob Clockwise to increase the volume level.
2. Rotate the Volume Knob Counter-Clockwise to decrease the volume level.

#### CAUTION

\* For your safety, while boating, keep the volume to a level at which external sounds can be heard.

## Radio (AM/FM/Weather Band) Operation



### [◀ SEEK] Seek Back Button

- Press and release button to tune down in frequency step by step.
- Press and Hold for Three Seconds to scan back to the previous strongest station frequency.

### [SEEK ▶] Seek Forward Button

- Press and release button to tune up in the frequency step by step.
- Press and Hold for Three Seconds to scan to the next strongest station frequency.

### [MENU] Menu Button

- Press to select AM, FM, Weather Band, Local (LO) or Distance (DX).
- Use the volume knob to scroll through options.
- Press in on the volume knob to select option in the middle of the carousel.
  - AM (Amplitude Modulation).
  - FM (Frequency Modulation).
  - Weather Band (NOAA - National Oceanic and Atmospheric Administration).
  - Local (LO).
  - Distance (DX).
- Press the Region Setting option to select the Region.
- Now a pop up window will appear providing 4 options.
  - Other Countries
  - USA
  - Europe
  - Australia

\*Default=USA

- Use the volume knob to toggle between region options.
- Press in on the volume knob to select your choice.
- Press the BACK button to return to the previous Screen.

Note: Sirius XM will be available in source screen when the Tuner region is set to USA. Pandora will be available when Region is set to USA/Australia. Else those options will be greyed out in Source list.

### [BACK] Back Button

- Press to go back to previous Menu or Settings Screen.
- Press to backwards in multiple Menu Screens.
- Press to return to current source play screen from Menu or Settings Screen.

## SiriusXM Satellite Radio Operation

Only SiriusXM® brings you more of what you love to listen to, all in one place. Get over 140 channels, including commercial-free music plus the best sports, news, talk, comedy and entertainment. Welcome to the world of satellite radio. A SiriusXM Vehicle Tuner and Subscription are required. For more information, visit [www.siriusxm.com](http://www.siriusxm.com).



### Activating your SiriusXM Subscription

After installing your SiriusXM Connect Vehicle Tuner and antenna, power on your Clarion MW4 Marine Source Unit and select SiriusXM mode. You should be able to hear the SiriusXM preview channel on Channel 1. If you cannot hear the preview channels, please check the installation instructions to make sure your SiriusXM Connect tuner is properly installed.

After you can hear the Preview channel, tune to Channel 0 to find the Radio ID of your tuner. In addition, the Radio ID is located on the bottom of the SiriusXM Connect Vehicle Tuner and its' packaging. You will need this number to activate your subscription. Write the number down for reference.

Note: the SiriusXM Radio ID does not include the letters I, O, S or F.

In the USA, you can activate online or by calling SiriusXM Listener care:

- Visit [www.siriusxm.com/activatenow](http://www.siriusxm.com/activatenow)
- Call SiriusXM Listener Care at 1-866-635-2349

For Canadian Subscriptions, please contact:

- Visit [www.siriusxm.ca/activatexm](http://www.siriusxm.ca/activatexm)
- Call XM customer Care at 1-877-438-9677

As part of the activation process, the SiriusXM satellites will send an activation message to your tuner. When your radio detects that the tuner has received the activation message, your radio will display: "<<Subscription Updated>>". Once subscribed, you can tune to channels in your subscription plan. Note, the activation process usually takes 10 to 15 minutes, but may take up to an hour. Your radio will need to be powered on and receiving the SiriusXM signal to receive the activation message.

## SiriusXM Satellite Radio Operation



### [◀ SEEK] Seek Back Button

- Press and release button to tune to the previous channel.

### [SEEK ▶] Seek Forward Button

- Press and release button to tune to the next channel.

### [MENU] Menu Button

- Press to select Direct Channel, Parental Controls, Channel Search, Category Search and Tag.
- Use the volume knob to scroll through options.
- Press in on the volume knob to select option in the middle of the carousel.
  - Direct (Tune directly to channel by entering channel number).
  - Parental Controls (Lock Mature Content Channels, Manage Password).
  - Channel Search (Search by Number or Letters).
  - Category Search (Search by Number or Letter).
  - Tag (Tag song to iPod/iPhone to purchase from iTunes when device is connected to iTunes).
- Settings.

### [BACK] Back Button

- Press to go back to previous Menu or Settings Screen
- Press to backwards in multiple Menu Screens
- Press to return to current source play screen from Menu or Settings Screen

## SiriusXM Satellite Radio Operation



### Direct Channel Tuning

1. From the SiriusXM Play Screen, Press the **MENU** Button.
2. Use the volume knob to scroll through options until the Direct Icon is in the middle of the carousel.
3. Press in on the volume knob to select Direct.
4. Now a pop-up window will appear with a numbers for you to enter to directly tune to a SiriusXM Channel.
5. Use the volume knob to scroll through the numbers until the halo is around the number you want to select.
6. Press in on the volume knob to select that number.
7. If the channel you would like to tune to is a single digit number, then you can proceed to the bottom of the pop-up window and select OK. If you would like to tune to a two or three digit channel, then proceed by selecting the additional numbers needed.
8. Once all the channel numbers are displayed in the window, scroll down to the bottom of the pop-up window and select OK.
9. Now you will return to the SiriusXM Play Screen and tuned to the channel entered.



### iTunes® Song Tagging

1. From the SiriusXM Play Screen, Press the **MENU** Button.
2. Use the volume knob to scroll through options until the Tag Icon is in the middle of the carousel.
3. Press in on the volume knob to select Tag.
4. Now a pop-up window will appear asking you to confirm to Tag the current song to your iPod/iPhone.
5. You will also see how many songs you can Tag are left (50 total).
6. Select "YES" to Tag the song or "CANCEL" and the song will not be Tagged.
7. When Tag limit is reached, a pop-up showing "Memory Full, Connect iPod" will be displayed.
8. You will also see "Already Tagged" pop up on selecting YES option if the song is already tagged.
9. Once the song is Tagged, you will return to SiriusXM Play Screen.
  - \* You will need to connect your iPod/iPhone to your home PC or MAC, launch iTunes to purchase the Tagged Songs that have been saved to your iPod/iPhone.
  - \*\* Tag icon will be greyed out when the song is not taggable or when the song has already been tagged.
  - \*\*\* Tag ID's will remain on the MW4 until the iPod/iPhone is connected. They will automatically be deleted after they are transferred.

## SiriusXM Satellite Radio Operation



### Channel and Category Sort by ABC or 123

1. From the SiriusXM Play Screen, Press the **MENU Button**.
2. Use the volume knob to scroll through options until the Channels/Categories Icon is in the middle of the carousel.
3. Press in on the volume knob to select Channels/Categories.
4. The list of SiriusXM Channels/Categories will now appear.
5. Press the **MENU Button**.
6. Now a pop-up window will appear with two options to choose from: "ABC" or "123".
  - "ABC" is sorted alphabetically
  - "123" is sorted by channel number.
7. Use the volume knob to toggle between the two options by moving the halo around the ABC icon.
8. Press in on the volume knob to select "ABC".
9. Now a pop-up window will appear with Letters in icons.
10. Use the volume knob to scroll through the Letters until the Letter you want is in the middle of the carousel.
11. Press in on the volume knob to select that Letter.
12. You will now see a list of Channels/Category appear based on your letter or number selection. Browse through the list of channels/category and select a channel. Then it starts playing the channel. If there is no match found for the selected alphabet/number, then pop up saying the same will be displayed.
13. Use the volume knob to scroll through the list of Channels.
14. When the Channel you would like to tune to is in the middle of the screen.
15. Press in on the volume knob to select that channel.
16. Now you will return to the SiriusXM Play Screen and tuned to the channel entered.

Note: In all search option (for all source option) , Searching is restricted to starting Alphabet/Number only.

## SiriusXM Satellite Radio Operation

### Channel List Tuning

1. From the SiriusXM Play Screen, Press the **MENU Button**.
2. Use the volume knob to scroll through options until the Channels Icon is in the middle of the carousel.
3. Press in on the volume knob to select Channels.
4. The list of SiriusXM Channels will now appear.
5. You can use the volume knob to scroll up or down the list of SiriusXM Channels.
6. Once the Channel you would like to listen to is in the center middle of the screen,
7. Press in on the volume knob to tune to that Channel.
8. If you select a Channel with a "Lock", then this Channel can not be selected until the correct password is entered.
- \* See Parental Controls for instructions to Set a Password, Change Password or to Lock Channels.
9. MW4 DC shall display SiriusXM Category list on Single press of **BACK Button** when it is displaying selected category channel

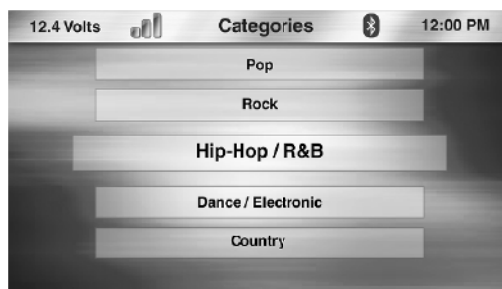

### Find a Channel by Category

1. From the SiriusXM Play Screen, Press the **MENU Button**.
2. Use the volume knob to scroll through options until the Categories Icon is in the middle of the carousel.
3. Press in on the volume knob to select Categories.
4. The list of SiriusXM Categories will now appear.
5. You can use the volume knob to scroll up or down the list of SiriusXM Categories.
6. Once the Category you would like is in the center middle of the screen,
7. Press in on the volume knob to select to that Category.
8. MW4 DC shall display SiriusXM Menu Options on Single press of **BACK Button** when it is displaying category list.
9. Once a Category is selected, list of channels from the selected Category will appear. Browse through the list of channels and select a Channel. Then it starts playing the selected Channel.
10. Press the **BACK Button** to go back to SiriusX category list when it is displaying selected category channel.

## SiriusXM Satellite Radio Operation

### Parental Controls

1. From the SiriusXM Play Screen, Press the **MENU Button**.
2. Use the volume knob to scroll through options until the Parental Controls Icon is in the middle of the carousel.
3. Press in on the volume knob to select Parental Controls.
4. Now a pop-up window will appear with two options to choose from: "Lock Mature Content Channels" or "Manage Password".
  - "Lock Mature Content Channels" locks the ability to tune to the "Mature Content" Channels.
  - "Manage Password" Provides the ability to Set a Password or to Change the Password to lock the Mature Content Channels.
  - The default passcode set for the Parental lock is 1111. This can be changed with the help of Manage Password.

### Lock Mature Content Channels

1. Press in on the volume knob to select "Lock Mature Content Channels".
2. A pop-up window will now appear asking you if you want to turn Lock the Mature Content Channels feature "ON" or "OFF".
3. Select "ON" by pressing in on the volume knob, to turn this feature "ON".
4. Now you will be asked to enter in a 4-digit Lock Code to Lock the Mature Content Channels.
5. Using the volume knob, scroll through the numbers and Press in on the volume knob to select a 4-digit Lock Code.

\* Write down the 4-digit Lock Code for future reference.

6. Now the SiriusXM Mature Content Channels are Lock and can not be listened to.

### Unlock Mature Content Channels

1. Press in on the volume knob to select "Lock Mature Content Channels".
2. A pop-up window will now appear asking you if you want to turn Lock the Mature Content Channels feature "ON" or "OFF".
3. Select "OFF" by pressing in on the volume knob, to turn this feature "OFF".
4. Now you will be asked to enter in a 4-digit Lock Code to Unlock the Mature Content Channels.
5. Using the volume knob, scroll through the numbers and Press in on the volume knob to select your 4-digit Code.
 

Use the default passcode unless it is changed using Manage passcode. If the default passcode is changed using Manage passcode, then enter the new changed passcode.
6. Now the SiriusXM Mature Content Channels are Unlocked and can be listened to.

### Manage Password

This setting will allow you to change your existing password to Lock Mature Content Channels.

1. From the SiriusXM Play Screen, Press the **MENU Button**.
2. Use the volume knob to scroll through options until the Parental Controls Icon is in the middle of the carousel.
3. Press in on the volume knob to select Parental Controls
4. Now a pop-up window will appear with two options to choose from: "Lock Mature Content Channels" or "Manage Password".
  - "Lock Mature Content Channels" locks the ability to tune to the "Mature Content" Channels.
  - "Manage Password" Provides the ability to Set a Password or to Change the Password to lock the Mature Content Channels.
5. Select "Manage Password".
6. Enter in your Current Lock Code. For the first time, current lock code is same as default passcode.
7. Select Done when finished.
8. Enter in a New Lock Code.
9. Select Done when finished.
10. You will now see a confirmation window appear displaying the new lock code.

\* Please remember this code. You will need it to listen to locked channels or to turn Off the Lock Mature Content Features.

## iPod Audio Operation



### [◀ SEEK] Seek Back Button

- Press and release button to go back to previous song.
- Press and Hold for Three Seconds to scan back through song, release and song will continue playing.

### [SEEK ▶] Seek Forward Button

- Press and release button to advance to next song.
- Press and Hold for Three Seconds to scan through song, release and song will continue playing.

### [▶||] Play / Pause Button

- Press to PAUSE current song.
- When track is PAUSED, press again to continue playing current song (iPod, Bluetooth Audio, USB, and Pandora).

### [BACK] Back Button

- Press to go back to previous Menu or Settings Screen.
- Press to backwards in multiple Menu Screens.
- Press to return to current source play screen from Menu or Settings Screen.

### [MENU] Menu Button

Press to access additional options.

- Playlists (Search by "ABC" or "123").
- Songs (Search by "ABC" or "123").
- Artists (Search by "ABC" or "123").
- Genre (Search by "ABC" or "123").
- Composers (Search by "ABC" or "123").
- Podcasts (Search by "ABC" or "123").
- Simple Mode (ON or OFF) = Operation and Control directly from iPod/iPhone.
- Tag (Tag song to iPod/iPhone for purchase through iTunes).
- Repeat (Song, Playlist, All, Off).
- Shuffle (ON or OFF).



## iPod Audio Operation



## Playlists

1. From the iPod Play Screen, Press the **MENU Button**.
2. Use the volume knob to scroll through options until the Playlists Icon is in the middle of the carousel.
3. Press in on the volume knob to select Playlists.
4. The list of your Playlists will now appear.
5. Use the volume knob to scroll through your Playlists.
6. Press in on the volume knob to select the Playlist that is in the middle of the screen.
7. You will now return to the iPod Play Screen and the first song in the Playlist will start playing.

## Playlists Search by ABC or 123

1. From the iPod Play Screen, Press the **MENU Button**.
2. Use the volume knob to scroll through options until the Playlists Icon is in the middle of the carousel.
3. Press in on the volume knob to select Playlists.
4. The list of your Playlists will now appear.
5. Press the **MENU Button**.
6. Now a pop-up window will appear with two options to choose from: "ABC" or "123".
  - "ABC" is search by Letter.
  - "123" is search by Number.
7. Use the volume knob to toggle between the two options by moving the halo around the ABC icon.
8. Press in on the volume knob to select "ABC" or "123".
9. Now a pop-up window will appear with Letters/Numbers in icons.
10. Use the volume knob to scroll through the Letters/Numbers until the Letter/Number you want is in the middle of the carousel.
11. Press in on the volume knob to select that Letter/Number.
12. You will now see a list of Playlists.
13. Use the volume knob to scroll through the list of Playlists.
14. When the Playlists you would like is in the middle of the screen.
15. Press in on the volume knob to select that Playlist.
16. Once selected, you will see the list of tracks corresponding to selected Playlist. Track Starts playing when selected on a particular track. Browsing sequence should go as Playlist->Tracks. Search can be done in each level.
17. Now you will return to the iPod Play Screen and the first song in the Playlist will start playing.

## iPod Audio Operation



## Songs

1. From the iPod Play Screen, Press the **MENU Button**.
2. Use the volume knob to scroll through options until the Songs Icon is in the middle of the carousel.
3. Press in on the volume knob to select Songs.
4. The list of your Songs will now appear.
5. Use the volume knob to scroll through your Songs.
6. Press in on the volume knob to select the Song that is in the middle of the screen.
7. You will now return to the iPod Play Screen and the song will start playing.

## Songs Search by ABC or 123

1. From the iPod Play Screen, Press the **MENU Button**.
2. Use the volume knob to scroll through options until the Songs Icon is in the middle of the carousel.
3. Press in on the volume knob to select Songs.
4. The list of your Songs will now appear.
5. Press the **MENU Button**.
6. Now a pop-up window will appear with two options to choose from: "ABC" or "123".
  - "ABC" is search by Letter.
  - "123" is search by Number.
7. Use the volume knob to toggle between the two options by moving the halo around the ABC icon.
8. Press in on the volume knob to select "ABC" or "123".
9. Now a pop-up window will appear with Letters/Numbers in icons.
10. Use the volume knob to scroll through the Letters/Numbers until the Letter/Number you want is in the middle of the carousel.
11. Press in on the volume knob to select that Letter/Number.
12. You will now see a list of Songs.
13. Use the volume knob to scroll through the list of Songs.
14. When the Song you would like is in the middle of the screen.
15. Press in on the volume knob to select that Song.
16. Now you will return to the iPod Play Screen and the song will start playing.

## iPod Audio Operation

**Artists**

1. From the iPod Play Screen, Press the **MENU Button**.
2. Use the volume knob to scroll through options until the Artists Icon is in the middle of the carousel.
3. Press in on the volume knob to select Artists.
4. The list of Artists will now appear.
5. Use the volume knob to scroll through your Artists.
6. Press in on the volume knob to select the Artist that is in the middle of the screen.
7. You will now return to the iPod Play Screen and the first song from the Artist will start playing.

**Artists Search by ABC or 123**

1. From the iPod Play Screen, Press the **MENU Button**.
2. Use the volume knob to scroll through options until the Artists Icon is in the middle of the carousel.
3. Press in on the volume knob to select Artists.
4. The list of your Artists will now appear.
5. Press the **MENU Button**.
6. Now a pop-up window will appear with two options to choose from: "ABC" or "123".
  - "ABC" is search by Letter.
  - "123" is search by Number.
7. Use the volume knob to toggle between the two options by moving the halo around the ABC icon.
8. Press in on the volume knob to select "ABC" or "123".
9. Now a pop-up window will appear with Letters/Numbers in icons.
10. Use the volume knob to scroll through the Letters/Numbers until the Letter/Number you want is in the middle of the carousel.
11. Press in on the volume knob to select that Letter/Number.
12. You will now see a list of Artists.
13. Use the volume knob to scroll through the list of Artists.
14. When the Artist you would like is in the middle of the screen.
15. Press in on the volume knob to select that Artist.
16. Once Selected, You will see the list of Album corresponding to selected Artist. Tracks will be shown when an Album is selected and track starts playing when selected on a particular track. Browsing sequence should go through the different levels like Artist->Album->Tracks. Search can be done in each level.
17. Now you will return to the iPod Play Screen and the first song from the Artist will start playing.

**Genre**

1. From the iPod Play Screen, Press the **MENU Button**.
2. Use the volume knob to scroll through options until the Genre Icon is in the middle of the carousel.
3. Press in on the volume knob to select Genre.
4. The list of music Genre will now appear.
5. Use the volume knob to scroll through the music Genre.
6. Press in on the volume knob to select the Genre that is in the middle of the screen.
7. You will now return to the iPod Play Screen and the first song from the Genre will start playing.

**Genre Search by ABC or 123**

1. From the iPod Play Screen, Press the **MENU Button**.
2. Use the volume knob to scroll through options until the Genre Icon is in the middle of the carousel.
3. Press in on the volume knob to select Genre.
4. The list of your music Genre will now appear.
5. Press the **MENU Button**.
6. Now a pop-up window will appear with two options to choose from: "ABC" or "123".
  - "ABC" is search by Letter.
  - "123" is search by Number.
7. Use the volume knob to toggle between the two options by moving the halo around the ABC icon.
8. Press in on the volume knob to select "ABC" or "123".
9. Now a pop-up window will appear with Letters/Numbers in icons.
10. Use the volume knob to scroll through the Letters/Numbers until the Letter/Number you want is in the middle of the carousel.
11. Press in on the volume knob to select that Letter/Number.
12. You will now see a list of Genre.
13. Use the volume knob to scroll through the list of Genre.
14. When the Genre you would like is in the middle of the screen.
15. Press in on the volume knob to select that Genre.
16. Once selected, You will see the list of Artist corresponding to the selected Genre. Then, When an artist is selected, corresponding Albums will be displayed. Tracks will be shown when an album is selected and track starts playing when selected on a particular track. Browsing sequence should go through the different levels like Genre->Artist->Album->Tracks. Tracks are the last levels. Search can be done in each level.
17. Now you will return to the iPod Play Screen and the first song from the Genre will start playing.

## iPod Audio Operation



### Composers

1. From the iPod Play Screen, Press the **MENU Button**.
2. Use the volume knob to scroll through options until the Composers Icon is in the middle of the carousel.
3. Press in on the volume knob to select Composers.
4. The list of Composers will now appear.
5. Use the volume knob to scroll through your Composers.
6. Press in on the volume knob to select the Composer that is in the middle of the screen.
7. You will now return to the iPod Play Screen and the first song from the Composer will start playing.

### Composers Search by ABC or 123

1. From the iPod Play Screen, Press the **MENU Button**.
2. Use the volume knob to scroll through options until the Composers Icon is in the middle of the carousel.
3. Press in on the volume knob to select Composers.
4. The list of your Composers will now appear.
5. Press the **MENU Button**.
6. Now a pop-up window will appear with two options to choose from: "ABC" or "123".
  - "ABC" is search by Letter.
  - "123" is search by Number.
7. Use the volume knob to toggle between the two options by moving the halo around the ABC icon.
8. Press in on the volume knob to select "ABC" or "123".
9. Now a pop-up window will appear with Letters/Numbers in icons.
10. Use the volume knob to scroll through the Letters/Numbers until the Letter/Number you want is in the middle of the carousel.
11. Press in on the volume knob to select that Letter/Number.
12. You will now see a list of Composers.
13. Use the volume knob to scroll through the list of Composers.
14. When the Composer you would like is in the middle of the screen.
15. Press in on the volume knob to select that Composer.
16. Once Selected, you will see the list of Album corresponding to selected composer. Tracks will be shown when an Album is selected and track starts playing when selected on a particular track. Browsing sequence should go through the different levels like Composer->Album->Tracks. Search can be done in each level.
17. Now you will return to the iPod Play Screen and the first song from the Composer will start playing.

## iPod Audio Operation



### Podcasts

1. From the iPod Play Screen, Press the **MENU Button**
2. Use the volume knob to scroll through options until the Podcasts Icon is in the middle of the carousel
3. Press in on the volume knob to select Podcasts
4. The list of downloaded Podcasts will now appear
5. Use the volume knob to scroll through the Podcasts
6. Press in on the volume knob to select the Podcast that is in the middle of the screen
7. You will now return to the iPod Play Screen and the Podcast will start playing

### Podcasts Search by ABC or 123

1. From the iPod Play Screen, Press the **MENU Button**
2. Use the volume knob to scroll through options until the Podcasts Icon is in the middle of the carousel
3. Press in on the volume knob to select Podcasts
4. The list of your downloaded Podcasts will now appear
5. Press the **MENU Button**
6. Now a pop-up window will appear with two options to choose from: "ABC" or "123"
  - "ABC" is search by Letter
  - "123" is search by Number
7. Use the volume knob to toggle between the two options by moving the halo around the ABC icon
8. Press in on the volume knob to select "ABC" or "123"
9. Now a pop-up window will appear with Letters/Numbers in icons
10. Use the volume knob to scroll through the Letters/Numbers until the Letter/Number you want is in the middle of the carousel.
11. You will now see a list of Podcasts starting with Alphabet/Letter
12. When the Podcast you would like is in the middle of the screen
13. Press in on the volume knob to select that Podcast
14. Once selected, You will see the list of tracks corresponding to selected Episode. Tracks start playing when selected on a particular track. Browsing sequence should go through the different levels like Episode->Tracks. Search can be done in each level.
15. Now you will return to the iPod Play Screen and the Podcast will start playing

## iPod Audio Operation



### Simple Mode

When this feature is turned ON, you will now be able to control the iPod/iPhone features directly from the iPod/iPhone.

#### Simple Mode ON

1. From the iPod Play Screen, Press the **MENU Button**.
  2. Use the volume knob to scroll through options until the Simple Mode Icon is in the middle of the carousel.
  3. Press in on the volume knob to select Simple Mode.
  4. You can now select the option to turn Simple Mode "ON".
  5. After you select "ON" you will now return to the iPod Play Screen.
- \* If you change your mind, and do not want to use the Simple Mode feature, press the Back Button to return to the iPod Menu Options.

#### Simple Mode OFF

Follow these steps to turn Simple Mode OFF if Simple Mode has been ON.

1. From the iPod Play Screen, Press the **MENU Button**.
2. Use the volume knob to scroll through options until the Simple Mode Icon is in the middle of the carousel.
3. Press in on the volume knob to select Simple Mode.
4. You can now select the option to turn Simple Mode "OFF".
5. After you select "OFF" you will now return to the iPod Play Screen.

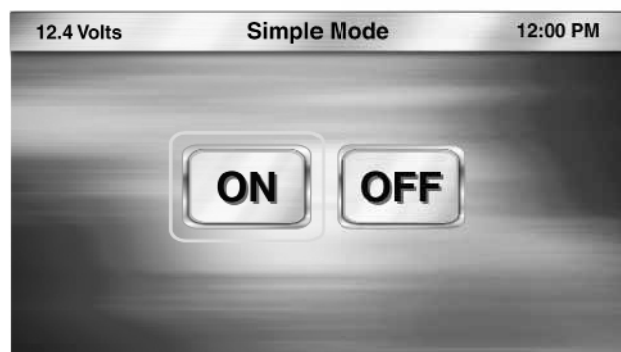

## iPod Audio Operation



### Repeat

1. From the iPod Play Screen, Press the **MENU Button**.
2. Use the volume knob to scroll through options until the Repeat Icon is in the middle of the carousel.
3. Press in on the volume knob to select Repeat.
4. Now a pop-up window will appear with Repeat options:
  - Song (Repeats current song).
  - Playlist (Repeats songs in Playlist).
  - All (Repeats All songs).
  - Off (Turns OFF the Repeat Feature).
5. After your choice has been made, you will see the Repeat Icon appear on the iPod Play Screen.

### Shuffle

1. From the iPod Play Screen, Press the **MENU Button**.
2. Use the volume knob to scroll through options until the Shuffle Icon is in the middle of the carousel.
3. Press in on the volume knob to select Shuffle.
4. Now a pop-up window will appear with Shuffle options:
  - ON (Turns the Shuffle Feature ON).
  - OFF (Turns the Shuffle Feature OFF).
5. After your choice has been made, you will see the Shuffle Icon appear on the iPod Play Screen.

## iPod Video Operation

### [ ◀ SEEK ] Seek Back Button

- Press and release button to go back to previous chapter.
- Press and Hold for Three Seconds to scan back through chapter, release and video will continue playing.

### [ SEEK ▶ ] Seek Forward Button

- Press and release button to advance to next chapter.
- Press and Hold for Three Seconds to scan through chapter, release and video will continue playing.

### [ ▶⏸ ] Play / Pause Button

- Press to PAUSE the video.
- When track is PAUSED, press again to continue playing the video.

### [ BACK ] Back Button

- Press to go back to previous Menu or Settings Screen.
- Press to backwards in multiple Menu Screens.
- Press to return to current source play screen from Menu or Settings Screen.



### [ MENU ] Menu Button (From iPod Video Play Screen)

Press to access additional options.

- Movies (Search by "ABC" or "123").
- TV Shows (Search by "ABC" or "123").
- Podcasts (Search by "ABC" or "123").



### [ MENU ] Menu Button (While Video is Playing)

Press to access additional options.

- Menu (Subtitles ON and OFF).
- Top (Plays video from the beginning of the current chapter).
- Chapters (Search Chapters by "123").
- Repeat (Chapter, All and OFF).

## iPod Video Operation

### WARNING

VIEWING A VIDEO SIGNAL ON ANY DASH MOUNTED MONITOR WHILE IN MOTION  
IS PROHIBITED BY LAW.

### iPod Video

1. From the iPod Audio Play Screen, Press the **MENU** Button.
2. Use the volume knob to scroll through options until the Video Icon is in the middle of the carousel.
3. Press in on the volume knob to select Video.
4. You will now switch to the iPod Video Play Screen.



### Select Video

1. From the iPod Video Play Screen, Press the **MENU** Button.
2. You will now see the following options:
  - Music (Returns you back to the iPod Audio Play Screen and Leaves iPod Video).
  - Movies (Search by "ABC" or "123").
  - TV Shows (Search by "ABC" or "123").
  - Podcasts (Search by "ABC" or "123").
3. Use the volume knob to scroll through options

### NOTE

IF YOU SEE A "AUDIO ONLY" SCREEN WHILE TRYING TO WATCH A MOVIE, PLEASE CHECK  
THE "VIDEO INTERLOCK" WIRE AND MAKE SURE IT IS CONNECTED.

VIDEO INTERLOCK  
ON (GROUND), OFF (NO GROUND), ON (GROUND)

## iPod Video Operation

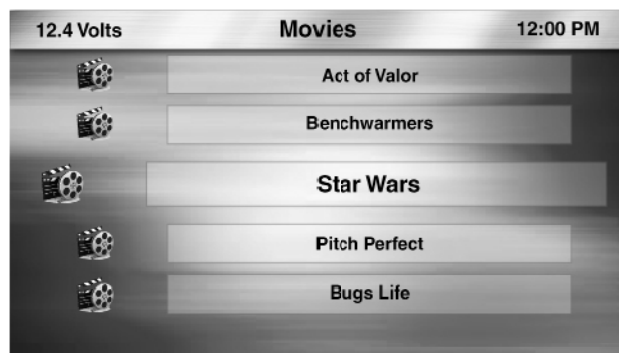

### Movies

1. Select Movies from the list of Menu Options from the iPod Video Play Screen.
2. You will now see the list of Movies that are on your iPod/iPhone.
3. Use the volume knob to scroll through the list of Movies.
4. When the movie you want to watch is in the middle of the screen.
5. Press in on the volume knob to select that movie.
6. The Movie will start playing.

### Movies Search by ABC or 123

1. From the iPod Video Play Screen, Press the MENU Button.
2. Use the volume knob to scroll through options until the Movies Icon is in the middle of the carousel.
3. Press in on the volume knob to select Movies.
4. The list of your Movies will now appear.
5. Press the MENU Button.
6. Now a pop-up window will appear with two options to choose from: "ABC" or "123".
  - "ABC" is search by Letter.
  - "123" is search by Number.
7. Use the volume knob to toggle between the two options by moving the halo around the ABC icon.
8. Press in on the volume knob to select "ABC" or "123".
9. Now a pop-up window will appear with Letters/Numbers in icons.
10. Use the volume knob to scroll through the Letters/Numbers until the Letter/Number you want is in the middle of the carousel.
11. Press in on the volume knob to select that Letter/Number.
12. Continue selecting Letters/Numbers until you have entered the Name of the Movie.
13. Once the Name of the Movie is complete, scroll to the bottom of the pop-up window and select OK.
14. You will now see a list of Movies.
15. Use the volume knob to scroll through the list of Movies.
16. When the Movie you would like is in the middle of the screen.
17. Press in on the volume knob to select that Movie.
18. Now you will return to the iPod Video Play Screen and the Movie will start playing.

## iPod Video Operation



### TV Shows

1. Select TV Shows from the list of Menu Options from the iPod Video Play Screen.
2. You will now see the list of TV Shows that are on your iPod/iPhone.
3. Use the volume knob to scroll through the list of TV Shows.
4. When the TV Shows you want to watch is in the middle of the screen.
5. Press in on the volume knob to select that TV Show.
6. The TV Show will start playing.

### TV Shows Search by ABC or 123

1. From the iPod Video Play Screen, Press the MENU Button.
2. Use the volume knob to scroll through options until the TV Shows Icon is in the middle of the carousel.
3. Press in on the volume knob to select TV Shows.
4. The list of your TV Shows will now appear.
5. Press the MENU Button.
6. Now a pop-up window will appear with two options to choose from: "ABC" or "123".
  - "ABC" is search by Letter.
  - "123" is search by Number.
7. Use the volume knob to toggle between the two options by moving the halo around the ABC icon.
8. Press in on the volume knob to select "ABC" or "123".
9. Now a pop-up window will appear with Letters/Numbers in icons.
10. Use the volume knob to scroll through the Letters/Numbers until the Letter/Number you want is in the middle of the carousel.
11. Press in on the volume knob to select that Letter/Number.
12. Continue selecting Letters/Numbers until you have entered the Name of the TV Show.
13. Once the Name of the TV Show is complete, scroll to the bottom of the pop-up window and select OK.
14. You will now see a list of TV Shows.
15. Use the volume knob to scroll through the list of TV Shows.
16. When the TV Show you would like is in the middle of the screen.
17. Press in on the volume knob to select that TV Show.
18. Now you will return to the iPod Video Play Screen and the TV Show will start playing.

## iPod Video Operation



### Podcasts

1. From the iPod Play Screen, Press the **MENU Button**
2. Use the volume knob to scroll through options until the Podcasts Icon is in the middle of the carousel
3. Press in on the volume knob to select Podcasts
4. The list of downloaded Podcasts will now appear
5. Use the volume knob to scroll through the Podcasts
6. Press in on the volume knob to select the Podcast that is in the middle of the screen
7. You will now return to the iPod Play Screen and the Podcast will start playing

### Podcasts Search by ABC or 123

1. From the iPod Play Screen, Press the **MENU Button**
2. Use the volume knob to scroll through options until the Podcasts Icon is in the middle of the carousel
3. Press in on the volume knob to select Podcasts
4. The list of your downloaded Podcasts will now appear
5. Press the **MENU Button**
6. Now a pop-up window will appear with two options to choose from: "ABC" or "123"
  - "ABC" is search by Letter
  - "123" is search by Number
7. Use the volume knob to toggle between the two options by moving the halo around the ABC icon
8. Press in on the volume knob to select "ABC" or "123"
9. Now a pop-up window will appear with Letters/Numbers in icons
10. Use the volume knob to scroll through the Letters/Numbers until the Letter/Number you want is in the middle of the carousel.
11. You will now see a list of Podcasts starting with Alphabet/Letter
12. When the Podcast you would like is in the middle of the screen
13. Press in on the volume knob to select that Podcast
14. Once selected, You will see the list of tracks corresponding to selected Episode. Tracks start playing when selected on a particular track. Browsing sequence should go through the different levels like Episode->Tracks. Search can be done in each level.
15. Now you will return to the iPod Play Screen and the Podcast will start playing

## iPod Video Operation



### Menu

1. While the video is playing, Press the **MENU Button**.
2. Use the volume knob to scroll through options until the halo is around the Menu Icon.
3. Press in on the volume knob to select Menu.
4. Now a pop-up window will appear with Menu option:
  - Subtitles (ON and OFF).
5. Press in on the volume knob to select the Menu Option.

\*\* Note: Not All Video Files Will Contain These Features. \*\*

### Subtitles (ON and OFF)

1. If you select Subtitles you will see the subtitles on the screen while the video is playing.
2. Use the volume knob to select your Subtitle options.
3. You can press the Back Button to return back to the iPod Video Play Screen.

### Top

This feature will take you to the beginning of the current chapter.

1. While the video is playing, Press the **MENU Button**.
2. Use the volume knob to scroll through options until the halo is around the Top Icon.
3. Press in on the volume knob to select Top.
4. You will be taken back to the iPod Video Play Screen and the video will begin playing from the start of the current chapter.

## iPod Video Operation



### Chapter

1. While the video is playing, Press the **MENU** Button.
2. Use the volume knob to scroll through options until the halo is around the Chapters Icon.
3. Press in on the volume knob to select Chapters.
4. Now a pop-up window will appear with a number pad for you to enter in the chapter number..
5. Use the volume knob to scroll through the numbers.
6. Press in on the volume knob to select the chapter number(s).
7. When you have finished your chapter selection.
8. Scroll to the bottom of the pop-up screen and select "OK".
9. You will now return to the iPod Video Play Screen and the video will start playing from the selected Chapter.



### Repeat

1. While the video is playing, Press the **MENU** Button.
  2. Use the volume knob to scroll through options until the halo is around the Repeat Icon.
  3. Press in on the volume knob to select Repeat.
  4. Now a pop-up window will appear with Repeat options:
    - Chapter (Repeats current Chapter).
    - All (Repeats All Chapters).
    - Off (Turns OFF the Repeat Feature).
  5. Press in on the volume knob to select your Repeat function.
- \* If you change your mind and do not want to use the Repeat function, press the Back Button and you will return to the iPod Video Play Screen.

## USB 1 and USB 2 Operation



### [◀ SEEK] Seek Back Button

- Press and release button to go back to previous song
- Press and Hold for Three Seconds to scan back through song, release and song will continue playing

### [SEEK ▶] Seek Forward Button

- Press and release button to advance to next song
- Press and Hold for Three Seconds to scan through song, release and song will continue playing

### [▶||] Play / Pause Button

- Press to **PAUSE** the song
- When track is **PAUSED**, press again to continue playing the song

### [BACK] Back Button

- Press to go back to previous Menu or Settings Screen
- Press to backwards in multiple Menu Screens
- Press to return to current source play screen from Menu or Settings Screen

### [MENU] Menu Button

- Press to access additional options
- Repeat (Song, Folder, All or OFF)
  - Random (ON or OFF)
  - Shuffle (ON or OFF)
  - Folders (Access Music Folders)
  - Songs (Access Songs)
  - SCAN option for Intro Music SCAN



## USB 1 and USB 2 Operation



### Shuffle

1. From the USB Play Screen, Press the **MENU Button**
2. Use the volume knob to scroll through options until the Shuffle Icon is in the middle of the carousel
3. Press in on the volume knob to select Shuffle
4. Now a pop-up window will appear with Shuffle options:
  - ON (Turns the Shuffle Feature ON)
  - OFF (Turns the Shuffle Feature OFF)
5. After your choice has been made, you will see the Shuffle Icon appear on the USB Play Screen

### Repeat

1. From the USB Play Screen, Press the **MENU Button**
2. Use the volume knob to scroll through options until the Repeat Icon is in the middle of the carousel
3. Press in on the volume knob to select Repeat
4. Now a pop-up window will appear with Repeat options:
  - Song (Repeats current Song)
  - Folder (Repeats songs in Folder)
  - All (Repeats All songs)
  - Off (Turns OFF the Repeat Feature)
5. After your choice has been made, you will see the Repeat Icon appear on the USB Play Screen

### Random

1. From the USB Play Screen, Press the **MENU Button**
2. Use the volume knob to scroll through options until the Random Icon is in the middle of the carousel
3. Press in on the volume knob to select Random
4. Now a pop-up window will appear with Random options:
  - ON (Turns the Random Feature ON)
  - OFF (Turns the Random Feature OFF)
5. After your choice has been made, you will see the Random Icon appear on the USB Play Screen

### SCAN

1. From the USB Play Screen, Press the **MENU Button**
2. Use the volume knob to scroll through options until the SCAN Icon is in the middle of the carousel
3. Press in on the volume knob to select SCAN
4. In play screen, Scan indicator will appear, indicating that it is in Scan mode and the first 10 seconds of each song in the folder will play

## USB 1 and USB 2 Operation



### Folders

1. From the USB Play Screen, Press the **MENU Button**
2. Use the volume knob to scroll through options until the Folders Icon is in the middle of the carousel
3. Press in on the volume knob to select Folders
4. The list of your Folders will now appear
5. Use the volume knob to scroll through your Folders
6. Press in on the volume knob to select the Folder that is in the middle of the screen
7. It will display the list of songs present in that folder. Then press in on the volume knob to select the song from the list. Now you will return to the play screen and song starts playing.

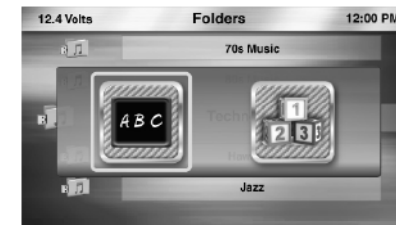

### Folders Search by ABC or 123

1. From the USB Play Screen, Press the **MENU Button**
2. Use the volume knob to scroll through options until the Folders Icon is in the middle of the carousel
3. Press in on the volume knob to select Folders
4. The list of your Folders will now appear
5. Press the **MENU Button**
6. Now a pop-up window will appear with two options to choose from: "ABC" or "123"
  - "ABC" is search by Letter
  - "123" is search by Number
7. Use the volume knob to toggle between the two options by moving the halo around the ABC icon
8. Press in on the volume knob to select "ABC" or "123"
9. Now a pop-up window will appear with Letters/Numbers in icons
10. Use the volume knob to scroll through the Letters/Numbers until the Letter/Number you want is in the middle of the carousel.
11. Press in on the volume knob to select that Letter/Number
12. you will now see a list of folder starting with the selected Alphabet/Number.
13. If there is no match found for the selected alphabet/number, then pop up saying the same will be displayed,
14. Use the volume knob to scroll through the list of Folder
15. When the Folder you would like is in the middle of the screen
16. Press in on the volume knob to select that Folder
17. It will display the list of songs present in that folder. Then press in on the volume knob to select the song from the list. Now you will return to the play screen and song starts playing

## USB 1 and USB 2 Operation



### Songs

1. From the USB Play Screen, Press the **MENU Button**
2. Use the volume knob to scroll through options until the Songs icon is in the middle of the carousel
3. Press in on the volume knob to select Songs
4. The list of your Songs will now appear
5. Use the volume knob to scroll through your Songs
6. Press in on the volume knob to select the Song that is in the middle of the screen
7. You will now return to the iPod Play Screen and the song will start playing



### Songs Search by ABC or 123

1. From the USB Play Screen, Press the **MENU Button**
2. Use the volume knob to scroll through options until the Songs icon is in the middle of the carousel
3. Press in on the volume knob to select Songs
4. The list of your Songs will now appear
5. Press the **MENU Button**
6. Now a pop-up window will appear with two options to choose from: "ABC" or "123"
  - "ABC" is search by Letter
  - "123" is search by Number
7. Use the volume knob to toggle between the two options by moving the halo around the ABC icon
8. Press in on the volume knob to select "ABC" or "123"
9. Now a pop-up window will appear with Letters/Numbers in icons
10. Use the volume knob to scroll through the Letters/Numbers until the Letter/Number you want is in the middle of the carousel.
11. Press in on the volume knob to select that Letter/Number
12. You will now see a list of folder starting with the selected Alphabet/Number.
13. You will now see a list of Songs. If there is no match found for the selected alphabet/number, then pop up saying the same will be displayed.
14. Use the volume knob to scroll through the list of Songs
15. When the Song you would like is in the middle of the screen
16. Press in on the volume knob to select that Song
17. Now you will return to the USB Play Screen and the song will start playing

Note: In all search option (for all source option), Searching is restricted to starting Alphabet/Number only

## Pandora Operation



### [◀ SEEK] Seek Back Button

- No function

### [SEEK ▶] Seek Forward Button

- Press and release button to advance to next song

### [▶||] Play / Pause Button

- Press to PAUSE the song
- When track is PAUSED, press again to continue playing the song

### [BACK] Back Button

- Press to go back to previous Menu or Settings Screen
- Press to go backwards in multiple Menu Screens
- Press to return to current source play screen from Menu or Settings Screen



### [MENU] Menu Button

Press to access additional options

- Stations (Music Stations from your Pandora Account)
- Bookmark (ON or OFF)
- Thumbs Up
- Thumbs Down

### Note:

The following Pandora connection status may appear:

- Please login to Pandora on device
- Device disconnected
- Pandora not responding
- Skip limit reached
- Station does not exist
- Limited connectivity
- Fetching stations information
- Unable to play due to music listening restrictions
- Pandora server under maintainace
- Check the mobile app on device
- Skip limit allowed
- Select a station from station list
- Track rating failed

## Pandora Operation



### Stations

1. From the Pandora Play Screen, press the **MENU Button**
2. Use the volume knob to scroll through options until the Stations Icon is in the middle of the carousel
3. Press in on the volume knob to select Stations
4. The list of your Stations will now appear
5. Use the volume knob to scroll through your Stations
6. Press in on the volume knob to select the Station that is in the middle of the screen
7. You will now return to the Pandora Play Screen and the song will start playing

### Stations Search by ABC or 123

1. From the Pandora Play Screen, press the **MENU Button**
2. Use the volume knob to scroll through options until the Stations Icon is in the middle of the carousel
3. Press in on the volume knob to select Stations
4. The list of your Stations will now appear
5. Press the **MENU Button**
6. Now a pop-up window will appear with two options to choose from: "ABC" or "123"
  - "ABC" is search by Letter
  - "123" is search by Number
7. Use the volume knob to toggle between the two options by moving the halo around the ABC icon
8. Press in on the volume knob to select "ABC" or "123"
9. Now a pop-up window will appear with Letters/Numbers in icons
10. Use the volume knob to scroll through the Letters/Numbers until the Letter/Number you want is in the middle of the carousel.
11. Press in on the volume knob to select that Letter/Number
12. You will now see a list of Stations starting with the same alphabet/number.
  - If there is no match found for the selected alphabet/number, then pop up saying the same will be displayed.
13. Use the volume knob to scroll through the list of Stations
14. When the Station you would like is in the middle of the screen
15. Press in on the volume knob to select that Station
16. Now you will return to the Pandora Play Screen and the Station will start playing
17. Station Art is display for each station, if available else generic station Art will be displayed.

Note: In all search option (for all source option), Searching is restricted to starting Alphabet/Number only

## Pandora Operation



### Bookmark

1. From the Pandora Play Screen, press the **MENU Button**
2. Use the volume knob to scroll through options until the Bookmark Icon is in the middle of the carousel
3. Press in on the volume knob to select Bookmark
4. Now a pop-up window will appear with Bookmark options:
  - YES (Bookmarks the current song to your Pandora Account)
  - CANCEL (Returns you back to the Pandora Play Screen)
5. If YES is selected, A pop up will appear with "Bookmark saved" screen for 2 seconds and then display again the Pandora Play screen
6. If Bookmark failure occurs, Pop up window will appear with "Bookmark not saved" for 2 seconds
7. After your choice has been made, you will return to the Pandora Play Screen



### Thumb Up

1. From the Pandora Play Screen, Press the **MENU Button**
2. Use the volume knob to scroll through options until the Thumb Up Icon is in the middle of the carousel
3. Press in on the volume knob to select Thumbs Up
4. After your choice has been made, you will return to the Pandora Play Screen

### Thumb Down

1. From the Pandora Play Screen, Press the **MENU Button**
2. Use the volume knob to scroll through options until the Thumb Down Icon is in the middle of the carousel
3. Press in on the volume knob to select Thumb Down
4. After your choice has been made, you will return to the Pandora Play Screen

### General pop ups for Pandora:

1. Device disconnected
2. Pandora server under maintenance
3. Pandora not responding
4. Check the mobile app on the device
5. Skip limit reached
6. Limited connectivity etc

## Settings



### Settings

1. Press the **Source Button (SRC)**
2. Use the volume knob to scroll through the sources
3. When the Settings Icon is in the middle of the carousel, Press in on the volume knob to select Settings
4. Once in Settings, the following features will be accessible:
  - MW4 Information -
  - Clock
  - Date
  - Bluetooth
5. Press in on the volume knob to select the Settings Option you would like to enter

This section contains information for the following MW4 Features and Functions:

#### MW4 Information

- Hardware Information
- Operating System Information (OS)
- Software Version Information
- Bluetooth Software Version Information
- Application Firmware Information
- System Reset



### MW4 Information

1. Press the **Source Button (SRC)**
2. Use the volume knob to scroll through the sources
3. When the Settings Icon is in the middle of the carousel, Press in on the volume knob to select Settings
4. Once in Settings, use the volume knob to scroll to MW4 Information
5. When the MW4 Information Icon is in the middle of the screen, Press in on the volume knob to enter the MW4 Information Screen
6. After you have finished reviewing the MW4 Information, Press the Back Button to return to the previous Settings Screen

## Settings

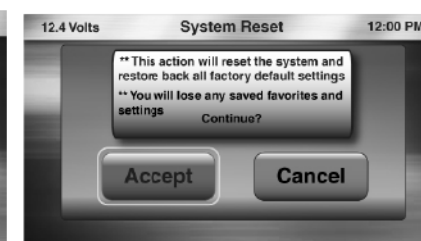
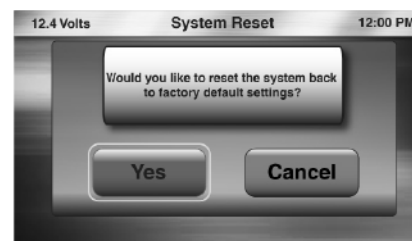

### System Reset

1. Press in Volume knob when System Reset option is focussed
2. Pop up window will appear with YES and CANCEL options
3. If selected YES by pressing on volume knob, then option to enter parental lock code will appear if Parental Lock is set to ON. If code is not entered properly, then a confirmation screen saying "Need to proceed without resetting lock code" will appear
4. If Parental Lock is entered correctly (if applicable) or if LOCK is OFF, then a confirmation will appear as below with the ACCEPT and CANCEL option  
 \*\*THIS ACTION WILL RESET THE SYSTEM AND RESTORE BACK TO ALL FACTORY DEFAULT SETTINGS\*\*  
 \*\* YOU WILL LOSE ANY SAVED FAVORITES AND SETTINGS\*\*
5. If ACCEPT is selected, then System will reset by powering down and then it will automatically restart
6. If CANCEL is selected, then it will return back to the current source in use

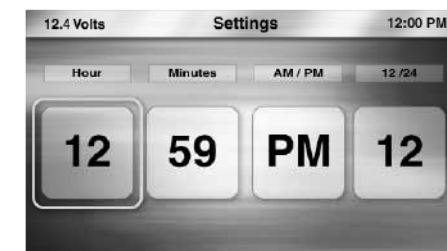

### Clock

1. Press the **Source Button (SRC)**
  2. Use the volume knob to scroll through the sources
  3. When the Settings Icon is in the middle of the carousel, Press in on the volume knob to select Settings
  4. Once in Settings, rotate the volume knob to Clock
  5. Press in on the volume knob to enter the Clock Settings
    - Hour
    - Minutes
    - AM/PM
    - 12 / 24 Hour Mode
- \*\* The halo will always default to Hour adjustment first, then minutes, AM/PM, and 12/24
6. With the halo around Hour, rotate the volume knob to adjust to the correct Hour
  7. Press in on the volume knob to set the Hour
  8. The halo will automatically shift to Minutes
  9. With the halo around the Minutes, rotate the volume knob to adjust to the correct Minutes
  10. Press in on the volume knob to set the Minutes
  11. The halo will automatically shift to AM/PM
  12. With the halo around the AM/PM, rotate the volume knob to change from AM to PM
  13. Press in on the volume knob to set AM or PM
  14. The halo will automatically shift to 12/24
  15. With the halo around the 12/24, rotate the volume knob to change from 12 to 24 Hour Mode
  16. Press in on the volume knob to set 12 or 24 Hour Mode
  17. After the Clock has been set, you will return to the Settings Menu

## Settings



### Date

1. Press the **Source Button (SRC)**
2. Use the volume knob to scroll through the sources
3. When the Settings Icon is in the middle of the carousel, Press in on the volume knob to select Settings
4. Once in Settings, rotate the volume knob to Date
5. Press in on the volume knob to enter the Date Settings
  - Day
  - Month
  - Date
  - Year (Default = 2013)
- \*\* The halo will always default to Day adjustment first, then Month, Date, and Year
6. With the halo around Day, rotate the volume knob to adjust to the correct Day
7. Press in on the volume knob to set the Day
8. The halo will automatically shift to Month
9. With the halo around the Month, rotate the volume knob to adjust to the correct Month
10. Press in on the volume knob to set the Month
11. The halo will automatically shift to Date
12. With the halo around the Date, rotate the volume knob to adjust to the correct Date
13. Press in on the volume knob to set the Date
14. The halo will automatically shift to Year
15. With the halo around the Year, rotate the volume knob to adjust the Year
16. Press in on the volume knob to set the year
17. After the Date has been set, you will return to the Settings Menu

**\*\*The Date Information will Only be displayed on the Large Clock \*\***  
**Please refer to the Display Settings to enable the Large Clock to be displayed after 25 seconds of no action.**

## Settings

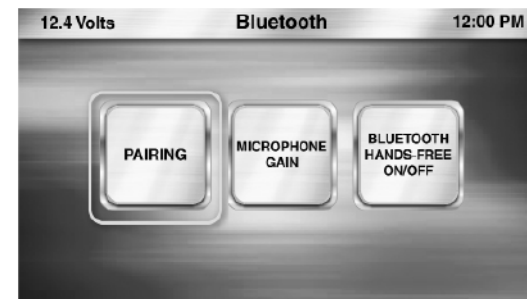

### Bluetooth

1. Press the **Source Button (SRC)**
2. Use the volume knob to scroll through the sources
3. When the Settings Icon is in the middle of the carousel, Press in on the volume knob to select Settings
4. Once in Settings, rotate the volume knob to Bluetooth
5. Press in on the volume knob to enter Bluetooth Settings
  - Bluetooth Hands-Free ON or OFF (Turns the Bluetooth Hands-Free Feature ON or OFF)
  - Pairing (Pair, Connect, Transfer Bluetooth Connection, and Delete Paired Device)
  - Microphone Gain (Adjust the Optional external Bluetooth Microphone sensitivity)



### Bluetooth (Hands-Free ON or OFF)

1. Press the **Source Button (SRC)**
2. Use the volume knob to scroll through the sources
3. When the Settings Icon is in the middle of the carousel, Press in on the volume knob to select Settings
4. Once in Settings, rotate the volume knob to Bluetooth
5. Press in on the volume knob to enter Bluetooth Settings
6. With the halo around Bluetooth Hands-Free ON / OFF Icon
7. Press in on the volume knob to select Bluetooth Hands-Free ON / OFF
8. Now a pop-up window will appear providing Two options:
  - ON = Turn ON the Bluetooth Hands-Free Profile (Allows for Hands-Free Calling)
  - OFF = Turns OFF the Bluetooth Hands-Free Profile (Disables the ability for Hands-Free Calling)
- \* Default = OFF
9. Use the volume knob to toggle between ON and OFF
10. Press in on the volume knob to select your choice
11. After your choice has been made, you will be taken back to the Bluetooth Settings Menu

## Settings

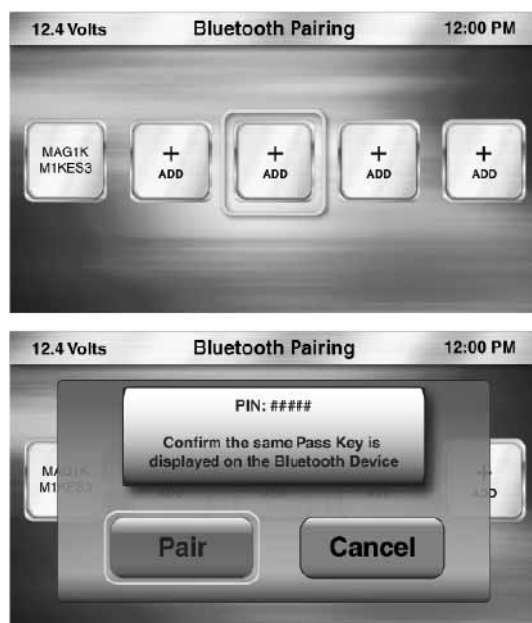

### Bluetooth (Pairing)

The MW4 Bluetooth Pairing sequence is based on the Bluetooth SSP (Simple Secure Pairing Profile) and will Not require input of a PIN Code to Pair Bluetooth Devices

1. Press the **Source Button (SRC)**
2. Use the volume knob to scroll through the sources
3. When the Settings Icon is in the middle of the carousel, Press in on the volume knob to select Settings
4. Once in Settings, rotate the volume knob to Bluetooth
5. Press in on the volume knob to enter Bluetooth Settings
6. Rotate the volume knob and move the halo until it is around the Pairing Icon
7. With the halo around Pairing Icon, Press in on the volume knob to select Bluetooth Device Pairing
8. You will now see the Bluetooth Pairing Screen that displays Five Icons that will populate with the "+ ADD" or "Paired Device Names"
- \* If No Devices have been Paired, you will see Five "+ ADD" Icons
9. Use the volume knob to toggle through the Icons to select the position to save the Paired Device Information
10. Press in on the volume knob to select a "+ ADD"
11. The MW4 is now in Bluetooth Pairing Mode
12. Confirm that your Bluetooth Device is "ON" and the Bluetooth on the device is "ON"
13. When the MW4 has found a Bluetooth Device, you will see a pop-up window appear asking you to Confirm the PIN Information from the MW4 to the Device
- \* Confirm that the PIN Number on the screen of the MW4 is the same as the PIN Number that is being Displayed on the screen of the Bluetooth Device
14. If both PIN Numbers are the same
15. Press in on the volume knob to select "PAIR"
16. Once the MW4 and the Bluetooth Device are Paired, you will now be taken to the Bluetooth Paired/Connected Device Information Screen

## Settings



### Bluetooth (Paired/Connected Device Information Screen)

**\*After Pairing a Device you will be taken to this screen.**  
You can access this screen when Pairing a Device is not necessary

This screen is where you can view the Paired Bluetooth Information, Switch Bluetooth connection to a different Paired Device and Delete the Paired Device

#### Access the Paired/Connected Device Information Screen

1. Press the **Source Button (SRC)**
  2. Use the volume knob to scroll through the sources
  3. When the Settings Icon is in the middle of the carousel, Press in on the volume knob to select Settings
  4. Once in Settings, rotate the volume knob to Bluetooth
  5. Press in on the volume knob to enter Bluetooth Settings
  6. Use the volume knob until the halo is around the Pairing Icon
  7. Use the volume knob and move the halo until it is around the Paired Device that you would like to:
    - Switch To This Device (Changes Bluetooth Connection)
    - Delete This Device (Select to Delete a Paired Bluetooth Device)
- Press the Back Button to return to the Bluetooth Settings Screen

## Settings



### Bluetooth (Switch To This Device)

1. When you are at the Paired/Connected Device Information Screen
2. Use the volume knob and move the halo until it is around Switch To This Device
3. Press in on the volume knob to switch Bluetooth Connection to this device
4. Now a pop-up window will appear asking you to Confirm Connection to this Device
5. Use the volume knob to Toggle between "YES" or "NO"
6. Press in on the volume knob to select your choice
7. If you select "YES", then you have now transferred Bluetooth Connection and you will return back to the Bluetooth Settings Screen
8. If you select "NO", then you will return back to the Bluetooth Settings Screen

### Bluetooth (Switch To This Device)

\* Follow these steps if you are Not in the Paired/Connected Device Information Screen

1. Press the Source Button (SRC)
2. Use the volume knob to scroll through the sources
3. When the Settings Icon is in the middle of the carousel, Press in on the volume knob to select Settings
4. Once in Settings, rotate the volume knob to Bluetooth
5. Press in on the volume knob to enter Bluetooth Settings
6. Rotate the volume knob and move the halo until it is around the Pairing Icon
7. With the halo around Pairing Icon
8. Press in on the volume knob to select Bluetooth Device Pairing
9. You will now see the Bluetooth Pairing Screen that displays Five Icons that will populate with the "+ ADD" or "Paired Device Names"
10. Use the volume knob and move the halo until it is around the Paired Device you would like to switch Bluetooth Connection to
11. Press in on the volume knob to select the Device you would like to switch Bluetooth Connection to
12. You will now be taken to the Paired/Connection Device Information Screen
13. Use the volume knob and move the halo until it is around Switch To This Device
14. Press in on the volume knob to switch Bluetooth Connection to this device
15. Now a pop-up window will appear asking you to confirm Connection to this Device
16. Use the volume knob to Toggle between "YES" or "NO"
17. Press in on the volume knob to select your choice
18. If you select "YES", then you have now transferred Bluetooth Connection and you will return back to the Bluetooth Settings Screen
19. If you select "NO", then you will return back to the Bluetooth Settings Screen

## Settings



### Bluetooth (Delete This Device)

1. When you are at the Paired/Connected Device Information Screen
2. Use the volume knob and move the halo until it is around Delete This Device
3. Press in on the volume knob to Delete This Device
4. Now a pop-up window will appear asking you to confirm you want to Delete This Device
5. Use the volume knob to Toggle between "YES" or "NO"
6. Press in on the volume knob to select your choice
7. If you select "YES", then you have now Deleted This Device and you will return back to the Bluetooth Settings Screen
8. If you select "NO", then you will return back to the Bluetooth Settings Screen

### Bluetooth (Delete This Device)

\* Follow these steps if you are Not in the Paired/Connected Device Information Screen

1. Press the Source Button (SRC)
2. Use the volume knob to scroll through the sources
3. When the Settings Icon is in the middle of the carousel, Press in on the volume knob to select Settings
4. Once in Settings, rotate the volume knob to Bluetooth
5. Press in on the volume knob to enter Bluetooth Settings
6. Rotate the volume knob and move the halo until it is around the Pairing Icon
7. With the halo around Pairing Icon
8. Press in on the volume knob to select Bluetooth Device Pairing
9. You will now see the Bluetooth Pairing Screen that displays Five Icons that will populate with the "+ ADD" or "Paired Device Names"
10. Use the volume knob and move the halo until it is around the Paired Device you would like to Delete
11. Press in on the volume knob to select the Device you would like to Delete
12. You will now be taken to the Paired/Connection Device Information Screen
13. Use the volume knob and move the halo until it is around Delete This Device
14. Press in on the volume knob to Delete This Device
15. Now a pop-up window will appear asking you to confirm Delete This Device
16. Use the volume knob to Toggle between "YES" or "NO"
17. Press in on the volume knob to select your choice
18. If you select "YES", then you have now Deleted This Device and you will return back to the Bluetooth Settings Screen
19. If you select "NO", then you will return back to the Bluetooth Settings Screen