

## Setup Operations

Press [Setup] button on the Main Menu screen. The Setup menu screen will be displayed.

### General Setup Menu



- Clock:** Touch the button to set the clock. Select Clock Mode 12 Hr.
- AM/PM:** Touch the button to change AM or PM, when 12Hr mode is selected.
- Beep:** The function of it is to choose the Beep voice on or off.
- Camera Image:** The Function of it is to choose the mode of camera image normal or mirror.
- Radio Field:** The function of it is to choose the radio mode in the country you are. It's contain USA, Europe, S. America, Other.



- Tel Mute:** The function of it is to set the Bluetooth ready on or off.
- Tel SP:** The function of it is to set the speaker of the Bluetooth ready front left or front right.
- Auxin Input SW:** The function of it is to choose the auxin input switch, including Low, Mid, High.
- Version:** Display the software version information.

### Video Setup Menu

This menu includes: TV Shape; Aux IN; Brightness.



- TV Shape:** The function of it is to choose the screen area shape - 4:3 or 16:9.
- Aux IN:** The function of it is to choose Aux In format. It contains AUTO, PAL, NTSC.
- Brightness:** Set brightness value from 0 to 20.

### ASP Setup Menu

This menu includes: Bass Freq; Treble Freq; Sub Filter; Bass Q-Factor.



- Bass Freq:** Choose the desired bass frequency. 60Hz, 80Hz, 100Hz, 200Hz
- Treble Freq:** Choose the desired treble frequency 10KHz/12.5KHz/15KHz/17.5KHz.
- Sub Filter:** Choose the desired Sub Filter frequency: 80Hz/120Hz/160Hz.
- Bass Q-Factor:** Choose the Bass Q-Factor: 1.0/1.25/1.5/2.0.

### Navigation Setup Menu

This menu includes: GPS Time, Time Zone, DST





## Setup Operations

**GPS Time:** Use this function of it is to synchronize the GPS time or not. It contains two choices: Ignore and Sync.

**Time Zone:** Choose the desired Time Zone: NTF/Atlantic/Eastern/Central/Mountain/Pacific/Alaska.

**DST:** Use this function to set Daylight Saving Time on or off.

### Misc Set Up

This menu include: TS Calibrate; Set Password; Parental control.

**TS Calibrate:** The function of it is to select the TS Calibrate YES or NO.

**Set password:** The function of it is to set the password of the child lock.

**Parental control:** The function of it is to set the rating of the age. It contains Kid Saf/G/PG/PG- 13/PG-R/R/ NC- 17/Adult.

**Software Update:** Choose the function to update the software.

**NAV Update:** Choose the function to update the NAV software.

**Load Factory:** The function is to select to load factory default or not.

**DVD Region:** Choose DVD region.

**Parking Det.:** The function of it is to select parking det. mode. Select: Ignore, Level and Seq.

**Macrovision:** The function of it is to select macrovision ON or OFF.

### Phone Menu

If you receive a phone call and the Bluetooth is On, the screen will display Phone Interrupt Menu.

1. Press the right top corner to go back to Main Menu.
2. Touch **[Setup]** button to set Tel Mute and Tel SP.

### EQ Set Up

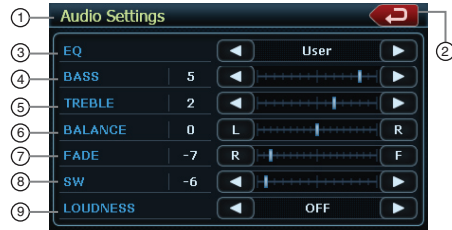

No.	Button Name	Function
1	Title Name	Display title name
2	Back Button	Close the Audio Settings menu
3	EQ	Set EQ mode
4	BASS	Set bass value
5	TREBLE	Set treble value
6	BALANCE	Set balance value
7	FADER	Set fader value
8	SW	Set Sub Woofer value
9	LOUDNESS	Set loudness on or off

### Monitor OFF Menu

Press Monitor OFF icon on Main Menu, it will show "Standing By". Touch the screen to turn the monitor ON. Touch the screen again to turn it OFF.

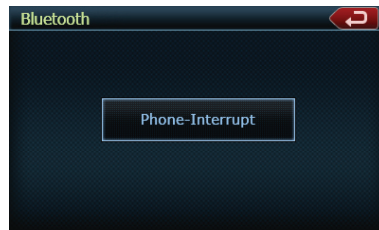

## 8. TROUBLESHOOTING

### GENERAL

Problem	Cause	Measure
Power does not turn on. (No sound is produced.)	Fuse is blown.	Replace with a fuse of the same amperage. If the fuse blows again, consult your store of purchase.
	Incorrect wiring.	Consult your store of purchase.
Nothing happens when buttons are pressed.  Display is not accurate.	The microprocessor has malfunctioned due to noise, etc.	Turn off the power and open the operation panel. Press the reset button with a thin rod. <b>Note:</b> <i>When the Reset button is pressed, turn off the ACC power.</i> * When the Reset button is pressed, frequencies of radio stations, titles, etc. stored in memory are cleared.*
The remote control unit does not work.	Direct rays of the sun fall on the light-receptive part of the remote control unit.	When direct rays of the sun fall on the light-receptive part of the remote control unit, it may not work.
	The batteries of the remote control unit are dead or there is no battery in the remote control unit.	Check the batteries of the remote control unit.

### DVD PLAYER

Problem	Cause	Measure
Disc cannot be loaded.	Another disc is already loaded.	Eject the disc before loading the new one.
	There is a foreign matter already in place.	Eject the foreign matter forcibly.
Sound skips or is noisy.	Compact disc is dirty.	Clean the compact disc with a soft cloth.
	Compact disc is heavily scratched or warped.	Replace with a compact disc with no scratches.
Sound is bad directly after power is turned on.	Water droplets may form on the internal lens when the car is parked in a humid place.	Let dry for about 1 hour with the power on.
The image is not displayed.	The parking brake is not engaged.	Check that the parking brake is engaged.
Disc cannot play with the display "PARENTAL VIOLATION" shown.	Feature exceeds set parental level.	Release the view limitation or change the parental level. See the subsection "Setting up the parental level"



## USB DEVICE

Problem	Cause	Measure
USB device cannot be inserted.	The USB device has been inserted with wrong direction.	Reversing the connection direction of the USB device, try it again.
	The USB connector is broken.	Replace with a new USB device.
USB device is not recognized.	The USB device is damaged.	Disconnect the USB device and reconnect. If the device is still not recognized, try replacing with a different USB device.
	Connectors are loose.	
No sound heard with the display "NO FILE" shown.	No MP3/WMA/AAC file is stored in the USB device.	Store these files properly in the USB device.
Sound skips or is noisy.	MP3/WMA/AAC files are not encoded properly.	Use MP3/WMA/AAC files encoded properly.
The iPod/iPhone's video image is disturbed.	The TV Signal setting of the iPod/iPhone is not set correctly.	Set the TV Signal setting (NTSC/PAL) of the iPod/iPhone correctly.

## 9. ERROR DISPLAY

If an error occurs, one of the following displays is displayed.  
Take the measures described below to solve the problem.

### DVD PLAYER

Display	Cause	Measure
<b>BAD DISC</b>	A disc is caught inside the CD deck and is not ejected.	This is a failure of DVD deck's mechanism and consult your store of purchase.
<b>BAD DISC</b>	A disc cannot be played due to scratches, etc.	Replace with a non-scratched, non-warped disc.
<b>BAD DISC</b>	A disc is loaded upside- down inside the DVD deck and does not play.	Eject the disc then reload it properly.
<b>PARENTAL VIOLATION</b>	Parental level error	Set the correct Parental level.
<b>WRONG REGION</b>	Region code error	Eject the disc, and replace correct region code disc.

If an error display other than the ones described above appears, press the Reset button.  
If the problem persists, turn off the power and consult your store of purchase.

\* When the Reset button is pressed, frequencies of radio stations, titles, etc. stored in memory are cleared.

## 10. SPECIFICATIONS

### FM Tuner

Frequency Range: 87.9 MHz to 107.9 MHz  
 Usable Sensitivity: 8 dB $\mu$ V  
 50dB Quieting Sensitivity: 14 dB $\mu$ V  
 Alternate Channel Selectivity: 70 dB  
 Stereo Separation: 25 dB (1 kHz)  
 Frequency Response: 30 Hz to 15kHz

### AM Tuner

Frequency Range: 530 kHz to 1710 kHz  
 Usable Sensitivity: 28 dB $\mu$ V

### DVD Player System

Digital Versatile Disc System with CDDA capable  
 Usable discs:  
 DVD video disc, Compact disc  
 Frequency Response: 20 Hz to 20 kHz  
 Sound/Noise Ratio: 95 dB (1W Ref)  
 Dynamic Range: 95 dB (1 kHz)  
 Distortion: 0.05%  
 Video system: NTSC  
 Digital Versatile Disc System

### Navigation

Memory: 2GB Flash Memory  
 Upgrade Platform: USB  
 3D Display Mode: 3D maps, 3D landmarks, 3D icons  
 User Mode: Simple mode, Advanced mode  
 TTS (Text to Speech):  
     Street Announcements  
 Find Menu: ADDRESS, POI, HISTORY, COORDINATES, FAVORITES, PLAN ON MAP  
 POI: 12 MILLION  
 Route Calculation: FAST, SHORT, ECONOMICAL, EASY  
 Vehicle Selection: CAR, TAXI, BUS  
 Road Selection: UNPAVED, PERMIT NEEDED MOTOR WAYS, TOLL, FERRIES, BORDER CROSSING, CARPOOL LANES

### Audio/Video Input

Audio input voltage: 300  $\mu$ V $\mu$ s (low)  
 Audio input voltage: 600  $\mu$ V $\mu$ s (med)  
 Audio input voltage: 950  $\mu$ V $\mu$ s (high)  
 Video input voltage: 1.0Vp-p @ 75 $\Omega$

### Audio/Video output:

Audio output impedance: 10k $\Omega$   
 Video output voltage: 1.0Vp-p @ 75 $\Omega$

### LCD Monitor

NX409 Screen Size: 6.5" wide type  
 Pixels: 280,800  
 Resolution: 1200 x 234  
 NZ409 Screen Size: 7" wide type  
 Pixels: 336,960  
 Resolution: 1440x234

### General

Power source voltage:  
 14.4 V DC (10.8 to 15.6 V allowable)  
 Ground: Negative  
 Current consumption: 4.0 A (1 W)  
 Auto Antenna Rated Current: 500 mA less  
 NX409 Dimensions of the Main Unit:  
 7" (178mm) Width, 3-15/16" (100mm) Height, 7" (179mm) Depth  
 NX409 Weight of the Main Unit: 3.5 kG  
 NZ409 Dimensions of the Main Unit:  
 7" (178mm) Width, 2" (50 mm) Height, 7.5" (191.5mm) Depth  
 NZ409 Weight of the Main Unit: 3.5 kG  
 Dimensions of the Remote Control Unit:  
 2-1/8" (54mm) Width, 9/16" (14mm) Height  
 4-13/16" (122 mm) Depth  
 Weight of the Remote Control Unit:  
 50 grams (including battery)

### Note:

- Specifications comply with JEITA Standards.
- Specifications and design are subject to change without notice for further improvement.

### Power Output:

18 W RMS x 4 Channels at 4  $\Omega$   
 and 1% THD+N

### Signal to Noise Ratio:

95 dBA (reference: 1 W into 4  $\Omega$ )





# INSTALLATION /WIRE CONNECTION GUIDE

## CONTENTS

1. BEFORE STARTING .....	47
2. PACKAGE CONTENTS .....	47
3. GENERAL CAUTIONS .....	47
4. CAUTIONS ON INSTALLATION .....	48
5. INSTALLING THE MAIN UNIT .....	49
6. CAUTIONS ON WIRING.....	51
7. WIRE CONNECTIONS.....	52

### 1. Before Starting

1. This set is exclusively for use in cars with a negative ground 12V power supply.
2. Read these instructions carefully.
3. Be sure to disconnect the battery“ ”terminal before starting. This is to prevent short circuit during installation. (Figure 1)

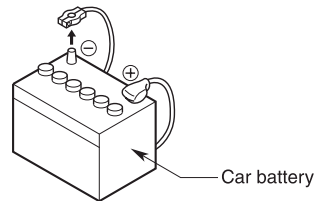

Figure 1

### 2. Package Contents

Main unit.....	1	2DIN Trim ring .....	1
GPS antenna.....	1	2DIN trim ring 200mm wide .....	1
SMK wiring harness .....	1	Back Strap .....	1
AV cable .....	1	Flush mount bolts .....	4
USB extending cable .....	1	Cap bolts .....	4
Remote control unit .....	1	Rear radio stud and stopper .....	1
Battery (CR2025) .....	1	Cleaning cloth.....	1
(Installed in remote control)		Warranty Card .....	1

### 3. General Cautions

1. Do not open the case. There are no user- serviceable parts inside. If you drop anything into the unit during installation, consult your dealer or an authorized Clarion service center.
2. Use a soft, dry cloth to clean the case. Never use a rough cloth, thinner, benzene, or alcohol etc. For tough dirt, apply a little cold or warm water to a soft cloth and wipe off the dirt gently.

#### 4. Cautions on Installation

1. Prepare all articles necessary for installing the source unit before starting.
2. This model features an operation panel that slides forward.  
On some types of cars, the operation panel may make contact with the dashboard or gearshift lever, in which case it cannot be installed. Before installing, check that the unit will not hamper operation of the gearshift lever or obstruct your view before selecting the installation location. (Figure 2)
4. If you have to do any work on the car body, such as drilling holes, consult your car dealer before hand.
5. Use the enclosed screws for installation. Using other screws can cause damage. (Figure 4)

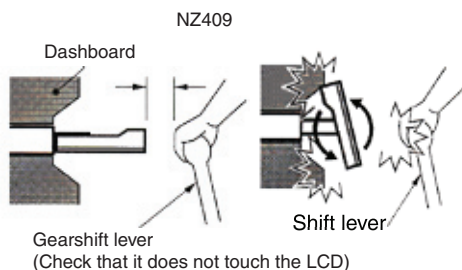

Figure 2

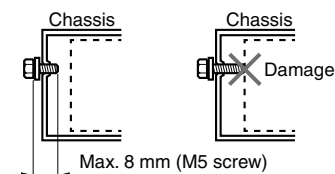

Figure 4

3. Install the unit within 30° of the horizontal plane. (Figure 3)

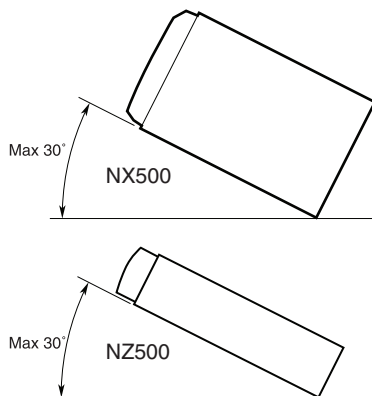

Figure 3



## 5. Installing the Main Unit

This unit is designed for fixed installation in the dashboard.

1. When installing the main unit in NISSAN vehicles, use the parts attached to the unit and follow the instructions in Figure 6. When installing the main unit in TOYOTA vehicles, use the parts attached to the vehicle and follow the instructions in Figure 7.

2. Wire as shown in Section 7.
3. Reassemble and secure the unit in the dashboard and set the face panel and center panel.

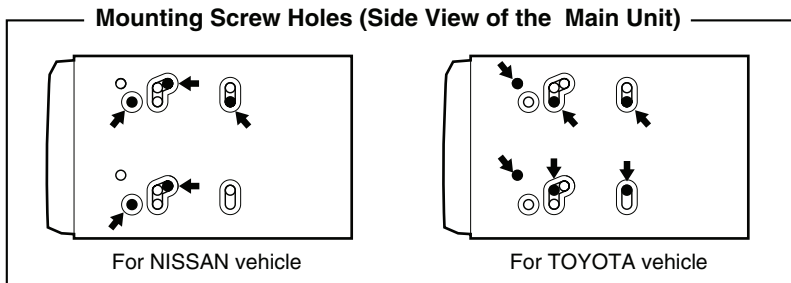

Figure 5

### Installing the Main Unit in NISSAN Vehicle

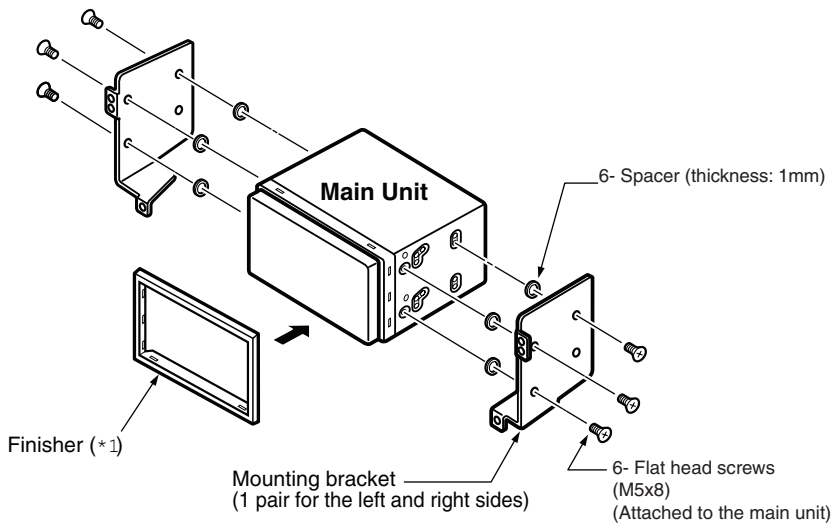

Figure 6

#### Note:

\*1: Position the face panel with its wide edge at the bottom. Fit the edge into the groove of the main





## Installing the Main Unit in TOYOTA Vehicle

Install by using parts attached to the vehicle. (Screws marked ★ are attached to the vehicle.)

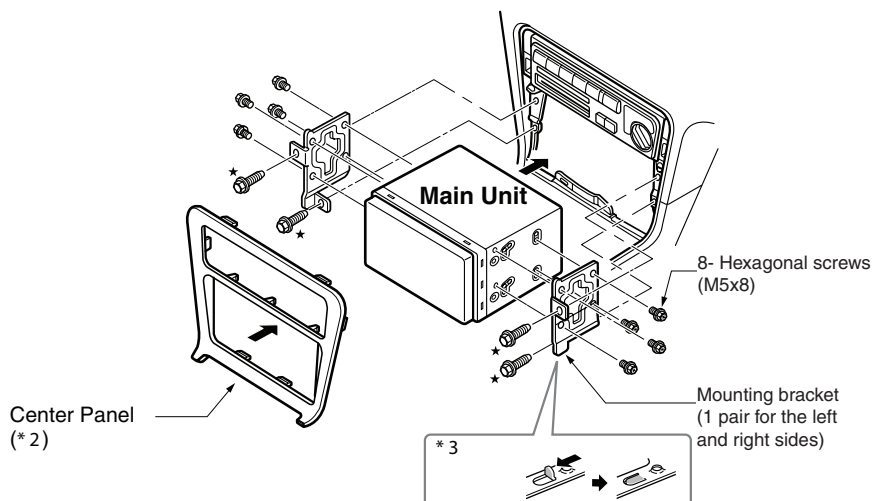
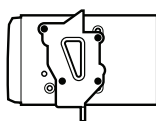

Figure 7

\*2 Some panel openings are too small for the unit depending on the vehicle type and model. In such a case, trim the upper and lower sides of the panel frame by about 0.5 to 1.5 mm so the unit can be inserted smoothly.

\*3 If a hook on the installation bracket interferes with the unit, bend and flatten it with a nipper or similar tool.

### Typical Mounting Brackets



Example 1

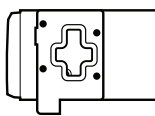

Example 2



Example 3

Affix the screws to the ● marks.

### Vehicles other than NISSAN and TOYOTA

In some cases the center panel may require modification. (Trimming, filing, etc.)

#### • Removing the Main Unit

When the main unit is to be removed, disassemble it in the reverse of the order in "INSTALLING THE MAIN UNIT".



## 6. Cautions on Wiring

1. Be sure to turn the power off before wiring.
2. Be particularly careful where you route the wires.  
Keep them well away from the engine, and exhaust pipe, etc. Heat may damage the wires.
3. If the fuse should blow, check to see if the wiring is correct.  
If a fuse is blown, replace it with a new one of the same amperage rating as the original (15A FUSE).
4. To replace the fuse, remove the old fuse on the back of the unit and insert the new one. (Figure 8)

### NOTE:

*There are various types of fuse holder. Do not let the battery side touch other metal parts.*

### ⚠ CAUTION

**After the connection, fix the cord by a clamp or insulation tape for protection.**

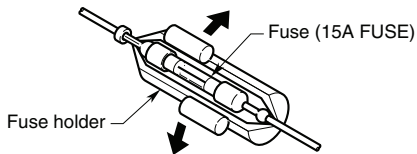

Figure 8

## 7. Wire Connections

### Note:

- Before installing, be sure to disconnect the negative cable of the car battery.
- In the optional devices, the RCA cables and the Connector cables are separately-sold items.

### NX409

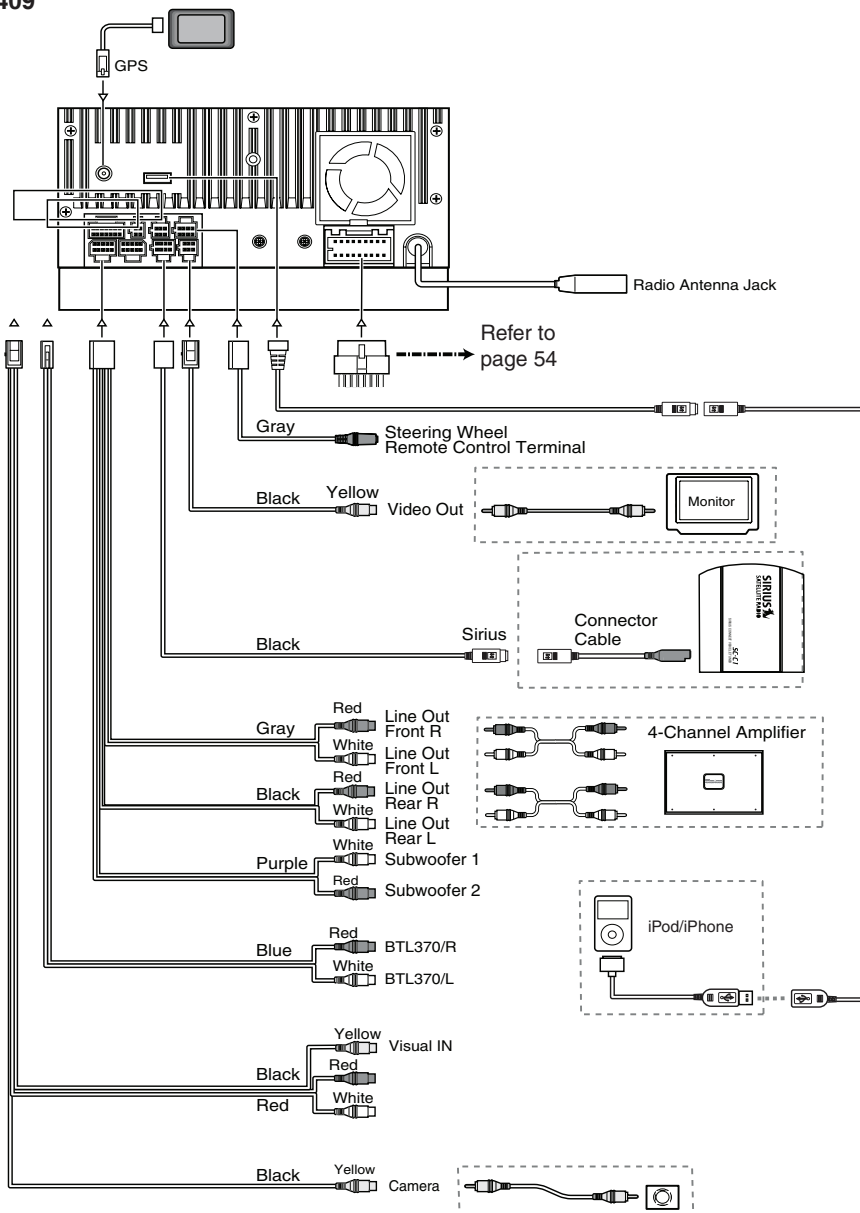



NZ409

English

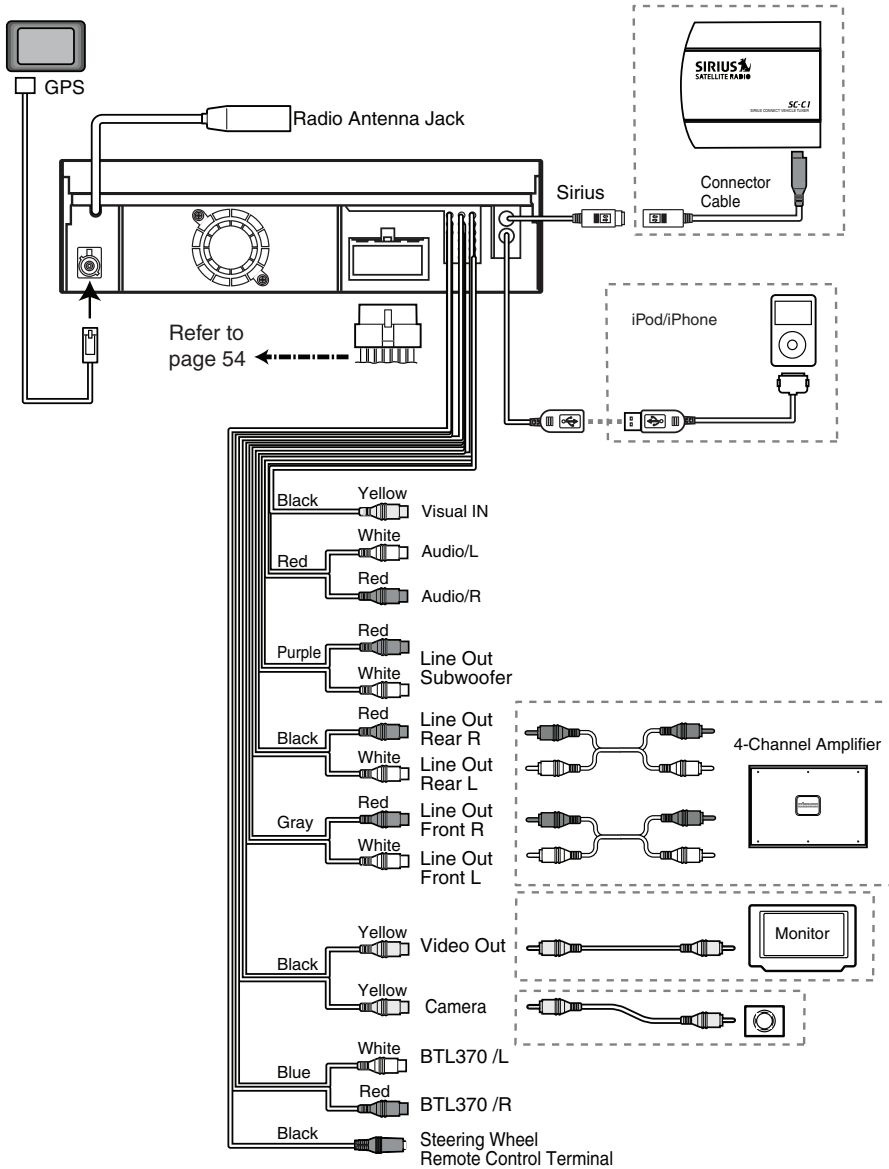

NX500/NZ500

53

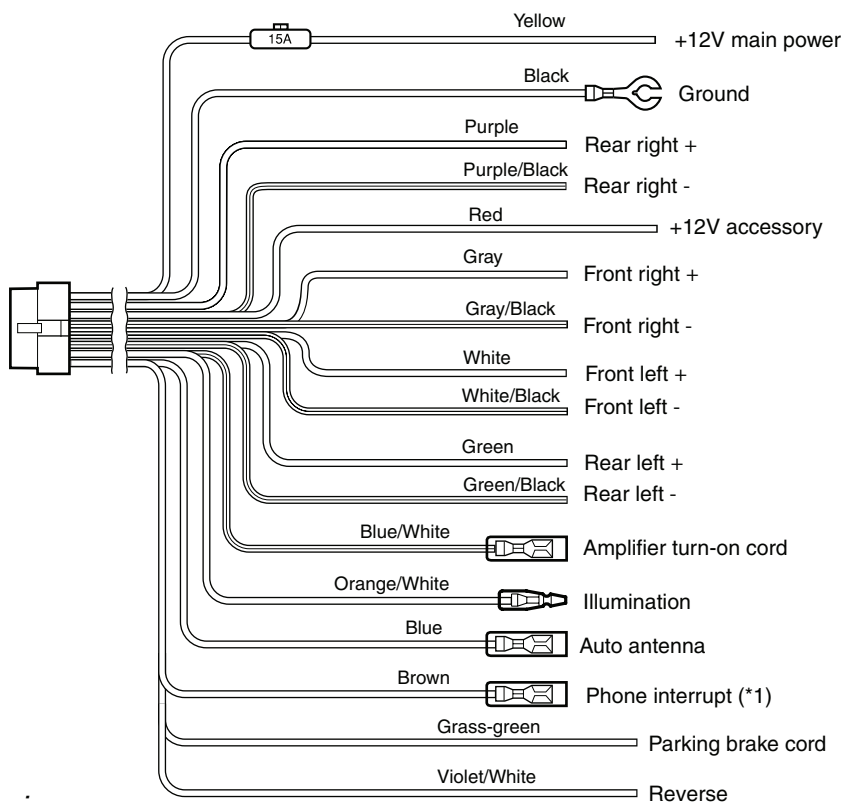

**Note**

\*1: Connecting the PHONE INTERRUPT terminal

The phone interrupt will mute the audio if the lead receives a negative or ground signal.

See next page for how to connect the parking brake cord.



## Connecting the parking brake cord

Connect the cord to parking brake lamp ground in the meter panel.

### Note:

- Connecting the parking brake cord to lamp ground allows you to watch iPod/iPhone video/DVD video/AV input when the parking brake is engaged.
- When the parking brake cord is not connected, the monitor will not show any video sources.
- If **"AUDIO ONLY"** appears on the screen just after turning on the ACC power of the car, release the parking brake while confirming safety, and then engage the parking brake again.

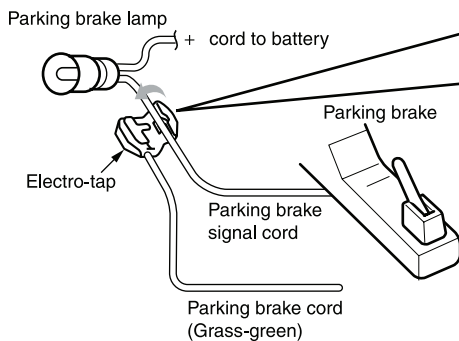

### How to attach the electro-tap

1. Place the Parking brake cord at the stopper, and fold it back in the direction of the arrow.
2. Pass the Parking brake signal cord through, and fold it back in the direction of the arrow.

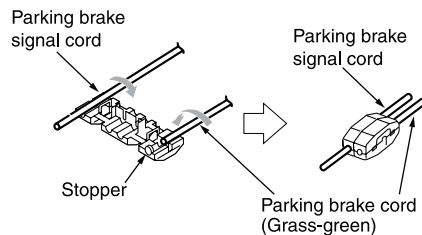

## Connecting the accessories

### • Connecting to the external amplifier

The external amplifiers can be connected to the 6 channel RCA output connections. Ensure that the connectors are not grounded or shorted to prevent damage to the unit.

### • Connecting to iPod/iPhone device

The iPod/iPhone device can be connected to dedicated iPod/iPhone connection on the main unit. For detailed information, refer to the instruction sheet or manual for the iPod/iPhone cable.

### Note:

- This unit may not support all functions of all iPod/iPhone devices
  - The iPod/ iPhone connection will charge your iPod/iPhone unless the iPod/iPhone battery is completely depleted.
- If the specified cord of the cellular phone is connected to the phone interrupt cord of the main unit, the audio mute is activated when cellular phone in use.

### • Connecting to Sirius Satellite Radio Receiver

When Sirius Satellite Radio Receiver is to be connected, use the dedicated connector. For detailed information, refer to the instruction manual of the Sirius Satellite Radio Receiver.