

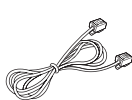

● Package Contents



Tel. Line



LAN Cable

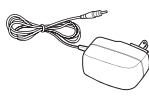

Adapter



Quick
Installation Guide

● To connect the cables as follows :

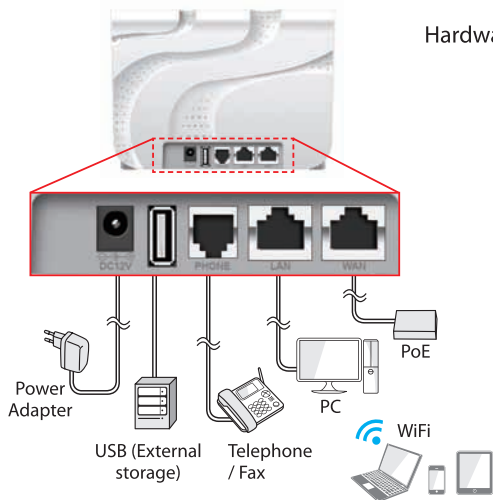

Hardware Reset

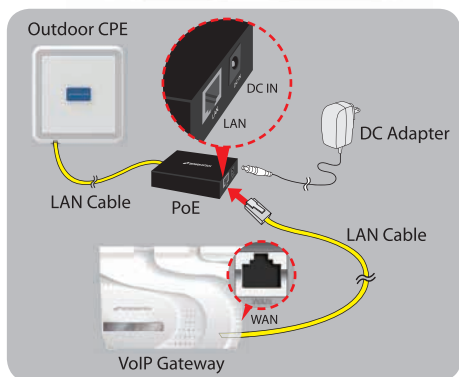

● LED Presentation

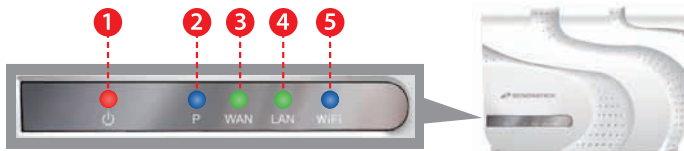

LED Indicator	LED Status	LED Color	Function
1 POWER	ON		Device Power On
2 PHONE	ON		Connected to phone
3 WAN	ON Blinking		Connected to Internet During WAN communication
4 LAN	ON Blinking		Connected to LAN During LAN communication
5 WiFi	ON		Connected to WiFi

Setting steps

- Make sure the LEDs working as follows
- How to connect to CPE's WiFi network:
 - ▶ Search for WiFi SSID **Seowon_WIFI**
 - ▶ There is no password for WiFi as default setting.
- Go to WEB "http://192.168.2.1".

The login page for Seowon Intech. It features the company logo and name at the top, followed by a 'Log-in' heading. Below this are two input fields: 'User Name' with the text 'admin' and a red circle '1' next to it, and 'Password' with masked dots and a red circle '2' next to it. A blue 'Login' button is positioned below the password field. At the bottom, it says 'Powered by Seowonintech'.

User Name = admin
Password = admin

- If your device doesn't connect to network, follow steps as below.
 - ▶ Check "**Network Setup**" from the left menu.

The 'Network Setup' page in the Seowon Intech web interface. On the left is a 'Menu' sidebar with options like 'LTE Config.', 'Indoor Gateway Config.', 'Overview', 'Operation mode', 'Network Setup', 'WAN', 'LAN', 'DHCP clients', 'VPN Passthrough', '2.4GHz WiFi', 'NAT Setup', 'Storage', 'VoIP Setup', and 'Administration'. The 'Network Setup' option is highlighted with a red circle '3'. The main area is titled 'Wide Area Network (WAN) Settings' and contains a description: 'You may choose different connection type suitable for your environment. Besides, you may also configure parameters according to the selected connection type.' Below this, there's a 'WAN' section with a 'WAN Connection Type' dropdown menu set to 'DHCP (Auto config)' (marked with a red circle '4'), a 'DHCP Mode' section with a 'Hostname' input field, and a 'MAC Clone' section with 'Enabled' and 'Disable' radio buttons. 'Apply' and 'Cancel' buttons are at the bottom right.

FCC Warning:

Any Changes or modifications not expressly approved by the party responsible for compliance could void the user's authority to operate the equipment.

This device complies with part 15 of the FCC Rules. Operation is subject to the following two conditions: (1) This device may not cause harmful interference, and (2) this device must accept any interference received, including interference that may cause undesired operation.

FCC Radiation Exposure Statement:

This equipment complies with FCC radiation exposure limits set forth for an uncontrolled environment. This equipment should be installed and operated with minimum distance 20cm between the radiator& your body.

This transmitter must not be co-located or operating in conjunction with any other antenna or transmitter.

Note:

This equipment has been tested and found to comply with the limits for a Class B digital device, pursuant to part 15 of the FCC Rules. These limits are designed to provide reasonable protection against harmful interference in a residential installation. This equipment generates uses and can radiate radio frequency energy and, if not installed and used in accordance with the instructions, may cause harmful interference to radio communications. However, there is no guarantee that interference will not occur in a particular installation. If this equipment does cause harmful interference to radio or television reception, which can be determined by turning the equipment off and on, the user is encouraged to try to correct the interference by one or more of the following measures:

- Reorient or relocate the receiving antenna.
- Increase the separation between the equipment and receiver.
- Connect the equipment into an outlet on a circuit different from that to which the receiver is connected.
- Consult the dealer or an experienced radio/TV technician for help.