

User manual

Please read this instruction carefully before use and keep it properly.

FCC ID:V3N-HANTAT-HTR300

Packing list

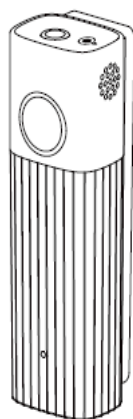

Receiver*1

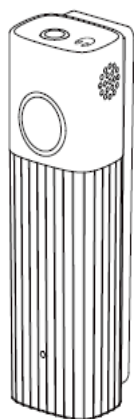

Transmitter*1

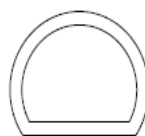

Windshields*1

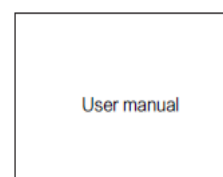

Manual*1

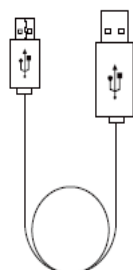

USB charging cable*1

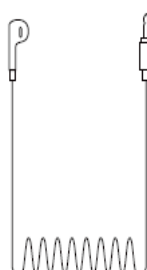

monitor earphone*1

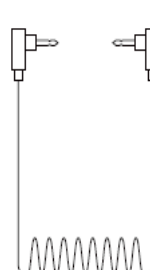

Audio cable*1

How to identify the product?

You can identify the product by the silkscreen on the back of the product.
Blue "RX" =Receiver Red "TX" =Transmitter

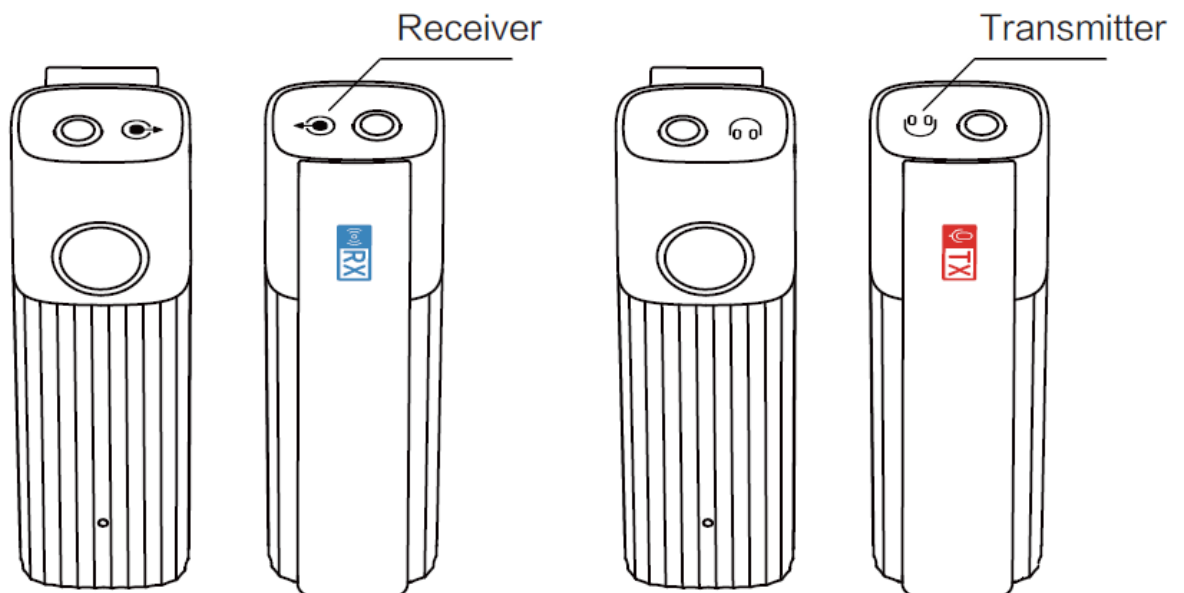

Product function guide

3.5mm interface

Connect sound card ,
mobile phone,etc.

3.5mm interface

Connect to monitor earphone,and then you can
receive audio synchronously in real time.

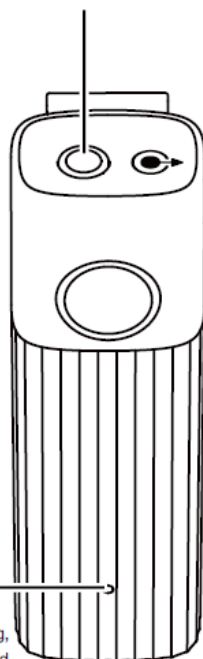

Indicator light

1. The red light is always on when charging,
and the red light is off when fully charged.
2. Flashing blue light means it is waiting for pairing,
and the blue light is always on when the pairing is successful.

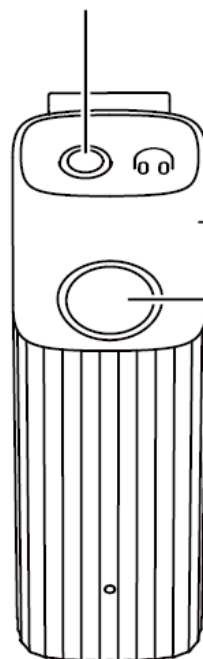

Microphone

Button

1. Turn on: Long press until the indicator light turns blue.
2. Turn off: press and hold until the indicator light goes out.
3. Pairing: the blue light flashes after power on,
double-click a button and then double-click another button.
The blue light will be on after successful pairing.
If the blue lights of both devices are on, the pairing is successful.

Usb charging port

How to use

Use the transmitter:

Wear the product on the person who needs to talk,
and then you can record the sound.

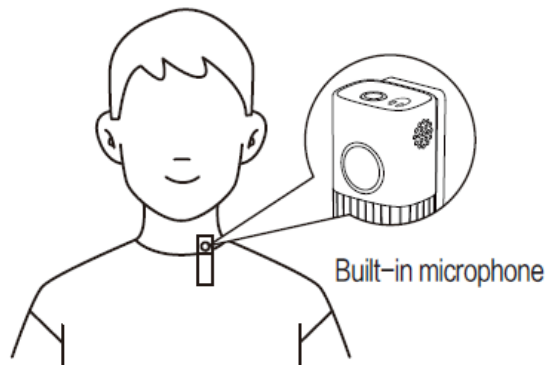

How to use monitor headphones:

Insert the monitor headset into the transmitter and wear it on the person who needs to receive the sound.

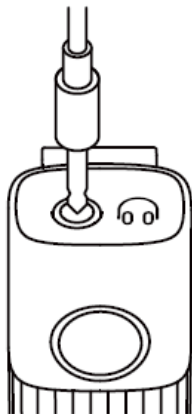

Step-1:

Insert the monitor earphone into the transmitter

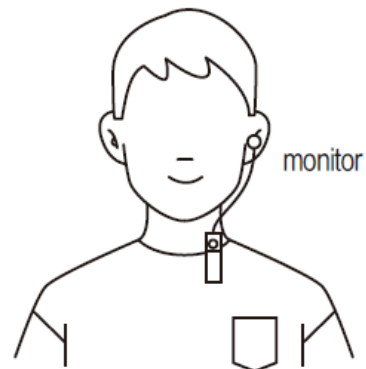

Step-2:

Wear them on the person who needs to be record the sound.

How to use

How to use the receiver:

Connect the audio cable to the 3.5mm interface of the receiving end and devices such as sound card, mobile phone, etc. (The mobile phone interface needs to support CTIA standard)

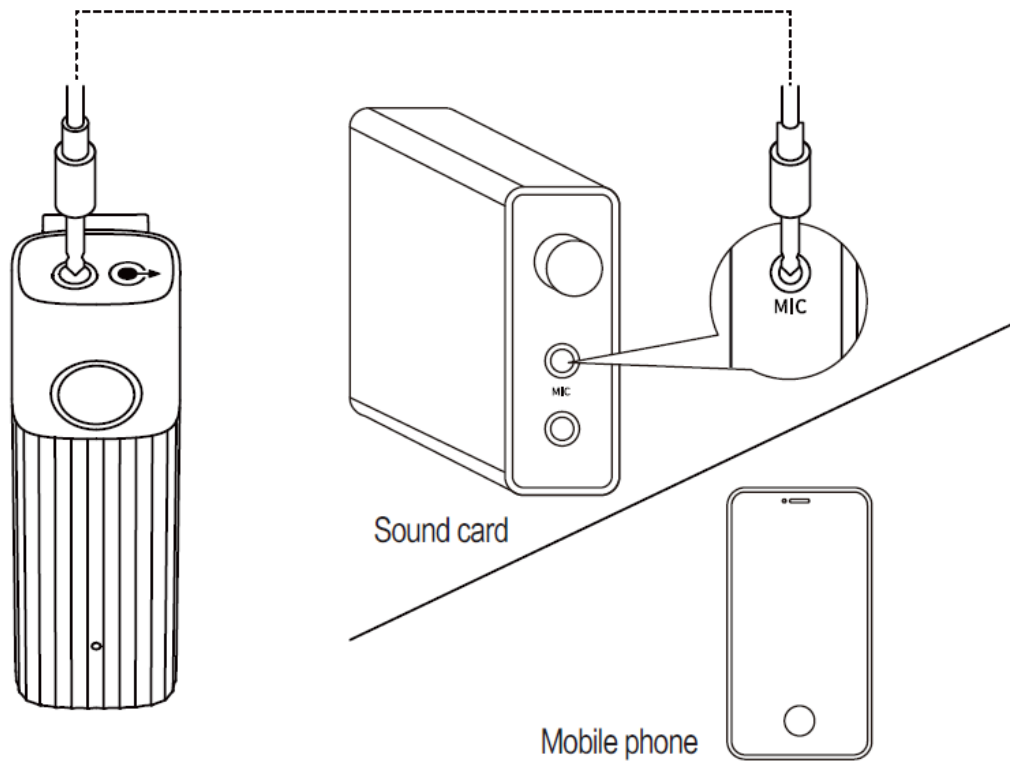

How to use

In use status:

After the product is turned on and successfully connected, the radio can be synchronized.

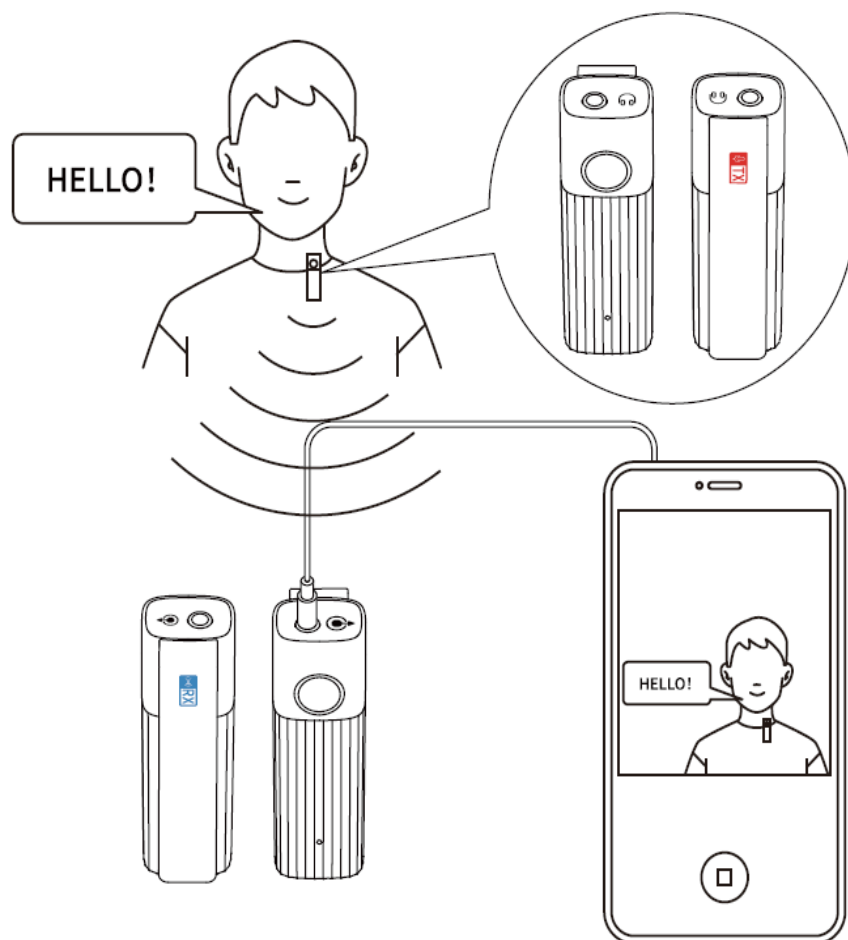

Notice

1. Do not dismantle the shell without authorization
2. Do not expose the whole product to excessive heat, such as long-term exposure to sunlight, fire, or similar high-temperature environments.
3. The battery cannot be replaced by yourself. If you need to replace it, please contact professional maintenance personnel.
4. Do not use external antennas or use other transmitting antennas without authorization.
5. The user shall bear the direct or indirect damage caused by the violation of the instructions.
6. Please use a soft dry towel to clean the product.
7. This product is not waterproof, please do not put it in water.
8. If you have any questions or problems about this product, but you cannot find out in this manual, please contact us.

FCC Warning Message

NOTE: This equipment has been tested and found to comply with the limits for a Class B digital device, pursuant to part 15 of the FCC Rules. These limits are designed to provide reasonable protection against harmful interference in a residential installation. This equipment generates uses and can radiate radio frequency energy and, if not installed and used in accordance with the instructions, may cause harmful interference to radio communications. However, there is no guarantee that interference will not occur in a particular installation. If this equipment does cause harmful interference to radio or television reception, which can be determined by turning the equipment off and on, the user is encouraged to try to correct the interference by one or more of the following measures:

- Reorient or relocate the receiving antenna.
- Increase the separation between the equipment and receiver.
- Connect the equipment into an outlet on a circuit different from that to which the receiver is connected.
- Consult the dealer or an experienced radio/TV technician for help

Changes or modifications not expressly approved by the party responsible for compliance could void the user's authority to operate the equipment.

This device complies with Part 15 of the FCC Rules. Operation is subject to the following two conditions:

- (1) this device may not cause harmful interference, and
- (2) this device must accept any interference received, including interference that may cause undesired operation.

List of Harmful Sub stance

Harmful Sub stance						
	(Pb)	(Hg)	(Cd)	(Cr(VI))	(PBB)	(PBDE)
Built-in circuit board	×	○	○	○	○	○
Shell	×	○	○	○	○	○
Accessories	×	○	○	○	○	○
<p>This form is compiled in accordance with the provisions of SJ/T11364</p> <p>O: It means that the hazardous substance has the content of all homogeneous materials of the part under the limit requirements of GB/T26572.</p> <p>X: It means that the content of the hazardous substance in at least a certain homogeneous material of the part exceeds the limit requirement of GB/T26572.</p>						

Warranty Card

Product name			
Product model			
Purchase date			
Problem description			
User name			
User address			
Contact number			