



8886 N. Government Way  
Hayden, ID 83835  
Phone: 208-772-2780  
Fax: 208-762-4877  
www.ztxwireless.com

## ZTX965D

### Multi Input 900 MHz Universal Transmitter

The ZTX965D offers the diversity of three independent contact closure alarm inputs, one independent analog input to monitor an external battery and one set of internal contact magnetic reed switches. All alarm inputs are de-bounced and are interrupt driven so the change of state is recognized in microseconds then verified for a few milliseconds which initiates the alarm or restore transmitted information.

The ZTX965D is capable of being supervised by the system, the period between and the number of transmits per supervisory check-in is programmable, 1 to 65,535 seconds and times to transmit from 1 to 255. Default values are 300 seconds and 2 supervisory transmits.

The ZTX965D internal battery is constantly monitored by the microprocessor and a low battery condition is the result of during a transmission or any event the battery level reaches a predetermined threshold. This threshold has been established to allow the battery to fully support the transmitter for as long as two weeks under normal operation. When the Low Battery Condition has been detected, the transmitter transmits a Low Battery Alarm and the Low Battery Status is latched. The Low Battery Status is transmitted with supervisory and alarm events.

### Mounting the ZTX965D

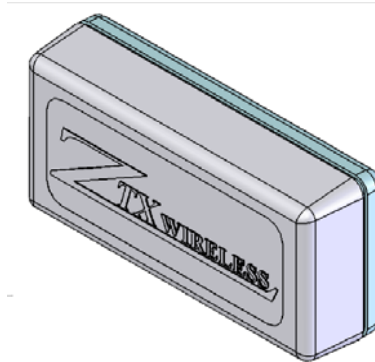

Mount the bracket to a wall, door jam or a window casing using two each # 6 flathead wood or sheet metal screws. Engage the enclosure bottom with slide latches and slide the enclosure onto the bracket until it latches. To remove the enclosure, remove the cover and remove the battery. Use a small screw driver to push and release the latch, under the battery, and slide the enclosure bottom off of the bracket.

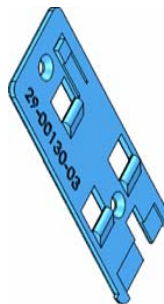

Specifications

Contacts external / internal	NO / NC
Max lead length for external contacts	12 feet
Dimensions	3.535" x 1.709" x 1.04"
Weight	2.5 oz (71gm)
Operating Temperature	32° to 140° F (0° to 60°C)
Typical reed switch engage / release	.6" / .8"
Battery type	3.0 V Lithium CR123A
Typical Battery life	4 years

ZTX965D User Manual Doc 100-00130-20 Rev 1 3-31-08

### ZTX965D Battery Replacement

To replace the battery, remove the cover, remove the battery and replace with a new battery, observing the polarity labeled under the battery. Push the reset button and reinstall the cover.

### ZTX965D Programming

The transmitter is factory programmed with default values and the IDs are sequentially programmed when the unit passes final test. For custom programming contact the factory. The programmed firmware resides in non-volatile flash memory. The loss of power will not cause the loss of program.

Reed switch top and side



Input connector J2  
Pin 1 = Ground  
Pin 2 = Alarm 1  
Pin 3 = Alarm 2  
Pin 4 = Alarm 3  
Pin 5 = External Battery  
Internal Reed 1 at top and 1 at right center

## Warranty & Disclaimer

ZTX Wireless, Inc. ("ZTX Wireless") warrants its products ("Product" or "Products") to conform to its own specifications and to be free of defects in materials and workmanship under normal use for a period of twelve (12) months from the date of manufacture. Within the warranty period ZTX Wireless will repair or replace, at its option, all or any part of the warranted products. ZTX Wireless will not be responsible for dismantling and/or reinstallation charges. To exercise the warranty, the User ("User", "Installer" or "Consumer" must be given a Return Material Authorization ("RMA") Number by ZTX Wireless. Details of shipment will be arranged at that time.

This warranty does not apply in cases of improper installation, misuse, failure to follow installation and operating instructions, alteration, abuse, accident or tampering, and repair by anyone other than ZTX Wireless.

This warranty is exclusive and expressly in lieu of all other warranties, obligations or liabilities, whether written, oral, express, or implied, including any warranty of merchantability or fitness for a particular purpose. ZTX Wireless will not be liable to anyone for any consequential or incidental damages for breach of this warranty or any other warranties.

This warranty shall not be modified, varied or extended. ZTX Wireless does not authorize any person to act on its behalf to modify, vary or extend this warranty. This warranty will apply to ZTX Wireless products only. All other products, accessories or attachments used in conjunction with ZTX Wireless equipment, including batteries, will be covered solely by their own warranty, if any. ZTX Wireless will not be liable for any direct, incidental or consequential damage or loss whatsoever, caused by the malfunction of Products due to products, accessories, or attachments of other manufacturers, including batteries, used in conjunction with ZTX Wireless Products. This warranty does not warrant the replacement of batteries that are used to power ZTX Wireless Products.

The User recognized that properly installed and maintained emergency call system may only reduce the risk of events such as personal injury, robbery, burglary or fire. It does not insure or guarantee that there will be no death, personal damage and/or damage to property as a result. ZTX Wireless does not claim that the Product may not be compromised and/or circumvented, or that the Product will prevent any death, personal and/or bodily injury and/or damage to property resulting from burglary, robbery, fire or otherwise, or that the Product will in all cases provide adequate warning or protection.

ZTX Wireless shall have no liability for any death, injury or damage, however incurred, based on a claim that ZTX Wireless Products failed to function. However, if ZTX Wireless is held liable, directly or indirectly, for any loss or damage arising under this limited warranty or otherwise, regardless of cause or origin, ZTX Wireless' maximum liability will not in any case exceed the purchase price of the Product, which will be fixed as liquidated damages and not as a penalty, and will be the complete and exclusive remedy against ZTX Wireless.

► **Warning:** The User should follow all installation, operation and maintenance instructions. The User is strongly advised to conduct Product and systems tests at least once each week. Changes in environmental conditions, electric or electronic disruptions and tampering, may cause the Product to not perform as expected.

► **Warning:** ZTX Wireless warrants its Product to the User. The User is responsible for exercising all due prudence and taking necessary precautions for the safety and protection of lives and property wherever ZTX Wireless products are installed.

► **Warning:** The Manufacturer is not responsible for any radio or TV interference caused by unauthorized modifications to this equipment. Such modifications could void the user's authority to operate this equipment.