

DYNAMO POWER

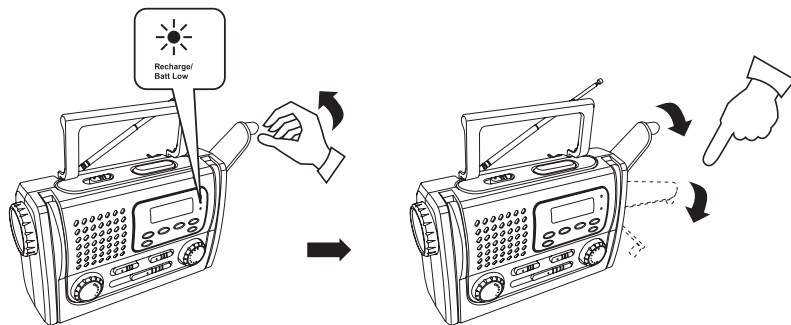

You can also use the built-in **POWER STATION** to charge an external low-voltage device such as a phone or PDA (subject to device compatability). Connect the device (cords not included) to the dynamo out jack and crank the dynamo.

AC ADAPTOR (NOT INCLUDED)

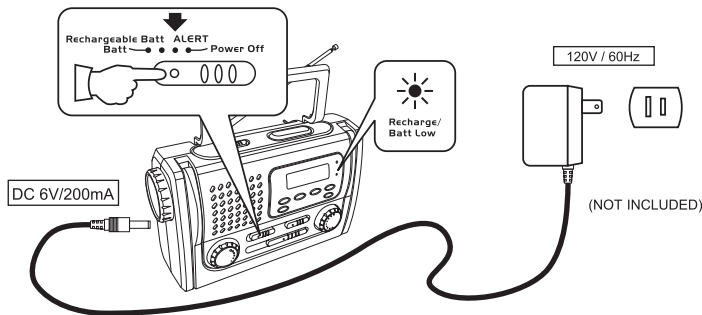

Note: Keep the AC Adaptor (Not Included) connected for about 12 hours to fully charge.

AUXILIARY BATTERIES (NOT INCLUDED)

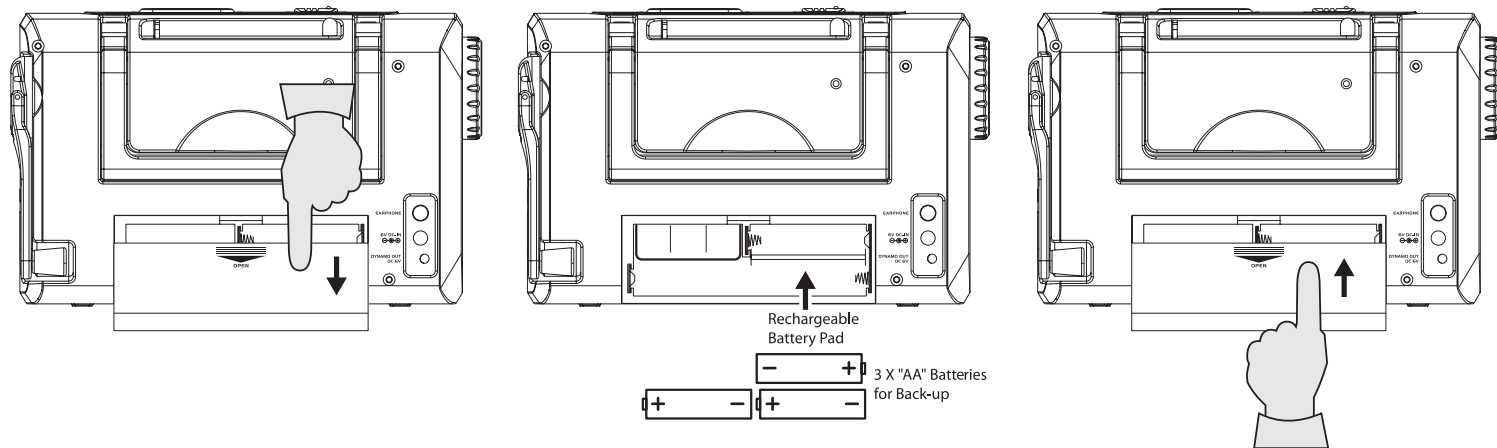

Replace the 3 "AA" batteries with new ones when the low battery indicator illuminates, the sound become unstable, or the clock display no longer functions.

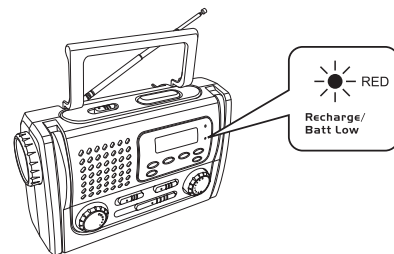

SETTING THE TIME

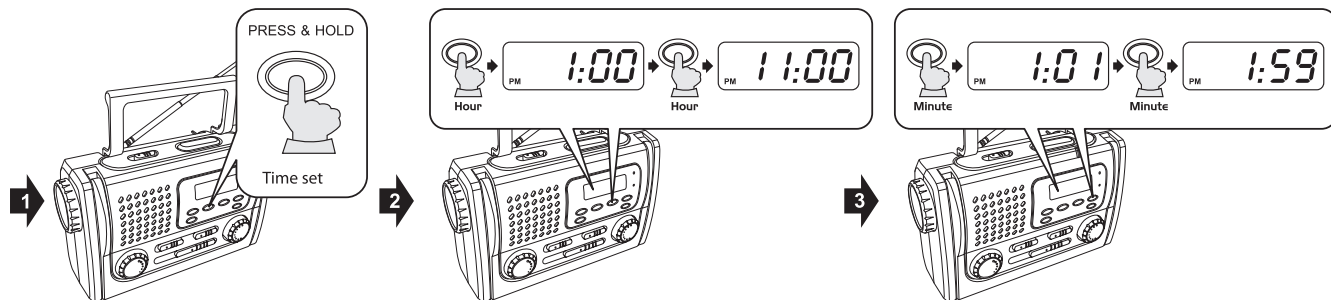

Note: In the Radio on mode, press the radio/clock button to alternate between radio and clock displays.



LISTENING TO THE RADIO

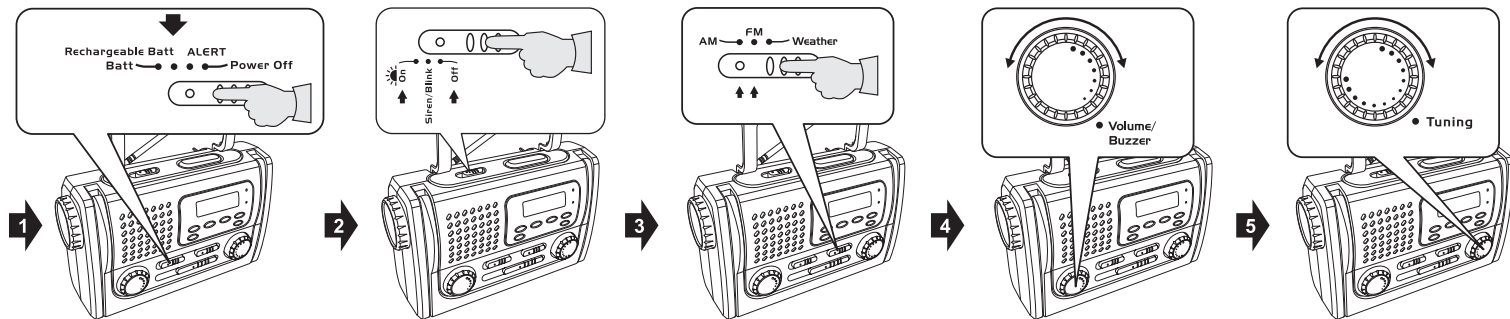

RECHARGEABLE BATT.=BUILT-IN RECHARGEABLE BATTERY
 BATT.=3 x "AA" ALKALINE BATTERIES (NOT INCLUDED)

TO IMPROVE RECEPTION

FM:

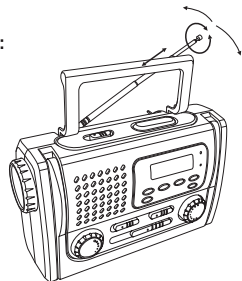

AM:

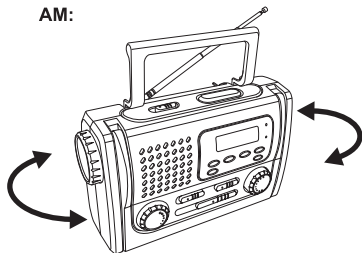

LISTENING WITH HEADPHONES (NOT INCLUDED)

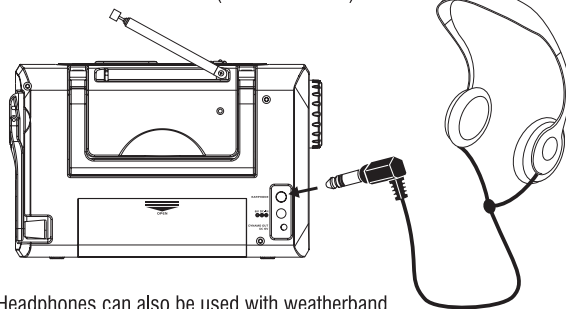

Note: Headphones can also be used with weatherband.