

# MC92N0-G

## QUICK START GUIDE



### BATTERY INSERTION

<http://www.motorolasolutions.com/mc92n0-g>  
See User Guide for more information

POST IN WORK AREA

#### Front View

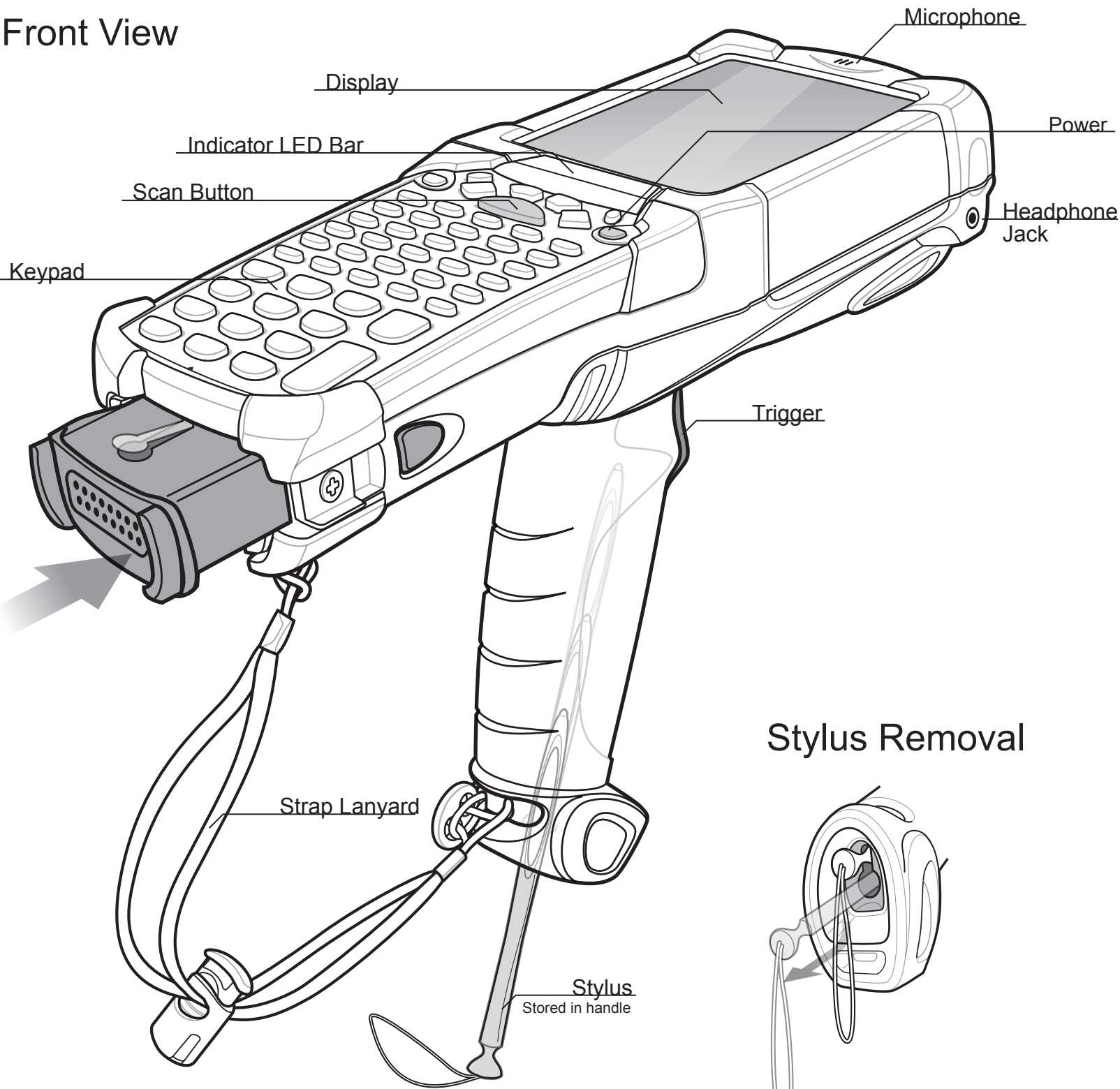

#### Battery Removal

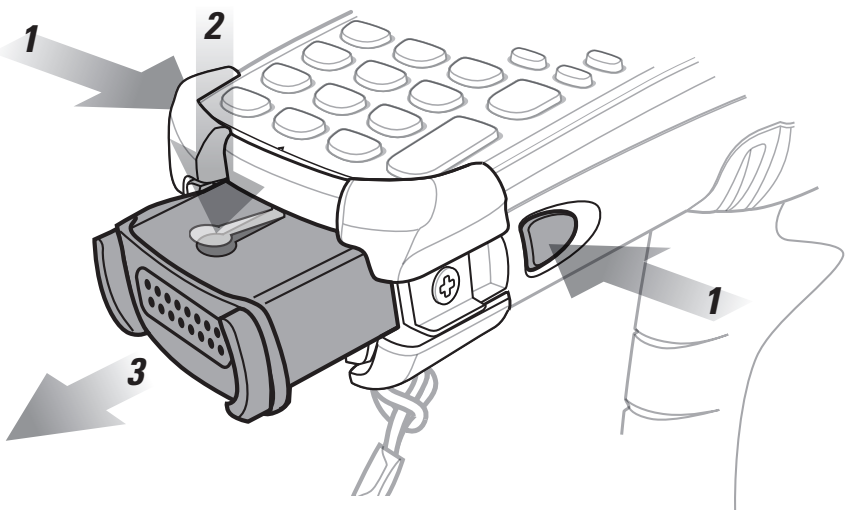

#### Stylus Removal

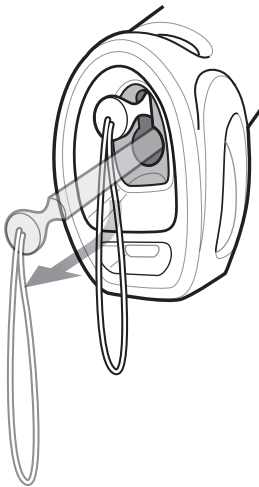

### SNAP-ON ACCESSORY INSTALLATION

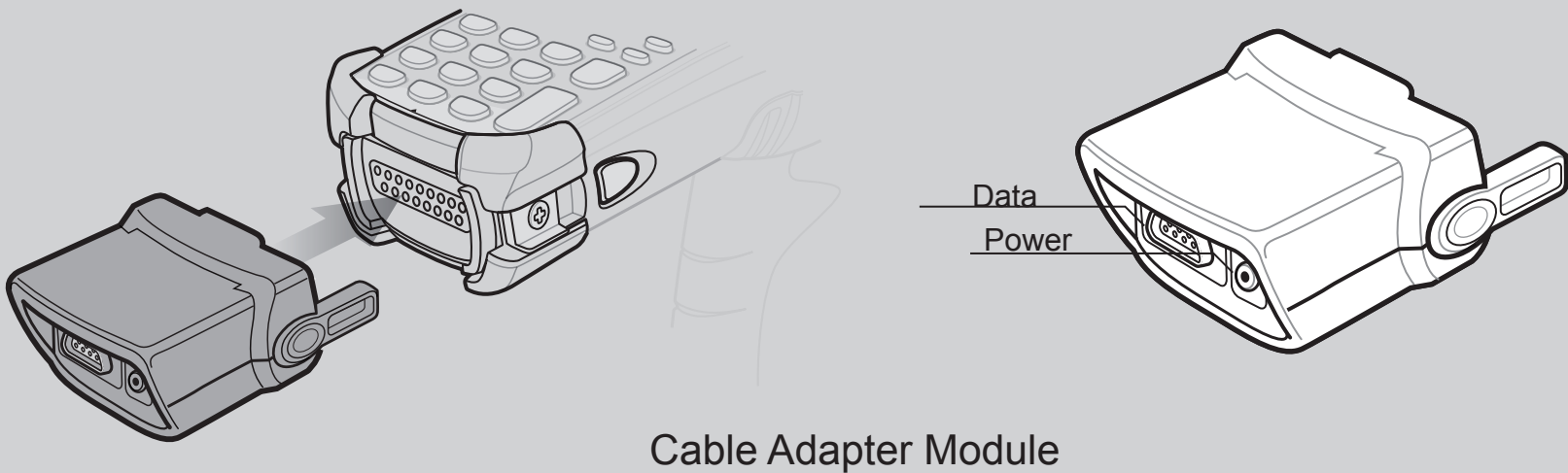

### CHARGING INSTRUCTIONS

⦿ = LED Indicator Location    Slow Flash = Normal Charge    Solid Amber = Full Charge    Fast Flash = Charging Error

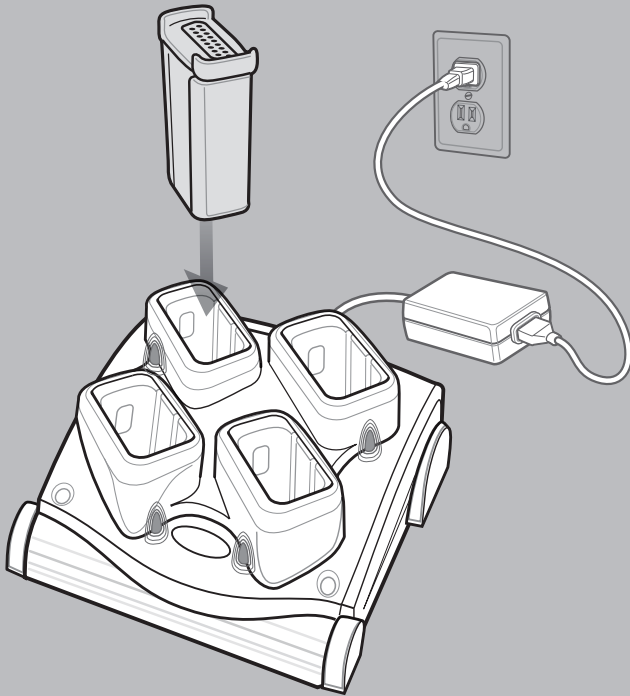

Four Slot Spare Battery Charger

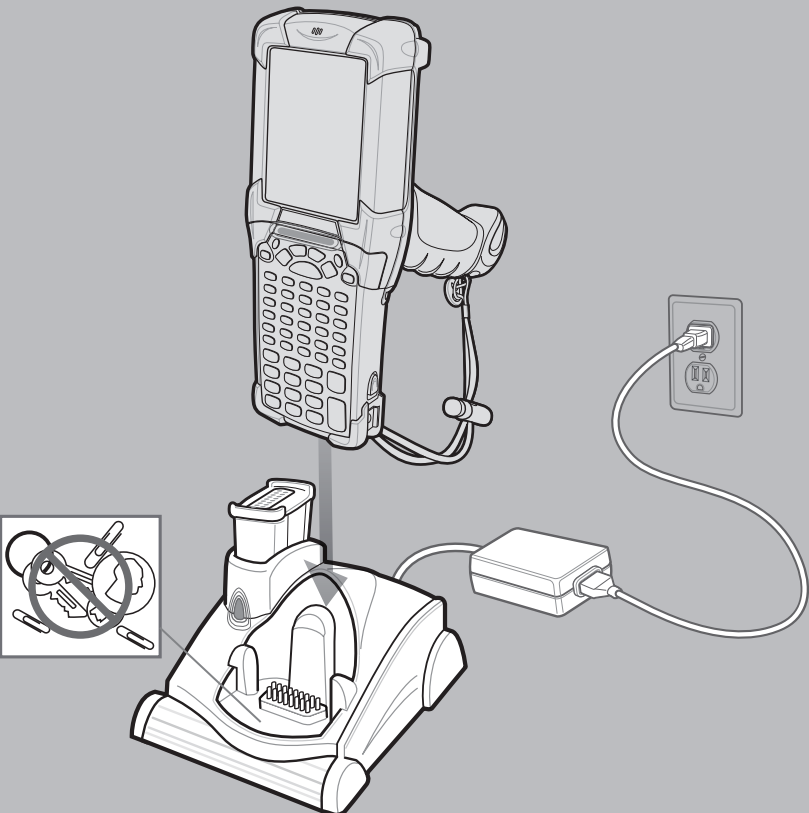

Single Slot Serial/USB Cradle

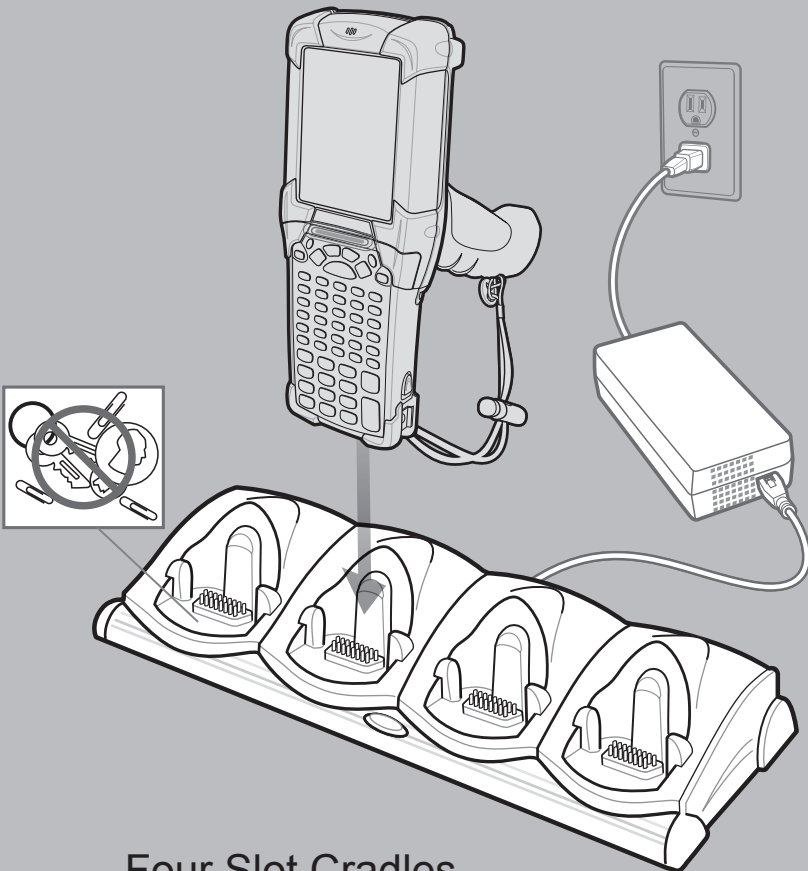

Four Slot Cradles  
Charge-Only Cradle and Ethernet Cradle

# OPTIMUM IMAGING AND SCANNING POSITIONS

Laser Scanning

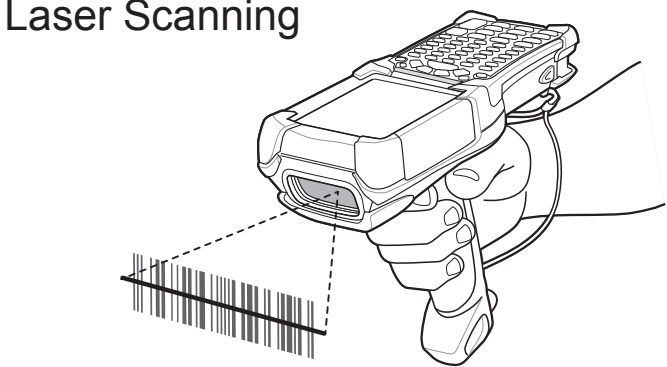

Standard Range Imaging

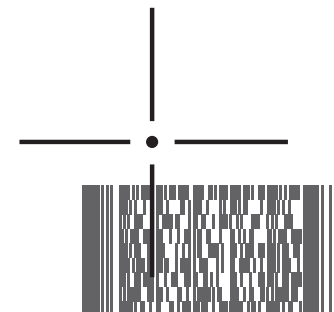
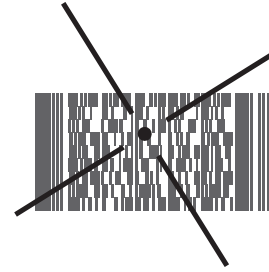
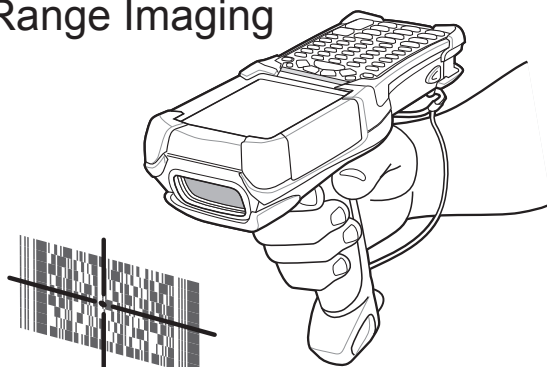

Long Range Imaging

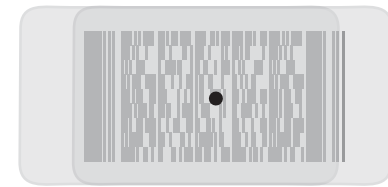
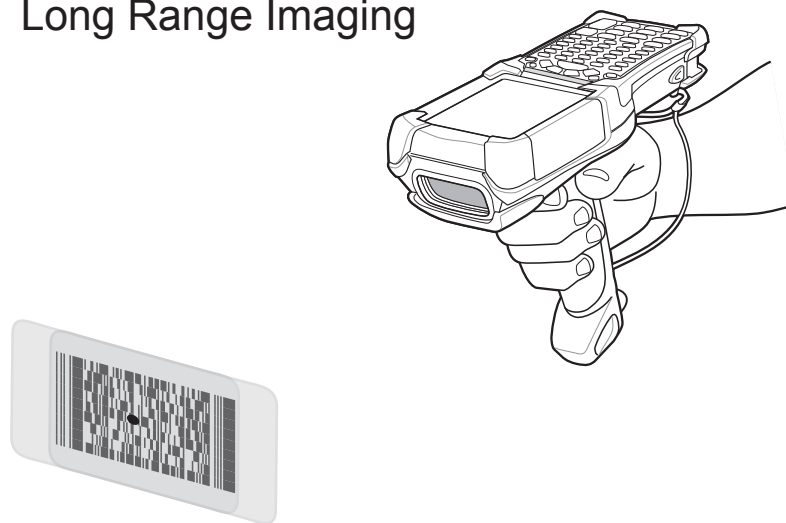

## OPTIMUM UPRIGHT BODY POSTURE



## AVOID EXTREME WRIST ANGLES

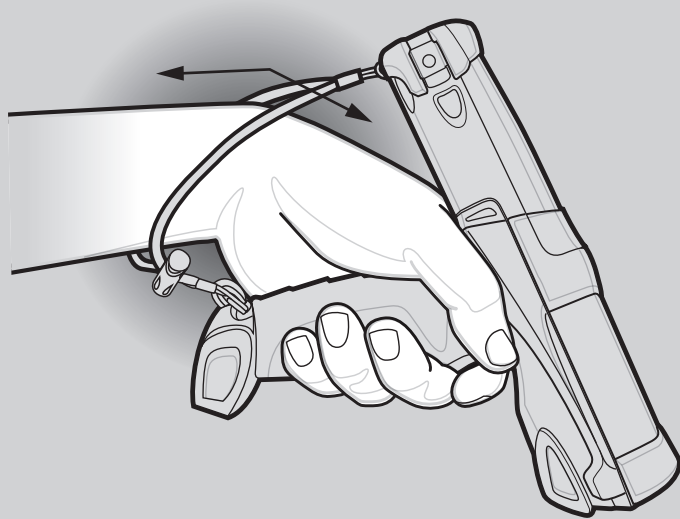

AVOID EXTREME WRIST ANGLES

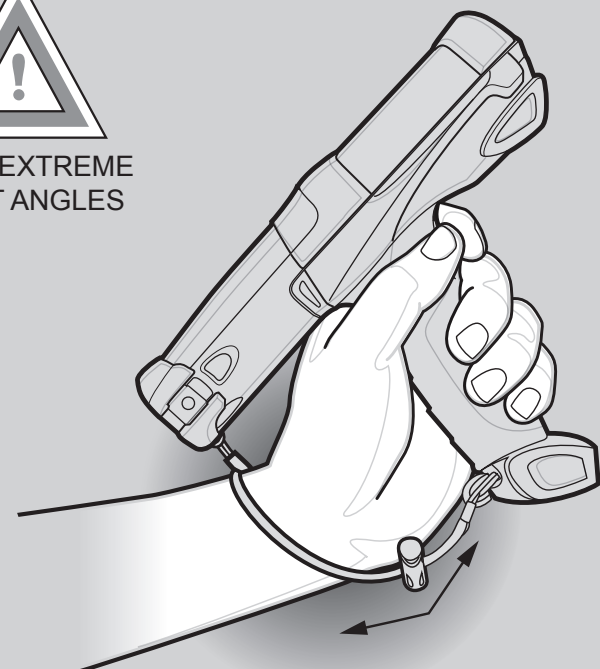

ALTERNATE LEFT AND RIGHT HANDS  
TAKING BREAKS AND TASK ROTATION RECOMMENDED

## OPTIMUM BODY POSTURE

Low Scanning  
Alternate left and right knees



AVOID BENDING

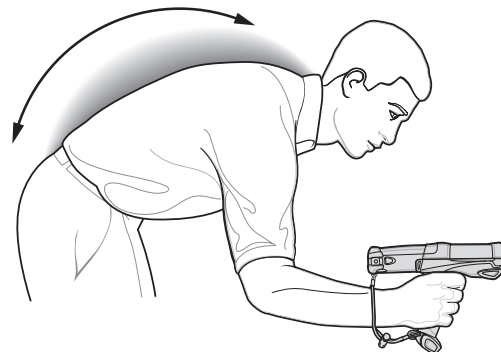

Alternate left and right hands



AVOID REACHING

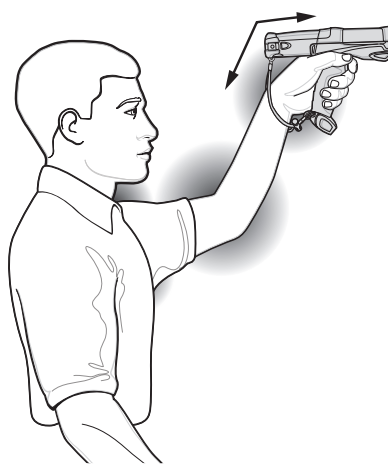

High Scanning  
Use a ladder



Taking breaks and  
task rotation recommended

POST IN WORK AREA

**MOTOROLA**  
Motorola Solutions, Inc.  
1301 E. Algonquin Rd. Schaumburg, IL 60196-1078, U.S.A.  
MOTOROLA, MOTO, MOTOROLA SOLUTIONS and the Stylized M Logo are trademarks or  
registered trademarks of Motorola Trademark Holdings, LLC and are used under license.  
All other trademarks are the property of their respective owners.  
© 2012 Motorola Solutions, Inc. All Rights Reserved.



72-161751-01 Rev A – July 2012



<http://www.motorolasolutions.com/mc92n0-g>

MC92N0-G

Recommended Usage Guide