



The lightning flash with arrowhead symbol, within an equilateral triangle, is intended to alert the user to the presence of uninsulated "dangerous voltage" within the product's enclosure that may be of sufficient magnitude to constitute a risk of electric shock to persons.



Caution: To prevent the risk of electric shock, do not remove cover (or back). No user-serviceable parts inside. Refer servicing to qualified service personnel.



The exclamation point within an equilateral triangle is intended to alert the user to the presence of important operating and maintenance (servicing) instructions in the literature accompanying the appliance.

WARNING:

TO REDUCE THE RISK OF FIRE OR ELECTRIC SHOCK, DO NOT EXPOSE THIS APPARATUS TO RAIN OR MOISTURE.

CAUTION:

TO REDUCE THE RISK OF ELECTRIC SHOCK, DO NOT REMOVE COVER (OR BACK). NO USER-SERVICEABLE PARTS INSIDE. REFER SERVICING TO QUALIFIED SERVICE PERSONNEL.

Safety Instructions

1. Read these instructions.
2. Keep these instructions.
3. Heed all warnings
4. Follow all instructions.
5. Do not use this apparatus near water.
6. Clean only with dry cloth.
7. Do not install near any heat sources such as radiators, heat registers, stoves, or other apparatus (including amplifiers) that produce heat.
8. Protect the power cord from being walked on.
9. Only use attachments specified by the manufacturer.
10. Unplug this apparatus during lightning storms or when unused for long periods of time.
11. Refer all servicing to qualified service personnel. Servicing is required when the apparatus has been damaged in any way, such as power-supply cord or plug is damaged, liquid has been spilled or objects have fallen into the apparatus, the apparatus has been exposed to rain or moisture, does not operate normally, or has been dropped.
12. Damage Requiring Service
Unplug the apparatus from the wall outlet and refer servicing to qualified service personnel under the following conditions:
 - A. When the power-supply cord or plug is damaged.
 - B. If liquid has been spilled, or objects have fallen into the apparatus.
 - C. If the apparatus has been exposed to rain or water.
 - D. If the apparatus has been dropped or damaged in any way.
 - E. When the apparatus exhibits a distinct change in performance this indicates a need for service.
13. Object and Liquid Entry
Never push objects of any kind into the apparatus through openings as they may touch dangerous voltage points or short-out parts that could result in a fire or electric shock. The apparatus shall not be exposed to dripping or splashing and no objects filled with liquids, such as vases shall be placed on the apparatus.
14. Batteries
Always consider the environmental issues and follow local regulations when disposing of batteries.

Precautions

1. **Care**
Occasionally you should dust the WorldRadio all over with a soft cloth. For stubborn stains, use a soft cloth dampened with a weak solution of mild detergent and water. Dry the WorldRadio immediately afterwards with a clean cloth. Don't use abrasive cloths, thinners, alcohol, or other chemical solvents, because they may damage the finish or remove the panel lettering.
2. **Power**
WARNING
BEFORE PLUGGING IN THE UNIT FOR THE FIRST TIME, READ THE FOLLOWING SECTION CAREFULLY.
AC outlet voltages vary from country to country.
Make sure that the voltage in your area meets the voltage requirements printed on the WorldRadio's rear panel (AC 230-240 V, 50 Hz). If you do not intend to use the WorldRadio for an extended period, remove the power cord from the AC outlet.
3. **Never Touch This Unit with Wet Hands**
Never handle this unit or its power cord while your hands are wet or damp. If water or any other liquid gets inside this unit, have it checked by your local dealer.
4. **Installing This Unit**
 - Install this unit in a well-ventilated location.
 - Do not expose this unit to direct sunlight or heat sources.
 - Install this unit horizontally. Never use it on its side or on a sloping surface, because it may cause a malfunction.



Dispose of the packaging and this product in accordance with the latest provisions.

Notes on Environmental Protection

After the implementation of the European Directive 2002/96/EU in the national legal system, the following applies: Electrical and electronic devices must not be disposed of with domestic waste. Consumers are obliged by law to return electrical and electronic devices at the end of their service lives to the public collection points that are set up for this purpose or designated points of sale. However, such details are defined by the national law of the respective country. This symbol on the product, the instruction manual or the packaging indicates that the product is subject to these regulations. By recycling, reusing the materials, or other forms of utilizing old devices, you are making an important contribution in protecting our environment.

Trademarks

The names of products of Joybien or other vendors and suppliers appearing in this document may be trademarks or service marks of their respective owners, which may be registered in some jurisdictions.

Microsoft, Windows, and Windows Media are trademarks or registered trademark of Microsoft Corp. in the United States and/or other countries.

vTuner is a trade mark of vTuner.com.

All other trademarks used in this document are trademarks or registered trademarks of their respective owners.

Copyright Notice

MPEG Layer-3 audio decoding technology licensed from Fraunhofer IIS and Thomson multimedia.

This product is protected by certain intellectual property rights of NEMS and BridgeCo. Use or distribution of such technology outside of this product is prohibited without a license from NEMS and BridgeCo or an authorized subsidiary.

This product is protected by certain intellectual property rights of Microsoft Corporation. Use or distribution of such technology outside of this product is prohibited without a license from Microsoft or an authorized subsidiary.

Content providers are using the digital rights management technology for Windows Media contained in this device ("WM-DRM") to protect the integrity of their content ("Secure Content") so that their intellectual property, including copyright, in such content is not misappropriated. This device uses WM-DRM software to play Secure Content ("WM-DRM Software"). If the security of the WM-DRM Software in this device has been compromised, owners of Secure Content ("Secure Content Owners") may request that Microsoft revoke the WM-DRM Software's right to acquire new licenses to copy, display and/or play Secure Content. Revocation does not alter the WM-DRM Software's ability to play unprotected content. A list of revoked WM-DRM Software is sent to your device whenever you download a license for Secure Content from the Internet or from a PC.

Microsoft may, in conjunction with such license, also download revocation lists onto your device on behalf of Secure Content Owners.

The information provided herein is believed to be accurate; nonetheless, the content may change without prior notice. Joybien assumes no responsibility for inaccuracies, errors, or omissions. And Joybien assumes no responsibility for

the use of this information, and all use of such information shall be entirely at the user's own risk. Specifications are subject to change without notice.

Welcome

Thank you for purchasing Joybien WorldRadio product. Your WorldRadio is designed to provide you hours of music enjoyment as much as we enjoy creating it with simple, convenient access to thousands of Internet radio stations worldwide. No matter whether you are in Alaska and would like to listen to the Hawaiian music, or whether you want to listen to the classical music, hard rock, or smooth jazz; the Joybien WorldRadio brings you home the radio station of your choice.

Your enjoyment is our pleasure. Thank you very much. Your Joybien Team.

Table of Contents

1 – WorldRadio at Your Fingertips	6
2 – WorldRadio Installation Step by Step	7
2.1 Overview of Your WorldRadio	7
2.1.1 WorldRadio Front Panel	7
2.1.2 WorldRadio Rear Panel.....	7
2.1.3 The Remote Control.....	8
2.2 Turning on Your WorldRadio for the First Time.....	9
2.2.1 Connection via Wired Configuration (LAN).....	9
2.2.2 Connection via Wireless Configuration (WLAN).....	10
3 – Using Your WorldRadio	12
3.1 Listen to the World Radio Program by Using the Front Panel Control.....	12
3.2 Using Remote Control to Access More Features	15
3.2.1 Listen to the WorldRadio by Using the Remote Control	15
3.2.2 Advanced Configuration	20
4 – For Network Expert User Only.....	25
4.1 The vTuner Premium Service.....	25
4.2 Playing Music Stored in Your Computer	27
Appendices	29
Appendix A: Specification	29
Appendix B: Troubleshooting	30
Appendix C: Regulations & Safety	33

1 – WorldRadio at Your Fingertips

From Opening the Package to Installation

Now please make sure that the content of the package is complete. Your WorldRadio comes with the following:

- ☒ WorldRadio main unit
- ☒ Power supply with cable adapter (9VDC , 2A)
- ☒ Remote control with two AAA batteries
- ☒ WorldRadio User Manual
- ☒ WorldRadio Quick Installation Guide



Your WorldRadio

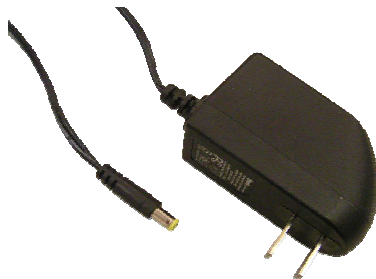

Power supply with cable adapter



Remote Control with batteries

Before You Start

Please ensure that the Internet Broadband Network access is available before using the WorldRadio.

2 – WorldRadio Installation Step by Step

2.1 Overview of Your WorldRadio

After taking your WorldRadio out of the box, please spend some of your time here to get familiarized with its features.

2.1.1 WorldRadio Front Panel

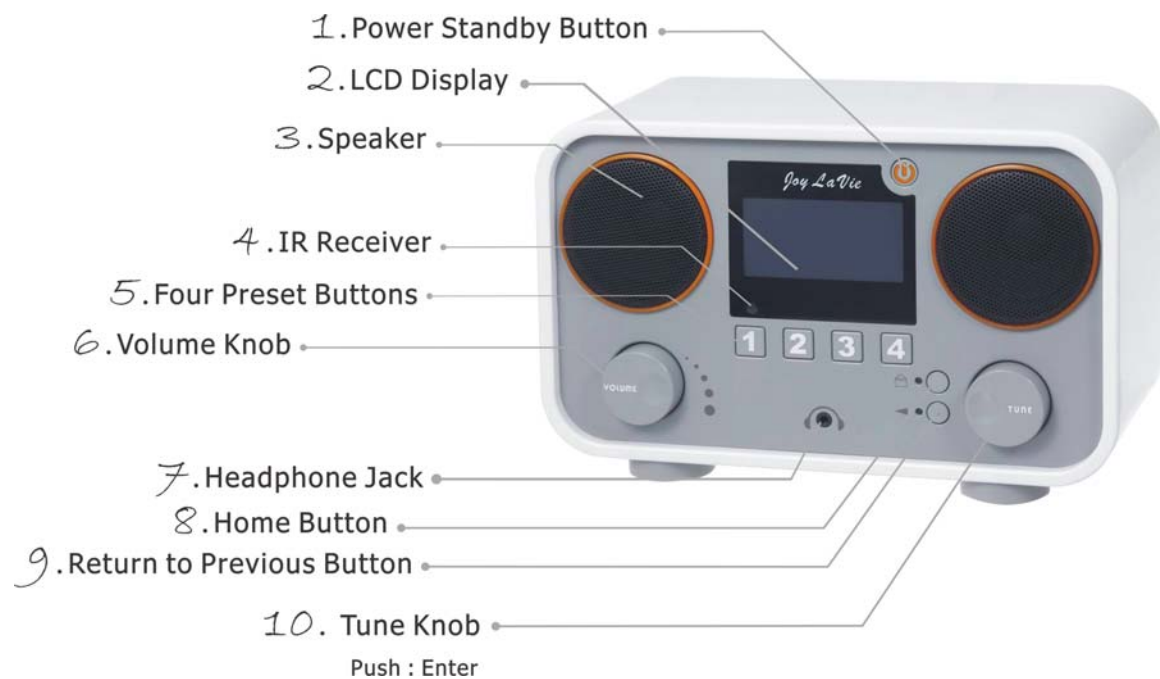

2.1.2 WorldRadio Rear Panel

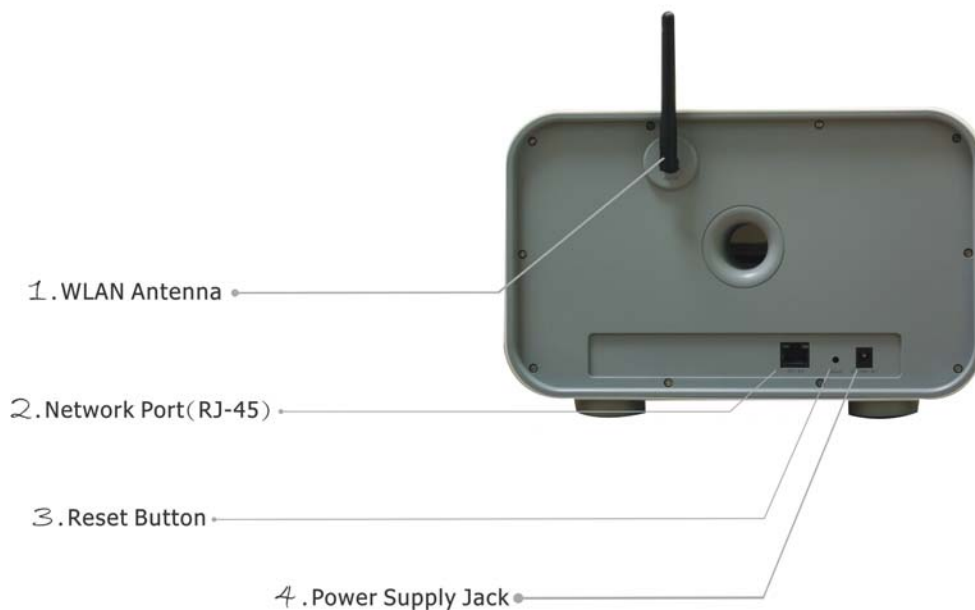

2.1.3 The Remote Control

The table below describes the functions of all the keys on the remote control in all three operating modes:



WorldRadio Remote Control

Key	Select and Play Modes	Configuration & Edit Modes
	Standby on/off (press).	
	Information button (switch between Play and Select screens)	
	Hotkeys for selecting stored favorites 1 - 9	Enter numbers and text: e.g.: Repeated presses of the '2' key will scroll through '2', 'a', 'b', 'c'
	Store current station/track as a PRESET. Press, then press required number key	Inactive
	Increase Volume	Toggle upper/lower case
	PLAYLIST: Open Select Menu for Dynamic Favorites list	
	Decrease Volume	Toggle Insert/Replace modes
	Scroll Up / Down (see Note 1) to highlight previous/next menu item. Press and hold for fast scroll	
	Return to previous, higher level menu	
	Go to Home Menu	
	Select highlighted menu item	
	Like current station/track (add to Dynamic Favorites list)	
	Dislike current station/track (remove from Dynamic Favorites list)	
	Skip back through track, album or playlist	Backspace (delete last character)
	Play selected station/track, or Pause currently playing station/track	
	Skip forward through track (press and hold), or skip tracks in album or playlist (press)	
	Stop Play	
	Repeat track (press once) Repeat all tracks in album or playlist (press twice)	
	Open Internet Radio menu	
	Open Configuration Menu (see Note 2)	
	Shuffle-play current album/playlist	
Note: Gray shading denotes key is inactive in Configuration Mode		

Note 1) These keys can be used to scroll through all characters in Edit mode, but the keypad is usually a quicker method.

Note 2) If pressed while editing, a screen appears asking if you want to Discard Changes. 'No' returns to Edit mode, 'Yes' performs the normal function of the button.

2.2 Turning on Your WorldRadio for the First Time

Preparing the WorldRadio for operation:

1. Place the WorldRadio at a flat surface.
2. Remove the packaging materials.
3. Place the WorldRadio at a location close to Ethernet LAN access.
4. Insert the batteries provided into the Remote Control device.
5. If you are accessing the Internet via wired Ethernet LAN, please proceed to **2.2.1 Connection via Wired Configuration (LAN)**.
6. If you are accessing the Internet via wireless LAN, please proceed to **2.2.2 Connection via Wireless Configuration (WLAN)**.

2.2.1 Connection via Wired Configuration (LAN)



1. You may access the Internet Broadband Network by plugging Ethernet Cable to the back of the WorldRadio.



2. Connect the power cable to the WorldRadio and connect it to the power supply.



3. Wait for the WordRadio to power up (it will take about 20 sec. to turn on for the first time); and then the welcome message will be displayed.



4. When the WordRadio is turned on for the first time, the Language menu will be displayed. You may select the Language by rotating the TUNE knob clockwise or counterclockwise; and then press the TUNE knob to select your language preference.

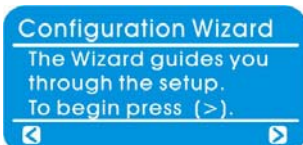

5. The WorldRadio will now start the Configuration Wizard. Press the TUNE knob to proceed.

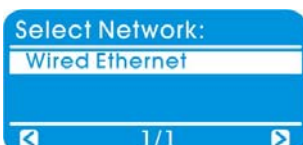

6. Press the TUNE knob again to enter the Wired Ethernet LAN setting.

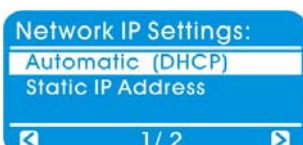

7. Press the TUNE knob to select the Automatic (DHCP) for Network IP address setting.

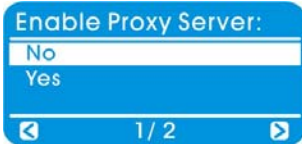

8. Select NO option for proxy server and then press the TUNE knob.



9. Press the TUNE knob again to apply the Settings.



10. Your WorldRadio is now configuring.

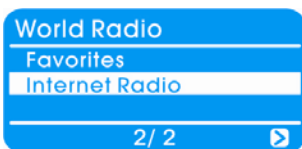

11. The network setting is completed and ready to play music!

2.2.2 Connection via Wireless Configuration (WLAN)



1. You may access the Internet Broadband Network wirelessly if you have a wireless Access Point in the accessible neighborhood.



2. Connect the power cable to the WorldRadio and connect it to the power supply.



3. Wait for the WordRadio to power up (it will take about 20 sec. to turn on for the first time); and then the welcome message will be displayed.



4. When the WordRadio is turned on for the first time, the Language menu will be displayed. You may select the Language by rotating the TUNE knob clockwise or counterclockwise; and then press the TUNE knob to select your language preference.



5. The WorldRadio will now start the Configuration Wizard. Press the TUNE knob to proceed.

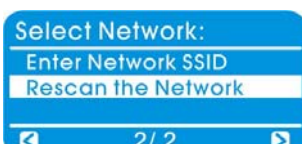

6. Press the TUNE knob again to enter the Wireless Ethernet LAN setting.

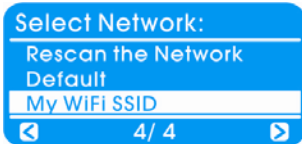

7. Please select your Access Point name then press the TUNE knob to enable your selection. (In this example, “My WiFi SSID” is the your Access Point of choice)
- Hint:** If your wireless LAN is encrypted, then proceed with step #8; otherwise, proceed to step #9.



8. Password setting. You will be prompted to enter a valid WEP code (with the Remote Control for the entry).
- Tip:** use  to switch upper/lower-case letters (with the Remote Control).



9. Press the TUNE knob to select the Automatic (DHCP) for Network IP address setting.



10. Select NO option for proxy server and then press the TUNE knob.

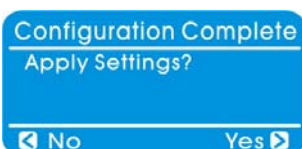

11. Press the TUNE knob again to apply the Settings.

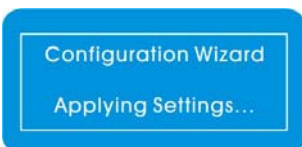

12. Your WorldRadio is now configuring.



13. The network setting is completed and ready to play music!

Congratulations! Your WorldRadio is now set properly.

The welcome message will be displayed; you may select radio stations from the Home Menu by pressing the  button on the front panel of the WorldRadio. Then select “Internet Radio” by pressing the TUNE knob to choose your desired station through different modes of Genres or Countries. (Note: rotate the TUNE knob clockwise or counterclockwise to select your preferred station in different Countries or Genres, and then press the TUNE knob to select and listen to the station of your choice.)



You may store your preferred station by pressing and holding any of the “1”, “2”, “3”, or “4” PRESET key on the WorldRadio’s front panel for 2 sec. You may then recall the stored station by pressing the corresponding PRESET key. You may press the Standby button to enter the WorldRadio into the Standby mode before next activation time.

3 – Using Your WorldRadio

3.1 Listen to the World Radio Program by Using the Front Panel Control

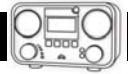

After properly configured your WorldRadio, you can enjoy listening to the radio stations around the world. You can quickly access radio station categorization by using buttons on the front panel of the WorldRadio. The table below describes the functions of all the keys on the front panel.



Key	Function
	Standby on/off (short press)
	Select highlighted menu item (TUNE Knob)
	Increase/ Decrease Volume (Volume Knob)
	Hotkeys for selecting stored favorites 1-4
	Go to Home Menu
	Return to previous, higher level menu



Power Standby

When you have finished using the WorldRadio, press the Standby button . The display will become blank and the device will remain in a standby state, consuming virtually no power, until you press again. Upon pressing the button again, the WordRadio will be activated and started to play from the last station you listened prior to entering the Standby Mode.



Volume Knob

You can adjust the playback volume clockwise or counterclockwise to increase and decrease the volume. A horizontal bar display shows the volume level as you are changing it, and returns a few seconds later to the Play Screen.

Example

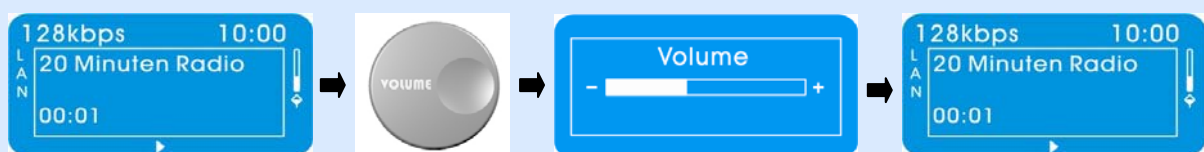



TUNE Knob

You may select the highlighted/selected items from any menu by turning the TUNE knob clockwise or counterclockwise to select your preferred audio sources, menu items or stations. Then press the TUNE Knob to select the item or station you want.

Example

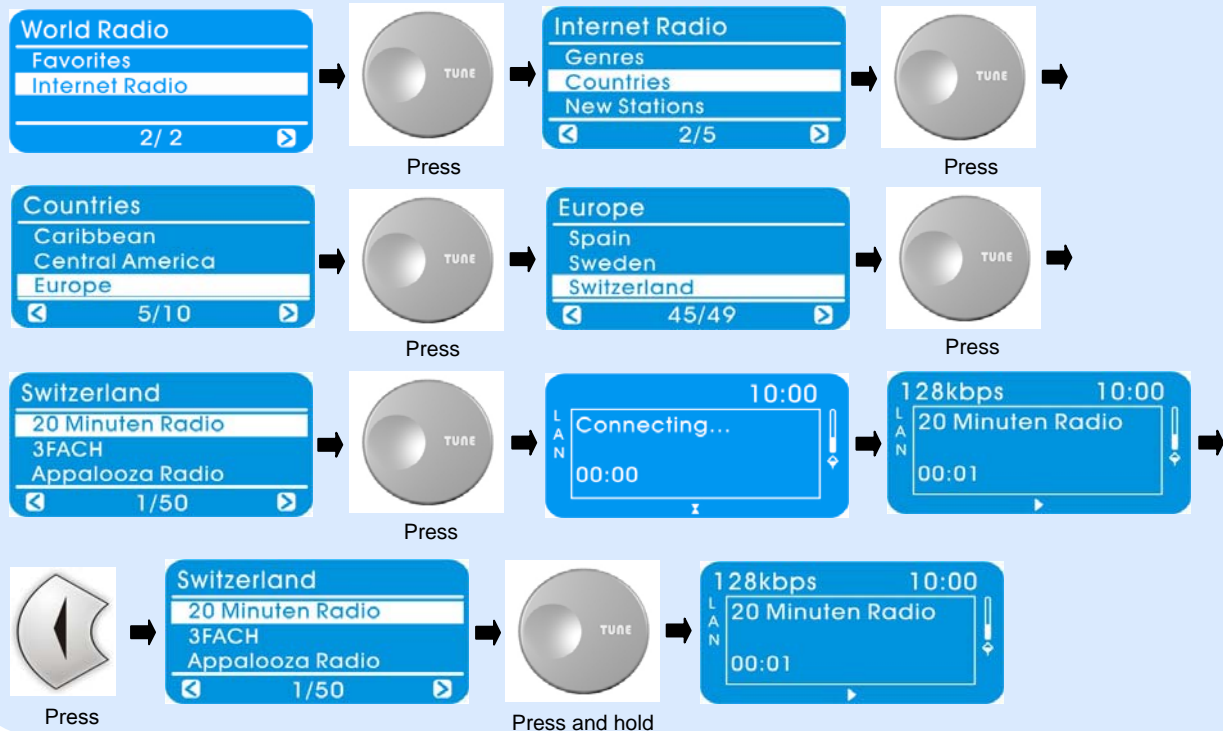

Four Preset Buttons

Simply store your preferred station by pressing and holding any of the “1”, “2”, “3”, or “4” PRESET key for 2 sec. You may then recall the stored station by pressing the corresponding PRESET shortcut key.

Example

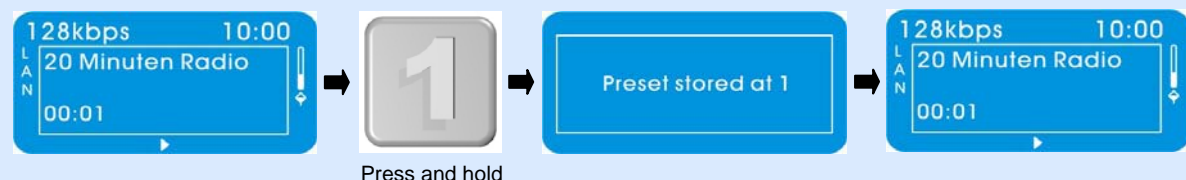



Home Menu

You can quickly access radio station categorization by Countries or Genres simply pressing the Home Menu button once on the front panel of the WorldRadio. In the Home Menu, the display shows a number of menu items which represent different audio sources. Select "Internet Radio" from the Home Menu, and then select a station you want to hear by browsing through the displayed categories.

Example



Return to Previous

If the  icon appears on the left of the screen, which means you can use the Button to go back to the previous or higher level menu screen.

Example



3.2 Using Remote Control to Access More Features



3.2.1 Listen to the WorldRadio by Using the Remote Control

You may also access radio station categorization by using keys on the remote control of the WorldRadio. Please refer to the table on page 7 which describes the functions of all the keys on the remote control. The frequently used keys and their functions are listed below for your quick review.



Key	Function
	Standby on/off (press)
	Go to Home Menu
	Hotkeys for selecting stored favorites 1 - 9
	Store current station/track as a PRESET. Press, then press required number key
	Like current station/track (add to Dynamic Favorites list)
	Dislike current station/track (remove from Dynamic Favorites list)
	PLAYLIST: Open Select Menu for Dynamic Favorites list
	Increase Volume
	Decrease Volume
	Return to previous, higher level menu
	Select highlighted menu item
	Open Configuration Menu
	Information button



Power Standby

When you have finished using the WorldRadio, press the Standby button . The display will become blank and the device will remain in a standby state, consuming virtually no power, until you press again. If you need to restart the device, for example, if the wireless link is lost, press and hold the Standby button until the display Restart Device appears.



When using the Standby button on the Remote Control to re-active the WorldRadio will not take you back to the last station listened prior to entering the Standby Mode; this is unlike using the Standby button on the Front Panel of the WorldRadio.



Home Menu

You can quickly access radio station categorization by Countries or Genres simply pressing the Home Menu button once on the remote control of the WorldRadio. In the Home Menu, the display shows a number of menu items which represent different audio sources. Select "Internet Radio" from the Home Menu, and then select a station you want to hear by browsing through the displayed categories.



1 ~ 9

Using Presets

Saving a Station to a Preset Number

Simply store your preferred station by pressing the **PRESET** button , followed the number key you want to use to store the station (e.g. **1**). The message '**Preset stored at 1**' will appear briefly. To change a **preset**, simply preset a different station to the same key.



Please do not use **0** for storing preset. The **0** is reserved for the Front Panel Standby button to store the last station listened. Also, Presets **1 ~ 4** on the Remote Control are sharing with presets **1 ~ 4** on the Front Panel of the WorldRadio.

Playing a Preset Item

At any time, simply press the relevant number button and the preset station will play.

Example of Diagrams for Using Presets

To Store:

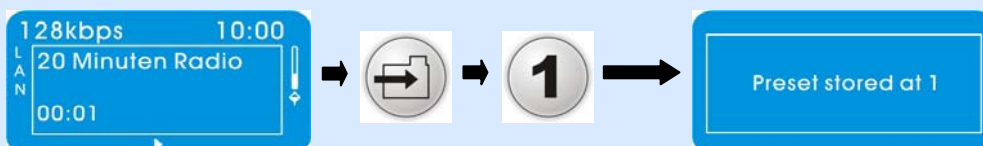

To Play:

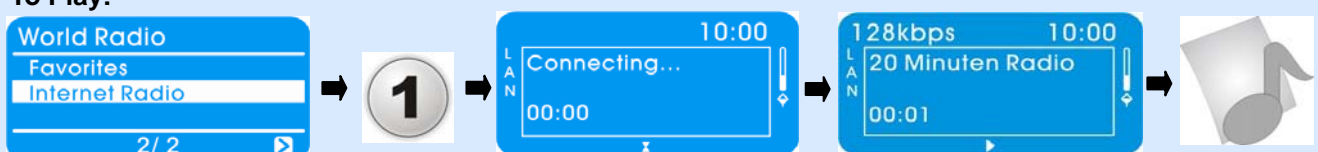



Using Favorites



Saving a Station to the Favorite Playlist

To save a station in the **Favorite Playlist**, first start the station, then press the button . A message '**Favorite added**' appears briefly on the screen, or '**Item already exists**', if you try to save the same station twice.



If you try to store more than 20 items in the **Favorite Playlist**, a '**List Full**' message appears on the screen, and you must then remove at least one item before adding any more.



Selecting and Playing Favorites from the Favorite Playlist

At any time, simply press the **Playlist** button to display the playlist of up to 20 items. Then Scroll up/down to highlight the station you want to hear, and press the button to play it.



Replacing Favorites on the Favorite Playlist

To remove a station from the playlist, first start it playing, then press the button . A message "**Favorite removed**" will appear briefly on the screen. You can then play a new station and store it by pressing .

Example of Diagrams for Using Favorites

To Store:

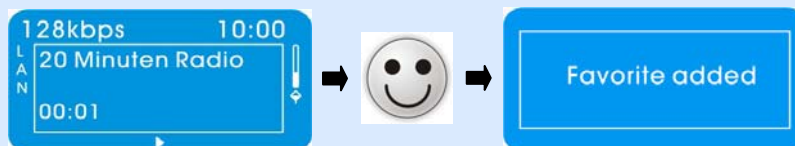

To Check my Favorite Folder and to Play:

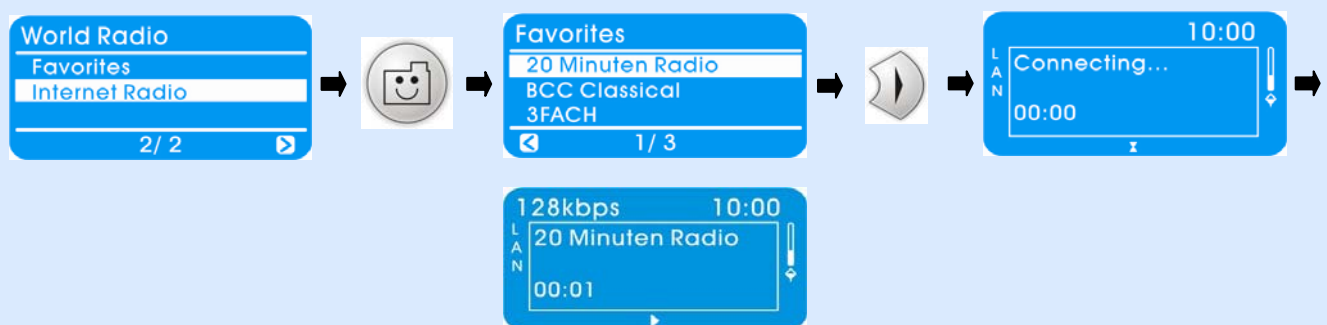

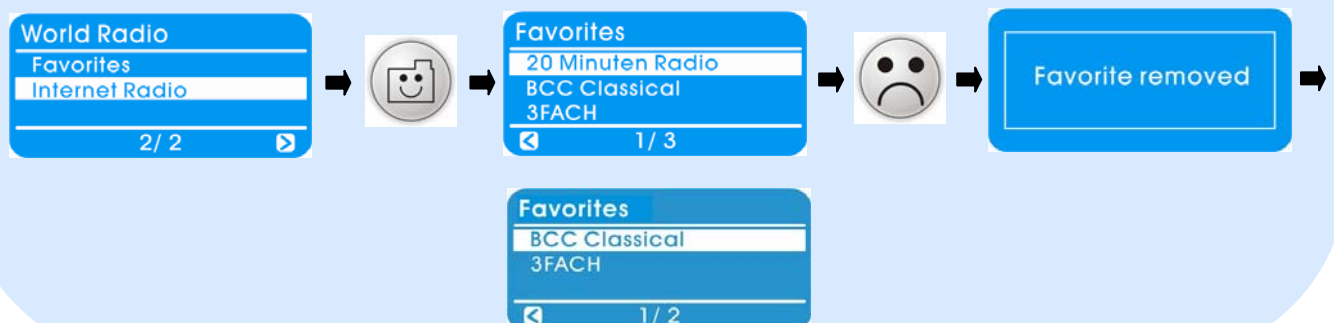

To Delete:

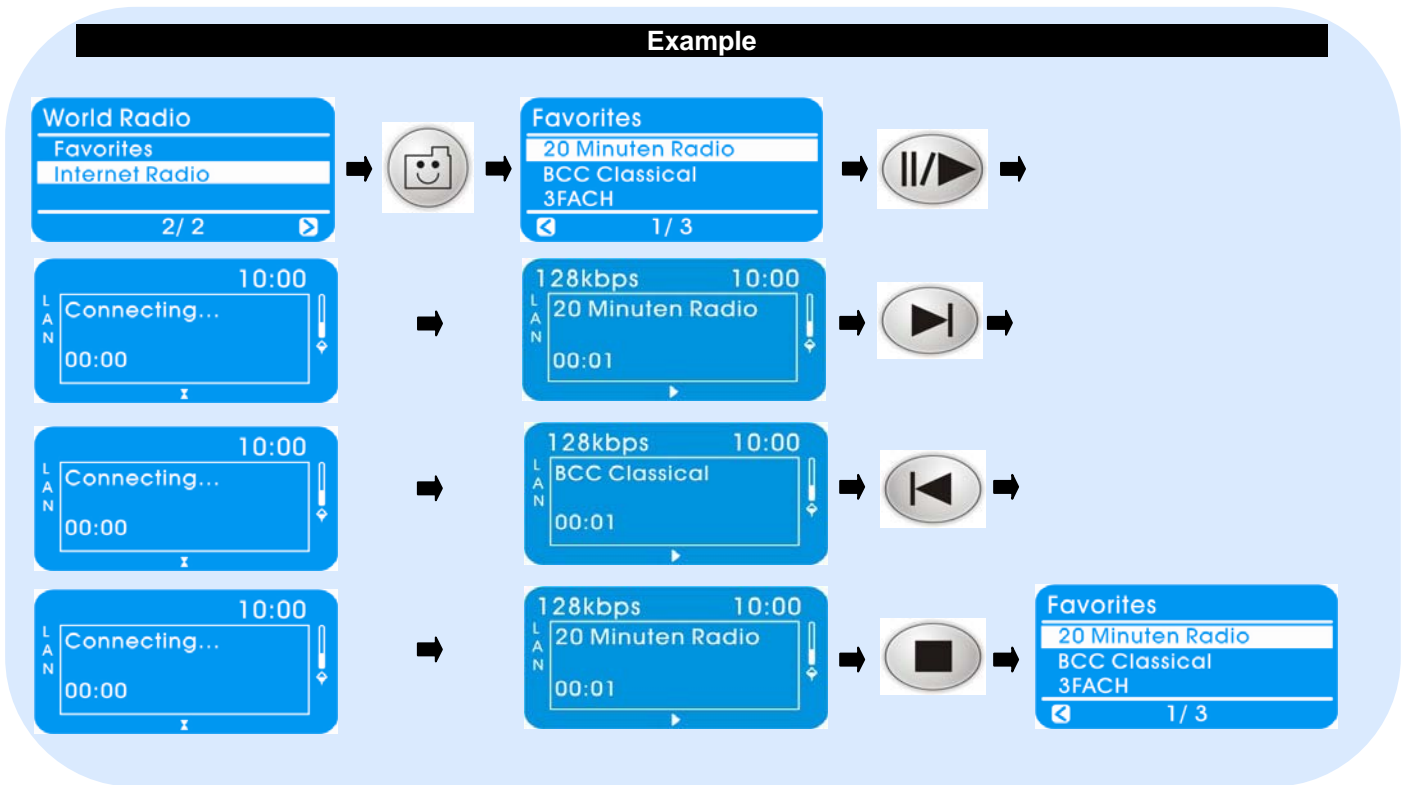



Volume + -

You can adjust the playback volume with the increase  and decrease  keys. A horizontal bar display shows the volume level as you are changing it, and returns a few seconds later to the Play Screen.





Return to Previous or higher level menu

If the  icon appears on the left of the screen, which means you can use the Button to go back to the previous or higher level menu screen.



Select highlighted menu item

To select from any menu, press the  key to highlight the item you want. The  icon at the bottom right of the screen means you can now press  to select the item.





Open Configuration Menu

Whenever you press the Configuration Menu key , the WorldRadio enters the Configuration Mode. The top level Configuration Menu looks like the table at the right. Scroll up/down to whatever you need and select it.

Configuration
Select Profile
Device Status
Configuration Wizard



INFO button

Press the INFO key  to return to last select screen, where you can prepare your next track or station. The current track/station will continue to play until the end, or until you select something else (or change the active Profile). Press  at any time to return to the Play Screen.

Example

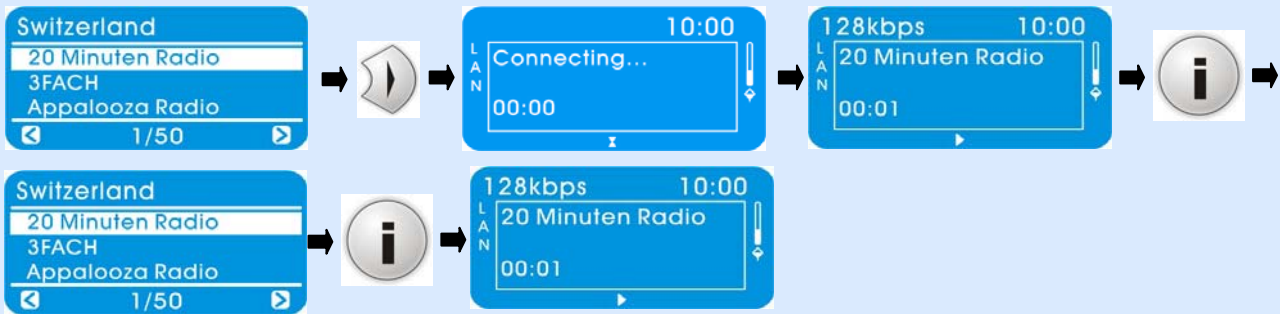

Example of diagrams for listening to the Internet Radio Stations by using the remote control

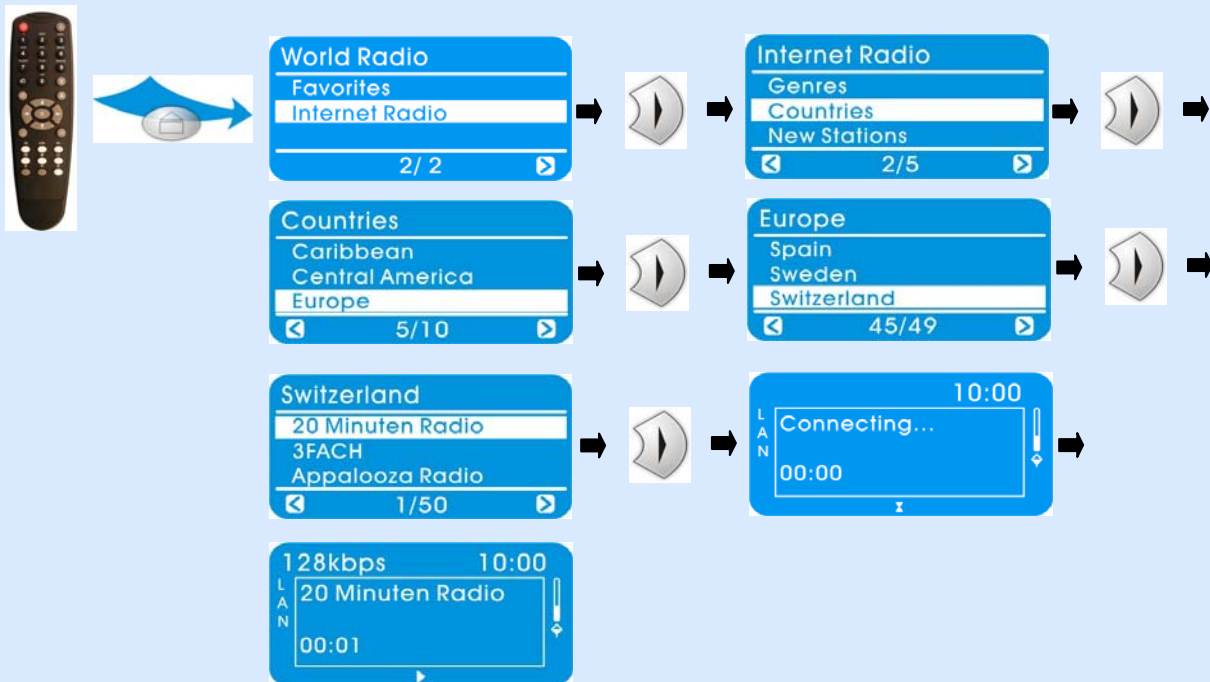

3.2.2 Advanced Configuration

There are two ways to change the setup of your WorldRadio. You can use the Remote Control and the LCD display or you can use your WorldRadio WEB Interface accessed on any PC that can communicate with your WorldRadio.

With just five exceptions, all configuration settings can be changed by either method. The exceptions are:

1. Selecting a **Language** (Remote Control only)
2. Setting **Date & Time** information and formats (Remote Control only)
3. Changing **Internet Radio** list settings (Remote Control only) and
4. Uploading new firmware (WorldRadio DMP-User Interface only).
5. Changing the name of a Profile (WorldRadio DMP-User Interface only).

A. Configuration Management Using the Remote Control

To enter **Configuration Mode**, press the () on the remote control to display the **Configuration Menu**, which contains some or all of the following **items**, depending on settings:

Select Language

Scroll up/down to the **Select Language item**, and select it. Scroll up/down to highlight your language, then select it. All future screen messages will then be displayed in that language.



The display language cannot be set by your WordRadio DMP-User Interface.

Advanced Settings

This menu contains three **items**:

- **Profile Management**

If this **item** is followed by an asterisk in brackets, **[*]**, **Profile Management** is enabled. If there is a blank space between the brackets, **[]**, it is disabled.

To change, select the **Profile Management** menu, select **Enabled** or **Disabled** as required, then return to the **Advanced Settings** menu by pressing .



- **Key Management**

This operates in the same way as **Profile Management**, and must be enabled if more than one Encryption Key is needed.



Key Management is always available when using your WordRadio DMP-User Interface.

- **Edit Device Name**

The default name is **World Radio**. If **Profile Management** is enabled, you can enter your own names for any of the three available profiles, initially called **Profile1**, **Profile 2** & **Profile 3**. Select **Edit Device Name**, then select **Change** from the next menu. Edit the name, press , then return to the Advanced Settings menu (i.e. press .



The device name can also be changed using your WordRadio DMP-User Interface.

Configure Date/Time

The date and time formats can be set by selecting this menu. First the **Select Time Zone** menu offers a choice of 32 standard zones, then **Daylight Saving** can be **enabled** or **disabled** and, finally, the **Select Time Format** menu offers 5 display formats for the date and time, which are obtained automatically from the Internet.

Select Profile

If **Profile Management** is enabled, the **Select Profile** item will be seen. It can be used to change the active **Profile**. The active profile is identified by an asterisk (**[*]**). To change profile, simply highlight the new profile and select it. The WorldRadio will then display the message **Restart Device** while the new **Profile** is being activated.

Device Status

Select this useful **item** to scroll up/down through a list of all settings in the active **Profile**. This is pure information –nothing can be changed while scrolling through this item.

Configuration Wizard

The WorldRadio **Configuration Wizard** guides you through the process of configuring network profiles. It is used when you want to use the remote control to:

- Install your WorldRadio for the first time
- Make changes to your network profile settings or
- Explore the more advanced options offered by your WorldRadio.

a. Network Information Needed by the Configuration Wizard

The **Configuration Wizard** guides you through the setup process, prompting you to select or edit all the settings for any of the available WorldRadio Profiles.





1. Your WorldRadio determines some settings automatically during its search for available networks. Therefore it may not need to prompt you for all of settings during the process described below.

2. You can leave the **Configuration Wizard** at any time by pressing  again. You will then be asked to confirm that you want to exit the Wizard and discard all changes.

b. STARTING THE CONFIGURATION WIZARD

The **Configuration Wizard** will start automatically the first time you power up your WorldRadio.

To start the **Configuration Wizard** at a later time:

1. Press  to display the **Configuration** menu.
2. Scroll up/down until **Configuration Wizard** is highlighted, and select it. When the introductory message appears, press  to go to the next screen and begin the setup process.



1. This process requires you to know some technical details of how your network is set up. If you are unsure of any of the settings, consult the person who set up your network, or refer to the appropriate network documentation.
2. Please refer back to Edit Screens on page 7 for instructions on entering and changing text and numbers, using the Remote Control.

c. SELECTING A PROFILE

If **Profile Management** is enabled, you will be prompted to **Load Profile**. Select one of the three **Profiles** for editing. Their default names are **Profile 1**, **Profile 2** and **Profile 3**, but they can be renamed, using your WordRadio DMP-User Interface. If **Profile Management** is disabled, the Wizard will start at the next **item**.

d. SELECTING A WIRELESS NETWORK

At the **Select Network** menu, follow these steps to select the **SSID** for the wireless network profile you are editing:

1. If more than one wireless network is available, scroll up/down and select the **SSID** you want to use.
2. If the **SSID** is followed by '(encrypted)', you will be asked to accept () or **change** the **WEP** or **WPA** encryption key.
For security reasons, the current key will be shown as a row of asterisks, *****.
3. If you want to set up a network that is not currently active, select **Edit Network SSID** and enter a new **SSID**, which must contain between 2 and 32 alphanumeric, case-sensitive characters.
4. Press when you have finished setting the **SSID**.

e. SELECTING A NETWORK TYPE

If you have used **Edit Network SSID**, the **Select Network Type** menu will appear. Always select **Infrastructure**, as you should be using your WorldRadio with a wireless Access Point (**AP**) or a wireless router.

f. SELECTING ENCRYPTION SETTINGS

If you see the **Select Encryption** menu, select:

- **No** if encryption is not used on the wireless network or
- **WEP** or **WPA**, if encryption is used.

If you select **WEP** or **WPA**, and **Key Management** is disabled, you will be prompted to **Enter Key1**.

If **Key Management** is enabled, you will see the **Select Key Index** menu and you must select one of the four possible keys for editing. If a key already exists in the current profile, a row of asterisks (*****) will be displayed in place of the key value.

As you enter the key, the **Key Type** and **Key Length** will be displayed in the top of the screen, based on what you have entered: i.e. **ASCII** or **Hex**, **64 bit** or **128 bit**. Press **OK**, then select **Exit Key Editing** and select the required **key** if you see the **Select Key** menu.

g. SELECTING NETWORK IP SETTINGS

At the **Network IP Settings** menu, choose **Automatic (DHCP)** if your network uses **DHCP** or **Static IP Address**, if you want to assign a fixed IP address for your WorldRadio.

If you choose **Static IP Address**, you will be prompted to edit/confirm the **IP Address** of the WorldRadio, the **Subnet Mask**, the **Gateway**, the **DNS Server Preferred** and (optionally) the **DNS Server Alternate**.

h. ENABLING A PROXY SERVER

1. If you see the **Enable Proxy Server** menu select **No** or **Yes**, depending on whether or not your network uses a proxy server.
2. If you choose **Yes**, you will be prompted to edit/confirm the **Proxy Hostname** (example: **proxy.mycompany.com**) and then the **Proxy Port** (example: **8080**). Press after entering all **Proxy** settings.

i. COMPLETING THE CONFIGURATION

When all required settings have been entered, the **Configuration Wizard** will display the message:



Press  to save your changes. If **Profile Management** is enabled, the **Save to Profile** menu will appear. Highlight the chosen profile and press to finish. The message **Applying Settings** will be briefly displayed, followed by **Restart Device**, if the active **Profile** has just been altered. The WorldRadio will display the **Configuration Menu** if an inactive profile was changed, or the **Home Menu** if it has been restarted.



If the message **No Network Found** or **Network Error -> check config** appears, the WorldRadio could not connect to any network: please refer to Troubleshooting on page 26.

B. Using WEB Interface

Start your web browser on your computer and search for the IP address shown on WorldRadio's LCD screen under **Device Status / Software address (IP)**; as an example, if your IP is 192.168.1.15, then enter <http://192.168.1.15> on your computer to start the WorldRadio DMP-User Interface.

Check your WorldRadio Device IP from your WorldRadio following the procedure below.

Example:

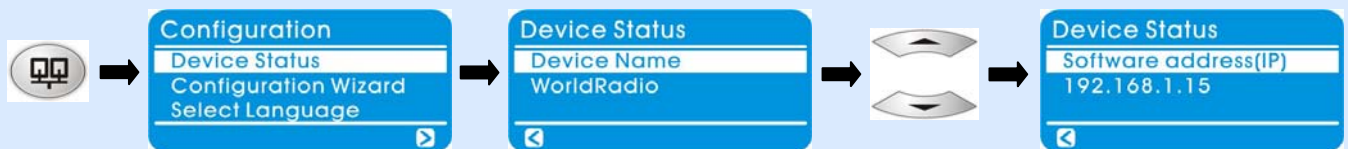

- Only when the **Profile Management** is enabled, you will be prompted to **Edit Profile**. Select one of the three **Profiles** for editing. Their default names are **Profile 1**, **Profile 2** and **Profile 3**, but they can be renamed, using your WordRadio DMP-User Interface. The device name can also be changed using the WordRadio DMP-User Interface.
- Your WorldRadio DMP-User Interface cannot be used until your WorldRadio has been set up.

4 – For Network Expert User Only

4.1 The vTuner Premium Service

The WorldRadio comes with a license included premier version of the **vTuner** Internet Radio service. **Select Internet Radio** from the **Home Menu**, then select a station by browsing through the displayed categories.

The available categories will depend on the level of service you have installed, but will include items like: **My Favorites**, **My Added Stations**, **Genres**, **Countries**, **New Stations**, **Most Popular Stations** and **Your ID# is XXXXXXXXXXXX**.

You can customize its list by adding stations of your own to it via your web browser following the below procedure.

1. Open the web browser and get to vTuner Premium Service at: <http://www.radio369.com>

2. Log on to the **"MEMBER LOGIN"** at the top right on the webpage by entering your Email Address and a Password of at least 6 characters.
3. Enter your ID # (MAC address) of your WorldRadio in the **"Sign in with your ID # From the World Radio"** area, at the lower left of the webpage, then click the  button.

(Note: It's not necessary to enter the separator characters as " : ". "001641C12082" should be entered in the below example.)

Please follow the following steps for retrieving your WorldRadio's ID (MAC) number:

Example:

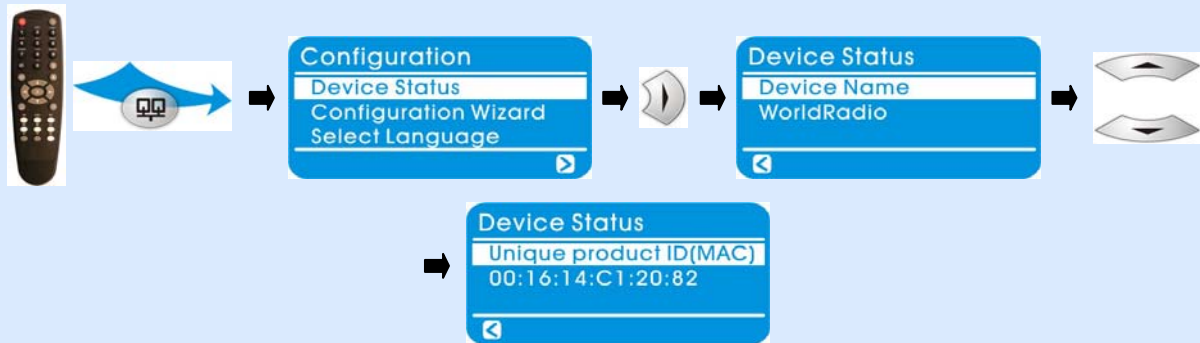

4. Next time while visiting vTuner Premium Service website, you only need to log on your Email Address and the Password you already registered.

My Favorite Groups

5. You can start to build up a set of **My Favorites**, sorted into user-defined **Groups**.
 - Choose your preferred stations browsed by **Format, Location or Language**.
 - Click then click the button to add the specific station to an existing or new Favorites group.
 - "XXXX has been added to your Favorite Group My__Favorites" will be showed on the webpage.
6. To see your favorite playlist in your customized Favorite, click "Home" and then "My__Favorites" to check them.
7. You can update it manually from vTuner website at any time.

My Added Stations

8. For your desired radio stations that are not currently on vTuner Radio Station List, you may manually add your desired radio stations by clicking button in "My Added Stations" and enter the information for the station you would like to add. You can see something like this and enter what requested.

My Added Stations

Enter the information for the station you would like to add.
The station will be immediately added as one of your favourites.

Station Name

Station URL
(for example, http://62.168.116.98:8000/dsp1)

Location
(for example, Canada, Germany, Buenos Aires)

Genre
(for example, Classical, Dance, Rock)

Type:

9. Click button and your new added station will appear in the menu under "My Added Stations".
10. To remove stations from your "My Favorites" or "My Added Stations", click button to delete them.

4.2 Playing Music Stored in Your Computer

The WorldRadio has UPnP (Universal Plug and Play) functionality that allows you to play music files stored in your computer supporting Windows Media Player 11 application.

Microsoft offers the Windows Media Player 11 free of charge at present via the following link:

<http://www.microsoft.com/windows/windowsmedia/player/11/default.aspx>

Once the installation is complete, run it by starting “Windows Media Player” on your computer and follow these steps below:

1. The display of first time opening the Windows Media Player.



2. Select Tools → Options



3. Select “Library” option and click “Configure Sharing” to share your music in your network.

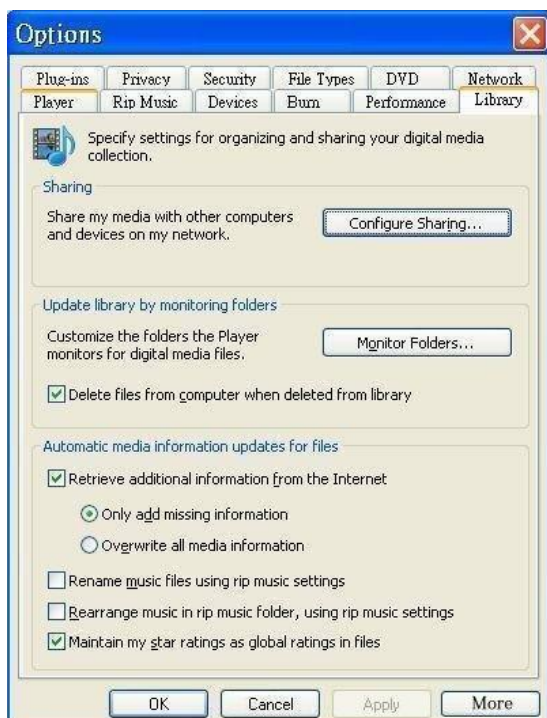

4. The display shows all media players found on your network. Select “Share my media to :” so that you may activate the selection. (the default is access denied)



5. You may choose “properties” by right clicking your mouse to see the ID(MAC) of the selected device.



6. The window of "Device Properties" looks like this. It shows detailed information of the selected device.

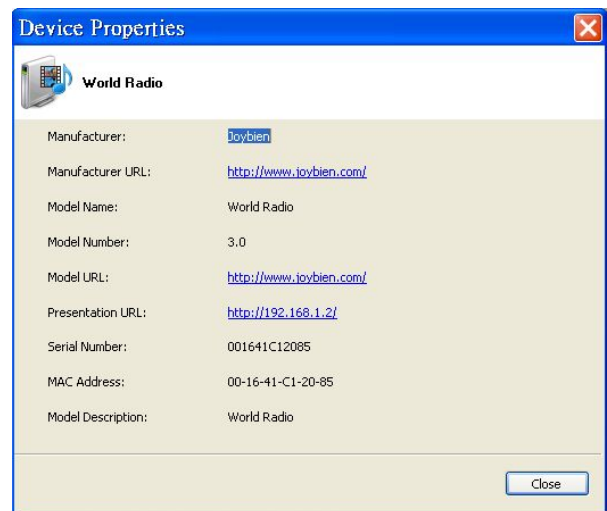

7. Finally select the computers and devices you would like to share from the list and click the “Allow” button, followed the “OK” button to make the media sharing active.



8. Now you can see different audio sources from the Home Menu of your WorldRadio by pressing the  button. The music collection can be found via the artist, genre, album or the folder structure.

Appendices**Appendix A: Specification**

Dimension	- 265 x 120 x 167 (mm)
Display	- 128 x 64 dots Blue/White Graphic LCD Module
Navigation	- Tune & Volume Rotary Knob - 4 Preset buttons - Home & Previous Selection Button - 32 keys IR Remote Control
Audio Playback	- Compression format: MP3, WAV, Windows Media® Audio and WMA-DRM10 - Internet radio station update from vTuner - UPnP™ support
Acoustics	- Two 3 Watt / 4 Ohm Speakers
Power Adapter	- Input: 100~240VAC, 50/60Hz - Output: 9VDC, 2A
CE / FCC Declaration	- FCC Class B, CE
Standards	- IEEE 802.11b/g (11/54 Mbit/s) - IEEE 802.3, IEEE 802.3u (10/100 Mbit/s) - UPnP™
Network Security	- WEP Encryption (64/128 bit key support) - WPA Encryption
Connections	- Built in 802.11b/g Wi-Fi - Ethernet RJ-45 - Power In - Headphone 3.5mm Jack
Environmental requirements	- Operating Temperature: 0~40 degree Celsius - Storage Temperature: -20~60 degree Celsius - Operating Humidity: 10~85% Non-Condensing - Storage Humidity: 5~90% Non-Condensing

Appendix B: Troubleshooting

FAQ -- Frequently Asked Questions and their answers

► *Nothing appears on the display when the WorldRadio switched on.*

Ans:

- If the power is unavailable, check that the WorldRadio power cable is properly connected and that the power is switched on.
- If WorldRadio is not known to the network, check that the MAC address for the WorldRadio has been entered correctly in the wireless network's MAC Access Control. Turn off the WorldRadio and turn it on again by unplugging and then plugging the power mains.
- 3. If Internet is unavailable, check that the Internet access point / router has an active connection to the Internet or not.

► *Cannot find an Internet Radio station (message displayed: Connection Down).*

Ans:

- If Internet connectivity is lost, check your internet access (e.g. by opening a browser and refreshing the page).
- If WorldRadio is not known to the network, check that the MAC address for the WorldRadio has been entered correctly in the wireless network's MAC Access Control. Turn off the WorldRadio and turn it on again by unplugging then plugging the power mains.
- If Internet is unavailable, check that the Internet access point has an active connection to the Internet.
- If the wireless network is incorrectly configured, open the WorldRadio PC Utility and select the WorldRadio that has the problem. Click the Profiles button and check that the active profile is correctly configured for your network. Turn on the WorldRadio and ensure that the correct profile has been select

► *Cannot connect to an Internet Radio station after pressing "Tune" and an error is displayed.*

Ans:

- You are connected to a station that is running, but it is not currently broadcasting any music. Try again later or choose another station.
- If the buffer is full (everything else seems normal), wait a few seconds until the buffer clears. If the problem persists, turn off the WorldRadio and turn it on again by unplugging and then plugging the power mains.
- If the station is not up, try looking up the station's Web site to see if there are any changes. Try a different Internet Radio station.
- There is a VPN (Virtual Private Network) running on your Router. Disable the VPN while running the WorldRadio. Warning: this may adversely affect other programs and data - proceed with caution.

- Your Router and the WorldRadio are not on the same subnet. The Router and the WorldRadio must be on the same subnet.
- The Router has a MAC filter enabled. Add the MAC address of the WorldRadio to the exception list.
- Your Router does not have DHCP server enabled. Enable the Router's DHCP server function.
- Or use a different network profile that allows for a fixed IP address.

► *TheWorldRadio does not react to the Remote Control nor to the Front Panel buttons and hangs in the UPnP Menu structure.*

Ans:

This can be caused by network delays when sending out UPnP requests. Wait a few seconds and try again. If the problem persists, turn off the WorldRadio and turn it on again by unplugging then plugging the power mains

► *After accessing an Internet Radio station, the device does not playback other Internet Radio stations.*

Ans:

Turn off the WorldRadio and turn it on again by unplugging then plugging the power mains.

► *Cannot find my access point / wireless router.*

Ans:

The WorldRadio is out of access point / wireless router's range. Try again by reducing the distance to the access point / wireless router.

► *The WorldRadio stops playing the music suddenly.*

Ans:

You are connected to a station that is temporarily out of service. Try again later or choose another station.

► *Where can I find my WorldRadio settings?*

Ans:

Select "Device Status" in the configuration menu. All configuration information and settings can be found here.

► *Can I change profile for using the WorldRadio in a different location?*

Ans:

Select the "Select Profile" in the configuration menu. You can create and store three personalized profiles in the WorldRadio that can be selected anytime you need them.

► *Is it safe listening to the internet radio program on my WorldRadio wirelessly?*

Ans:

The WorldRadio if enabled with WEP encryption will be just as safe as other wireless accessing devices; and the WorldRadio will be less likely to be attacked by hackers.

► *Cannot hear any audio from the WorldRadio.*

Ans:

Turn on the volume.

► *I am hearing a lot of static or interference on the WorldRadio?*

Ans:

The internet streaming rate may be too low on the station side. Try again later or choose another station.

► *Can I link the WorldRadio to my HiFi system?*

Ans:

The WorldRadio has a standard 3.5mm jack at the front panel that can be connected to a hifi or a pair of headphones.

► *The WorldRadio's display freezes, and there's no response to press any of the buttons and/or knobs.*

Ans:

- Press the Reset Button at the rear panel. Wait for 30 seconds or so for system to restart.
- If failed, then turn off the WorldRadio and turn it on again by unplugging and then plugging the power mains.
- If still doesn't work, be sure to check your network setting & connectivity.

► *Why am I seeing HTTP address like " HTTP://192.168.0.4 " on screen ?*

Ans:

- The WorldRadio is trying to establish LAN connection with your router to access to the internet; please wait for a few more seconds for the radio to re-start.
- If the WorldRadio wouldn't re-start, please unplug then plug in the power mains to perform a physical re-start.
- And if the symptom persists, please also check your router setting.

[For further information, please refer to our website.](#)

Appendix C: Regulations & Safety

EU Declaration of Conformity

This product carries the CE-Mark in accordance with the related European Directives. CE marking is the responsibility of Joybien Technologies, Co., Ltd., Taiwan.

We hereby declare that the product is in compliance with EU Directive 89/336/EEC using EN55022:1998, EN55024:1998, EN61000-3-2:2000 and EN61000-3-3:1995.

CE Warning: This is a class B product. In a domestic environment this product may cause radio interference in which case the user may be required to take adequate measures.

Federal Communication Commission Interference Statement

This equipment has been tested and found to comply with the limits for a Class B digital device, pursuant to Part 15 of the FCC Rules. These limits are designed to provide reasonable protection against harmful interference in a residential installation.

This equipment generates, uses and can radiate radio frequency energy and, if not installed and used in accordance with the instructions, may cause harmful interference to radio communications. However, there is no guarantee that interference will not occur in a particular installation. If this equipment does cause harmful interference to radio or television reception, which can be determined by turning the equipment off and on, the user is encouraged to try to correct the interference by one of the following measures:

- . Reorient or relocate the receiving antenna.
- . Increase the separation between the equipment and receiver.
- . Connect the equipment into an outlet on a circuit different from that to which the receiver is connected.
- . Consult the dealer or an experienced radio/TV technician for help.

FCC Caution : To assure continued compliance, any changes or modifications not expressly approved by the party responsible for compliance could void the user's authority to operate this equipment. (Example - use only shielded interface cables when connecting to computer or peripheral devices).

FCC Radiation Exposure Statement

This equipment complies with FCC RF radiation exposure limits set forth for an uncontrolled environment. This equipment should be installed and operated with a minimum distance of 20 centimeters between the radiator and your body.

This device complies with Part 15 of the FCC Rules. Operation is subject to the following two conditions:

- (1) This device may not cause harmful interference, and (2) This device must accept any interference received, including interference that may cause undesired operation.

The Joybien WorldRadio does not contain any user serviceable parts. Repairs should be made only by an authorized Joybien service center. Unauthorized repairs or modifications could result in permanent damage to the equipment, and void your warranty and your authority to operate the device under Part 15 regulations.