



# SWIMMING POOL FALL DETECTOR SENSOR PREMIUM™

Sensor Premium™ : PRE007-US

## INSTALLATION AND OPERATION GUIDE READ CAREFULLY AND KEEP FOR REFERENCE

### CONTENTS

<b>1</b>	<b>Introduction – Safety recommendations</b>	<b>2</b>
<b>2</b>	<b>Contents of the package</b>	<b>2</b>
<b>3</b>	<b>« Quick Start Guide »</b>	<b>3</b>
<b>4</b>	<b>Operating principle</b>	<b>4</b>
<b>5</b>	<b>Installation of the Sensor Premium™</b>	<b>6</b>
5.1	Insertion of the tube	7
5.2	Insertion of the batteries	7
5.3	Choice of location	8
5.4	Installation for testing	9
5.5	Tests	10
5.6	Final installation	11
<b>6</b>	<b>Installation of the remote siren</b>	<b>13</b>
<b>7</b>	<b>Using Sensor Premium™</b>	<b>15</b>
7.1	I want to have a swim	15
7.2	Automatic restart	16
7.3	Manual restart	16
7.4	Too much wind	16
7.5	Low-volume siren mode	17
7.6	Complete stop	17
7.7	Replacing the batteries	18
7.8	I have a problem with my fall detector	19
7.8.1	Two regular beeps are heard	19
7.8.2	I cannot find the cause of my problem	19
<b>8</b>	<b>Frequently asked questions</b>	<b>20</b>
<b>9</b>	<b>Further information</b>	<b>21</b>
<b>10</b>	<b>Warranty and after sales service</b>	<b>23</b>
<b>11</b>	<b>Monthly tests</b>	<b>24</b>

### FCC REGULATION

NOTE: THE MANUFACTURER IS NOT RESPONSIBLE FOR ANY RADIO OR TV INTERFERENCE CAUSED BY UNAUTHORIZED MODIFICATIONS TO THIS EQUIPMENT. SUCH MODIFICATIONS COULD VOID THE USER'S AUTHORITY TO OPERATE THE EQUIPMENT.

**THIS DEVICE COMPLIES WITH PART 15 OF THE FCC RULES.** OPERATION IS SUBJECT TO THE FOLLOWING CONDITIONS: (1) THIS DEVICE MAY NOT CAUSE HARMFUL INTERFERENCE, AND (2) THIS DEVICE MUST ACCEPT ANY INTERFERENCE RECEIVED, INCLUDING INTERFERENCE THAT MAY CAUSE UNDESIRED OPERATION.

## 1 Introduction – Safety recommendations

---

Thank you for purchasing a Sensor Premium™ swimming pool alarm.

This swimming pool alarm complies with the ASTM F2208-02<sup>e1</sup> standard

**This guide will help you** install your swimming pool alarm and understand its operating principle.

If you have any question or comment concerning your swimming pool alarm, please contact your retailer or:

Sensor Premium™ Customer Care  
P.O. Box 3839  
Cary, North Carolina 25519-3839  
Telephone: 000 000 0000  
usa@sensor-premium.com

- **Sensor Premium™ is a swimming pool alarm which detects the fall of a child weighing 18 lbs or more by setting off a siren.**
- **This device is not intended to replace any other safety consideration; that is, adult supervision, lifeguards, fences, gates, pool covers, locks, and so forth, and some devices may not detect gradual entry.**
- **Sensor Premium™ is not intended as a substitute for the watchfulness of parents and/or responsible adults, which remains the essential factor for the protection of children under the age of five.**
- **Sensor Premium™ is not a rescue device, immediate action by a responsible adult is essential when the alert signal is heard.**
- **In no event can your retailer or the manufacturer of the alarm system be held responsible for any person or animal falling or drowning.**
- **Warning must be given that the pool and surrounding area are under electronic surveillance**

Please read carefully the safety recommendations given throughout and on §9 of this manual.

## 2 Contents of the package

---

Despite the careful attention we pay to the quality of our products and their packaging, you are requested to check its contents.

- Central unit with black flexible tube
- 1 rigid tube
- 4 D alkaline batteries
- 1 fastening kit (screws, washers, joints, rawplugs, 2 magnet key-rings)
- 1 test validation sheet
- 1 conformity declaration sheet
- The terms of guarantee at the end of this guide
- 1 remote siren, its mains power supply and its attachment kit (2 screws, 2 rawplugs)

To get additional magnets, contact your retailer.

### 3 « Quick Start Guide »

#### INSTALLATION

- Set the rigid tube in place and insert the batteries in your fall detector (see §5.1 et §5.2)

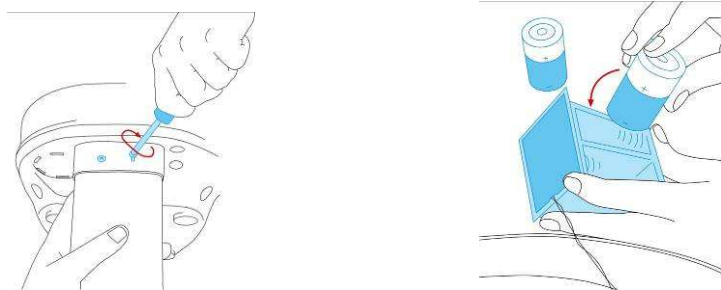

- Install your fall detector at the appropriate location on your pool (see §5.3), making sure that the tube immersion depth is correct: 8.5 in (+/- 1 in). Cut the rigid tube down to the right length if necessary. (see §5.4)
- Switch your detector to ARMED mode (long beep – green indicator light flashing) by moving a magnet over the swimmer symbol.

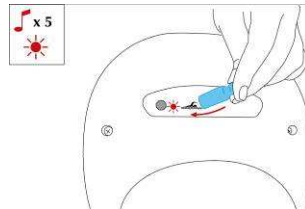

- Carry out a fall test: from the top of the coping, drop a 2.5 US gallon jerry-can filled so as to weigh 18 lbs, as far away from your detector as possible. The siren should go off in less than 20 seconds. (see §5.5)

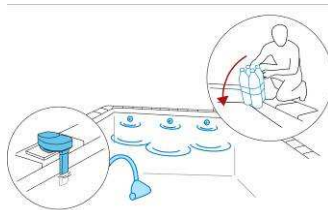



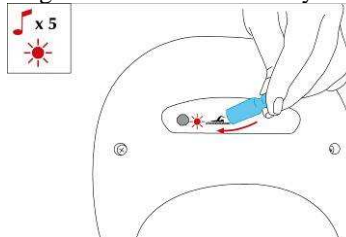



- Turn the siren off by moving a magnet over the swimmer symbol. The red indicator light flashes.



- Fasten Sensor Premium™ on the edge of your pool using the fastening kit supplied (see §5.6).
- Wait for your device to restart automatically (long beep – green indicator light flashing - see §7)
- Your device is now operational.

USE

SIGNAL	STATUS
Green indicator light flashing  ...  ... 	Detector in ARMED mode – Pool under surveillance
Red indicator light flashing  ...  ... 	Detector in DISARMED mode – Pool not monitored
All indicator lights off	Detector in OFF mode – Pool not monitored
1 low-pitched beep every minute	Low batteries: replace the 4 batteries in your fall detector
2 low-pitched beeps every minute	Malfunction requiring return to the after-sales service

To switch between ARMED and DISARMED mode, move a magnet over the swimmer symbol.

## 4 Operating principle

- How does Sensor Premium™ work?

Sensor Premium™ detects and analyzes disturbances in your pool. It was designed to detect the fall of a child weighing 18 lbs or more in the conditions specified below. It warns of the fall by setting off a loud siren.

For your safety and comfort, it has three main operating modes:

- **ARMED MODE:**
  - o Sensor Premium™ monitors the pool, its green indicator light is flashing.
  - o The siren will go off if a person weighing 18 lbs or more falls into the pool.
- **DISARMED MODE:**
  - o You must activate this mode before using the pool to avoid setting off the siren.
  - o Sensor Premium™ is not monitoring the pool, the red indicator light is flashing.
  - o No accidental fall will be detected.
  - o **Warning:** the device remains in DISARMED mode for about 10 minutes after the swimmers have left the pool. It automatically switches to ARMED mode once the pool is still.
  - o In case of strong wind, the device can no longer monitor the pool and will automatically switch to DISARMED mode.
- **OFF MODE:**
  - o You can activate this mode to replace the batteries or perform maintenance operations on the pool.
  - o Sensor Premium™ is not monitoring the pool. All indicator lights are off.
  - o No accidental fall will be detected.
  - o There is no automatic restart.

In order to minimize your response time, Sensor Premium™ has a remote siren controlled by a radio link, which is to be installed as close as possible to your living quarters. It will also set off the siren in case of a fall into your pool (see §6).

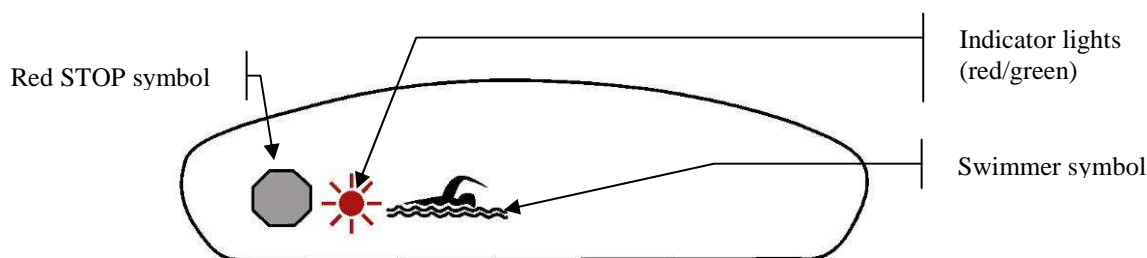

- Sensor Premium™ principle signals:



Pict. 1

See Table next page

▪ Sensor Premium™ principle signals:

MODE	SIGNALISATION		PRECISIONS
	DETECTEUR	SIRENE DEPORTEE	
ARMED	Green indicator light flashing 		<ul style="list-style-type: none"> <li>- The siren goes off if a person falls into the pool (or if the device detects an event similar to a fall)</li> </ul> <hr/> <p>To switch to ARMED mode</p> <ul style="list-style-type: none"> <li>- From the DISARMED mode: either move the magnet over the swimmer symbol (<b>Pict 1</b>), or wait for the pool to be sufficiently still to allow automatic switching to the ARMED mode (1 long beep). This may take from 5 to 10 minutes, depending on how disturbed the water in the pool is.</li> </ul>
DISARMED	Red indicator light flashing 		<ul style="list-style-type: none"> <li>- Mode allowing swimming</li> <li>- The siren will not go off if you are swimming.</li> <li>- Sensor Premium™ is liable to switch automatically to the DISARMED mode when there is too much wind and it can no longer perform its monitoring function.</li> </ul> <p><b>NEVER LEAVE THE POOL UNATTENDED IN THIS MODE</b></p> <hr/> <p>To switch to DISARMED mode:</p> <ul style="list-style-type: none"> <li>- From the ARMED mode: move the magnet over the swimmer symbol -5 short beeps (<b>Pict. 1</b>).</li> </ul> <p>Once Sensor Premium™ has switched to the DISARMED mode, you will have 3 minutes to use the pool before the device automatically switches back to ARMED mode</p>
Re-activation phase	Red and green indicator lights flashing in turns 		<ul style="list-style-type: none"> <li>- Intermediate mode, during which only heavy falls are detected (<b>see §7.3</b>)</li> </ul> <p><b>NEVER LEAVE THE POOL UNATTENDED IN THIS MODE</b></p>
Setting off	The siren goes off	The siren goes off	<ul style="list-style-type: none"> <li>- A fall or similar event is detected in the pool. <b>QUICK ACTION MUST BE TAKEN IMMEDIATELY.</b></li> <li>- Turn the siren off by moving the magnet over the swimmer symbol (<b>Pict 1</b>).</li> </ul> <p>NOTE: In the absence of action on your part, the siren stops automatically after 3 minutes.</p>
OFF	None		<p>You can completely switch off Sensor Premium™ when replacing the batteries or during maintenance on your pool.</p> <p><b>NEVER LEAVE THE POOL UNATTENDED IN THIS MODE</b></p> <hr/> <p>To switch to this mode: <b>see §7.6.</b> To switch from this mode: move the magnet over the swimmer symbol (<b>Pict. 1</b>), 5 short beeps, you will then switch to the DISARMED mode.</p>

▪ Failure signals

Failure	Sound signals	
	With the magnet	Periodic
Low batteries	4 short, low-pitched beeps	1 short, low-pitched beep every minute
<b>Malfunction</b> <b>Return to the after-sales service required</b>	–	<b>2 short, low-pitched beeps every minute</b>

## 5 Installation of the Sensor Premium™

### INSTALLATION PRECAUTIONS

- Check that the Sensor Premium™ sirens can be heard from inside your home.
- Your fall detector must be installed in calm weather on a still pool.
- The alarm system must be installed at a location where the water depth is 12 in. minimum.
- The probe (rigid angled tube + black flexible tube) might have to be cut to obtain an immersion depth of 8.5 in. (+/- 1 in.). The installation of a level controller is recommended. Contact your retailer for advice.
- Make sure that the water in your pool is clear and pure before installing your device.
- Some robot cleaners of the diving robot type are incompatible with fall detection systems.
- Proper operation of Sensor Premium™ cannot be guaranteed in the presence of a bubble pool cover.
- **Warning:** Sensor Premium™ is fitted with a powerful siren (over 100 dB). In case the siren should go off, please take all necessary precautions to protect your auditory system during the installation.

### Outils nécessaires à l'installation :

- 1 pozi screwdriver
- 1 tape measure
- 1 2.5 US gallon jerry-can
- 1 rope about 6 ft long.
- 1 drill with concrete bit Ø 0.31 in (8mm)
- 1 hacksaw
- 1 pencil

Your fall detector is installed in 6 steps:

- 5.1 Insertion of the tube
- 5.2 Insertion of the batteries
- 5.3 Choice of location
- 5.4 Installation for testing
- 5.5 Tests
- 5.6 Final installation

**UTMOST VIGILANCE IS REQUIRED FROM THE PARENT/RESPONSIBLE ADULT DURING THE INSTALLATION OF YOUR FALL DETECTOR**

## 5.1 Insertion of the tube

Warning! The black flexible tube is connected to the central unit, and must be handled with care.

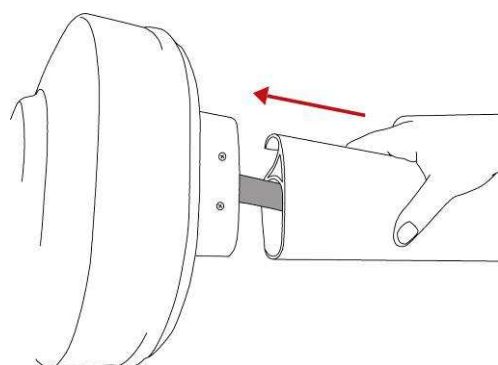

Insert the rigid tube on the black flexible tube (be careful with the direction of the tube). Push in completely the tube on the base (1 in).

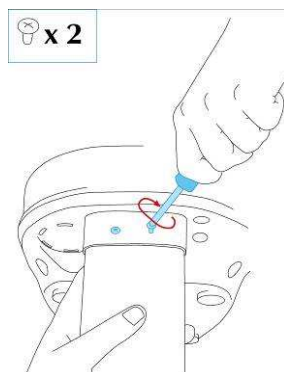

Screw the 2 screws on the front

## 5.2 Insertion of the batteries

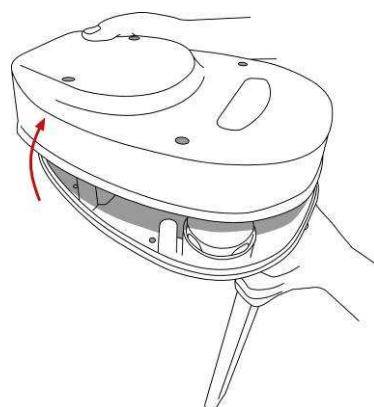

Remove the cover by unscrewing the 4 screws

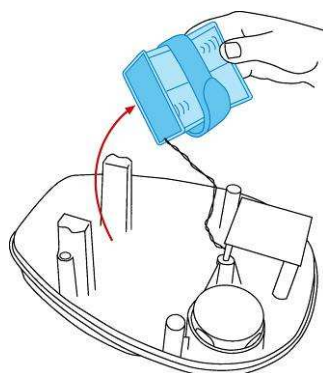

Remove the batteries holder fixed by strap (velcro system)

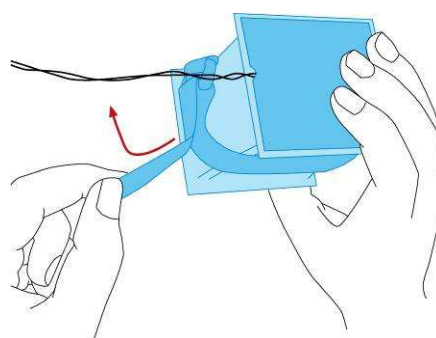

Untie the strap

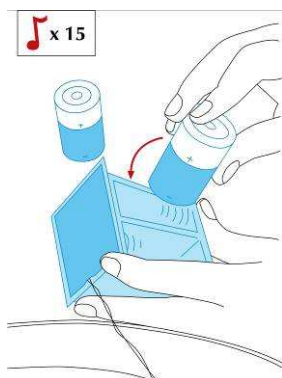

Insert the 4 D batteries in the appropriate housing, making sure the polarity is respected. You will hear 15 short beeps. Your device is in OFF mode

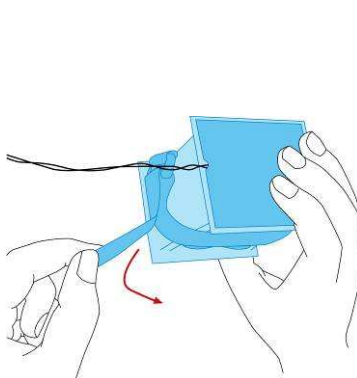

Tie the strap

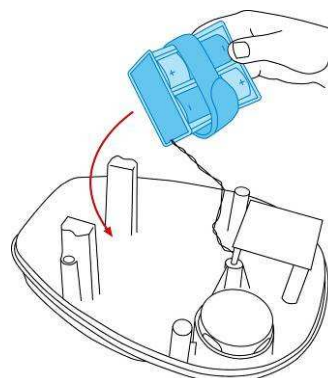

Put back the batteries holder in the appropriate housing

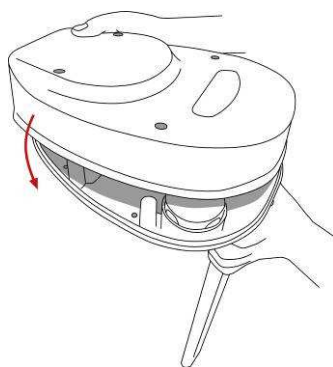

Put the cover back in place on the base without tightening the screws.

### 5.3 Choice of location

Do not install your device on the pool edge before having determined the location that will ensure optimal monitoring of your swimming pool.

After having determined the appropriate location, you must ensure that the siren can be heard from your home.

Your fall detector must be **positioned in the center of the greatest length** of your swimming pool, on a coping (position recommended for rectangular swimming pools). If your pool does not correspond to the configurations shown below, **ask your retailer for advice**.

Check that the activation zone (where you place the magnet) is easy and practical to access .

- ⚠ Ensure that Sensor Premium™ is more than 3 feet away from the filtration system (return fittings, waste plug, skimmer, vacuum fittings, etc.) or waterfall or any other device that may disturb the pool at this place.
- ⚠ Your fall detector can be used on pools with maximum dimensions of 20 x 40 feet (6 x 12 m), and must not be more than 28 feet (8.5 m) away from all possible fall locations.
- ⚠ In the case of a larger swimming pool, or one that is of a particular shape, ask your retailer for advice.

EXAMPLES:

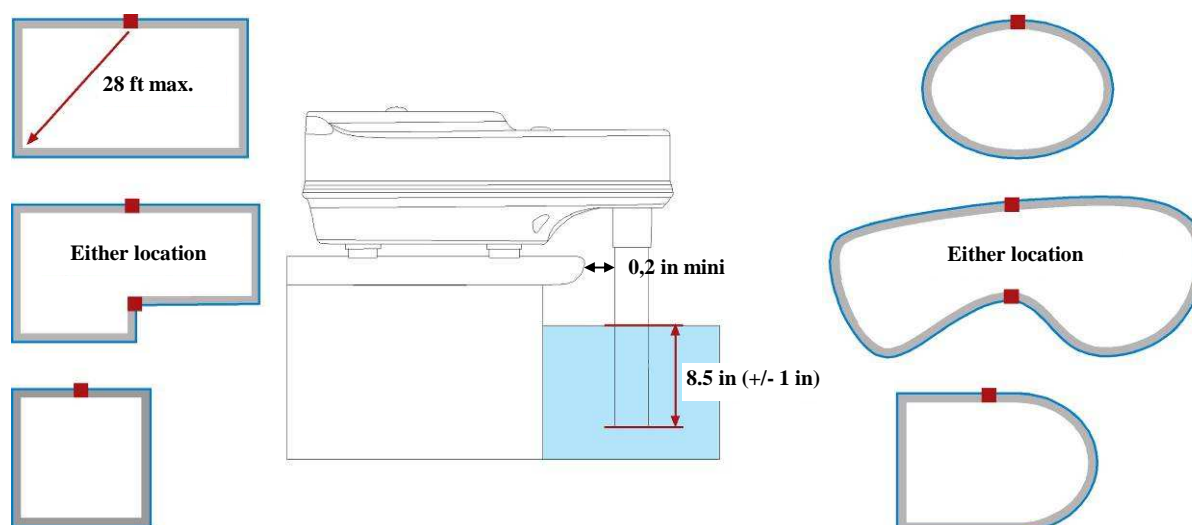

○ : Possible location of your central unit



## 5.4 Installation for testing

 x 4

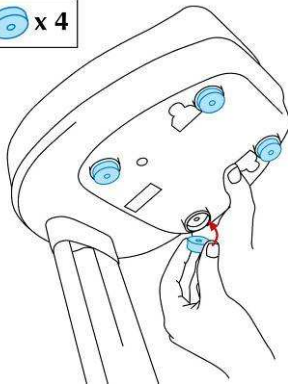

Place the 4 pieces of stabilizing foam under the device

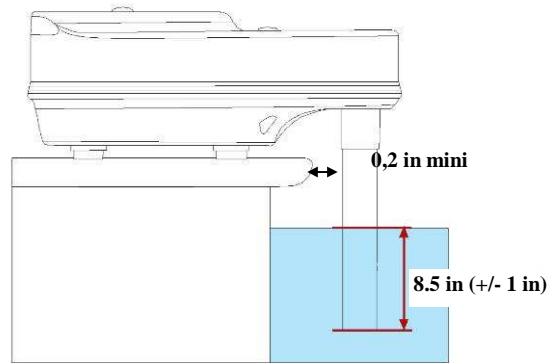

Position the device at the selected location, making sure that the distance between the probe and the edge of the coping is at least

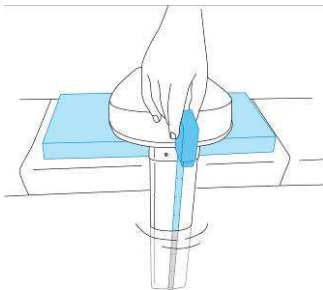

Check the immersion depth.

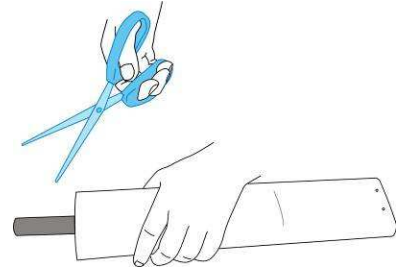
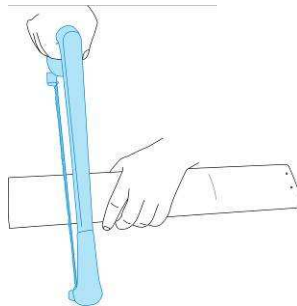

If your probe is immersed by more than 8.5 in. (+/- 1 in.) 0.2 in. **Cut it carefully using a hacksaw and scissors** (both the tube and the flexible tube) to obtain a proper immersion depth

If the water level has been deliberately lowered, suitable probe extenders are available from your retailer.

- Your device is in OFF mode, and should be activated for the installation tests by moving the magnet over the swimmer symbol area.
- You will hear 5 short beeps, the red indicator light flashes, you are in DISARMED mode.
- Wait for the automatic switch to ARMED mode (1 long beep, green indicator light flashing) before starting the tests.

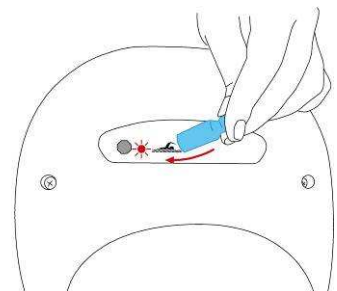

## 5.5 Tests

- Make sure that the pool is still. If you have a swim jet, turn it off.
- Prepare a 2.5 US gallon jerry-can with enough water to reach a weight of 18 lbs (8 kg), and tie the 6 feet rope to it to recover it when performing fall tests.

NOTE: If you wish, you can conduct your tests in low-volume siren mode (optional). In this mode, the volume of the siren is reduced and the siren stops automatically after 5 seconds. Refer to §7.5 for further details.

- For these tests, Sensor premium™ must be in ARMED mode (green indicator light flashing). If such is not the case, move the magnet over the swimmer symbol.
  - If in spite of this, the indicator light does not switch to green, this means that the pool is not still enough. You must imperatively wait until your pool is still before carrying out the tests.
- Test 1 - Robot cleaner + filtering
  - Leave Sensor Premium™ in ARMED mode for 10 minutes with the filtering on and the robot cleaner working, only if you have a robot cleaner.
    - Sensor Premium™ must remain in ARMED mode (green indicator light flashing) without the siren going off.

Some diving type robot cleaners (a robot which moves out of and dives back into the water, possibly causing a disturbance similar to a fall) are not compatible with fall detectors.

If this test fails:

- **Look up § 8, page X.**
- Contact your retailer
- Contact our technical support service: [usa@sensor-premium.com](mailto:usa@sensor-premium.com)

- Test 2 - Falls

- Make sure that your device is in ARMED mode (green indicator light flashing)

1) Move to the spot furthest away from your fall detector.

- Simulate the fall of a person by dropping the 18 lbs jerry-can from the top of the coping.
  - The siren must go off less than 20 seconds after the fall.
  - Turn the alarm off by moving the magnet over the swimmer symbol.

Wait for your fall detector to restart automatically (1 long beep – green indicator light flashing).

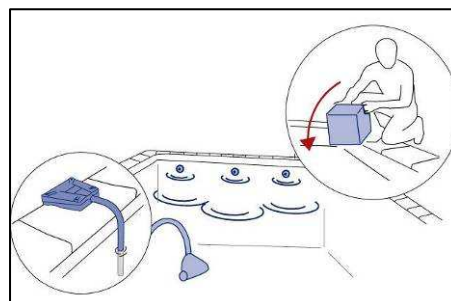

**During the tests, after each fall, you must wait for the automatic restart of Sensor Premium™ before performing another fall. Depending on wind and pool disturbance conditions, this restart may take about ten minutes.**

2) Move to 3 feet away from your fall detector

- Simulate the fall of a person by dropping the 18 lbs jerry-can from the top of the coping.
  - The siren must go off less than 20 seconds after the fall.
  - Turn the alarm off by moving the magnet over the swimmer symbol.

The test is validated.

If one of these tests fails:

- Look up § 8.
- Contact your retailer
- Contact our technical support service: [usa@sensor-premium.com](mailto:usa@sensor-premium.com)

All the tests have been conducted successfully, you may now proceed with the final installation of your device.

## 5.6 Final installation

**WARNING:** Sensor Premium™ is liable to set off its siren during the various operations. It is therefore strongly recommended to switch to OFF mode (see §7.6) so that it can be freely handled during its final installation.

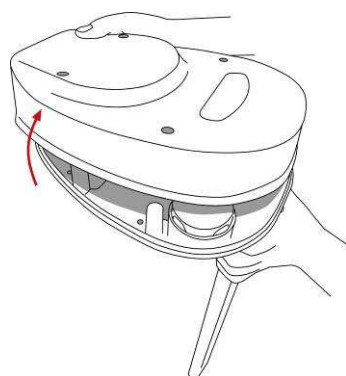

Remove the cover from your fall detector.

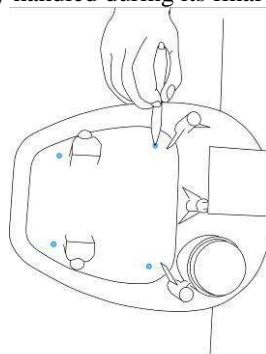

Locate the 4 holes at the bottom of the base.

Position the base on the coping so that the rigid tube is more than 0,2 in away from the coping.

Using a felt-tip pen, mark the position of the holes to be drilled in the coping through the 4 holes in the base

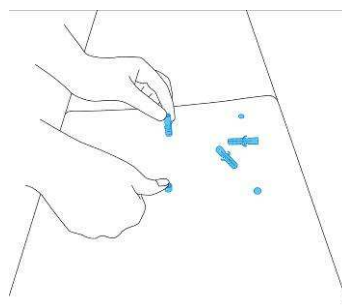
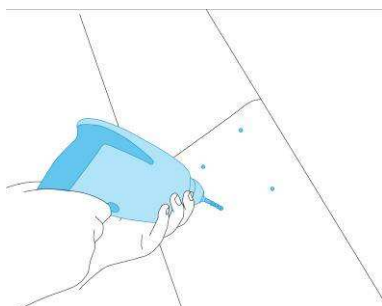

Drill the 3 holes in the coping with a Ø 0.3 in. bit and set the rawplugs in place

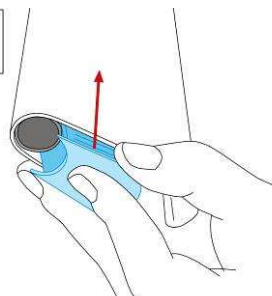

Insert the cap on the tube

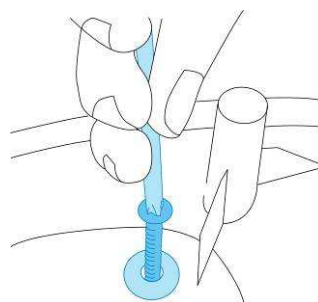
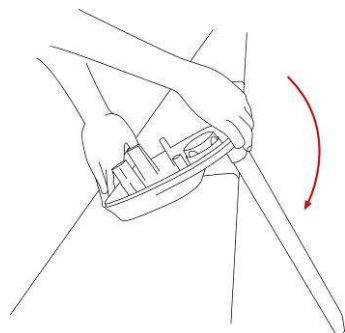
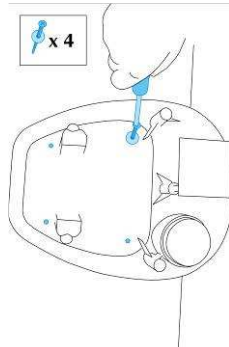

Position and fasten the base using the 4 screws and the 4 washers (the 4 washers are inside the box).

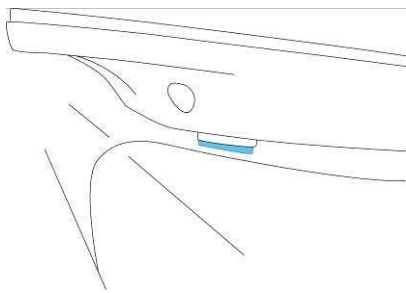

Do not crush completely the stabilizing foam pads while screwing

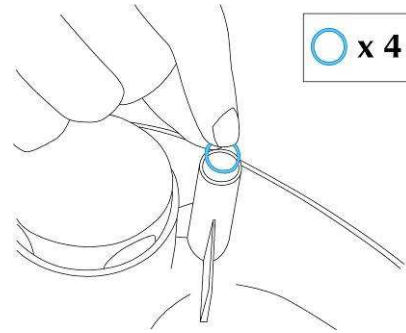

Position the 4 small black joints on the base screw barrels

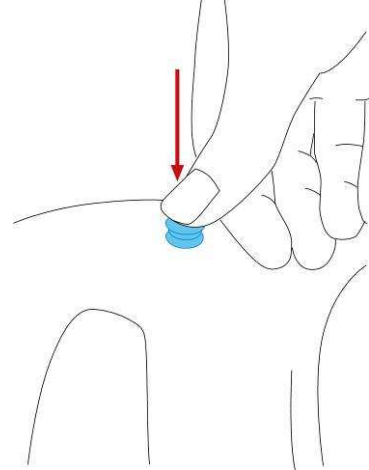
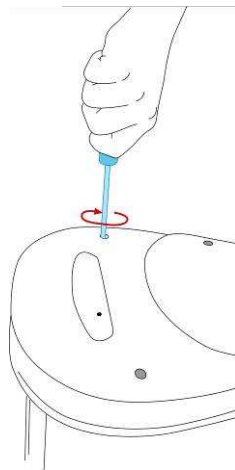
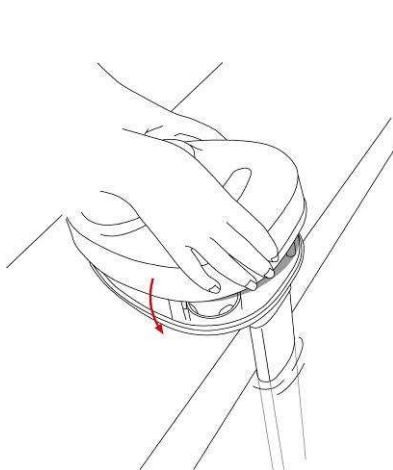

Put the cover back in place and screw the 4 screws as tightly as possible (do not use an electric screwdriver) and put the 4 protective caps in place

**WARNING: The installation of the joints and foam pads, like the fastening, must be done with care to ensure waterproofing and proper running of your device.**

- Check one last time that your alarm is working properly.
  - o Switch to DISARMED mode by moving the magnet over the swimmer symbol (5 short beeps, red indicator light flashing).
  - o Wait for your device to restart automatically (1 long beep – green indicator light flashing).
  - o Perform a fall test as far away from your device as possible.
  - o If the fall is detected in less than 20 seconds, your installation is validated.
- Wait for Sensor Premium™ to restart automatically before walking away from the pool.
- Complete the test validation sheet and send it to the address below:

Sensor Premium™ Customer Care  
P.O. Box 3839  
Cary, North Carolina 25519-3839

**PUT YOUR MAGNETS AWAY TO KEEP THEM OUT OF THE REACH OF CHILDREN.**

## 6 Installation of the remote siren

To install and use your remote siren, you must have the following components and tools:

- The siren (red and white unit)
- The 110V/12V, 450 mA AC power adapter
- The fastening kit (bag containing 2 screws and 2 rawplugs)
- A drill with a Ø 0.25 in bit
- A Pozi screwdriver

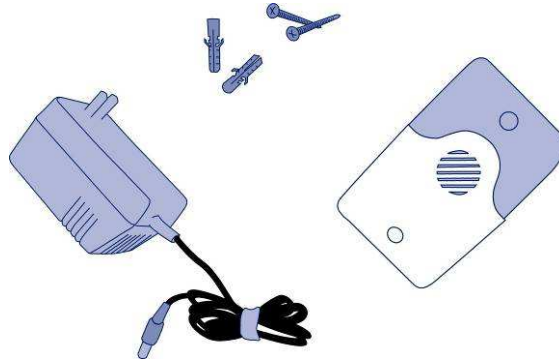

The remote siren must be installed at a maximum distance of 100 feet from Sensor Premium™. This is not an outside siren, it must be installed inside the house, and protected from bad weather.

### - Operating principle

- o The remote siren is controlled from a distance by Sensor Premium™ using radio waves.
- o If a fall is detected by Sensor Premium™ in the pool, the Sensor Premium™ siren and the remote siren will go off simultaneously.
- o You cannot turn off the sirens from your remote siren; you must imperatively go to the pool, ascertain the reason why the siren went off, take any necessary action and turn off the sirens by moving a magnet over the swimmer symbol.
- o As with Sensor Premium™, if you do not turn off the siren by moving a magnet over the swimmer symbol after it has gone off, the siren will stop automatically after 3 minutes.
- o When you switch modes from Sensor Premium™ (ARMED, DISARMED), the remote siren beeps to indicate that your action has been taken into account.

### - Synchronization

To make sure that Sensor Premium™ and the remote siren are connected, you must synchronize the two devices.

- Select a location for your remote siren
  - o Less than 100 feet from Sensor Premium™
  - o Fitted with a mains power point
- b)** Connect the adapter to the remote siren (Pict. 2)
- c)** Connect the adapter to the mains, a sound signal is heard, your remote siren is powered up (Pict. 3)
- d) With a pen, briefly press the black button on the side of the remote siren, a sound signal is heard, and the green indicator light inside the siren flashes (Pict. 4)
- e) Leave your siren at the location chosen and return to your detector of fall at the pool.

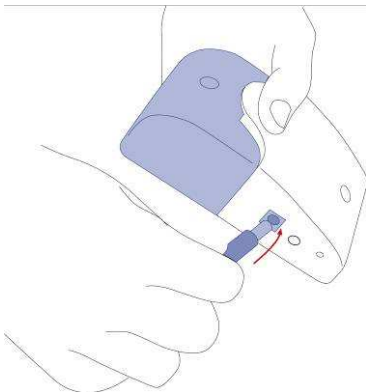

Pict. 2

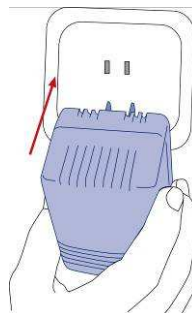

Pict. 3

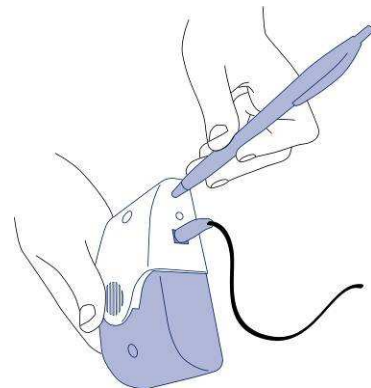

Pict. 4

- f) Lay and keep a magnet (for about 3 seconds) on the Sensor Premium™ swimmer symbol, until you hear a short loud beep and the Sensor Premium™ red indicator light starts flashing quickly. The remote siren must emit a beep.
  - g) Return to the remote siren and press again with a pen on the black button on the side of your remote siren; a sound signal is heard. Sensor Premium™ and your remote siren should now be synchronized.
  - h) Move the magnet over the Sensor Premium™ swimmer symbol: Sensor Premium™ and the remote siren should each emit a sound signal.
  - i) Perform a fall test in your pool to validate the radio link. Turn the two sirens off by moving the magnet over the swimmer symbol.
  - o You can synchronize one or more Sensor Premium™ with one or more sirens. To do this, you must repeat operations d) e) f) and g) for each Sensor Premium™ after having pressed the black button on the remote siren(s).
  - o You can re-initialize your remote siren by pressing the black button for a longer time (about 3 seconds). You will then have to repeat the synchronization operations.
- **Fixation**
- o At the selected and validated location, drill two holes with a diameter of 0.25 in. one above the other, 3.5 in. apart. To make the radio link easier, it is recommended to position the siren as high as possible on the wall (but check the length of the adapter cord) (Pict. 5)
  - o Insert the two rawplugs into the two holes (Pict. 6)
  - o Screw the two screws through the siren and into the rawplugs (Pict. 7)



**Pict. 5**

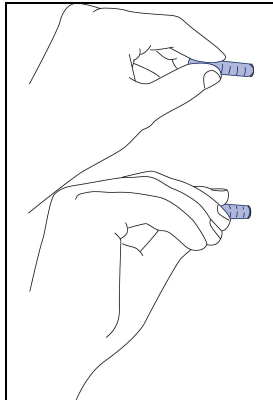

**Pict. 6**

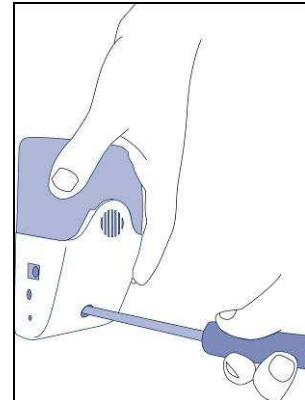

**Pict. 7**

## 7 Using Sensor Premium™

**The magnets must be kept out of the reach of children**

### **PRECAUTIONS FOR USE**

- Sensor Premium™ is not intended as a substitute for the watchfulness of parents and/or responsible adults, which remains the essential factor for the protection of children under the age of five.
- Action must be taken when the siren is heard.
- Certain rough weather conditions (strong winds, storms, etc.) and the use of certain powerful cleaning equipment can cause untimely alarm triggering.
- Your alarm system will not operate if the water in the probe is frozen or the surface of the pool is frozen. It is hard to know when the water is frozen in the tube. If in doubt, check that your fall detector is working properly.
- When cleaning the outside of your device, (waterline,...), do not use any high-pressure cleaning apparatus, abrasive brush and/or other implements which might scratch or damage your fall detector.
- Proper operation of Sensor Premium™ cannot be guaranteed in the presence of a bubble pool cover.
- To ensure proper operation of your device, please keep the water pure and clean (in particular, to avoid the formation of algae inside the probe).
- Should you restart your detector after a long period, perform the tests described in § 5.4. In case of a problem, contact your retailer immediately.
- The only authorized operation on the device once it is installed is changing the battery.
- Regularly check that your fall detector is working properly by performing the monthly tests mentioned in this guide (see § 11).
- Some robot cleaners of the diving robot type are incompatible with fall detection systems.
- Any user who shuts off the system must be aware that surveillance by a person must take over from the system.
- The greatest vigilance by the parent/responsible adult is necessary between the end of the swim and reactivation of the alarm system.

### **7.1 I want to have a swim**

- Your detector is in monitoring mode (green indicator light flashing).
- Move the magnet over the swimmer symbol, you will hear 5 short beeps, the red indicator light flashes.
- You can have a swim.

After swimming, the pool will not be monitored until the device is restarted, which will happen when the pool is still again. The device is restarted about ten minutes after the swim.

**DURING THIS TIME, YOUR POOL IS NOT PROTECTED.  
UTMOST VIGILANCE IS REQUIRED FROM THE PARENT/RESPONSIBLE ADULT.**

## 7.2 Automatic restart

Your fall detector continuously checks the pool disturbance conditions.

As soon as your pool becomes still again, after a swim or strong disturbance (strong wind, swim jet...) **your fall detector automatically switches to ARMED mode and the green light flashes**. This may take about ten minutes.

**Your pool is now protected.**

**Warning: Your device is liable to switch to ARMED mode if you are in the pool without creating any disturbances.**

## 7.3 Manual restart

After your swim, you can indicate to your fall detector that the pool is not being used, so that monitoring is resumed faster.

Then, move the magnet over the swimmer symbol when leaving the pool.

You are then in one of the three situations described below.

Case 1: Your fall detector considers that your pool is very disturbed. In this case, your device acknowledges your request by emitting a short, high-pitched beep, but cannot resume monitoring immediately. Its red indicator light flashes. It will gradually resume monitoring as the pool becomes still. (Reactivation phase: See table §4)

**DURING THIS TIME, YOUR POOL IS NOT PROTECTED.**

**UTMOST VIGILANCE IS REQUIRED FROM THE PARENT/RESPONSIBLE ADULT.**

Case 2: Your fall detector considers that your pool is disturbed. In this case, your device acknowledges your request by emitting a short, high-pitched beep. Its green and red indicator lights flash in turn. Your fall detector will only detect heavy falls, and will gradually resume full monitoring of the pool.

**DURING THIS TIME, UTMOST VIGILANCE IS REQUIRED FROM THE PARENT/RESPONSIBLE ADULT.**

Case 3: Your fall detector considers that your pool is still. It resumes immediately monitoring of the pool by emitting a long, high-pitched beep. Its green indicator light flashes.

**YOUR POOL IS NOW PROTECTED**

## 7.4 Too much wind

In some cases, in the presence of rough weather conditions (strong wind, heavy rain, thunderstorm...), your fall detector is liable to interrupt its monitoring function. Its red indicator light flashes.

**YOU MUST BE PARTICULARLY VIGILANT WHEN THE WEATHER IS ROUGH.**

Warning: The performance of Sensor Premium<sup>TM</sup> is not guaranteed beyond wind levels higher than those specified in standard ASTM F2208-02<sup>e1</sup>.



## 7.5 Low-volume siren mode

In this (optional) mode, your siren sounds only for a short time and at a low volume, to allow you to perform the installation tests and the monthly tests without disturbing you or the neighborhood.

- The TESTS mode lasts for 30 minutes.
- The beginning and ending of the TESTS mode are indicated by a specific tune.

To manually start and stop the TESTS mode, place and keep the magnet on the swimmer symbol **until the sound validation** (loud beep) and until the red indicator light flashes quickly. Perform this operation 3 times in a row (Pict. 8).\*

- Manual start of the TESTS mode: red indicator light continuously on during the specific tune.
- Manual end of the TESTS mode: green indicator light continuously on during the specific tune.

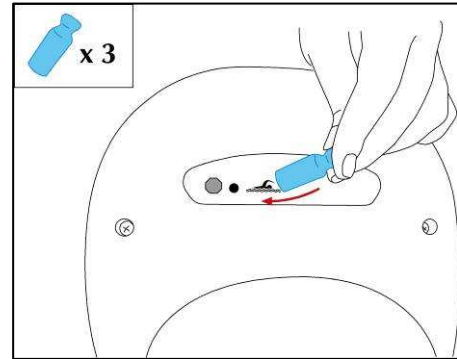

Pict. 8

**\*Warning:** When you place the magnet on the swimmer symbol, the device responds **at first** as described in §7.1 “I want to have a swim” and in §7.3 “Manual restart”. You must keep the magnet on this area to have sound validation (indicated by a loud beep) and fast flashing of the red indicator light.

## 7.6 Complete stop

In complete stop mode, all Sensor Premium™ indicator lights are off.

**When Sensor Premium™ is in complete stop mode, vigilance by a person must imperatively take over, or another safety system must be installed as an alternative.**

To turn off your device, place and keep one of the magnets on the swimmer symbol until the sound validation (loud beep) is heard, and until the red indicator light flashes quickly, **then** move the 2<sup>nd</sup> magnet over the red Stop symbol (Pict. 9). The red indicator light remains on during the confirmation sound signal (15 short beeps).

**\*Warning:** When you place the magnet on the swimmer symbol, the device responds **at first** as described in §7.1 “I want to have a swim” and in §7.3 “Manual restart”. You must keep the magnet on this area to have sound validation (indicated by a loud beep) and fast flashing of the red indicator light.

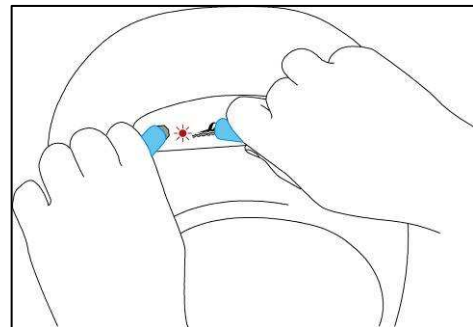

Pict. 9

- To reactivate Sensor premium™:
  - Move the magnet over the swimmer symbol.
  - You will hear 5 short, high-pitched beeps + flashing red indicator light.
  - Wait for the automatic restart (flashing green indicator light) or restart manually (see §7.3).

**Please make sure that Sensor Premium™ is in monitoring mode before leaving your pool.  
If such is not the case, utmost vigilance is required from the parent/responsible adult.**

## 7.7 Replacing the batteries

Sensor Premium™ gives a low-battery alert by:

- 1 short, low-pitched beep every minute,
- 4 short, low-pitched beeps every time the magnet is moved over the swimmer symbol.

In this case, the 4 D alkaline batteries must be replaced with new batteries of the same type. The use-by dates are given on the alkaline batteries. Be responsible, and take the old batteries back to your retailer instead of throwing them away.

We advise you to change the batteries at the start of the season.

When replacing the batteries, please follow the indications below:

First, switch Sensor Premium™ to OFF mode (see §7.6 above).

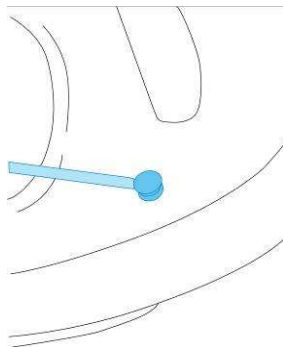

Carefully remove the 4 caps using a flat screwdriver.

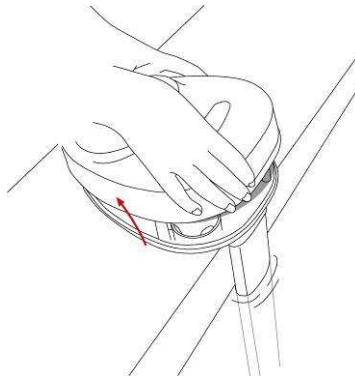

Unscrew the 4 screws and remove the cover.

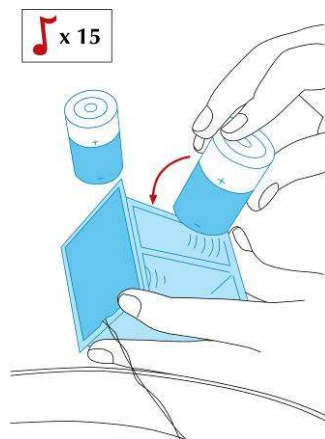

Remove the used batteries and insert the new batteries in the appropriate housing, making sure the polarity is respected.

You will hear a validation sound signal (15 short, high-pitched beeps). Sensor Premium™ is in OFF mode.

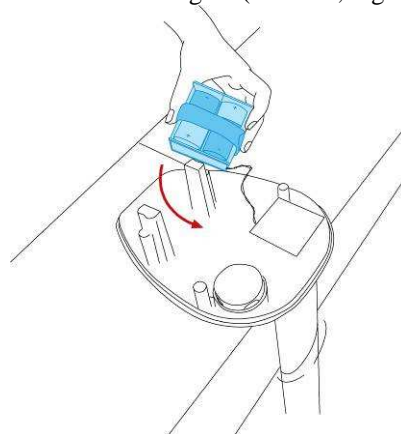

Put back the batteries holder in the appropriate housing

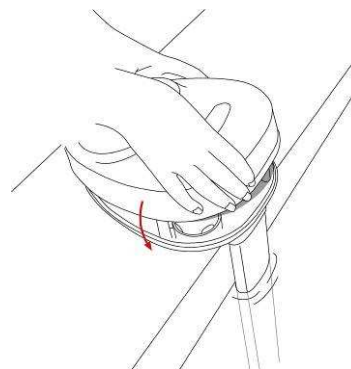

Put the cover back in place and screw the 4 screws as tightly as possible (do not use an electric screwdriver) and put the 4 protective caps in place

**Perform fall tests to make sure that your fall detector is working properly.**

## **7.8 I have a problem with my fall detector**

### **7.8.1 Two regular beeps are heard**

Sensor Premium™ indicates that there is an operating problem by emitting 2 short, low-pitched beeps every minute.

In this case, Sensor Premium™ has to be sent back to the After-Sales Service.

Send your device back, with a copy of your purchase invoice, and giving your details, to the address below:

**Sensor Premium™ Customer Care**  
**P.O. Box 3839**  
**Cary, North Carolina 27519-3839**

### **7.8.2 I cannot find the cause of my problem**

Your device does not emit the 2 beeps as described above, and you cannot understand where the problem comes from.

In this case, please contact by phone, e-mail or mail the MG International After-Sales Service:

- E-mail: [usa@sensor-premium.com](mailto:usa@sensor-premium.com)
- Address:

Sensor Premium™ Customer Care  
P.O. Box 3839  
Cary, North Carolina 27519-3839  
[usa@sensor-premium.com](mailto:usa@sensor-premium.com)

Please provide a clear description of the problem encountered, so that your device can be processed quickly. Please also provide our technicians with your details and a sketch of your pool, including its dimensions (length, width, depth, recess if any) as well as the location of the return fittings, vacuum fittings, skimmer, and any other piece of equipment which might create disturbances, such as, for instance, a swim jet. Show the location of the fall detector on the edge of your pool.

These informations will help our technicians to better understand the problem with your device, and to quickly find a solution.

## 8 Frequently asked questions

---

### During the installation

QI1. During the test phase with filtering and robot cleaner, the siren goes off accidentally, or your fall detector switches from ARMED mode (green light flashing) to DISARMED mode (red light flashing)?

RI1.1. Make sure that your fall detector is not within three feet of the filtration system (return fittings, waste plug, skimmer, vacuum fittings, etc.) or waterfall or any other device that may disturb the pool at this place.

RI1.2. Check the immersion depth of your fall detector probe. Rectify it if required. See §5.3.

RI1.3. Perform the installation and validation tests under favorable weather conditions (no wind).

RI1.4. Your fall detector is not suited to your type of pool. Ask your retailer or the after-sales service for advice: [usa@sensor-premium.com](mailto:usa@sensor-premium.com)

RI1.5. Your robot cleaner is not compatible with your fall detector. It causes an event similar or identical to the fall of a child. Contact your retailer for advice.

RI1.6. If none of these conditions seems to you to be the cause of the malfunction, ask your retailer for advice or contact our technical support: [usa@sensor-premium.com](mailto:usa@sensor-premium.com)

QI2. When the 18 lb (8 kg) weight is dropped during the test phase, your fall detector takes longer than 20 seconds to set off the siren, or does not set it off at all?

RI2.1. The dimensions of your pool are greater than 20 x 40 feet, or your pool is of a very particular shape. A single fall detector is not sufficient. Contact your retailer for advice.

RI2.2. Your fall detector is not positioned at the recommended location. The fall occurs beyond its 28 feet detection range. Position it at the recommended location. See §5.3.

RI1.3. If none of these conditions seems to you to be the cause of the malfunction, ask your retailer for advice or contact our technical support: [usa@sensor-premium.com](mailto:usa@sensor-premium.com)

### During use

QU1. The siren goes off accidentally.

RU1.1. Check the immersion depth of your fall detector. Rectify it if required. See §5.3.

RU1.2. The weather conditions are too unfavorable (strong wind, storm...) and affect the operation of your device.

RU1.3. Your robot cleaner is not compatible with your fall detector. It causes an event similar or identical to the fall of a child. Contact your retailer for advice.

RU1.4. If none of these conditions seems to you to be the cause of the malfunction, ask your retailer for advice or contact our technical support: [usa@sensor-premium.com](mailto:usa@sensor-premium.com)

QU2. Your fall detector does not go off during the monthly tests.

RU2.1. Check the condition of your batteries. Please refer to §7.7.

RU2.2. Check the immersion depth of your fall detector. Rectify it if required. See §5.3.

RU2.3. The weather conditions are too unfavorable (strong wind, storm,...) and affect the operation of your device.

RU2.4. Your fall detector emits 2 short, low-pitched beeps every minute: send your device back to the MG International After-Sales Service.

RU2.5. If none of these conditions seems to you to be the cause of the malfunction, ask your retailer for advice or contact our technical support: [usa@sensor-premium.com](mailto:usa@sensor-premium.com)

## 9 Further information

### SAFETY ADVICE RELATED TO THE ALARM

This alarm system is not a replacement for common sense or individual responsibility. Its purpose is not to be a replacement for vigilance by a parent or responsible adult, which remains the vital factor in protecting children under the age of 5.



### WARNING

Improper installation, testing, maintenance or operation of this product can make the alarm fail to sound, increasing the risk of drowning. Follow all instructions in this document to reduce this risk.

### IMPORTANT SAFETY INFORMATION ABOUT YOUR POOL ALARM

Even when correctly installed, maintained, tested, and operated, this alarm cannot completely prevent drowning:



- **In some situations, the alarm will not sound when a child enters the pool.**
  - If a child enters the pool slowly or gradually, without disturbing the water much, the alarm may not detect it.
  - The alarm may not detect very small children (under 18 lbs) entering the pool.
  - When weather (e.g., wind) or other factors disturb the water, the alarm automatically reduces sensitivity or becomes **DISARMED**, to prevent excessive false alarms. When this happens, a child may enter the pool without the alarm sounding.
  - When the alarm is **DISARMED** to allow swimming, it will not sound if a child enters the pool or if a child is drowning.
  - After swimming with the alarm in **DISARMED** mode, the alarm will not sound if a child enters the water until the device **switches back to ARMED mode**. Depending on how disturbed the water is from swimming, this may take more than 10 minutes (depending on weather conditions) .
  - If the water level is too high or too low, the alarm will not function properly. The probe must be immersed at 8,5 in (+ / - 1 inches).
  - The alarm will not operate if the water in the probe is frozen or the surface of the pool is frozen.
  - If the alarm is in off mode, the alarm will not sound.
  - If the alarm is in “low-volume siren” mode, the alarm sound will be quieter than usual and may not be heard.
  - When a bubble pool cover is used at the same time.
- **The alarm does not rescue children from the water.** When the alarm sounds, a rescuer must respond immediately – a child rescued in less than 1 minute has a good chance of survival, but the odds of surviving rapidly decline the longer the child is immersed. To increase the chance of rescuing a child who enters the pool, a responsible adult capable of rescuing a child must be present, able to hear the alarm, and ready to respond immediately. Even an immediate response when the alarm sounds does not guarantee survival; the only sure way to prevent drowning is to keep children out of the pool.
- **The alarm does not prevent children from entering the pool.** Use adult supervision and barriers, such as fences, enclosures, or pool covers, to keep children from entering the pool.
- **This device is not intended to replace any other safety consideration:** that is, adult supervision, lifeguards, fences, gates, pool covers, locks, and so forth, and some devices may not detect gradual entry. This device may not detect children entering the water gradually.
- **Check local requirements to determine the safety measures that are required in your jurisdiction.** Consider using multiple layers of protection, in addition to adult supervision and this pool alarm, to keep children away from the pool or alert adults to their presence. For more information, contact the Association of Pool and Spa Professionals ([www.TheAPSP.org](http://www.TheAPSP.org)).



- **This alarm does not replace responsible adult supervision.**
- **Whenever children are in an area where they have access to the pool:**
  - Assign an adult to be in charge of watching the children. This person must stay close to the children and actively look at what the children are doing at all times. Make sure that the adult knows it is his/her job, and that if he/she leave, he/she must tell another adult to take over.
  - Make sure the adult in charge of watching the children is able to swim so he/she can rescue a child from the pool, and is able to call for emergency assistance. The adult should understand how the alarm works and know not to rely on the alarm in place of actively watching the children.
  - If there are many children near the pool, it may be necessary to assign multiple adults to watch them.
  - When the alarm is DISARMED to allow swimming, it will not sound if a child enters the pool or if a child is drowning, so adult supervision is particularly important.
- **When children are not in an area where they have access to the pool:**
  - Make sure that adults understand that they must keep children away from the pool, even with the alarm in place.
  - Make sure any adult who uses the pool understands how to operate the alarm, and that they must monitor the pool after swimming until the alarm returns to ARMED mode.

#### **GENERAL SWIMMING POOL SAFETY TIPS**

- Teach children to swim as early as possible. Do not allow a child who does not swim well to enter the pool unaccompanied. Consider putting Personal Flotation Devices (PFDs) on children who do not swim well.
- Learn first aid and CPR.
- Prohibit diving and jumping when small children are in the water nearby. Prohibit running and playing around the pool.
- Don't leave pool toys and floats in the pool or pool area that may attract young children to the water.
- Always keep the pool water clear and clean.
- Keep a telephone and list of emergency numbers accessible near the pool so you can call for help in an emergency, and so you can answer the phone without leaving children unattended.
- Keep rescue equipment, including a life ring and shepherd's hook, near the pool.
- Wet the back of the neck, arms and legs before entering cold water in order to accustom the skin to the water temperature and reduce the risk of a "cold shock" response.

#### **How to rescue a child from the pool**

1. Rescue the children first and yell for help. Call for emergency services and begin CPR for one minute.
2. Extend a long object, such as a pole, shepherd's hook or towel, and pull in the child, or throw the child a floating object.
3. If the child is not responsive, grab a float and jump into the water. Turn the child face up, bring him or her to shallow water or pool steps, and lift the child up onto dry ground.
4. Roll the child onto his or her back while supporting the head and neck. Begin CPR if you are trained. If you are not trained in CPR, follow the instructions from the emergency personnel.
5. Replace wet clothes with warm blankets.

## 10 Warranty and after sales service

### WARRANTY

MG International warrants this (Sensor Premium™) product (the “Product”) against any defects in materials and workmanship and shall provide warranty services and/or replacements during the periods stipulated below, beginning from the date of first purchase:

- Alarm system & siren – two (2) years parts and labor; and
- Any consumables (e.g. batteries, dehydrating sachets, magnets, etc.) included in the original Product – ninety (90) days free replacement.

In addition to the warranty exclusions noted below, this warranty does not apply to normal discoloration, fading, or minor deteriorations of exterior surfaces resulting from exposure to the elements, except to the extent that the Product’s intended performance is affected thereby.

Replacement or repair of any defective part or Product will not extend the applicable warranty period.

If any fault or defect with the Product arises, the following steps must be taken:

- (i) Notify MG International of the Product model number, serial number and details of the defect. On receipt of this information, MG International will provide service data or shipping instructions for defects that meet the warranty criteria; and
- (ii) If the Product is not covered by warranty, an estimate of charges will be furnished by MG International before any repairs are made.

MG International’s sole liability for any defective Product is limited solely to MG International repairing or replacing any Product or part thereof pursuant to this warranty. MG International reserves the right to replace any repairable parts with new or refurbished parts. In no event shall MG International be held responsible for any other costs, charges, expenses, losses or damages (direct, indirect, incidental, special, exemplary, consequential, or otherwise), of any kind whatsoever arising out of a defective Product.

**DURING ANY PERIOD IN WHICH THE PRODUCT IS DISABLED, WHETHER DUE TO DEFECT OR OTHERWISE, THE PURCHASER IS ADVISED TO INCREASE ACTIVE PERSONAL MONITORING AND SUPERVISION OF THE POOL AREA.**

### WARRANTY EXCLUSIONS

The warranty does not apply to any Product (i) that is not installed in compliance with the applicable Product documentation; (ii) for which the user does not successfully perform any installation tests, and subsequently conduct regular maintenance and tests, as required in the applicable Product documentation; or (iii) on which the original identification marks have been removed or modified or the warranty sticker (inside the Product) is damaged. Further, this warranty does not apply to, and MG International shall not be liable for: (i) any defect in, or failure of, the Product resulting from an accident, shock, negligence or misuse; (ii) any defect in, or failure of, the electrical supply to the Product; (iii) damage or defect due to lightning or other Acts of God; (iv) any defect of, or caused by, parts not supplied by MG International; (v) degraded or corroded components due to prolonged immersion of the Product in water other than as specified in the applicable Product documentation; (vi) modification, adjustment, repair, disassembly or maintenance performed by any party other than MG International or its approved subcontractors and retailers; or (vii) due to any other cause which does not result from a defect in materials and workmanship.

### WARRANTY DISCLAIMERS

EXCEPT FOR THE WARRANTIES SET FORTH ABOVE, MG INTERNATIONAL HEREBY DISCLAIMS ANY AND ALL REPRESENTATIONS AND WARRANTIES OF ANY KIND, EXPRESSED OR IMPLIED, WHETHER ARISING FROM A COURSE OF DEALING OR USAGE OF TRADE, INCLUDING, WITHOUT LIMITATION, THE IMPLIED WARRANTIES OF MERCHANTABILITY, FITNESS FOR A PARTICULAR PURPOSE AND NON-INFRINGEMENT.

THE PRODUCT IS NOT A REPLACEMENT FOR COMMON SENSE OR INDIVIDUAL RESPONSIBILITY. THE PRODUCT IS NOT INTENDED TO BE, AND IS NOT, A REPLACEMENT FOR ACTIVE PERSONAL SUPERVISION OF A POOL.

NEVER LEAVE A CHILD NEAR A POOL WITHOUT THE SUPERVISION OF A RESPONSIBLE ADULT. CHILDREN CAN DROWN QUICKLY AND SILENTLY. THE PRODUCT IS NOT A LIFE SAVING DEVICE AND IS MERELY AN AID TO A COMPREHENSIVE PROGRAM OF POOL SAFETY

INCLUDING ADULT SUPERVISION. THE PRODUCT IS INTENDED FOR USE ON RESIDENTIAL SWIMMING POOLS ONLY AND MG INTERNATIONAL ASSUMES NO RESPONSIBILITY FOR INJURIES (INCLUDING DEATH) OR PROPERTY DAMAGES ARISING OUT OF THE USE OF THE PRODUCT, OR INABILITY TO USE THE PRODUCT, OPERATION OR MAINTENANCE OF THE PRODUCT.

This warranty is not transferable, and shall be null and void in the event of any transfer of ownership of the Product.

## 11 Monthly tests

In order to check the proper operation of your Swim Alert™, it is essential that verification tests be carried out on a monthly basis (see §5.4) and that the results be recorded in the form below.

**In the event of malfunction, inform your retailer immediately and take the necessary measures to prevent access to your pool, and monitor it.**

Retailer contact details .....  
 Serial number of device .....  
 Date of purchase: .....

- |   |   |
|---|---|
| 1. tests performed on:.....<br>successful <input type="checkbox"/> - not successful <input type="checkbox"/>  | 2. tests performed on:.....<br>successful <input type="checkbox"/> - not successful <input type="checkbox"/>  |
| 3. tests performed on:.....<br>successful <input type="checkbox"/> - not successful <input type="checkbox"/>  | 4. tests performed on:.....<br>successful <input type="checkbox"/> - not successful <input type="checkbox"/>  |
| 5. tests performed on:.....<br>successful <input type="checkbox"/> - not successful <input type="checkbox"/>  | 6. tests performed on:.....<br>successful <input type="checkbox"/> - not successful <input type="checkbox"/>  |
| 7. tests performed on:.....<br>successful <input type="checkbox"/> - not successful <input type="checkbox"/>  | 8. tests performed on:.....<br>successful <input type="checkbox"/> - not successful <input type="checkbox"/>  |
| 9. tests performed on:.....<br>successful <input type="checkbox"/> - not successful <input type="checkbox"/>  | 10. tests performed on:.....<br>successful <input type="checkbox"/> - not successful <input type="checkbox"/> |
| 11. tests performed on:.....<br>successful <input type="checkbox"/> - not successful <input type="checkbox"/> | 12. tests performed on:.....<br>successful <input type="checkbox"/> - not successful <input type="checkbox"/> |
| 13. tests performed on:.....<br>successful <input type="checkbox"/> - not successful <input type="checkbox"/> | 14. tests performed on:.....<br>successful <input type="checkbox"/> - not successful <input type="checkbox"/> |
| 15. tests performed on:.....<br>successful <input type="checkbox"/> - not successful <input type="checkbox"/> | 16. tests performed on:.....<br>successful <input type="checkbox"/> - not successful <input type="checkbox"/> |
| 17. tests performed on:.....<br>successful <input type="checkbox"/> - not successful <input type="checkbox"/> | 18. tests performed on:.....<br>successful <input type="checkbox"/> - not successful <input type="checkbox"/> |
| 19. tests performed on:.....<br>successful <input type="checkbox"/> - not successful <input type="checkbox"/> | 20. tests performed on:.....<br>successful <input type="checkbox"/> - not successful <input type="checkbox"/> |
| 21. tests performed on:.....<br>successful <input type="checkbox"/> - not successful <input type="checkbox"/> | 22. tests performed on:.....<br>successful <input type="checkbox"/> - not successful <input type="checkbox"/> |
| 23. tests performed on:.....<br>successful <input type="checkbox"/> - not successful <input type="checkbox"/> | 24. tests performed on:.....<br>successful <input type="checkbox"/> - not successful <input type="checkbox"/> |

**Product references:**  
**Sensor Premium™ (PRE007-US)**

**Manufacturer / distributor:**  
 MG International - Z.I. Athélia II 13600 La Ciotat - France  
 Tel.: +33 891 025 026 (0.22€/min) - infoconso@aquasensor.com  
 Company ID: 441 743 002 – VAT No.: FR 80 441 743 002