

# Operation Instructions

---

## (A) Headset Overview

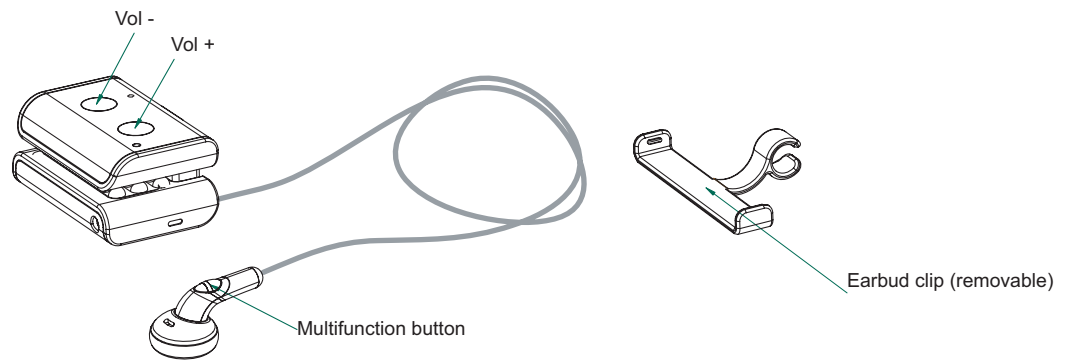

## (B) Turning the Headset On/Off

To switch the headset on:

Press the Multifunction button for about 5 seconds until the LED indicator flashes BLUE.

Before use, the headset needs to be 'paired' with a Bluetooth enabled mobile phone (see 'C' below). After pairing, the headset will automatically link to the mobile phone on power up – the pairing process does not need to be repeated unless the headset is used with a different mobile phone.

To switch the headset off:

Press the Multifunction button for about 5 seconds, the LED indicator blinks RED a few times, then turns OFF.

## (C) Pairing the Headset

1. Make sure the headset is OFF.
2. Make sure the mobile phone is switched ON.
3. Press the Multifunction button for about 10 seconds until the LED flashes RED and BLUE alternatively. The headset is now ready for pairing with the mobile phone.
4. Enable the device discovery feature on the mobile phone. Note: Please refer to your mobile phone's instructions for how to enable the device discovery service.
5. Once the mobile phone discovers the headset, the device name "TREX-01" appears on the phone's screen.
6. Follow the phone instructions to accept the pairing. Enter "0000" when you are prompted to enter a passkey.
7. The pairing process will time-out if the above procedure cannot be completed before the LED turns off (about 2 minutes). In this case, you will need to repeat the procedure again. The status should be indicated on your phone's screen.
8. The phone will indicate once the pairing is successfully completed. The LED indicator will then flash BLUE at a 3 second interval – this indicates that the headset is in standby mode.
9. You can now make and answer calls through the headset.

## (D) Accepting a Call

When an incoming call comes, the headset rings and the LED indicator flashes green. To accept the call from the headset, press the Multifunction button once. Note: If you do not wish to use the headset to answer a call you can answer the call using your phone in the usual way.

Please note that you need to wait until the ring tone is present from the headset before pressing the Multifunction button to answer a call.

## (E) Ending a Call

To end a call, press the Multi-function button once or press the phone's END key. The headset then returns to standby mode.

## (F) Making a Call

To make a call, use the keypad of your mobile phone as usual.

## (G) Volume Control

During a call, you can adjust the headset speaker volume. A beep can be heard for each volume up or down step. To increase/decrease the volume, press the Volume + / - button until the desired level is reached.

## (H) Charging the Headset

When the headset battery level is low, the LED will flash RED and you will hear a warning tone every few seconds. Plug the power adapter into an electrical outlet.

When the headset is fully charged, the LED indicator will turn off. Charging will take approximately 1.5 hours.

## (I) Auto-Off Feature

If the headset loses connectivity with your mobile phone for a period of 10 minutes, the headset will automatically turn itself off to save power. If this happens, simply turn the headset back on.

---

## Federal Communications Commission (FCC) Statement

15.21

You are cautioned that changes or modifications not expressly approved by the part responsible for compliance could void the user's authority to operate the equipment.

15.105(b)

This equipment has been tested and found to comply with the limits for a Class B digital device, pursuant to part 15 of the FCC rules. These limits are designed to provide reasonable protection against harmful interference in a residential installation. This equipment generates, uses and can radiate radio frequency energy and, if not installed and used in accordance with the instructions, may cause harmful interference to radio communications. However, there is no guarantee that interference will not occur in a particular installation. If this equipment does cause harmful interference to radio or television reception, which can be determined by turning the equipment off and on, the user is encouraged to try to correct the interference by one or more of the following measures:

- Reorient or relocate the receiving antenna.
- Increase the separation between the equipment and receiver.
- Connect the equipment into an outlet on a circuit different from that to which the receiver is connected.
- Consult the dealer or an experienced radio/TV technician for help.

Operation is subject to the following two conditions:

- 1) this device may not cause interference and
- 2) this device must accept any interference, including interference that may cause undesired operation of the device.

FCC RF Radiation Exposure Statement:

This equipment complies with FCC radiation exposure limits set forth for an uncontrolled environment. End users must follow the specific operating instructions for satisfying RF exposure compliance. This transmitter must not be co-located or operating in conjunction with any other antenna or transmitter.