

'SEE SAW' Portable active woofer Bluetooth speakers (for smart phones; with NFC pairing function)

Product Features

- 2+1 speakers 20W total hi power with active sub-woofer!
- 'SEE SAW' on/off hidden facet switch design
- *Bluetooth® v3.0 wireless connection up to 10M
- NFC™ pairing function
- Superb sound portable stereo speakers
- Super bass enhancer module built-in
- Built-in battery rechargeable
- AC-DC charger adaptor included (per different country version)
- Speaker phone call-pick function
- Portable chic style design
- AUX 3.5mm audio input
- Ideal audio mate for smart phones or other multimedia player devices

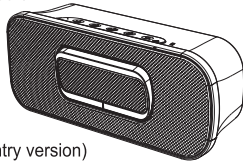

These portable stereo speakers are compliant with Bluetooth v3.0 wireless standard, and powered by its built-in battery which is rechargeable by supplied AC-DC charger adaptor. The 2+1 powerful drivers system with active sub-woofer, plus the super bass enhancer built-in module, produce superb powerful sound even to satisfy 'smart phone audiophiles'. The simplicity-look casing is a stylistic desktop design which can be portable as well. This is an ideal wireless audio companion for smart phone users.

Charging the speaker

Open the rubber cover of the back panel on the speaker. Turn on the travel lock slide switch from to position. Connect the provided AC-DC charger adaptor's DC plug to the DC jack on the speakers' back panel. Red LED on the top panel next to will light up to indicate charging (fig.1). When the speaker is fully charged (approx. in 3.5 hrs every recharging), LED will turn into blue.

Caution: Use ONLY the provided AC-DC charger adaptor which was custom made to match this speaker.

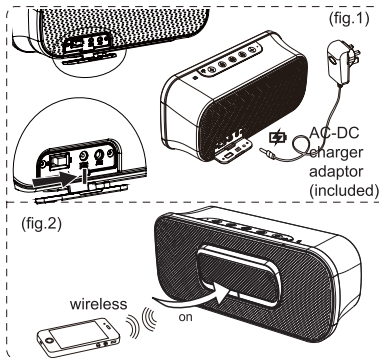

NFC™ Pairing with your phone

Turn on the travel lock slide switch at the back panel from to position; and push the main body 'see saw' button to ON position (fig.2) to switch on the speaker, and then if your smart phone is NFC enabled,

- Firstly, locate the NFC antenna spot on your smart phone (fig.3)
- NFC antenna is now on the top of our BT-88N speakers (fig.3)
- Align NFC antennas as close as possible, you will hear a 'cling' sound when they matched (fig.4)
- Wait for a few second and you will hear a "Bloop" sound from the speaker and its blue LED will lit continuously. The pairing is completed now.

Note-

1. "The N-Mark is a trademark or registered trademark of NFC Forum, Inc. in the United States and in other countries."
2. Some phone models are NFC enabled, but their NFC Apps were not built-in. For these models you will need to install a NFC Apps and activate the NFC function on your phone— Please visit our website to download the driver installer : <http://www.manova.com.hk/download.php>

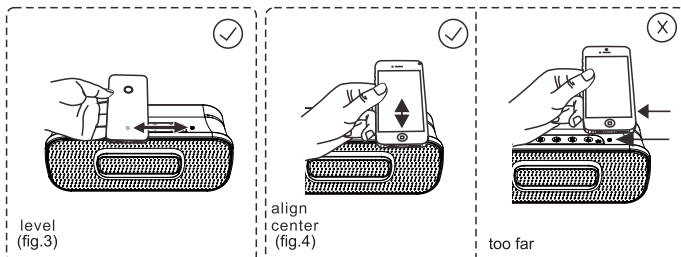

Pairing the speaker (manually)- if your phone is NOT NFC enabled

a.) Turn on the travel lock slide switch at the back panel from to position; and push the main body 'see saw' button to ON position (fig.2) to switch on the speaker, and then, power is auto ON within 3 sec. and LED indicates blue on front. For first time use, the blue LED will be flashing fast (8 times every sec.) to show it is ready for pairing. Browse your smart phone Bluetooth device list found, and select the one named 'SEE SAW' to confirm pairing on your smart phone. You will hear a beep tone on the speakers which is

sent from your phone, and then the speakers' blue LED flashes steadily (1.5 times every sec.). Pairing connection is successful then.

b.) When you need to disconnect the speaker, you first switch off Bluetooth function on your smart phone, the speakers' blue LED will flash slowly (1 time every sec.) Then you switch OFF (press 'see saw' button to OFF) the speakers, the pairing memory will be then kept there.

Next time when you press 'see saw' button ON the speakers, it will automatically connect to your smart phone again and blue LED lit continuously (when your smart phone's Bluetooth function is also ON and nearby <5M).

c) If you need to pair the speakers with a new smart phone, switch off Bluetooth function on your old smart phone first. Then power on your new smart phone's Bluetooth function. After that switch off and re-open to power on the speakers (or press and hold [play/call] button for 3 sec.) until the speakers' blue LED will be flashing fast again (8 times every sec.), and then you repeat steps as in above paragraph a.).

Call-pick function

When speakers is connected to your smart phone (blue LED lit continuously), whenever there is an incoming call ring, you can press [play/call] button once on the speakers to pick up and use it as speaker phone. (press and hold [play/call] 2 sec. will switch the call to your smart phone)

How to Use / Controls

Adjust volume: during music playback or call, press to increase speaker volume, or to reduce speaker volume. You can press once or multiple times, or press and hold until adjust volume to desire level.

During music playback, press [next] will forward to play next track; press [prev] will backward to previous track. Press [play] once will pause playback, press again to resume play.

If battery power becomes low, there will be some beeping alert sound during playback, and LED flashes RED and BLUE quickly (8 times every sec., Red light interval every 4 sec.). Then charge the speakers as mentioned in above section. (You can play music at the same time while charging the built-in battery...)

You can use the AUX 3.5mm audio cable connection to smart phones or other player devices for music playback (fig.5).

Whenever you plug in the AUX port, the Bluetooth connection will be powered off. You can still press to increase speaker volume, or to reduce speaker volume for convenient operation.

(You will need to operate the smart phone to resume music playback when you disconnect the AUX cable and use it wireless again)

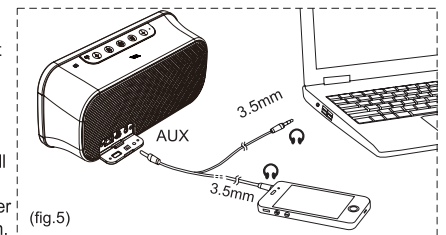

Specifications:

dimensions:	W 215 x D 67 x H 90 mm
product weight:	1025g
Bluetooth wireless connection :	v3.0 +EDR; class II; typ. 8M visible distance; max. 10M
support multiple pairing:	up to 4 devices**
drivers:	2x dia. 40mm mid/high ranges + 1x dia. 67mm sub-woofer
frequency response (0dB at 1KHz):	100 Hz ~ 20,000 Hz
amplifier output :	2x 2.2W (THD=10%, 1KHz@0dB)
amplifier max. output :	20W (THD=10%, 1KHz@0dB)
signal to noise ratio:	>100dB
(amplifier level, A weighted, f=1KHz max. power at THD < 1%)	
operation voltage	min. 6.4V; max. 8.4V DC
built-in 3.7V Li-ion rechargeable batteries	
battery charging voltage	typ. 9V; max. 9V DC (supplied AC-DC adaptor only)
battery charging current	1000mA max.
battery charging time	3.5 hours.
drain current (power on, no input)	120mA
playback time	up to 10 hours (fully charged, volume at 1/3 level)
standby time	up to 18 hours

*The Bluetooth® word mark and logos are registered trademarks owned by Bluetooth SIG, Inc. and any use of such marks by Manova International Limited is under license. Other trademarks and trade names are those of their respective owners.

**Design and specifications are subject to change per technical needs, without prior notice

**This speaker supports pairing 'records' up to 4 devices, but NOT 'connection' to 4 devices at the same time

FCC WARNING

This device complies with Part 15 of the FCC Rules. Operation is subject to the following two conditions:

- (1) This device may not cause harmful interference, and
- (2) this device must accept any interference received, including interference that may cause undesired operation.

NOTE 1: Any changes or modifications to this unit not expressly approved by the party responsible for compliance could void the user's authority to operate the equipment.