

'TwinS' Bluetooth Stereo Wireless™ Earphone Pair set

- [1] function button (L & R sides)
- [2] Bluetooth LED (L & R sides)
- [3] built-in microphone
- [4] charge LED
- [5] micro USB recharge port
- [6] recharge cord
- [7] portable case (2-to-1 recharge port)

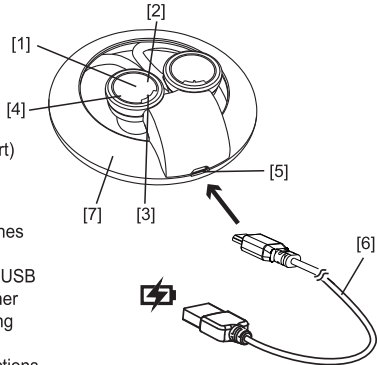

Product Features

- TWS StereoWireless™ Earphones
- auto-pairing Left & Right
- 2-in-1 portable case with micro USB ports - charge 2 earbuds together
- comfort earbuds for long wearing
- secure wearing ear-hangers
- IPX-4 splash proof for sporty actions
- stereo quality music
- handsfree call pick / end
- Bluetooth v4.2 wireless

Put earbuds back to case

- i) lift up rubber covers on earbuds,
- ii) turn earbuds align the mark,
- iii) point earbuds to the mark on case,
- iv) align and insert micro USB ports to plugs,
- v) snap ear-hangers in place in case, done

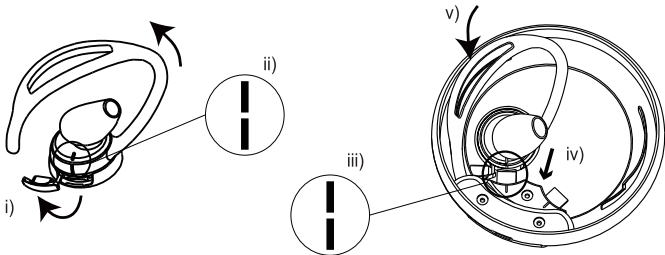

Charging the earbuds

- a) plug recharge cord to the port on the case;
  - b) plug the other end to a USB power source;
  - c) RED LED lights up > charging;
  - d) till fully charged (approx. <=1 hr) > RED LEDs turn off > BLUE LEDs ON
- \* during charging, cannot operate earbuds

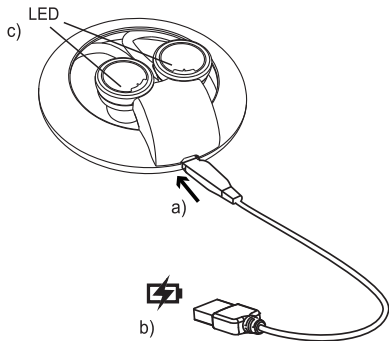

Take out earbuds

- I. hold earbud body and pull out,
- II. lift ear hangers out from the case,

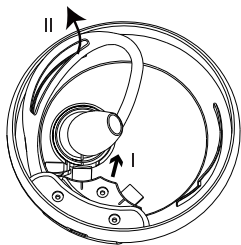

Wearing

- 01) earbud tips are free size for all,
- 02) lay open ear-hangers above ears,
- 03) turn hanger tip ends and slide in behind ears,
- 04) turn bodies pointing tips to ear holes > better hearing and comforts,

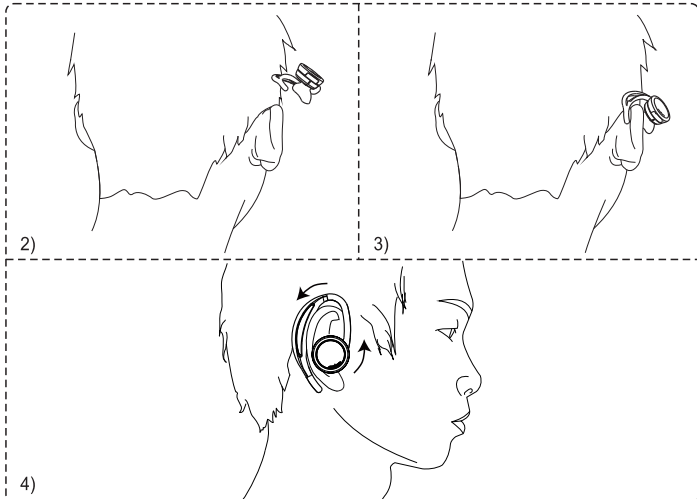

Taking off

- 05) the other way around above steps 04 > 03 > 02, take off earbuds
- 06) Put earbuds back to case as above i) > v)

Pairing 1st time (also pair L & R earbuds)

- a) Press & hold BOTH earbuds — 8s > ON, until hear 'dodooo...' AND 'pairing';
- b) (now BOTH earbud LEDs flashing Red and Blue);
- c) ●● Double click ONE earbud as Main;
- d) hear 'searching for slave' > 'pairing success' > 'set connected' > 'pairing';
- e) (now Main earbud LED flashing Red and Blue);
- f) phone Bluetooth ON, search and select (TwinS);
- g) hear 'pairing success' > 'set connected';
- h) now pairing & connection to your phone is successful! (both earbuds' Blue LED slowly blinks)

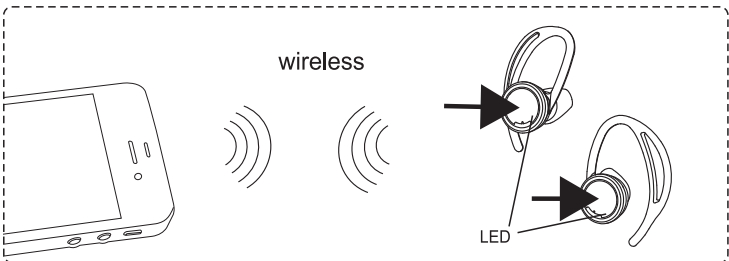

Power Off

- i) Press & hold Either earbud — 5s > Off, until 'power off...' 'power off';
- j) (now BOTH earbud LEDs flash Red then off).

Pairing Again (L & R earbuds paired)

- k) Press & hold BOTH earbuds — 3s > ON, until hear 'dodooo...';
- l) hear 'set connected' > 'pairing';
- m) (now Main earbud LED flashing Red and Blue);
- n) phone Bluetooth ON, search and select (TwinS);
- o) hear 'set connected';
- p) now pairing & connection to your phone is successful! (both earbuds' Blue LED slowly blinks)

Re-connect Phone

- q) (previous phone Bluetooth ON, before turn on earbuds)
  - r) Press & hold BOTH earbuds — 3s > ON, until hear 'dodooo...';
  - s) hear ...> 'set connected';
  - t) now pairing & connection to your phone is successful! (both earbuds' Blue LED slowly blinks)
- \*\*If you just use one earbud at a time, same steps as above BUT just with one earbud\*\*

Play / Pause music

- click EITHER earbud ● = play (from player previous track position)
- click again ● = pause

Call-pick function

- during incoming call, (if playing music > stop)
- > hear 'you have an incoming call (e.g.) 67891234... you have an incoming call...'
- click Main earbud ● = call pick;
- click again ● = call end;
- OR Press & hold Main earbud — 1s = reject call directly (hear 'dududu')

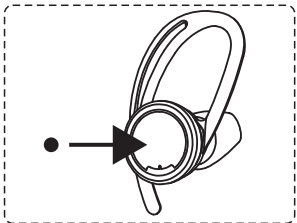

Redial

- at NO incoming call, double click Main earbud ●● = redial last no. in call out history of the phone

Others

- Adjust volume- by operating your phone.
- Reset earbuds- repeat steps as above [Pairing 1st time (also pair L & R earbuds)]

Battery low > recharge

- during music playback, > hear 'battery low, please charge...'
- repeat steps as above [Put earbuds back to case] and [Charging the earbuds]
- (if ignore, till battery further drop will be auto-off)

Specifications:

Dimensions:	W 83 x H 83 x D 27 mm (including holder case)
Product weight:	35g
Bluetooth wireless connection	v4.2; class II; typ. 8M visible distance; max. 10M
Driver:	dia. 13mm x2
Driver max. output :	3mW x2
Signal to noise ratio:	94db (Audio DAC)
Operation voltage	min. 3V; max. 4.2V DC
Built-in 3.7V Li-polymer rechargeable battery	
Battery charging voltage	typ. 5V; max. 5.5V DC (via. USB port)
Battery charging current	100mA max. (for earphones)
	500mA max. (for charger carry case)
Battery charging time	1 hour
Drain current (power on, no input)	<=1.2mA
playback/standby time	up to 3.5 hours (fully charged, volume at 1/3 level)

\*The Bluetooth® word mark and logos are registered trademarks owned by Bluetooth SIG, Inc. and any use of such marks by Manova International Limited is under license. Other trademarks and trade names are those of their respective owners.

\*Design and specifications are subject to change per technical needs, without prior notice

dd 2017/06/30

## FCC Statement

This device complies with part 15 of the FCC Rules. Operation is subject to the following two conditions: (1) This device may not cause harmful interference, and (2) this device must accept any interference received, including interference that may cause undesired operation.

Any Changes or modifications not expressly approved by the party responsible for compliance could void the user's authority to operate the equipment.

**Note:** This equipment has been tested and found to comply with the limits for a Class B digital device, pursuant to part 15 of the FCC Rules. These limits are designed to provide reasonable protection against harmful interference in a residential installation. This equipment generates uses and can radiate radio frequency energy and, if not installed and used in accordance with the instructions, may cause harmful interference to radio communications. However, there is no guarantee that interference will not occur in a particular installation. If this equipment does cause harmful interference to radio or television reception, which can be determined by turning the equipment off and on, the user is encouraged to try to correct the interference by one or more of the following measures:

- Reorient or relocate the receiving antenna.
- Increase the separation between the equipment and receiver.
- Connect the equipment into an outlet on a circuit different from that to which the receiver is connected.
- Consult the dealer or an experienced radio/TV technician for help.

The device has been evaluated to meet general RF exposure requirement. The device can be used in portable exposure condition without restriction.

-----