

Installation instructions

CARDEA



CARDEA T112 / T113



CARDEA PIN T11 / T111



CARDEA W T102 / T103



CARDEA W PIN T10 / T101

WARNINGS AND ADDITIONAL INFORMATION

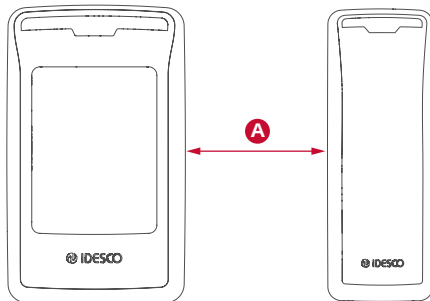

The reading distance is affected by the distance between the readers **A** and the material of the mounting surface, for example, metal reduces the reading distance.

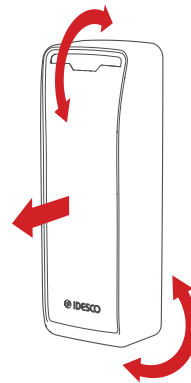

The Tamper is a feature that can be enabled by configuration.

A change in the reader's position triggers an alarm.

Note: Tamper activates at each startup and configuration. To prevent false alarms, finish installing before you configure.

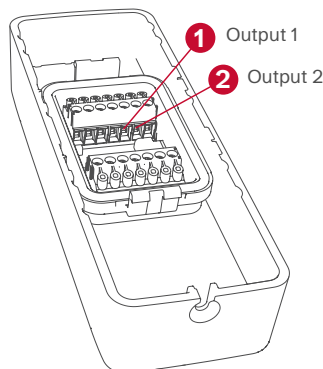

The maximum output current is 500 mA on both outputs.

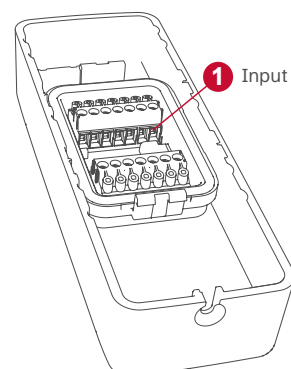

The maximum input voltage is 30 VDC.

CONTENTS OF THE READER PACKAGE:

Reader, mounting plate, connector housing cover and connectors.

Additionally, for wall mounting you will need: screws and a screwdriver.

Idesco Oy

Elektroniikkatie 4
90590 Oulu
Finland

Tel. +358 (0)20 743 4175
Email info@idesco.fi
idesco.fi

POWER SUPPLY 10...30 VDC

Power consumption: 2,5W in Idesco default configuration

PINS	CONNECTIONS	PIGTAIL CABLES
Connector 1		
Pin 1	VDC	Red ●
Pin 2	GND	Black ●
Pin 3	RS485 D+ / WIE1 / (C&D Clock)	White ○
Pin 4	RS485 D- / WIE0 / (C&D Data)	Green ●
Pin 5	Out 1	Red-Blue ●
Pin 6	Out 2	Brown-Green ●
Pin 7	In 1	White-Green ●

Connector 2		
Pin 7	Pin pad	Grey-Pink ●
Pin 6	Backlight	Violet ●
Pin 5	RS232 RxD	Grey ●
Pin 4	RS232 TxD	Pink ●
Pin 3	Red LED	Brown ●
Pin 2	Green LED	Blue ●
Pin 1	Speaker	Yellow ●

If you are using Liyy 14 x 0,14 cable, you can connect the wires according to the color coding in the diagram above.

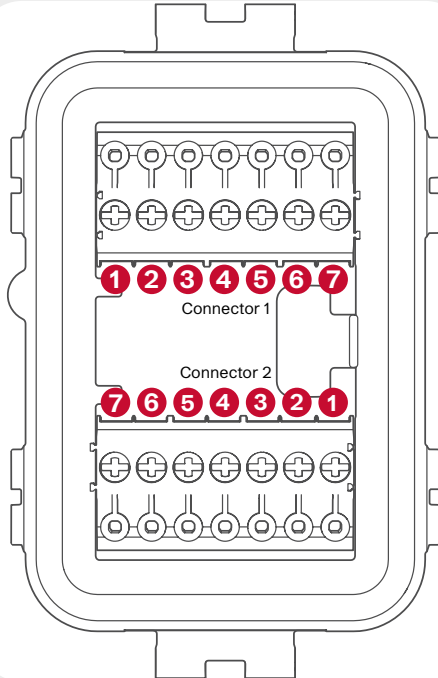

INSTALLATION

Exact dimensions of the products can be found at the end of the next page.

1 Install the mounting plate

Attach the mounting plate to the wall with screws.

Note: Do not overtighten.

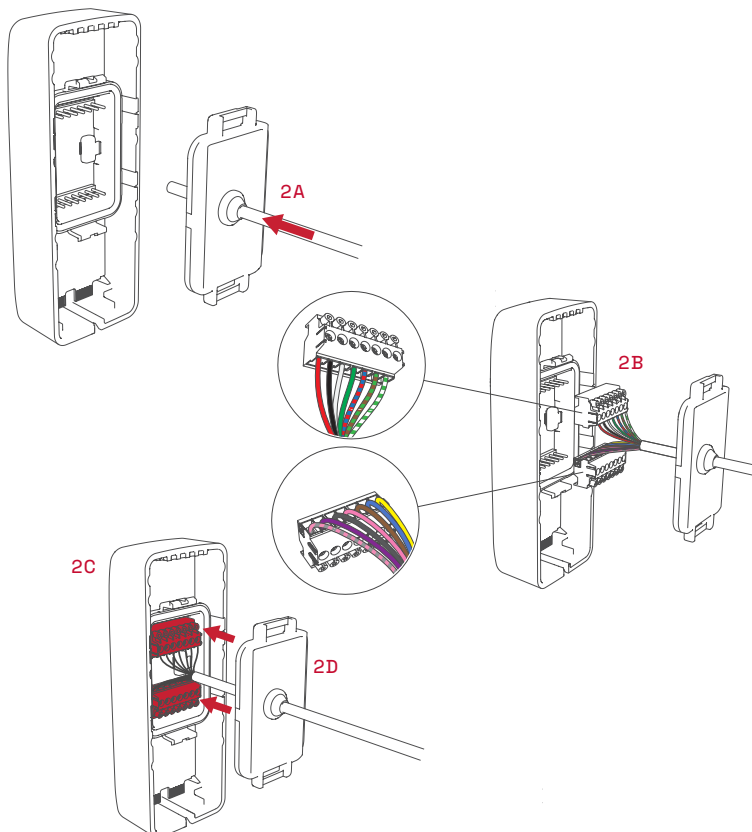
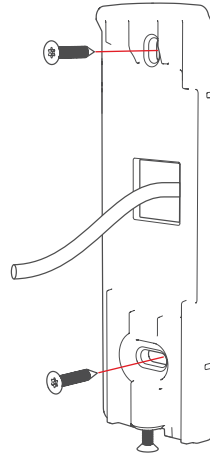

2 Wiring the reader

2A) Thread cable through the hole in the connector housing cover but do not remove the grommet.

Use a cable approximately 6mm \pm 0.5mm thick.

2B) Connect wires to connector in correct positions (follow guide on page 2).

Note: Incorrect wiring can permanently damage a reader.

2C) Install connectors to the reader.

2D) Press the connector housing cover into place.

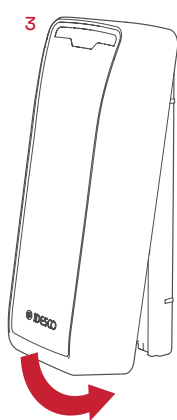

3 Attach the reader

Attaching the reader to the mounting plate with a hinge.

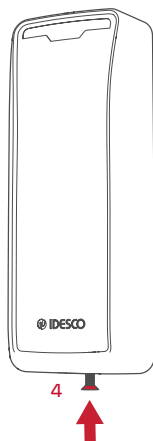

4 Tighten the security screw

Tighten the security screw from the bottom of the housing.

DIMENSIONS

Cardea

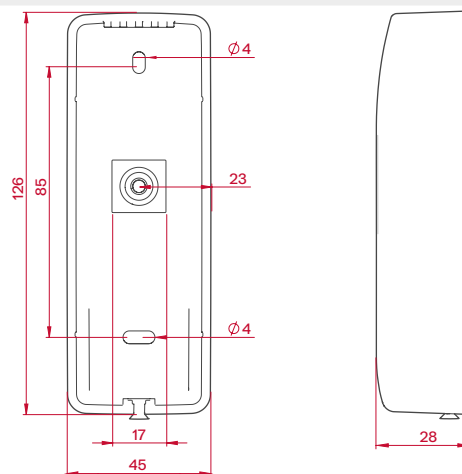

Cardea W

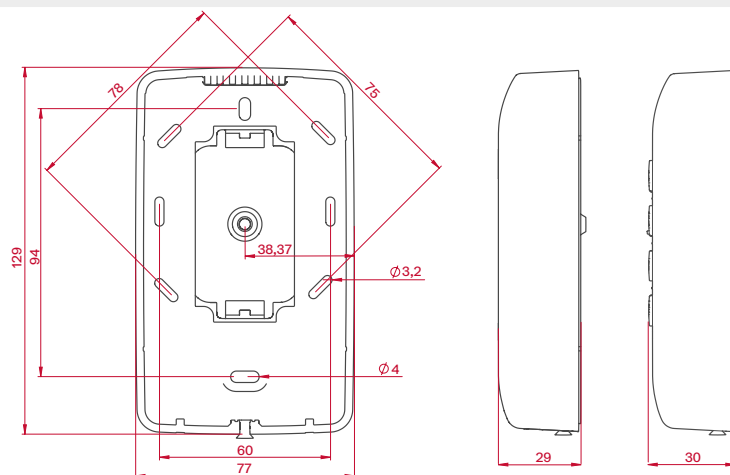

Idesco Oy

Elektroniikkatie 4
90590 Oulu
Finland

Tel. +358 (0)20 743 4175
Email info@idesco.fi
idesco.fi

REGULATORY

This reader complies with the requirements of the EMC Directive 2014/30/EU, the Low Voltage Directive 2014/35/EU, the RoHS Directive 2011/65/EU, the RED Directive 2014/53/ EU and accordingly carries the CE marking.

FCC

This device complies with part 15 of the FCC Rules. Operation is subject to the following two conditions:

1. This device may not cause harmful interference.
2. This device must accept any interference received, including interference that may cause undesired operation.

CAUTION: Any changes or modifications not expressly approved by the party responsible for compliance could void the user's authority to operate the equipment.

Note:

This equipment has been tested and found to comply with the limits for a Class B digital device, pursuant to part 15 of the FCC Rules. These limits are designed to provide reasonable protection against harmful interference in a residential installation. This equipment generates, uses and can radiate radio frequency energy and, if not installed and used in accordance with the instructions, may cause harmful interference to radio communications. However, there is no guarantee that interference will not occur in a particular installation. If this equipment does cause harmful interference to radio or television reception, which can be determined by turning the equipment off and on, the user is encouraged to try to correct the interference by one or more of the following measures:

- Reorient or relocate the receiving antenna.
- Increase the separation between the equipment and receiver.
- Connect the equipment into an outlet on a circuit different from that to which the receiver is connected.
- Consult the dealer or an experienced radio/TV technician for help.

Canada Radio Certification

This device contains licence-exempt transmitter(s)/receiver(s) that comply with Innovation, Science and Economic Development Canada's licence-exempt RSS(s). Operation is subject to the following two conditions:

1. This device may not cause interference.
2. This device must accept any interference, including interference that may cause undesired operation of the device.

Le présent appareil est conforme aux CNR d'Industrie Canada applicables aux appareils radio exempts de licence. L'exploitation est autorisée aux deux conditions suivantes:

1. L'appareil ne doit pas produire de brouillage.
2. L'utilisateur de l'appareil doit accepter tout brouillage radioélectrique subi, même si le brouillage est susceptible d'en compromettre le fonctionnement.

The minimum installation distance of the product from users is > 20 cm.

Idesco Oy reserves the right to revise this publication and to make changes to its content as well as the right to change or discontinue these products, at any time, without obligation to notify any person or entity of such revisions or changes. All trademarks and registered trademarks are property of their respective owners.
02.07.2025 C00944 v.1.00

Idesco Oy

Elektroniikkatie 4
90590 Oulu
Finland

Tel. +358 (0)20 743 4175
Email info@idesco.fi
idesco.fi

