



FL301A Series – 2K Floodlight Wi-Fi Security Camera: Installation Guide

Modified on Fri, Jun 27 at 3:07 PM

The [FL301A Series – 2K Floodlight Wi-Fi Security Camera](#) can be installed on any outdoor wall or under an eave for optimal coverage.

For additional support, check out the frequently asked questions (FAQs), the Lorex app guide, or the troubleshooting guide.

What's Included

- 2K Floodlight Wi-Fi Security Camera (with pre-installed bracket)
- Screwdriver for MicroSD Compartment
- Wall Mounting Template
- Adhesive Mounting Pad
- 3x Drywall Anchors
- 3x Mounting Screws
- 9.8 ft (3 m) Power Adapter

Installing the MicroSD Card

MicroSD Card Not Included.

1. Use the included screwdriver to remove the two screws on the MicroSD compartment, located on the bottom of the camera next to the speaker.

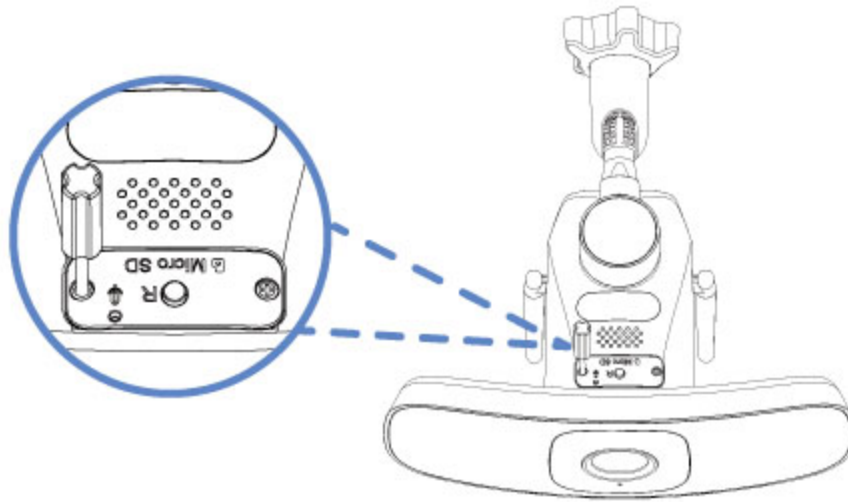

2. Insert a MicroSD card into the slot until it clicks into place.



3. Replace the compartment cover and tighten both screws.

4. Power on the camera and check the Lorex app to confirm the MicroSD card is detected.

Camera Placement Tips

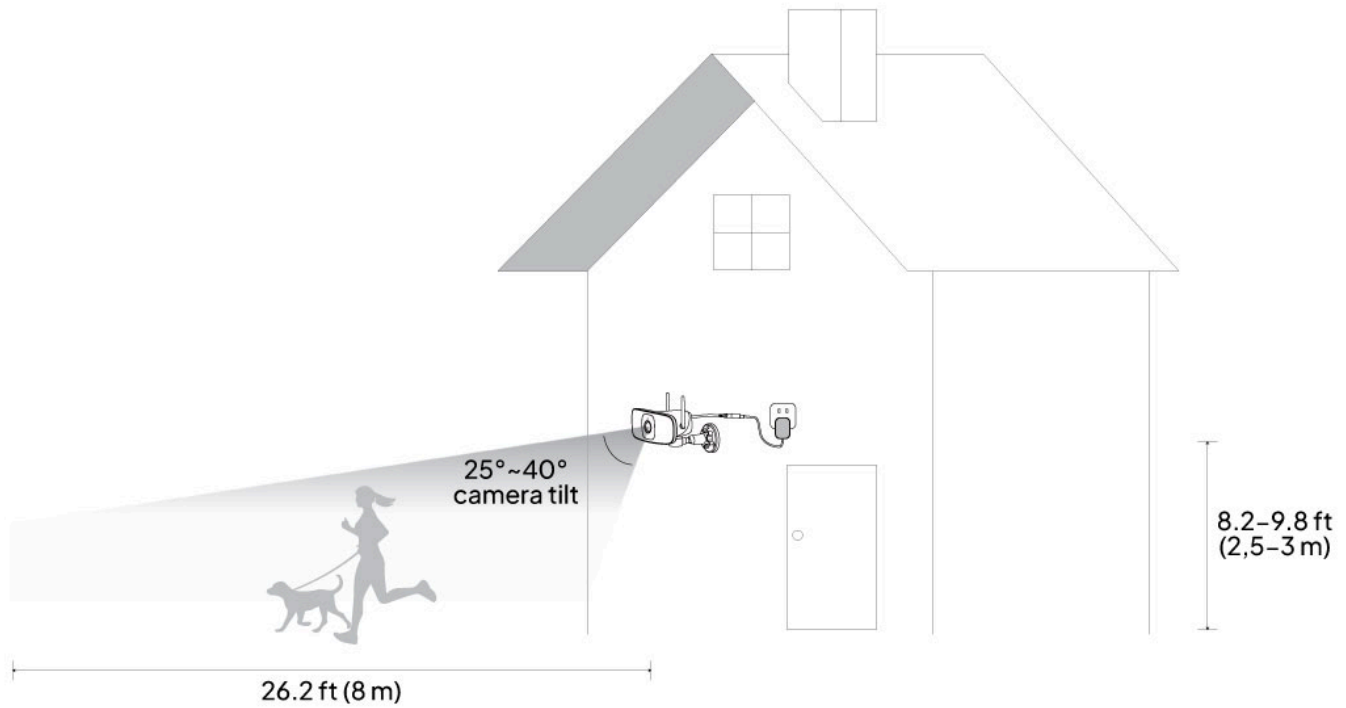

- Choose a key area to monitor, like a driveway, front door, garage, or backyard.
- **Mount the camera 8.2–9.8 ft (2,5–3 m) high** for a wide view and clear facial details.
- **Place the camera within 9.8 ft (3 m) of a power outlet** to ensure the cable can reach comfortably.
- **Tilt the camera downward at a 25°–40° angle** to capture motion effectively **up to 26.2 ft (8 m) away**.
- Use the app to preview the camera view before installing it permanently.
- Avoid pointing it toward direct sunlight or bright lights to prevent glare.
- Adjust the angle to avoid reflections from windows or shiny surfaces.
- Keep the view clear of trees, walls, or anything that could block or trigger false alerts.
- Install under an eave or overhang if possible to shield it from harsh weather.
- Set motion zones in the app to reduce false alerts and focus on what matters most.

Installing the Floodlight Camera

1. Choose a mounting location that offers a clear view and access to a power outlet.
2. Place the provided mounting template on the wall where you want to install the floodlight camera.

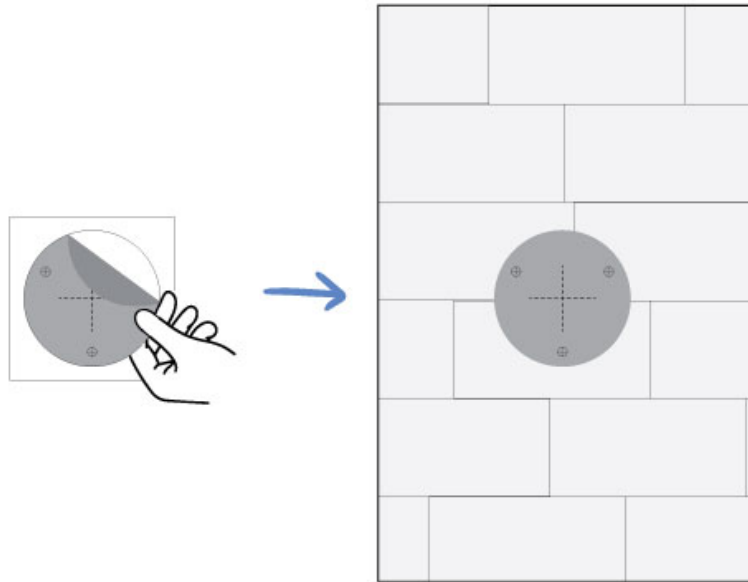

3. Drill where marked. Use drywall anchors if installing into drywall.

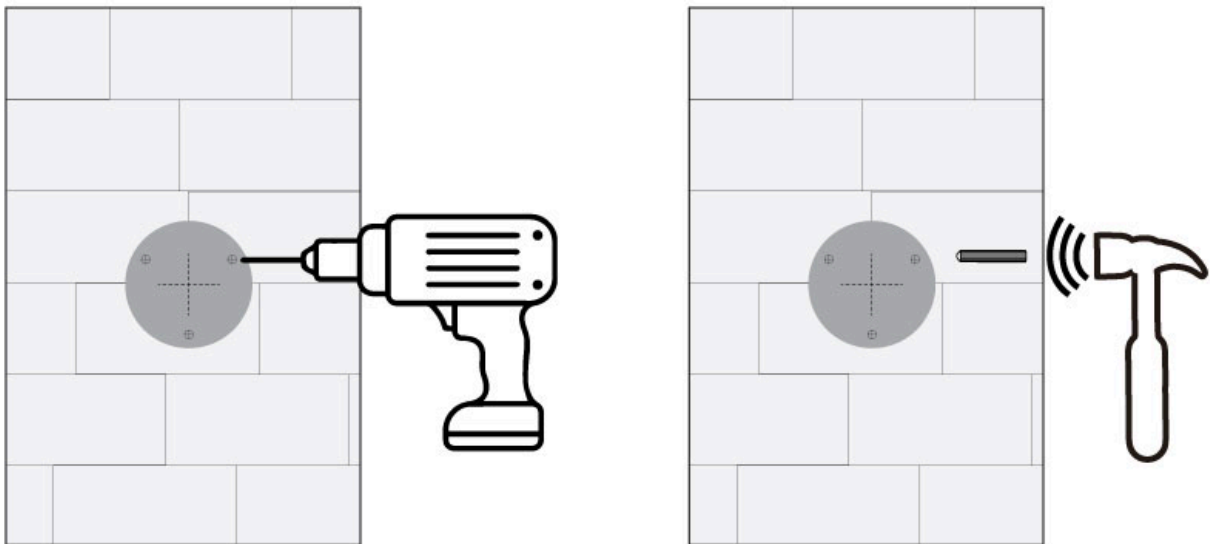

4. Peel off the backing from the adhesive mounting pad (foam piece). Stick the adhesive side firmly to the bottom of the floodlight camera's bracket.

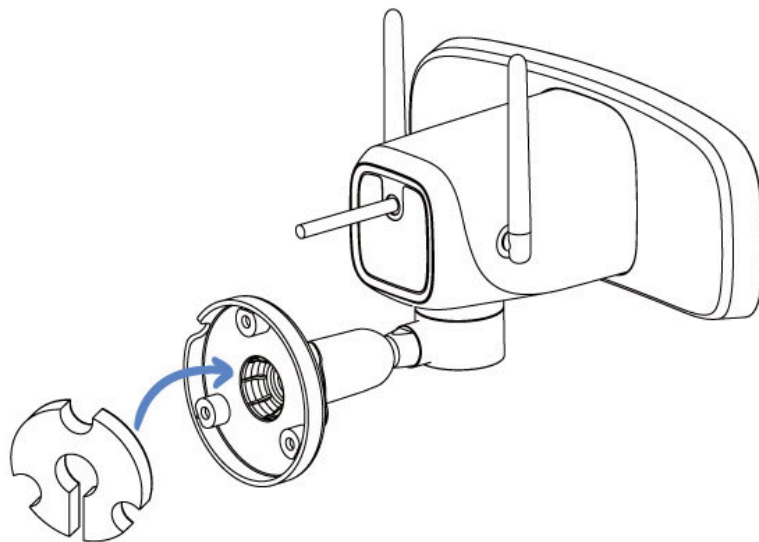

5. Align the bracket over the drilled holes and secure it using the provided screws.

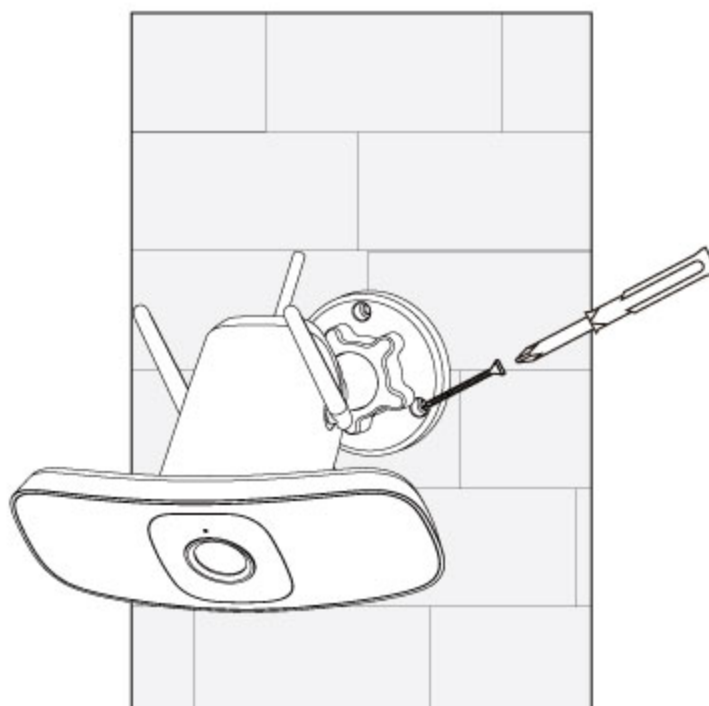

6. Loosen the bracket's adjustment ring by turning it counterclockwise. Position the camera to your desired angle, then tighten the adjustment ring clockwise to lock the position.

⚠ Ensure the side with the speaker faces downward.

- **Rotate bracket 360°**

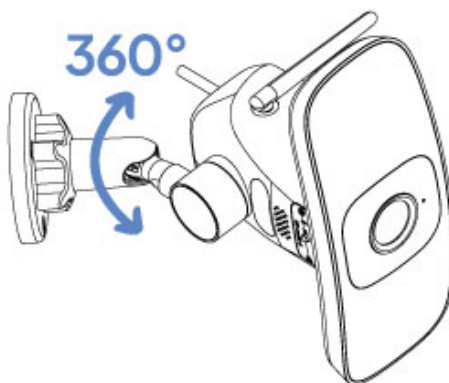

- **Tilt camera down 90°**

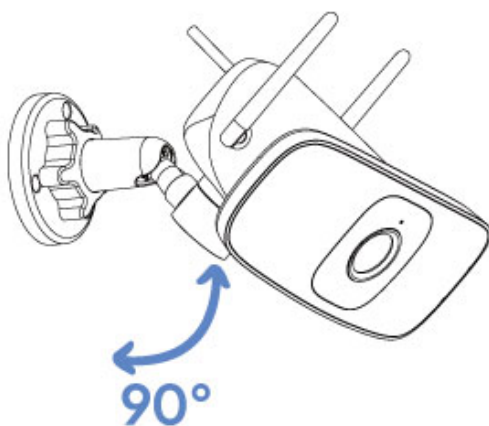

- **Pan camera left/right 180°**

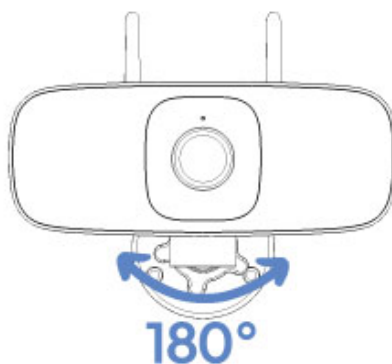

7. Plug the floodlight camera's cable into the power adapter until it clicks into place. The connection should feel tight. This ensures a secure and waterproof connection.

⚠ If the cable unplugs easily, it's not fully connected and may allow water to seep in.

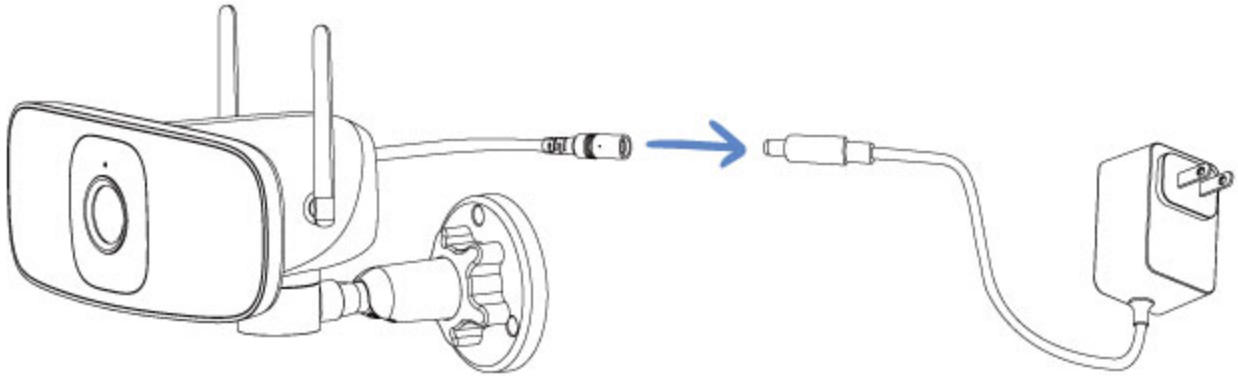

8. Plug the power adapter into a power outlet.

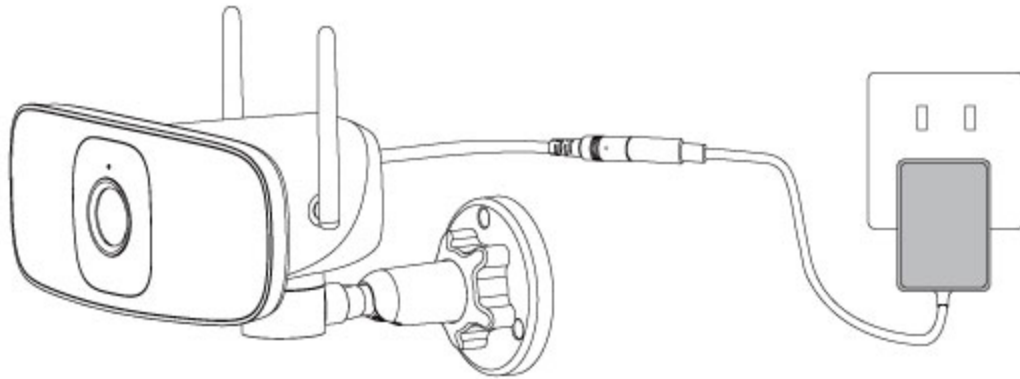

Certification

FCC Statement

This equipment has been tested and found to comply with the limits for a Class B digital device, pursuant to part 15 of the FCC Rules. These limits are designed to provide reasonable protection against harmful interference in a residential installation. This equipment generates, uses and can radiate radio frequency energy and, if not installed and used in accordance with the instructions, may cause harmful interference to radio communications. However, there is no guarantee that interference will not occur in a particular installation. If this equipment does cause harmful interference to radio or television reception, which can be determined by turning the equipment off and on, the user is encouraged to try to correct the interference by one or more of the following measures:

- Reorient or relocate the receiving antenna.
- Increase the separation between the equipment and receiver.
- Connect the equipment into an outlet on a circuit different from that to which the receiver is connected.

- Consult the dealer or an experienced radio/TV technician for help

Changes or modifications not expressly approved by the party responsible for compliance could void the user's authority to operate the equipment.

This device complies with Part 15 of the FCC Rules. Operation is subject to the following two conditions:

(1) this device may not cause harmful interference, and (2) this device must accept any interference received, including interference that may cause undesired operation.

RF Exposure Warning Statements:

This equipment complies with FCC radiation exposure limits set forth for an uncontrolled environment. This equipment shall be installed and operated with minimum distance 20cm between the radiator & body.

This device contains licence-exempt transmitter(s)/receiver(s) that comply with Innovation, Science and Economic Development Canada's licence-exempt RSS(s). Operation is subject to the following two conditions: (1) This device may not cause interference. (2) This device must accept any interference, including interference that may cause undesired operation of the device.

L'émetteur/récepteur exempt de licence contenu dans le présent appareil est conforme aux CNR d'Innovation, Sciences et Développement économique Canada applicables aux appareils radio exempts de licence. L'exploitation est autorisée aux deux conditions suivantes : (1) L'appareil ne doit pas produire de brouillage; (2) L'appareil doit accepter tout brouillage radioélectrique subi, même si le brouillage est susceptible d'en compromettre le fonctionnement.

Radio Frequency Exposure Statement for IC

This equipment complies with IC exposure limits set forth for an uncontrolled environment. The device can be used in portable exposure conditions. This equipment shall be installed and operated with minimum distance 20cm between the radiator & body.

Cet équipement est conforme aux limites d'exposition IC établies pour un environnement non contrôlé. L'appareil peut être utilisé dans des conditions d'exposition portables. Cet équipement doit être installé et utilisé avec une distance minimale de 20 cm entre le radiateur et le corps.

Hardware Version Identification Number (HVIN):**FL301A-DBW-AZ1, FL301A-DBW-AA1**

Search for more topics

Still have questions?

If you still have questions or couldn't find what you're looking for, our support team is here to help—feel free to reach out for further assistance.

[Contact Us →](#)