

1

Slide the stand
off the camera.



2

Insert the Micro-USB into the
port on the back of the camera.
Replace the stand, and plug
the cord into a power outlet.

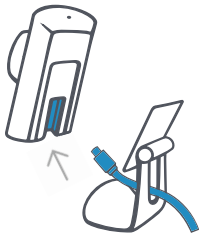

3

Launch the SimpliSafe app
on your smartphone.

4

Go to "Cameras" in the main
menu and tap the ⚙ icon.



Setup Guide

Warning: Changes or modifications to this unit not expressly approved by the party responsible for compliance could void the user's authority to operate the equipment.