

SAFETY PRE-CAUTIONS

- Do not operate during thunderstorms or rain.
- Avoid water, sand and snow when operating your car.
- Do not submerge car or controller in water.
- Never operate your car on the street or highway.
- Never operate your car in a confined or crowded area, and do not use people or animals as obstacles.
- Do not run your car into furniture, objects or hard surfaces, as this will cause damage to both the objects and the car.
- Keep fingers, hair and loose clothing away from the tires, gears and motor while the car is switched to "ON".
- Do not leave car or transmitter near sources of heat or under direct sunlight for long periods of time.
- Do not leave car or transmitter outside overnight. Dampness is harmful to interior components.
- Remove all batteries when not in use to avoid accidental operation.
- **Adult supervision is recommended when operating this car.**

BATTERY PRE-CAUTIONS

- BATTERY MUST BE RECYCLED OR DISPOSED OF PROPERLY ACCORDING TO INDIVIDUAL STATE OR LOCAL GOVERNMENT REGULATIONS.
- Batteries should be inserted with the correct polarity.
 - Do not short circuit battery contacts.
 - Do not mix old or new batteries, or different types of batteries.
 - Remove batteries if car will not be used for a long period.
 - Check the batteries regularly for leakage.
 - Do not dispose batteries in a fire - batteries may leak or explode.
 - Use only the recommended batteries or batteries of equal quality/type.
 - Do not recharge non-rechargeable batteries.

CAUTION:
In locations subject to radio frequency interference, the product may not function normally.

FCC NOTE:
THE ANTENNA PROVIDED IS A UNIQUE ANTENNA. BY INSTALLATION OF UNAUTHORIZED ANTENNA TO THIS EQUIPMENT. SUCH UNAUTHORIZED INSTALLATION COULD VOID THE USER'S AUTHORITY TO OPERATE THE EQUIPMENT.

THE MANUFACTURER IS NOT RESPONSIBLE FOR ANY RADIO OR TV INTERFERENCE CAUSED BY UNAUTHORIZED MODIFICATIONS TO THIS EQUIPMENT. SUCH MODIFICATION COULD VOID THE USER'S AUTHORITY TO OPERATE THE EQUIPMENT.

KEEP THIS INSERT FOR REFERENCE SINCE IT CONTAINS IMPORTANT INFORMATION

RADIO CONTROL
NOT SUITABLE FOR CHILDREN UNDER 6 YEARS OF AGE

- Warning: Changes or modifications to this unit not expressly approved by the party responsible for compliance could void the user's authority to operate the equipment.
- NOTE: This equipment has been tested and found to comply with the limits for a Class B digital device, pursuant to Part 15 of the FCC rules. These limits are designed to provide reasonable protection against harmful interference in a residential installation. This equipment generates, uses and can radiate radio frequency energy and, if not installed and used in accordance with the instructions, may cause harmful interference to radio communications. However, there is no guarantee that interference will not occur in a particular installation. If this equipment does cause harmful interference to radio or television reception, which can be determined by turning the equipment off and on, the user is encouraged to try to correct the interference by one or more of the following measures:
- Reorient or relocate the receiving antenna.
 - Increase the separation between the equipment and receiver.
 - Connect the equipment into an outlet on a circuit different from that to which the receiver is connected.
 - Consult the dealer or an experienced radio / TV technician for help.

This device complies with Part 15 of the FCC Rules. Operation is subject to the following two conditions: (1) this device may not cause harmful interference, and (2) this device must accept any interference received, including interference that may cause undesired operation.

Distributed by
Variety Wholesalers, Inc.
218 South Garnett Street
Henderson
NC 27536
Phone : 1-252-430-2001
USA Exclusive Distributor & Importer
Exclusive Internet Sales
ebuy0128@gmail.com
etrad0128@gmail.com
YC Design Limited
Date Tracking Code : 0514

PRINTED IN CHINA



WARNING!
CHOKING HAZARD - Small parts.
Not suitable for children under 3 years.

Factory Ref. No. HS2211
Item No. F30-X4518
SKU No. 422404



ANNIHILATOR
RADIO CONTROLLED ALL-TERRAIN RACE CAR

OPERATING INSTRUCTIONS

Please read this entire insert before operating this product.

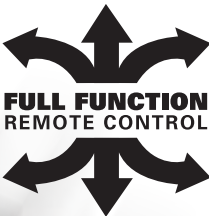

CAUTION! ELECTRIC TOY: Not recommended for children under 6 years of ages. As with all electrical products, precautions should be observed during handling and use to reduce the risk of electrical shock.

ATTENTION PARENTS: It is recommended that this toy and all accessories be periodically examined for potential hazards and that any potentially hazardous parts be repaired or replaced.

INSTALL BATTERIES

PUT 7*AA Batteries in the vehicle (Not Included)

1. Make sure the ON/OFF switch of the vehicles is at the OFF position. (See Diagram 1)
2. Use a screwdriver to unscrew and remove the battery compartment door. (See Diagram 1)
3. Insert seven "AA" alkaline (recommended) batteries by matching batteries marking as indicated on the battery compartment. (See Diagram 2)
4. Close the battery compartment door and tighten the screw with a screwdriver. (See Diagram 3).

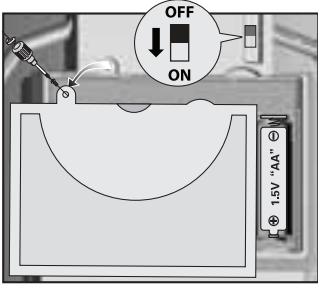

Diagram 1

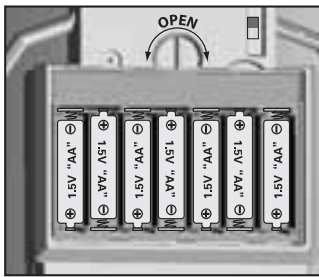

Diagram 2

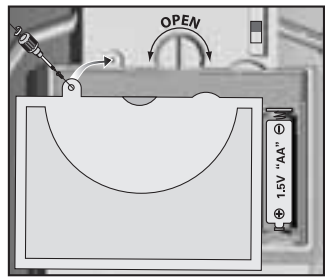
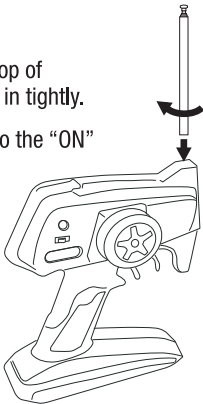
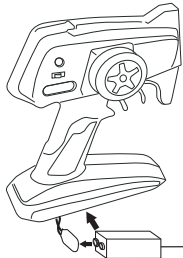

Diagram 3

REMOTE TRANSMITTER SET-UP

Put 1 x 9V Battery in the Transmitter (Not included)

1. Remove the battery cover on the bottom of the transmitter. Insert 1 "9V" battery into the compartment and replace the battery cover.
2. Insert the antenna to the top of the transmitter and screw in tightly.
3. Switch the power switch to the "ON" position



1 x 9V Battery (Not Included)

OPERATIONS

1. Place the car on a smooth, flat surface and extend antenna fully on the remote controller.
2. To move the car forward in a straight line pull trigger back with finger.
3. To move the car backward in a straight line push trigger forward with finger.
4. To turn the car right, turn the steering wheel on the side of the remote controller clockwise.
5. To turn the car left, turn the steering wheel on the side of the remote controller counter-clockwise.

NOTE: For maximum performance, hold the transmitter upright so the antenna points up (do not point the antenna at the car, this will reduce the signal range).

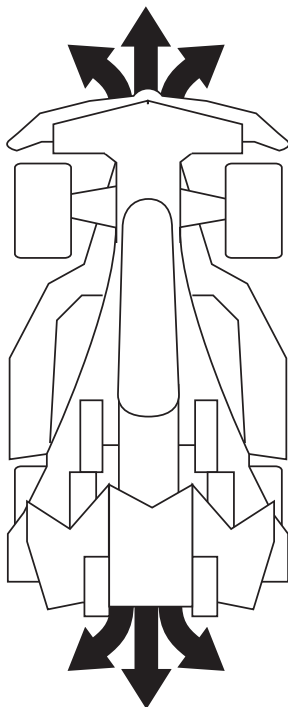
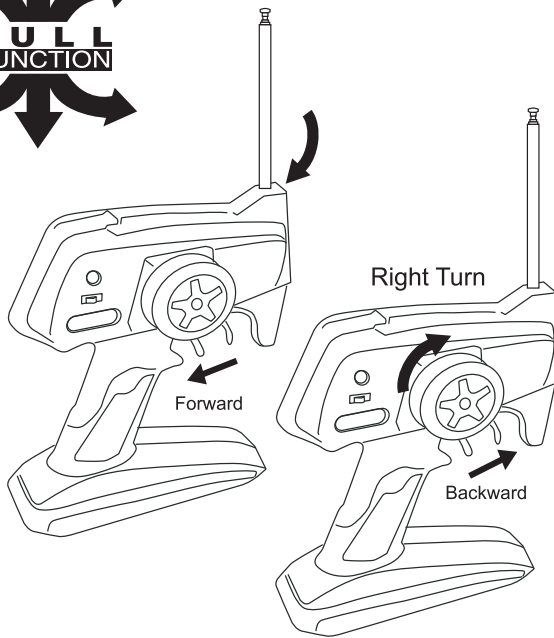
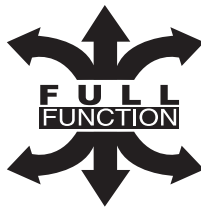

6. Adjust the steering alignment lever located on the bottom of the car (between front wheels). If the car does not run straight when moving forward (refer to drawing on the Car Set Up section for location of the steering alignment lever).

TROUBLE-SHOOTING

PROBLEM	PROBABLE SOLUTIONS
Car does not move or runs slowly	<ul style="list-style-type: none">• Make sure power switch on car and transmitter are in the "ON" position• Make sure the batteries in the car and transmitter are installed properly• Replace 7xAA (1.5V) battery in vehicle with fresh alkaline battery• Replace 9V battery in transmitter with fresh alkaline battery
Car moves erratically or transmitter range is short	<ul style="list-style-type: none">• Change locations as there may be radio interference in the area• Move away from other remote control cars as they may be operating on the same frequency• Make sure antenna in transmitter is screwed in tight and fully extended• Make sure transmitter battery connections are in good condition and replace battery
Car does not work after going through water or snow	<ul style="list-style-type: none">• Allow car to dry thoroughly overnight• Avoid driving in water or snow