

## Labeling Information

Panasonic Model: R8U4FD3830Y  
P/N: R8U4FD3830Y

BTv4.0 Dual Mode USB HCI Module  
For the Smart Monitor

FCC ID: U6YBT800  
IC: 219P-BT800

Rev. 3

July. 15, 2019

## 1. Scope

This document describes the labeling artwork, location, and justification for the location of such labels for the Panasonic Bluetooth module, R8U4FD3830Y.

## 2. Label Artwork

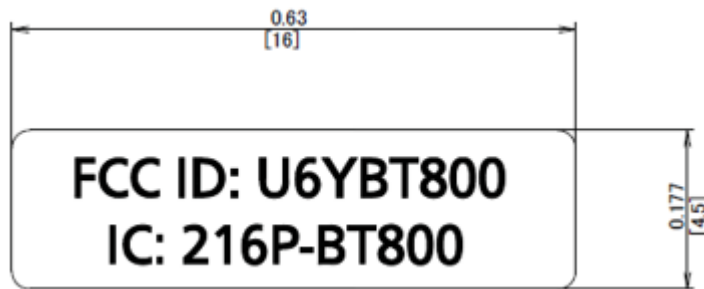

Fig. 1

## 3. Justification for Placement Location

This section describes the justification for the placement of the new ID & part number labels on the antenna board. The original version of the Bluetooth module circuit manufactured by Laird has been modified to remove the onboard chip antenna as seen below in Fig. 2a. The Product label, and ID label are illustrated in Fig. 2b.

The Laird radio circuit is placed onto the antenna board as seen in Fig. 2b. The antenna board and the radio module circuit now becomes the entire module. The antenna board is not a host, and only contains the modified radio circuit module, tuning circuit, TVS, and a connector for power and USB data which then connects to a host.

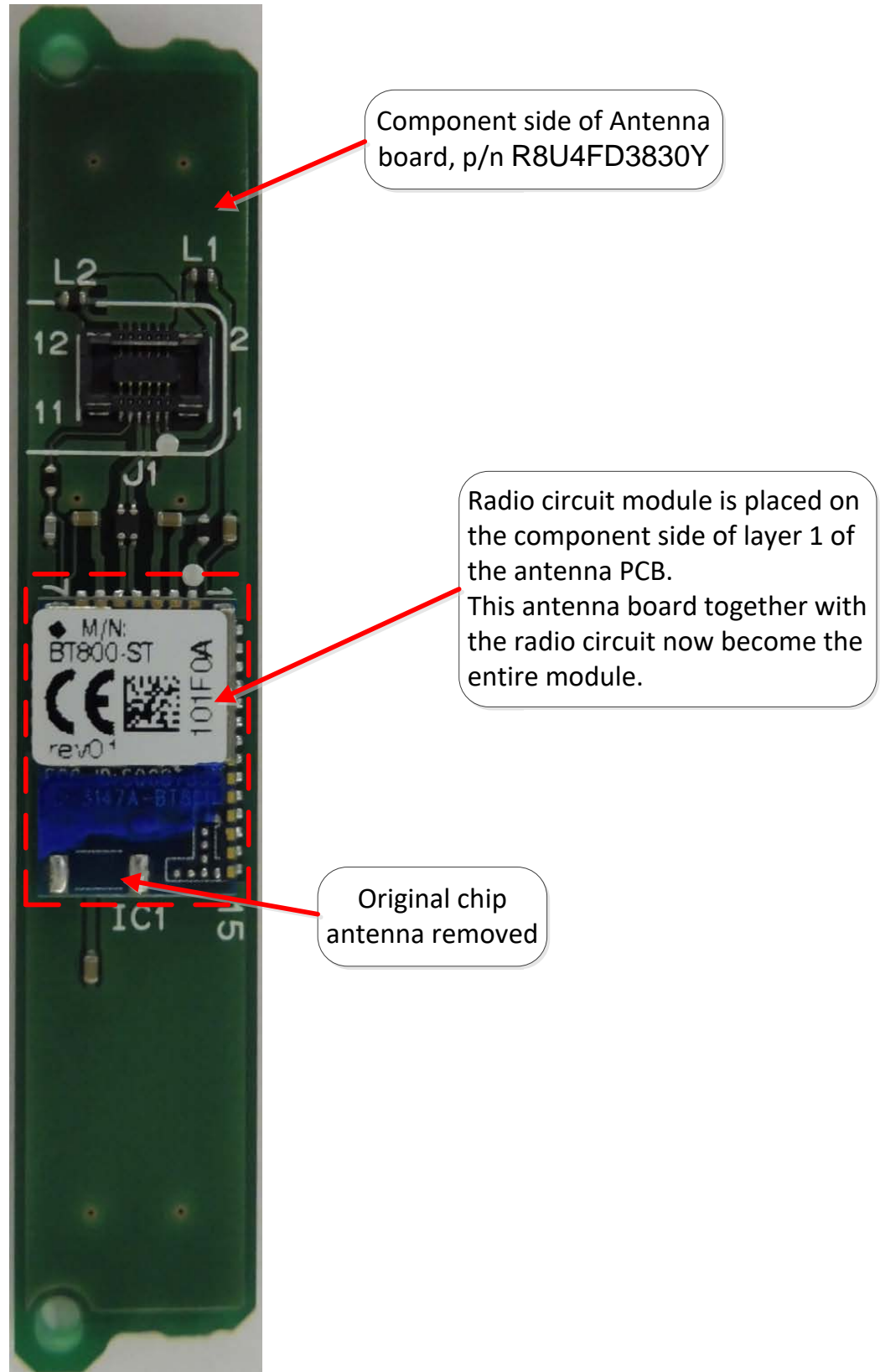

Fig. 2a

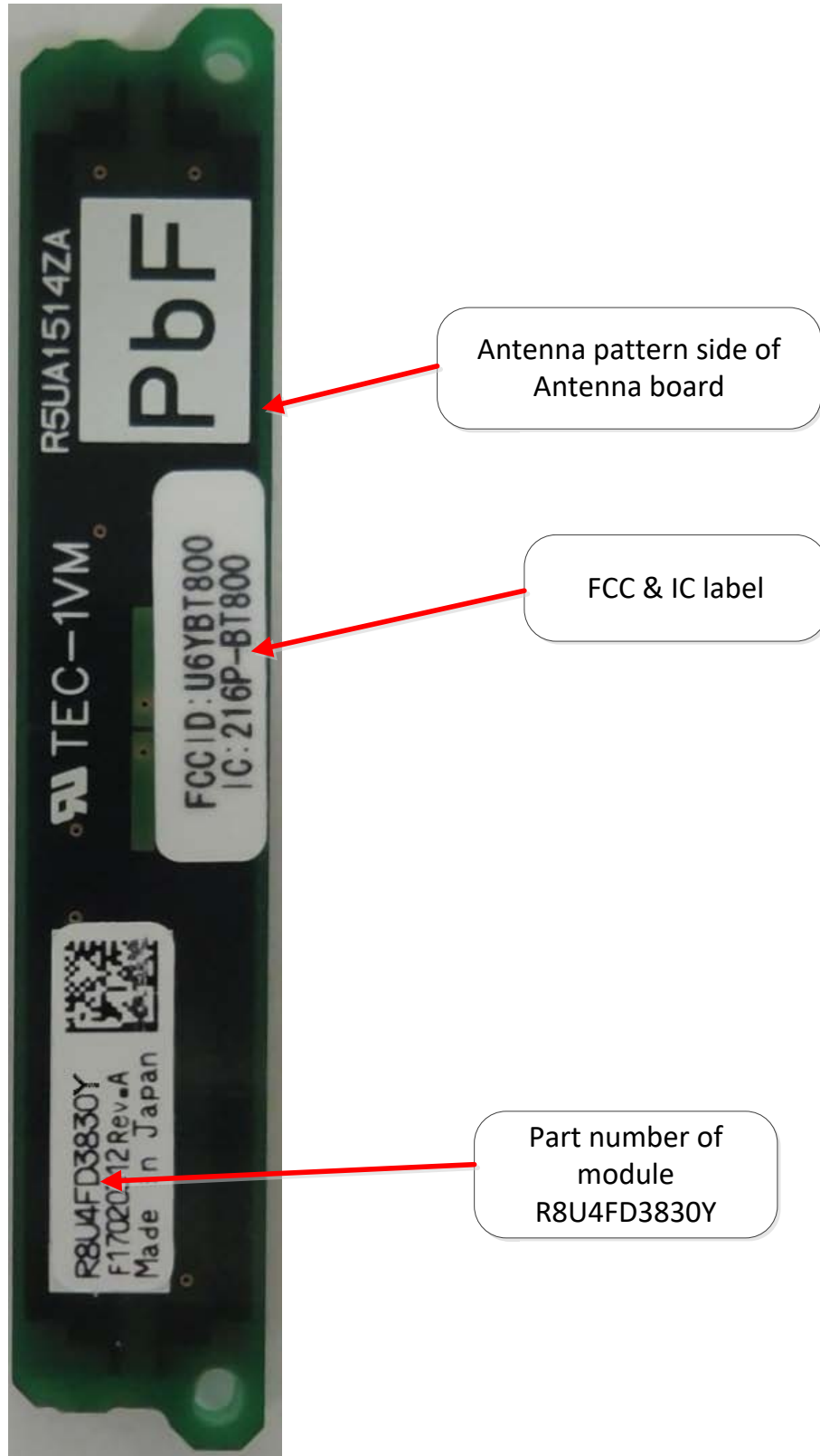

Fig. 2b