

# SRS-200BM

## User's Manual

(Bluetooth Mono Headset)



## Safety Notices

- Prior to use, please read "Bluetooth Mono Headset user's manual", carefully for its instructions and notices and use it appropriately.
- Please follow the instructions in order to prevent user's risks and property damages.

### Warnings

- Please do not damage the headset with a sharp object.  
(such as nail, knife and scissors)
- Please do not wet or soak headset in water.
- Please do not let childrens or pets bite or suck the headset.
- Please do not touch product with a wet hand.
- Please do not use other battery chargers other than the battery charger provided.

### Cautions

- Avoid the direct ray of light or a hot and humid place.  
(e.g., spa and sauna)
- Do not put in or near a thermic appliance such as heater and microwave.  
(Doing so may distort the product or result in explosion or fire.)
- Do not use the product near a microwave or wireless LAN.  
(The electromagnetic interference between products using the same frequency may result in malfunction or noise.)
- Turn off the product before storing, and keep it away from places with high temperatures of more than 50°C, under direct ray of light, or inside a hot vehicle. Keeping it in high temperature may cause degradation of the performance and reduce the durability of the battery.
- Please do not drop or shock the headset.

- Please do not rebuild, disassemble or repair the headset arbitrarily. If rebuilt, disassembled or repaired arbitrarily it will be not able to receive any free repair service.
- If you are calling at a high volume for a long period of time, it may damage your hearing.
- If you hold the product with your hands too tight, the voice quality may be degraded.
- Please do not use this headset while you are driving. If its use is inevitable, please follow the related laws and regulations and make your conversation as short as possible.



#### Cautio

Since the Bluetooth Mono Headset has a possibility of bad connection, it shall not be used for the services directly related to safety.

## Table of Contents

Safety Notices .....	2
Warnings .....	2
Cautions .....	2
Introduction.....	5
Package .....	5
Features.....	6
Before Starting to Use.....	7
Preparations.....	7
Charging.....	7
Usage.....	8
Turning On/Off the Headset.....	8
Wearing the Headset.....	8
Connecting the Headset to a Bluetooth Device.....	9
Calling .....	10
Receiving a Call .....	11
Hanging up the Call.....	12
Refusing a Call .....	12
Call Switching .....	12
Specifications.....	14
Troubleshooting.....	15
LED Status Indication .....	16
Quality Warranty.....	17

## Introduction

Wireless Mono Headset, developed with the Bluetooth technology, has the following primary features.

- Wireless Mono Headset
- Wireless Handsfree

## Package

- After purchasing, detach the BD\_Address/serial number label from the product, keep it attached to the blank of the warranty (required for the after-sales service.).

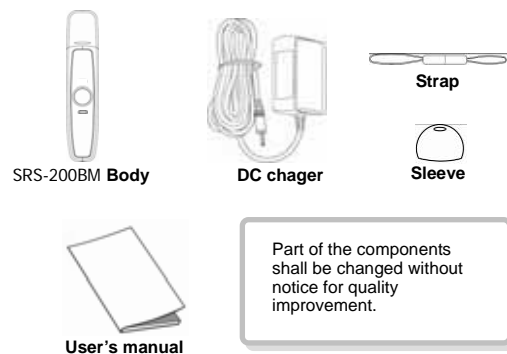

## ■ Features

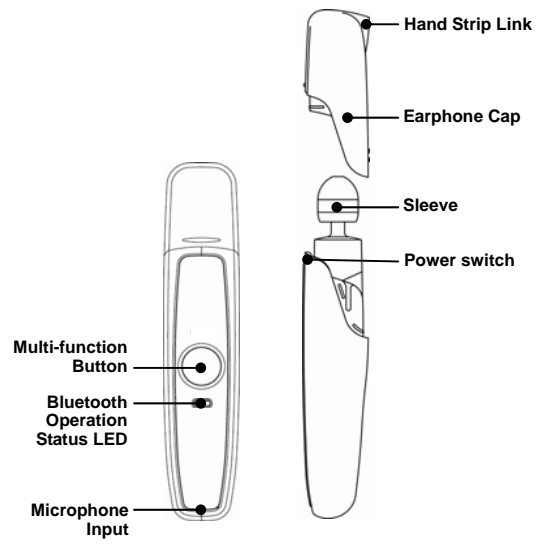

## Before Starting to Use

### Preparations

- Please read the instructions carefully before its useage.

### Charging

- The product includes a built-in battery. Please charge it with the DC charger provided in the box.
- After purchasing this product, please charge the battery fully before using it for the first time.



- Please charge the headset until the indicator turns from Red to Blue.
- Do not use the headset while charging.



### Caution

Please do not charge this headset with the unspecified chargers. It may cause damage and deterioration.

## Usage

### Turning On/Off the Headset

The headset may be turned on/off by opening/closing the earphone cap.

#### ON

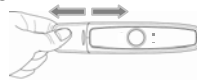

Pull earphone cap.

#### OFF

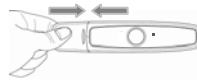

Pushing earphone cap.

### Wearing the Headset

- 1 Pull earphone cap.



- 2 Bend the earphone.



- 3 Wear on your ear.





### Connecting the Headset to a Bluetooth Device

- Connection between headset and Bluetooth mobile phone is made wirelessly through an encoded authentication.



**The following registration process should be performed for the initial connection.**

1. Set the headset into stand by mode. With Multi-function button pressed, you may open the earphone cap turn on the power. (As the operation status LED flicks in Blue and Red color, stand-by mode lasts for around three minutes.)
2. Search the headset from the mobile phone, referring to the mobile phone user's manual.
3. Select "SRS-200BM" from the searched list.
4. Enter "0000" when mobile phone asks for password or pin-number.
5. Select "SRS-200BM" from the list of registered devices.

\* Once registered, there is no need for re-registering for future connection.

\* If there is no registered devices in three minutes of register-stand-by mode, it automatically switches to connect-stand-by mode. In this case, turn off the device and try to register from the beginning.



#### Caution

Please refer to the User's Manual of your mobile phone for the details about Bluetooth headset connection, registration and deletion.

## Calling

### Calling to the Latest Number

- Press the multi-function button to check the last call history saved in the phone.
- Press the multi-function button again to call the last number. (Depends on the type of the mobile phone, you may call without saving the call history.)

### Calling with a Voice

- Please press the multi-function button for more than 2 seconds.
- You can use it according to the sequence of voice calling function of your mobile phone.



#### Caution

When the mobile phone supports voice calling function and is connected through a handsfree profile, calls can be placed with a voice.

### Calling with a Mobile Phone

- Please call with your mobile phone.
- Check the calling tone from the mobile phone and push the multi-function button on your headset. You can either hear the calling tone or communicate through headset. (In case of the mobile phone that supports an automatic call switching function, the call automatically switches to the headset.)



#### Caution

Making a call in a noisy place or outside may cause a difficulty for communication.

## Receiving a Call

Since this headset supports the automatic connection function, calls can be automatically received even when the earphone cap is connected to the main body.

### Receiving a Call while the cap is closed

- 1 Pull earphone cap.



- 2 Bend the earphone.



- 3 Wear on your ear.



### Receiving a Call while the cap is opened

- Please press the multi-function button when the phone rings.

#### ! Caution

When a call is received through a mobile phone, push the multi-function button once for 2 seconds to switch it to the headset talk.  
(At this time, the Bluetooth function should be enabled.)

### Hanging up the Call

- Please press the multi-function button to hang up the phone.

### Refusing a Call

#### Refusing a Call while the cap is closed

- Please reject the call from the mobile phone while referring to the mobile phone user's manual.
- When the earphone cap is detached from the main body, When hearing a phone bell from the headset, please push the multi-function button for more than 2 seconds.

#### Refusing a Call while the cap is opened

- Please press the multi-function button for more than 2 seconds when the phone rings.

### Call Switching



While having a conversation, use it when switching from headset to Mobile phone or vice versa.

From headset To Bluetooth mobile phone	Press the multi-function button for more than 2 seconds
From Bluetooth mobile phone To headset	Press the multi-function button for more than 2 seconds

#### Re-connection Function

- \* This device saves the information of the connected device, and reconnection of the latest device is possible when asked by the user.
- \* Disconnected headset and Bluetooth devices are available for reconnection in 3 minutes, they are automatically reconnected.
- \* Then, it should maintain the connection status.

## Specifications

Specification	Description
Product Name	Radio Device for Radio data communication System (SRS-200BM) 
Authentication Number	FCC ID : U6KSRS200BMA MIC : SLA-SRS-200BM CE0678  00000000000
Bluetooth QD ID	B012702
Bluetooth Specification	Version 2.0
Supported Bluetooth Profile	Headset profile(HSP), Handsfree profile(HFP)
Frequency Range	2.402 ~ 2.480 GHz
Transmission Output	0.1mW ~ 2.5mW
Range	Maximum 10 meters
Operating Temperature	-10℃ ~ 50℃
Standby Time	Maximum 100 Days
Talk Time	Maximum 3.5 hours
Battery Charging Time	2 hours
Adaptor Spec	Rated Input: AC 100~240V, 50/60Hz Rated Output: DC 5V
Dimension	SRS-200BM Body (16.6 x 80 x 14.8 mm)
Weight	11g ( including Earphone Cap)

## Troubleshooting

Problem	Action
The operation status LED is not turned on.	► If the operation status LED is not responding even after turning on the power switch, it is because the battery is discharged. Use after charging it sufficiently.
Device registration can not be done.	► Registration should be made from the user's Bluetooth device after setting the headset to the registration status and turning on the Bluetooth operation of the Bluetooth device. (Please refer to the Bluetooth device usage from the user's manual of the Bluetooth device.)
Authentication code is Not working.	► When connecting between Bluetooth devices, the accurate authentication number should be entered. (In case of this product, the number is "0000").
It has bad connections. It is frequently Disconnections.	► The radio wave is not stable. Please try to use it in another location. ► It is either under a bad status of receiving radio waves due to an obstacle between Bluetooth devices or by a long distance between them. Please make shorter the distance between two devices.
The battery standby is too short.	► Since battery is a consumable article, its standby time will get shorter from the initial use. ► The use time can be shorter if the charged product is left in a low or high temperature for a long period of time.
Heat is generated from headset .	► It requires a considerable amount of current while talking. Heat is generated in this process and when talking for a long period of time. ► You may continue to use since it doesn't influence on the lifetime and performance of the product.

## LED Status Indication

Headset Status	LED Indication	Status Sound
Power On	The red LED blinks for 1 second	
Power Off	The blue LED blinks for 1 second	
Charging completion	Blue LED turns on	
Connection Standby Mode (Pairing Mode)	Red and Blue LEDs blink (max. 3 minutes)	
Connection Completion, Connection Alive	Blue LED blinks at the interval of 5 seconds	
Connection Failure		A long sound with 1 syllables
Disconnecting		A short sound with 1 syllables
When Receiving a Call		Ring Tone
Calling		Getting higher 4 syllables
Hanging up the Call		Getting lower 2 syllables
View Recent Call List		Getting higher 4 syllables
Voice Dialing		Getting higher 4 syllables
Insufficient Battery		Interval of 30 seconds warning sound occurrence



## Quality Warranty

Thank you for purchasing SLaudiolab products. Since the quality assurance period of this product starts from the date of purchase, please have the purchase date written on this sheet to have appropriate services. SLaudiolab assures this product as shown below according to the following compensation rules and regulations.

### **Free Repair/Maintenance Services**

- Free repair/maintenance services shall be provided when problem occurs under normal use of this product within one year from the date of purchase (within the warranty period).
- The warranty period for batteries is 6 months from the date of purchase.

### **Charged Services**

- Services applicable to the following cases shall be charged even within the warranty period.
  - When the problem occurs from user's fault, intent and Alteration.
  - When the problem occurs due to the defect of connecting device.
  - When the problem occurs from a natural disaster such as fire, earthquake, flood or thunderbolt.
  - When the problem occurs from an abnormality of power source.
  - When the repair/maintenance has been made by a person or technician other than those from SL Audio Laboratory service centers and/or authorized agents.

### **Parts Retention Period**

- The holding time of each part for maintenance is 3 years after sterilization.

Type of Consumer Claims	Compensation Criteria	
	Within the Warranty Period	After the Warranty Period
When a major repair is required due to a functional or performance defect caused under normal use within 10 days from the date of purchase.	Replace or refund	N/A
When a major repair is required due to a functional or performance defect caused under normal use within 30 days from the date of purchase.	Replace	N/A
When a problem occur more than three times cause of the same reason (on the 4th time).	Replace or refund	Charged repair
When the replacement requires a major repair within 30 days from the date of replacement.	Refund	N/A
When a problem has recurred again after it repaired for the 4th time. (on the 5th time).	Replace or refund	N/A
When the repair is not possible. (within the parts retention period)	Replace or refund	Refund the amount depreciated from the purchase price plus 10% to the amount.
If the replacement is not possible.	Refund	N/A

Product		Bluetooth Mono Headset		
Model		SRS-200BM		
Serial No				
Date of Purchase				
Customer	Name		Tel	
	Add			
Agent	Name		Tel	
	Add			

SLaudiolab Co., Ltd.  
6F Won-il Bldg, #57-30 Nonhyun-Dong, Gangnam-Gu, Seoul

## For CE Marking

Declaration of conformity  
We, SLaudiolab Of 6F Won-il Bldg, #57-30 Nonhyun-Dong  
Gangnam-Gu, Seoul, Korea

Declare under our sole responsibility that our product  
SLaudiolab type SRS-200BM

To which this declaration relates is in conformity with the  
Appropriate standards EN 300 328, EN 301 489-1,  
EN301 489-17, EN50360 and EN 60950-1 following the  
provisions of  
Radio Equipment and Telecommunication Equipment  
Directive 1999/5/EC with requirements covering  
EMC directive 89/336/EEC and Low Voltage directive  
73/23/EEC.

Signature



Seoul March 2007  
Danny Park, Chief executive officer

## For FCC

This device complies with Part 15 of the FCC Rules. Operation is subject to the following two conditions: (1) This device may not cause harmful interference. (2) This device must accept any interference received, including interference that may cause undesired operation.

Caution: Changes or modifications not expressly approved by SLaudiolab could void the user's authority to operate the equipment.

### NOTE:

FCC Radiation Exposure Statement:

This Equipment complies with FCC radiation exposure limits set forth for an uncontrolled environment. This transmitter must not be relocated or operated in conjunction with any other antenna or transmitter.



regulations.

Dispose of the product  
according to local  
standards and



**SLaudiolab Co., Ltd.**  
6F Won-il Bldg, #57-30 Nonhyun-Dong,  
Gangnam-Gu, Seoul, Korea

Printed in Korea