

Bluetooth® Headset
WB120

User Guide

New Release by

WISE & BLUE

New Release by

WISE & BLUE



INTRODUCTION

Bluetooth® wireless technology

Bluetooth wireless technology allows you to connect compatible communication devices without cables.

A Bluetooth connection does not require that the phone and the headset be in line of sight, but both devices should be within 10meters(33 feet) of each other. Connections can be subject to interference from obstructions, such as walls, or other electronic devices.

The headset is compliant with the Bluetooth Specification 2.0 supporting the following profiles : headset profile and Hands-Free Profile. Check with the manufacturers of other devices to determine their compatibility with this device. There may be restrictions on using Bluetooth technology in some locations. Check with your authorities or service provider.

WB120 PACKAGE CONTENTS



Headset



Extra Ear-rubber
(Small, Large)



Travel Charger



Earloop pack(option)



Cradle



Car Holder



Hand strap



User Manual

WB120 Overview

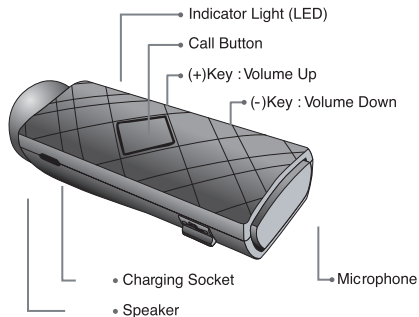

1 Make sure that your headset is fully charged before you start using it.

2 Plug the charger cable into the Charging Socket.

- The red LED turns on when the headset is charging (If the headset is completely discharged, It may take a couple of minutes for the LED to turn on). When the headset is fully charged (about 2hours), The red LED turns off.
- When battery power is low, the red LED starts to flash and you can hear beep.

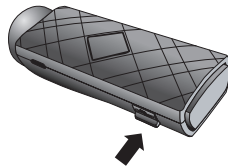

Turning your headset on and off

To turning on : Press and hold for 3 seconds the call button until the LED flashes Blue.

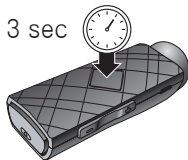

To turning off : Press and hold for 5 seconds the Call Button until the LED flashes Red.

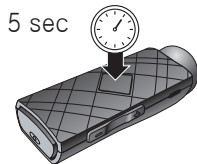

Pair it with your phone

Before you use the headset, you need to pair it with your phone.

- 1 Turing on the headset.
- 2 Fold the earpiece and then you can see the LED flashes alternately Blue and Red.



- 3 When the LED starts to flash 'Blue and Red F, set your phone to discover "WB120"

4 Set your Bluetooth phone to discover the "WB120"

A) Follow your phone instruction guide

- Going to Bluetooth menu on your phone and selecting the option to 'discover' or 'connect' a Bluetooth device (and select the "Handsfree" mode if your phone ask).

B) Your phone will find the "WB120"

- If you want to pair with it, press 'YES' or 'OK' on the phone.
- Enter the passkey or PIN = 0000(4 zeros) and press 'YES' or 'OK' on the phone.
- Once connected to your Bluetooth phone, The LED flashes Blue.
- Your headset is now set up and ready to be used.

Note

- 1) It is better to try pair your headset with the phone close-by.
- 2) Once you have paired your headset with the phone, You don't need to pair it again until you want to use it with another phone.
- 3) In case of unsuccessful pairing, repeat steps 2 to 3.
- 4) Blue and Red flashing (Pairing Mode) will return to Stand-by mode (the LED flashes Blue) if not paired in 10minutes.

1 To wear the headset, Fold the earpiece.



2 Plug the headset into your ear and point the headset toward your mouth.

For optimal performance, wear the Headset and your phone on the same side of your body.

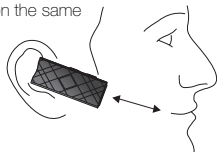

Using your Headset

1 Hold

- Call button is locked when the earpiece is unfolded. It can prevent unwished call.
- All the functions except power On/Off do not work in "Hold" Mode.

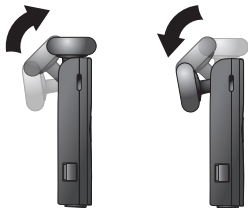

Hold Mode

2 Answer a call

Fold the earpiece or tap the call button to answer an incoming call.

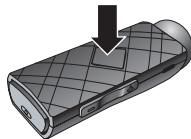

3 End a call

Unfold the earpiece or tap the call button to end an active call.

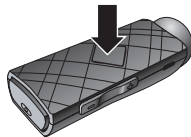

4 Make a call

Enter number on your phone and press send, and the call is automatically transferred to the headset. If your phone does not support this function, Press and hold for 2 seconds the Call Button after entering number on your phone.

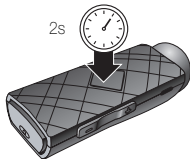

5 Adjust Volume

Press the Volume Up or Down Button to adjust the volume

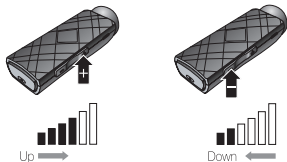

6 Activate voice dialing (Phone dependent)

- 1) Tap the Call Button.
- 2) You can hear the Audio signal.
- 3) Speak the name of the person that you want to call.

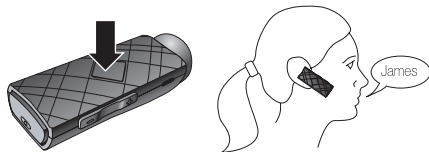

- ※ To cancel Voice Dialing, Tap the Call Button.
- ※ Please consult your phone's user manual for more information about using this feature.

7 Reject a call (Phone dependent)

Press and hold for 2 seconds the Call Button when the phone rings to reject an incoming call.

8 Redial last call (Phone dependent)

Press and hold for 2 seconds to call back the last number.

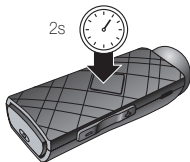

9 Mute a call

- Mute on : Press and hold for 2 seconds the Volume up or down Button
- Mute off : Tap the Volume up or down Button

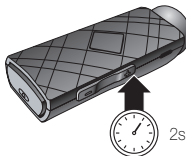

10 3way call (Phone dependent)

- Press and hold for 6 seconds the volume up button to place the active call on hold and answer the waiting call.
- Press and hold for 6 seconds the volume up button to switch between the two calls.
- Press and hold for 6 seconds the volume down button to end the active call.

11 Auto reconnection

After successful pairing, the headset automatically reconnects to your phone when the headset is turned on.

12 Transfer an active call

- From the phone to the headset : Press and hold for 3 seconds the Call Button during a call.
- From the headset to the phone : Press and hold for 3 seconds the Call Button during a call.

Note

Some features are phone/network dependent. See your phone's user manual for more information

Using Accessory

The headset is supplied with a cradle, a hand strap and a car holder. When you do not keep the headset on your ear, you can carry it conveniently using the Accessory.

1 Cradle

- 1) Place the headset into the cradle until it locks and you can put it on your shirt.

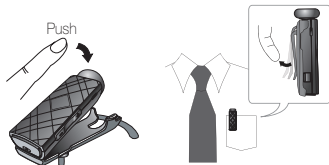

- 2) To release the headset, push down release point and take the headset out.



2 Hand strap

You can carry the headset with your phone

- 1) Hook on the cradle with the hand strap.
- 2) Tie to your phone with the hand strap.

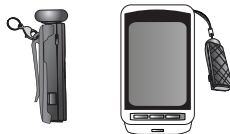

3 Car Holder

- 1) Adhere the car holder to dashboard or proper place in your car.
- 2) Folding the earpiece and place the headset in the car holder.

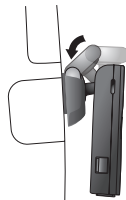

4 Changing faceplate

Two faceplates are provided.

As shown in the pictures, take the faceplate out and place a faceplate.

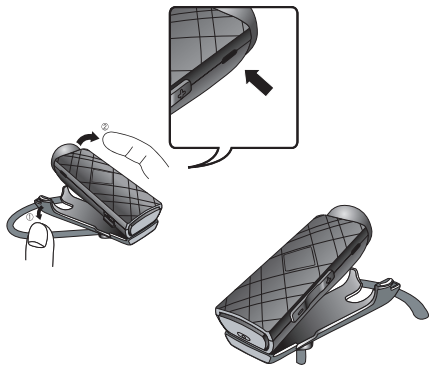

Specification

Product Type	Bluetooth Mono Headset
Bluetooth Version	Bluetooth 2.0
Bluetooth Profile	Headset & Hands-free profile
Frequency Range	2402 ~ 2480 MHz
Dimension	52 x 18 x 11 mm
Weight	9.8g
Operating Range	Up to 10meters (33feet)
Operating Temperature	-20°C ~ 55°C
Talking Time	Up to 5.5 hours(HV3 Packet)
Standby time	Up to 100 hours
Charging	2 hour/full charging
Battery	Rechargeable Li-Polymer
Charger Rated Input	AC100~240V, 50/60Hz
Charger Rated Output	DC 5.0V / 700mA

※ Talk Time and Standby time are dependent on phone models.

Troubleshooting

If you cannot connect the headset to your phone, do as follows :

- Ensure that the headset is charged, switched on, and paired with and connected to your phone.
- Ensure that the Bluetooth feature is activated on your phone.
- Check that the headset is within 10 meters (33 feet) of your phone and that there are no obstructions between the headset and the phone, such as walls or other electronic devices.

WARNING: This equipment may generate or use radio frequency energy. Changes or modifications to this equipment may cause harmful interference unless the modifications are expressly approved in the instruction manual. The user could lose the authority to operate this equipment if an unauthorized change or modification is made.

Taking care of your headset

- Keep all accessories and enhancements out of the reach of small children.
- Keep the device dry. Precipitation, humidity, and all types of liquids or moisture can contain minerals that will corrode electronic circuits. If your device does get wet, allow it to dry completely.
- Do not use or store the device in dusty, dirty areas. Its moving parts and electronic components can be damaged.
- Do not store the device in hot areas. High temperatures can shorten the life of electronic devices, damaged batteries, and warp or melt certain plastics.
- Do not store the device in cold areas. When the device returns to its normal temperature, moisture can form inside the device and damage electronic circuit boards.
- Do not attempt to open the device
- Do not drop, knock, or shake the device. Rough handling can break internal circuit boards and fine mechanics.
- Do not use harsh chemicals, cleaning solvents, or strong detergents to clean the device.

Warranty

Wise & Blue warrants this product against all defects in material and workmanship for period of one year from the date of original purchase. The conditions of this warranty and our responsibilities under this warranty are as follows:

- The warranty is limited to the original purchaser.
- A copy of your receipt or other proof of purchase is required.
- The warranty is void if the serial number, date code label or product label is removed, or if the product has been subject to physical abuse, improper installation, modification, or repair by unauthorized parties
- The responsibility of Wise & Blue products shall be limited to the repair or replacement of the product at its sole discretion
- Any implied warranty on Wise & Blue products is limited to one year from the date of purchase on all parts, including any cords and connectors
- Specifically exempt from any warranty are limited-life consumable components subject to normal wear and tear, such as microphone windscreens, ear cushions, decorative finishes, batteries, and other accessories
- Wise & Blue is not liable for any incidental or consequential damages arising from the use or misuse of any Wise & Blue product

- This warranty gives you specific rights and you may have other rights which vary from area to area
- Unless otherwise instructed in the User Guide, the user may not, under any circumstances, attempt to perform service, adjustments or repairs on this unit, whether in or out of warranty. It must be returned the purchase point, factory or authorized service agency for all such work
- Wise & Blue will not assume any responsibility for any loss or damage incurred in shipping. Any repair work on Wise & Blue products unauthorized third parties voids any warranty

Certification

FCC

This device complies with part 15 of the FCC Rules. Operation is subject to the following two conditions: (1) This device may not cause harmful interference, and (2) this device must accept any interference received, including interference that may cause undesired operation

CE

Hereby, Wise & Blue Co., Ltd. declares that this WB120 is in compliance with the essential requirements and other relevant provisions of directive 1999/5/EC.

Bluetooth

The Bluetooth word mark and logos are owned by the Bluetooth SIG, Inc. and any use of such marks by Wise & Blue is under license.