

NAME:REVERS OBJECT:061-0978-XX DATE:17-Nov-09 15:54:21

-00 SHOWN

Midmark 9A40800X  
Wireless Remote  
FCC ID: U399A408F1  
IC: 6978A-9A408F1

THIS DEVICE COMPLIES WITH PART 15 OF THE FCC RULES. OPERATION IS SUBJECT TO THE FOLLOWING TWO CONDITIONS: (1) THIS DEVICE MAY NOT CAUSE HARMFUL INTERFERENCE. AND (2) THIS DEVICE MUST ACCEPT ANY INTERFERENCE RECEIVED. INCLUDING INTERFERENCE THAT MAY CAUSE UNDESIED OPERATION.

-01 SHOWN

Midmark 9A41800X  
Wireless Remote  
FCC ID: U399A408F1  
IC: 6978A-9A408F1

THIS DEVICE COMPLIES WITH PART 15 OF THE FCC RULES. OPERATION IS SUBJECT TO THE FOLLOWING TWO CONDITIONS: (1) THIS DEVICE MAY NOT CAUSE HARMFUL INTERFERENCE. AND (2) THIS DEVICE MUST ACCEPT ANY INTERFERENCE RECEIVED. INCLUDING INTERFERENCE THAT MAY CAUSE UNDESIED OPERATION.

Midmark 9A40800X  
Wireless Remote  
FCC ID: U399A408F1  
IC: 6978A-9A408F1

THIS DEVICE COMPLIES WITH PART 15 OF THE FCC RULES. OPERATION IS SUBJECT TO THE FOLLOWING TWO CONDITIONS: (1) THIS DEVICE MAY NOT CAUSE HARMFUL INTERFERENCE. AND (2) THIS DEVICE MUST ACCEPT ANY INTERFERENCE RECEIVED. INCLUDING INTERFERENCE THAT MAY CAUSE UNDESIED OPERATION.

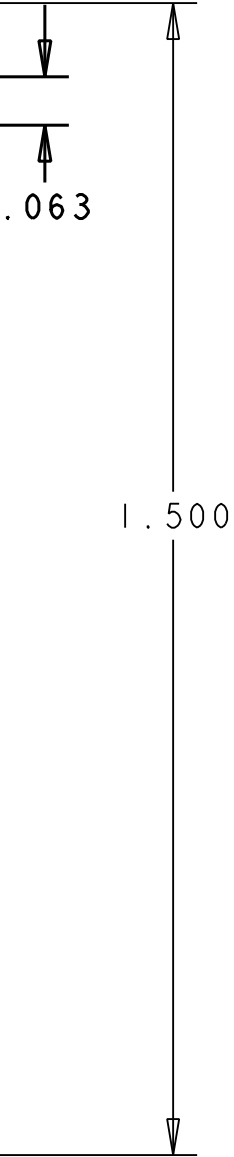

- NOTES:
- 1. INK COLOR: SILVER (SYMBOL & TEXT).  
BACKGROUND: BLACK
  - 2. MATERIAL: 2 MIL CLEAR MYLAR
  - 3. TEXT: HELVITICA, 1/16" MIN HEIGHT.
  - 4. LABEL TO BE MANUFACTURED USING A U.L. RECOGNIZED COMPONENT MARKING AND LABELING SYSTEM.
  - 5. LABEL TO BE C.S.A. ACCEPTED. MANUFACTURER'S CSA INSIGNIA TO BE PRINTED ON ROLL CORE OR UNUSED PART OF LABEL SHEET.
  - 6. LABEL TO COMPLY WITH ALL UL60601-1 REQUIREMENTS FOR PERMANENT LABEL.
  - 7. SYMBOLS TO CONFORM WITH IEC 348 STANDARD.

SCALE: 4.00 -00 SHOWN

M33979	11/17/09	RE	ALL: ADDED A '1' TO IC AND FCC NUMBER.	D
M32621	9/9/09	STM	REMOVED -02	C1
M32621	11/10/08	STM	ADDED -02	C
M31814	9/17/08	KPW	ADDED -01	B
M30407	3/6/07	JCH	RESIZED LABEL, ADDED FCC AND IC IDENTIFICATION NUMBERS AND PARAGRAPH.	A2
M30407	3/5/07	JCH	RELEASED	A1
ECO NO	DATE	CH BY	CHANGE	REV

THIS PRINT AND THE INFORMATION CONTAINED THEREIN ARE PROPERTY OF MIDMARK CORPORATION ARE FURNISHED TO THE HOLDER IN CONFIDENCE AND ARE NOT TO BE REPRODUCED,USED,OR DISCLOSED TO OTHERS WITHOUT THE EXPRESS WRITTEN PERMISSION OF MIDMARK CORPORATION

INCH [MILLIMETER]	INCH [MILLIMETER]
UNSPECIFIED GENERAL TOLERANCES	
ANGULAR +/-	0.50°
FRACTIONAL +/-	0.1
DECIMAL.XX +/-	0.03
DECIMAL.XXX +/-	0.015

COMMERCIAL TOLERANCES SHALL APPLY ON BAR, ROD, WIRE, SHEET, ETC.

ITEM	QTY	PART NUMBER	DESCRIPTION
MATERIAL SPEC			<div><div>MIDMARK®</div><div>MIDMARK CORPORATION, VERSAILLES, OHIO 45380</div></div>
SCALE	4.000	CK BY DATE	SHEET 1 OF 1
PREPARED BY J. HEMPKER	DATE 22-Feb-07	PART NAME	LABEL, WIRELESS FOOT CONTROL
APPROVED BY	DATE	PART NUMBER	061-0978-XX
			REV D