



Congratulations! You're the proud owner of a Gemmy Incredible Light Show. Please read over the directions carefully before using your Gemmy Incredible Light Show.

 **CAUTION:** Do not attempt to assemble or operate your Incredible Light Show during unusually strong winds. If it becomes too windy for safe operation, please disassemble your Incredible Light Show and bring indoors until conditions improve.

 Remove all plastic fasteners and tags. These are part of the packaging and should be discarded.

Contents: [SHOW DIAGRAMS OF EACH ITEM]

Base	1pc
Base Screws	4pcs
Incredible Light Show (collapsed)	1pc
Inner Poles - separated	3pcs
Control Box / Speaker Hook	1pc
Base Anchor Stakes	4pcs
Control Box	1pc
Speaker	1pc
Nylon Tethers	4pcs
Tether Stakes	4pcs
Wireless Remote	1pc
AAA Batteries	3pcs
AC Adapter	1pc
Input: 120V - 60Hz 270mA	
Output: 24V - 20VA	

Assembly Instructions:

1. Remove contents from packaging. Lay out Base in a clear and flat area.
2. Insert the small Base Anchor Stakes through the holes within the bottom of the Base and into the ground.
3. Assemble Inner Poles by sliding the ends into the provided shafts to create one long Inner Pole.
4. Turn the collapsed Incredible Light Show on its side and insert the Inner Pole through all three center holes and into slot under the star at the top of the tree.
5. Place the Inner Poles thru the Incredible Light Show to extend it to full height. Carefully lift the Incredible Light Show upright and set into anchored Base. Please note this action may require 2 persons.
6. Secure Inner Pole to base by inserting Base Screws into the provided holes. Tighten Base Screws to create a tight, snug fit so that the Incredible Light Show stands upright and does not lean.

7. Attach the Hook onto the center pole. We recommend you place the Control Box/Speaker Hook at the top of the lowest pole. Tighten screws to secure the hook on the pole.
8. Attach the Speaker by hanging it to the Inner Pole facing out. Close the clasp on the back which secures the speaker onto the Inner Pole.
9. Attach the Control Box by hanging it to the Inner Pole, opposite the speaker. Close the clasp on the back which secures the Control box onto the Inner Pole.
10. Connect the Speaker cable to the cable coming from the Control box.
11. Attach the hooks located at the end of the Nylon Tethers to the ridge of the plastic Star mount at the top of the Incredible Light Show. Attach other end of Nylon Tethers to the Tether Stakes. Drive Tether Stakes into ground so that the Nylon Tethers are taut.
12. Attached the AC adapter cord as shown. Then plug the UL Listed adapter into the power source. This power unit is Intended to be correctly oriented in vertical or floor mount position.
13. Place the 3xAAA batteries inside the remote control.
14. Resetting the Remote Control -Before activating your Incredible Light show you must reset both the Control box and the Remote Control. Follow the easy steps listed below.
 - a. Press the reset button on the Control Box. This will activate a flashing LED for approximately 2 minutes.
 - b. During this time period, use a ball point pen or other blunt object to press the reset button located on the back of the remote control.
 - c. Once these actions have been taken, you may now proceed to play your Incredible Light Show.

Do not attempt to operate your Incredible Light show in the following conditions:

- 1 During inclement weather conditions such as heavy rains and wind storms, store the product indoors.
- 2 Operation of your Incredible Light Show during extreme weather conditions is not recommended.

Storage: Do not discard box as it should be used for storage. Keep your disassembled Incredible Light Show and return all parts to the original packaging, if possible. Store in a cool, dry location.

Trouble Shooting Checklist:

If your Incredible Light Show is not operating, the problem may be:

1. The power source is disabled or the cord is unplugged.
2. The batteries within the Wireless Remote may need to be replaced.
3. The reset buttons have not been reset properly. Follow instructions above on how to reset the Control Box and Remote Control.

Frequently Asked Questions (FAQ's)

1. *Can I leave my Incredible Light Show running overnight?*
We recommend that you turn off while unattended. Extended use beyond 8 hours will not damage your Incredible Light Show.
2. *How much electricity does an Incredible Light Show consume?*
It uses about as much energy as two 100-watt light bulbs.
3. *What is the best way to store my Incredible Light Show?*
Store dry in a bag, box or other storage container and keep in a cool, dry location.
4. *My area is prone to unusually windy conditions, will this affect my Incredible Light Show?*
In order to prevent damage, we suggest you keep the Incredible Light Show protected from high winds by simply disassembling the item and bringing it indoors until wind conditions improve.
5. *What if it is raining or snowing? Will this affect my Incredible Light Show?*
Operation of your Incredible Light Show during light weather conditions, such as a gentle rain or snowfall is fine. However, operation of your Incredible Light Show during extreme weather conditions, such as heavy snow, rain or windstorms is not recommended as the unit may become over-weighted or could fall over, thus damaging the unit.



CAUTION: Operation of your Incredible Light Show during extreme weather conditions is not recommended.

Warning!

This equipment has been tested and found to comply with the limits for a class B digital device, pursuant to part 15 of the FCC Rules. These limits are designed to provide reasonable protection against harmful interference in a residential installation.

This equipment generates, uses and can radiate radio frequency energy and, if not installed and used in accordance with the instructions, may cause harmful interference to radio communications. However, there is no guarantee that interference will not occur in a particular installation. If this equipment does cause harmful interference to radio or television reception, which can be determined by turning the equipment off and on, the user is encouraged to try to correct the interference by one or more of the following measures:

- Reorient or relocate the receiving antenna.
- Increase the separation between the equipment and receiver.
- Connect the equipment into an outlet on a circuit different from that to which the receiver is connected.
- Consult the dealer or an experienced radio/TV technician for help.

Changes or modifications not expressly approved by the party responsible for compliance could void the user's authority to operate the equipment.

This device complies with Part 15 of the FCC Rules. Operation is subject to the following two conditions:

- (1) This device may not cause harmful interference.
- (2) This device must accept any interference received, including interference that may cause undesired operation.

These instructions relate to the following item numbers:

11600, 11607, 11624, 11625, 77002, 77003, 77005, 77006, 77008, 77010

Gemmy makes more fun and festive products than you can imagine!
Check out our website at WWW.GEMMY.COM to see for yourself!

WARNING:

This product contains chemicals, including lead, known to the State of California to cause cancer, and birth defects or other reproductive harm.

Wash hands after handling.

Patent pending.



© Gemmy 2007
Printed in China

Made in China

117 Wrangler Dr.
Coppell, TX 75019

**Customer Service: 1-800-231-6879, 9:00am to 5:00pm
Central Standard Time or Visit us at www.gemmy.com**

FUNCTIONALITY OF WIRELESS REMOTE

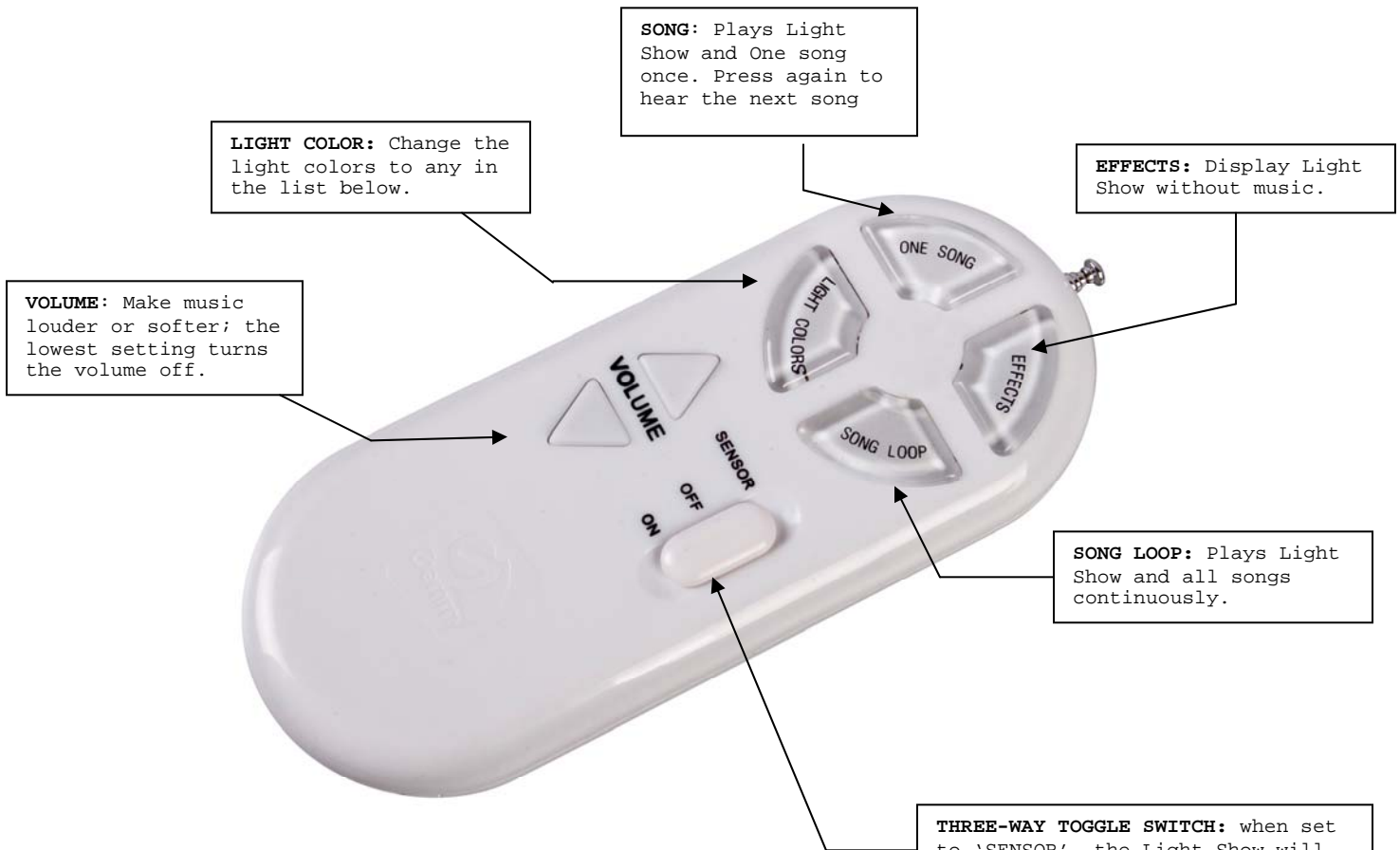

LIGHT COLORS LIST

Each press of the 'LIGHT COLORS' button clicks to the next option:

1. Red
2. White
3. Green
4. Blue
5. Light Blue
6. Pink
7. Amber
8. Rainbow (Red, Green, Blue, Gold and White stripes)
9. Candy Cane (Red and White alternating stripes)
10. Red and Green alternating stripes



© Gemmy 2007

Printed in China
Made in China

innovation. powered by



visit us at gemmy.com