



## Pet Locator User Guide



# **Zoombak Services**

## **Pet Locator User Guide**

[www.zoombak.com](http://www.zoombak.com)

### **COPYRIGHTS**

© 2007 Connectid, LLC. • All Rights Reserved

### **NOTICES**

This document neither grants any license nor conveys any rights with respect to the subject matter hereof or otherwise. Zoombak expressly retains all intellectual and other property rights with respect to this document and all matters set forth herein. This document is neither an offer nor an acceptance. Neither party will be obligated with respect to the subject matter hereof unless and until such party has entered into a definitive agreement, and then only in accordance with the terms of such agreement. Some technical assertions of capability included herein are estimates based on limited information gathered from past experience.

### **TRADEMARKS**

Zoombak™ and the Zoombak logo are trademarks owned by Connectid, LLC and protected in the United States and other countries.

# Table of Contents

1	Introduction.....	1
2	Getting Started.....	2
2.1	Zoombak Pet Device Features .....	2
2.1.1	Front/Aerial View of Device.....	2
2.1.2	Key Functions.....	3
2.1.3	Device Orientation .....	3
2.2	Pet Device Package Contents.....	4
3	Using the Pet Device .....	5
3.1	Charging the Battery.....	6
3.2	Turning the Pet Device ON/OFF .....	7
3.3	Monitoring the Pet Device Status .....	7
3.4	Placing the Device on Your Pet.....	8
4	Safety and Warranty Information .....	10
4.1	Safety Information .....	11
4.1.1	Reduction of Hazardous Materials (RoHS).....	11
4.2	SARS .....	12
4.3	Warranty Information.....	13
4.3.1	Service After Expiration of Warranty.....	13
4.3.2	Warranty Limitations .....	14
4.4	Water Resistance .....	14
5	Contacting Customer Care.....	15
6	Device Specifications.....	16
6.1	Device.....	17
6.2	Certifications.....	18
6.3	AC Wall Charger .....	18

# 1. Introduction

Thank you for purchasing the Zoombak Pet Device. This guide will introduce you to all of the features and provide you with instructions on how to use and operate this exciting new product. The Zoombak Pet Device manual is divided into five main sections:

- **Section 2: Getting Started.**
- **Section 3: Using the Zoombak Pet Device.**
- **Section 4: Safety and Warranty Information.**
- **Section 5: Contacting Customer Care.**
- **Section 6: Device Specifications.**

Please note that the features and usage of the Zoombak Pet data service will be addressed in a separate manual.

## 2. Getting Started

This section addresses two primary areas:

- Zoombak Pet Device Features.
- Pet Device Package Contents.

### 2.1 Zoombak Pet Device Features

#### 2.1.1 Front/Aerial View of Device

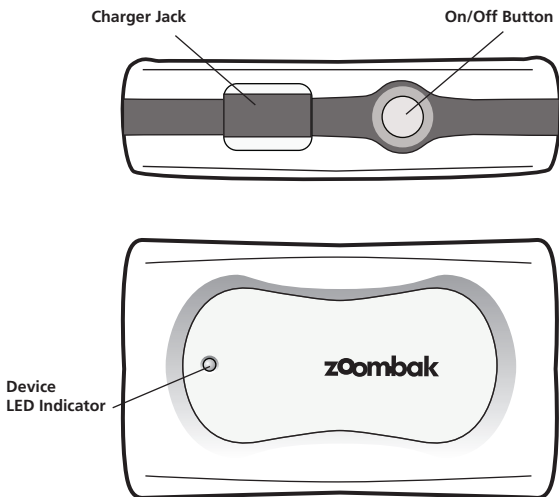

## 2.1.2 Key Functions

- **Charger Jack** – Connects the Zoombak Pet device to the AC wall charger (included).
- **Device Status LED Indicator** – Allows you to monitor (at a glance) the status of your Zoombak Pet device.

## 2.1.3 Device Orientation

For maximum performance, place the device on your pet with the Zoombak logo facing out, with the right-hand side of the device as unobstructed as possible. This will allow the highest level of performance from the embedded GPS antenna.

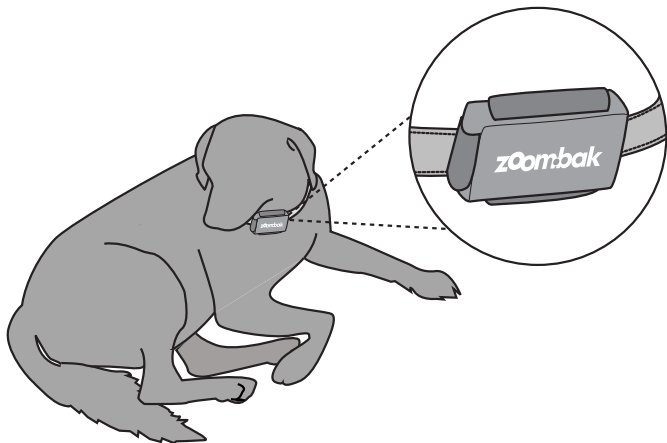

## 2.2 Pet Device Package Contents

When you purchase the Zoombak Pet device, the package should contain, at minimum, the following:

- Zoombak Pet Device
- Zoombak Pet Pouch (to attach the device to the pet's collar)
- AC Wall Charger
- Zoombak Pet Quick Start Guide
- Zoombak Pet Device User Manual



If your device package does not include all of these elements, please return the package to the place of purchase (i.e. retail store, Zoombak Webstore) or visit Zoombak's Customer Care website at <http://www.Zoombak.com> for contact information.

### **3. Using the Pet Device**

This section addresses four primary areas:

- Charging the Battery.
- Turning the Device On/Off.
- Monitoring Device Status.
- Placing the Device on the Pet.



## 3.1 Charging the Battery

Before using the Zoombak Pet device for the first time, you will want to charge the device battery. Follow these simple instructions to charge the battery. The initial battery charge time will be 6 hours; each subsequent battery charge should be less than 4 hours.

1. Remove the Zoombak Pet device and AC wall charger from the Zoombak Pet package.
2. Plug the AC wall charger into a wall outlet.
3. Attach the Zoombak Pet device to the AC wall charger via the Charger Jack on the Zoombak Pet device.
4. The LED Status Indicator will glow solid amber (yellow), indicating that the Zoombak Pet device is charging.
5. Once the LED Status Indicator glows solid green, this will signal that the Zoombak Pet device is fully charged. Do not continue to Section 3.2 until the device is charged.

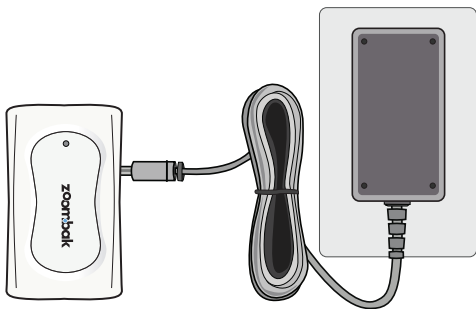

## 3.2 Turning the Pet Device ON/OFF

In order to power the Zoombak Pet device on or off, follow these simple instructions:

1. Press the ON/OFF button on the Zoombak Pet device for two (2) seconds to power up the device. The LED Status Indicator will blink **GREEN**, indicating that the Zoombak Pet device is ON.
2. To turn off the Zoombak Pet device, press the ON/OFF button for two (2) seconds. The LED Status Indicator will not glow, indicating that the Zoombak Pet device is OFF.

## 3.3 Monitoring the Pet Device Status

Refer to the following list in order to determine the status of your Zoombak Pet device at anytime.

BLINKING <b>GREEN</b>	Indicates Power ON
BLINKING <b>AMBER (YELLOW)</b>	Indicates Low Battery
SOLID <b>GREEN</b>	Indicates Fully Charged
SOLID <b>AMBER (YELLOW)</b>	Indicates Charging
NO COLOR	Indicates Power OFF or Battery Dead

### 3.4 Placing the Device on Your Pet

In order for the Zoombak Pet device to locate your pet, the device must be attached to your pet's collar. It is important to note that the Zoombak Pet device is not recommended for pets under 15 lbs. Follow these simple instructions to attach the Zoombak Pet device to your pet's collar:

1. Remove the Zoombak Pet device and Zoombak Pet pouch from the package purchased at the retail store or from Zoombak's webstore.
2. Charge the Zoombak Pet device following the steps in Section 3.1.
3. Once fully charged, turn the Zoombak Pet device on following the steps in Section 3.2.
4. Place the Zoombak Pet device in the Zoombak Pet pouch, as indicated in the following figure.

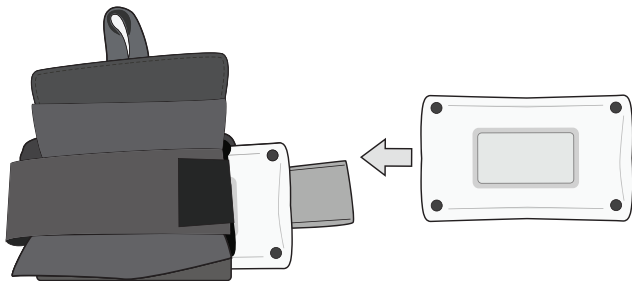

5. Once the Zoombak Pet device is in the pouch, place the Zoombak Pet pouch on your pet's collar, as indicated in the following figure. Please note that the pouch will attach to any type, form or size of collar.

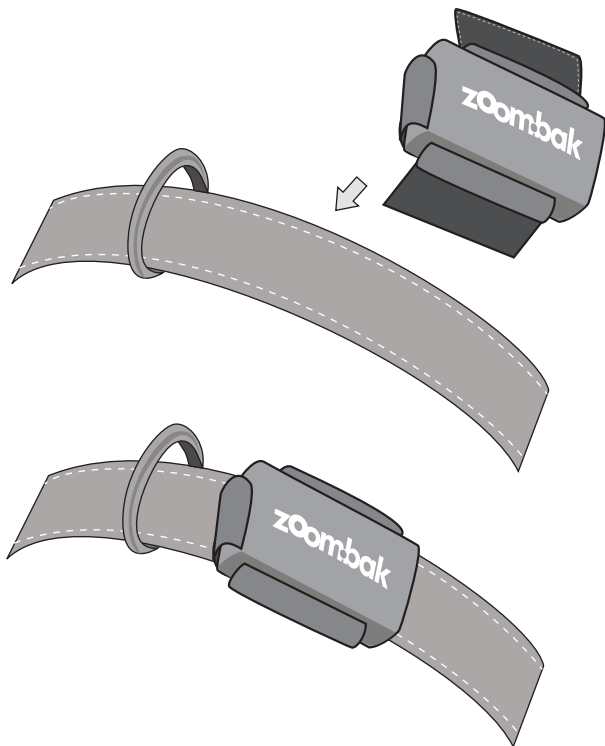

6. To detach the device from your pet, you will simply need to remove the Zoombak Pet device from the pouch, without removing the entire pouch from your pet's collar.

## **4. Safety and Warranty Information**

This section addresses three primary areas:

- Safety Information
- Specific Absorption Rate (SAR)
- Warranty Information

## 4.1 Safety Information

Your Zoombak device contains a Lithium Ion (LI) battery pack. Leakage of ingredients contained within battery pack or the combustion of products of the ingredients can cause personal injury as well as damage to your Zoombak device. If battery leakage occurs avoid contact with skin. If contact occurs, immediately wash thoroughly with soap and water. If liquid leaking from battery pack comes in contact with your eyes, immediately flush thoroughly with water and see a doctor. In case of ingestion, immediately contact your doctor and/or go to the emergency room.

If the battery leaks into your pet's fur, immediately wash the affected area with soap and water and wrap the area to prevent the pet from licking the leakage from their fur. If liquid leaking from the battery pack comes in contact with your pet's eyes, immediately flush them with water and contact your veterinarian. If your pet ingests battery fluid, DO NOT induce vomiting (as this can further damage your pet's GI tract). Should ingestion occur, immediately contact your veterinarian or ASPCA Animal Poison Control center at 1-888-426-4435. Please note that there is a \$55 consultation fee associated with contacting the ASPCA.

To avoid battery leakage:

- Do not expose battery to excessive vibration, physical shock or liquids
- Do not disassemble, attempt to repair or deform the battery
- Do not dispose of battery pack in fire
- Do not peel or damage the battery label

### 4.1.1 Reduction of Hazardous Materials (RoHS)

This device does not contain Lead, Cadmium, mercury, hexavalent chromium, polybrominated biphenyl (PBB) or polybrominated diphenyl ether (PBDE).



## **4.3 Warranty Information**

Connectid, LLC warrants to the original purchaser that the device shall be free from defects in material and workmanship for a period of twelve (12) months from date of purchase. If a defect covered by this warranty occurs during the warranty period Zoombak will repair or replace your device product or component free of charge. The purchaser is entitled to this warranty only if the date of purchase is registered at point of sale or if purchaser can demonstrate that the product was purchased in the last twelve (12) months.

### **4.3.1 Service After Expiration of Warranty**

Please visit our website [www.zoombak.com](http://www.zoombak.com) or call our Customer Assistance hotline at XXX-XXX-XXXX for troubleshooting information and repair or replacement options. In some instances it may be necessary to ship the completed product to Zoombak. Please do not send any products to Zoombak without first contacting our Customer Assistance hotline.



### **4.3.2 Warranty Limitations**

THIS WARRANTY SHALL BE NULL AND VOID IF THIS PRODUCT: (a) IS USED FOR COMMERCIAL PURPOSES; (b) IS MODIFIED, OPENED OR TAMPERED WITH; (c) IS DAMAGED BY NEGLIGENCE, ACCIDENT, UNREASONABLE USE OR OTHER CAUSES UNRELATED TO DEFECT IN MATERIAL OR WORKMANSHIP.

## **4.4 Water Resistance**

The Zoombak Pet Device has a water resistance rating of IPX6. This means the device can not be immersed in water and continue to function, but the device can withstand "strong water jets".

## 5. Contacting Customer Care

Need help with operating your Zoombak device?

Contact Zoombak Customer Service:

[www.zoombak.com](http://www.zoombak.com)

or call: X-XXX-XXX-XXXX, Monday – Sunday 24 hours a day (Times subject to change).

## 6. Device Specifications

This section provides the following detailed device specifications:

- Device
- Certification
- AC Wall Charger

## 6.1 Device

Feature	Specification
Size	72.9 x 43.1 x (19.07 ~ 20.07) mm
Weight	73 grams
Frequency	<div> <div>GSM 900</div> <div>880– 915 MHz (Tx)</div> <div>925– 960 MHz (Rx)</div> </div> <div> <div>GSM 850</div> <div>824 – 849 MHz (Tx)</div> <div>869 – 894 MHz (Rx)</div> </div> <div> <div>GSM 1800</div> <div>1710–1785 MHz (Tx)</div> <div>1805–1865 MHz (Rx)</div> </div> <div> <div>GSM 1800</div> <div>1710–85 MHz (Tx)</div> <div>1805–1865 MHz (Rx)</div> </div> <div> <div>GSM 1900</div> <div>1850–1910 MHz(Tx)</div> <div>1930–1990 MHz(Rx)</div> </div> <div> <div>GSM 1900</div> <div>1850–1910 MHz(Tx)</div> <div>1930–1990 MHz(Rx)</div> </div>
Transmit Power	Up to 2W
Battery Voltage	3.7 v
Operating Temp.	-20o to 60o C
Water Resistance	IPX6

## 6.2 Certifications

CE	FCC
IC	PTCRB
CTIA	ETSI
GCF	UL, UK (battery and charger)

## 6.3 AC Wall Charger

Input: 90 - 264 VAC, 47- 63 Hz
Output: 5.4 VDC @ 1.2A, short-circuit protected
Operating Temperature: -5° to +45° C