

PACKING LIST



- ① 2.4GHz Wireless Camera×1 ② 2.4GHz Wireless Receiver×1
 ③ Antenna for Receiver×1 ④ Adapter for Camera×1
 ⑤ Adapter for Receiver ×1 ⑥ AV Cable ×1

* Only one of the four cameras included in the package.

DIAGRAM

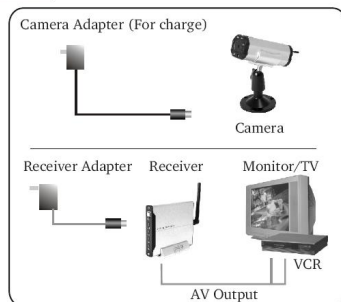

-1-

STRUCTURE

CAMERA

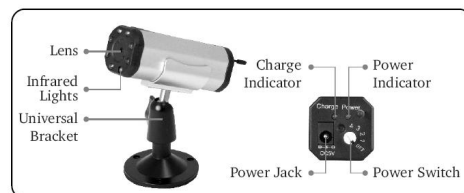

RECEIVER

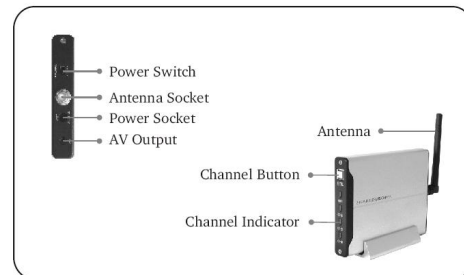

-2-

INSTALLATION

1. Locate the camera to a specific position and then adjust it to a suitable angle.

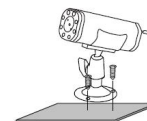

2. Turn on the camera by tuning the power switch from **OFF** to any channel and the power indicator lights up green.

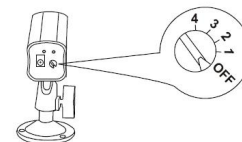

Notes:

- The camera with built-in Li-battery is able to work at least 2 hours continuously and independently anywhere.
- If the battery is dead, please recharge it with the camera adapter (DC 5V 700mA). The charge indicator lights up red during charging and turns dim after a full charge. A full charge will take about 2 hours.
- The power switch must be kept at **OFF** position during charging.



-3-

3. Connect the antenna to the receiver.

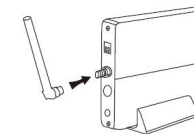

4. Connect the adapter (DC 8V 200mA) to the receiver. Slide the power switch to **ON** position.

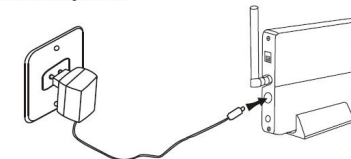

5. Connect the receiver to a monitor/TV with AV cable (yellow for video and red for audio).

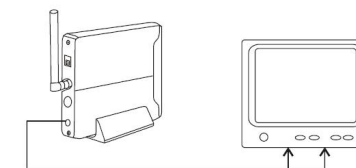

-4-

6. Power on the monitor/TV and select **AV** mode.



7. Set the channel of receiver same as that of camera by pressing the channel button continuously, and the pictures are displayed on the monitor/TV.

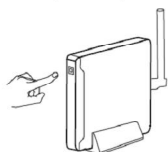

8. Rotate the lens by the focus tuner to adjust the focus for the better display effect (only suitable for 832J and 841J).

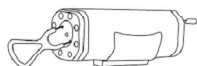

Note: The focus of the camera was set clearly as default.

9. Adjust the brightness, contrast and color of the monitor/TV for the perfect effect.



SPECIFICATIONS

ITEMS	832J	840J	841J	842J
Imaging Sensor	CMOS			
CMOS Total Pixels	628 × 582(PAL); 510 × 492(NTSC)			
View Angle	62°			
Minimum Illumination	0Lux			
Transmission Frequency	ISM 2.400MHz~2.483MHz			
Transmission Power	10mW/CE, 2mW/FCC			
Modulation Type	FM			
Bandwidth	18MHz			
Power Supply	+5V _{DC}			
Battery Type	Lithium Battery			
Battery Capacity	500mAh			
Charge Time	2h			
Working Time	5h	5h(IR OFF) 2h(IR ON)	5h(IR OFF) 2h(IR ON)	5h(IR OFF) 2h(IR ON)
Undistorted Effective Range	100m			
Night Vision Range	Not Available	5m	3m	5m
Dimensions(W × D × H) (mm) (Excluding bracket)	83 × 30 × 75	83 × 30 × 90	25 × 66 × 25	28 × 90 × 28
Weight	120g	120g	100g	110g
Receiving Frequency	ISM 2.400MHz~2.483MHz			
Intermediate Frequency	480MHz			
Demodulation Type	FM			
Antenna	50dBi 30A			
Receiving Sensitivity	< -85dBm			
Video Output Level	1Vp-p@75ohm, 5Vp-p/38dB			
Audio Output Level	1Vp-p@600ohm			
Power Supply	+8V _{DC}			
Consumption Current	180mA			
Dimensions(W × D × H)	100 × 16 × 82 (mm) (Excluding antenna)			
Weight	120g			
Operating Temperature	-10°C~+30°C/+14°F~+122°F			
Storage Temperature	-30°C~+85°C/-22°F~+185°F			
Operating Humidity	85%RH			

* 832J means ZT-832T + ZF709; 840J means ZT-840T + ZF709;

841J means ZT-841T + ZF709; 842J means ZT-842T + ZF709

* Channel Frequency: CH1=2,414MHz; CH2=2,432MHz; CH3=2,450MHz;
CH4=2,468MHz

* Actual transmission range may vary according to weather, location, interference or building construction.

* All the specifications are subject to minor change without prior notice.

EU Environmental Protection

Waste electrical products should not be disposed of with household waste. Please recycle where facilities exist. Check with your Local Authority or retailer for recycling advice.



CAUTIONS

- The apparatus shall not be exposed to dripping or splashing and that no objects filled with liquids, such as vases, shall be placed on the apparatus.
- Turn off the Camera/Receiver if the system is not in use.
- The adapter is used as the disconnect device from the mains. The adapter shall remain readily operable.
- The Camera/Receiver can only be completely disconnected from the mains by unplugging the adapter.
- Do not cut the DC power cable of the apparatus to fit with another power source.

Operation Guide

2.4GHz Wireless Camera Series
with Built-in Li-battery
Model: 832J/840J/841J/842J

FCC Information

This device complies with part 15 of the FCC Rules. Operation is subject to the following two conditions: (1) This device may not cause harmful interference, and (2) This device must accept any interference received, including interference that may cause undesired operation.

CAUTION: Changes or modifications not expressly approved by Summer infant may void the users authority to operate this equipment.

NOTE: This equipment has been tested and found to comply with the limits for a Class B digital device, pursuant to part 15 of the FCC Rules.

These limits are designed to provide reasonable protection against harmful interference in a residential installation. This equipment generates, uses and can radiate radio frequency energy and, if not installed and used in accordance with the instructions, may cause harmful interference to radio communications. However, there is no guarantee that interference will not occur in a particular installation. If this equipment does cause harmful interference to radio or television reception, which can be determined by turning the equipment off and on, the user is encouraged to try to correct the interference by one or more of the following measures:

- Reorient or relocate the receiving antenna
- Increase the separation between the equipment and the receiver
- Consult the dealer or an experienced radio / TV technician for help.