

# AV Adapter User Manual

Model: BlueTone™BTAV201

## **Declaration:**

**Without written permission from original manufacturer, reproduction, transfer, distribution or storage of part or all of the contents in this document in any form is prohibited.**

**The company reserves rights to make any changes and improvements to the product described in this document without prior notice.**

This device complies with part 15 of the FCC Rules. Operation is subject to the following two conditions: (1) This device may not cause harmful interference, and (2) this device must accept any interference received, including interference that may cause undesired operation.

## **FEDERAL COMMUNICATIONS COMMISSION INTERFERENCE STATEMENT**

This equipment has been tested and found to comply with the limits for a Class B digital device, pursuant to part 15 of the FCC Rules. These limits are designed to provide reasonable protection against harmful interference in a residential installation. This equipment generates, uses and can radiate radio frequency energy and, if not installed and used in accordance with the instructions, may cause harmful interference to radio communications. However, there is no guarantee that interference will not occur in a particular installation. If this equipment does cause harmful interference to radio or television reception, which can be determined by turning the equipment off and on, the user is encouraged to try to correct the interference by one or more of the following measures:

- Reorient or relocate the receiving antenna.
- Increase the separation between the equipment and receiver.
- Connect the equipment into an outlet on a circuit different from that to which the receiver is connected.
- Consult the dealer or an experienced radio/ TV technician for help.

### **CAUTION:**

Any changes or modifications not expressly approved by the grantee of this device could void the user's authority to operate the equipment.

## **RF exposure warning**

The equipment must be installed and operated in accordance with provided instructions and the antenna(s) used for this transmitter must be installed to provide a separation distance of at least 20 cm from all persons and must not be co-located or operating in conjunction with any other antenna or transmitter. End-users and installers must be provided with antenna installation instructions and transmitter operating conditions for satisfying RF exposure compliance.

### **Warning:**

**Users should not make changes or modify the device in any way. Changes or modifications without expressly approved by the party responsible for compliance could void the user's authority to operate the device.**

## ----- Introduction -----

### Bluetooth Technology

Bluetooth is an internationally standardized technology supporting short distance wireless communications. Any two Bluetooth-compatible equipments, such as mobile phone, PDA、PC, headset, mouse, keyboards, printer, etc. can wirelessly communicate with each other via Bluetooth connection. To ensure worldwide compatibility, Bluetooth operates on the globally available ISM (Industrial Scientific and Medical) frequency band. Within 2.4 GHz and 2.48 GHz, Bluetooth transmits data up to either 10 meters (CLASS II mode) or 100 meters (CLASS I mode) using 79 frequency hopping channels.

Though line-of-sight is not required, Bluetooth connections could be subject to interferences from obstructions such as walls, human bodies, and other electronic devices. In addition, due to variations on product implementation, it is likely that Bluetooth equipments from different manufactures have interoperability issues. In that case, you may consult with manufactures to check product compatibility.

**Note** that, there could be some restrictions imposing on using Bluetooth devices in some countries. Please check with your local authorities.

### Product Features

- ❖ Bluetooth 2.0 specification compliant, interference-tolerable with WLAN devices
- ❖ Class I, operation range up to 100 meters (330 feet)
- ❖ As a multi-mode Bluetooth AV adapter, it supports transmitter mode and receiver mode
- ❖ In transmitter mode, it can be used with any multimedia player with stereo output, and send the music to the Bluetooth-enabled speakers or headsets.
- ❖ In receiver mode, it can be used with any speaker system with stereo input, and accept the music from Bluetooth multimedia devices
- ❖ Data rate up to 721 Kbps
- ❖ User friendly and plug-and-play

### Overview

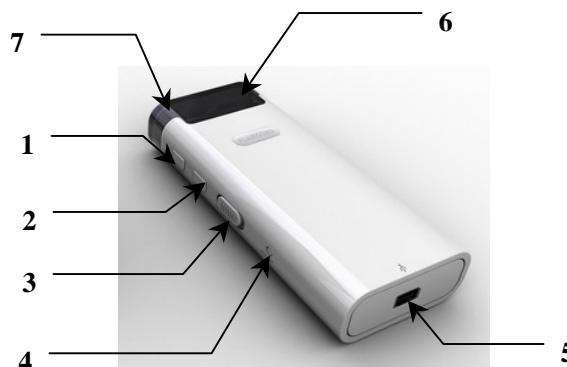

Figure 1 Overview

1. **On/off**, to turn on/off the device.
2. **Pair**, to activate the pairing mode of the device.
3. **Receive/Transmit**
4. **Reset**
5. **8-pin USB port**, to connect the charging cable or line-in/line-out cable.
6. **Red LED**, to indicate that the device is in transmitter mode or in charging mode.
7. **Blue LED**, to indicate that the device is in receiver mode.

## Accessory

There is a multifunctional connecting cable in the package (referring to Figure 2). One side of the connecting cable is an 8pin USB port which can be connected to the adapter. The other side of the connecting cable has three ports. They are USB port, Line-in port, and Line-out port.

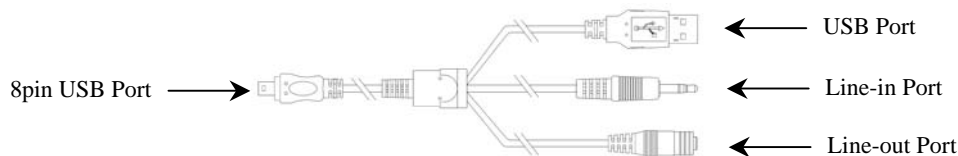

Figure 2 Multifunctional Connecting Cable

Please refer to following sections for details of using.

## ----- Getting Started -----

### Battery Charging and Usage

This device contains a rechargeable Li-Polymer battery. The charging time is about two hours.

Connect the 8pin USB port of the multifunctional connecting cable to the bottom of the adapter, and then plug the travel charger to the power outlet to start charging. During charging, the red LED is always on.

You can also use the USB port of connecting cable for charging the device from your PC, which will take longer to charge as the power output of the USB port is lower than it is with the car charger.

Once the battery is fully charged, it can provide up to four hours of work time and up to 150 hours of standby time.

### Turning on and off

#### Turning on

Press and hold button **On/off** for at least three seconds, and the LED will be on. This indicates the adapter is power on.

When the adapter is power on, the red LED blinks five times per second in transmitter mode, and the blue LED blinks once every two seconds in receiver mode.

### Turning off

When the adapter is power on, press and hold button **On/off** for at least three seconds, and the LED will be off. This indicates the adapter is power off.

### Mode Choosing

This AV adapter is a multi-mode adapter. It can be used in either transmitter mode or receiver mode. You can switch two modes by using button **Receive/Transmit**.

#### Transmitter mode

When the adapter is power off, push button **Receive/Transmit** upwards to adjust the adapter to transmitter mode. After power on and completing pairing, the adapter can be connected with any multimedia player with stereo output such as MP3, PSP, WALKMAN/DISKMAN, and etc. through the line-in port of the multifunctional connecting cable (referring to Figure2). And the music will be sent to the Bluetooth-enabled speakers or headsets (referring to Figure 3).

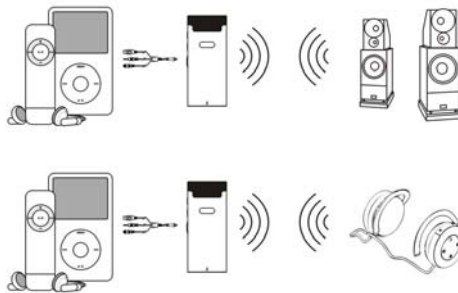

Figure 3 Connect with Multimedia Player

#### Receiver mode

When the adapter is power off, push button **Receive/Transmit** downwards to adjust the adapter to receiver mode. After power on and completing pairing, the adapter can be connected with any speaker system with stereo input through the line-out port of the multifunctional connecting cable (referring to Figure2). And the music will be received from Bluetooth multimedia devices, such as Bluetooth handset (referring to Figure 4).

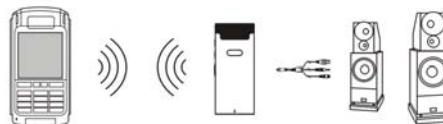

Figure 4 Connect with Speaker System

You can switch the transmitter and receiver modes by pushing button **Receive/Transmit** upwards or downwards. The adapter can work in only one mode at a time.

### Note

*Before pairing or connecting, you must choose the right mode for the adapter. It is recommended to choose the mode when the adapter is power off. Otherwise, the adapter will turn off after the mode is set and you have to turn it on again.*

## Pairing

Short press button **Pair**. If the LED blinks five times per second, it is an indication that the adapter has successfully entered the pairing mode.

Place another Bluetooth device which has also entered the pairing mode close to the adapter. These two Bluetooth devices will search for each other to complete the pairing procedure. (For how to activate the pairing mode of the other Bluetooth device, you can refer to its user guide.)

When the adapter is used to connect a handset, the handset will search for the adapter, and show the device name **BTAV201** on the screen of the headset. Confirm the pairing as the handset requests, and then enter passkey '0000' on the phone side to complete the pairing procedure. (For how to activate the pairing mode of the handset, you can refer to its user guide.)

If the pairing is successful, the device enters the connected mode, and the LED blinks once per second.

The device will remain in the pairing mode for one minute. If pairing cannot be finished within one minute, the device will enter into the standby mode (without Bluetooth connection in this case), and the LED will change to blink once every two seconds.

## Using Two Adapters of This Model Together

This AV adapter is a multi-mode adapter. However, it can work in only one mode at a time. That is, it cannot send and receive audio signals at the same time.

By using two adapters of this model together, it can help two Bluetooth-unable devices establish wireless communication (referring to Figure 5). In this case, you can adjust one adapter to transmitter mode and connect it with the line-in cable, and adjust the other adapter to receiver mode and connect it with the line-out cable.

For details of the pairing and connecting between the two adapters, refer to the previous section.



Figure 5 Connect with two Bluetooth-unable Devices

## Reset

There is a reset button located on one side of the device. Pressing the button by using a sharp pin can bring the adapter back to normal operation. After resetting, you must turn on the adapter again to use it.