

SCUD TECHNOLOGY WIRELESS PROFESSIONAL

***SBT<sup>2</sup>2008***  
***BLUETOOTH EARPHONE***

***SBT<sup>2</sup>2008***  
***BLUETOOTH EARPHONE***

**USER'S GUIDE**

## CONTENTS

<b>Brief Introduction</b> .....	<b>3</b>
Bluetooth	
Bluetooth Earphone	
General Features	
<b>Operation</b> .....	<b>6</b>
Charge	
Keypads function	
Switch On/Off	
Matching	
Dialing and receiving	
Connect PC and PDA	
<b>Important Info</b> .....	<b>10</b>
Troubleshooting	
Maintenance	
Charger	
Wired Earphone	
Battery Info.	
<b>List</b> .....	<b>15</b>

## **Brief Introduction**

### **■ What is Bluetooth?**

Bluetooth technology is a cutting-edge open specification that enables short-range wireless connections between desktop and notebook computers, personal digital assistants, mobile phones, camera phones, printers, digital cameras, headsets, keyboards and even a computer mouse. Bluetooth wireless technology uses a globally available frequency band (2.4GHz) for worldwide compatibility. In a nutshell, Bluetooth technology unplugs your digital peripherals and makes cable clutter a thing of the past.

Bluetooth technology, invented according to the global standard and specialized for the global-recognized frequency bandwidth ISM(Industrial Scientific and Medical), is designed for transmitting the digital information under the bandwidth of 2.4GHz~2.48GHz divided into 79 channels, with the frequency of 1600 hops per second, covering a range of 10cm~10m .

### **Bluetooth Earphone**

Bluetooth Earphone is designed with the latest specialized technology for wireless sound transmission. It can be connected with other Bluetooth devices, such as cell phones, PCs, laptops, PADs within 15m range.

**Caution:**

Changes or modifications to this unit not expressly approved by the party responsible for compliance will void the user's authority to operate the equipment. Any change to the equipment will void FCC grant.

**Note:** This equipment has been tested and found to comply with the limits for a Class B digital device, pursuant to part 15 of the FCC Rules. These limits are designed to provide reasonable protection against harmful interference in a residential installation. This equipment generates, uses and can radiate radio frequency energy and, if not installed and used in accordance with the instructions, may cause harmful interference to radio communications. However, there is no guarantee that interference will not occur in a particular installation. If this equipment does cause harmful interference to radio or television reception, which can be determined by turning the equipment off and on, the user is encouraged to try to correct the interference by one or more of the following measures:

—Reorient or relocate the receiving antenna.

—Increase the separation between the equipment and receiver.

—Connect the equipment into an outlet on a circuit different from that to which the receiver is connected.

—Consult the dealer or an experienced radio/TV technician for help.

Modifications not authorized by the manufacturer may void users authority to operate this device.

This device complies with part 15 of the FCC Rules. Operation is subject to the following two conditions: (1) This device may not cause harmful interference, and (2) this device must accept any interference received, including interference that may cause undesired operation.

This equipment complies with FCC radiation exposure limits set forth for an uncontrolled environment.

■ **General Features**

Bluetooth Specification	Bluetooth 1.1 version
Profiles Supported.	Headset and Hands Free
Transmission scope Class	Class 2
Supporting transmission packet	HV1/HV2/HV3
Supporting frequency-hopping mode	USA/EU (79 channel)
Sensitivity	<-80dBm@0.1%BER
Output power	-8.0dBm
Frequency range	(2.402~2.480)GHz
Size	60.5mm×26.0mm×21.0mm
Call Time	4 hours
Standby Time	100 hours
Recharge Battery	120 mAh/3.7V

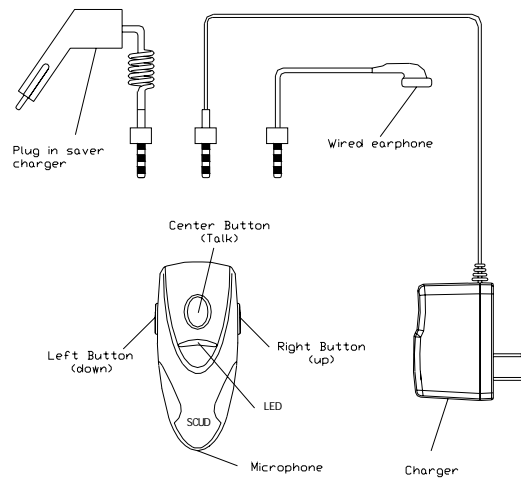

Schematic Diagram

## **Operation**

### **■ Charge**

There is the chargeable battery in the earphone. It needs for 3 hours to be charged fully when used for the first time, and then it will take about 2~3 hours to charge each time. Communication time will last for about 4~5 hours and the standby time is about 100 hours when the battery has been charged fully.

1.Connecting the charger to a socket (or connect the car-used charger with the cigarette plug in the car), the indicator will be turned on as red. (Don't use the car-used charger for the first time).

2.Connect the charger with earphone as the picture shows, it is charging at this moment.

3.When the power is full, the red indicator on the charger will become green slowly.

### **■ Keypads Function**

This Bluetooth earphone supports two kinds of profile, which is operated through three keypads showed as follows. The profile is selected depending on the terminal cell-phone. It cannot be altered after being selected. Please consult the manual that the cell-phone manufacturer offers.

#### **Headset Profile:**



State	TALK Button		Volume adjustable button	
	Short press	Hold press	Short press	Hold press
Power off	–	Power On	–	–
Standby	Voice dial	Power Off	–	–
Voice Dial	Cancel	Power Off	–	–
Ringing	Answer	Power Off	–	–
Communication	End a call	Power Off	Adjust volume	Mute

**Hands Free Profile:**

State	TALK Button		Volume adjustable button	
	Shot press	Hold press	Shot press	Hold press
Power Off	–	Power On	–	–
Standby	Voice dial	Power Off	Adjust volume	Re-dialed last call No.
Voice Dial	Cancel	Power Off	–	–
Ringing	Answer	Refuse calls	–	–
Communication	End calls	Transfer to mobile	Adjust volume	Mute

■ **Switch ON/OFF**

1.To switch on the earphone: Pressing TALK for about

5 seconds would lead the earphone to work when the LED indicator twinkles green for 5 times.

2.To switch off the earphone: Pressing TALK for about 3 seconds, it will be off when the red LED indicator twinkles for 5 times and the red、 green indicator both don't show.

3.The green indicator's twinkling once per 3 seconds means under standby. And the twinkling of red indicator shows the insufficient power (Red、 Green indicator keep off when the power is insufficient).

#### ■ **Matching**

Before using the earphone, you must match it with your mobile phone or other Bluetooth devices.

1.The earphone must be off before matching. To start matching, press TALK for about 9 seconds till the red light and the green light shine alternately.

2. The specification of Bluetooth phone would give the details of starting the matching program with the Bluetooth earphone. After searching, a new option of "SUCD010" would show in the Bluetooth device list.

3.You will be required to enter Pin-code of 0000, and press CONFIRM to finish the matching program.

(NOTE: 0000 is the pre-setting Pin-code in earphone)

#### **Attention:**

1. When the earphone isn't in the matching mode, your mobile could not search it. Make sure that the earphone is in matching mode before searching.

2. The matching mode will last for about 2 minutes. If matching is still not finished within 2 minutes, the earphone will be off automatically.

■ **Dialing and receiving**

■ After the matching, you can dial or receive calls with earphone. This earphone device supports voice dialing. If your mobile have this function, you can operate it according to the mobile instruction.

■ **Dialing**

1.By Voice: Press TALK key, and say the name who you' d like to call when there' s a warning tone.

2.By keypads of mobile: Dial with keypad as usual, then it would transfer automatically to earphone.

3.Re-dialing: Holding press voice-adjusted button can re-dial the former call number.

4.The in-call can be refused by holding press TALK key. This function is available for the mobile supported hand-free.

■ **Receiving and ending**

1.When earphone is on and the in-call comes, you will hear music from the earphone. And the blue indicator will shine twice per3 seconds. Press TALK and answer the phone.

2.Volume can be adjusted during the conversation by pressing the volume button.

3.To finish the conversation, pressing TALK button or no one.

4. If the earphone is off when the in-call comes, hold press TALK to switch on, then press TALK again to answer the phone.

■ **Mute**

Please hold press volume-adjusted button to switch on mute function.

■ **Low power**

The red indicator on the earphone shines to show the battery power is insufficient. Please charge it asap..

**Important Info**

■ **Troubleshooting**

1.Red indicator shines

It shows that the battery power is insufficient, charge it asap.

2.Can' t be switched on after charging 30 minus.

At-least 40-mins charging is needed for the first time.

3.No sound from earphone

○Ensure the earphone has finished matching with other Bluetooth devices.

○Ensure the earphone is power on.

○Ensure the earphone and the matched device are within 15 meters.

○Ensure your mobile is in good receiving situation

○Some Bluetooth mobile can only support one earphone set , if you match it with more than two sets, the other one would be no

signal.

4. Why the mobile and earphone work abnormally under full battery power and power on.

○ Ensure your mobile is with Bluetooth technology and the matching program has been finished.

5. Whether Bluetooth earphone is applicable to all mobile?

○ No. Bluetooth earphone is applicable to headset & handsfree mobiles with Bluetooth technology only.

6. What's the transmission distance between mobile phone and earphone?

○ This earphone item has won Bluetooth international approval BOB, and it is completely accorded with Bluetooth 1.1 version & specification of CLASSII. The max. range reaches 10 meters. But the environment and quality of your mobile phone would affect the communication range.

7. Why other Bluetooth devices appear in my mobile list when the earphone and mobile phone are being matched?

○ When the mobile phone with Bluetooth function is matching, it will also search out other bluetooth mobile phones (eg. PDA, NB). And "SCUD010" would show in the mobile list.

8. Why can't my mobile phone find my earphone when matching?

○ If your earphone is not in matching mode, the mobile can not search it. Please set your earphone to be in matching mode before you match it with your mobile phone. (Regarding how to set the matching pattern, please refer to "Matching" item)

9. Is it necessary to match the mobile phone

and the earphone every time ?

○No. The matching between the mobile phone and the earphone is only once. After that, no rematch is necessary even one of them is disconnected from outlet.

10. Why there's noise with my Bluetooth earphone?

○The communication quality may be affected by the following two factors:

○If your mobile is not in a good receiving situation, the communication will be relatively bad.

○Noise will be a little bit louder if the distance between mobile and earphone is beyond the certain scope.

11. What shall I do if I can't hear clearly with the earphone?

○Adjust the volume of mobile phone or earphone. Meanwhile, check and see that your mobile phone is in the good receiving situation.

12. Why my earphone doesn't work suddenly?

○Maybe it is out of power. When it is in low power, the red indicator shines.

13. Why voice dialing of earphone doesn't work?

○You should record the voice tag with earphone first.

14. Why the receiving way is different from each mobile phone?

○It's because of the different design of the Bluetooth

software by each mobile manufacturer.

### **Maintenance**

○ Using non-original accessories may result in the descend of the function of product, or confliction of electrical and failure of guarantee repair.

○ Do not disassemble earphone. It may destroy the product or cause the failure of guarantee repair.

○ Don't put it in the dusty place

○ Clean earphone surface with soft and clean cloth.

○ Put it in pocket when not used.

○ Keep it away from children. It may be destroyed by children's improper setting.

○ Don't put it in the too high or low temperature.

### ■ **Charger**

○ The charger is designed specially for using indoor. Please don't use it outdoor.

○ Charger must be connected with proper power supply.

○ To unplug charger from the wall outlet, grasp the charger itself but not the cord.

### ■ **Wired Earphone**

○ Wired earphone's connection with Bluetooth earphone also achieves communication.

○ If communicate by wired earphone the bluetooth earphone must be put higher than the waist (Better to put it parallel to your upper half pocket).

### ■ **Battery Info**

○ For new battery, charge it for at least 4 hours every time until it's fully charged.

■ **Battery Maintenance:**

▲ The battery can't be replaced by anyone except qualified service personnel.

▲ The battery can reach an extreme long life by normal use.

▲ The ambient temperature should be between  $-10^{\circ}\text{C}$  ~  $45^{\circ}\text{C}$  when being charged.

▲ The capacity of battery can reach a maximum when used in ambient temperature.

▲ Battery power will descend if used in a low temperature.

▲ If you don't use the earphone for a long time, charge it at least once a month.

■ **About Matching**

Matching is a process of connecting two Bluetooth devices. It will establish a permanent safe connection and transmit data rapidly between these two matched devices. There's no need to insert password in every data.

■ **Bluetooth PIN-code**

Each Bluetooth Earphone pre-set an identification code 0000. When matching the earphone with other Bluetooth devices, you are required to enter Identification Code 0000. Pre-setting way may be different



from each phone factory, so please set it according to the mobil instruction. Matched device will keep the matching program though the following circumstances happen:

- One of devices is power off;
- one of devices interrupt or stop service;
- Any device is re-started.

**List**

- ★ Bluetooth Earphone
- ★ Fashionable pocket for Bluetooth earphone
- ★ 100V/240V charger
- ★ Cigarette Plug (choose and buy)
- ★ Wired Earphone
- ★ Ear-hanger
- ★ Sponge Bag
- ★ Instruction Manual