



*Metal*  
VW



**NEW BEETLE**

**PROPORTIONAL RADIO CONTROL**  
MODEL GRADE DETAIL  
WHEELS SPRING SUSPENSION  
CONTROL UP TO 3 CARS WITH TRI-BAND

**1:32**

## Use The Manual

### Caution

- Do not combine the use of new and old batteries.
- Do not combine the use of different types of batteries.
- Make sure the batteries are installed with the correct polarity in the battery compartment.
- Operate the vehicle on smooth surface. Do not operate through puddles of water, on sand, thick carpet or dusty environment that will damage the vehicle and electronic parts.
- Do not operate the vehicle with the same frequency of other player in the same area that will interfere the frequency and make the vehicle out of control.
- Do not store the transmitter and vehicle in a location of high temperature or high humidity. Do not store the product under direct sunlight.
- Do not attempt to disassemble or solder the transmitter and vehicle.
- Non-rechargeable batteries are not to be recharged.
- Rechargeable batteries are only to be charged under adult supervision.
- Rechargeable batteries are to be removed from the toy before being charged.

### Content

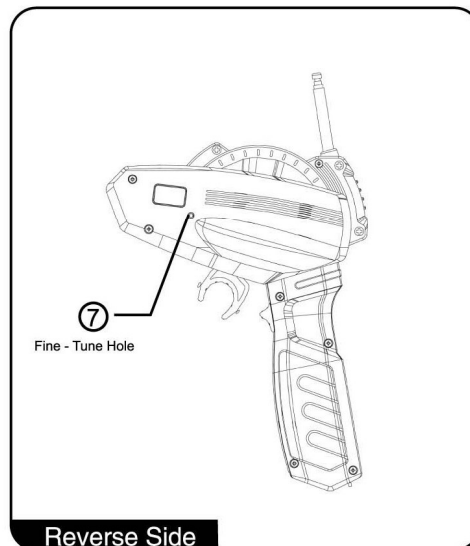
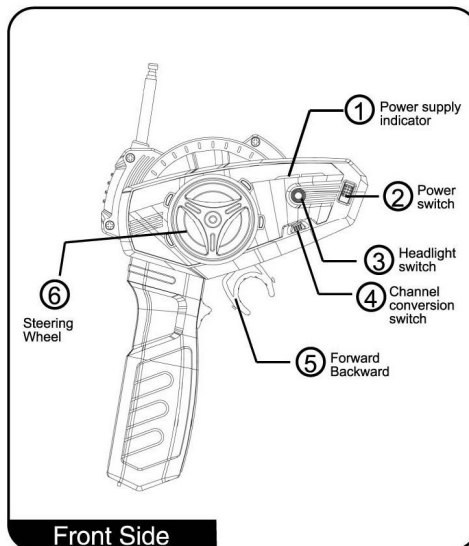

## Operation

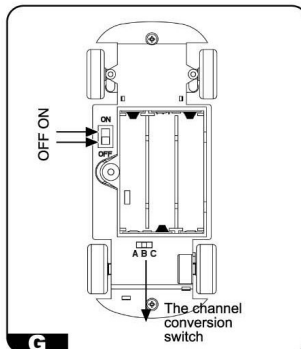
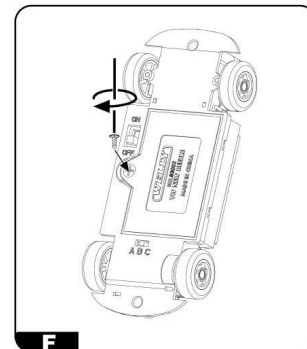
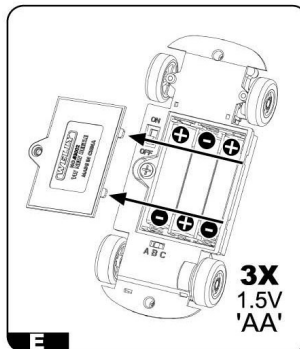
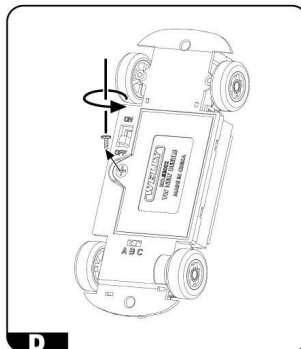
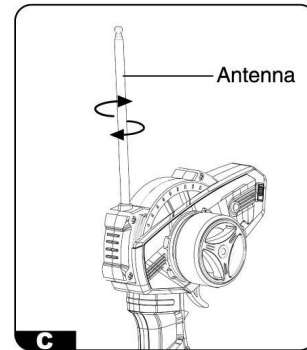
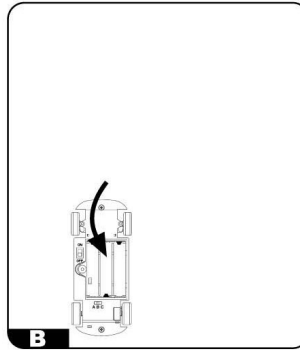
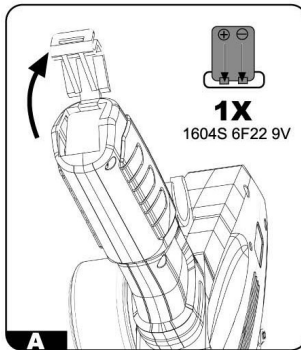

## Remarks

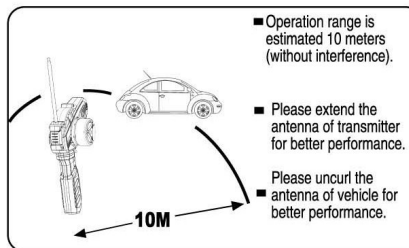

■ Operation range is estimated 10 meters (without interference).

■ Please extend the antenna of transmitter for better performance.

■ Please uncurl the antenna of vehicle for better performance.

FCC ID:  
MADE IN CHINA

The device complies with part 15 of the FCC Rules.

Operation is subject to the following two condition:

- (1) this device may not cause harmful interference, and
- (2) this device must accept any interference received, including interference that may cause undesired operation.

## Countries Intended For Use

■ Austria	■ France	■ Ireland	■ Estonia	■ Malta	■ Sweden
■ Belgium	■ Cyprus	■ Italy	■ Hungary	■ The Netherlands	■ United Kingdom
■ Denmark	■ Slovenia	■ Luxembourg	■ Latvia	■ Slovakia	■ Greece
■ Finland	■ Germany	■ Portugal	■ Lithuania	■ Spain	■ The Czech Republic

■ Hereby, Welly Die Casting Fly Ltd., declare that this 1:32 R/C Car is in compliance with the essential requirements and other relevant provisions of Directive 1999/5/EC.

■ Two frequencies (27MHz, 40MHz) are available for this product.

■ Please refer the frequency stated on the product or box for actual frequency.

## FCC Statement

NOTE: This equipment has been tested and found to comply with the limits for a Class B digital device, pursuant to Part 15 of the FCC Rules. These limits are designed to provide reasonable protection against harmful interference in a residential installation. This equipment generates, uses and can radiate radio frequency energy and, if not installed and used in accordance with the instructions, may cause harmful interference to radio communications. However, there is no guarantee that interference will not occur in a particular installation. If this equipment does cause harmful interference to radio or television reception, which can be determined by turning the equipment off and on, the user is encouraged to try to correct the interference by one or more of the following measures:

- Reorient or relocate the receiving antenna.
- Increase the separation between the equipment and receiver.
- Connect the equipment into an outlet on a circuit different from that to which the receiver is connected.
- Consult the dealer or an experienced radio/TV technician for help.

**Warning:** Changes or modifications to this unit not expressly approved by the party responsible for compliance could void the user's authority to operate equipment.

## Warning

- The supply terminals are not to be short-circuited.
- Avoid water damage to transmitter and vehicle. If they get wet, stop operating immediately and wait until they completely dry.
- Do not dispose batteries in fire that may cause explosion.
- If liquid leaking from the batteries stick to your skin or clothes, wash off immediately. If liquid get into your eyes, wash your eyes with distilled water and consult a physician immediately.



*Metal*

**SUBARU  
IMPREZA WRC**



**PROPORTIONAL RADIO CONTROL**

MODEL GRADE DETAIL WHEELS SPRING SUSPENSION CONTROL UP TO 3 CARS WITH TRI-BAI

**1:34**

## Use The Manual

### Caution

- Do not combine the use of new and old batteries.
- Do not combine the use of different types of batteries.
- Make sure the batteries are installed with the correct polarity in the battery compartment.
- Operate the vehicle on smooth surface. Do not operate through puddles of water, on sand, thick carpet or dusty environment that will damage the vehicle and electronic parts.
- Do not operate the vehicle with the same frequency of other player in the same area that will interfere the frequency and make the vehicle out of control.
- Do not store the transmitter and vehicle in a location of high temperature or high humidity. Do not store the product under direct sunlight.
- Do not attempt to disassemble or solder the transmitter and vehicle.
- Non-rechargeable batteries are not to be recharged.
- Rechargeable batteries are only to be charged under adult supervision.
- Rechargeable batteries are to be removed from the toy before being charged.

### Content

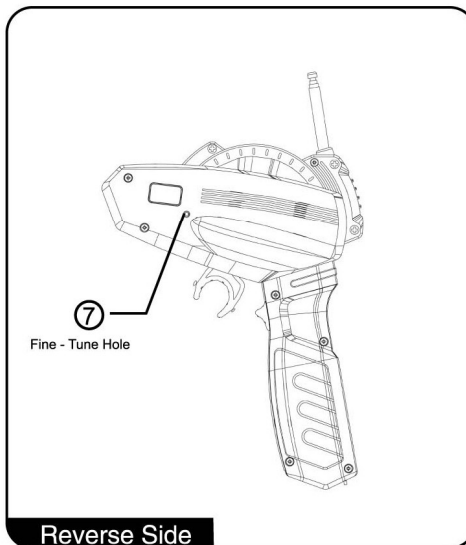
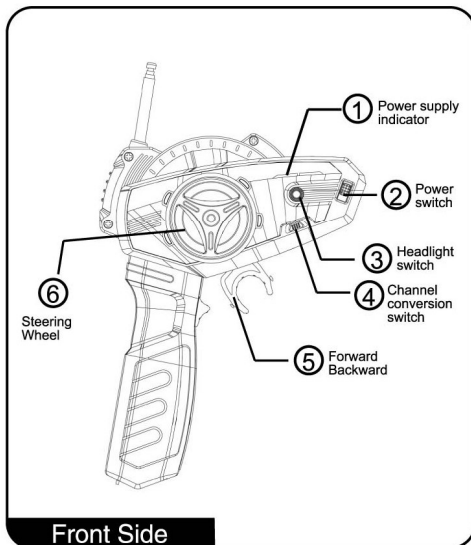

## Operation

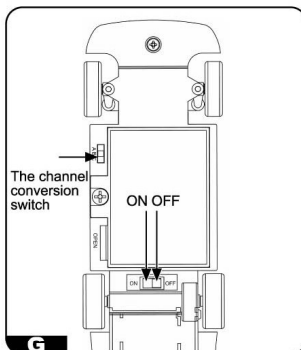
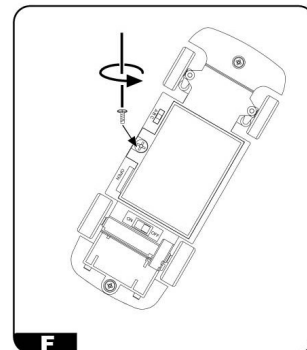
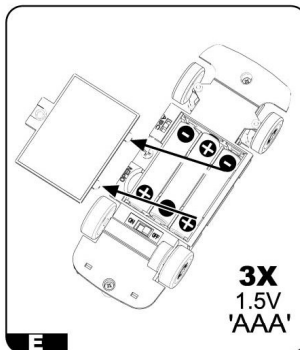
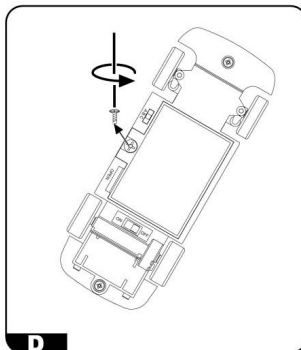
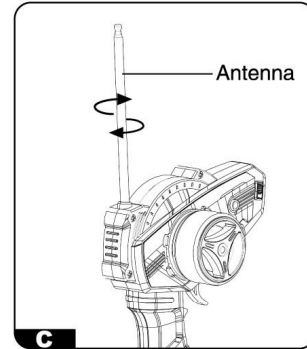
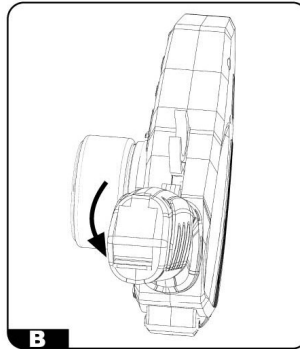
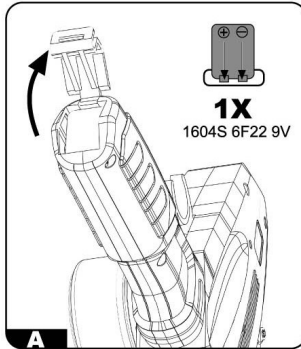

## Remarks

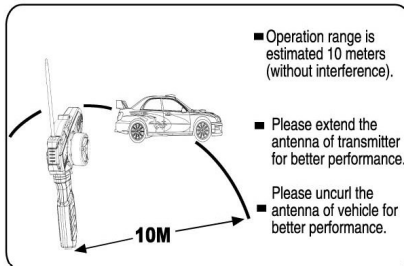

■ Operation range is estimated 10 meters (without interference).

■ Please extend the antenna of transmitter for better performance.

■ Please uncurl the antenna of vehicle for better performance.

FCC ID:  
MADE IN CHINA

The device complies with part 15 of the FCC Rules. Operation is subject to the following two condition:  
(1) this device may not cause harmful interference, and  
(2) this device must accept any interference received, including interference that may cause undesired operation.

## Countries Intended For Use

■ Austria	■ France	■ Ireland	■ Estonia	■ Malta	■ Sweden
■ Belgium	■ Cyprus	■ Italy	■ Hungary	■ Poland	■ The Netherlands
■ Denmark	■ Slovenia	■ Luxembourg	■ Latvia	■ Slovakia	■ United Kingdom
■ Finland	■ Germany	■ Portugal	■ Lithuania	■ Spain	■ Greece
					■ The Czech Republic

■ Hereby, Welly Die Casting Fty.Ltd., declare that this 1:34 R/C Dirt Machines is in compliance with the essential requirements and other relevant provisions of Directive 1999/5/EC.

■ Two frequencies (27MHz, 40MHz) are available for this product.

■ Please refer the frequency stated on the product or box for actual frequency.

## FCC Statement

NOTE: This equipment has been tested and found to comply with the limits for a Class B digital device, pursuant to Part 15 of the FCC Rules. These limits are designed to provide reasonable protection against harmful interference in a residential installation. This equipment generates, uses and can radiate radio frequency energy and, if not installed and used in accordance with the instructions, may cause harmful interference to radio communications. However, there is no guarantee that interference will not occur in a particular installation. If this equipment does cause harmful interference to radio or television reception, which can be determined by turning the equipment off and on, the user is encouraged to try to correct the interference by one or more of the following measures:

- Reorient or relocate the receiving antenna.
- Increase the separation between the equipment and receiver.
- Connect the equipment into an outlet on a circuit different from that to which the receiver is connected.
- Consult the dealer or an experienced radio/ TV technician for help.

**Warning:** Changes or modifications to this unit not expressly approved by the party responsible for compliance could void the user's authority to operate equipment.

## Warning

- The supply terminals are not to be short-circuited.
- Avoid water damage to transmitter and vehicle. If they get wet, stop operating immediately and wait until they completely dry.
- Do not dispose batteries in fire that may cause explosion.
- If liquid leaking from the batteries stick to your skin or clothes, wash off immediately. If liquid get into your eyes, wash your eyes with distilled water and consult a physician immediately.

**NOTE:**

THE MANUFACTURER IS NOT RESPONSIBLE FOR ANY RADIO OR TV INTERFERENCE CAUSED BY UNAUTHORIZED MODIFICATIONS TO THIS EQUIPMENT. SUCH MODIFICATIONS COULD VOID THE USER AUTHORITY TO OPERATE THE EQUIPMENT.)