

UHF Wireless Amplifier

User Manual of AUH210



AUH210

AUR210

AUT210

Safety Guidelines

Important Information

This manual contains notices which you should observe to ensure your own personal safety, as well as to protect the product and connected equipment. They are marked as follows according to the level of danger.

Warning Indicates that death, severe personal injury or substantial damage to property will or can result if proper precautions are not taken.





Notes Indicates that personal injury or property can result if proper precautions are not taken.





Warning

 High voltage inside. Only qualified personal should be allowed to maintain, repair and refit the machine to avoid the happenness of some abnormal situations and other dangers.

 If not using, please plug out the power outlet of the receiver and shut off the AC power supply.

 When being short of voltage, the receiver should be recharged in time otherwise it will influence the life span of the accumulator inside.

 When plugging out the power line of the receiver, press the power pin tightly and then plug. Do not plug the power line directly to avoid the snapping of the power line.

 Do not knot or break the power line, so as to avoid the generation of fire and electrocute.

 If getting drenched or some liquid flowing into the machine, the machine should not be operated. Please return the machine to the qualified personal for test.

Notes

 Please clean the machine by dry soft cloth. Do not use gasoline, diluent or other chemical products.

If planning no usage of the transmitter or the microphone for months, take out the batteries to avoid the leaking of the battery attaint the transmitter.

No using of the receiver for long time, please recharge it full once three month.

Please do not knot or pull the line when Lavalier Mic or Headset Mic is used.

FCC Notes



This equipment complies with Part 74 of the FCC Rules.

A license is required for operation subjective device will be issued only to the following:

- (1) A licensed of an AM, FM, TV or international broadcast station or low power TB station. Low power auxiliary stations will be licensed for used with a specific broadcast or low power TV station or combination of stations licensed to the same licensee within the same community.
- (2) A broadcast net work entity.
- (3) A cable television system operator who operates a cable system that produces program material for origination or access cable-casting as defined in § 76.5(r).
- (4) Motion picture producers as defined in § 74.801
- (5) Television program producers as defined in § 74.801
- (6) Licensees an conditional licensees of stations in the Multipoint Distribution service and Multichannel Multipoint Distribution Service as defined in § 21.2 of this chapter, or entities that hold an executed lease agreement with an MDS or MMDS licensee or conditional licensee or with and Instructional Television Fixed service licensee or permitted.

CAUTION



Any changes of modifications not expressly approved by the grantee of this device could void the users authority to operate the equipment.

I. Part Names, Functions and Battery Installation of the Handheld Microphone(AUH210):

1.Part Names and Functions

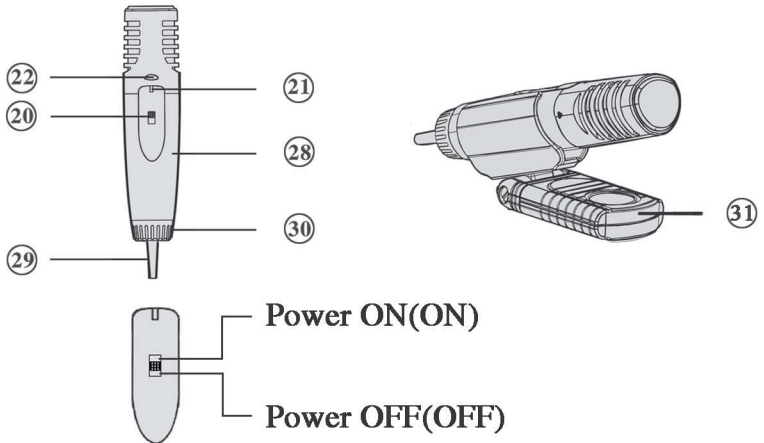

- ②⑦ Microphone Infrared Wire Interface
- ②⑧ Aluminum Shell
- ②⑨ Antenna
- ③⑦ Locking Rotary
- ③⑧ Bracket Connection

2.Battery Installation

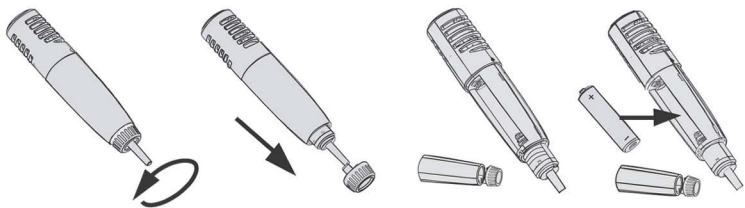

- Rotate the Aluminum Shell ②⑧ at the transmitter's base by rotating counter-clockwise.
- Insert the batteries. (Pay attention to the correct polarities.)
- Replace the cover and rotate clockwise into locked position.

II. Operating Instruction of Handheld Microphone (AUH210):

- Battery Installation(As in Diagram 2)
- Adjust the power switch of the microphone ②⑨ to ON and at this time the indicator ②① will light. When it is in green, it means working properly. You can use it right now.
- Switch the microphone ②⑨ to ON. If the indicator ②① is flashing. It means the battery is out of power. Please change the battery on time.
- Switch the microphone ②⑨ to ON. If the indicator ②① is in red. It means the channels of the transmitter and the receiver are not the same. You need to change them into the same.
- Continuously press the button "OK" for 3 seconds. " 👁 " will appear and flash on the screen. Release pressing "OK". The receiver will go into Auto-Searching Status. The buzzer will sound continuously when the receiver has found an open channel.
- After the reciver's channel has been selected as above, and the receiver is still buzzing, hold the Infrared Wireless Interface ②② of the transmitter several inches from the Infrared Wireless Interface ④ of the receiver.
- Turn on the switch ②⑨ of the handheld transmitter and wait a few seconds for the receiver buzzing to stop, which signals the successful programming of the channel selected on the receiver into the transmitter

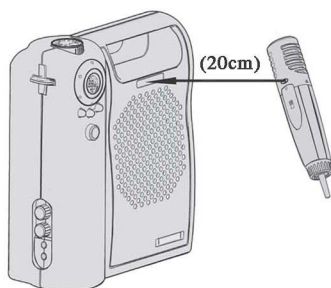

III. Main Specifications of the Transmitter (AUH210):

Type	HandHeld Transmitter (AUH210)
Power	DC:1.2V or 1.5V×1
	One "AA" Battery (alkaline)
RF Output Power	5.7dBm
Harmonic Emissions	>50dB
Battery Life	About 12 hours ※
Dimensions	φ 26×128mm
Weight	55g(without battery)

※ Battery life is determined by its brand and model.

If there will be any change of the technology and specifications for this series of products, we won't notify you separately.

UHF Wireless Amplifier

Tips To Obtain the Best Results

- Use only the fresh alkaline batteries. Do not use “general purpose” (carbon-zinc) batteries.
- Turn the transmitter off when not in use. Remove the battery if the transmitter is not to be used for a period of time.
- A receiver cannot receive signals from two transmitters at the same time.
- The power switch on the transmitter has three positions: “ Off ”, “ Standby ” and “ On ”. In the middle “ Standby ” position, the transmitter sends only RF to the receiver; the audio source is turned off.
- Turn the transmitter off when not in use. Remove the battery if the transmitter is not to be used for a period of time.

One-Year Limited Warranty

This system is hereby limited to one year warranty from the date of purchase from us. Consequential or incident damages resulting from a breach of any applicable express or implied warranties are hereby excluded. This warranty is in lieu of all other agreements and warranties, general or special, express or implied and no representative or person including distributor, agent or employee is authorized to assume for us any other liability in connection with the sale or use of this product.



ARRAY ELECTRONIC CO., LTD.

ADDRESS: XISHANQIAO, YUHUATAI ZONE,

NANJING, 210041, CHINA

TEL: +86 25 5280 1556-223

FAX: +86 25 5280 1218

EMAIL: JENNIFER@ARRAY.SH

HTTP://WWW.ARRAY.SH

Version4.0