

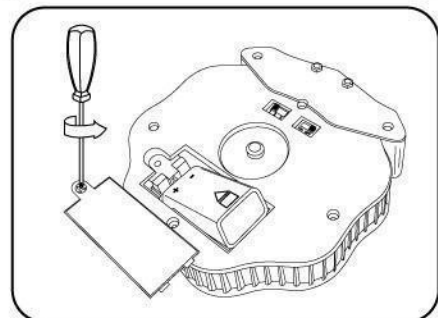

## Note to Adults

To ensure that the child's play is both safe and fun, please review all operating instructions and safety rules with your child.

## Battery and Antenna Installation - Transmitter and Vehicle



Install one 9V battery with polarity (+/-) as shown inside battery compartment.

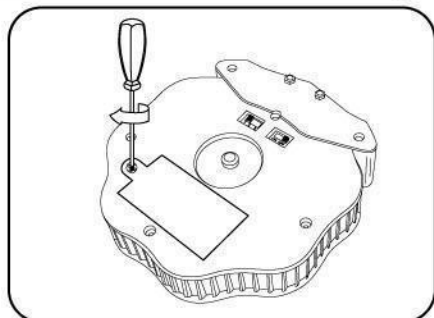

Tighten battery door with a Philips head screwdriver (not included).

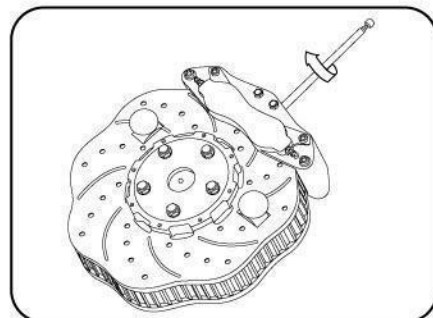

Tighten the antenna into the transmitter.

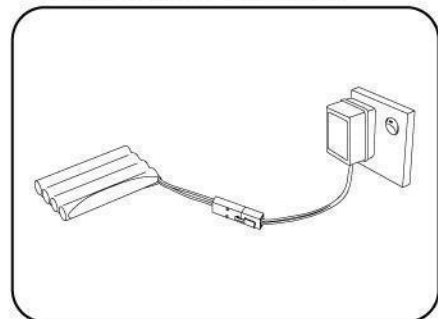

Attach the 9.6V Ni-Cd battery pack to the battery charger, then plug the battery charger into a standard wall outlet.

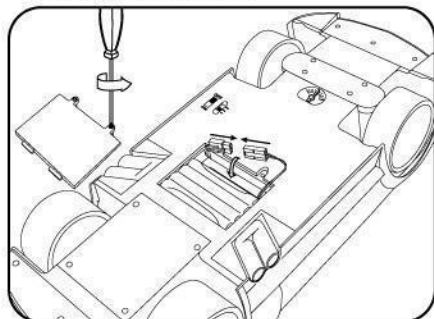

Remove battery door with a Philips head screwdriver (not included) and attach the 9.6V battery pack to the play inside battery compartment with polarity (+/-).

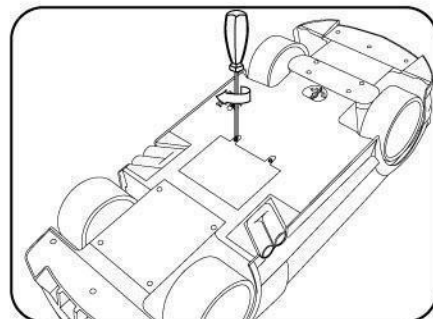

Tighten battery door with a Philips head screwdriver (not included).

## Battery Safety Information

Batteries may leak fluids that can cause damage to your toy. To avoid battery leakage:

- Do not mix old and new batteries or batteries of different types: alkaline, standard (carbon-zinc) or rechargeable (nickel-cadmium).
- Insert batteries as indicated inside the battery compartment.
- Remove batteries during long periods of non-use. Always remove exhausted batteries from the toy.
- Do not dispose of batteries in a fire. The batteries may explode or leak.
- Never short-circuit the battery terminals.
- Use only batteries that are the same or equivalent of those that are required on the box package.
- Do not charge non-rechargeable batteries.
- Remove rechargeable batteries from the toy before charging.
- If rechargeable batteries are used, they should be charged according to manufacturer's specifications and under adult supervision.

## Battery Performance Note

For best performance, use alkaline batteries. Battery life will vary according to brand.

## Rechargeable Ni-Cd Battery Pack Information

This product contains Nickel-Cadmium battery. Battery must be recycled or disposed of properly.

- New battery pack must be charged for 5 hours the first three times charged. After that, subsequent charges will require only 4 hours.
- DO NOT recharge battery pack if it shows leakage or corrosion.
- DO NOT disassemble the battery pack. The battery pack is a sealed rechargeable Nickel-Cadmium battery.
- DO NOT recharge battery pack until it is fully discharged.
- DO NOT overcharge battery pack.
- DO NOT cover the battery pack with any sort of material while charging.

- DO NOT charge non-rechargeable batteries.
- If battery pack and / or charger are wet, thoroughly dry before charging.
- After charging, the battery pack will be warm, this is normal for fully charged batteries.
- After use, the battery pack will be hot, wait until battery pack cools before recharging.

## Battery Charger Information

- Specification of battery charger: INPUT: 120V AC 60Hz 5.5W OUTPUT: 12V DC 200mA
- The battery charger is not a toy.
- If the battery charger is damaged, DO NOT use it.

**CAUTION:** Only allow children at least 8 years old to use the battery charger. The battery charger is not a toy and should be used only under adult supervision.

## Transmitter and Vehicle Operation

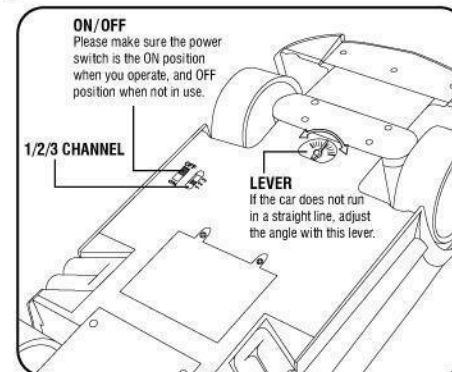

The vehicle has three channels per frequency, please make sure the channel switch is on the corresponding position matched the position of channel switch of the transmitter before play.

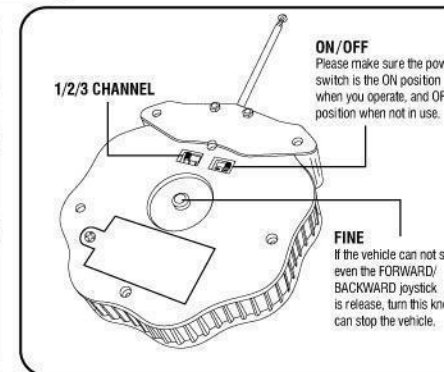

The transmitter has three channels per frequency, please make sure the channel switch is on the corresponding position matched the position of channel switch of the vehicle before play.

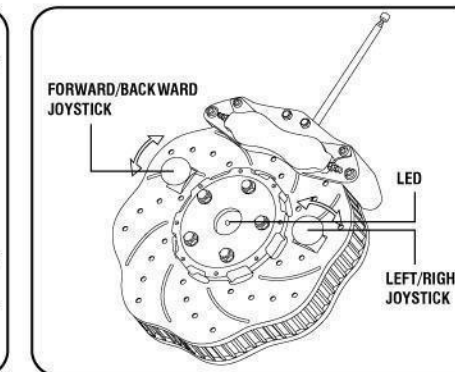

Change the angle of FORWARD/BACKWARD joystick can change the vehicle's speed from slow to fast or from fast to slow.

## Safety Tips

- **NEVER** operate your vehicle on the street, thru water, sand, snow, thick carpet, or in the rain. If your vehicle gets wet, discontinue use until completely dry.
- **DO NOT** pick up vehicle while in motion.
- **DO NOT** store either unit near a source of heat or in direct sunlight for extended period.
- **DO NOT** operate the vehicle on the table top or other elevated surfaces.
- Keep fingers, hair and loose clothing away from the wheels.
- Adult supervision is recommended when this vehicle is being operated.
- **AVOID** running vehicle into objects.
- To avoid accidental operation, leave the power switch in the OFF position and remove all batteries when not in use.

## Quick Tips

- When your vehicle begins to lose performance, power or function, it may be time to replace the batteries.
- Radio interference may cause your vehicle to run poorly. In the event of interference, you may need to operate the vehicle in another location.
- Your vehicle's performance may vary depending on the driving surface.
- Point your transmitter antenna up, not downward toward your vehicle. If your vehicle gets too far away, it won't work properly.
- Smart Circuitry  
If your vehicle gets stalled or stuck during play, a special circuit will cut power to protect it. Release your transmitter and wait 30 seconds or above (reposition your vehicle if necessary), and the vehicle will be ready to operate again.

THE MANUFACTURER IS NOT RESPONSIBLE FOR ANY RADIO OR TV INTERFERENCE CAUSED BY UNAUTHORIZED MODIFICATIONS TO THIS EQUIPMENT. SUCH MODIFICATIONS COULD VOID THE USER AUTHORITY TO OPERATE THE EQUIPMENT

NOTE: This equipment has been tested and found to comply with the limits for a Class B digital device, pursuant to Part 15 of the FCC Rules. These limits are designed to provide reasonable protection against harmful interference in a residential installation. This equipment generates, uses and can radiate radio frequency energy and, if not installed and used in accordance with the instructions, may cause harmful interference to radio communications. However, there is no guarantee that interference will not occur in a particular installation. If this equipment does cause harmful interference to radio or television reception, which can be determined by turning the equipment off and on, the user is encouraged to try to correct the interference by one or more of the following measures:

- Reorient or relocate the receiving antenna.
- Increase the separation between the equipment and receiver.
- Connect the equipment into an outlet on a circuit different from that to which the receiver is connected.
- Consult the dealer or an experienced radio/TV technician for help.



© 2006 ProMarkCo, Limited  
5201 Village Parkway, Suite 301  
Rogers, Arkansas 72758  
MADE & PRINTED IN CHINA

This device complies with Part 15 of the FCC Rules. Operation is subject to the following two conditions:  
(1) this device may not cause harmful interference,  
and (2) this device must accept any interference received, including interference that may cause