

¹ ***Car Hands-Free Wireless Earphones***

LK-168C installation and operational instructions

Thank you for purchasing our product. “LK-168C” is a special car hands-free wireless earphone.

User of wireless earphone will make you enjoy comfortable communications.

In order to use this product effectively, it is suggested that you read the operation instructions carefully before using this product. Keep the instruction manual well.

♪Attention: Our company will take no responsibilities on any consequences due to improper installation and operation with this product.

Product Feature

- Product apply to most of the cellular phones.
- Share of the car “cigar socket” plug
- Exquisite wireless earphone, flexibility on privacy communication,
- Harmonious design and convenient operation
- Automatically switch to cellular phone operation even though when you play MP3 or iPod if there is call coming in or you like to dial out.
- Automatically switch back and forth between cellular phone or FM radio set if MP3 feature is not been use.
- Stereo audio frequency converter has Hi-Fi effect.

Part name

“Figure 1”

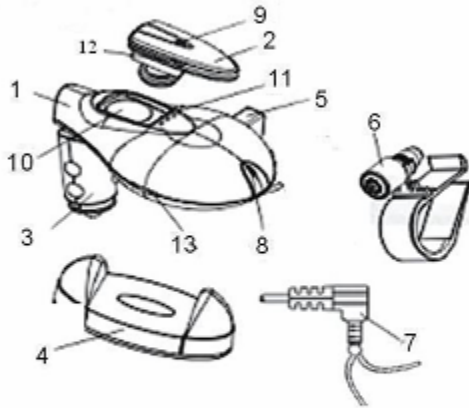

- | | |
|------------------------|--------------------------------------|
| 1) Main unit | 7) Cell phone connector plug |
| 2) Wireless earphone | 8) Main unit Power indicator |
| 3) "Cigar socket" plug | 9) Earphone Power indicator |
| 4) Cellphone holder | 10) Earphone holder |
| 5) Cellphone connector | 11) Wireless earphone charging probe |
| 6) Microphone & clip | 12) Earphone switch |
| | 13) Volume control |

Installation instruction

1. Start engine, and plug in the “Cigar Socket” of the main unit, (Figure 1, #3) into the “ igniter socket” of the car. Make sure the LED lit.(Figure 1, #9)
2. Place the microphone in a suitable position, and make sure the visor facing the user. (Note that installation shall be made on a position without influence on operation and vision field)
3. Connect the main unit connector from the microphone wire to the main unit. (Figure 1, #5) (☺ If earphone socket of cellular phone, please find a compatible adapter, ask your retail store)
4. When you connect MP3 or iPod, please make sure the sound converting line connect to main unit (Figure 1, #7) firmly.
5. ²Turn on the radio, set the Frequency adjustments for your own Transmitting Frequency (For instance, 88.1MHz). Please read the manual for your specification.

6. When you use the earphone, please switch the button to **On** position. When you finish the talk, please set it back to **Off** position. (Keep in mind that the earphone switch always set to OFF position when it in idle position).

Operational Instruction:

1. Please keep your earphone and cellular phone in a certain distance, after you connect the cellular phone with the main unit. (Otherwise, distortion could occur).
2. This product can be used only when the main unit's indicator (Figure 1, #9) is on in red.
3. When there is call coming, for a phone with automatic receiving function, it can perform automatic communication with device at ON position; For a phone without automatic receiving function, it can perform communication only after call key is pressed ON. (Note: partial automatic receiving phones do not work).
4. The received voice (other party's voice)
5. The voice volume from car speaker, it can be adjusted by either the volume-controller of the car radio set or the volume controller of the main unit.
6. When the wireless earphone (Figure1, #2) is being used, it's power LED(Figure 1,#10) is on; When it is not used, put the wireless earphone on the earphone holder for charging (Figure 1, #11). During the charging, wireless earphone's power LED is off. When charging is over, it will automatically stop charging
7. The earphone switch always set to **OFF** position when user is not using it.
8. Our product can convert automatically. When the user's friend takes a call, it can stop enjoying the music from mp3 player with the car audio, let the user talk with his friend freely. After the call it can let the car audio play music with the mp3 player automatically.
9. Put the cellular away from the main unit as far as possible will get better quality on communication.

Federal Communication Commission Interference Statement:

This equipment has been tested and found to comply with the limits for a Class B digital device, pursuant to part 15 of the FCC Rules. These limits are designed to provide reasonable protection against harmful interference in a residential installation. This equipment generates, Uses and can radiate radio frequency energy and, If not installed and used in accordance with the instructions, May cause harmful interference to radio communications. However, there is no guarantee that interference will not occur in a particular installation. If this equipment does cause harmful interference to radio or television reception, which can be determined by turning the equipment off and on, the user is encouraged to try to correct the interference by one of the following measures:

- Reorient or relocate the receiving antenna.
- Increase the separation between the equipment and receiver.
- Connect the equipment into an outlet on a circuit different from that to which the receiver is connected.
- Consult the dealer or an experienced radio/TV technician for help.

FCC CAUTION: Any changes or modifications not expressly approved by the party responsible for compliance could void the user's authority to operate this equipment.

This device complies with Part 15 of the FCC Rules. Operation is subject to the following two conditions: (1) This device may not cause harmful interference, and (2) This device must accept any interference received, including interference that may cause undesired operation.