

If you want to buy more than two wireless microphones, and you are to use them together, please choose those products that frequencies are different. If frequencies are the same, you'd better separate them at least 100m in case they interfere each other.

## PROFESSIONAL WIRELESS MICROPHONE SYSTEM

### VII SPECIFICATION

1. COMPREHENSIVE PERFORMANCE
 

CARRIER FREQUENCY:	VHF174-216MHz
FREQUENCY STABILIZATION	LFSS THAN $\pm 30$ ppm
DYNAMIC RANGE:	MORE THAN 90dB
TOTAL HARMONIC DISTORTION:	LESS THAN 0.5%
FREQUENCY RESPONSE:	40Hz-15KHz $\pm 3$ dB
AUDIO OUTPUT LEVEL:	SEPARATE TYPE: 0- $\pm 400$ mV
MIX TYPE:	0- $\pm 200$ mV
2. FIXED RECEIVER
 

POWER SUPPLY:	DC 17V 200mA
CONSUME POWER:	3 WATT
SIGNAL/NOISE RATIO:	MORE THAN 90dB
IMAGE & SPURIOUS REJECTION:	MORE THAN 80dB
BORDER UPON CHANNEL REJECTION:	MORE THAN 80dB
RECEIVING SENSITIVITY:	10dBuV (STNAD=30dB)
DE-EMPHASIS:	50uS
3. BODYPACK MICROPHONE
 

TRANSMITTER POWER:	8.5mW
MODULATION TYPE:	FM, F3F
MAX DEVIATION:	$\pm 25$ KHz
SPURIOUS EMISSION:	MORE THAN 40dB (WITH CARRIER)
BATTERY VOLTAGE:	9V battery
CONTINUOUS USING:	6 hours

### VIII. REPAIR WITH SIMPLE FAULT

1. Turn on the receiver, but the indicator is not lighted.
  - ☆ Make sure if the power cable is well fixed. Is the socket in good condition? Is the fuse blown?
2. When you speak, the "AUDIO" light twinkles, but no sound output.
  - ☆ Make sure if the volume keep in lowest place, or the audio cable is not fixed well.
3. The effective signal-receiving distance becomes close. And signal receiving is not well.
  - ☆ Perhaps you have not put out the antennas.
  - Perhaps you should change a new battery.
  - Perhaps the receiver is not put in right place.
  - Perhaps there is a strong magnetic field in your surroundings.
4. Timbre becomes bad
  - ☆ Perhaps the voltage of the battery is not enough. You need change. Perhaps there are the same frequency signals in your surroundings. Do not use two machines with the same frequency at the same time in a place. (Separate them at least 100M.)

※ Don't open and repair it when some serious breakdown happens. Please connect the seller or our company, we'll help you wholeheartedly. Thank you!

### SYSTEM COMPOSITION

- |                  |    |
|------------------|----|
| 1. receiver      | x1 |
| 2. microphones   | x1 |
| 3. audio cable   | x1 |
| 4. power Adapter | x1 |
| 5. battery 9v    | x1 |

### ATTENTION

1. Avoid putting the main machine in a blind angle when it is used. This is for keeping signal receiving in good condition.
2. Don't throw fall, toss, cast the handling microphone when it is used, in case damage it seriously.
3. Please keep the machine from direct sunshine or rains. And put it in a place as far as possible from the magnetic field.
4. Don't open it yourself, because there is high voltage in it.

**Thank you for buying our excellent wireless microphone series products. Before you use our products please read this Owner's Manual, so that you can enjoy it.**

## PROFESSIONAL WIRELESS MICROPHONE SYSTEM

**Enbao**®

**VHF**  
MODEL: SG-866

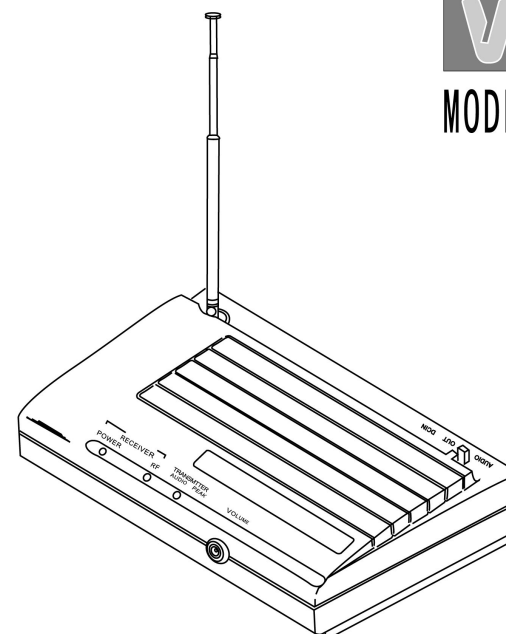

## OPERATION MANUAL

**BEFORE USING THE MACHINE PLEASE  
READ THIS OWNER'S MANUAL**

## I. FUNCTION INTRODUCTION

Our special Wireless microphone system SG-866 has these characteristics as the following. For many reasons, such as low frequency, traditional wireless microphones system are easy to be interfered especially because many machines CD, VCD and LD, radiate out too many harmonic. To solve this problem we design this kind professional wireless microphone. We adopt a series of measures to improve its functions, advance frequency, using multilevel high frequency and mid frequency narrowband filter, multiple noise detect and control. We also design it special functions (tone key locked identity) to avoid interference from outside.

## II. MAIN FUNCTION

- ▲ Using VHF 220-270 Mhz band to avert interfering frequency.
- ▲ Using multilevel high frequency and mid frequency narrowband filter, so as to dispel any possible interfering signals.
- ▲ The wireless microphone uses hidden antenna, looks good and are useful.
- ▲ There is a voltage indicating circuit in the microphone. It can tell you if it is necessary to change the battery.
- ▲ A specially designed circuit switch is on the phone. It is for clearing up waves of miscellaneous signals.
- ▲ All use quartz crystal oscillating circuits, so the frequency is very steady.
- ▲ With audio compressing-expanding technology, the machine can lower noises and increase the dynamic range. It can also lower reecho.
- ▲ Particular noise detect to avoid interference from outside opens the mute system.
- ▲ Choose excellent chipset and high quality component, so that its timbre is very good.
- ▲ Longest distance in open: 80m. Ideal distance in open: 40m
- ▲ It is suitable for stages, ballrooms, auditoria, classrooms and families.

## III. OPERATION OF THE RECEIVER

1. Pull out antenna, make them be perpendicular with the machine.
2. Power line Connection to DC 18V socket.
3. Connection of the audio output: One end of the audio cable into "AUDIO OUT" socket and other end audio amplifier or mixer's "MIX IN" or "AUX IN" socket.
4. Push the power switch, the power-indicating light is lighted.
5. When the microphone is working the "RF" light of the receiver is lighted, The receiver output voice, volume of the receiver can be controlled by adjusting the volume knob.

- ★ Attention when you install of the receiver  
It should be more than 1m high from the floor.  
It should be more than 1m beyond the wall.  
Antennas should be put out fully, otherwise it'll influence receiving signals.

## IV. OPERATION OF THE MICROPHONE

1. Open the battery box, then put in a 9v battery.  
Attention: The polarity should be right.
2. Turn on the microphone. If the light does not twinkle or is always lighted, you should check the battery if the voltage is enough or the battery is well arranged.
3. Turn the mute switch to middle, the receiver will cut out audio output and control noises through it.

## V. RECEIVER FEATURES

1. POWER ON INDICATOR: Glows green when the receiver is powered on.
2. RF SIGNAL INDICATOR: Glows yellow when RF signals are received.
3. TRANSMITTER AUDIO PEAK INDICATOR: Flashes red when the audio signal.
4. VOLUME CONTROL: Adjusts the output volume of the receiver.
5. TELESCOPING ANTENNA: Receives signals from the transmitter.
6. AUDIO OUTPUT: Output the audio signals for connection to amplifiers.
7. PLASTIC SHELL: Receiver plastic shell.
8. POWER INPUT: Accepts power from supplied AC adapter.

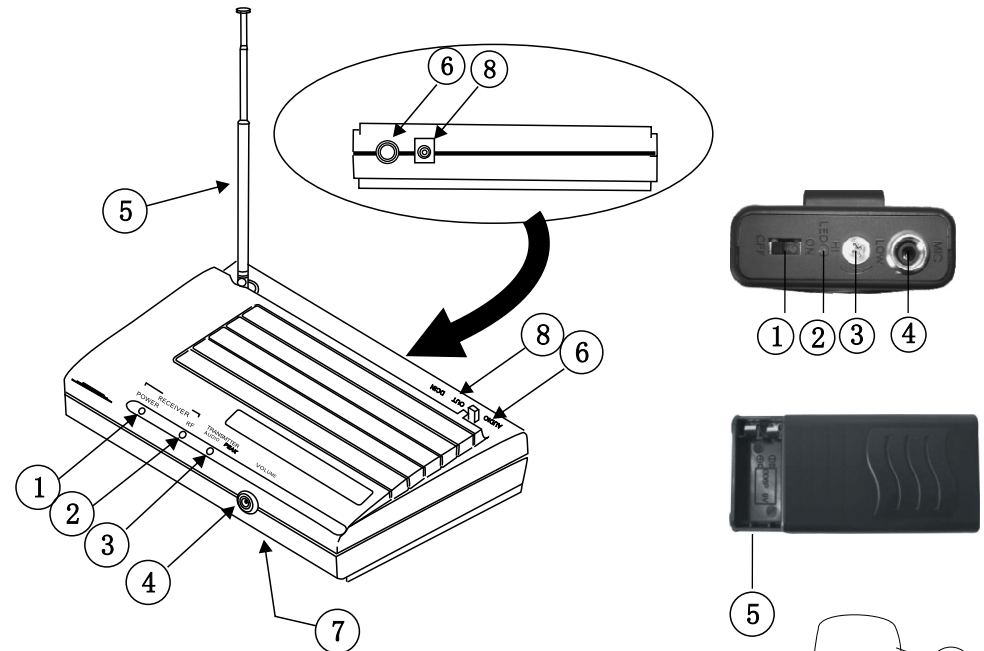

## VI. CONTROL AND FUNCTION (Microphone)

- 1: Power switch.
- 2: Low voltage indicator.
- 3: Input attenuation.
- 4: AF input.
- 5: Battery room.
- 6: Mic
- 7: Battery indicator
- 8: Power & silent switch
- 9: Battery case

